

## ELF15J THIN LINE STATIONARY LOUVER EXTRUDED ALUMINUM

### STANDARD CONSTRUCTION

#### FRAME

1 1/2" (38) deep, 6063T5 extruded aluminum with .063" (1.6) nominal wall thickness. Caulking surfaces provided.

#### BLADES

6063T5 extruded aluminum with .063" (1.6) nominal wall thickness. Blades are positioned at 45° angle and spaced approximately 1 7/8" (48) center to center.

#### SCREEN

5/8" x .040" (16 x 1) expanded, flattened aluminum bird screen in removable frame. Screen adds approximately 1/2" (13) to louver depth.

#### FINISH

Mill.

#### MINIMUM SIZE

6"w x 6"h (152 x 152).

#### APPROXIMATE SHIPPING WEIGHT

2.5 lb. per sq. ft. (12.2 kg/m²).

#### MAXIMUM FACTORY ASSEMBLY SIZE

Shall be 60 sq. ft. (5.6m²) per section, not to exceed 120"w x 72"h (3048 x 1829) or 72"w x 120"h (1829 x 3048).

Louvers larger than the maximum factory assembly size will require field assembly of smaller sections.

#### SUPPORTS

Louvers may be provided with rear mounted blade supports that increase overall louver depth depending on louver size, assembly configuration or wind-load.

Consult Ruskin for additional information.

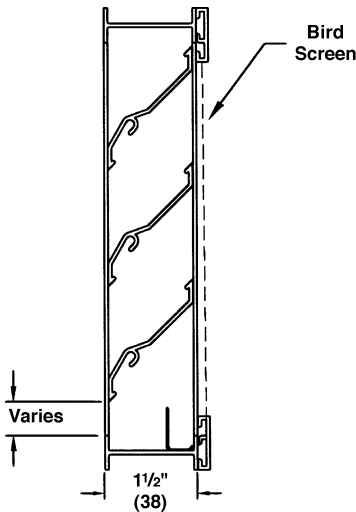
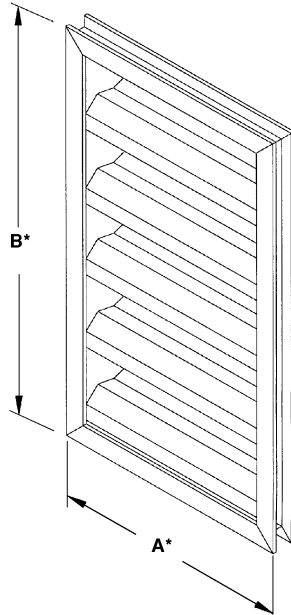

### FEATURES

The ELF15J offers:

- 50% Free Area.
- Published performance ratings based on testing in accordance with AMCA Publication 511.
- Aluminum construction for low maintenance and high resistance to corrosion.

### VARIATIONS

Variations to the basic design of this louver are available at additional cost. They include:

- Extended sill.
- Hinged frame.
- Front or rear security bars.
- Filter racks.
- Installation angles.
- A variety of bird and insect screens.
- Selection of finishes: prime coat, baked enamel (modified fluoropolymer), epoxy, Pearledize, Kynar, clear and color anodize. (Some variation in anodize color consistency is possible.)

Consult Ruskin for other special requirements.

### FRAME CONSTRUCTION

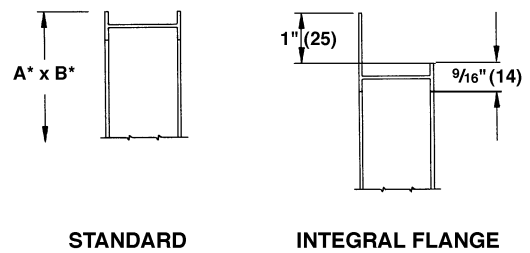

Dimensions in inches, parenthesis ( ) indicate millimeters.

\*Units furnished 1/4" (6) smaller than given opening dimensions.

TAG	QTY.	SIZE		FRAME	VARIATIONS
		A*-WIDE	B*-HIGH		
PROJECT ARCH./ENGR. REPRESENTATIVE				LOCATION CONTRACTOR DATE	

# TYPICAL INSTALLATION DETAILS

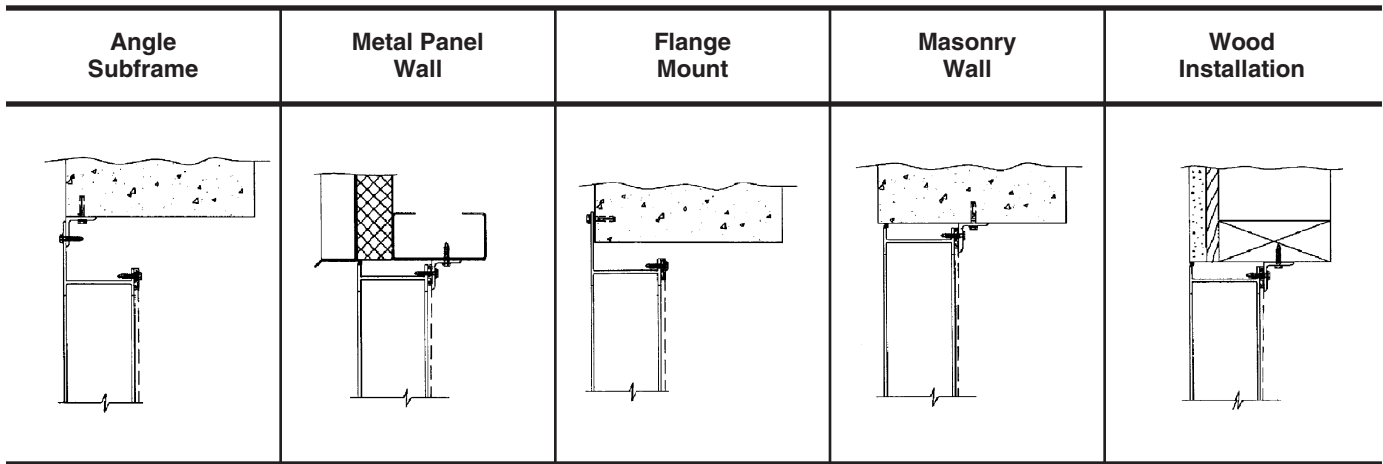

## SUGGESTED SPECIFICATION

Furnish and install louvers as hereinafter specified where shown on plans or as described in schedules. Louvers shall be stationary type. Louvers shall have a minimum of 50% free area based on a 48" wide x 48" high (1219 x 1219) size. Stationary blades shall be contained within a 1 1/2" (38) frame. Louver components (heads, jambs, sills, blades & mullions) shall be factory assembled by the louver manufacturer. Louver sizes too large for shipping shall be built up by the contractor from factory assembled louver sections to provide overall sizes required. Louver design shall incorporate structural supports required to withstand a wind load of 20 lbs. per sq. ft. (.96kPa) (equivalent of a 90 mph [145 KPH] wind - specifier may substitute any loading required).

Louvers shall be Ruskin Model ELF15J extruded 6063T5 aluminum alloy construction as follows:

Frame: 1 1/2" (38) deep .063" (1.6) wall thickness.

Blades: .063" (1.6) nominal wall thickness. Blades are positioned at 45° angle and spaced at approximately 17/8" (48) center to center.

Screen: 3/4" x .051" (19 x 1.3) expanded, flattened aluminum in removable frame.

Finish: Select finish specification from Ruskin Finishes Brochure.

Published louver performance data derived from testing in accordance with AMCA 500 for Air Performance must be submitted for approval prior to fabrication and must demonstrate pressure drop equal to or less than the Ruskin model specified.

## PRESSURE DROP

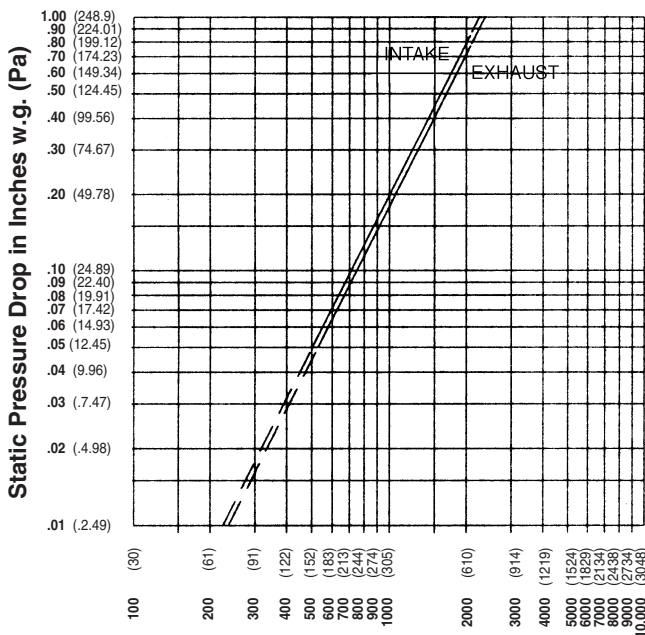

## FREE AREA GUIDE

Free Area Guide shows free area in ft² and m² for various sizes of ELF15J.

Width – Inches and Meters

	12	18	24	30	36	42	48	54	60
	0.30	0.46	0.61	0.76	0.91	1.07	1.22	1.37	1.52
<b>12</b>	<b>0.37</b>	<b>0.58</b>	<b>0.79</b>	<b>1.01</b>	<b>1.22</b>	<b>1.43</b>	<b>1.64</b>	<b>1.85</b>	<b>2.06</b>
0.30	0.03	0.05	0.07	0.09	0.11	0.13	0.15	0.17	0.19
<b>18</b>	<b>0.62</b>	<b>0.98</b>	<b>1.33</b>	<b>1.69</b>	<b>2.04</b>	<b>2.39</b>	<b>2.75</b>	<b>3.10</b>	<b>3.46</b>
0.46	0.06	0.09	0.12	0.16	0.19	0.22	0.26	0.29	0.32
<b>24</b>	<b>0.87</b>	<b>1.37</b>	<b>1.87</b>	<b>2.37</b>	<b>2.86</b>	<b>3.36</b>	<b>3.86</b>	<b>4.36</b>	<b>4.85</b>
0.61	0.08	0.13	0.17	0.22	0.27	0.31	0.36	0.41	0.45
<b>30</b>	<b>1.06</b>	<b>1.66</b>	<b>2.27</b>	<b>2.88</b>	<b>3.48</b>	<b>4.09</b>	<b>4.69</b>	<b>5.30</b>	<b>5.90</b>
0.76	0.10	0.15	0.21	0.27	0.32	0.38	0.44	0.49	0.55
<b>36</b>	<b>1.31</b>	<b>2.06</b>	<b>2.81</b>	<b>3.56</b>	<b>4.30</b>	<b>5.05</b>	<b>5.80</b>	<b>6.55</b>	<b>7.30</b>
0.91	0.12	0.19	0.26	0.33	0.40	0.47	0.54	0.61	0.68
<b>42</b>	<b>1.56</b>	<b>2.45</b>	<b>3.34</b>	<b>4.24</b>	<b>5.13</b>	<b>6.02</b>	<b>6.91</b>	<b>7.80</b>	<b>8.69</b>
1.07	0.06	0.10	0.13	0.17	0.20	0.24	0.27	0.31	0.34
<b>48</b>	<b>1.81</b>	<b>2.85</b>	<b>3.88</b>	<b>4.92</b>	<b>5.95</b>	<b>6.98</b>	<b>8.02</b>	<b>9.05</b>	<b>10.09</b>
1.22	0.17	0.26	0.36	0.46	0.55	0.65	0.75	0.84	0.94
<b>54</b>	<b>2.06</b>	<b>3.24</b>	<b>4.42</b>	<b>5.60</b>	<b>6.77</b>	<b>7.95</b>	<b>9.13</b>	<b>10.31</b>	<b>11.48</b>
1.37	0.19	0.30	0.41	0.52	0.63	0.74	0.85	0.96	1.07
<b>60</b>	<b>2.25</b>	<b>3.53</b>	<b>4.82</b>	<b>6.11</b>	<b>7.39</b>	<b>8.68</b>	<b>9.96</b>	<b>11.25</b>	<b>12.53</b>
1.52	0.21	0.33	0.45	0.57	0.69	0.81	0.93	1.05	1.17

Free area velocity at point of .01 oz./ft.² (3g/m²) of free area water penetration: 390 fpm (119 m/min).



3900 Dr. Greaves Rd.  
 Kansas City, MO 64030  
 (816) 761-7476  
 FAX (816) 765-8955  
 www.ruskin.com