

High Performance Sound Rated Floor System

Model Ultra Quiet SR

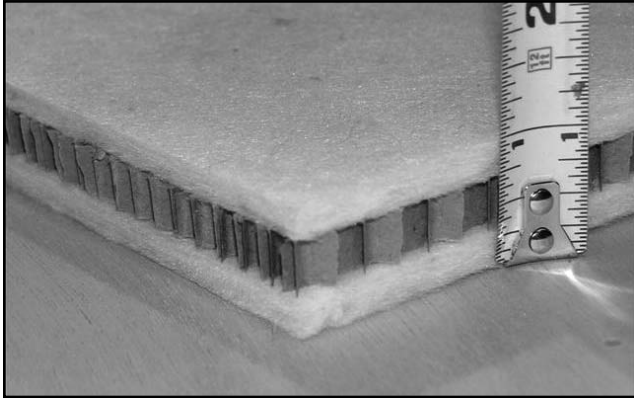

Kinetics Model Ultra Quiet SR Floorboard is a high performance continuous underlayment material which substantially reduces impact noise transmission through hard surface floor systems. Lab Ratings of IIC (Impact Insulation Class) approaching 60 are possible in typical applications, compared with IIC-25 to 34 with conventional construction.

Model Ultra Quiet SR Floorboard is a new concept in the control of noise in condominiums, apartments, multi-family dwellings, commercial buildings, and other areas where footfall and impact noise can be the cause of occupant complaints.

Model Ultra Quiet SR Floorboard is a 1 inch (25 mm) thick composite of high density molded glass fibers separated by a rigid phenolic-treated honeycomb core

Features

- **Greater noise control than typical ¼ to ½ inch sound control mats**
- Withstands live loads up to 1000 psf
- Maintains strength even when wet
- Cuts easily with standard construction knife
- Very lightweight, easy to handle and install
- Approved for use with gypsum concrete, standard concrete, and built up wood floors
- Combines high resilience and sound absorption in a single layer
- Does not shrink or curl like nylon fiber products

Application

Many occupants have a preference for hard surface floors such as ceramic tile, quarry tile, marble, hardwood flooring, engineered floors, or vinyl tile. Without carpeting to cushion footfalls, impact noise will be heard clearly in the occupied spaces below.

Many localities have adopted building codes which require minimum IIC and STC ratings for floor/ceiling systems. An IIC of 50 or less will result in disturbing impact sounds below. With an IIC of 50 to 60, certain sounds may be audible in the spaces below. Acousticians familiar with noise issues in high end condominium buildings often recommend a lab tested assembly with ratings in the 55 to 60 range to minimize occupant complaints.

Ultra Quiet SR Floorboard is used where more typical ¼" to ½" sound control mats do not provide the necessary sound reduction. This 1-inch thick resilient layer dramatically improves impact (IIC) noise ratings through the floor assembly while increasing the STC rating for airborne noise as well.

For use with either wood frame or concrete structural floors, Ultra Quiet SR Floorboard can be installed with a reinforced mortar bed, gypsum concrete, or a poured concrete slab.

Technical Data

- Size: 4' x 6'
- Thickness: 1"
- Nominal Weight: 16 lbs./sheet
- Approved for use with 1-1/2" gypsum concrete, 2000 psi minimum with metal lath reinforcing. See installation guidelines.



Acoustical Tests

Hardwood Floor with 1/8" Pad
 Gypsum Concrete
Kinetics Ultra Quiet SR Floorboard
 3/4" Plywood
 14" I-Joist
 6" Fiberglass Insulation
 Resilient Channel
 2 Layers of 5/8" Gypsum Board

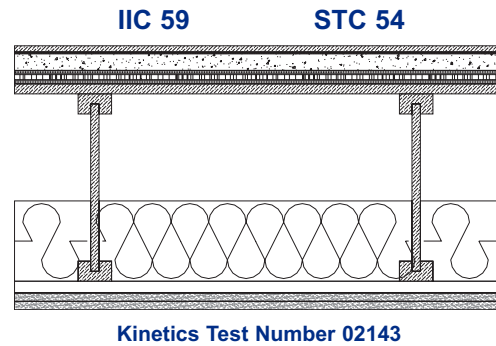

Hardwood Floor with 1/8" Pad
 Gypsum Concrete
Kinetics Ultra Quiet SR Floorboard
 3/4" Plywood
 14" I-Joist
 6" Fiberglass Insulation
 2 Layers of 5/8" Gypsum Board - Direct Screw attachment
No Resilient Channel

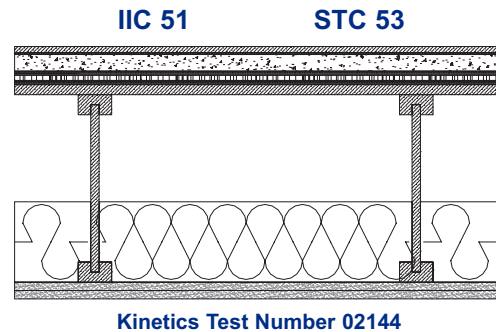

Hardwood Floor with 1/8" Pad
 Gypsum Concrete
 3/4" Plywood
 14" I-Joist
 6" Fiberglass Insulation
 2 Layers of 5/8" Gypsum Board - Direct Screw attachment
No Resilient Channel

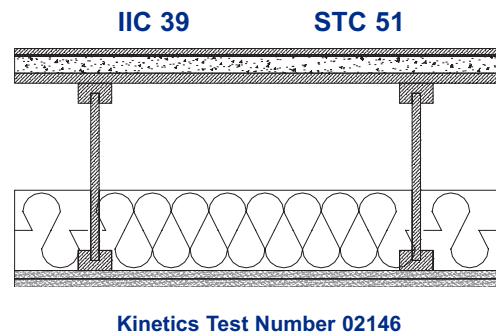

Typical Edge Detail

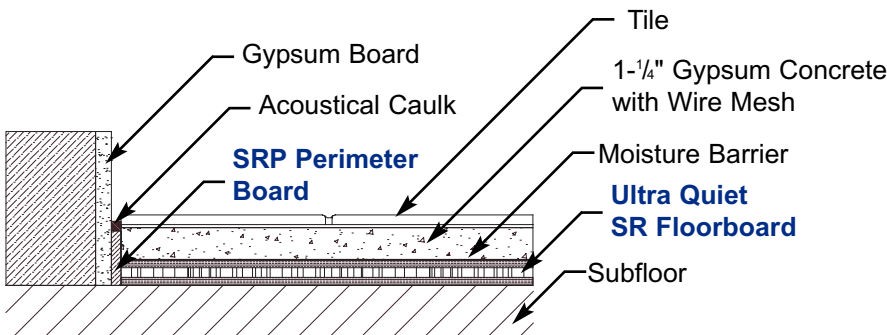

United States	Canada
6300 Irelan Place	3570 Nashua Drive
P.O. Box 655	Mississauga, Ontario
Dublin, Ohio 43017	L4V 1L2
Phone: 614-889-0480	Phone: 905-670-4922
Fax: 614-889-0540	Fax: 905-670-1698

www.kineticsnoise.com
archsales@kineticsnoise.com

Kinetics Noise Control, Inc. is continually upgrading the quality of our products. We reserve the right to make changes to this and all products without notice.

Download Model Ultra Quiet SR information including three-part specification, installation guidelines, and typical installation drawings at www.kineticsnoise.com/arch/ultraquiet.aspx. Call the factory at 800-959-1229 if needing additional information; ask for Architectural sales. Purchase Model Ultra Quiet SR and accessories through your local sales representative (www.kineticsnoise.com/arch/rep/).