

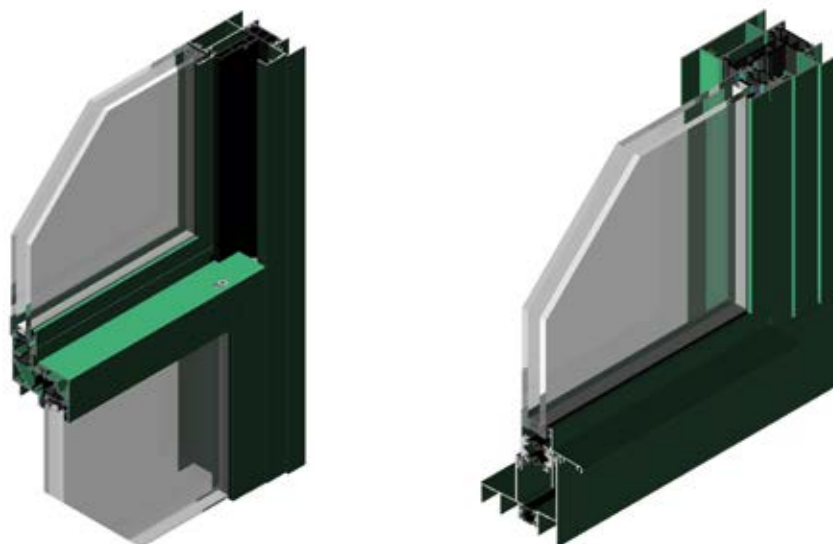

## Series HX32 Single Hung/Tilt • Series FX32 Fixed 3 1/4" High Performance Thermal, Architectural Grade Windows



### HX32 HIGH PERFORMANCE THERMAL SINGLE HUNG TILT

Designed to meet the increasing demand for thermally innovative products needed for schools, government buildings and multi-family housing, EFCO's HX32 single hung / tilt window, combines superior thermal U-factors with architectural grade structural performance to meet the high standards and specifications of today's building envelope requirements.

#### Features

#### Benefits

3 1/4" Frame depth	Provides economy and versatility with other EFCO systems
Single Hung Tilt configuration	Allows cleaning from interior of building
10 lb water	Provides superior protection from the elements
Architectural rating of AW50	Independent lab AAMA certification
Fully strutted- 2 color availability	Enhances architectural aesthetics
1" Glazing pocket	Allows for broader glazing options
Internal Glass muntins available	Simulates historical grid applications
U-Factor as low as .35 (see chart on page 2)	Reduces energy consumption
CRF of 65	Warmer interior surface temperatures and comfort
Base STC of 33 with standard annealed insulating glass	Reduces outside noise
Block and tackle or Class F balance options	Allows window size versatility while maintaining consistent operation forces
Series FX32 fixed stacking mate, U-Factor of .33	Provides transom, various round top and side light options
Full line of EFCO XTherm® accessories	Sub-frames and mullions provide structural support and construction tolerance
Snap-in nail flange / vapor barrier	Provides for ease of installation and coordination with air/vapor barrier construction



# Series HX32 Single Hung/Tilt • Series FX32 Fixed 3 1/4" High Performance Thermal, Architectural Grade Windows

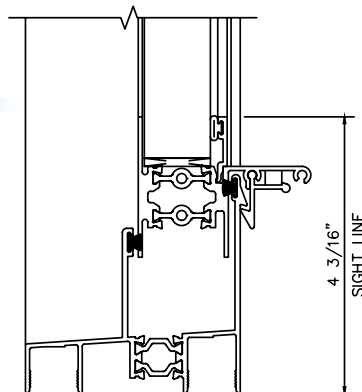
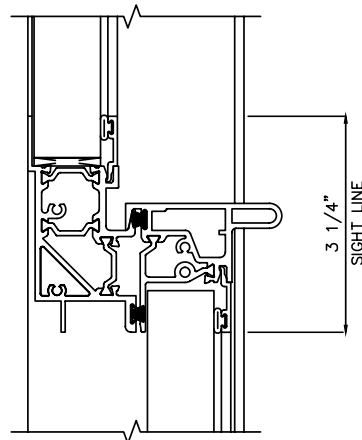
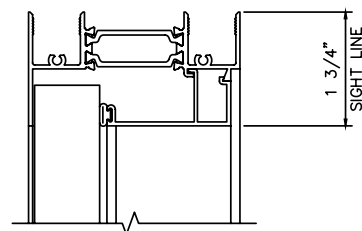
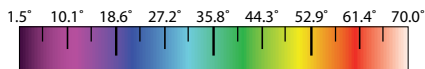
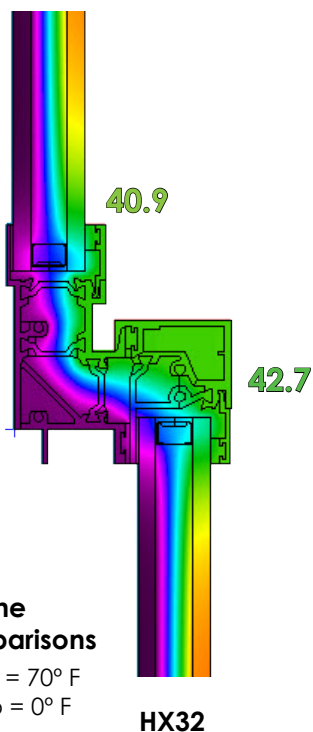

## PERFORMANCE DATA

### HX32 SINGLE HUNG

AAMA RATING	AW50
AIR INFILTRATION	<.24 CFM/SF @ 6.24 PSF
WATER	NO LEAKAGE @ 10 PSF
STRUCTURAL	75 PSF
CRF-FRAME	65

*Note: All performance data is subject to change based on testing recertification and/or revised AAMA testing protocol. Please contact EFCO for latest performance values.*

### FX32 SINGLE HUNG

AAMA RATING	AW80
AIR INFILTRATION	<.10 CFM/SF @ 6.24 PSF
WATER	NO LEAKAGE @ 12 PSF
STRUCTURAL	130 PSF
CRF-FRAME	73

HX32 THERMAL U-FACTORS	
CENTER OF GLASS U-FACTOR	SINGLE HUNG 47" X 59"
.34	.45
.30	.42
.24	.38
.20	.35

FX32 THERMAL U-FACTORS	
CENTER OF GLASS U-FACTOR	FIXED 47" X 59"
.34	.41
.30	.38
.24	.33
.20	.29

HX32 HARDWARE CHART	SWEEP LOCK	AUTO SILL LOCK	2 OR 4 BLOCK & TACKLE BALANCES	2 CLASS 5 BALANCES
SINGLE HUNG	S	O	S	O

O - Optional  
S - Standard  
Blank - N/A

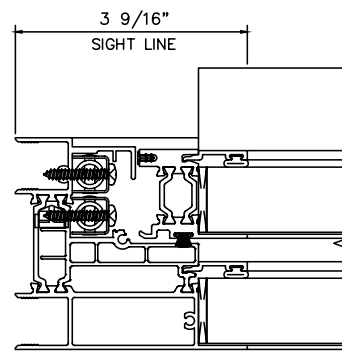

# Series HX32 Single Hung/Tilt • Series FX32 Fixed 3 1/4" High Performance Thermal, Architectural Grade Windows

## Main Frame Construction

The frames have a depth of 3 1/4" and are constructed of 6063-T6 aluminum alloy. The nominal material wall thickness for the frame is .062", and the sill has a minimum wall thickness of .062". Corners are of screw spline construction and sealed. See Illustration 1.

## Sash Frame Construction

The sash consists of aluminum members with .062" nominal material wall thickness of 6063-T6 alloy. Corners are of screw spline construction and sealed. Dual weather-stripped continuous interlock at the sash meeting rail(s) offers superior weathering and structural performance. See Illustration 2.

## Thermal Barrier

All members are thermally isolated with thermal struts consisting of glass reinforced polyamide nylon, mechanically crimped in raceways extruded in the exterior and interior extrusions. See Illustration 3.

## Weather Stripping

All sash are weather-stripped with FIN-SEAL® or equal. Two holes through the window frame facilitate weepage.

## Screens

Screen frames are extruded 6063-T6 aluminum alloy. Half screens are easily removed by side loading, no clips or plunger operation required. 18 x 16 mesh screens are available in fiberglass and .011" diameter aluminum. 18 x 18 mesh screens are available in .009" diameter stainless steel.

## Hardware

Painted, zinc die cast sweep locks. Automatic sill locks are fabricated of aluminum alloy and finished to match the window. Meeting rail is secured with retractable, stainless steel, Allen keyed, tilt latch screws. See illustration 1. Two types of balance systems are available. A spring loaded block and tackle balance rated Class 1 with a .70 MAF\* ratio is standard. A high performance torsion spring and extension spring balance rated Class 5 with a .30 MAF\* ratio is optional. EFCO reserves the right to substitute a higher performance balance as project conditions dictate, i.e., large, heavy sash requiring minimum operating force. See the Hardware Chart for available hardware types.

## Glazing

Sash is inside glazed with an extruded aluminum glazing bead for 1" overall glazing depth.

## Finishes

A full range of Class 1 anodized finishes in clear, champagne, light-med-dark bronze ranges and black. High performance 50% and 70% PVDF flurpolymer painted coatings are available in a practically unlimited custom color palette.

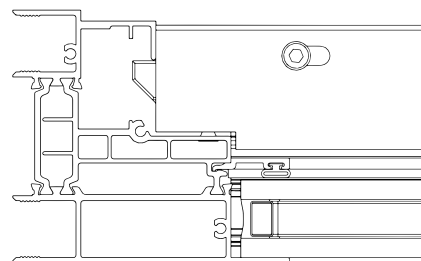

Illustration 1

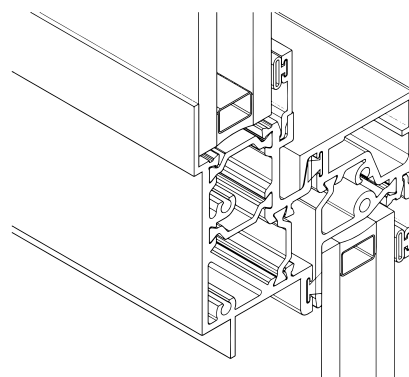

Illustration 2

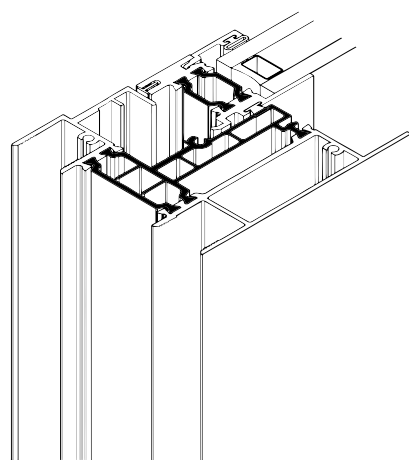

Illustration 3

