CHOOSING THE PROPER INLET GRATE

Adopting an inlet grate design requires an analysis of the functions the grate should perform. A designer must review the drainage requirements and then specify which functions will be necessary for satisfactory grate and all other performance requirements of each application. For example, if the only consideration is for the grate to efficiently intercept large quantities of storm water from the gutter, then a grate with the proper geometry and flow-through area is the one to choose. Although capacity is an important function, there are other considerations that must be evaluated to satisfy the requirements of a functional, correctly located, safe grate. Designers must note that there may be other considerations in addition to those listed below that should be evaluated prior to making a choice. **SEE, ESPECIALLY, "IMPORTANT INFORMATION ON CHOOSING THE RIGHT CASTING FOR YOUR APPLICATION," BEGINNING ON PAGE 7 OF THIS CATALOG, INCLUDING THE MATERIAL THERE CONCERNING HANDICAPPED PERSON, PEDESTRIAN AND BICYCLE SAFETY CONCERNS.**

CONSIDERATIONS FOR HANDICAPPED PERSONS, BICYCLES AND PEDESTRIANS

Design and placement of the grate must be suitable for use in areas where handicapped persons, bicycles and pedestrians may be present.

The adoption of the Americans with Disabilities Act (ADA), the prominence of narrow-tired bicycles and concern for pedestrian safety dictates that designers carefully consider the safety of the type of grating selected for various applications. If the installation is changed in concept, scope or usage pattern at some future date, designers must at that time reconsider the types of gratings used and determine if they still meet their safety requirements. If not, designers must replace these existing grates with more appropriate styles.

GRATES FOR BICYCLES

The designer must determine the appropriate grate design and inlet location for safe use by bicycle traffic, having in mind the specific details of location and foreseeable use. The following are some important considerations:

1. The style of grate employed should allow bicycle travel from all accessible directions. Grates located in open areas, or adjacent to driveways, or in other locations where they are not adjacent to barrier curbs require special attention in this regard.
2. In general, we suggest consideration of our Type L vane style grates. Certain grates shown in our catalog are generally not suitable for use where bicycle traffic is a consideration. The designer is responsible for making the appropriate grate selection.
3. If slotted grates or vane-type grates other than our Type L are considered, they should have sufficiently narrow openings and/or should have appropriately spaced transverse (cross) bars to ensure that any foreseeable width and diameter of bicycle tire cannot drop down into openings to an unsafe extent.
4. Gutter slopes should not be substantially swaled into the curb so as to create a disturbance in the roadway which might affect the ability of bicycles or other traffic to traverse them.

GRATES FOR PEDESTRIANS AND HANDICAPPED

Various regulations or customs may dictate the use of specific types of grates, such as gratings with longitudinal slope openings no greater than 1/4" or 1/2". Designers must carefully evaluate the location and placement of grates against applicable specifications to be sure they are using grates that will satisfy the specification's requirement and provide a pathway (accessible route) for pedestrians and handicapped persons. The Americans with Disabilities Act (ADA) provides grating specification guidelines that can be used in creating accessible routes for handicapped individuals.

HYDRAULIC EFFICIENCY

The ability of a grate to intercept storm water or its hydraulic efficiency is an important function. The main considerations in design are the geometry and the flow-through area of the openings for each individual grate. NEENAH has recognized the designers need for hydraulic information on individual grates. We studied individual grate performance by establishing our own hydraulic testing program and are now capable of supplying grate capacity information on the grates shown in this catalog. Please contact us for specific charts and information.

SCREENING OUT HARMFUL DEBRIS

An inlet grate must act as a strainer and prevent harmful debris from entering sewer lines. Objects such as branches, large sheets of semi rigid material, sticks, chunks of wood, etc. which are easily passed by large curb openings (open throat) are conveniently prevented from entering the catch basin by a well chosen grate.

If large debris gets into the catch basin, it can often float or wash into the lines, clogging them at inaccessible locations and making the drainage system ineffective.

Should clogging of the grate occur at the upstream end, grates of longer lengths usually provide the extra flow-through capacity necessary to accommodate the gutter flow as well as some of the side flow.

ABILITY TO PASS UNOBJECTIONABLE DEBRIS

Organic material such as grass clippings, leaves, small stones, scraps of paper and even small twigs should be passed into the catch basin. Because of their size and configuration they are not a hazard for the sewer lines.

Grates designed with closely spaced bars for strength and safety become easily clogged from very small but always present debris. The problem is magnified even more as this debris is packed into the openings by passing traffic creating a hard, semi-solid surface. If the velocity of the gutter flow is insufficient to dislodge the packed debris, the grate becomes ineffective.

The answer then is to provide grate openings wide enough, of suitable length or of special design to pass this debris and still meet the other requirements. NEENAH has many sizes and styles that can be implemented into your designs.

STRENGTH

Inlet grates placed in roadways must be designed to withstand heavy traffic loads. A common designation for standard highway loads is described as H20-44 loading for single axle trucks and HS20-44 for tandem axle trucks (tractor semi-trailer units) The maximum axle loading in both cases is 32,000 lbs, or 16,000 lbs. for each set of dual wheels. There may be cases where more extreme design loads are necessary such as airports, commercial applications, industrial sites or installations where extra heavy loads and/or extremely hard tires are present. Refer to page 5, **Castings for Different Traffic Conditions** for additional information.

DURABILITY

A gutter inlet grate should be designed to match or exceed the expected life of the installation. The inherent rust-resisting properties of unpainted cast iron and its time-tested performance insures long life. The strength of cast iron grates resists earth and pavement pressures - qualities one should question in other non-cast iron materials.

■ **Note:** When specifying/ordering grates, refer to “Choosing the proper inlet grate” on pages 117-118.
 For a complete listing of FREE OPEN AREAS and WEIR PERIMETERS of all NEENAH grates, refer to pages 306-311.

STORM WATER MANAGEMENT WITH NEENAH GRATES

An important consideration in any storm water management plan is the proper selection and use of drainage grates. The NEENAH line of inlet, area and drainage grates offers hundreds and hundreds of choices. Different shapes, sizes and geometry provide varying capacities which can match your inlet and outlet control requirements.

When runoff conditions overtax sewer lines or treatment capacity, engineers frequently detain excess storm water by temporarily impounding storm water in suitable depressed open space areas, parking lots or other available basin type structures. With NEENAH capacity rated grates, ponded water can be slowly released at a controlled rate as sewer lines and treatment facilities are able to accept new discharges.

SEE "IMPORTANT INFORMATION ON CHOOSING THE RIGHT CASTING FOR YOUR APPLICATION," BEGINNING ON PAGE 7 OF THIS CATALOG, INCLUDING THE MATERIAL THERE CONCERNING HANDICAPPED PERSON, PEDESTRIAN AND BICYCLE SAFETY CONCERNS.

Specific applications of NEENAH drainage grate products include:



MEDIAN DRAIN AND FREEWAY DRAINAGE

Stormwater management on freeways is important so that roads are safe for motorists during wet weather. NEENAH offers a variety of choices for inlet boxes, median inlets or ditch checks.



TRENCH FRAME AND GRATE

For draining large impervious areas, many designers specify NEENAH trench drains. Sizes range from 6" to 48" widths. Drains can be installed in any length with direction changes to suit the area and drainage conditions.



HIGH CAPACITY VANE STYLE TYPE "L"

NEENAH's high capacity vane style grates offer designers the best combination of hydraulic efficiency and safety for triangular gutter slope applications.

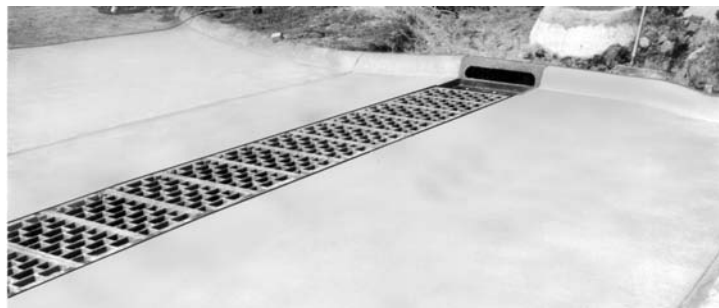

SHEET FLOW INTERCEPTING GRATES

There are numerous occasions when designers desire to remove sheet flow from streets or parking lots. NEENAH has addressed this need with specialized castings suited for various situations.

■ Note: When specifying/ordering grates, refer to "Choosing the proper inlet grate" on pages 117-118. For a complete listing of FREE OPEN AREAS and WEIR PERIMETERS of all NEENAH grates, refer to pages 306-311.

TYPE "L" VANE STYLE GRATES

CAPACITY

An important function of an inlet grate is capacity - the ability to intercept the storm water from the gutter. Hydraulic tests prove the Type "L" Vane Style Grates will accept more water than any of the conventional grate styles under virtually all flow conditions. Even with extremely high volume and velocity conditions in the gutter, there will be very little if any water that the grate will not capture, providing the water passes over it. The efficiency of these grates can be as much as 20% greater than conventional designs. For this reason, an ever increasing number of states, counties and municipalities have adopted the Type "L" Vane Style Grate as a standard.



Cross section of Vane Style Grate in testing flume showing hydraulic performance at 2 cfs.

GRATE PLACEMENT

Type "L" Vane Style Grates are being used in grate replacement programs in many cities throughout the country, not only because of their storm water capacity features but also because they are more likely to be safe for bicycles than many other styles of grates. A replacement high capacity Type "L" grate can be dimensioned to fit most catch basin inlets. Our Product Engineering and Sales Departments are available to assist you in developing your grate replacement program.

BICYCLE GRATES

Please read in its entirety "Pedestrian, Bicycle and Handicap Considerations" on page 7, in which we suggest consideration of Type "L" vane style grates where bicycles are a factor in the choice of a casting.

DEBRIS

A properly functioning inlet grate such as the Type "L" Vane Style Grate must screen out the larger harmful debris and prevent it from entering and clogging the sewer pipe. Small debris, which can be easily handled by the underground portions of the storm sewer, are allowed to pass through the grate openings to prevent blockage on the surface of the grate.

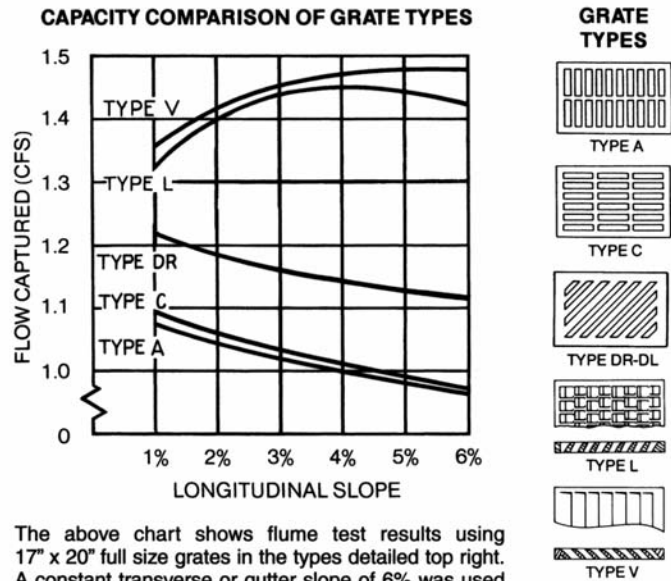

■ Note: When specifying/ordering grates, refer to “Choosing the proper inlet grate” on pages 117-118.
 For a complete listing of FREE OPEN AREAS and WEIR PERIMETERS of all NEENAH grates, refer to pages 306-311.

INLET GRATE TYPES CURB FACE TYPES

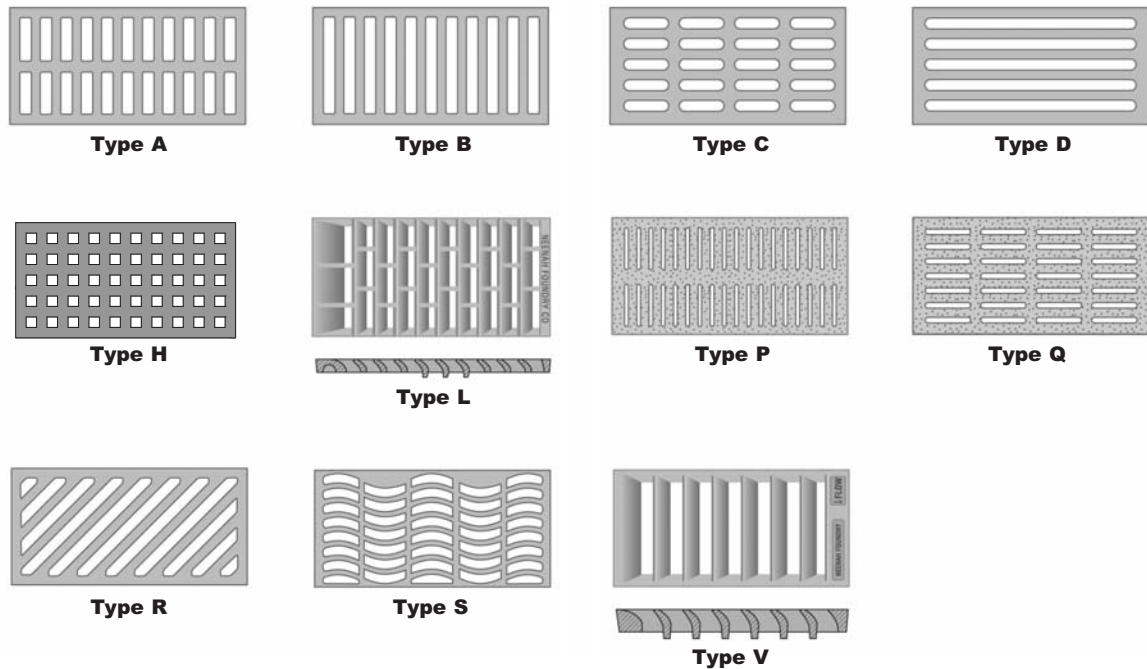

COMBINATION
INLETS
3

The templates shown illustrate a few of the many types of curb sections which can be properly matched with the catch basin inlets shown on the following pages. As noted, curb boxes can be adjusted to match concrete curb heights.

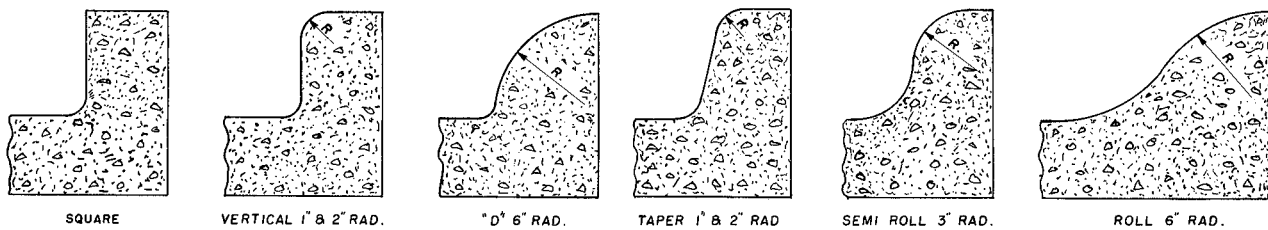

ENVIRO-CURB LOGOS

As noted on the following catalog items, our curb boxes and curb plates can be furnished with Environmental Notices which address specific drainage situations. If your installation requires such a notice, please contact NEENAH for specific availability and needs.



Illustrating R-3000-A

■ Note: When specifying/ordering grates, refer to "Choosing the proper inlet grate" on pages 117-118.
 For a complete listing of FREE OPEN AREAS and WEIR PERIMETERS of all NEENAH grates, refer to pages 306-311.

R-3000 Series
EnviroNotice Plates

Catalog No.	Type
R-3000-A	Cast into Curb
R-3000-B	Surface Mount

3 COMBINATION INLETS

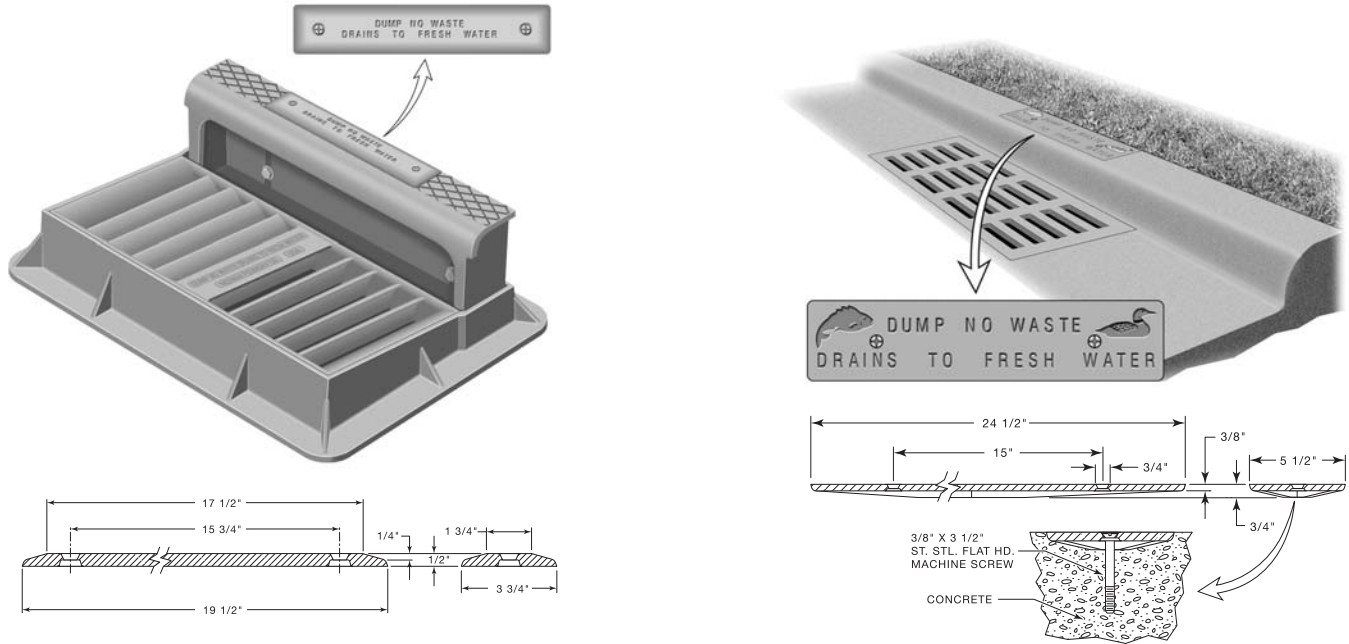

R-3010
Combination Inlet Frame, Grate, Curb Box

Heavy Duty

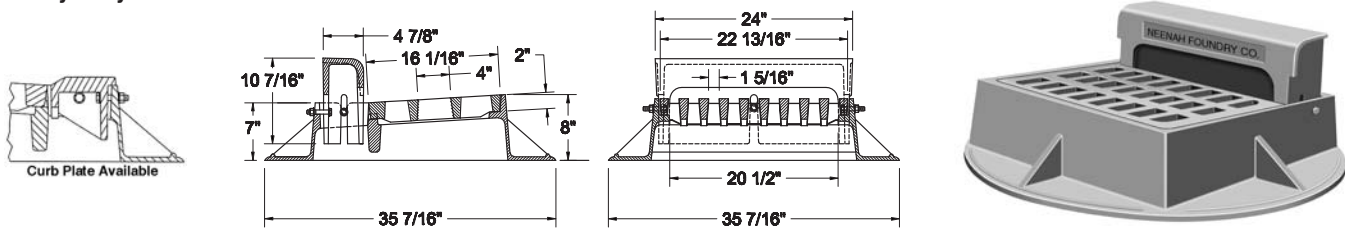

CATALOG NUMBER	GRATE TYPE	SQ. FT. OPEN	WEIR PERIMETER LINEAL FEET
R-3010	S	1.0	4.6
R-3010	A	1.0	4.6
R-3010	L	0.9	4.6
R-3010	R	1.1	4.6

Standard Grate (shown): Type A

Alternate Grate(s):

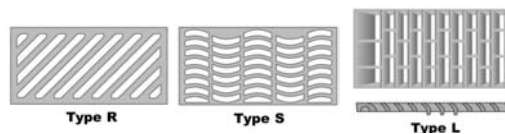

Available Curb Boxes: 1-1/2" Radius Open (standard), 3" Radius Open, 1-1/2" Radius Barred, 6" Radius Open
 Enviro-Curb Boxes and Enviro-Curb Plates available, see above and page 121.

■ Note: When specifying/ordering grates, refer to "Choosing the proper inlet grate" on pages 117-118.
 For a complete listing of FREE OPEN AREAS and WEIR PERIMETERS of all NEENAH grates, refer to pages 306-311.

R-3010-L Combination Inlet Frame, Grate, Curb Box

Heavy Duty

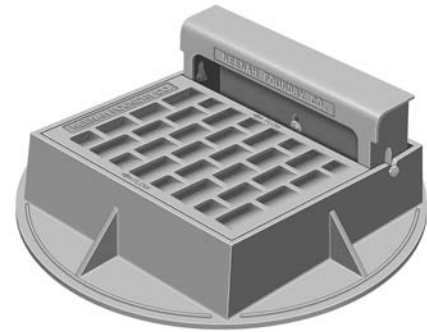
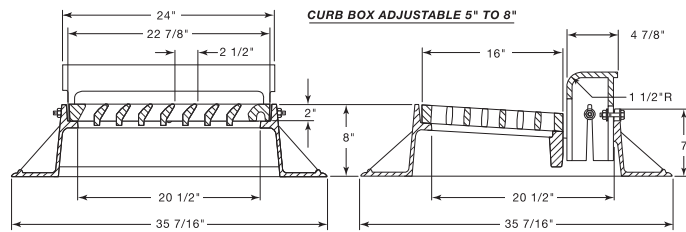

CATALOG NUMBER	GRATE TYPE	SQ. FT. OPEN	WEIR PERIMETER LINEAL FEET
R-3010-L	L	0.9	4.6

Available Curb Boxes: 1-1/2" Radius Open (standard)
 Enviro-Curb Boxes available, see page 121.

COMBINATION
INLETS
3

R-3015 Combination Inlet Frame, Grate, Curb Box

Heavy Duty

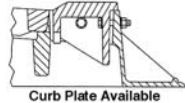
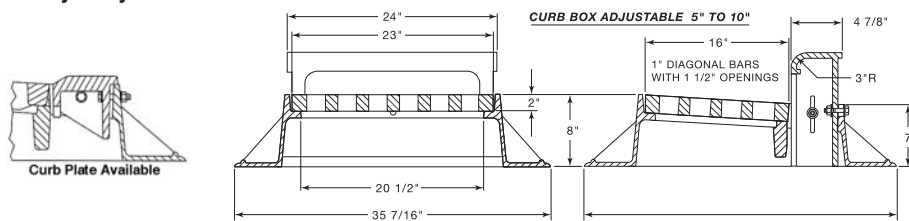

CATALOG NUMBER	GRATE TYPE	SQ. FT. OPEN	WEIR PERIMETER LINEAL FEET
R-3015	L	0.9	4.6
R-3015	R	1.1	4.6
R-3015	S	1.0	4.6
R-3015	A	1.0	4.6

Standard Grate (shown): Type R-diagonal
 Alternate Grate(s):

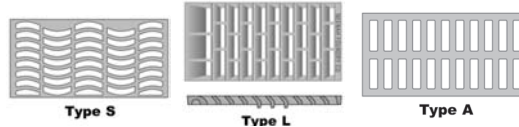

Available Curb Boxes: 1-1/2" Radius Open (standard), 3" Radius Open, 1-1/2" Radius Barred, 6" Radius Open
 Enviro-Curb Boxes and Enviro-Curb Plates available, see above and page 121.

R-3030 Combination Inlet Frame, Grate, Curb Box

Heavy Duty

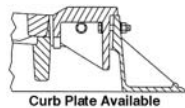
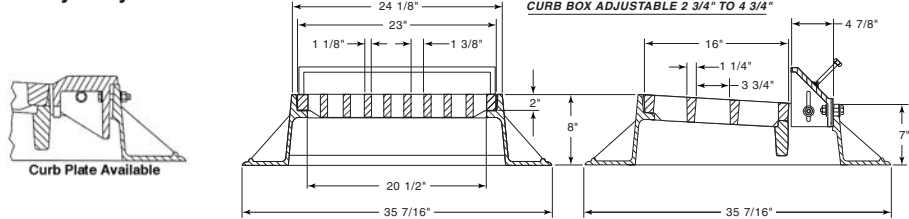

CATALOG NUMBER	GRATE TYPE	SQ. FT. OPEN	WEIR PERIMETER LINEAL FEET
R-3030	A	1.0	4.6
R-3030	R	1.1	4.6
R-3030	L	0.9	4.6
R-3030	S	1.0	4.6

Standard Grate (shown): Type A
 Alternate Grate(s):

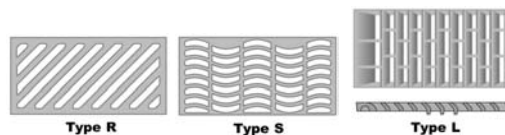

Available Curb Boxes: 1-1/2" Radius Open (standard), 3" Radius Open, 6" Radius Open
 Enviro-Curb Boxes available, see page 121.

■ Note: When specifying/ordering grates, refer to "Choosing the proper inlet grate" on pages 117-118.
 For a complete listing of FREE OPEN AREAS and WEIR PERIMETERS of all NEENAH grates, refer to pages 306-311.

R-3031-B Combination Inlet Frame, Grate, Curb Box

Heavy Duty

CATALOG NUMBER	GRATE TYPE	SQ. FT. OPEN	WEIR PERIMETER LINEAL FEET
R-3031-B	S	0.8	4.8

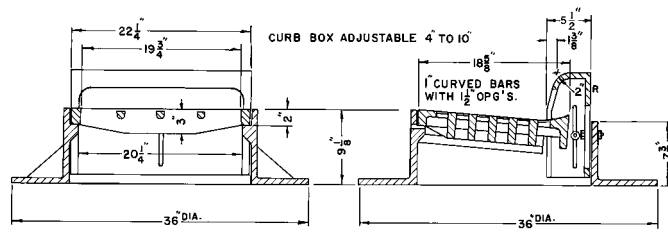

R-3032-B Split Combination Inlet Frame, Grate, Curb Box

Heavy Duty

CATALOG NUMBER	GRATE TYPE	SQ. FT. OPEN	WEIR PERIMETER LINEAL FEET
R-3032-B	S	0.8	4.8

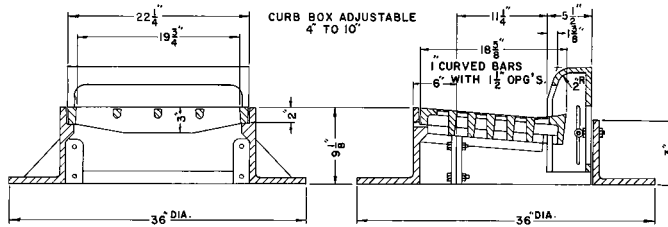

R-3034-B Roll Type Inlet Frame, Grate, Curb Box

Heavy Duty

CATALOG NUMBER	GRATE TYPE	SQ. FT. OPEN	WEIR PERIMETER LINEAL FEET
R-3034-B	S	1.1	4.8

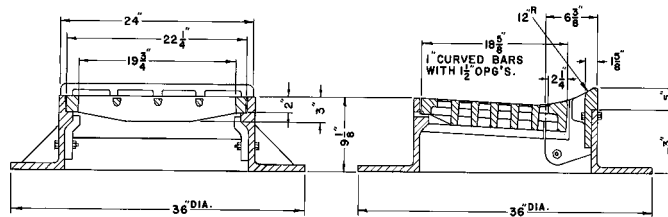

■ Note: When specifying/ordering grates, refer to "Choosing the proper inlet grate" on pages 117-118.
 For a complete listing of FREE OPEN AREAS and WEIR PERIMETERS of all NEENAH grates, refer to pages 306-311.

R-3035-A Split Roll Type Inlet Frame, Grate, Curb Box

Heavy Duty

CATALOG NUMBER	GRATE TYPE	SQ. FT. OPEN	WEIR PERIMETER LINEAL FEET
R-3035-A	S	1.1	4.8

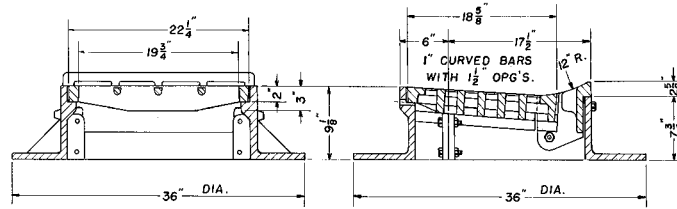

Suitable for 24" curb and gutter, split frame facilitates forming and eliminates boxing out. When paving roadway, simply place small section of frame against the form on the pavement side at catch basin location. After forms are removed, attach large frame section and curb box using bolts provided, and pour curb and gutter section. If curb and gutter are installed first, reverse the procedure.

R-3036-B Concave Inlet Frame, Grate

Heavy Duty

CATALOG NUMBER	GRATE TYPE	SQ. FT. OPEN	WEIR PERIMETER LINEAL FEET
R-3036-B	S	1.1	7.4

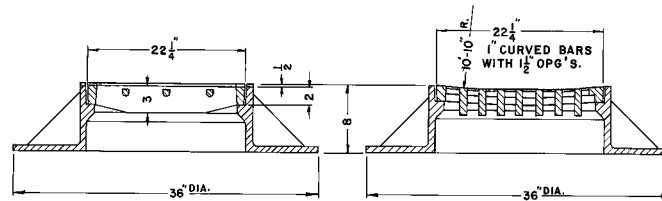

R-3038-A Expressway Inlet Frame, Grate

Heavy Duty

CATALOG NUMBER	GRATE TYPE	SQ. FT. OPEN	WEIR PERIMETER LINEAL FEET
R-3038-A	S	1.5	4.8

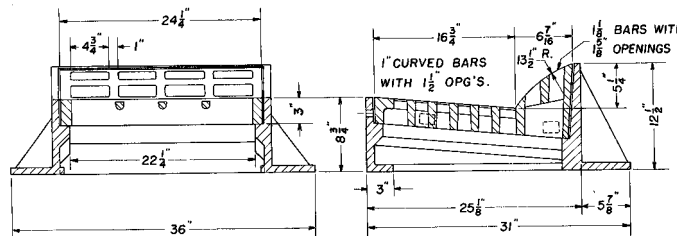

R-3039-A Roll Type Inlet Frame, Grate, Curb Box

Heavy Duty

CATALOG NUMBER	GRATE TYPE	SQ. FT. OPEN	WEIR PERIMETER LINEAL FEET
R-3039-A	S	1.5	5.0

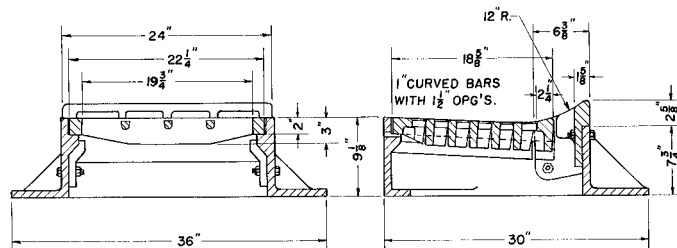

■ Note: When specifying/ordering grates, refer to "Choosing the proper inlet grate" on pages 117-118.
 For a complete listing of FREE OPEN AREAS and WEIR PERIMETERS of all NEENAH grates, refer to pages 306-311.

R-3065 Combination Inlet Frame, Grate, Curb Box

Heavy Duty

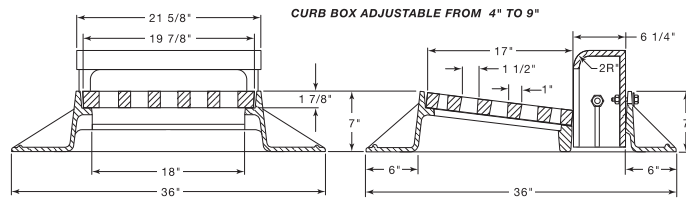

Standard Grate (shown): Type R-diagonal

Alternate Grate(s):

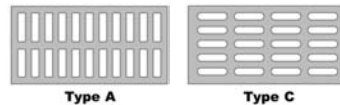

Available with Type L grate, see R-3065-L.
 Available with Type V grate, see R-3065-V.

CATALOG NUMBER	GRATE TYPE	SQ. FT. OPEN	WEIR PERIMETER LINEAL FEET
R-3065	R	0.9	4.5
R-3065	C	0.7	4.5
R-3065	A	0.9	4.5

3 COMBINATION INLETS

R-3065-L Combination Inlet Frame, Grate, Curb Box

Heavy Duty

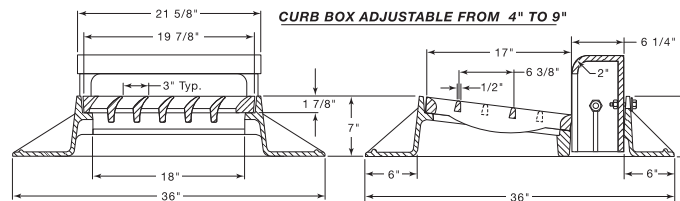

CATALOG NUMBER	GRATE TYPE	SQ. FT. OPEN	WEIR PERIMETER LINEAL FEET
R-3065-L	L	0.8	4.5

R-3065-V Combination Inlet Frame, Grate, Curb Box

Heavy Duty

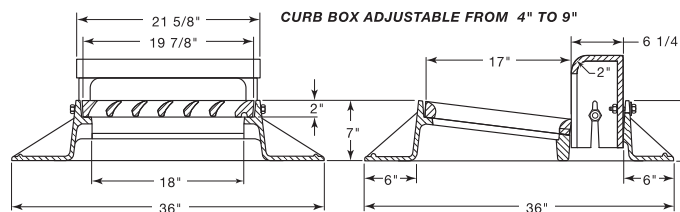

CATALOG NUMBER	GRATE TYPE	SQ. FT. OPEN	WEIR PERIMETER LINEAL FEET
R-3065-V	V	1.3	4.5

R-3066 Combination Inlet Frame, Grate, Curb Box

Heavy Duty

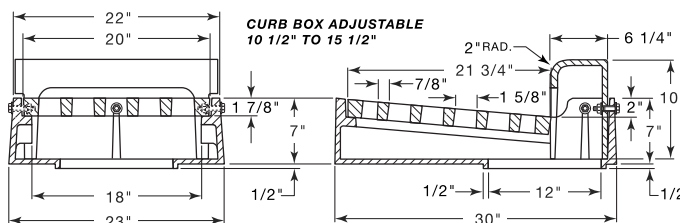

CATALOG NUMBER	GRATE TYPE	SQ. FT. OPEN	WEIR PERIMETER LINEAL FEET
R-3066	R	1.4	5.3

■ Note: When specifying/ordering grates, refer to "Choosing the proper inlet grate" on pages 117-118.
 For a complete listing of FREE OPEN AREAS and WEIR PERIMETERS of all NEENAH grates, refer to pages 306-311.

R-3067 Combination Inlet Frame, Grate, Curb Box

Heavy Duty

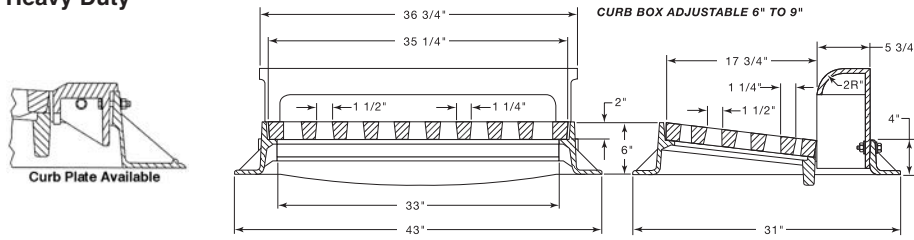

CATALOG NUMBER	GRATE TYPE	SQ. FT. OPEN	WEIR PERIMETER LINEAL FEET
R-3067	R	2.0	5.8
R-3067	C	1.6	5.8
R-3067	L	2.1	5.8

Standard Grate (shown): Type R-diagonal

Alternate Grate(s):

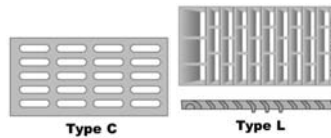

Available Curb Boxes: 2"Radius Open, 3"Radius Open, 6"Radius Open, 10"Radius Open, Mountable/Barred
 Enviro-Curb Boxes available, see page 121.

For Double and Triple units, refer to R-3295-2 and R-3295-3.

R-3067-C Combination Inlet Frame, Grate

Heavy Duty

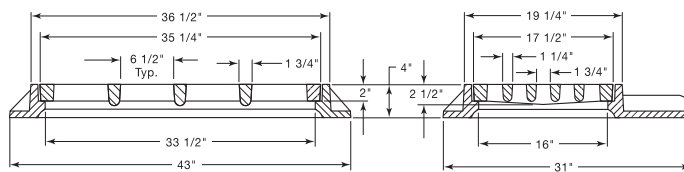

CATALOG NUMBER	GRATE TYPE	SQ. FT. OPEN	WEIR PERIMETER LINEAL FEET
R-3067-C	C	2.1	8.8
R-3067-C	L	2.1	8.8

Standard Grate (shown): Type C

Alternate Grate(s):

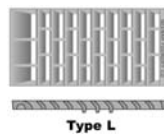

Furnished without curb box for use at driveway locations.

R-3067-L Combination Inlet Frame, Grate, Curb Box

Heavy Duty

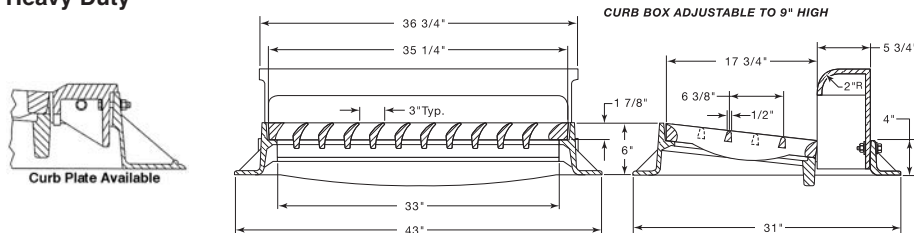

CATALOG NUMBER	GRATE TYPE	SQ. FT. OPEN	WEIR PERIMETER LINEAL FEET
R-3067-L	L	2.1	5.8

Available Curb Boxes: 2"Radius Open, 3"Radius Open.

Enviro-Curb Boxes available, see page 121.



■ Note: When specifying/ordering grates, refer to "Choosing the proper inlet grate" on pages 117-118.
 For a complete listing of FREE OPEN AREAS and WEIR PERIMETERS of all NEENAH grates, refer to pages 306-311.

R-3067-V Combination Inlet Frame, Grate, Curb Box

Heavy Duty

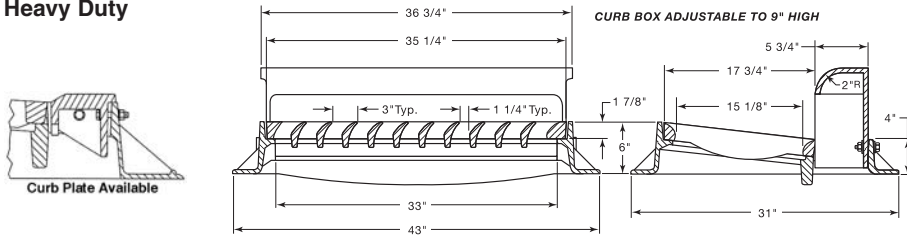

CATALOG NUMBER	GRATE TYPE	SQ. FT. OPEN	WEIR PERIMETER LINEAL FEET
R-3067-V	V	2.4	5.8

R-3067-VB Combination Inlet Frame, Grate, Curb Box

Heavy Duty

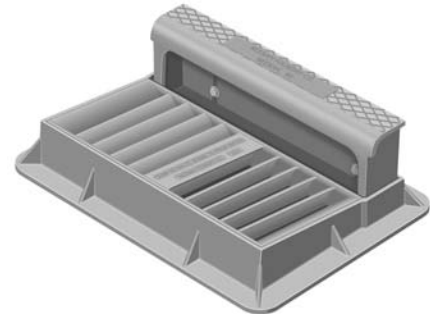
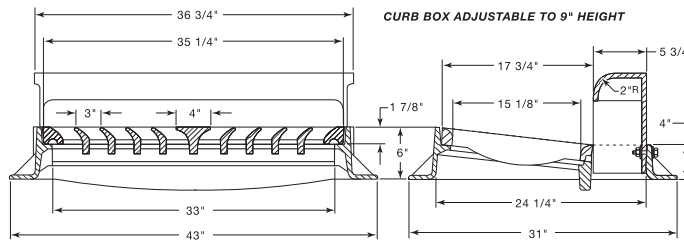

CATALOG NUMBER	GRATE TYPE	SQ. FT. OPEN	WEIR PERIMETER LINEAL FEET
R-3067-VB	V	2.7	5.8

R-3070 Combination Inlet Frame, Grate, Curb Box

Heavy Duty

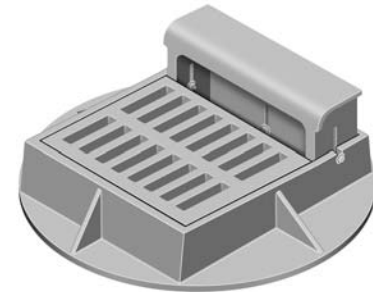
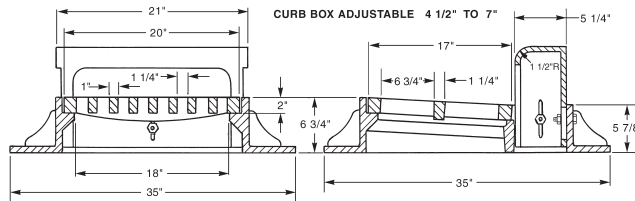

CATALOG NUMBER	GRATE TYPE	SQ. FT. OPEN	WEIR PERIMETER LINEAL FEET
R-3070	A	0.9	4.5
R-3070	L	0.8	4.5
R-3070	R	0.9	4.5
R-3070	V	1.3	4.5

Standard Grate (shown): Type A

Alternate Grate(s):

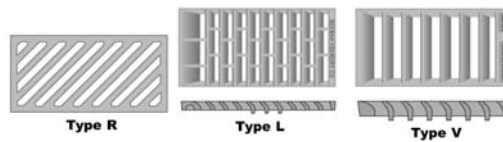

Available Curb Boxes: 1-1/2"Radius Open (standard), 1-1/2"Radius Barred, 3"Radius Open
 Enviro-Curb Boxes available, see page 121.

■ Note: When specifying/ordering grates, refer to "Choosing the proper inlet grate" on pages 117-118.
 For a complete listing of FREE OPEN AREAS and WEIR PERIMETERS of all NEENAH grates, refer to pages 306-311.

R-3075
Combination Inlet Frame, Grate, Curb Box

Heavy Duty

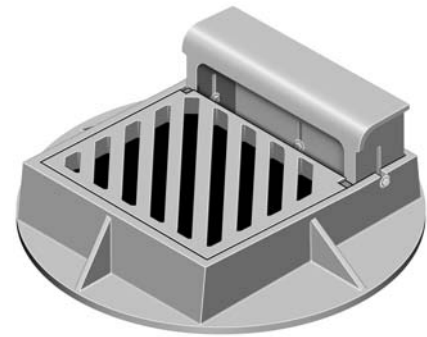
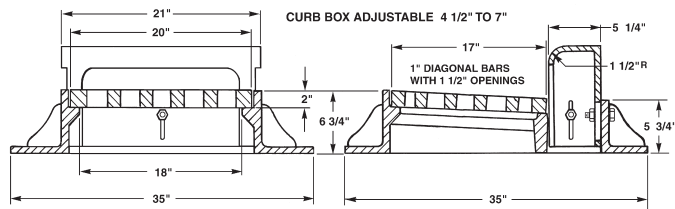

CATALOG NUMBER	GRATE TYPE	SQ. FT. OPEN	WEIR PERIMETER LINEAL FEET
R-3075	R	0.9	4.5

Available Curb Boxes: 1-1/2" Open (standard), 1-1/2" Barred, 3" Open

COMBINATION
INLETS
3

R-3075-L
Combination Inlet Frame, Grate, Curb Box

Heavy Duty

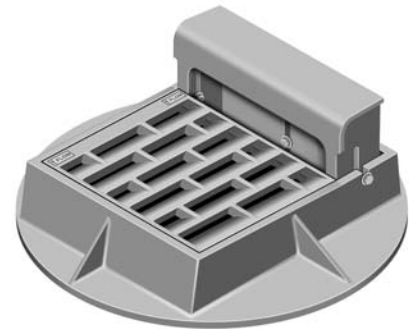
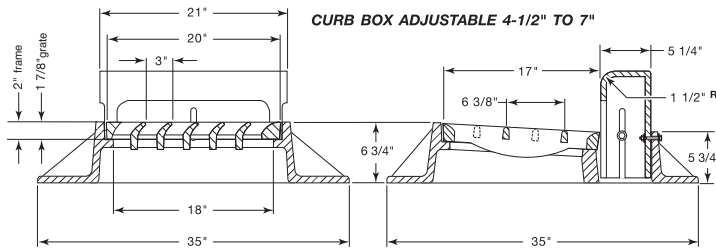

CATALOG NUMBER	GRATE TYPE	SQ. FT. OPEN	WEIR PERIMETER LINEAL FEET
R-3075-L	L	0.8	4.5

Enviro-Curb Boxes available, see page 121.

R-3075-V
Combination Inlet Frame, Grate, Curb Box

Heavy Duty

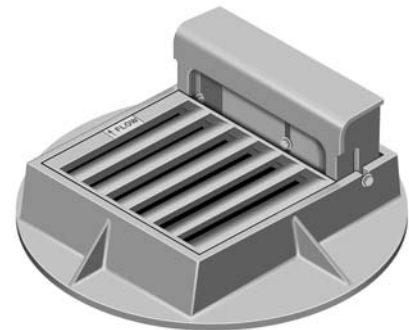
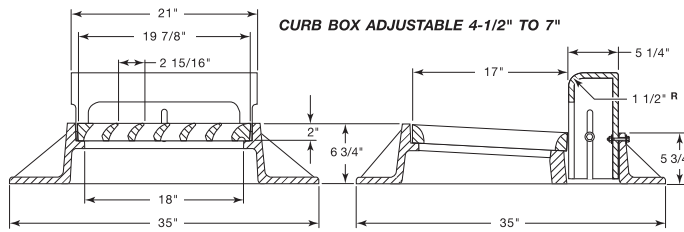

CATALOG NUMBER	GRATE TYPE	SQ. FT. OPEN	WEIR PERIMETER LINEAL FEET
R-3075-V	V	1.3	4.5

■ Note: When specifying/ordering grates, refer to "Choosing the proper inlet grate" on pages 117-118.
 For a complete listing of FREE OPEN AREAS and WEIR PERIMETERS of all NEENAH grates, refer to pages 306-311.

R-3076-4M Curb Hood

R-3076-6B Curb Hood

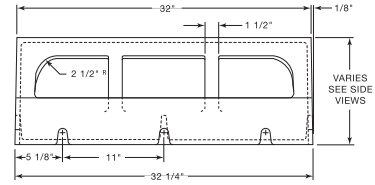
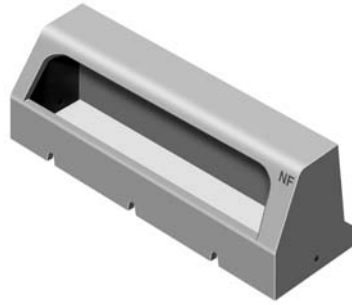

FRONT VIEW FOR R-3076-4M AND R-3076-6M

R-3076-6M Curb Hood

R-3076-8B Curb Hood

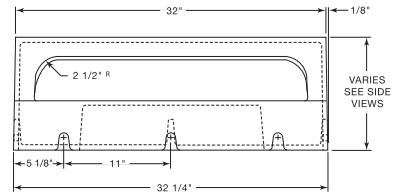

FRONT VIEW FOR R-3076-6B AND R-3076-8B

Bolt Slots on hoods for attachment to R-3076, R-3077, R-3078 and R-3079 Gutter Inlets.

Illustrated unit composed of R-3077-L, R-3078, R-3077-R and R-3076-6B curb hoods.

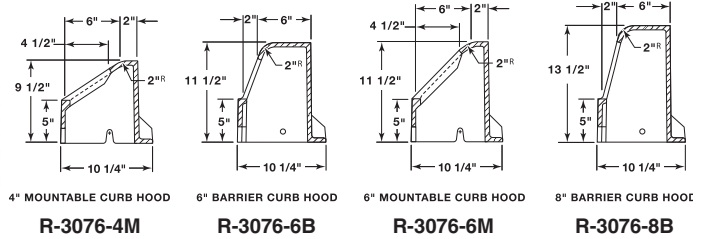

4" MOUNTABLE CURB HOOD
R-3076-4M

6" BARRIER CURB HOOD
R-3076-6B

6" MOUNTABLE CURB HOOD
R-3076-6M

8" BARRIER CURB HOOD
R-3076-8B

■ Note: When specifying/ordering grates, refer to "Choosing the proper inlet grate" on pages 117-118.
 For a complete listing of FREE OPEN AREAS and WEIR PERIMETERS of all NEENAH grates, refer to pages 306-311.

R-3076 3-Flange Gutter Inlet Frame, Grate

Heavy Duty

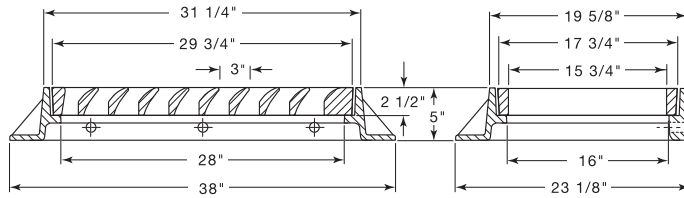

CATALOG NUMBER	GRATE TYPE	SQ. FT. OPEN	WEIR PERIMETER LINEAL FEET
R-3076	V	1.5	7.9
R-3076	L	1.4	7.9

Standard Grate (shown): Type V
 Alternate Grate(s):

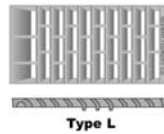

R-3077 Double Unit Inlet Frame, Grate

Heavy Duty

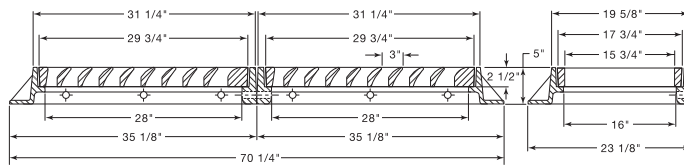

CATALOG NUMBER	GRATE TYPE	SQ. FT. OPEN	WEIR PERIMETER LINEAL FEET
R-3077	V	3.0	12.9
R-3077	L	2.8	12.9
R-3077-L	V	1.5	7.9
R-3077-L	L	1.4	7.9
R-3077-R	V	1.5	7.9
R-3077-R	L	1.4	7.9

Standard Grate (shown): Type V
 Alternate Grate(s):

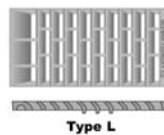

For Left section only, order R-3077-L.
 For Right section only, order R-3077-R.

R-3078 Inlet Frame, Grate (Center Only)

Heavy Duty

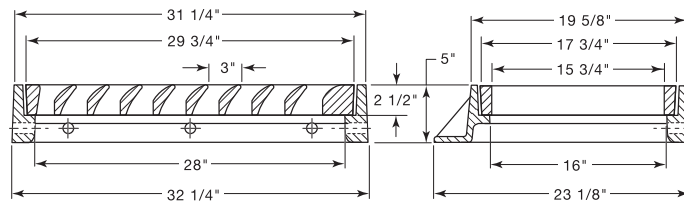

Illustrated between R-3077-L and R-3077-R.

CATALOG NUMBER	GRATE TYPE	SQ. FT. OPEN	WEIR PERIMETER LINEAL FEET
R-3078	V	1.5	5.0
R-3078	L	1.4	5.0

Standard Grate (shown): Type V
 Alternate Grate(s):

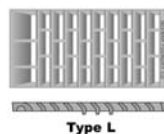

COMBINATION
 INLETS
 3

■ Note: When specifying/ordering grates, refer to "Choosing the proper inlet grate" on pages 117-118.
 For a complete listing of FREE OPEN AREAS and WEIR PERIMETERS of all NEENAH grates, refer to pages 306-311.

R-3079
Inlet Frame, Grate (Center Only)

Heavy Duty

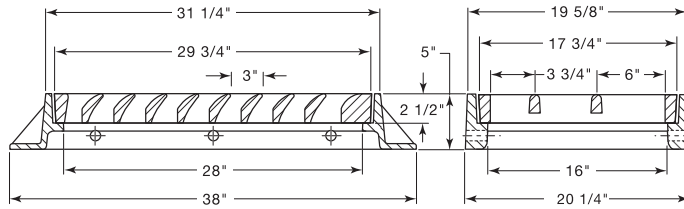

Standard Grate (shown): Type L
 Alternate Grate(s):

CATALOG NUMBER	GRATE TYPE	SQ. FT. OPEN	WEIR PERIMETER LINEAL FEET
R-3079	L	1.4	5.5
R-3079	V	1.5	5.5

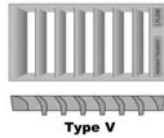

Illustrated with R-3076.

R-3157-1
Combination Inlet Frame, Grate, Curb Box

Heavy Duty

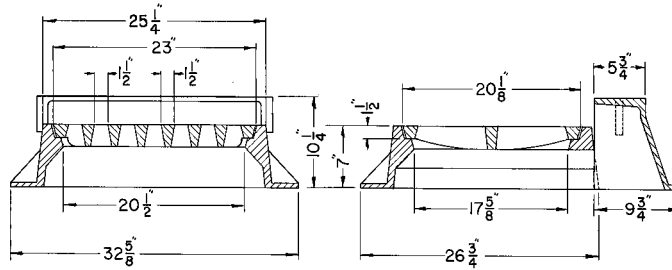

CATALOG NUMBER	GRATE TYPE	SQ. FT. OPEN	WEIR PERIMETER LINEAL FEET
R-3157-1	A	1.1	5.2

R-3157-2
Combination Inlet Frame, Grate, Curb Box

Heavy Duty

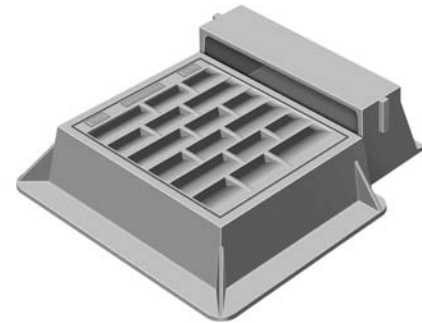
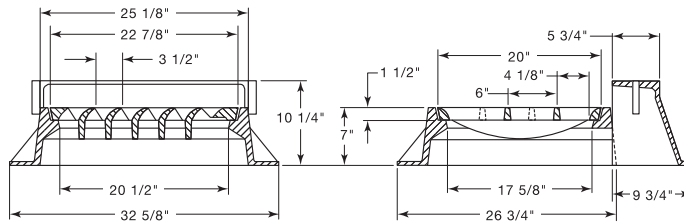

CATALOG NUMBER	GRATE TYPE	SQ. FT. OPEN	WEIR PERIMETER LINEAL FEET
R-3157-2	L	1.6	5.2

Enviro-Curb Boxes available, see page 121.

■ Note: When specifying/ordering grates, refer to "Choosing the proper inlet grate" on pages 117-118.
 For a complete listing of FREE OPEN AREAS and WEIR PERIMETERS of all NEENAH grates, refer to pages 306-311.

R-3157-A
Combination Inlet Frame, Double Grate, Curb Box

Heavy Duty

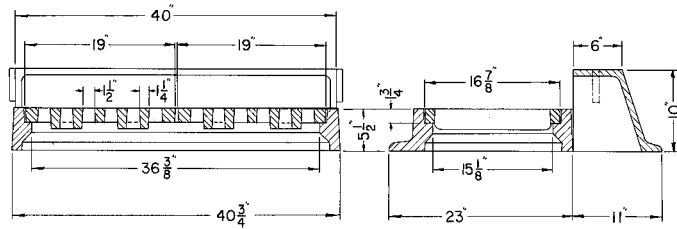

CATALOG NUMBER	GRATE TYPE	SQ. FT. OPEN	WEIR PERIMETER LINEAL FEET
R-3157-A	K	2.1	6.0
R-3157-A	L	1.2	6.0

Standard Grate (shown): Type K.

Alternate Grate(s):

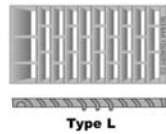

If no curb required, refer to R-3425-A or R-3425-B.

COMBINATION
INLETS
3

R-3157-AL
Combination Inlet Frame, Double Grate, Curb Box

Heavy Duty

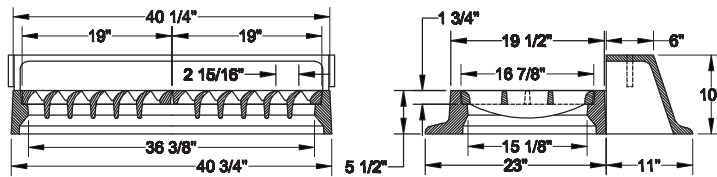

CATALOG NUMBER	GRATE TYPE	SQ. FT. OPEN	WEIR PERIMETER LINEAL FEET
R-3157-AL	L	2.3	6.0

Enviro-Curb Boxes available, see page 121.

R-3159-A
Combination Inlet Frame, Grate, Curb Box

Heavy Duty

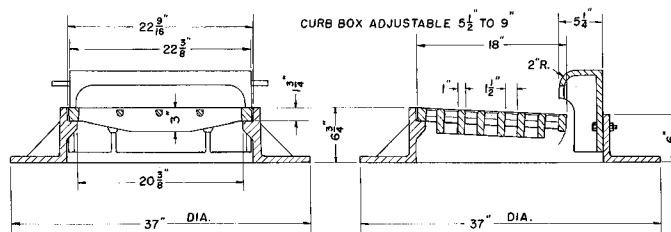

CATALOG NUMBER	GRATE TYPE	SQ. FT. OPEN	WEIR PERIMETER LINEAL FEET
R-3159-A	S	1.3	4.9

■ Note: When specifying/ordering grates, refer to "Choosing the proper inlet grate" on pages 117-118.
 For a complete listing of FREE OPEN AREAS and WEIR PERIMETERS of all NEENAH grates, refer to pages 306-311.

R-3161 Combination Inlet Frame, Grate, Curb Box

Heavy Duty

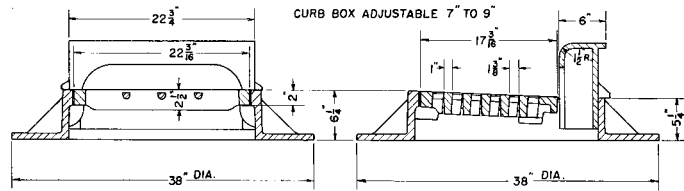

CATALOG NUMBER	GRATE TYPE	SQ. FT. OPEN	WEIR PERIMETER LINEAL FEET
R-3161	S	1.3	4.7

R-3165 Combination Inlet Frame, Grate, Curb Box

Heavy Duty

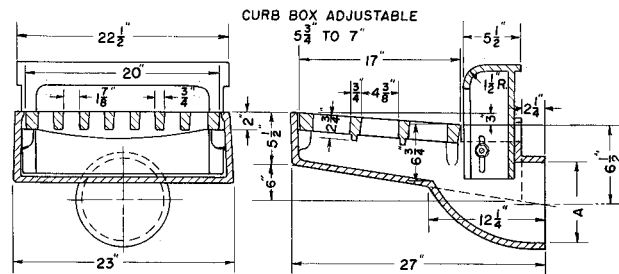

Furnished standard with Ductile Iron grate.
 For use where conditions do not permit catch basin under inlet.
 Drainage is to catch basin behind curb.
 Available with 8", 10" or 12" rear outlet - specify when ordering.

Standard Grate (shown): Type A
 Alternate Grate(s):

CATALOG NUMBER	GRATE TYPE	SQ. FT. OPEN	WEIR PERIMETER LINEAL FEET
R-3165	A	1.4	4.5
R-3165	V	1.2	4.5

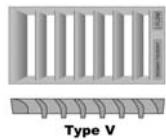

Available Curb Boxes: 1-1/2" Open (shown), 3" open

R-3169 Combination Inlet Frame, Grate, Curb Box

Heavy Duty

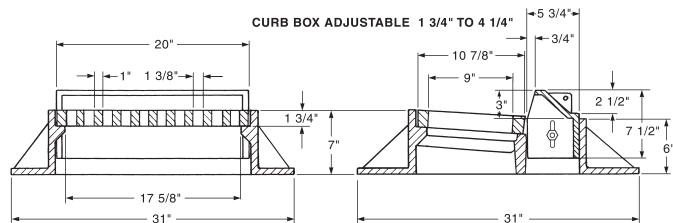

Standard Grate (shown): Type B
 Alternate Grate(s):

CATALOG NUMBER	GRATE TYPE	SQ. FT. OPEN	WEIR PERIMETER LINEAL FEET
R-3169	B	0.7	3.5
R-3169	P	0.2	3.5
R-3169	S	0.5	3.5

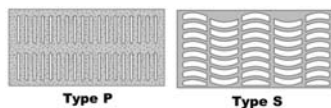

■ Note: When specifying/ordering grates, refer to "Choosing the proper inlet grate" on pages 117-118.
 For a complete listing of FREE OPEN AREAS and WEIR PERIMETERS of all NEENAH grates, refer to pages 306-311.

R-3170 Combination Inlet Frame, Grate, Curb Box

Heavy Duty

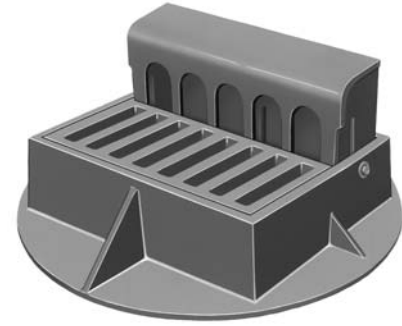
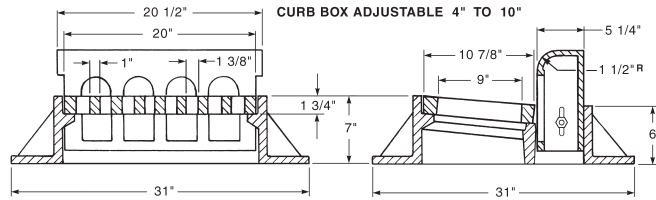

CATALOG NUMBER	GRATE TYPE	SQ. FT. OPEN	WEIR PERIMETER LINEAL FEET
R-3170	B	0.7	3.5

Available with open curb box if specified.
 Available without front flange if specified.

COMBINATION INLETS 3

R-3188 Combination Inlet Frame, Grate, Curb Box

Heavy Duty

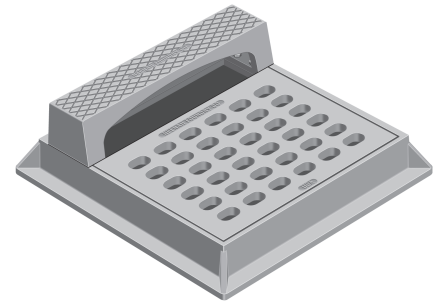
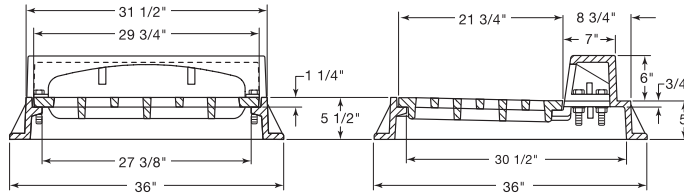

CATALOG NUMBER	GRATE TYPE	SQ. FT. OPEN	WEIR PERIMETER LINEAL FEET
R-3188	C	0.5	8.6

R-3191, R-3192, R-3193 Series Frame Grate & Unmountable or Mountable Curb Box

Heavy Duty

Furnished with Reticuline Steel Grate.

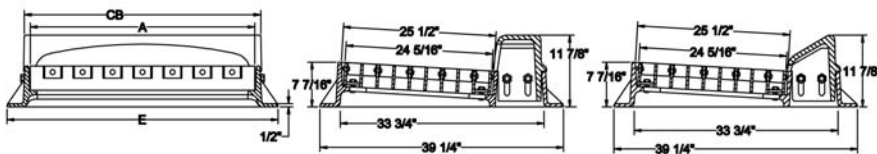

A	CB	E	UNMOUNTABLE CATALOG NO.	MOUNTABLE CATALOG NO.
27 1/2"	29 1/2"	35 1/4"	R-3191-CU1	R-3191-CM1
38"	39 1/2"	45 1/2"	R-3192-CU2	R-3192-CM2
47 1/2"	49 1/2"	55 1/4"	R-3193-CU3	R-3193-CM3

CATALOG NUMBER	GRATE TYPE	SQ. FT. OPEN	WEIR PERIMETER LINEAL FEET
R-3191	K	3.2	6.2
R-3192	K	4.4	7.8
R-3193	K	5.6	8.6

■ Note: When specifying/ordering grates, refer to "Choosing the proper inlet grate" on pages 117-118.
 For a complete listing of FREE OPEN AREAS and WEIR PERIMETERS of all NEENAH grates, refer to pages 306-311.

R-3203 Series Flat Drain Frame, Grate

Heavy Duty

CATALOG NUMBER	GRATE TYPE	SQ. FT. OPEN	WEIR PERIMETER LINEAL FEET
R-3203-A	H	1.0	6.6
R-3203-B	H	1.0	6.6
R-3203-C	H	1.0	6.6

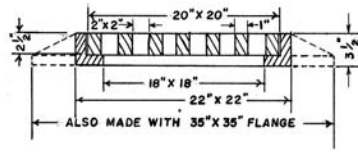

Illustrating R-3203-B with 27" x 27" frame.

Catalog No.	Description
R-3203-A	with 22" x 22" base
R-3203-B	with top 27" x 27"
R-3203-C	with flange 35" x 35"

R-3205 Concave Inlet Frame, Grate

Heavy Duty

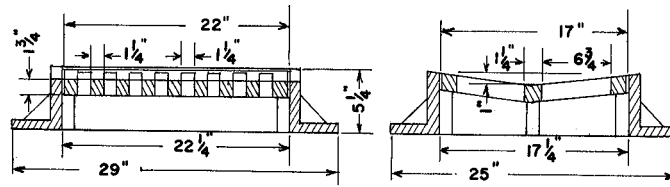

Standard Grate (shown): Type K.

Alternate Grate(s):

CATALOG NUMBER	GRATE TYPE	SQ. FT. OPEN	WEIR PERIMETER LINEAL FEET
R-3205	K	0.9	6.5
R-3205	P	0.3	6.5

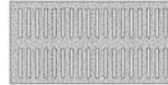

Type P



R-3210-A Catch Basin Frame, Convex Grate

Heavy Duty

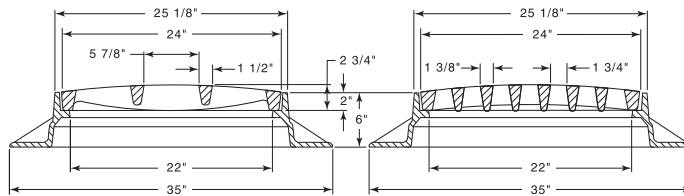

Standard Grate (shown): Type C convex

Alternate Grate(s):

CATALOG NUMBER	GRATE TYPE	SQ. FT. OPEN	WEIR PERIMETER LINEAL FEET
R-3210-A	C	1.5	8.0
R-3210-A	A	1.5	8.0
R-3210-A	R	1.6	8.0

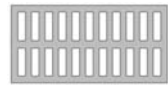

Type A



Type R

Available with Type L grate, see R-3210-L.
 Available with Type Q grate, see R-3210-Q.



R-3210-ALM Catch Basin Frame, LiftMate Convex Grate

Heavy Duty

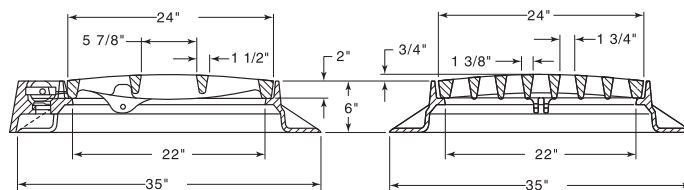

CATALOG NUMBER	GRATE TYPE	SQ. FT. OPEN	WEIR PERIMETER LINEAL FEET
R-3210-ALM	C	1.5	8.0



■ Note: When specifying/ordering grates, refer to "Choosing the proper inlet grate" on pages 117-118.
 For a complete listing of FREE OPEN AREAS and WEIR PERIMETERS of all NEENAH grates, refer to pages 306-311.

R-3210-L
Catch Basin Frame, Grate

Heavy Duty

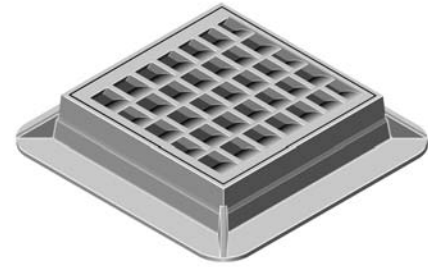
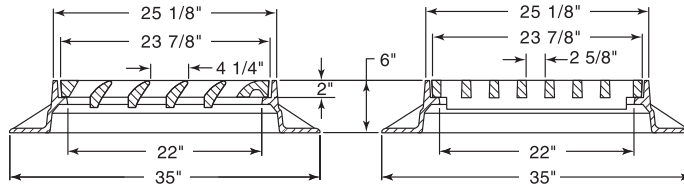

CATALOG NUMBER	GRATE TYPE	SQ. FT. OPEN	WEIR PERIMETER LINEAL FEET
R-3210-L	L	1.5	8.0

R-3210-LLM
Catch Basin Frame, LiftMate Grate

Heavy Duty

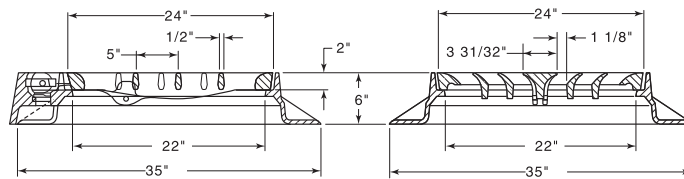

CATALOG NUMBER	GRATE TYPE	SQ. FT. OPEN	WEIR PERIMETER LINEAL FEET
R-3210-LLM	L	1.4	8.0

R-3210-Q
Catch Basin Frame, Grate

Heavy Duty

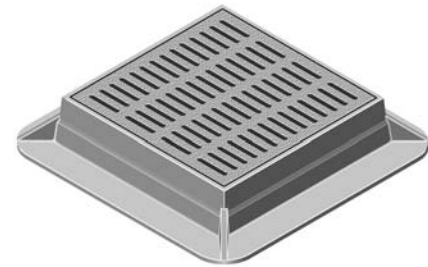
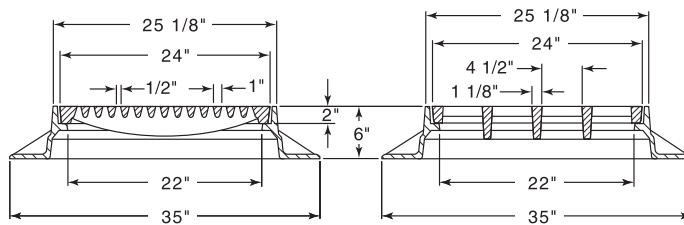

CATALOG NUMBER	GRATE TYPE	SQ. FT. OPEN	WEIR PERIMETER LINEAL FEET
R-3210-Q	Q	0.8	8.0

R-3220
Combination Inlet Frame, Convex Grate, Curb Box

Heavy Duty

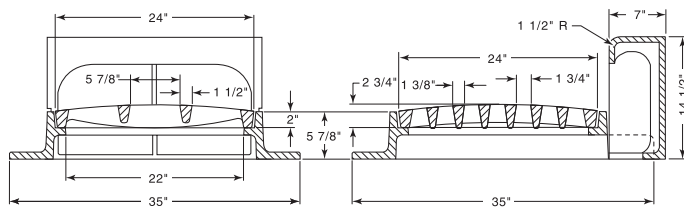

Standard Grate (shown): Type C.
 Alternate Grate(s):

CATALOG NUMBER	GRATE TYPE	SQ. FT. OPEN	WEIR PERIMETER LINEAL FEET
R-3220	C	1.5	8.0
R-3220	R	1.6	8.0



Type R

Available with square curb face or radius face of 1", 1-1/2", 2" or 3".

■ Note: When specifying/ordering grates, refer to "Choosing the proper inlet grate" on pages 117-118.
 For a complete listing of FREE OPEN AREAS and WEIR PERIMETERS of all NEENAH grates, refer to pages 306-311.

R-3220-L Combination Inlet Frame, Grate, Curb Box

Heavy Duty

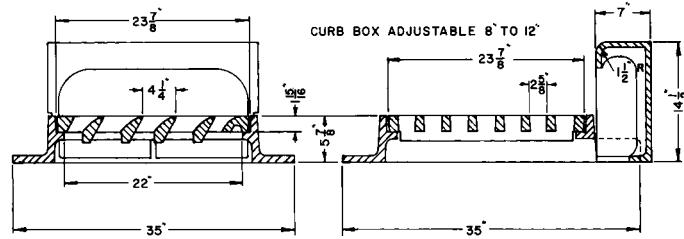

CATALOG NUMBER	GRATE TYPE	SQ. FT. OPEN	WEIR PERIMETER LINEAL FEET
R-3220-L	L	1.5	6.0

R-3222-1A Catch Basin Frame, Grate

Heavy Duty

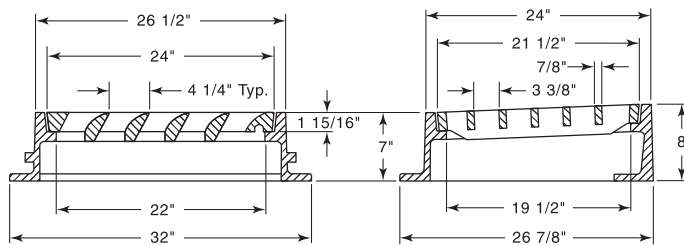

CATALOG NUMBER	GRATE TYPE	SQ. FT. OPEN	WEIR PERIMETER LINEAL FEET
R-3222-1A	L	1.0	7.6

R-3222-1ALM Catch Basin Frame, LiftMate Grate

Heavy Duty

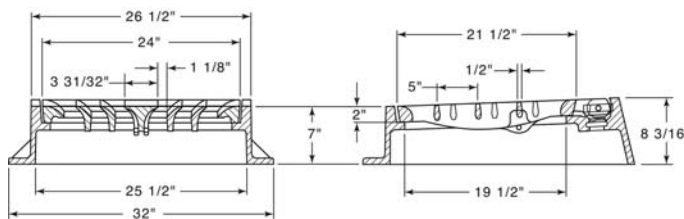

CATALOG NUMBER	GRATE TYPE	SQ. FT. OPEN	WEIR PERIMETER LINEAL FEET
R-3222-1ALM	L	1.5	8.0

R-3222-LA Combination Inlet Frame, Grate, Curb Box

Heavy Duty

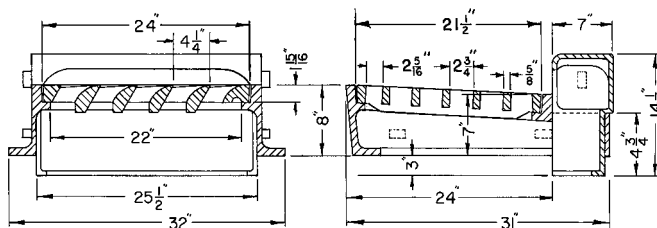

CATALOG NUMBER	GRATE TYPE	SQ. FT. OPEN	WEIR PERIMETER LINEAL FEET
R-3222-LA	L	1.0	5.6

Also available with Type C grate, order as R-3222-C.

■ Note: When specifying/ordering grates, refer to "Choosing the proper inlet grate" on pages 117-118.
 For a complete listing of FREE OPEN AREAS and WEIR PERIMETERS of all NEENAH grates, refer to pages 306-311.

R-3223 Series Cast Iron Sub-Basin Bowl

Heavy Duty

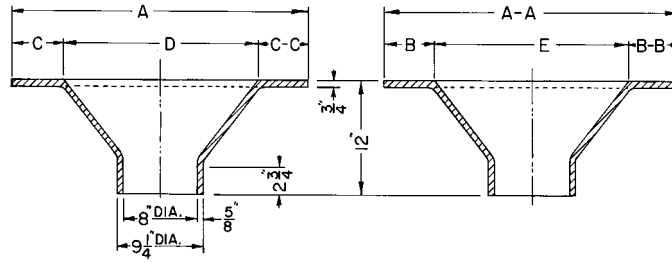

COMBINATION
 INLETS
 3

Catalog No.	Dimensions in inches							
	A	A-A	B	B-B	C	C-C	D	E
R-3223	37 3/4	35	5 1/4	5 1/4	3 1/2	5 1/4	29	24 1/2
R-3223-A	37	31	5 1/4	5 1/4	5 1/4	5 1/4	20 1/2	20 1/2
R-3223-B	31	31	5 1/4	5 1/4	5 1/4	5 1/4	20 1/2	20 1/2

R-3226 Series Catch Basin Elbow

Heavy Duty

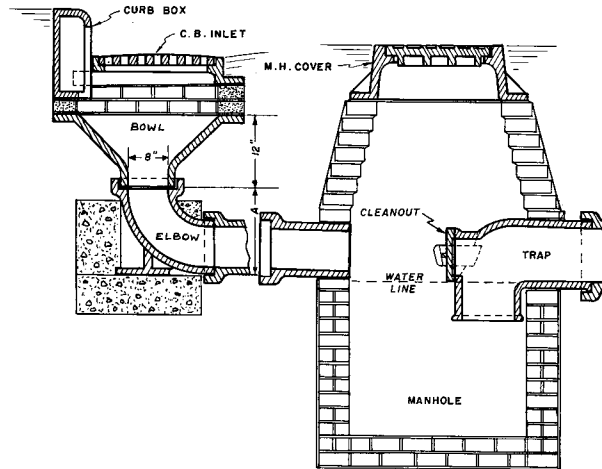

Section showing one method of catch basin assembly. Note catch basin frame, grate, curb box, catch basin bowl and elbow. See R-3705 series for catch basin trap detail.

Catalog No.	Elbow Height "A"
R-3226-A	12 1/2
R-3226-B	20

R-3227 Expressway Inlet, Frame, Grate

Heavy Duty

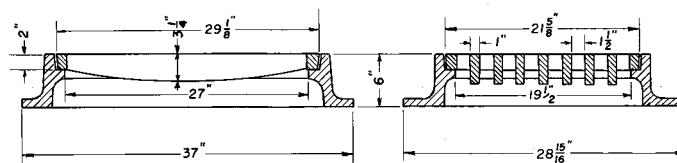

CATALOG NUMBER	GRATE TYPE	SQ. FT. OPEN	WEIR PERIMETER LINEAL FEET
R-3227	D	2.3	8.5

■ Note: When specifying/ordering grates, refer to "Choosing the proper inlet grate" on pages 117-118.
 For a complete listing of FREE OPEN AREAS and WEIR PERIMETERS of all NEENAH grates, refer to pages 306-311.

R-3227-C
Expressway Inlet, Frame, Grate

Heavy Duty

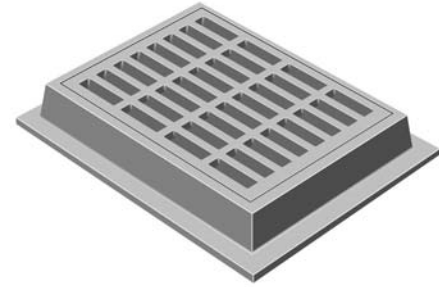
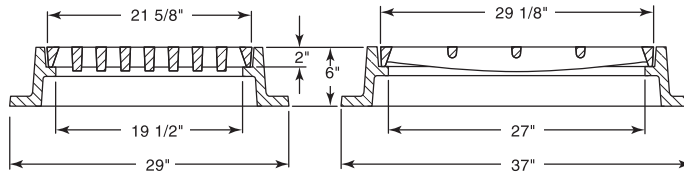

CATALOG NUMBER	GRATE TYPE	SQ. FT. OPEN	WEIR PERIMETER LINEAL FEET
R-3227-C	C	1.9	8.5

32 slotted openings, 1-7/16 x 5-3/4".

R-3227-D
Expressway Inlet, Frame, Grate

Heavy Duty

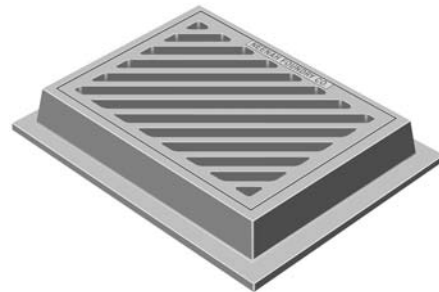
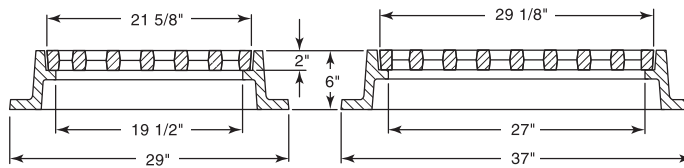

CATALOG NUMBER	GRATE TYPE	SQ. FT. OPEN	WEIR PERIMETER LINEAL FEET
R-3227-D	R	2.3	8.5

R-3228-BD
Combination Inlet Frame, Diagonal Grate, Curb Box

Heavy Duty

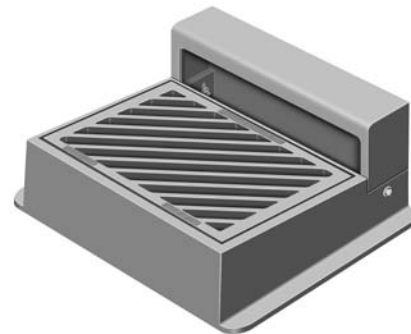
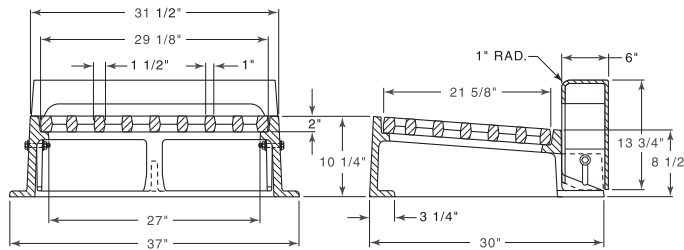

CATALOG NUMBER	GRATE TYPE	SQ. FT. OPEN	WEIR PERIMETER LINEAL FEET
R-3227-BD	R	2.3	6.0

Curb box adjustable 6" to 9".
 Also available with Type C grate, order as R-3228-BC.

■ Note: When specifying/ordering grates, refer to "Choosing the proper inlet grate" on pages 117-118.
 For a complete listing of FREE OPEN AREAS and WEIR PERIMETERS of all NEENAH grates, refer to pages 306-311.

R-3228-G
Expressway Inlet, Frame, Grate, Curb Box

Heavy Duty

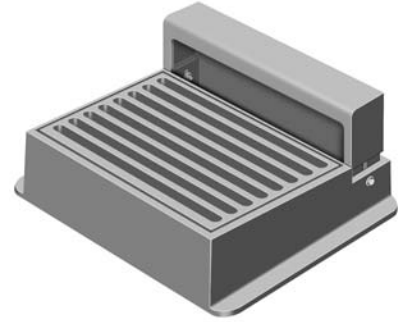
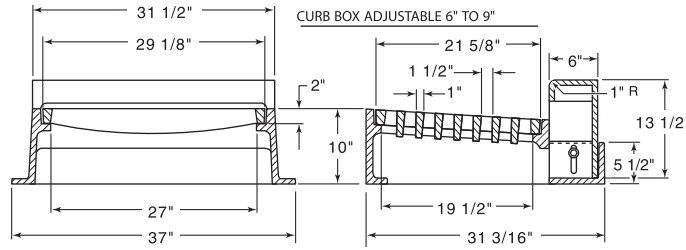

CATALOG NUMBER	GRATE TYPE	SQ. FT. OPEN	WEIR PERIMETER LINEAL FEET
R-3227-G	D	2.2	6.0

Curb box adjustable 6" to 9".
 Also available with Type R-diagonal grate, order as R-3228-GD.

R-3228-H
Expressway Inlet, Frame, Grate, Curb Box

Heavy Duty

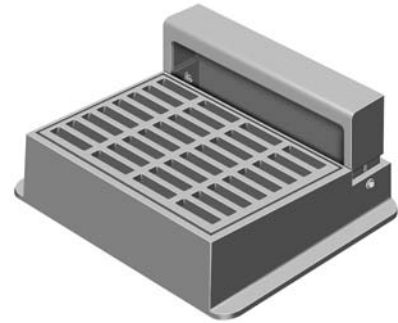
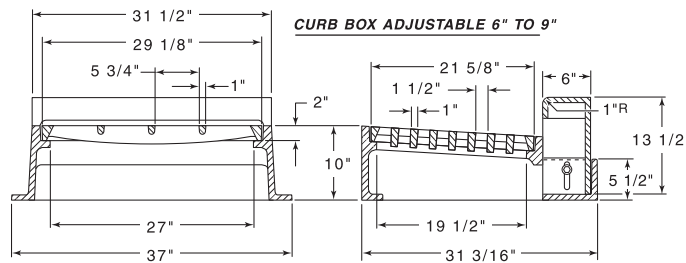

CATALOG NUMBER	GRATE TYPE	SQ. FT. OPEN	WEIR PERIMETER LINEAL FEET
R-3227-H	C	1.9	6.0

Curb box adjustable 6" to 9".

R-3228-J
Expressway Inlet, Frame, Grate, Curb Box

Heavy Duty

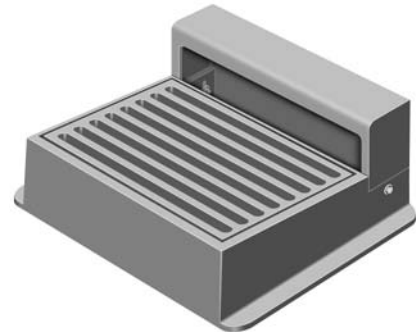
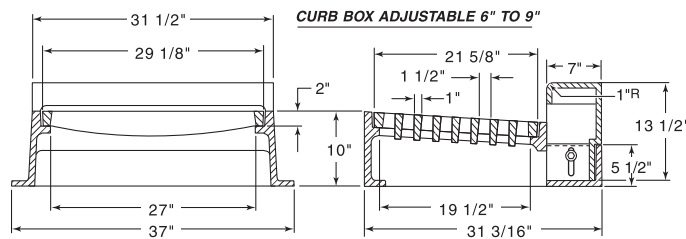

CATALOG NUMBER	GRATE TYPE	SQ. FT. OPEN	WEIR PERIMETER LINEAL FEET
R-3227-J	D	2.2	6.0

Curb box adjustable 6" to 9".
 Also available with Type R-diagonal grate, order as R-3228-JD.

R-3228-K
Expressway Inlet, Frame, Grate, Curb Box

Heavy Duty

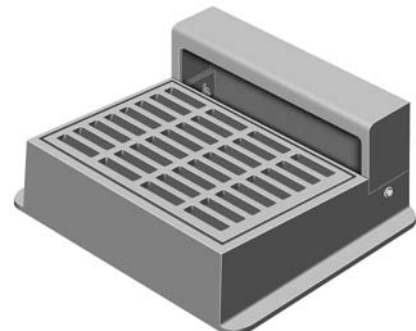
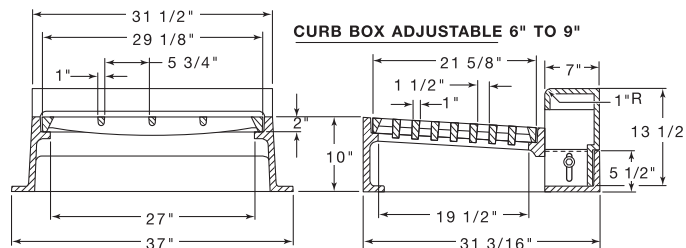

CATALOG NUMBER	GRATE TYPE	SQ. FT. OPEN	WEIR PERIMETER LINEAL FEET
R-3227-K	C	1.9	6.0

Curb box adjustable 6" to 9".

COMBINATION
INLETS
3

■ Note: When specifying/ordering grates, refer to "Choosing the proper inlet grate" on pages 117-118.
 For a complete listing of FREE OPEN AREAS and WEIR PERIMETERS of all NEENAH grates, refer to pages 306-311.

R-3229-A Combination Inlet Frame, Convex Grate, Curb Box

Heavy Duty

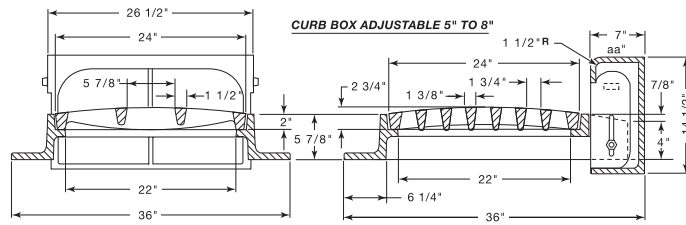

CATALOG NUMBER	GRATE TYPE	SQ. FT. OPEN	WEIR PERIMETER LINEAL FEET
R-3229-A	C	1.5	8.0
R-3229-A	R	1.6	8.0
R-3229-A	D	1.6	8.0

Standard Grate (shown): Type C

Alternate Grate(s):

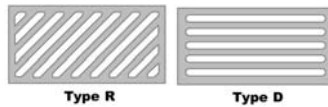

R-3229-L Combination Inlet Frame, Grate, Curb Box

Heavy Duty

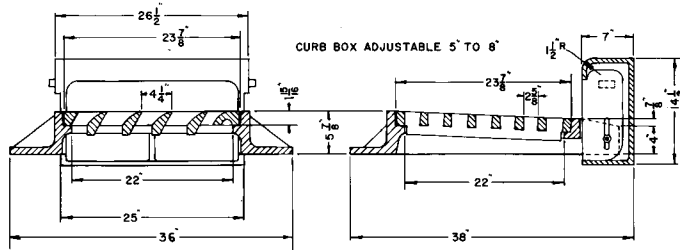

CATALOG NUMBER	GRATE TYPE	SQ. FT. OPEN	WEIR PERIMETER LINEAL FEET
R-3229-L	L	1.5	6.0

R-3233 Large Combination Inlet Frame, Grate, Curb Box

Heavy Duty

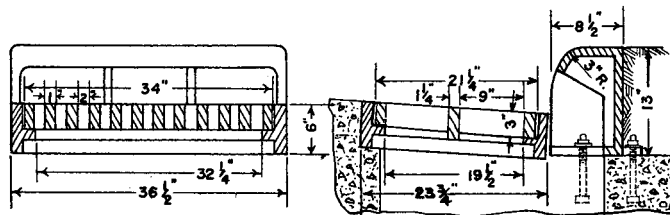

CATALOG NUMBER	GRATE TYPE	SQ. FT. OPEN	WEIR PERIMETER LINEAL FEET
R-3233	A	2.8	6.4

To order without curb box, see R-3469.

■ Note: When specifying/ordering grates, refer to "Choosing the proper inlet grate" on pages 117-118.
 For a complete listing of FREE OPEN AREAS and WEIR PERIMETERS of all NEENAH grates, refer to pages 306-311.

R-3233-A
Combination Inlet Drain

Heavy Duty

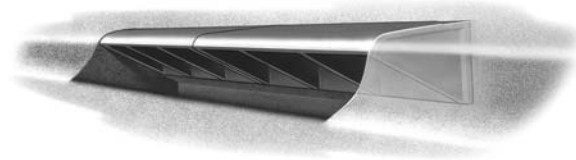
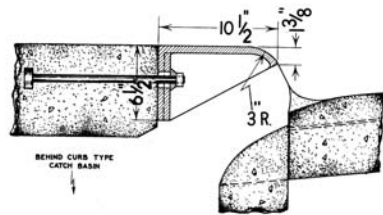

Multiple sections usually furnished in heavy drainage areas. Concrete catch basin constructed behind curb, using R-6040. Behind-the-curb manhole illustrated with R-3469. Not recommended for use in areas where large gutter trash objects are prevalent. Curb opening, without gutter grate, allows large trash to enter catch basin and clog lines. 7/8" diameter anchor bolts furnished by others. Can be used either single or in combination as shown.

COMBINATION
INLETS
3

R-3233-D
Large Combination Inlet Frame, Grate, Curb Box

Heavy Duty

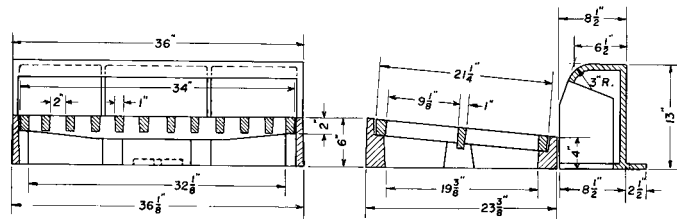

CATALOG NUMBER	GRATE TYPE	SQ. FT. OPEN	WEIR PERIMETER LINEAL FEET
R-3233-D	A	2.8	6.4

R-3234-B1
Combination Inlet Frame, Grate, Curb Box

Heavy Duty

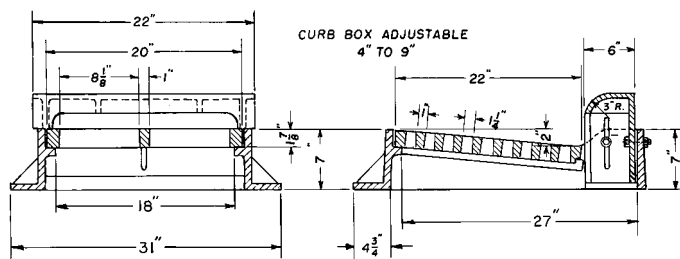

CATALOG NUMBER	GRATE TYPE	SQ. FT. OPEN	WEIR PERIMETER LINEAL FEET
R-3234-B1	A	1.1	5.3
R-3234-B1	R	1.4	5.3

Standard Grate (shown): Type A
 Alternate Grate(s):

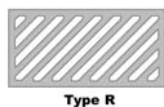

■ Note: When specifying/ordering grates, refer to "Choosing the proper inlet grate" on pages 117-118.
 For a complete listing of FREE OPEN AREAS and WEIR PERIMETERS of all NEENAH grates, refer to pages 306-311.

R-3235 Combination Inlet Frame, Grate, Curb Box

Heavy Duty

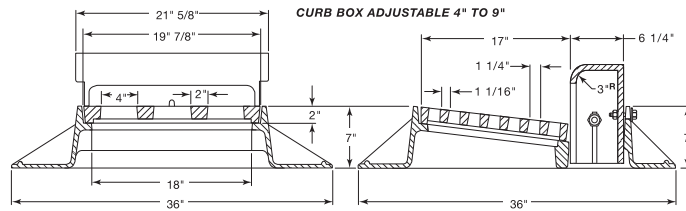

CATALOG NUMBER	GRATE TYPE	SQ. FT. OPEN	WEIR PERIMETER LINEAL FEET
R-3235	C	0.7	4.5
R-3235	A	0.9	4.5
R-3235	L	0.8	4.5
R-3235	R	0.9	4.5

Standard Grate (shown): Type C

Alternate Grate(s):

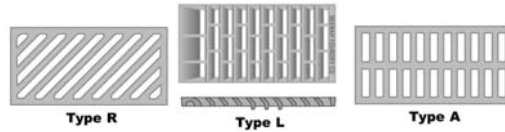

R-3236 Combination Inlet Frame, Grate, Curb Box

Heavy Duty

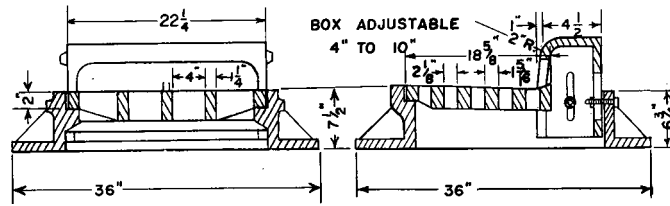

CATALOG NUMBER	GRATE TYPE	SQ. FT. OPEN	WEIR PERIMETER LINEAL FEET
R-3236	C	1.2	4.9

R-3236-1 Combination Inlet Frame, Grate, Curb Box

Heavy Duty

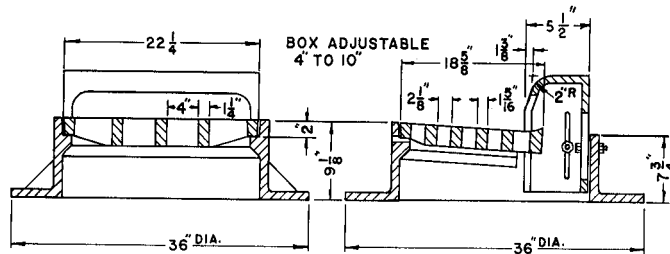

CATALOG NUMBER	GRATE TYPE	SQ. FT. OPEN	WEIR PERIMETER LINEAL FEET
R-3236-1	C	1.2	4.9

Weep holes furnished standard.

■ Note: When specifying/ordering grates, refer to "Choosing the proper inlet grate" on pages 117-118.
 For a complete listing of FREE OPEN AREAS and WEIR PERIMETERS of all NEENAH grates, refer to pages 306-311.

R-3236-A
Split Combination Inlet Frame, Grate, Curb Box

Heavy Duty

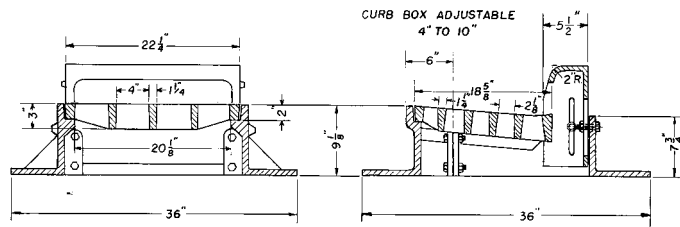

CATALOG NUMBER	GRATE TYPE	SQ. FT. OPEN	WEIR PERIMETER LINEAL FEET
R-3236-A	C	1.2	4.9

Weep holes furnished standard.

Split design facilitates forming for pavement or gutter. NO BOXING OUT, NO SPECIAL FORMS REQUIRED. Either the curb-side portion or the street-side portion of the casting may be placed against the form at the prescribed location so that concrete may be poured with the unit in place. When form is removed, the corresponding portion of the casting may be bolted to the portion in position to form a complete unit.

R-3237 See pages 201-205 for more Roll Type products
Roll Type Inlet Frame, Grate, Curb Box

Heavy Duty

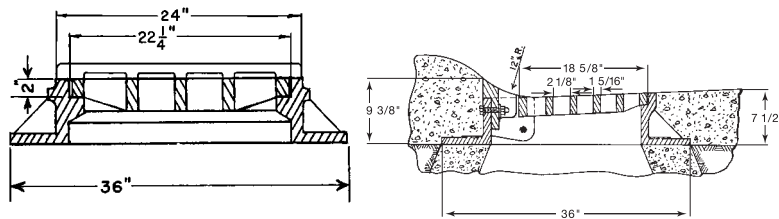

CATALOG NUMBER	GRATE TYPE	SQ. FT. OPEN	WEIR PERIMETER LINEAL FEET
R-3237	C	1.3	4.9

Same as R-3236 except curb box is designed for roll type curb.

R-3237-1
Roll Type Inlet Frame, Grate, Curb Box

Heavy Duty

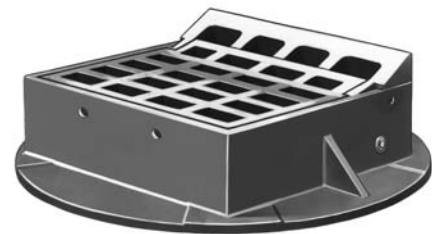
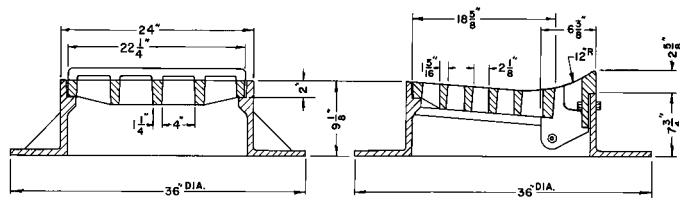

CATALOG NUMBER	GRATE TYPE	SQ. FT. OPEN	WEIR PERIMETER LINEAL FEET
R-3237-1	C	1.3	4.9

COMBINATION
INLETS
3

■ Note: When specifying/ordering grates, refer to "Choosing the proper inlet grate" on pages 117-118.
 For a complete listing of FREE OPEN AREAS and WEIR PERIMETERS of all NEENAH grates, refer to pages 306-311.

R-3237-A Split Roll Type Inlet Frame, Grate, Curb Box

Heavy Duty

Same as R-3236-A except curb box is designed for roll type curb.

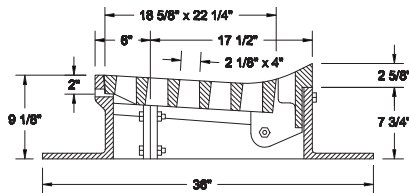

CATALOG NUMBER	GRATE TYPE	SQ. FT. OPEN	WEIR PERIMETER LINEAL FEET
R-3237-A	C	1.3	4.9

COMBINATION INLETS

R-3237-B Split Roll Type Inlet Frame, Grate, Curb Box

Heavy Duty

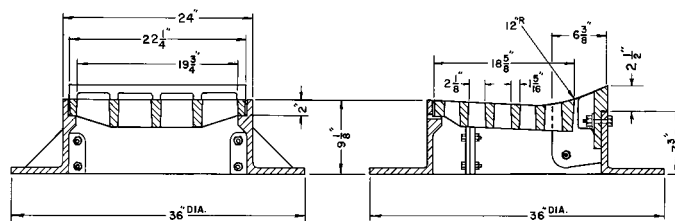

CATALOG NUMBER	GRATE TYPE	SQ. FT. OPEN	WEIR PERIMETER LINEAL FEET
R-3237-B	C	1.3	4.9

R-3238 Concave Inlet Frame, Grate

Heavy Duty

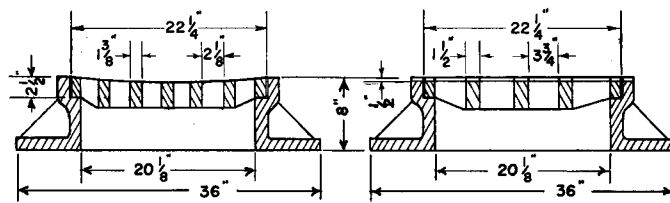

CATALOG NUMBER	GRATE TYPE	SQ. FT. OPEN	WEIR PERIMETER LINEAL FEET
R-3238	C	1.3	7.4

■ Note: When specifying/ordering grates, refer to "Choosing the proper inlet grate" on pages 117-118.
 For a complete listing of FREE OPEN AREAS and WEIR PERIMETERS of all NEENAH grates, refer to pages 306-311.

R-3246 Combination Inlet Frame, Grate, Curb Box

Heavy Duty

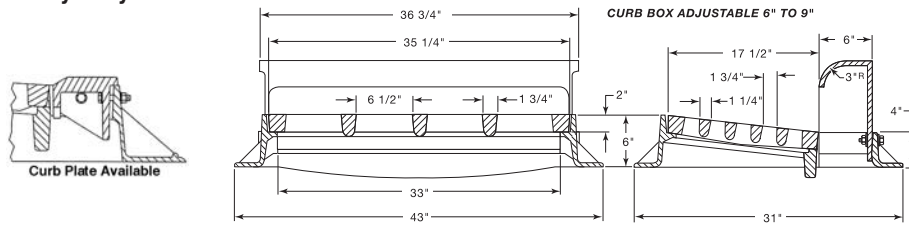

CATALOG NUMBER	GRATE TYPE	SQ. FT. OPEN	WEIR PERIMETER LINEAL FEET
R-3246	C	1.6	5.8
R-3246	L	2.1	5.8
R-3246	V	2.4	5.8

Standard Grate (shown): Type C

Alternate Grate(s):

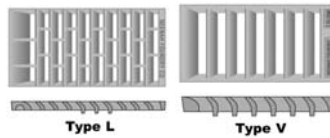

Also available with square, 1" radius, 2" radius or D-shaped curb face.
 Order R-3246-1 for curb plate.

R-3246-A Combination Inlet Frame, Grate, Curb Box

Heavy Duty

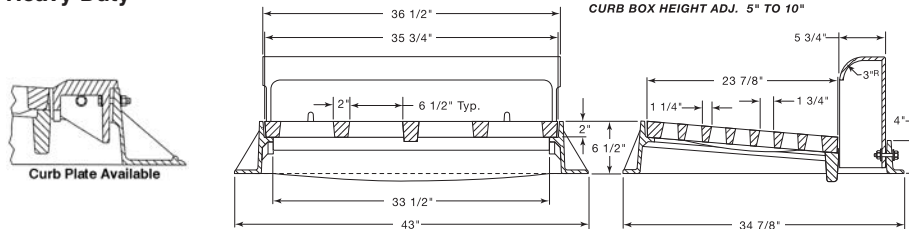

Standard Grate (shown): Type C

Alternate Grate(s):

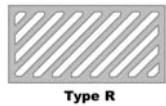

Also available with square, 1" radius, 2" radius or D-shaped curb face.
 Order R-3246-AP for curb plate.

CATALOG NUMBER	GRATE TYPE	SQ. FT. OPEN	WEIR PERIMETER LINEAL FEET
R-3246-A	C	2.2	7.0
R-3246-A	R	2.7	7.0

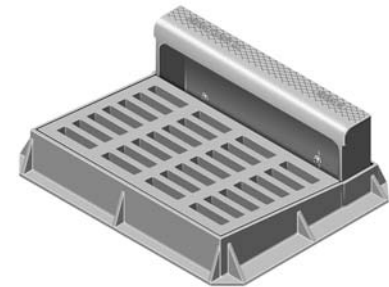

■ Note: When specifying/ordering grates, refer to "Choosing the proper inlet grate" on pages 117-118.
 For a complete listing of FREE OPEN AREAS and WEIR PERIMETERS of all NEENAH grates, refer to pages 306-311.

R-3246-AL Combination Inlet Frame, Grate, Curb Box

Heavy Duty

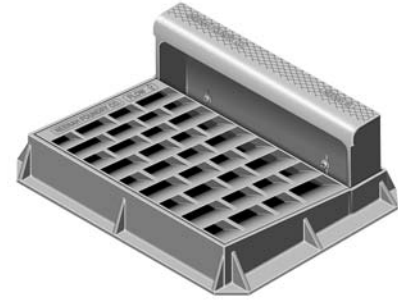
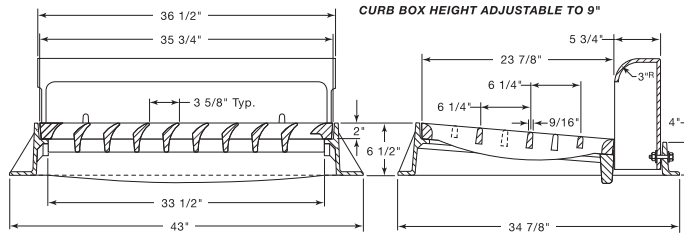

CATALOG NUMBER	GRATE TYPE	SQ. FT. OPEN	WEIR PERIMETER LINEAL FEET
R-3246-AL	L	3.1	7.0
R-3246-AL	R	2.7	7.0

Standard Grate (shown): Type L
 Alternate Grate(s):

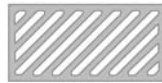

Type R

R-3246-AM Combination Inlet Frame, Grate, Mountable Curb Box

Heavy Duty

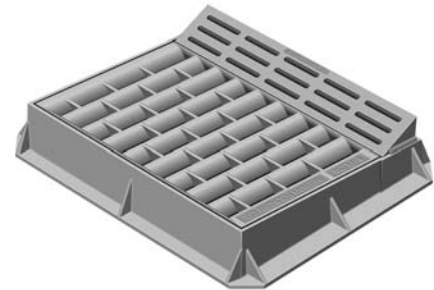
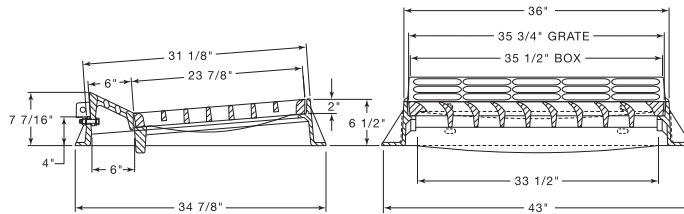

CATALOG NUMBER	GRATE TYPE	SQ. FT. OPEN	WEIR PERIMETER LINEAL FEET
R-3246-AM	R	1.9	5.8
R-3246-AM	L	3.1	5.8

Standard Grate (shown): Type L
 Alternate Grate(s):



Type R

R-3246-CC Combination Inlet Frame, Grate, Curb Box

Heavy Duty

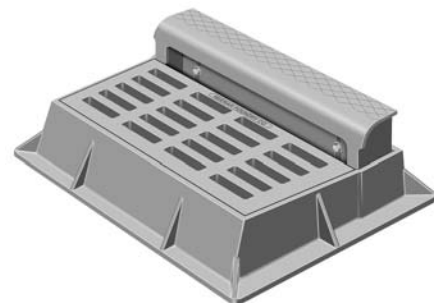
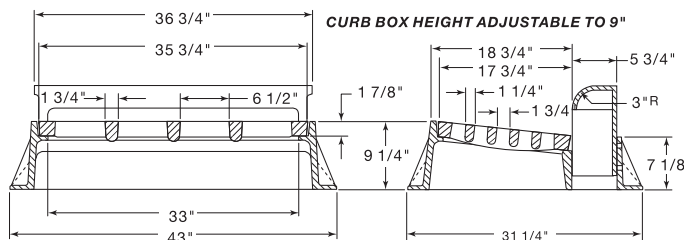

CATALOG NUMBER	GRATE TYPE	SQ. FT. OPEN	WEIR PERIMETER LINEAL FEET
R-3246-CC	C	1.8	5.8
R-3246-CC	R	1.9	5.8

Standard Grate (shown): Type C.
 Also available with grate Type R-diagonal.



Type R

■ Note: When specifying/ordering grates, refer to “Choosing the proper inlet grate” on pages 117-118.
 For a complete listing of FREE OPEN AREAS and WEIR PERIMETERS of all NEENAH grates, refer to pages 306-311.

R-3246-CL Combination Inlet Frame, Grate, Curb Box

Heavy Duty

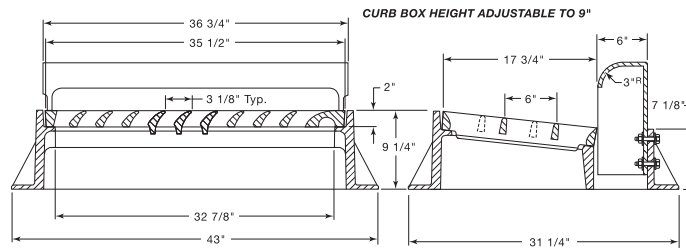

CATALOG NUMBER	GRATE TYPE	SQ. FT. OPEN	WEIR PERIMETER LINEAL FEET
R-3246-CL	L	1.6	5.8
R-3246-CL	C	2.1	5.8

Standard Grate (shown): Type L.
 Also available with grate Type C.



Type C

R-3246-E Combination Inlet Frame, Grate, Mountable Curb Box

Heavy Duty

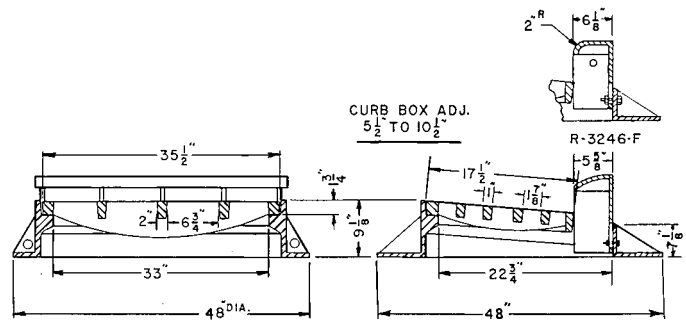

CATALOG NUMBER	GRATE TYPE	SQ. FT. OPEN	WEIR PERIMETER LINEAL FEET
R-3246-E	C	1.6	5.8

Also available with 2" radius curb box, order R-3246-F.

R-3247-2D Combination Inlet Frame, Grates, Curb Box

Heavy Duty

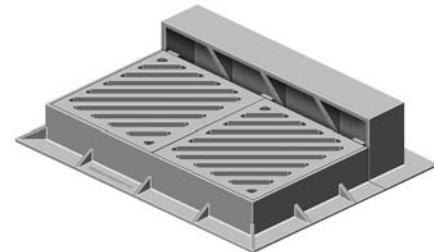
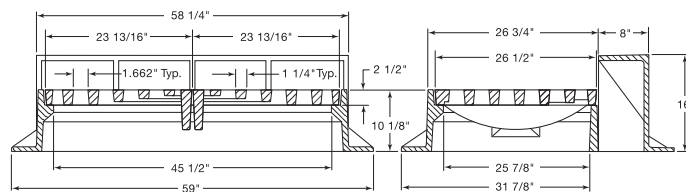

CATALOG NUMBER	GRATE TYPE	SQ. FT. OPEN	WEIR PERIMETER LINEAL FEET
R-3247-2D	R	3.8	8.4
R-3247-2L	L	4.6	8.4
R-3247-2Q	Q	1.8	8.4

Standard Grate (shown): Type R.

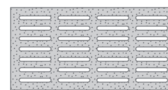

Type Q



Type L

Can be furnished without curb box, see R-3572 and R-3573 series.

Available with 2-piece Type Q grate, order R-3247-2Q.

Available with 2-piece Type L grate, order R-3247-2L.

■ Note: When specifying/ordering grates, refer to "Choosing the proper inlet grate" on pages 117-118.
 For a complete listing of FREE OPEN AREAS and WEIR PERIMETERS of all NEENAH grates, refer to pages 306-311.

R-3249-F Combination Inlet Frame, Grate, Curb Box

Heavy Duty

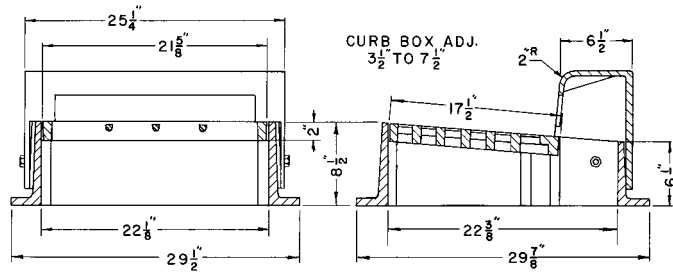

CATALOG NUMBER	GRATE TYPE	SQ. FT. OPEN	WEIR PERIMETER LINEAL FEET
R-3249-F	S	1.1	4.7

R-3250-1 Combination Inlet Frame, Grate, Curb Box

Heavy Duty

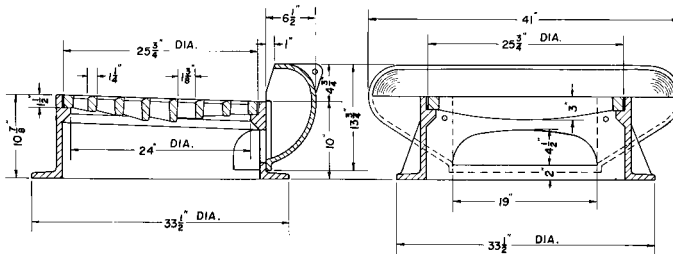

CATALOG NUMBER	GRATE TYPE	SQ. FT. OPEN	WEIR PERIMETER LINEAL FEET
R-3250-1	K	1.5	5.5

Note lug preventing grate rotation.
 Extended curb box provides additional drainage capacity through curb. Note sweeping radius for efficiency in self-cleaning and reduction of turbulence.
IMPORTANT- remove cap screws from curb box when concrete curb has set.

R-3250-A Combination Inlet Frame, Grate, Curb Box

Heavy Duty

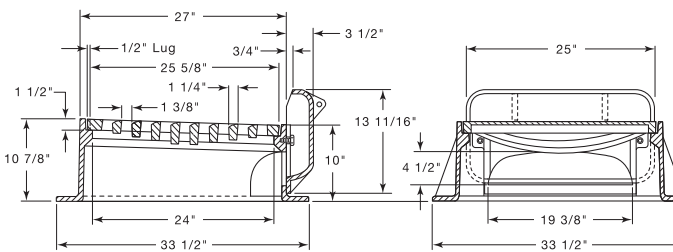

CATALOG NUMBER	GRATE TYPE	SQ. FT. OPEN	WEIR PERIMETER LINEAL FEET
R-3250-A	K	1.5	5.5

Note lug preventing grate rotation.
 Also available with straight face curb.
IMPORTANT- remove cap screws from curb box when concrete curb has set.

■ Note: When specifying/ordering grates, refer to "Choosing the proper inlet grate" on pages 117-118.
 For a complete listing of FREE OPEN AREAS and WEIR PERIMETERS of all NEENAH grates, refer to pages 306-311.

R-3250-B Combination Inlet Frame, Grate, Curb Box

Heavy Duty

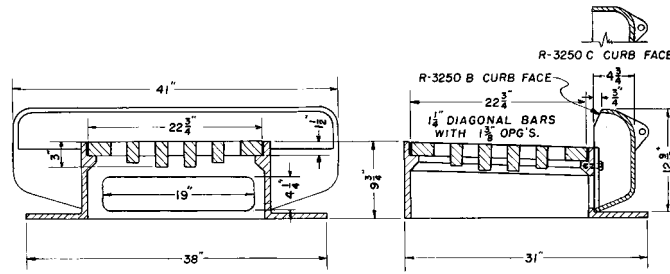

CATALOG NUMBER	GRATE TYPE	SQ. FT. OPEN	WEIR PERIMETER LINEAL FEET
R-3250-B	R	1.4	5.8
R-3250-C	R	1.4	5.8

Also available with straight face curb box, order **R-3250-C**.

R-3250-BSP Catch Basin Frame, Grate

Heavy Duty

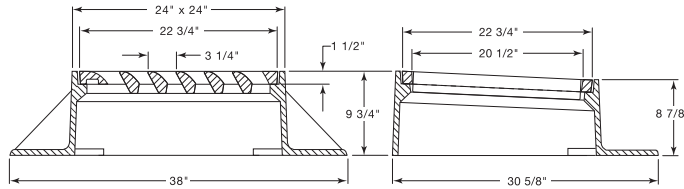

CATALOG NUMBER	GRATE TYPE	SQ. FT. OPEN	WEIR PERIMETER LINEAL FEET
R-3250-BSP	V	1.3	7.6
R-3250-BSP	D	1.4	7.6
R-3250-BSP	L	1.0	7.6

Standard Grate (shown): Type V.
 Also available with grate Type D or Type L.

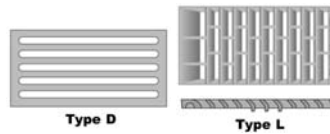

R-3250-CL Combination Inlet Frame, Grate, Curb Box

Heavy Duty

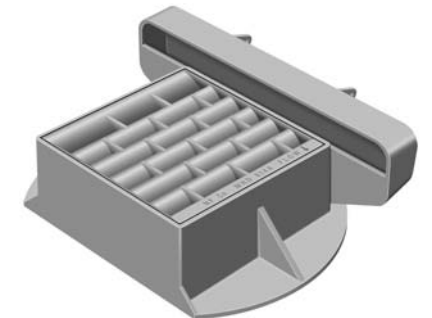
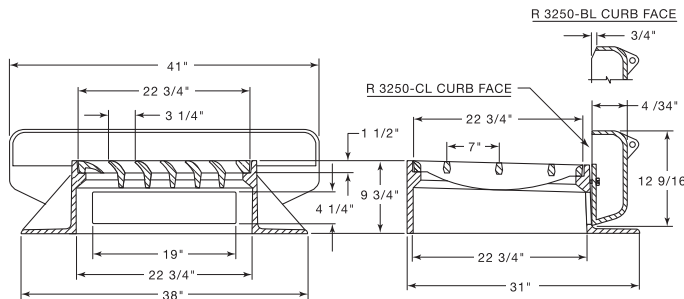

CATALOG NUMBER	GRATE TYPE	SQ. FT. OPEN	WEIR PERIMETER LINEAL FEET
R-3250-CL	L	1.0	5.8
R-3250-BL	L	1.0	5.8

Also available with tapered face curb box, order **R-3250-BL**.

COMBINATION
 INLETS
 3

■ Note: When specifying/ordering grates, refer to "Choosing the proper inlet grate" on pages 117-118.
 For a complete listing of FREE OPEN AREAS and WEIR PERIMETERS of all NEENAH grates, refer to pages 306-311.

R-3250-CV Combination Inlet Frame, Grate, Curb Box

Heavy Duty

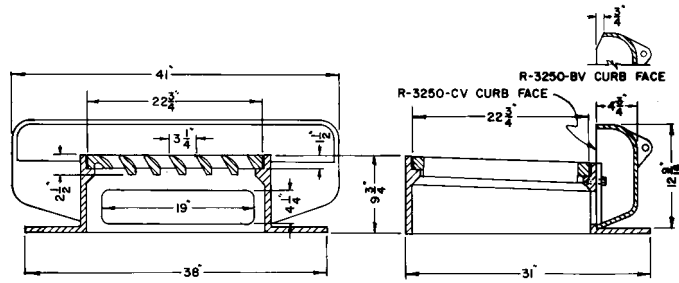

CATALOG NUMBER	GRATE TYPE	SQ. FT. OPEN	WEIR PERIMETER LINEAL FEET
R-3250-CV	V	1.3	5.8
R-3250-BV	V	1.3	5.8

Also available with tapered face curb box, order R-3250-BV.

R-3250-DV Adjustable Combination Inlet

Heavy Duty

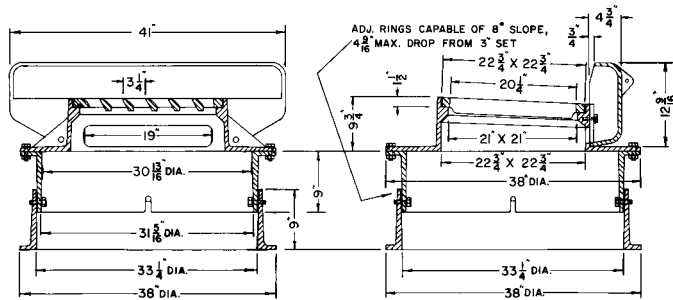

CATALOG NUMBER	GRATE TYPE	SQ. FT. OPEN	WEIR PERIMETER LINEAL FEET
R-3250-DV	V	1.3	5.8

R-3250-DVSP Adjustable Combination Inlet

Heavy Duty

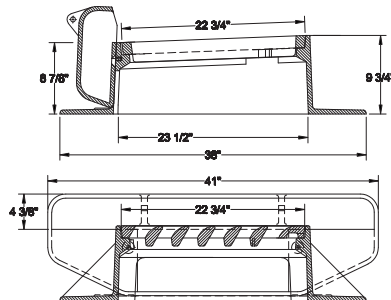

CATALOG NUMBER	GRATE TYPE	SQ. FT. OPEN	WEIR PERIMETER LINEAL FEET
R-3250-DVSP	V	1.3	5.8

R-3250-EV Adjustable Combination Inlet

Heavy Duty

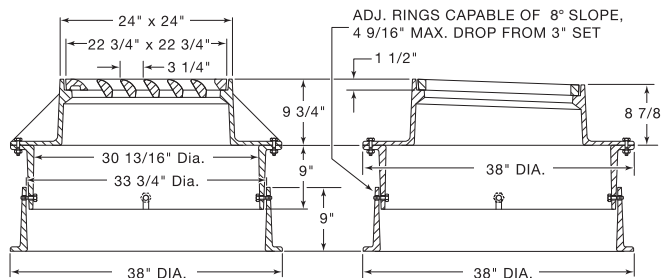

CATALOG NUMBER	GRATE TYPE	SQ. FT. OPEN	WEIR PERIMETER LINEAL FEET
R-3250-EV	V	1.3	7.6

■ Note: When specifying/ordering grates, refer to “Choosing the proper inlet grate” on pages 117-118.
 For a complete listing of FREE OPEN AREAS and WEIR PERIMETERS of all NEENAH grates, refer to pages 306-311.

R-3250-EVSP Adjustable Combination Inlet

Heavy Duty

CATALOG NUMBER	GRATE TYPE	SQ. FT. OPEN	WEIR PERIMETER LINEAL FEET
R-3250-EVSP	V	1.3	7.6

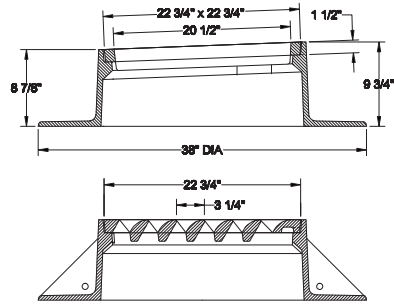

R-3251 Catch Basin Inlet Frame, Convex Grate

Heavy Duty

CATALOG NUMBER	GRATE TYPE	SQ. FT. OPEN	WEIR PERIMETER LINEAL FEET
R-3251	C	1.0	6.3

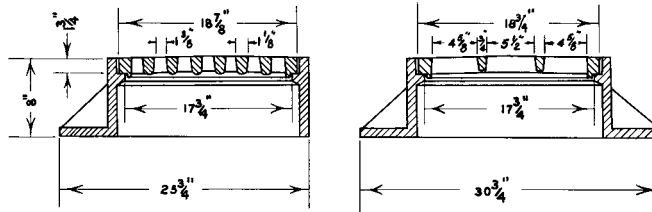

R-3252-A Combination Inlet Frame, Grate, Curb Box

Heavy Duty

CATALOG NUMBER	GRATE TYPE	SQ. FT. OPEN	WEIR PERIMETER LINEAL FEET
R-3252-A	V	1.3	5.8

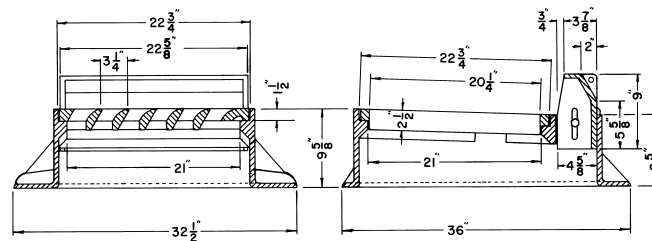

R-3256 Inlet Frame, Lid, Access Lid

Heavy Duty

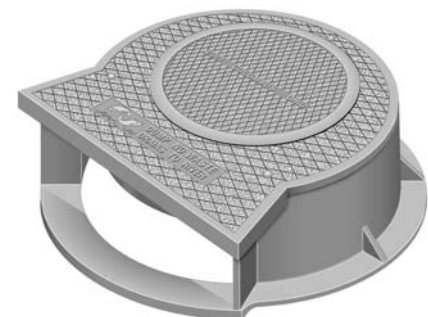
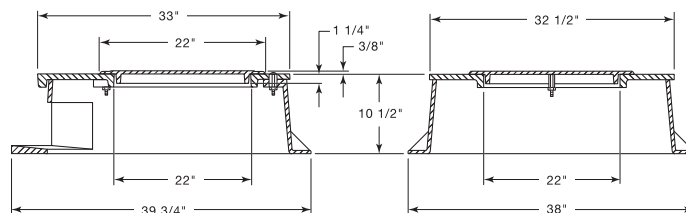

Large lid furnished standard with straight face as shown.
 Also available for 8-foot or 20-foot corner radius.

Not recommended for use in areas where large gutter trash objects are prevalent. Curb opening, without gutter grate, allows large trash to enter catch basin and clog lines.

■ Note: When specifying/ordering grates, refer to "Choosing the proper inlet grate" on pages 117-118.
 For a complete listing of FREE OPEN AREAS and WEIR PERIMETERS of all NEENAH grates, refer to pages 306-311.

R-3260-A Combination Inlet Frame, Grate, Curb Box

Heavy Duty

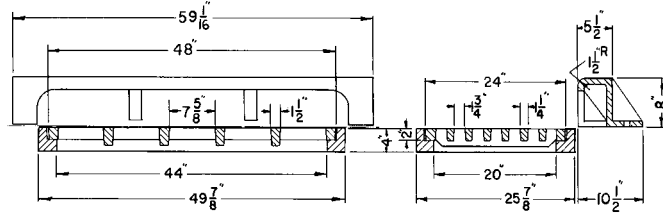

Standard Grate (shown): Type C.
 Also available with 2-piece grate Type L.

CATALOG NUMBER	GRATE TYPE	SQ. FT. OPEN	WEIR PERIMETER LINEAL FEET
R-3260-A	A	3.2	8.0
R-3260-A	L	3.0	8.0

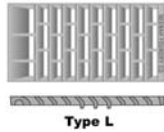

R-3261-A Combination Inlet Frame, Grate, Curb Box

Heavy Duty

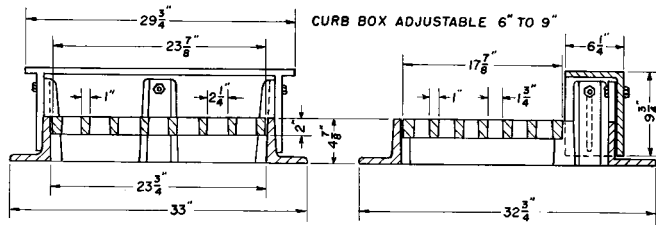

CATALOG NUMBER	GRATE TYPE	SQ. FT. OPEN	WEIR PERIMETER LINEAL FEET
R-3261-A	H	1.1	5.5

R-3262 Series Storm Water Curb Openings

Heavy Duty

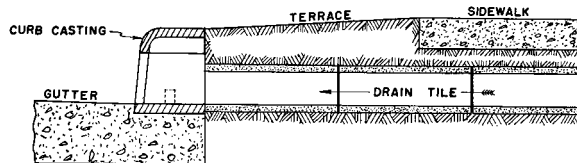
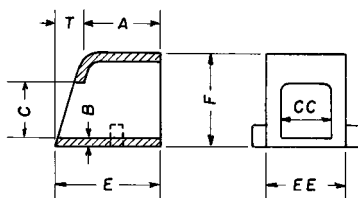

Curb opening castings are used as shown, where it is advantageous to transmit storm water from downspout in shallow drains and discharge it through the curb to the street gutter.

Catalog No.	Dimensions in inches							
	A	B	C	C-C	E	E-E	F	T
R-3262-1	5	1/2	4	4	6	5	7	1
R-3262-2	6	1/2	4	4	8 1/4	5	6	2 1/4
R-3262-3*	5	1/2	4	5 1/2	6	6 1/2	6 1/2	1
R-3262-4	5	1/2	4	16	7	17	6 3/8	2
R-3262-6	6	1/2	6	6	8	7 1/4	9	2

*4" ID outlet is optional

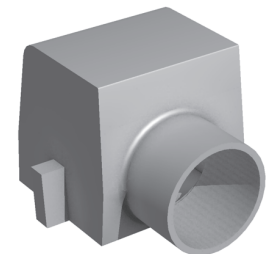

Rear view of R-3262-3 only.
 (optional)

■ Note: When specifying/ordering grates, refer to "Choosing the proper inlet grate" on pages 117-118.
 For a complete listing of FREE OPEN AREAS and WEIR PERIMETERS of all NEENAH grates, refer to pages 306-311.

R-3264
Storm Water Curb Opening

Heavy Duty

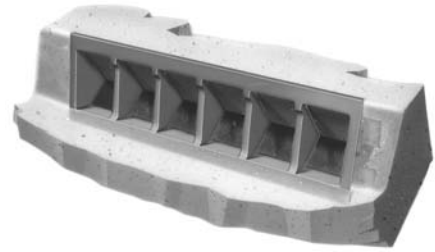
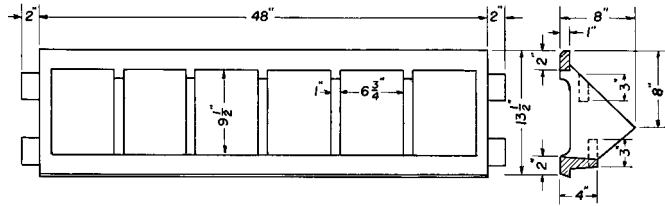

COMBINATION
 INLETS
 3

R-3266
Torrent Inlet Frame, Grate

Heavy Duty

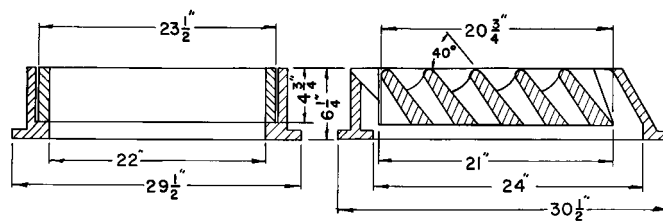

CATALOG NUMBER	GRATE TYPE	SQ. FT. OPEN	WEIR PERIMETER LINEAL FEET
R-3266	V	1.8	7.3

R-3268
Storm Water Curb Opening

Heavy Duty

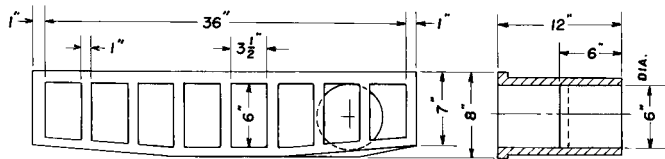

R-3270
Roll Type Inlet Frame, Grate

Heavy Duty

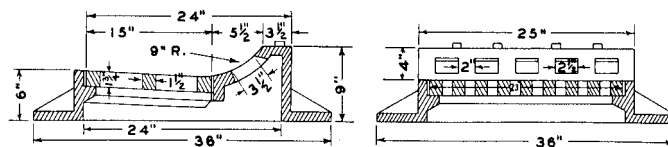

CATALOG NUMBER	GRATE TYPE	SQ. FT. OPEN	WEIR PERIMETER LINEAL FEET
R-3270	A	0.9	4.4

Image shows casting installed in roll type curb.
 Concrete over top of frame is reinforced to prevent breaking away.



■ Note: When specifying/ordering grates, refer to "Choosing the proper inlet grate" on pages 117-118.
 For a complete listing of FREE OPEN AREAS and WEIR PERIMETERS of all NEENAH grates, refer to pages 306-311.

R-3273-A Combination Inlet Frame, Grate, Curb Box

Heavy Duty

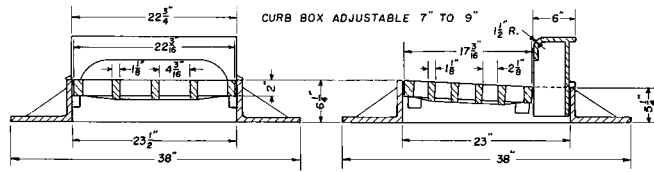

Standard Grate (shown): Type C.
 Also available with grate Type S.



CATALOG NUMBER	GRATE TYPE	SQ. FT. OPEN	WEIR PERIMETER LINEAL FEET
R-3273-A	C	1.2	4.7
R-3273-A	S	1.0	4.7

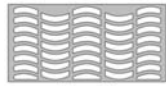

Type S

R-3274 Combination Inlet Frame, Grate, Curb Box

Heavy Duty

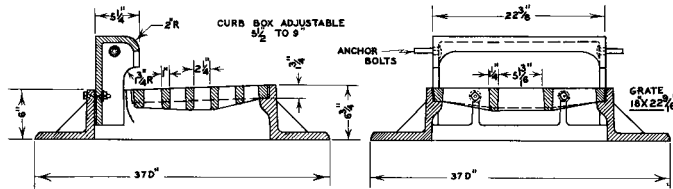

Standard Grate (shown): Type C.
 Also available with grate Type S, order R-3159-A.



CATALOG NUMBER	GRATE TYPE	SQ. FT. OPEN	WEIR PERIMETER LINEAL FEET
R-3274	C	1.2	4.9
R-3159-A	S	1.3	4.9

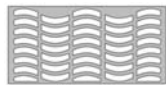

Type S

Available with 3" radius semi-roll curb box.

R-3274-A Combination Inlet Frame, Grate, Curb Box

Heavy Duty

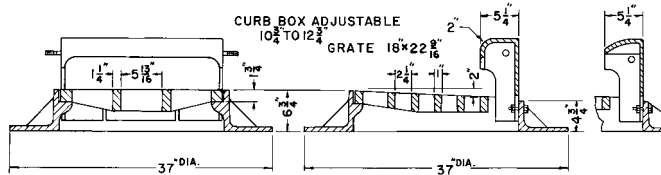

Standard Grate (shown): Type C.
 Also available with grate Type S.



CATALOG NUMBER	GRATE TYPE	SQ. FT. OPEN	WEIR PERIMETER LINEAL FEET
R-3274-A	C	1.4	4.9
R-3274-A	S	1.3	4.9
R-3274-B	C	1.4	4.9
R-3274-B	S	1.3	4.9



Type S

Available with mountable curb box, order R-3274-B.

■ Note: When specifying/ordering grates, refer to “Choosing the proper inlet grate” on pages 117-118.
 For a complete listing of FREE OPEN AREAS and WEIR PERIMETERS of all NEENAH grates, refer to pages 306-311.

R-3275
Combination Inlet Frame, Grate, Curb Box

Heavy Duty

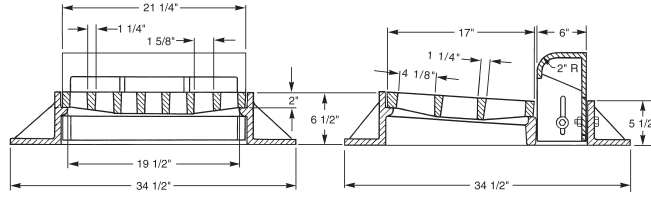

CATALOG NUMBER	GRATE TYPE	SQ. FT. OPEN	WEIR PERIMETER LINEAL FEET
R-3275	A	1.0	4.6

Available with barred curb box.

COMBINATION INLETS 3

R-3277-A
Combination Inlet Frame, Grate, Curb Box

Heavy Duty

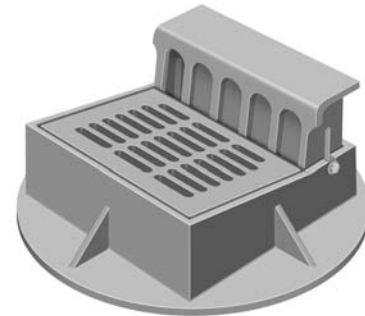
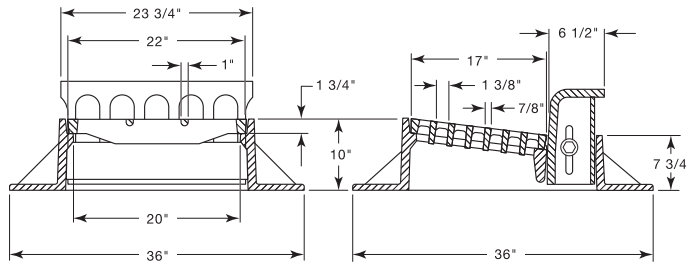

CATALOG NUMBER	GRATE TYPE	SQ. FT. OPEN	WEIR PERIMETER LINEAL FEET
R-3277-A	C	1.2	4.6
R-3277-A	R	1.2	4.6
R-3277-A	L	0.7	4.6

Standard Grate (shown): Type C.
 Also available with grate Type R or Type L.

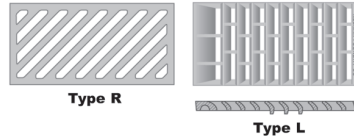

R-3278-A
Combination Inlet Frame, Grate, Curb Box

Heavy Duty

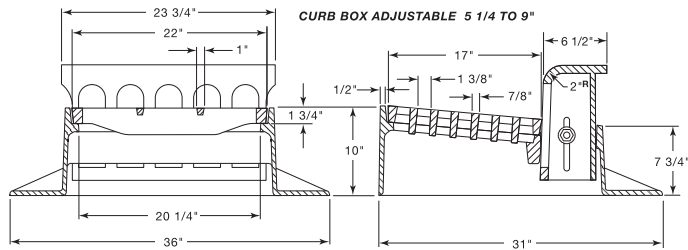

CATALOG NUMBER	GRATE TYPE	SQ. FT. OPEN	WEIR PERIMETER LINEAL FEET
R-3278-A	C	1.2	4.6
R-3278-AR	R	1.2	4.6

Standard Grate (shown): Type C.
 Also available with grate Type R-diagonal, order R-3278-AR.

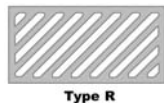

Available with Type L grate, see R-3278-AL.

Available with open curb box.
 Frame available with 4-sided flange support.
 2-1/4" adjusting ring available, see R-1979 series.

■ Note: When specifying/ordering grates, refer to "Choosing the proper inlet grate" on pages 117-118.
 For a complete listing of FREE OPEN AREAS and WEIR PERIMETERS of all NEENAH grates, refer to pages 306-311.

R-3278-AL Combination Inlet Frame, Grate, Curb Box

Heavy Duty

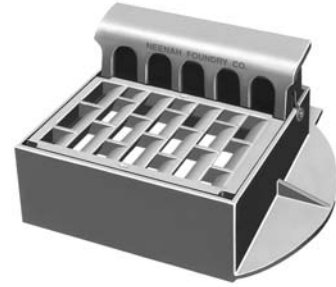
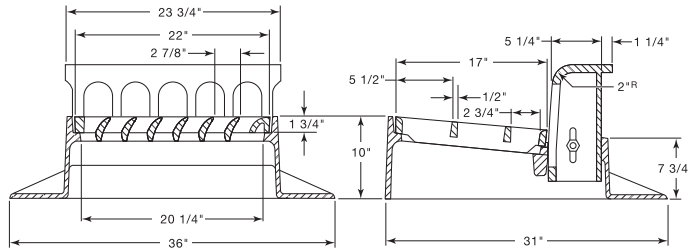

Standard Grate (shown): Type L.

Also available with grate Type R-diagonal, order R-3278-AR.

CATALOG NUMBER	GRATE TYPE	SQ. FT. OPEN	WEIR PERIMETER LINEAL FEET
R-3278-AL	L	0.7	4.6
R-3278-AR	R	1.2	4.6

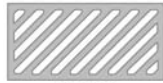

Type R

Available with Type C grate, see R-3278-A.

Available with open curb box.

Frame available with 4-sided flange support.

2-1/4" adjusting ring available, see R-1979 series.

R-3280 Series Curb Plate, Grate

Heavy Duty

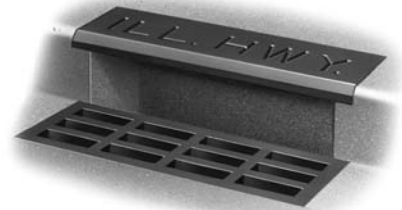
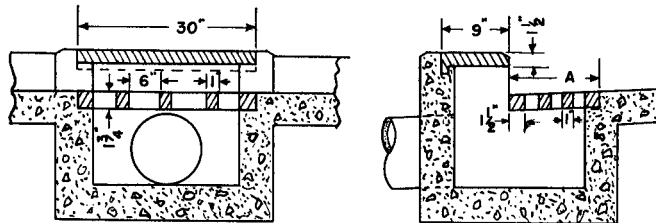

Catalog No.	A
R-3280-A	18
R-3280-B	12

CATALOG NUMBER	GRATE TYPE	SQ. FT. OPEN	WEIR PERIMETER LINEAL FEET
R-3280-A	C	1.8	5.5
R-3280-B	C	1.2	4.5

R-3281-A Combination Inlet Frame, Grate, Curb Box

Heavy Duty

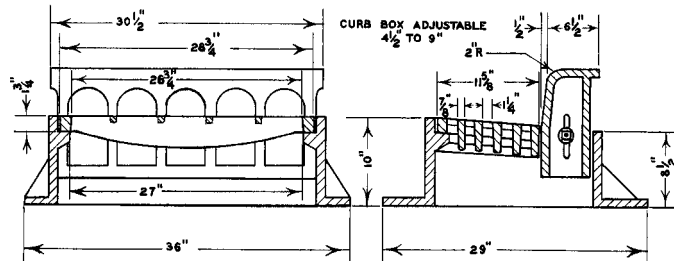

CATALOG NUMBER	GRATE TYPE	SQ. FT. OPEN	WEIR PERIMETER LINEAL FEET
R-3281-A	C	1.0	4.3

Available with 3" radius curb box, open curb box, or curb grate.

Enviro-Curb Boxes available, see page 121.

■ Note: When specifying/ordering grates, refer to "Choosing the proper inlet grate" on pages 117-118.
 For a complete listing of FREE OPEN AREAS and WEIR PERIMETERS of all NEENAH grates, refer to pages 306-311.

R-3281-AL
Combination Inlet Frame, Grate, Curb Box

Heavy Duty

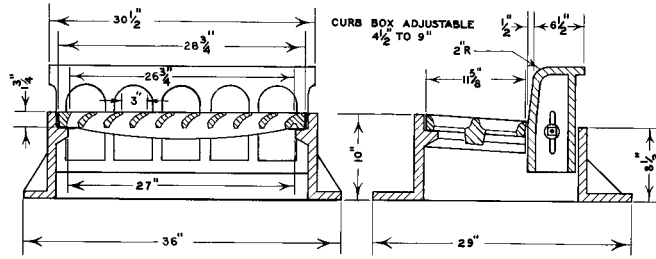
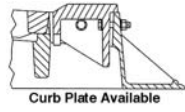

CATALOG NUMBER	GRATE TYPE	SQ. FT. OPEN	WEIR PERIMETER LINEAL FEET
R-3281-AL	L	0.5	4.3

Available with 3" radius curb box or open curb box.
 Enviro-Curb Boxes available, see page 121.

R-3286-8V
Combination Inlet Frame, Grate, Curb Box

Heavy Duty

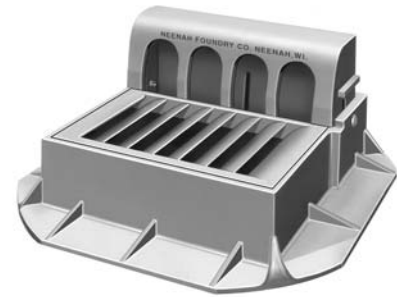
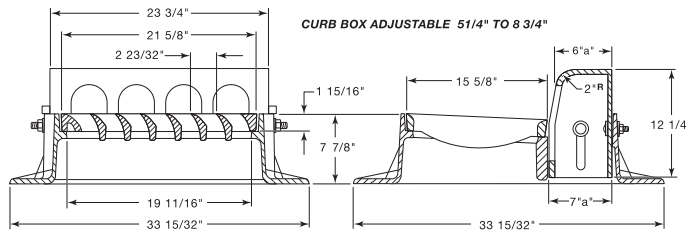

CATALOG NUMBER	GRATE TYPE	SQ. FT. OPEN	WEIR PERIMETER LINEAL FEET
R-3286-8V	V	0.7	4.4

Available with 3" radius curb box.

R-3287-5
Combination Inlet Frame, Grate

Heavy Duty

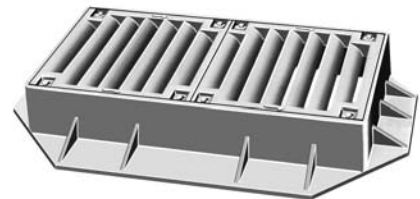
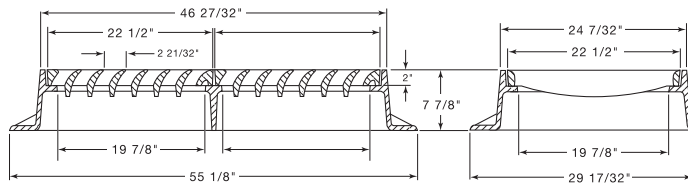

CATALOG NUMBER	GRATE TYPE	SQ. FT. OPEN	WEIR PERIMETER LINEAL FEET
R-3287-5	V	3.2	11.3

2-1/2" adjusting ring available, see R-1979 series.

R-3287-10V
Combination Inlet Frame, Grate, Curb Box

Heavy Duty

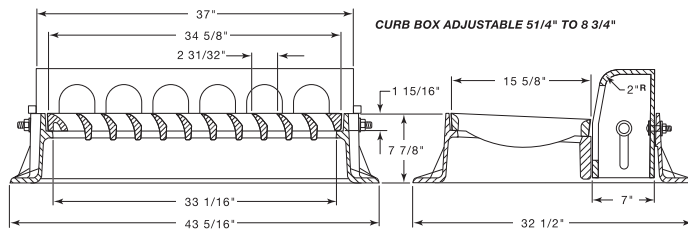

CATALOG NUMBER	GRATE TYPE	SQ. FT. OPEN	WEIR PERIMETER LINEAL FEET
R-3287-10V	V	2.1	5.5

Available with 3" radius curb box.

COMBINATION
 INLETS
 3

■ Note: When specifying/ordering grates, refer to "Choosing the proper inlet grate" on pages 117-118.
 For a complete listing of FREE OPEN AREAS and WEIR PERIMETERS of all NEENAH grates, refer to pages 306-311.

R-3287-15
Combination Inlet Frame, Grate, Curb Box

Heavy Duty

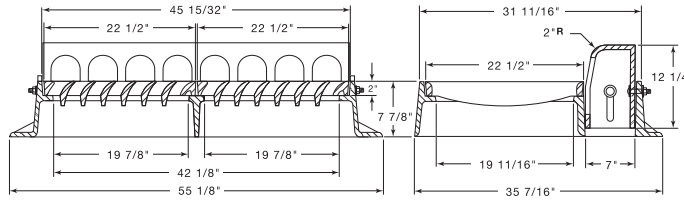

CATALOG NUMBER	GRATE TYPE	SQ. FT. OPEN	WEIR PERIMETER LINEAL FEET
R-3287-15	V	3.2	7.5

R-3287-SB10
Combination Inlet Frame, Grate, Curb Box

Heavy Duty

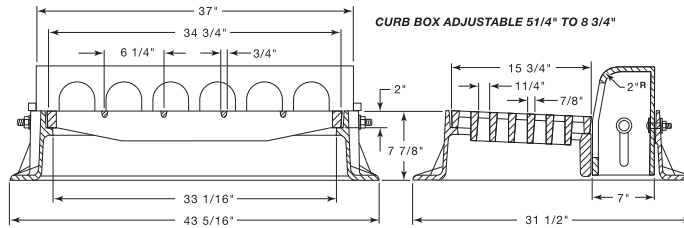

CATALOG NUMBER	GRATE TYPE	SQ. FT. OPEN	WEIR PERIMETER LINEAL FEET
R-3287-SB10	S	1.5	5.5

R-3288-E2
Double Inlet Frame, Two-Piece Grate, Curb Plate

Heavy Duty

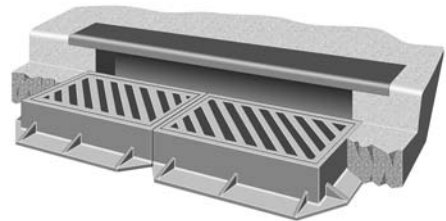
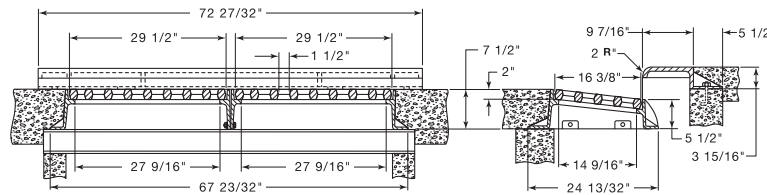

CATALOG NUMBER	GRATE TYPE	SQ. FT. OPEN	WEIR PERIMETER LINEAL FEET
R-3288-E2	R	2.6	7.6
R-3288-E2	V	2.8	7.6

Optional cast support beam available.

Standard Grate (shown): Type R-diagonal.
 Also available with grate Type V.

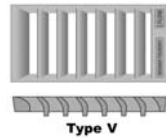

Type V

■ Note: When specifying/ordering grates, refer to "Choosing the proper inlet grate" on pages 117-118.
 For a complete listing of FREE OPEN AREAS and WEIR PERIMETERS of all NEENAH grates, refer to pages 306-311.

R-3288-HV2
Double Inlet Frame, Two-Piece Grate, Curb Plate

Heavy Duty

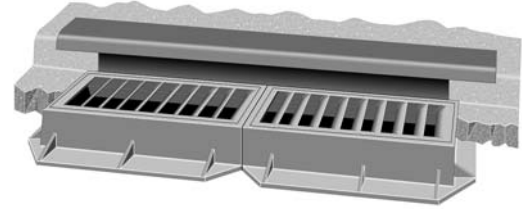
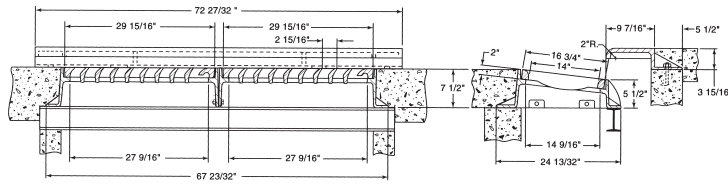

CATALOG NUMBER	GRATE TYPE	SQ. FT. OPEN	WEIR PERIMETER LINEAL FEET
R-3288-HV2	V	2.8	7.6

R-3289-C
Single Inlet Frame, Grate, Curb Plate

Heavy Duty

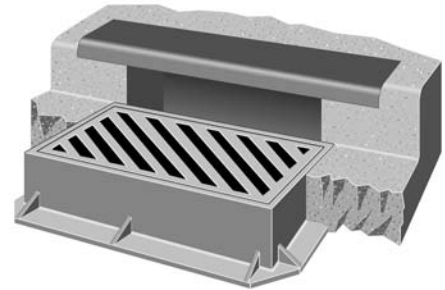
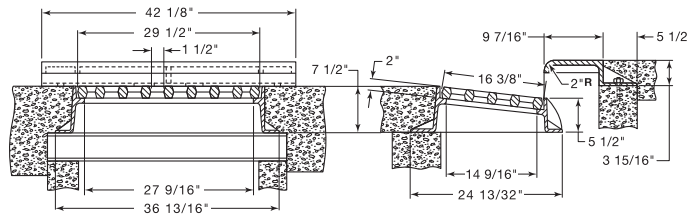

CATALOG NUMBER	GRATE TYPE	SQ. FT. OPEN	WEIR PERIMETER LINEAL FEET
R-3289-C	R	1.3	5.2

R-3289-HV
Single Inlet Frame, Grate, Curb Plate

Heavy Duty

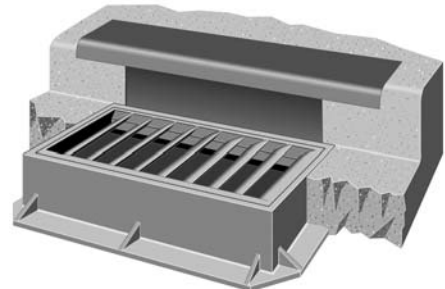
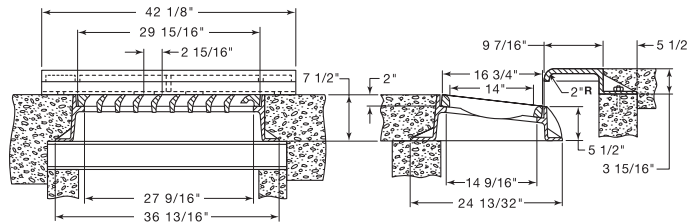

CATALOG NUMBER	GRATE TYPE	SQ. FT. OPEN	WEIR PERIMETER LINEAL FEET
R-3289-HV	V	1.4	5.2

COMBINATION
INLETS
3

■ Note: When specifying/ordering grates, refer to "Choosing the proper inlet grate" on pages 117-118.
 For a complete listing of FREE OPEN AREAS and WEIR PERIMETERS of all NEENAH grates, refer to pages 306-311.

R-3290 Combination Inlet Frame, Grate, Curb Box

Heavy Duty

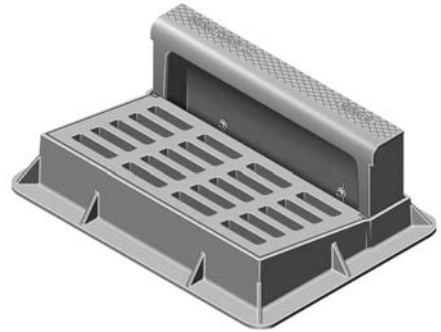
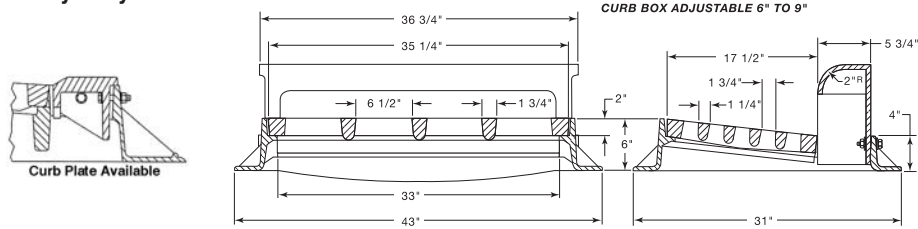

CATALOG NUMBER	GRATE TYPE	SQ. FT. OPEN	WEIR PERIMETER LINEAL FEET
R-3290	C	1.6	5.8
R-3290	V	2.4	5.8
R-3290	R	1.9	5.8
R-3290	L	2.1	5.8

Standard Grate (shown): Type C.
 Also available with grate Type V, Type R-diagonal or Type L.

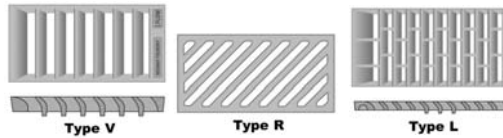

Available Curb Boxes: 2"Radius Open (standard), 3"Radius Open
 Enviro-Curb Boxes available, see page 121.

R-3290-A Gutter Inlet Frame, Grate

Heavy Duty

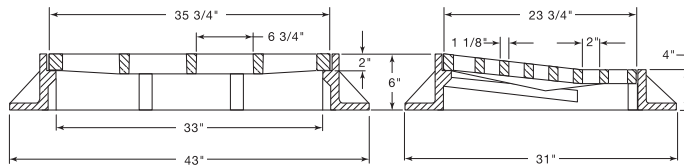

CATALOG NUMBER	GRATE TYPE	SQ. FT. OPEN	WEIR PERIMETER LINEAL FEET
R-3290-A	C	2.6	9.9
R-3290-A	A	2.6	9.9

Standard Grate (shown): Type C.
 Also available with grate Type A.

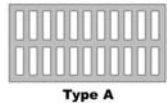

Furnished without curb box for use at driveway locations and in gutters.

R-3290-B Gutter Inlet Frame, Grate

Heavy Duty

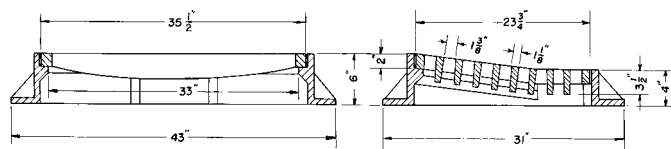

CATALOG NUMBER	GRATE TYPE	SQ. FT. OPEN	WEIR PERIMETER LINEAL FEET
R-3290-B	D	3.5	9.9

■ Note: When specifying/ordering grates, refer to “Choosing the proper inlet grate” on pages 117-118.
 For a complete listing of FREE OPEN AREAS and WEIR PERIMETERS of all NEENAH grates, refer to pages 306-311.

R-3290-C Gutter Inlet Frame, Grate

Heavy Duty

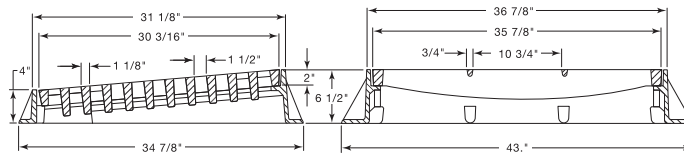

CATALOG NUMBER	GRATE TYPE	SQ. FT. OPEN	WEIR PERIMETER LINEAL FEET
R-3290-C	D	3.7	11.0
R-3290-C	C	3.7	11.0

Standard Grate (shown): Type D.
 Also available with grate Type C.



Type C

R-3290-VB Gutter Inlet Frame, Grate

Heavy Duty

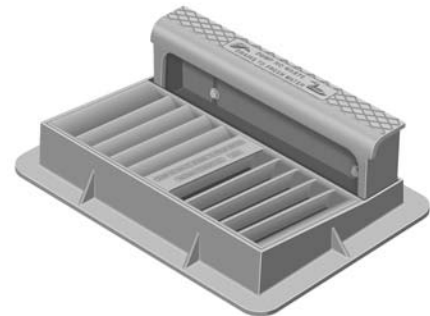
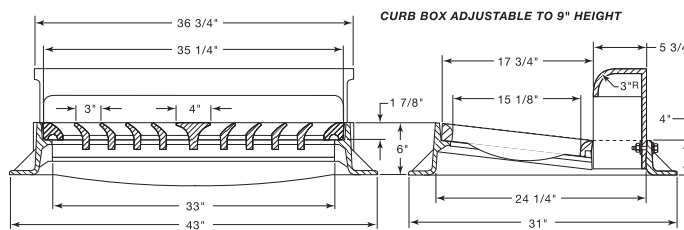

CATALOG NUMBER	GRATE TYPE	SQ. FT. OPEN	WEIR PERIMETER LINEAL FEET
R-3290-VB	V	2.7	5.8

R-3291 Gutter Inlet Frame, Grate

Heavy Duty

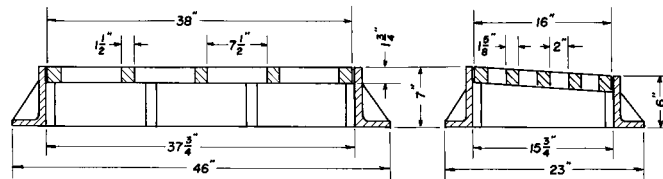

CATALOG NUMBER	GRATE TYPE	SQ. FT. OPEN	WEIR PERIMETER LINEAL FEET
R-3291	C	1.7	9.0

■ Note: When specifying/ordering grates, refer to "Choosing the proper inlet grate" on pages 117-118.
 For a complete listing of FREE OPEN AREAS and WEIR PERIMETERS of all NEENAH grates, refer to pages 306-311.

R-3292 Combination Inlet Frame, Grate, Curb Box

Heavy Duty

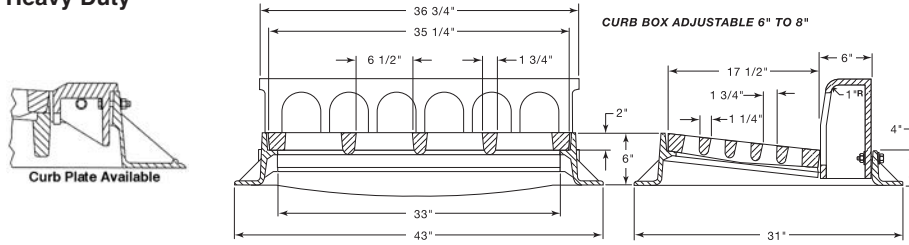

CATALOG NUMBER	GRATE TYPE	SQ. FT. OPEN	WEIR PERIMETER LINEAL FEET
R-3292	C	1.6	5.8

Available with mountable grated or solid curb plate in place of curb box.

R-3295 Combination Inlet Frame, Grate, Curb Box

Heavy Duty

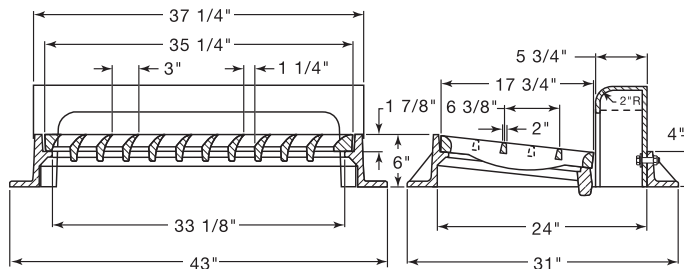

CATALOG NUMBER	GRATE TYPE	SQ. FT. OPEN	WEIR PERIMETER LINEAL FEET
R-3295	L	2.1	5.8
R-3295	C	2.1	5.8
R-3295	V	2.4	5.8

Standard Grate (shown): Type L.
 Also available with grate Type V or Type C.

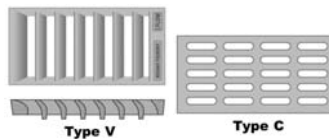

R-3295-2 Double Unit Frame, Grate, Curb Box

Heavy Duty

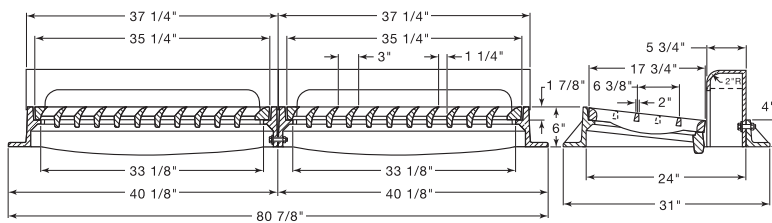

CATALOG NUMBER	GRATE TYPE	SQ. FT. OPEN	WEIR PERIMETER LINEAL FEET
R-3295-2	L	4.2	8.8
R-3295-2	V	4.8	8.8
R-3295-2	C	4.2	8.8
R-3295-2	R	3.8	8.8

Standard Grate (shown): Type L.
 Also available with grate Type R-diagonal, Type C or Type V.

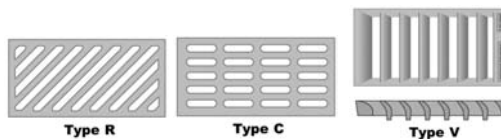

■ Note: When specifying/ordering grates, refer to "Choosing the proper inlet grate" on pages 117-118.
 For a complete listing of FREE OPEN AREAS and WEIR PERIMETERS of all NEENAH grates, refer to pages 306-311.

R-3295-3
Triple Unit Frame, Grate, Curb Box

Heavy Duty

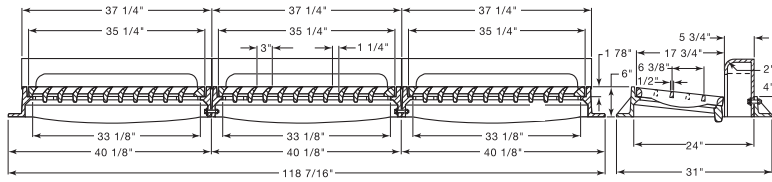

CATALOG NUMBER	GRATE TYPE	SQ. FT. OPEN	WEIR PERIMETER LINEAL FEET
R-3295-3	L	6.3	11.8
R-3295-3	V	7.2	11.8
R-3295-3	C	6.3	11.8
R-3295-3	R	5.7	11.8

Standard Grate (shown): Type L.
 Also available with grate Type C, Type R-diagonal or Type V.

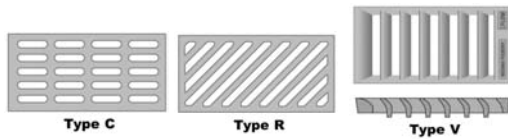

Additional center sections can be added for greater overall length - please specify.

R-3297-1
Combination Inlet Frame, Grate, Curb Box

Heavy Duty

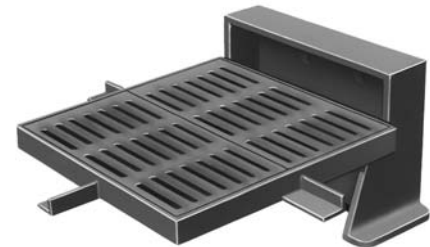
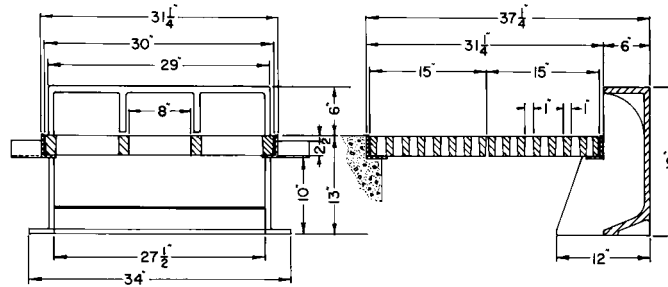

CATALOG NUMBER	GRATE TYPE	SQ. FT. OPEN	WEIR PERIMETER LINEAL FEET
R-3297-1	C	2.3	7.5
R-3297-1	L	2.4	7.5

Standard Grate (shown): Type C.
 Also available with grate Type L.

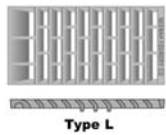

Fabricated steel frame, Gray iron grates and curb box.

COMBINATION
 INLETS
 3

■ Note: When specifying/ordering grates, refer to “Choosing the proper inlet grate” on pages 117-118.
 For a complete listing of FREE OPEN AREAS and WEIR PERIMETERS of all NEENAH grates, refer to pages 306-311.

R-3303
Catch Basin Frame, Lid

Heavy Duty

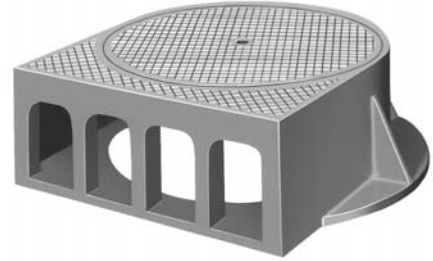
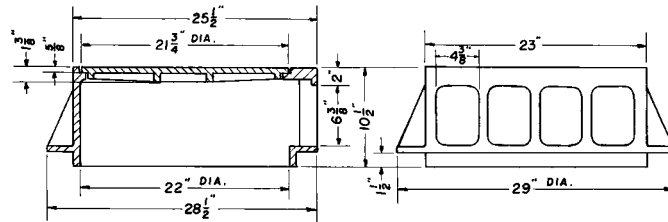

For behind-the-curb construction.

R-3305
Catch Basin Frame, Lid

Heavy Duty

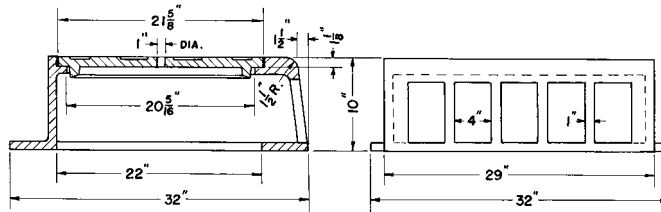

For behind-the-curb construction.

R-3308
Catch Basin Frame, Lid

Heavy Duty

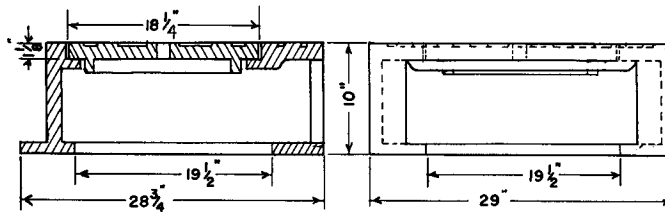

For behind-the-curb construction.

Not recommended for use in areas where large gutter trash objects are prevalent. Curb opening, without gutter grate, allows large trash to enter catch basin and clog lines.

■ Note: When specifying/ordering grates, refer to "Choosing the proper inlet grate" on pages 117-118.
 For a complete listing of FREE OPEN AREAS and WEIR PERIMETERS of all NEENAH grates, refer to pages 306-311.

R-3312-A
Single Catch Basin Frame, Lid

Heavy Duty

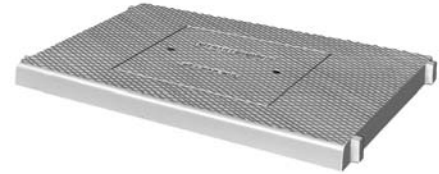
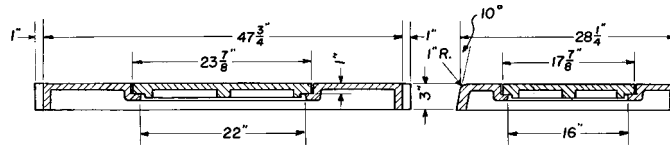

For behind-the-curb construction.
 Not recommended for use in areas where large gutter trash objects are prevalent. Curb opening, without gutter grate, allows large trash to enter catch basin and clog lines.

COMBINATION
 INLETS
 3

R-3312-B
Double Catch Basin Frame, Lid

Heavy Duty

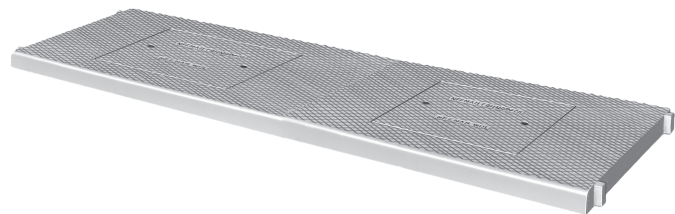
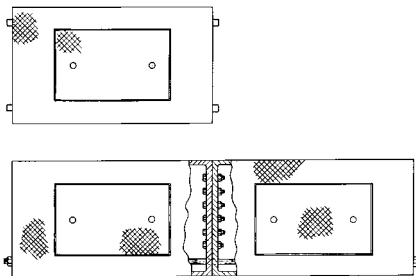

See 3312-A for additional dimensional information.

For behind-the-curb construction.
 Not recommended for use in areas where large gutter trash objects are prevalent.
 Curb opening, without gutter grate, allows large trash to enter catch basin and clog lines.
 Double unit consists of two sections placed end to end with butting joint machine-finished.
 1" steel rod keeps frames tightly together.

R-3313
Catch Basin Frame, Lid

Heavy Duty

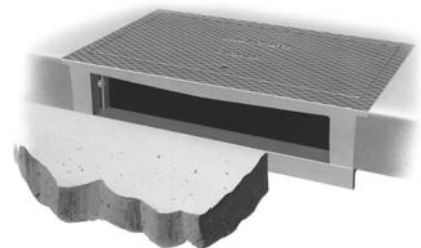
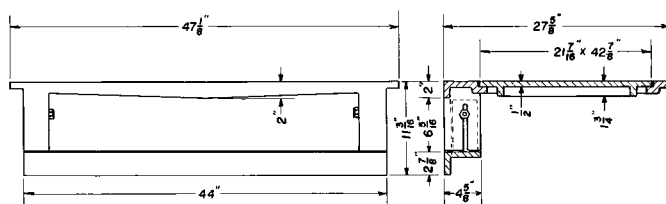

Not recommended for use in areas where large gutter trash objects are prevalent.
 Curb opening, without gutter grate, allows large trash to enter catch basin and clog lines.

■ Note: When specifying/ordering grates, refer to "Choosing the proper inlet grate" on pages 117-118.
 For a complete listing of FREE OPEN AREAS and WEIR PERIMETERS of all NEENAH grates, refer to pages 306-311.

R-3318
Catch Basin Frame, Lid

Heavy Duty

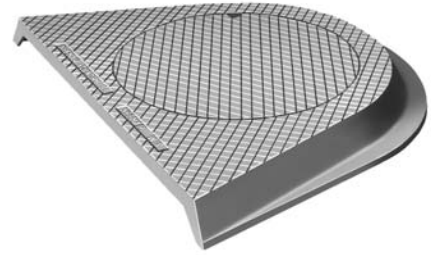
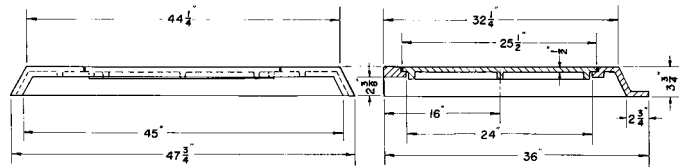

Not recommended for use in areas where large gutter trash objects are prevalent.
 Curb opening, without gutter grate, allows large trash to enter catch basin and clog lines.

R-3323
Inlet with Flat Pan Outlet

Heavy Duty

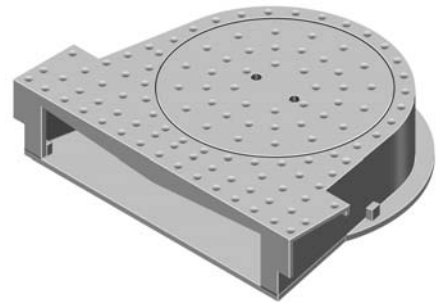
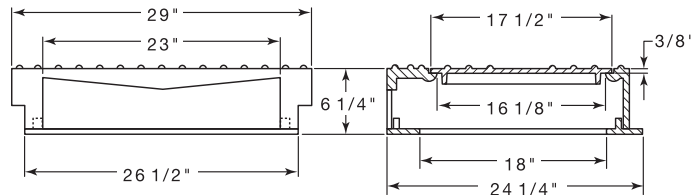

Not recommended for use in areas where large gutter trash objects are prevalent.
 Curb opening, without gutter grate, allows large trash to enter catch basin and clog lines.

R-3323-P
Inlet with Deep Pan Outlet

Heavy Duty

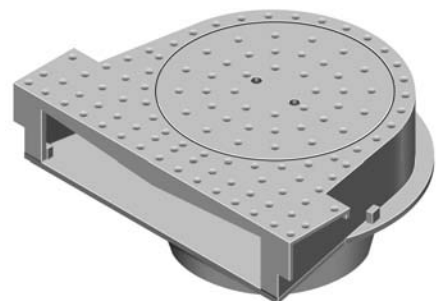
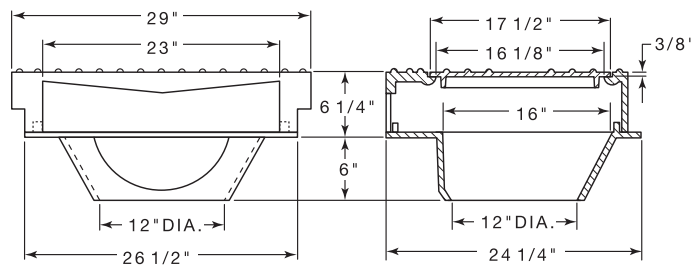

Not recommended for use in areas where large gutter trash objects are prevalent.
 Curb opening, without gutter grate, allows large trash to enter catch basin and clog lines.

■ Note: When specifying/ordering grates, refer to "Choosing the proper inlet grate" on pages 117-118.
 For a complete listing of FREE OPEN AREAS and WEIR PERIMETERS of all NEENAH grates, refer to pages 306-311.

R-3324
Inlet with Flat Pan Outlet

Heavy Duty

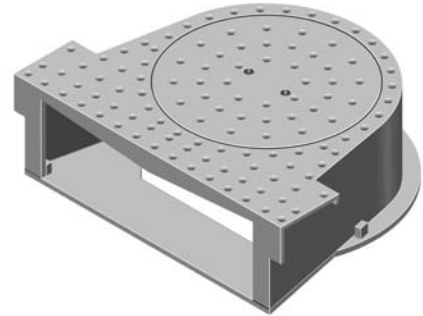
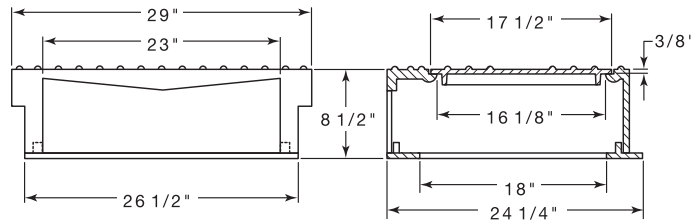

Not recommended for use in areas where large gutter trash objects are prevalent.
 Curb opening, without gutter grate, allows large trash to enter catch basin and clog lines.

COMBINATION
 INLETS
 3

R-3324-P
Inlet with Deep Pan Outlet

Heavy Duty

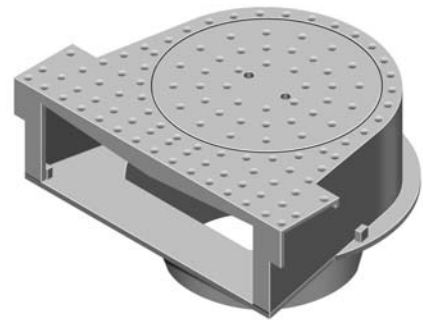
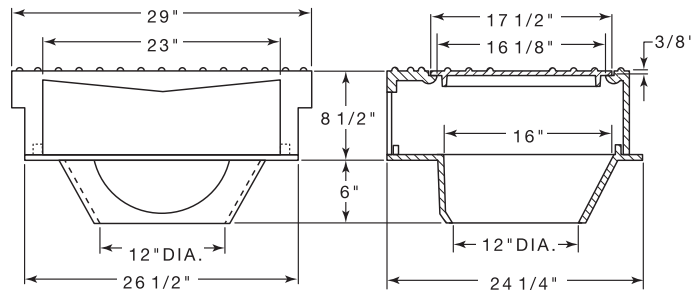

Not recommended for use in areas where large gutter trash objects are prevalent.
 Curb opening, without gutter grate, allows large trash to enter catch basin and clog lines.

R-3326
Large Catch Basin Frame, Lid

Heavy Duty

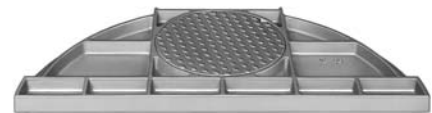
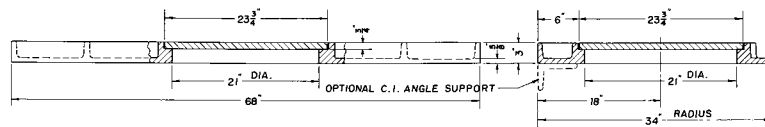

Available with 3" radius curb front, order **R-3326-A**.
 Specify cast iron angle support if required.
 Not recommended for use in areas where large gutter trash objects are prevalent.
 Curb opening, without gutter grate, allows large trash to enter catch basin and clog lines.

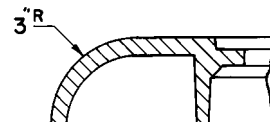

■ Note: When specifying/ordering grates, refer to "Choosing the proper inlet grate" on pages 117-118.
 For a complete listing of FREE OPEN AREAS and WEIR PERIMETERS of all NEENAH grates, refer to pages 306-311.

R-3330 Series
Catch Basin Frame, Lid

Heavy Duty

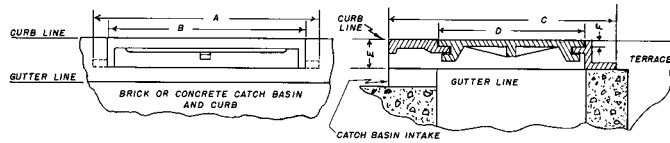

Illustrating R-3330

Not recommended for use in areas where large gutter trash objects are prevalent.
 Curb opening, without gutter grate, allows large trash to enter catch basin and clog lines.

Catalog No.	Dimensions in inches					
	A	B	C	D	E	F
R-3330	34 1/2	30	34	23 1/2	4	1
R-3331	34	30	31 3/4	22 3/4	4	7/8

R-3333-A
Catch Basin Frame, Lid

Heavy Duty

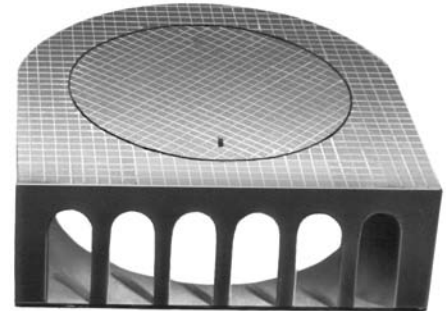
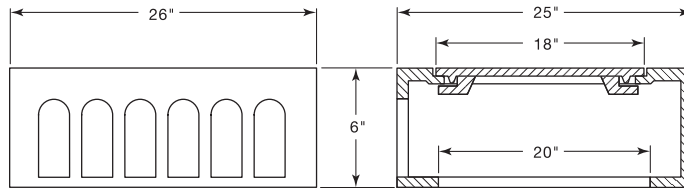

For behind-the-curb construction.
 Lids furnished standard with type "F" locks.
 Openings are 3" x 4-1/2".

R-3334-F
Catch Basin Frame, Lid

Heavy Duty

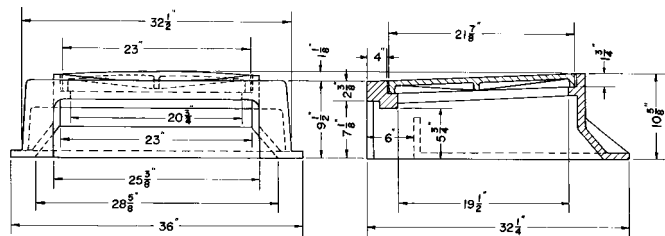

For behind-the-curb construction.
 Not recommended for use in areas where large gutter trash objects are prevalent. Curb opening, without gutter grate, allows large trash to enter catch basin and clog lines.

■ Note: When specifying/ordering grates, refer to "Choosing the proper inlet grate" on pages 117-118.
 For a complete listing of FREE OPEN AREAS and WEIR PERIMETERS of all NEENAH grates, refer to pages 306-311.

R-3335-1
Combination Inlet Gutter Plate, Curb Box, Solid Lid

Heavy Duty

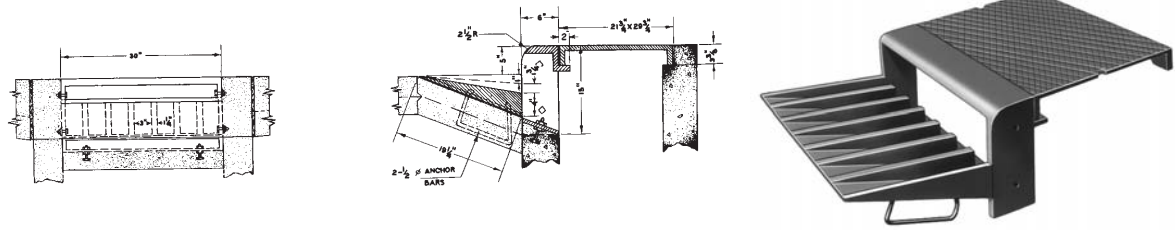

For behind-the-curb construction.
 Has removable cast iron cover.
 Also furnished with curb casting for 10 and 20 foot corner radius in double unit. Used in multiples of 3 or 4 single units for heavy drainage area. Specify when multiples or radius units are required.

COMBINATION
INLETS
3

R-3335-B
Combination Inlet Gutter Plate, Curb Box, Access Frame, Lid

Heavy Duty

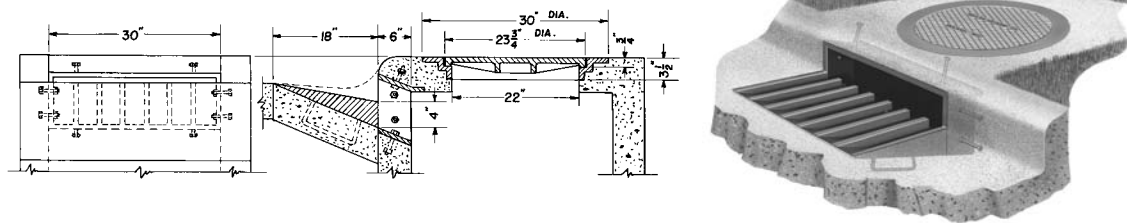

For behind-the-curb construction.
 For heavy drainage areas, can be supplied in multiples of 2, 3 or 4 single units with one catch basin access cover. Specify the number of curb and gutter units required for multiple design.

R-3337-A
Gutter Inlet Frame, Grate

Heavy Duty

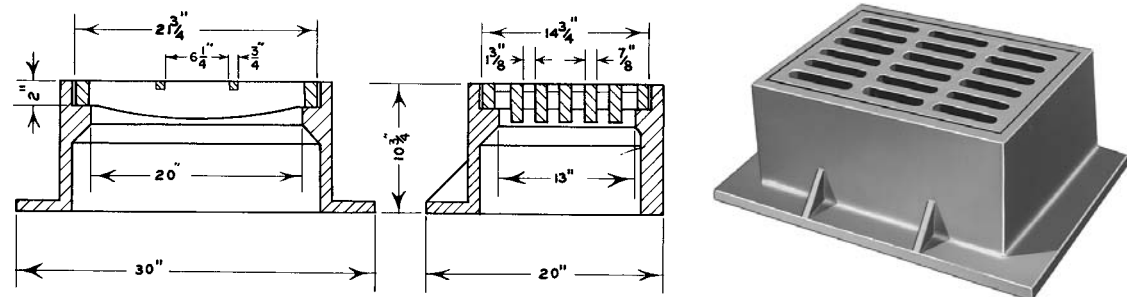

CATALOG NUMBER	GRATE TYPE	SQ. FT. OPEN	WEIR PERIMETER LINEAL FEET
R-3337-A	C	1.1	6.0

■ Note: When specifying/ordering grates, refer to "Choosing the proper inlet grate" on pages 117-118.
 For a complete listing of FREE OPEN AREAS and WEIR PERIMETERS of all NEENAH grates, refer to pages 306-311.

R-3338-F Single Convex Inlet Frame, Grate

Heavy Duty

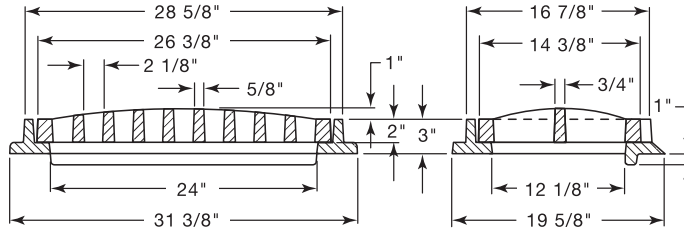

CATALOG NUMBER	GRATE TYPE	SQ. FT. OPEN	WEIR PERIMETER LINEAL FEET
R-3338-F	A	1.4	6.5

Grate reversible if flat top inlet is required.
 Four wall frame is also available.

R-3338-G Single Convex Inlet Frame, Double Grate

Light Duty

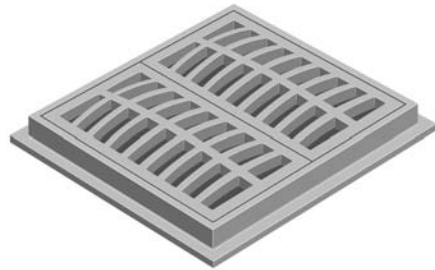
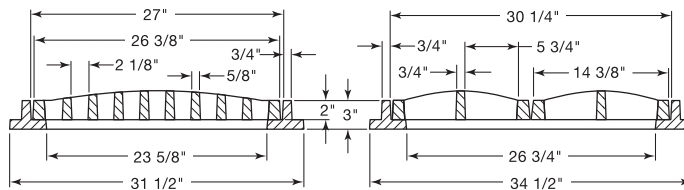

CATALOG NUMBER	GRATE TYPE	SQ. FT. OPEN	WEIR PERIMETER LINEAL FEET
R-3338-G	A	2.8	9.5

Grate reversible if flat top inlet is required.

R-3339 Catch Basin Inlet Frame, Grate

Heavy Duty

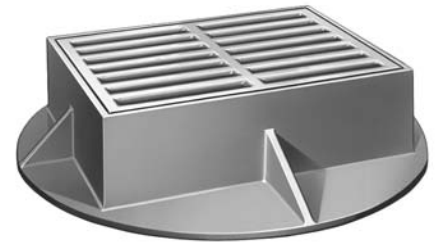
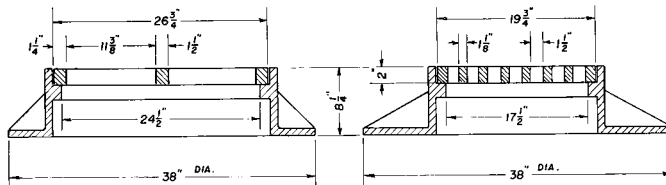

CATALOG NUMBER	GRATE TYPE	SQ. FT. OPEN	WEIR PERIMETER LINEAL FEET
R-3339	C	1.6	7.8
R-3339-1	C	1.4	7.8

Alternate grate available (1-1/2" x 4-15/16" slots), order as R-3339-1.

R-3339-A Catch Basin Inlet Frame, Grate

Heavy Duty

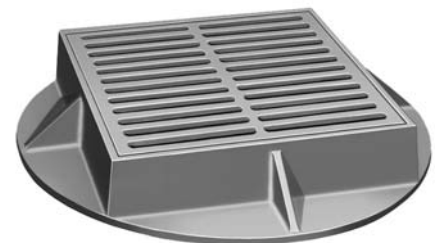
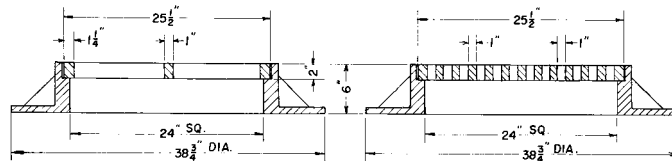

CATALOG NUMBER	GRATE TYPE	SQ. FT. OPEN	WEIR PERIMETER LINEAL FEET
R-3339-A	A or C	1.8	8.5

■ Note: When specifying/ordering grates, refer to “Choosing the proper inlet grate” on pages 117-118.
 For a complete listing of FREE OPEN AREAS and WEIR PERIMETERS of all NEENAH grates, refer to pages 306-311.

R-3340 Series Slab-Type Frame, Grate with Anchor Flange

Heavy Duty

CATALOG NUMBER	GRATE TYPE	SQ. FT. OPEN	WEIR PERIMETER LINEAL FEET
R-3340-B	C	1.3	6.8
R-3340-D	C	1.2	7.5

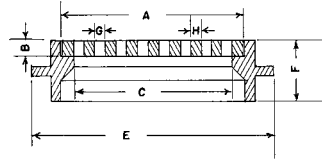

Catalog No.	Dimensions in inches							
	A	B	C	D	E	F	G	H
R-3340-B	17 1/4 x 23 3/4	2	15 1/8 x 22	17 1/2 x 24	23 1/2 x 30	5	2 x 6	1 1/8
R-3340-D	20 x 25	2	18 x 23	20 x 25	26 x 31	5	1 1/2 x 4 3/4	1 5/8

R-3341 to R-3351 Series Concave Gutter Inlet Frame, Grate

Heavy Duty

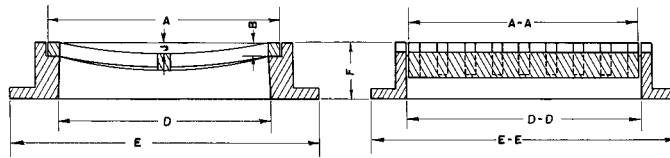

CATALOG NUMBER	GRATE TYPE	SQ. FT. OPEN	WEIR PERIMETER LINEAL FEET
R-3341	K	0.3	3.2
R-3342	K	0.5	4.4
R-3344	K	1.1	6.2
R-3345	K	1.1	6.8
R-3346	C	1.4	8.9
R-3347	K	1.3	7.4
R-3347-A	K	2.3	10.4
R-3348	A	1.9	8.0
R-3349-A	K	1.8	7.7
R-3350	K	2.2	9.3
R-3351	C	2.7	9.3

Catalog No.	Dimensions in inches								
	A	A-A	B	D	D-D	E	E-E	F	J
R-3341	7 1/2	11 1/2	1 1/2	8	11 1/2	15 1/2	19	6	3/4
R-3342 *	11 1/2	15	1	10	15	30	-	9 1/2	1
R-3344 **	13	24	2	13	24	23	34	9 1/2	1
R-3345	15	26	1 1/2	12	26	20	34	6	1 1/2
R-3346	15	38 1/2	1 1/4	16 1/2	40	23	47	7 1/2	1
R-3347	22 1/4	22 1/4	2 1/2	20 1/8	20 1/8	36	Dia.	8	1/2
R-3347-A	22 7/8	39 5/8	2	18 1/2	35 1/4	29 3/4	46 1/2	6	1
R-3348	24	24	2	26 1/2	26 1/2	35	35	7	1
R-3349-A	18	28	2 1/4	16	26	25	35	4 1/2	3/4
R-3350	28	28	1 3/4	29	29	35	35	6	1 3/8
R-3351 ***	28	28	1 1/2	29	29	35	35	6	1 3/4

* Only available with 30" diameter base flange.

** Furnished with openings parallel with gutter.

*** Grate supported by lugs.

COMBINATION
INLETS
3

■ Note: When specifying/ordering grates, refer to "Choosing the proper inlet grate" on pages 117-118.
 For a complete listing of FREE OPEN AREAS and WEIR PERIMETERS of all NEENAH grates, refer to pages 306-311.

R-3356-A
Concave Gutter Inlet Frame, Grate

Heavy Duty

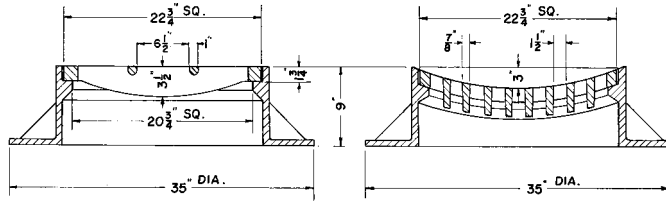

CATALOG NUMBER	GRATE TYPE	SQ. FT. OPEN	WEIR PERIMETER LINEAL FEET
R-3356-A	C	1.5	7.6

R-3357-A
Concave Gutter Inlet Frame, Grate

Heavy Duty

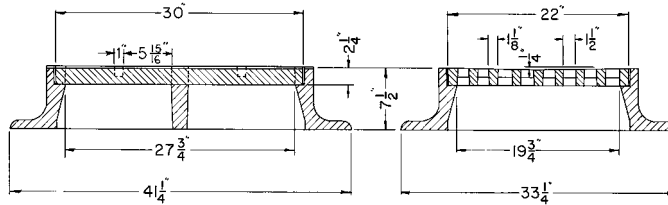

CATALOG NUMBER	GRATE TYPE	SQ. FT. OPEN	WEIR PERIMETER LINEAL FEET
R-3357-A	C	2.0	8.7

R-3359
Concave Gutter Inlet Frame, Grate

Heavy Duty

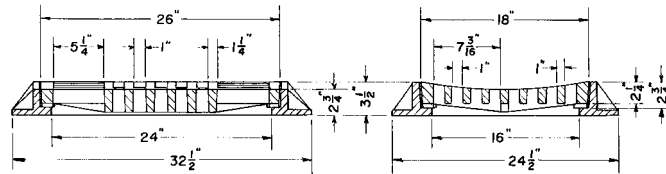

CATALOG NUMBER	GRATE TYPE	SQ. FT. OPEN	WEIR PERIMETER LINEAL FEET
R-3359	K	1.1	7.3

R-3360-A
Single Valley Gutter Inlet Frame, Grate

Heavy Duty

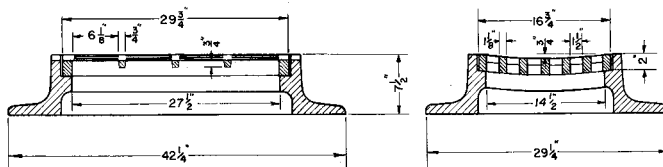

Standard Grate (shown): Type C.
 Also available with grate Type D.

CATALOG NUMBER	GRATE TYPE	SQ. FT. OPEN	WEIR PERIMETER LINEAL FEET
R-3360-A	C	1.6	7.8
R-3360-A	D	1.7	7.8

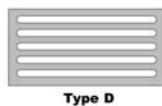

■ Note: When specifying/ordering grates, refer to "Choosing the proper inlet grate" on pages 117-118.
 For a complete listing of FREE OPEN AREAS and WEIR PERIMETERS of all NEENAH grates, refer to pages 306-311.

R-3361 Double Valley Gutter Inlet Frame, Grate

Heavy Duty

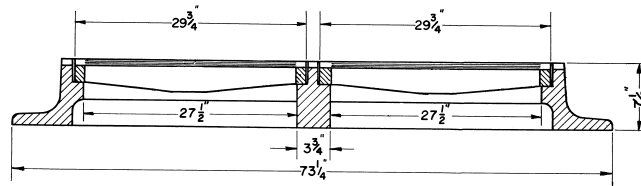

CATALOG NUMBER	GRATE TYPE	SQ. FT. OPEN	WEIR PERIMETER LINEAL FEET
R-3361	K	3.4	12.7
R-3361	C	3.2	12.7

Standard Grate (shown): Type D.
 Also available with grate Type C.

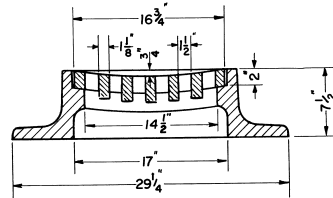

Type C

R-3362 Concave Gutter Inlet Frame, Grate

Light Duty

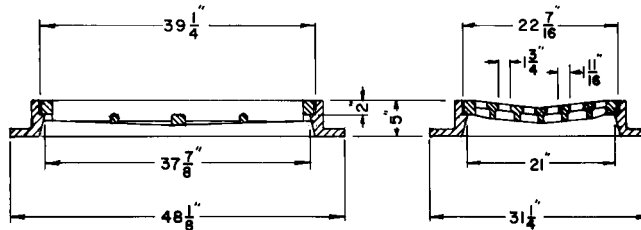

CATALOG NUMBER	GRATE TYPE	SQ. FT. OPEN	WEIR PERIMETER LINEAL FEET
R-3362	C	2.3	10.3

R-3362-1 Concave Gutter Inlet Frame, Grate, Curb Box

Light Duty

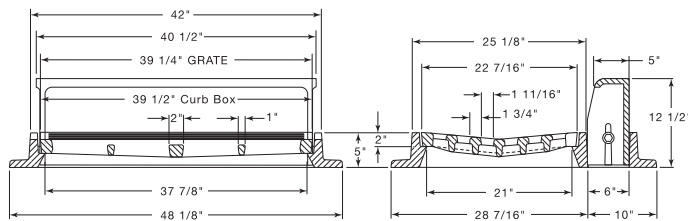

CATALOG NUMBER	GRATE TYPE	SQ. FT. OPEN	WEIR PERIMETER LINEAL FEET
R-3362-1	C	2.3	7.0
R-3362-1	L	2.9	7.0

Standard Grate (shown): Type C.
 Also available with grate Type L.

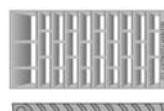

Type L

■ Note: When specifying/ordering grates, refer to "Choosing the proper inlet grate" on pages 117-118.
 For a complete listing of FREE OPEN AREAS and WEIR PERIMETERS of all NEENAH grates, refer to pages 306-311.

R-3362-L
Concave Gutter Inlet Frame, Grate

Heavy Duty

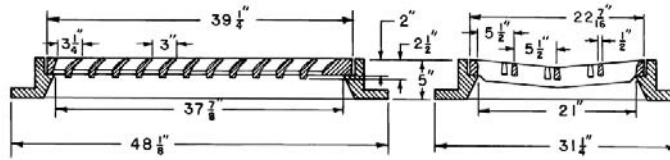

CATALOG NUMBER	GRATE TYPE	SQ. FT. OPEN	WEIR PERIMETER LINEAL FEET
R-3362-L	L	2.9	10.3

Can be furnished as double unit with side flanges removed as shown in R-3363-1.

R-3363-1
Double Unit Inlet Frame, Grate, Curb Box

Light Duty

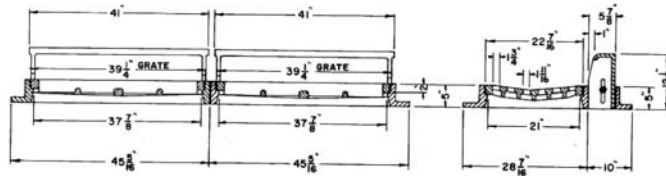

CATALOG NUMBER	GRATE TYPE	SQ. FT. OPEN	WEIR PERIMETER LINEAL FEET
R-3363-1	C	4.6	10.3
R-3363-1	L	5.8	10.3

Standard Grate (shown): Type C.
 Type L grate available.

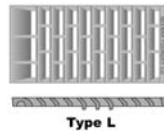

R-3381
Concave Gutter Inlet Frame, Grate

Heavy Duty

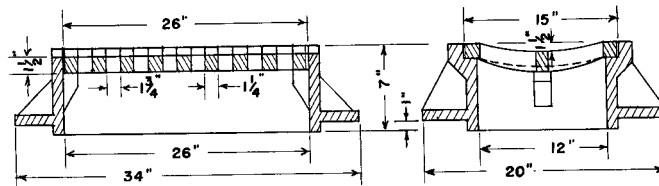

CATALOG NUMBER	GRATE TYPE	SQ. FT. OPEN	WEIR PERIMETER LINEAL FEET
R-3381	A	1.0	6.8

R-3382
Concave Gutter Inlet Frame, Grate

Heavy Duty

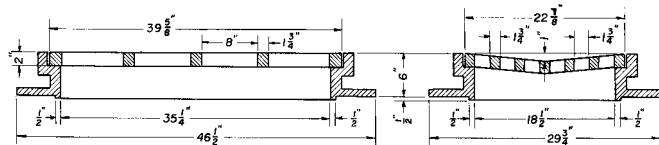

CATALOG NUMBER	GRATE TYPE	SQ. FT. OPEN	WEIR PERIMETER LINEAL FEET
R-3382	C	2.3	10.4

■ Note: When specifying/ordering grates, refer to "Choosing the proper inlet grate" on pages 117-118.
 For a complete listing of FREE OPEN AREAS and WEIR PERIMETERS of all NEENAH grates, refer to pages 306-311.

R-3393-A
Concave Gutter Inlet Frame, Grate

Heavy Duty

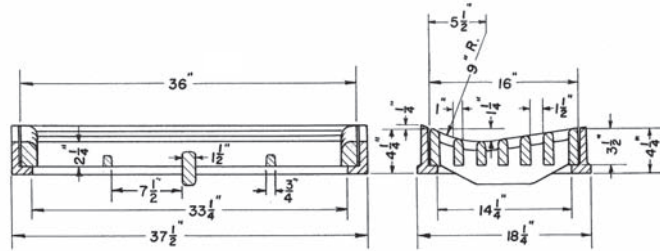

Grates are bolted to frame.

CATALOG NUMBER	GRATE TYPE	SQ. FT. OPEN	WEIR PERIMETER LINEAL FEET
R-3393-A	C	2.0	8.7

R-3396
Concave Gutter Inlet Frame, Grate

Heavy Duty

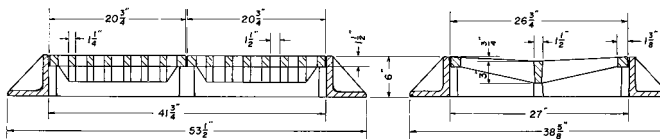

CATALOG NUMBER	GRATE TYPE	SQ. FT. OPEN	WEIR PERIMETER LINEAL FEET
R-3396	C	3.2	11.4

R-3397
Gutter Inlet Frame, Grate

Heavy Duty

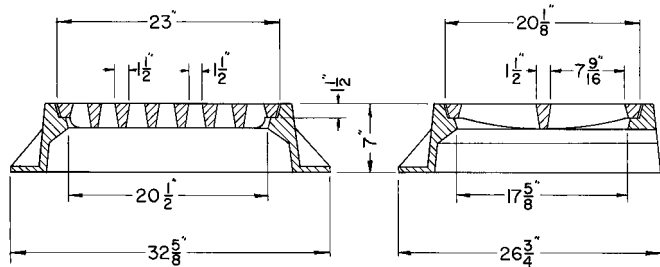

Note opening at rear of frame.

CATALOG NUMBER	GRATE TYPE	SQ. FT. OPEN	WEIR PERIMETER LINEAL FEET
R-3397	A	1.1	7.2

R-3401 Series
Gutter Inlet Frame, Grate

Heavy Duty

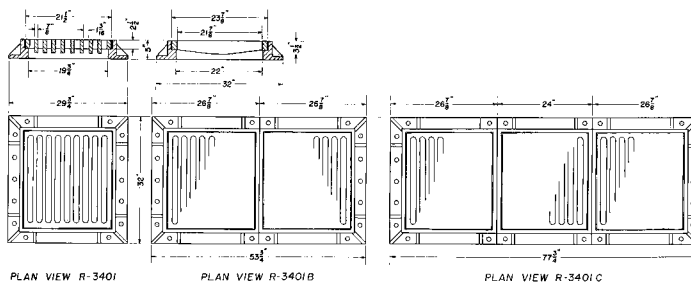

Illustrating R-3401

Catalog No.	No. of grates	CATALOG NUMBER	GRATE TYPE	SQ. FT. OPEN	WEIR PERIMETER LINEAL FEET
R-3401	single grate	R-3401	D	1.9	7.6
R-3401-B	double grate	R-3401-B	B	3.8	11.2
R-3401-C	triple grate	R-3401-C	B	5.7	14.7

COMBINATION
 INLETS
 3

■ Note: When specifying/ordering grates, refer to "Choosing the proper inlet grate" on pages 117-118.
 For a complete listing of FREE OPEN AREAS and WEIR PERIMETERS of all NEENAH grates, refer to pages 306-311.

R-3402 to R-3403 Series Gutter Inlet Frame, Grate

Heavy Duty

CATALOG NUMBER	GRATE TYPE	SQ. FT. OPEN	WEIR PERIMETER LINEAL FEET
R-3402	H	0.4	4.0
R-3402-E	A or C	2.1	8.0
R-3403	A	1.1	6.5

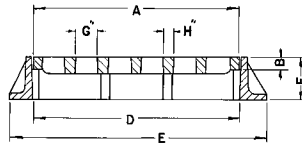

Illustrating R-3402-E

Catalog No.	Dimensions in inches						
	A	B	D	E	F	G	H
Square							
R-3402	11 7/8 x 11 7/8	1 1/8	11 7/8 x 11 7/8	17 x 17	4	1 1/2 x 1 1/2	5/8
R-3402-E	24 x 24	1 1/2	24 x 24	29 3/4 x 29 3/4	5	2 5/8 x 6 1/2	1
Rectangular							
R-3403	16 3/4 x 22 1/4	1 13/16	16 3/4 x 22 1/4	25 x 30 3/8	5 7/8	1 7/8 x 4 1/16	1

R-3403-A1 Gutter Inlet Frame, Grate

Heavy Duty

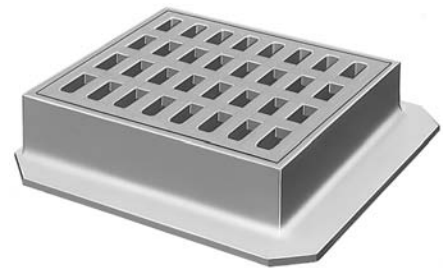
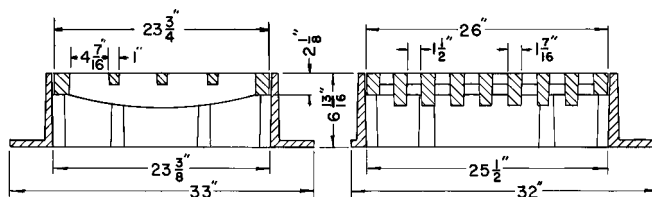

CATALOG NUMBER	GRATE TYPE	SQ. FT. OPEN	WEIR PERIMETER LINEAL FEET
R-3403-A1	A	1.5	8.3

R-3403-F Gutter Inlet Frame, Grate

Heavy Duty

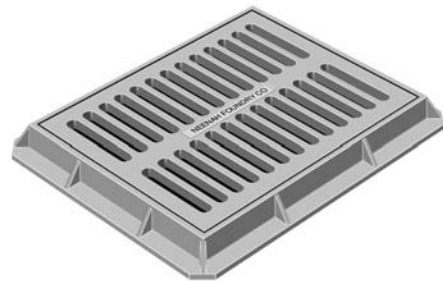
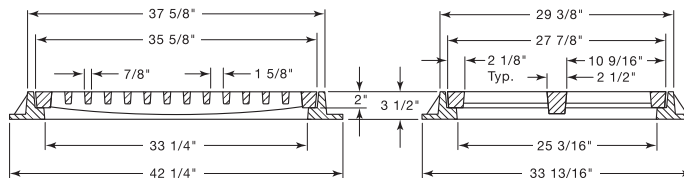

CATALOG NUMBER	GRATE TYPE	SQ. FT. OPEN	WEIR PERIMETER LINEAL FEET
R-3403-F	A	3.2	10.6

■ Note: When specifying/ordering grates, refer to "Choosing the proper inlet grate" on pages 117-118.
 For a complete listing of FREE OPEN AREAS and WEIR PERIMETERS of all NEENAH grates, refer to pages 306-311.

R-3404 to R-3405 Series Gutter Inlet Frame, Grate

Heavy Duty

CATALOG NUMBER	GRATE TYPE	SQ. FT. OPEN	WEIR PERIMETER LINEAL FEET
R-3404	H	1.4	7.2
R-3405	H	1.5	7.9
R-3405-A	H	1.3	8.0
R-3405-A	L	1.5	8.0
R-3405-B	H	1.3	8.0
R-3405-B	L	1.5	8.0

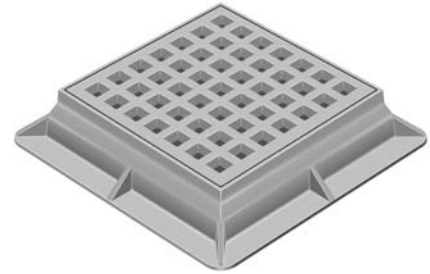
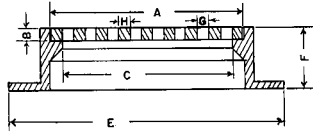

Illustrating R-3405

Catalog No.	Dimensions in inches						
	A	B	C	E	F	G	H
R-3404	21 1/2 x 21 1/2	1 1/2	20 1/8 x 20 1/8	30 5/8 x 30 5/8	5 1/8	2 x 2	15/16
R-3405	23 5/8 x 23 5/8	1 1/2	22 x 22	32 3/4 x 32 3/4	6	2 1/8 x 2 1/8	1
R-3405-A **	23 7/8 x 23 7/8	2	22 x 22	32 1/8 x 32 1/8	6 1/8	2 1/4 x 2 1/4	1 7/16
R-3405-B * **	23 7/8 x 23 7/8	2	22 x 22	32 1/8 x 29	6 1/8	2 1/4 x 2 1/4	1 7/16

* Same as R-3405-A except base flange on 3 sides only.

** Also available grate Type L.

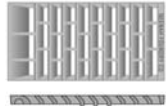

Type L

R-3406 Single Gutter Inlet Frame, Grate

Heavy Duty

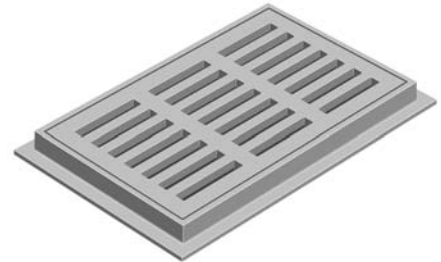
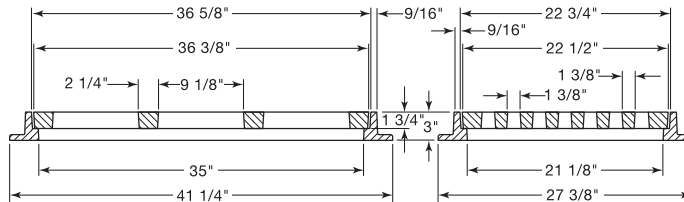

CATALOG NUMBER	GRATE TYPE	SQ. FT. OPEN	WEIR PERIMETER LINEAL FEET
R-3406	C	1.8	9.8
R-3406-2	C	3.7	15.9

Double unit available with 27 3/8" x 79" outside frame dimension, order **R-3406-2**.

COMBINATION
INLETS
3

■ Note: When specifying/ordering grates, refer to "Choosing the proper inlet grate" on pages 117-118.
 For a complete listing of FREE OPEN AREAS and WEIR PERIMETERS of all NEENAH grates, refer to pages 306-311.

R-3406-A
Single Gutter Inlet Frame, Grate

Heavy Duty

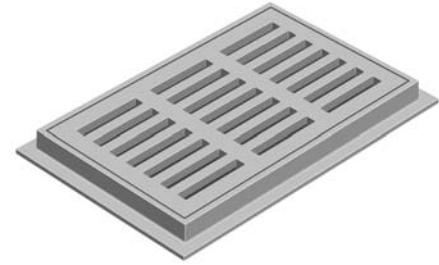
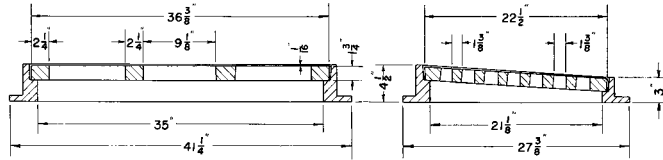

CATALOG NUMBER	GRATE TYPE	SQ. FT. OPEN	WEIR PERIMETER LINEAL FEET
R-3406-A	C	1.8	9.8
R-3406-A2	C	3.7	15.9

Note sloping top.
 Double unit available with 27 3/8" x 79" outside frame dimension, order **R-3406-A2**.

R-3408-AL
Double Gutter Inlet Frames, Grates

Heavy Duty

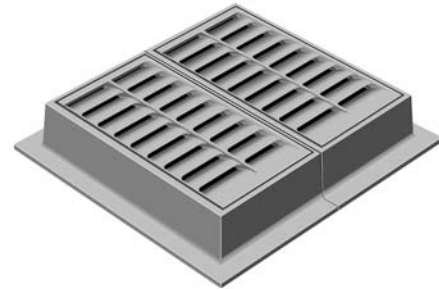
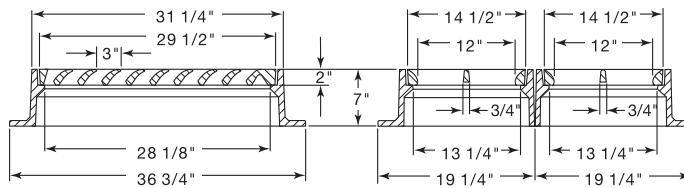

CATALOG NUMBER	GRATE TYPE	SQ. FT. OPEN	WEIR PERIMETER LINEAL FEET
R-3408-AL	L	2.4	9.7

R-3408-BL
Double Gutter Inlet Frames, Grates

Heavy Duty

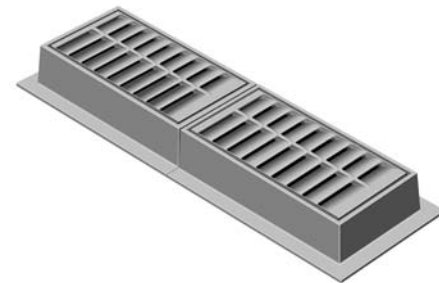
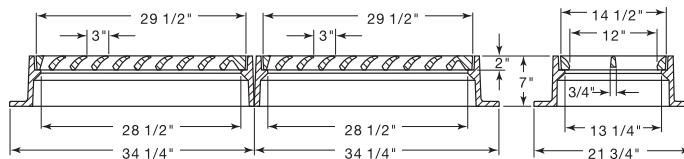

CATALOG NUMBER	GRATE TYPE	SQ. FT. OPEN	WEIR PERIMETER LINEAL FEET
R-3408-BL	L	2.4	12.5

R-3408-L
Single Gutter Inlet Frame, Grate

Heavy Duty

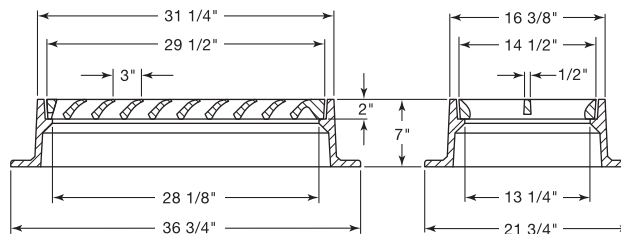

CATALOG NUMBER	GRATE TYPE	SQ. FT. OPEN	WEIR PERIMETER LINEAL FEET
R-3408-L	L	1.2	7.3

■ Note: When specifying/ordering grates, refer to "Choosing the proper inlet grate" on pages 117-118.
 For a complete listing of FREE OPEN AREAS and WEIR PERIMETERS of all NEENAH grates, refer to pages 306-311.

R-3409 Gutter Inlet Frame, Grate

Heavy Duty

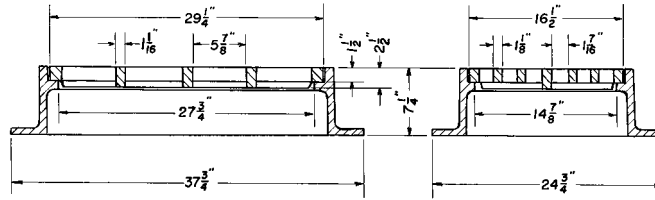

CATALOG NUMBER	GRATE TYPE	SQ. FT. OPEN	WEIR PERIMETER LINEAL FEET
R-3409	C	1.5	7.6

R-3413 to R-3416 Series Long Gutter Inlet Frame, Grate

Heavy Duty

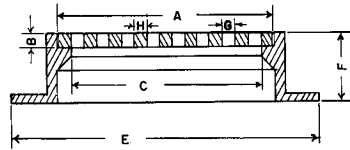

CATALOG NUMBER	GRATE TYPE	SQ. FT. OPEN	WEIR PERIMETER LINEAL FEET
R-3413	C	1.5	9.0
R-3415	A	4.1	13.5
R-3416	A	1.4	9.8

Dimensions in inches

Catalog No.	A	B	C	E	F	G	H
R-3413	18 x 36	2	16 x 34	28 x 46	7	1 3/4 x 6 1/4	1 1/4
R-3415 *	23 x 58	1	21 x 56	35 x 70	8 1/2	1 x 8	1
R-3416	23 1/2 x 35 1/2	2	22 x 33	34 x 46	6 1/4	2 x 9 3/4	1 1/4

* Grate in two sections.

R-3420 Track and Bridge Drain Frame, Grate

Heavy Duty

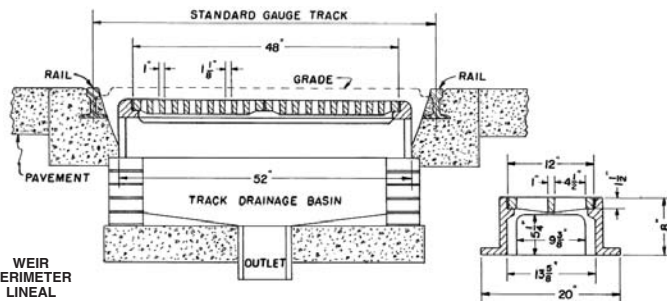

CATALOG NUMBER	GRATE TYPE	SQ. FT. OPEN	WEIR PERIMETER LINEAL FEET
R-3420	A	1.2	10.0

R-3423 Track and Bridge Drain Frame, Grate

Heavy Duty

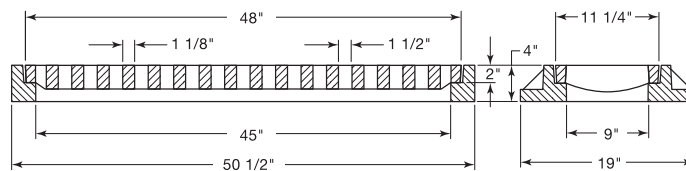

CATALOG NUMBER	GRATE TYPE	SQ. FT. OPEN	WEIR PERIMETER LINEAL FEET
R-3423	B	1.6	9.9

COMBINATION
INLETS
3

■ Note: When specifying/ordering grates, refer to "Choosing the proper inlet grate" on pages 117-118.
 For a complete listing of FREE OPEN AREAS and WEIR PERIMETERS of all NEENAH grates, refer to pages 306-311.

R-3425-A Single Flange Gutter Inlet Frame, Double Grate

Heavy Duty

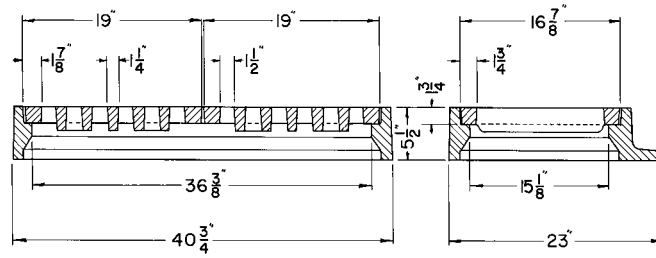

Standard Grate (shown): Type K.
 Also available with grate Type L.

CATALOG NUMBER	GRATE TYPE	SQ. FT. OPEN	WEIR PERIMETER LINEAL FEET
R-3425-A	K	2.1	9.4
R-3425-A	L	2.3	9.4

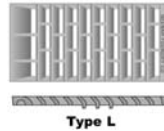

R-3425-B Double Flange Gutter Inlet Frame, Double Grate

Heavy Duty

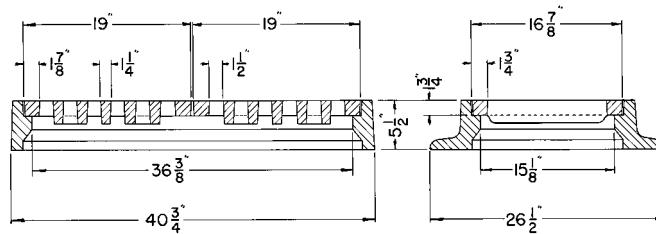

Standard Grate (shown): Type K.
 Also available with grate Type L.

CATALOG NUMBER	GRATE TYPE	SQ. FT. OPEN	WEIR PERIMETER LINEAL FEET
R-3425-B	K	2.1	9.4
R-3425-B	L	2.3	9.4

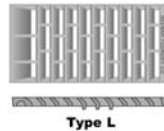

R-3429 to R-3438 Series Square and/or Round Gutter Inlet Frame, Grate

Heavy Duty

CATALOG NUMBER	GRATE TYPE	SQ. FT. OPEN	WEIR PERIMETER LINEAL FEET
R-3429-A	A or C	1.0	6.0
R-3430	A or C	0.9	6.6
R-3433	A or C	1.5	8.0
R-3433	L	1.6	7.9
R-3437	A or C	3.3	12.0
R-3438-A	A or C	7.0	16.6

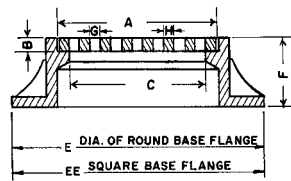

Illustrating R-3430

Catalog No.	Dimensions in inches							
	A	B	C	E	EE	F	G	H
R-3429-A	18 x 18	1 1/2	16 1/4 x 16 1/4	30" Dia	-	6	2 1/4 x 4 1/4	1
R-3430	20 x 20	1 3/4	18 x 18	36" Dia	31 x 31	5	1 3/8 x 3 1/2	1 1/4
R-3433 **	24 x 24	2	22 x 22	38" Dia	35 x 35	6	1 3/4 x 6	1 3/8
R-3437 *	36 x 36	1 3/4	34 x 34	-	45 x 45	7	2 x 4	1 3/8
R-3438-A *	50 x 50	1 3/4	48 x 48	-	59 x 59	8	1 1/2 x 6 1/4	1 1/8

* Grate furnished in two pieces.

** Also available with grates A/C or Type L.

■ Note: When specifying/ordering grates, refer to "Choosing the proper inlet grate" on pages 117-118.
 For a complete listing of FREE OPEN AREAS and WEIR PERIMETERS of all NEENAH grates, refer to pages 306-311.

R-3448 to R-3457 Series Rectangular Gutter Inlet Frame, Grate

Heavy Duty

CATALOG NUMBER	GRATE TYPE	SQ. FT. OPEN	WEIR PERIMETER LINEAL FEET
R-3448-B	A	1.1	6.8
R-3448-C	C	0.9	6.8
R-3448-D	S	1.2	6.8
R-3449	A	0.9	6.8
R-3451	C	1.5	7.3
R-3451-B	C	1.7	7.8
R-3454	A	4.1	13.2
R-3454-B	D	2.5	9.9

CATALOG NUMBER	GRATE TYPE	SQ. FT. OPEN	WEIR PERIMETER LINEAL FEET
R-3454-BL	L	3.1	7.0
R-3454-C	C	2.9	13.2
R-3455-A	A	2.6	9.8
R-3455-C	A	2.6	10.0
R-3457-C2	A	6.0	14.0

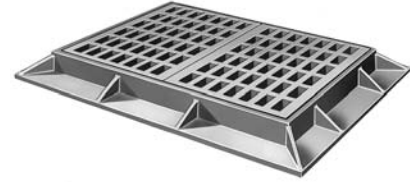
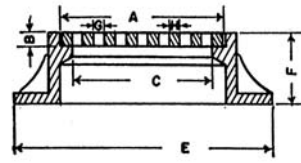

Catalog No.	A	B	C	E	F	G	H
R-3448-B	17 3/4 x 22 3/4	1 3/4	***	23 3/4 x 32	6 3/4	1 5/8 x 3 1/4	1 1/8
R-3448-C	17 3/4 x 22 3/4	1 3/4	***	34	6 3/4	1 1/2 x 3	1 1/4
R-3448-D **	17 3/4 x 22 3/4	1 3/4	***	34	6 3/4	1 1/2 x 5 3/8	1
R-3449	18 x 23	2	***	24 x 29	5	1 1/4 x 7	1 1/8
R-3451	18 x 36	2	16 x 34	28 x 46	7	1 3/4 x 6 1/4	1 1/4
R-3451-B	19 3/4 x 26 3/4	2	17 1/2 x 24 1/2	38	8 1/4	1 1/2 x 11 3/8	1 1/2
R-3454 *	22 5/8 x 56 3/4	1	21 x 56	35 x 70	8 1/2	1 x 6 1/4	1
R-3454-B	23 3/4 x 35 7/8	2	21 3/4 x 33 3/8	31 x 45	6 1/2	1 x 32 3/8	1
R-3454-BL §	23 3/4 x 35 7/8	2	21 3/4 x 33 3/8	31 x 45	6 1/2		1
R-3454-C	23 3/4 x 35 7/8	2	21 3/4 x 33 3/8	31 x 45	6 1/2	1 3/4 x 6 1/2	1 1/4
R-3455-A	23 1/2 x 35 1/2	2	22 x 33	34 x 46	6 1/4	2 x 9 3/4	1 1/4
R-3455-C	24 x 36	1 3/4	22 x 34	36 x 48	9	1 3/4 x 6	1
R-3457-C2 ¥	36 x 48	1 3/4	***	42 x 54	5 1/2	1 7/8 x 21 3/8	1 1/4

* Grate in two sections.

** Sinusoidal style (Type S) grate.

*** Frames provided with lugs supporting grates at corners.

¥ Frame and Grate furnished in two pieces. Frame with center support bar.

§ Vane style (Type L) grate.

R-3460 Series Special Gutter Inlet Frame, Grate

Heavy Duty

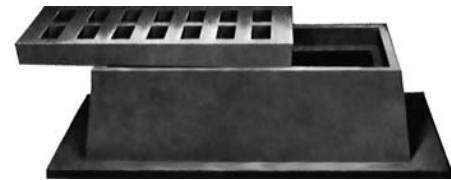
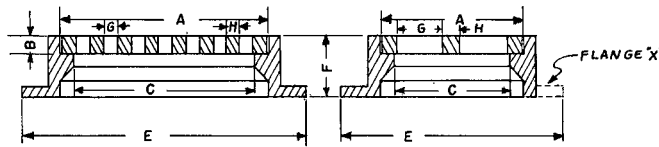

Illustrating R-3460-D

CATALOG NUMBER	GRATE TYPE	SQ. FT. OPEN	WEIR PERIMETER LINEAL FEET
R-3460-A	A	0.8	6.0
R-3460-A	C	1.1	6.0
R-3460-D	A	0.8	6.0
R-3460-D	C	0.8	6.0

Type A grate furnished, Type C available on request.

Catalog No.	A	B	C	E	F	G	H
R-3460-A	14 1/2 x 21 1/2	2	13 x 20	23 x 30	5 1/2	1 21/32 x 5 11/32	1 1/4
R-3460-D *	14 1/2 x 21 1/2	2	13 x 20	20 x 30	10 1/2	1 21/32 x 5 11/32	1 1/4

* Flange "x" removed making 3-flange inlet.



Type C

R-3461 3-Flange Gutter Inlet Frame, Grate

Heavy Duty

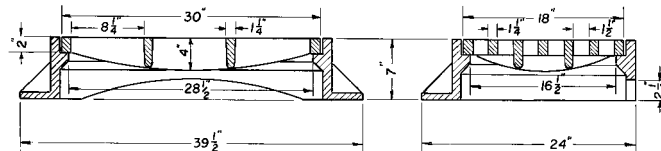

CATALOG NUMBER	GRATE TYPE	SQ. FT. OPEN	WEIR PERIMETER LINEAL FEET
R-3461	C	1.5	8.0

■ Note: When specifying/ordering grates, refer to "Choosing the proper inlet grate" on pages 117-118.
 For a complete listing of FREE OPEN AREAS and WEIR PERIMETERS of all NEENAH grates, refer to pages 306-311.

R-3462-B Single Gutter Inlet Frame, Grate

Heavy Duty

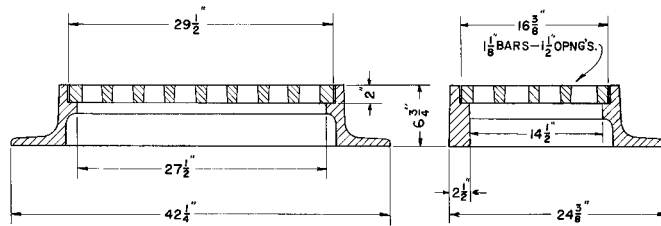

CATALOG NUMBER	GRATE TYPE	SQ. FT. OPEN	WEIR PERIMETER LINEAL FEET
R-3462-B	R	1.8	7.6

R-3463-B Double Gutter Inlet Frames, Grates

Heavy Duty

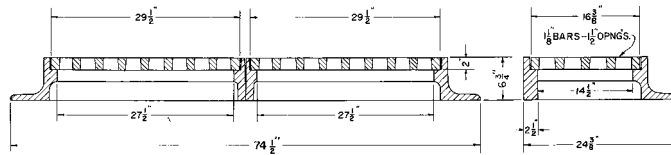

CATALOG NUMBER	GRATE TYPE	SQ. FT. OPEN	WEIR PERIMETER LINEAL FEET
R-3463-B	R	3.5	12.6

R-3465 Gutter Inlet Frame, Grate

Heavy Duty

CATALOG NUMBER	GRATE TYPE	SQ. FT. OPEN	WEIR PERIMETER LINEAL FEET
R-3465	A	0.8	6.0
R-3465	C	1.1	6.0

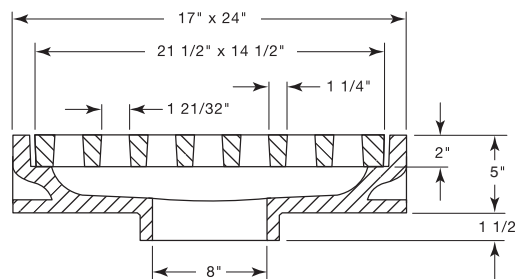

Standard Grate (shown): Type A.
 Also available with grate Type C.



Type C

R-3466-A Gutter Inlet Frame, Grate

Heavy Duty

CATALOG NUMBER	GRATE TYPE	SQ. FT. OPEN	WEIR PERIMETER LINEAL FEET
R-3466-A	A	0.8	6.0
R-3466-A	C	0.8	6.0

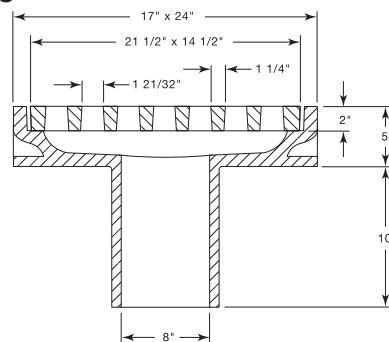

Standard Grate (shown): Type A.
 Also available with grate Type C.



Type C

■ Note: When specifying/ordering grates, refer to "Choosing the proper inlet grate" on pages 117-118.
 For a complete listing of FREE OPEN AREAS and WEIR PERIMETERS of all NEENAH grates, refer to pages 306-311.

R-3469
Gutter Inlet Frame, Grate

Heavy Duty

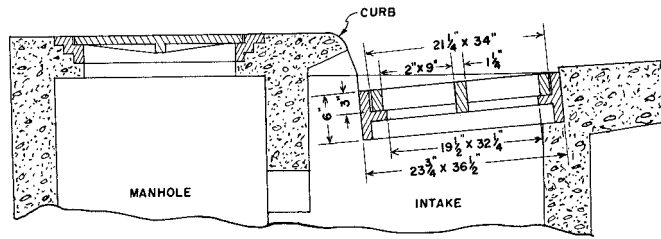

CATALOG NUMBER	GRATE TYPE	SQ. FT. OPEN	WEIR PERIMETER LINEAL FEET
R-3469	A	2.7	9.2

The drawing shows one method of installing as a combination intake and manhole. The cleanout manhole listed under Neenah R-6040 is not furnished as part of this combination and should be ordered separately.

When increased drainage is required, two or more inlets are placed end to end in combinations over large basins or trench drains.

R-3469-E2
Gutter Inlet Frame, Grate

Heavy Duty

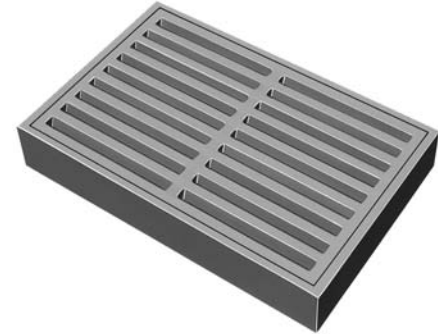
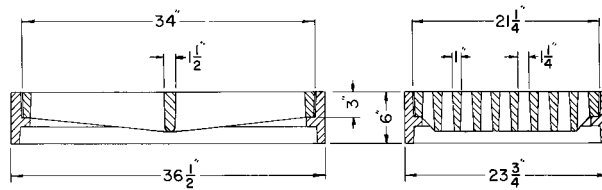

CATALOG NUMBER	GRATE TYPE	SQ. FT. OPEN	WEIR PERIMETER LINEAL FEET
R-3469-E2	C	2.3	9.2
R-3469-E2	A	2.7	9.2

Standard Grate (shown): Type C.
 Also available with grate Type A.

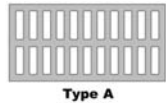

R-3470
Gutter Inlet Frame, Grate

Heavy Duty

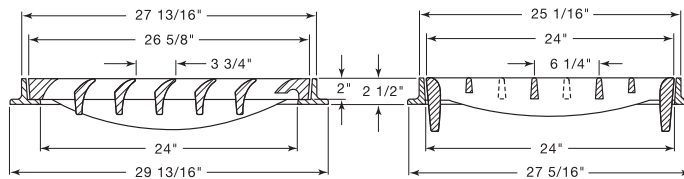

CATALOG NUMBER	GRATE TYPE	SQ. FT. OPEN	WEIR PERIMETER LINEAL FEET
R-3470	L	2.2	8.4

COMBINATION
 INLETS
 3

■ Note: When specifying/ordering grates, refer to "Choosing the proper inlet grate" on pages 117-118.
 For a complete listing of FREE OPEN AREAS and WEIR PERIMETERS of all NEENAH grates, refer to pages 306-311.

R-3470-2 Double Gutter Inlet Frame, Grates

Heavy Duty

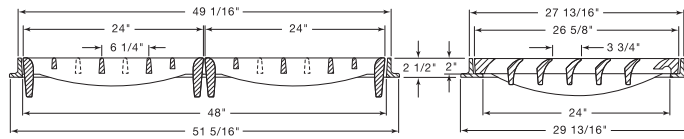

CATALOG NUMBER	GRATE TYPE	SQ. FT. OPEN	WEIR PERIMETER LINEAL FEET
R-3470-2	L	4.4	12.4

R-3471 Narrow Gutter Inlet Frame, Grate

Heavy Duty

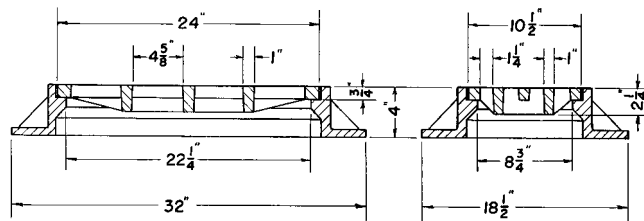

CATALOG NUMBER	GRATE TYPE	SQ. FT. OPEN	WEIR PERIMETER LINEAL FEET
R-3471	C	0.6	5.8

R-3472 Gutter Inlet Frame, Grate

Heavy Duty

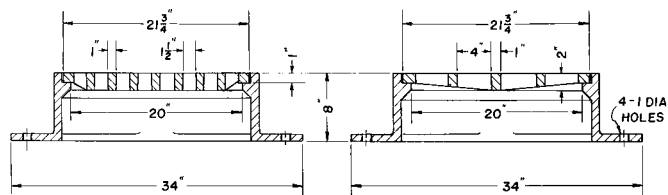

CATALOG NUMBER	GRATE TYPE	SQ. FT. OPEN	WEIR PERIMETER LINEAL FEET
R-3472	A or C	1.3	7.3

R-3473 Gutter Inlet Frame, Grate

Heavy Duty

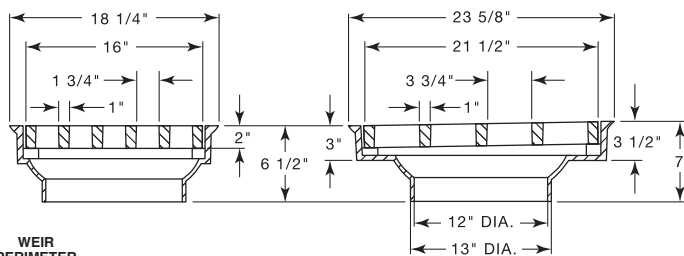

CATALOG NUMBER	GRATE TYPE	SQ. FT. OPEN	WEIR PERIMETER LINEAL FEET
R-3473	C	0.9	6.3