



# BAR GRATING

McNICHOLS® Quality Bar Grating is the top choice for strength, safety and overall value!





Bar Grating provides a load bearing surface but allows air, light, heat, sound and fluid to pass through. Bar Grating is strong, durable and virtually maintenance free.

**GALVANIZED STAIR TREADS SHIPPED SAME DAY!**

## PRODUCT OPTIONS

	WELDED	HEAVY-DUTY WELDED	LOCKED BY SWAGING	PRESS-LOCKED CLOSE MESH
Pattern Types				
	pg. 26 / webcode: GBW1	pg. 27 / webcode: GBW2	pg. 28 / webcode: GBL1	pg. 31 / webcode: GBP1

## PRODUCT SPECIFICATIONS

Series (Visit <a href="http://mcnichols.com">mcnichols.com</a> for all of our series options)	GW, SGW	GHB	GAL, SFT Flush Top, I-Bar GIA, Safe-T-Grid®	GAA, GCM
Materials	Plain Steel, Galvanized Steel, Stainless Steel	Plain Steel, Galvanized Steel	Aluminum, Stainless Steel	Plain Steel, Galvanized Steel, Aluminum
Surface	Smooth or Serrated	Smooth or Serrated	Smooth, Grooved or Serrated	Smooth or Serrated
Bar Thickness	1/8", 3/16"	1/4" (5/16", 3/8" special order)	1/8", 3/16", 1/4", .94" (Safe-T-Grid®)	3/16"
Bar Heights	3/4" to 2-1/2"	1" to 3"	1" to 2-1/2"	1" to 2"
Standard Sizes	2'x20', 3'x20', 2'x12', 3'x12', 2'x24', 3'x24', 4'x24'	3'x20'	2'x20', 2'x24', 3'x20', 3'x24'	3'x12', 3'x24' (GAA Only)
QR Code (Scan using a QR Reader on your smart phone)				

Not all product combinations are available. See [mcnichols.com](http://mcnichols.com) for availability.

## BAR GRATING APPLICATIONS



WELDED BAR GRATING

Welded Bar Grating is a suitable flooring application choice because of its strength, safety and overall value. Welded bar grating has a rectangular-shaped bearing bar that is available in a variety of bar thicknesses, heights, spacings and materials.



GW SERIES



SGW SERIES

GW, SGW SERIES WEB CODE: GBW1

GW Series Grating will handle most moderate loads and light wheel traffic with its standard bearing bar centers of 1-3/16".

SGW Series Grating will handle heavier loads than the GW Series.



Welded Stair Treads page 32

PRODUCT OPTIONS

- Materials: Plain Steel, Galvanized Steel, Stainless Steel (Plain Steel available with a standard black painted coat)
- Surface: Smooth or Serrated
- Bar Heights: 3/4" to 2-1/2"
- Bar Thickness: 1/8", 3/16"
- Standard Sizes: 2'x20', 3'x20', 2'x24', 3'x24'



Serrated Grating

STEEL LOAD TABLE: GW, GW-2

Bearing Bar Size	SPAN (1-3/16" Center to Center Bar Spacing)											
	2'	2'6"	3'	3'6"	4'	4'6"	5'	5'6"	6'	7'	8'	
3/4" x 1/8"	U	355	227	158	116	89	70					
	D	.099	.155	.223	.304	.397	.503					
	C	355	284	237	174	178	158					
3/4" x 3/16"	U	533	426	355	305	266	237					
	D	.099	.155	.223	.304	.397	.502					
	C	533	426	355	305	266	237					
1" x 1/8"	U	632	404	281	206	158	125	101	84	70		
	D	.075	.116	.168	.228	.298	.378	.466	.563	.670		
	C	632	505	421	361	316	281	253	230	211		
1" x 3/16"	U	947	606	421	309	237	187	152	125	105		
	D	.074	.116	.168	.228	.298	.377	.467	.563	.670		
	C	947	758	632	541	474	421	379	344	316		
1-1/4" x 1/8"	U	987	632	439	322	247	195	158	130	110	81	
	D	.060	.093	.134	.182	.239	.302	.372	.451	.536		
	C	987	789	658	564	493	439	395	359	329	282	
1-1/4" x 3/16"	U	1480	947	658	483	370	292	237	196	164	121	
	D	.060	.093	.134	.182	.238	.302	.373	.451	.536	.731	
	C	1480	1184	987	846	740	658	592	538	493	423	
1-1/2" x 1/8"	U	1421	909	632	464	355	281	227	188	158	116	89
	D	.050	.078	.112	.152	.198	.252	.310	.376	.447	.608	.794
	C	1421	1137	947	812	711	632	568	517	474	406	355
1-1/2" x 3/16"	U	2132	1364	947	696	533	421	341	282	237	174	133
	D	.050	.078	.112	.152	.199	.251	.310	.376	.447	.608	.794
	C	2132	1705	1421	1218	1066	947	853	775	711	609	533
1-3/4" x 3/16"	U	2901	1857	1289	947	725	573	464	384	322	237	181
	D	.043	.067	.096	.130	.170	.215	.266	.322	.383	.521	.681
	C	2901	2321	1934	1658	1451	1289	1161	1055	967	829	725
2" x 3/16"	U	3789	2425	1684	1237	947	749	606	501	421	309	237
	D	.037	.058	.084	.114	.149	.189	.233	.282	.335	.456	.596
	C	3789	3032	2526	2165	1895	1684	1516	1378	1263	1083	947
2-1/4" x 3/16"	U	4796	3069	2132	1566	1199	947	767	634	533	392	300
	D	.033	.052	.074	.101	.132	.168	.207	.250	.298	.406	.530
	C	4796	3837	3197	2741	2398	2132	1918	1744	1599	1370	1199
2-1/2" x 3/16"	U	5921	3789	2632	1933	1480	1170	947	783	658	483	370
	D	.030	.047	.067	.091	.119	.151	.186	.225	.268	.365	.477
	C	5921	4737	3947	3383	2961	2632	2368	2153	1974	1692	1480

To determine load for SGW, SGW-2, multiply value at left by the load factor of 1.27. Deflection under the factored loads will be same as shown in the load table.

For Serrated Grating the depth of the grating required will be 1/4" greater than shown in tables.

BAR SPACING: GW, GW-2, SGW

SERIES	GW (19W4)	GW-2 (19W2)	SGW (15W4)	SGW-2 (15W2)
Bar Spacing				
End View (showing 3/16" thickness, 1/8" thickness also available)				
Bearing Bar Size (Height x thickness)	Series No. #/SF	Series No. #/SF	Series No. #/SF	Series No. #/SF
3/4" x 1/8"	GW-75A 4.1	GW-75A-2 5.0	SGW-75A 5.0	SGW-75A-2 5.9
3/4" x 3/16"	GW-75 5.8	GW-75-2 6.7	SGW-75 7.2	SGW-75-2 8.1
1" x 1/8"	GW-100A 5.2	GW-100A-2 6.1	SGW-100A 6.4	SGW-100A-2 7.3
1" x 3/16"	GW-100 7.5	GW-100-2 8.4	SGW-100 9.3	SGW-100-2 10.2
1-1/4" x 1/8"	GW-125A 6.3	GW-125A-2 7.2	SGW-125A 7.9	SGW-125A-2 8.8
1-1/4" x 3/16"	GW-125 9.1	GW-125-2 10.0	SGW-125 11.3	SGW-125-2 12.2
1-1/2" x 1/8"	GW-150A 7.4	GW-150A-2 8.3	SGW-150A 9.3	SGW-150A-2 10.2
1-1/2" x 3/16"	GW-150 10.8	GW-150-2 11.7	SGW-150 13.5	SGW-150-2 14.4
1-3/4" x 3/16"	GW-175 12.5	GW-175-2 13.4	SGW-175 15.6	SGW-175-2 16.5
2" x 3/16"	GW-200 14.1	GW-200-2 15.0	SGW-200 17.7	SGW-200-2 18.6
2-1/4" x 3/16"	GW-225 15.8	GW-225-2 16.7	SGW-225 19.8	SGW-225-2 20.7
2-1/2" x 3/16"	GW-250 17.4	GW-250-2 18.3	SGW-250 21.9	SGW-250-2 22.8

PANEL WIDTHS: GW, GW-2, SGW

#Bars	GW, GW-2	SGW, SGW-2	#Bars	GW, GW-2	SGW, SGW-2	#Bars	GW, GW-2	SGW, SGW-2
2	1-3/8"	1-1/8"	17	19-3/16"	15-3/16"	32		29-1/4"
3	2-9/16"	2-1/16"	18	20-3/8"	16-1/8"	33		30-3/16"
4	3-3/4"	3"	19	21-9/16"	17-1/16"	34		31-1/8"
5	4-15/16"	3-15/16"	20	22-3/4"	18"	35	NOTE: Width and length tolerance ± 1/4"	32-1/16"
6	6-1/8"	4-7/8"	21	23-15/16"	18-15/16"	36		33"
7	7-5/16"	5-13/16"	22	25-1/8"	19-7/8"	37		33-15/16"
8	8-1/2"	6-3/4"	23	26-5/16"	20-13/16"	38		34-7/8"
9	9-11/16"	7-11/16"	24	27-1/2"	21-3/4"	39		35-13/16"
10	10-7/8"	8-5/8"	25	28-11/16"	22-11/16"			
11	12-1/16"	9-9/16"	26	29-7/8"	23-5/8"			
12	13-1/4"	10-1/2"	27	31-1/16"	24-9/16"			
13	14-7/16"	11-7/16"	28	32-1/4"	25-1/2"			
14	15-5/8"	12-3/8"	29	33-7/16"	26-7/16"			
15	16-13/16"	13-5/16"	30	34-5/8"	27-3/8"			
16	18"	14-1/4"	31	35-13/16"	28-5/16"			

STANDARD SIZES

CLIPS & FASTENERS

For a list of clips and fasteners and their purpose please see page 42.



HEAVY-DUTY WELDED BAR GRATING

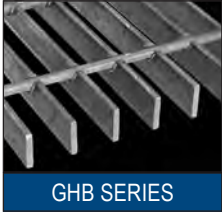

GHB SERIES

WEB CODE: GBW2

GHB Series can handle heavier load requirements with a bearing bar thickness of 1/4" and bar heights from 1" to 3". It is ideal for heavy rolling applications, such as bridge floor, highways, airport runways or other high-load trench applications.

**EMBED ANGLES** add to the life of your Trench Grating! Call for more information.

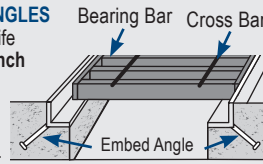

Heavy-Duty Welded Stair Treads page 32

PRODUCT OPTIONS

- Materials: Plain Steel, Galvanized Steel (Plain Steel available with a standard black painted coat)
- Surface: Smooth or Serrated
- Bar Heights: 1" to 3"
- Bar Thickness: 1/4" (5/16" or 3/8" special order)
- Standard Sizes: 3'x20'

BAR SPACING: GHB, GHB-2

SERIES	GHB (19W4)	GHB-2 (19W2)
Bar Spacing		
End View (showing 1/4" thickness. 3/8" and 5/16" thickness also available)		
Bearing Bar Size (height x thickness)	Series No. #/SF	Series No. #/SF
1" x 1/4"	GHB 100 9.8	GHB 100-2 10.7
1-1/4" x 1/4"	GHB 125 12.0	GHB 125-2 12.9
1-1/2" x 1/4"	GHB 150 14.3	GHB 150-2 15.1
1-3/4" x 1/4"	GHB 175 16.5	GHB 175-2 17.4
2" x 1/4"	GHB 200 18.7	GHB 200-2 19.6
2-1/2" x 1/4"	GHB 250 23.2	GHB 250-2 24.0
3" x 1/4"	GHB 300 27.9	

STEEL LOAD TABLE: GHB, GHB-2

Bearing Bar Size	SPAN (1-3/16" Center to Center Bar Spacing)															
	1'-0"	1'-6"	2'-0"	2'-6"	3'-0"	3'-6"	4'-0"	4'-6"	5'-0"	5'-6"	6'-0"	6'-6"	7'-0"	7'-6"	8'-0"	
1" x 1/4"	U	5615	2495	1404	898	624	458	351	277	225	186	156	133	115	100	88
	D	0.021	0.047	0.083	0.129	0.186	0.253	0.331	0.419	0.518	0.627	0.745	0.875	1.018	1.166	1.329
	C	2807	1872	1404	1123	936	802	702	624	561	510	468	432	401	374	351
1-1/4" x 1/4"	U	8772	3899	2193	1404	975	716	548	433	351	290	244	208	179	156	137
	D	0.017	0.037	0.066	0.104	0.149	0.203	0.265	0.335	0.414	0.501	0.597	0.701	0.811	0.931	1.059
	C	4386	2924	2193	1754	1462	1253	1097	975	877	797	731	675	627	585	548
1-1/2" x 1/4"	U	12632	5614	3158	2021	1404	1031	790	624	505	418	351	299	258	225	197
	D	0.014	0.031	0.055	0.086	0.124	0.169	0.221	0.279	0.345	0.418	0.497	0.583	0.676	0.777	0.881
	C	6316	4211	3158	2526	2105	1805	1579	1404	1263	1148	1053	972	902	842	790
1-3/4" x 1/4"	U	17193	7641	4298	2751	1910	1404	1075	849	688	568	478	407	351	306	269
	D	0.012	0.027	0.048	0.074	0.106	0.145	0.189	0.239	0.296	0.357	0.426	0.500	0.580	0.666	0.758
	C	8597	5731	4298	3439	2866	2456	2149	1910	1719	1563	1433	1323	1228	1146	1075
2" x 1/4"	U	22456	9980	5614	3593	2495	1833	1404	1109	898	742	624	532	458	399	351
	D	0.010	0.023	0.041	0.065	0.093	0.127	0.166	0.210	0.259	0.313	0.373	0.438	0.507	0.582	0.662
	C	11228	7485	5614	4491	3743	3208	2807	2495	2246	2041	1871	1727	1604	1497	1404
2-1/2" x 1/4"	U	35088	15595	8772	5614	3899	2864	2193	1733	1404	1160	975	830	716	624	548
	D	0.008	0.019	0.033	0.052	0.075	0.101	0.132	0.168	0.207	0.250	0.298	0.350	0.406	0.466	0.530
	C	17544	11696	8772	7018	5848	5013	4386	3899	3509	3190	2924	2699	2506	2339	2193
3" x 1/4"	U	50527	22456	12632	8084	5614	4125	3158	2495	2021	1670	1404	1196	1031	898	789
	D	0.007	0.016	0.028	0.043	0.062	0.085	0.110	0.140	0.172	0.209	0.248	0.291	0.338	0.388	0.441
	C	25263	16842	12632	10105	8421	7218	6316	5614	5053	4593	411	3887	3609	3368	3158
3-1/2" x 1/4"	U	68772	30565	17193	11004	7641	5614	4298	3396	2751	2273	1910	1628	1404	1223	1075
	D	0.006	0.013	0.024	0.037	0.053	0.072	0.095	0.120	0.148	0.179	0.213	0.250	0.290	0.333	0.379
	C	34386	22924	17193	13754	11462	9825	8597	7641	6877	6252	5731	5290	4912	4585	4298
4" x 1/4"	U	89825	39922	22456	14372	9981	7333	5614	4436	3593	2969	2495	2126	1833	1597	1404
	D	0.005	0.012	0.021	0.032	0.047	0.063	0.083	0.105	0.129	0.156	0.186	0.219	0.253	0.291	0.331
	C	44913	29942	22456	17965	14971	12832	11228	9981	8983	8166	7485	6910	6416	5988	5614
D	0.004	0.009	0.017	0.026	0.037	0.051	0.066	0.084	0.104	0.125	0.149	0.175	0.203	0.233	0.265	

Theoretical values based on F (Allowable bending stress) = 20,000 psi, E (Modulus of elasticity) = 30,000,000 psi gross section of bearing bar. U - Safe Uniform Load - pounds per sq. ft.; D - Deflection in inches; C - Concentrated Load - pounds per ft. width at mid span

GHB and GHB-2 is welded. This grating is not normally used for standard floor layouts but is usually selected by engineers for rolling or vehicular loads for narrow space work.

This technical information provided is as a reference for evaluation by technically skilled persons only, with any use thereof to be at their independent discretion and risk. McNichols shall have no responsibility or liability for results obtained or damages resulting from improper evaluation or use of grating.

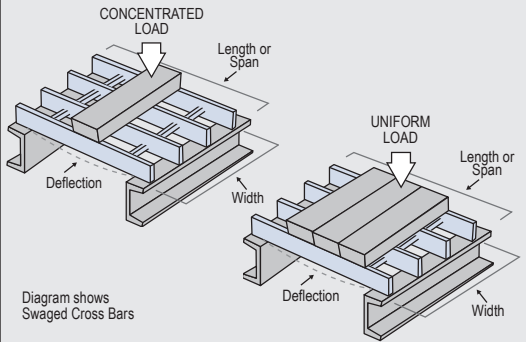

PANEL WIDTHS: GHB, GHB-2

#Bars	Bearing Bar Thickness			#Bars	Bearing Bar Thickness		
	1/4"	5/16"	3/8"		1/4"	5/16"	3/8"
2	1-7/16"	1-1/2"	1-9/16"	17	19-1/4"	19-5/16"	19-3/8"
3	2-5/8"	2-11/16"	2-3/4"	18	20-7/16"	20-1/2"	20-9/16"
4	3-13/16"	3-7/8"	3-15/16"	19	21-5/8"	21-11/16"	21-3/4"
5	5"	5-1/16"	5-1/8"	20	22-13/16"	22-7/8"	22-15/16"
6	6-3/16"	6-1/4"	6-5/16"	21	24"	24-1/16"	24-1/8"
7	7-3/8"	7-7/16"	7-1/2"	22	25-3/16"	25-1/4"	25-5/16"
8	8-9/16"	8-5/8"	8-11/16"	23	26-3/8"	26-7/16"	26-1/2"
9	9-3/4"	9-13/16"	9-7/8"	24	27-9/16"	27-5/8"	27-11/16"
10	10-15/16"	11"	11-1/16"	25	28-3/4"	28-13/16"	28-7/8"
11	12-1/8"	12-3/16"	12-1/4"	26	29-15/16"	30"	30-1/16"
12	13-5/16"	13-3/8"	13-7/16"	27	31-1/8"	31-3/16"	31-1/4"
13	14-1/2"	14-9/16"	14-5/8"	28	32-5/16"	32-3/8"	32-7/16"
14	15-11/16"	15-3/4"	15-13/16"	29	33-1/2"	33-9/16"	33-5/8"
15	16-7/8"	16-15/16"	17"	30	34-11/16"	34-3/4"	34-13/16"
16	18-1/16"	18-1/8"	18-3/16"	31	35-7/8"	35-15/16"	36"

PEDS AND TREDS® Welded Heavy Duty Steel Grating

SPECIAL ORDER

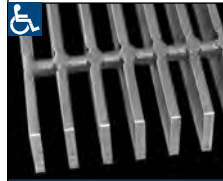

PEDS AND TREDS® Welded Heavy Duty Steel Grating satisfies both ADA and AASHTO (American Association of State Hwy. & Trans. Officials). It is ideal for parking garages, sidewalks and pedestrian accessible roadways where ventilation or drainage is required.

LOCKED BY SWAGING BAR GRATING

Locked by Swaging Grating is manufactured using an exclusive swaging (or pinching) and forming process that prevents the cross bars from turning or twisting. Panels are available in rectangular bar, flush top, I-bar and T-bar styles in a variety of bar heights. Offered in aluminum only.

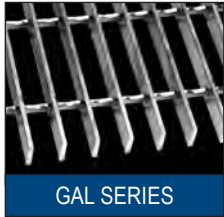

GAL SERIES

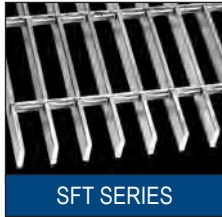

SFT SERIES

**GAL, SFT SERIES** WEB CODE: GBL1

GAL Series is an economical solution for applications requiring high strength and rigidity. GAL Series is lightweight and corrosion-resistant.

SFT Series has cross bars flush with the bearing bars along the top and is the product of choice where standing and walking comfort is a requirement.

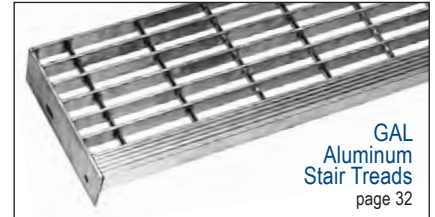

GAL Aluminum Stair Treads page 32

**PRODUCT OPTIONS**

- Materials: Aluminum
- Surface: Smooth or Serrated
- Bar Heights: 1" to 2" (2-1/4" & 2-1/2" special order)
- Bar Thickness: 1/8", 3/16" Rectangular
- Standard Sizes: 2'x20', 2'x24', 3'x20' or 3'x24'

**ALUMINUM LOAD TABLE: GAL, SFT, SFT-2**

Bearing Bar Size	SPAN (1-3/16" Center to Center Bar Spacing)											Theoretical values based on F (Allowable bending stress) = 12,000 psi, E (Modulus of elasticity) = 10,000,000 psi gross section of bearing bar. U - Safe Uniform Load - # per sq. ft. D - Deflection in inches C - Concentrated Load - # per ft. width at mid span				
	2'	2'6"	3'	3'6"	4'	4'6"	5'	5'6"	6'	7'	8'					
1" x 1/8"	U	421	269	187	137	105	83									Spans shaded in blue produce a deflection of 1/4" or less under a uniform load of 100 lbs. per square foot. This deflection is recommended as the maximum to provide pedestrian comfort. It can be exceeded at the discretion of the engineer.
	D	.144	.225	.324	.439	.574	.727									
	C	421	337	281	241	211	187									
	D	.115	.180	.259	.353	.462	.583									
1" x 3/16"	U	632	404	281	206	158	125									
	D	.144	.225	.324	.440	.576	.730									
	C	632	505	421	361	316	281									
	D	.115	.180	.259	.353	.461	.584									
1-1/4" x 1/8"	U	658	421	292	215	164	130	105	87	73						
	D	.115	.180	.259	.353	.459	.583	.718	.871	1.035						
	C	658	526	439	376	329	292	263	239	219						
	D	.092	.144	.208	.282	.369	.466	.576	.696	.828						
1-1/4" x 3/16"	U	987	632	439	322	247	195	158	130	110	81					
	D	.115	.180	.259	.353	.461	.583	.720	.868	1.040	1.419					
	C	987	789	658	564	493	439	395	359	329	282					
	D	.092	.144	.207	.282	.368	.467	.576	.697	.830	1.129					
1-1/2" x 1/8"	U	947	606	421	309	237	187	152	125	105	77	59				
	D	.096	.150	.216	.294	.384	.486	.602	.724	.862	1.171	1.530				
	C	947	758	632	541	474	421	379	345	316	271	237				
	D	.077	.120	.173	.235	.307	.389	.480	.582	.691	.821	1.229				
1-1/2" x 3/16"	U	1421	909	632	464	355	281	227	188	158	116	89				
	D	.096	.150	.216	.294	.384	.487	.599	.726	.865	1.176	1.539				
	C	1421	1137	947	812	711	632	568	517	474	406	355				
	D	.077	.120	.173	.235	.307	.389	.480	.581	.692	.841	1.228				
1-3/4" x 3/16"	U	1934	1238	860	632	484	382	309	256	215	158	121				
	D	.082	.129	.185	.252	.329	.417	.514	.623	.741	1.009	1.318				
	C	1934	1547	1289	1105	967	860	774	703	645	553	484				
	D	.066	.103	.148	.202	.263	.333	.412	.498	.593	.707	1.054				
2" x 3/16"	U	2526	1617	1123	825	632	499	404	334	281	206	158				
	D	.072	.113	.162	.221	.288	.364	.450	.544	.649	.881	1.153				
	C	2526	2021	1684	1444	1263	1123	1011	919	842	722	632				
	D	.058	.090	.130	.176	.230	.292	.360	.436	.518	.606	.922				
2-1/4" x 3/16"	U	3197	2046	1421	1044	799	632	512	423	355	261	200				
	D	.064	.100	.144	.196	.256	.324	.400	.484	.576	.784	1.025				
	C	3197	2558	2132	1827	1599	1421	1279	1163	1066	914	799				
	D	.051	.080	.115	.157	.205	.259	.320	.387	.461	.628	.819				
2-1/2" x 3/16"	U	3947	2526	1754	1289	987	780	632	522	439	322	247				
	D	.058	.090	.130	.176	.230	.292	.360	.436	.519	.705	.923				
	C	3947	3158	2632	2256	1974	1754	1579	1435	1316	1128	987				
	D	.046	.072	.104	.141	.184	.233	.288	.348	.415	.565	.737				

**BAR SPACING: GAL, SFT**

SERIES	GAL	GAL-2	SFT	SFT-2
Bar Spacing				
End View (showing 3/16 inch thickness. 1/8 inch thickness also available)				
Bearing Bar Size (height x thickness)	Series No. #/SF	Series No. #/SF	Series No. #/SF	Series No. #/SF
1" x 1/8"	GAL-100A 1.8	GAL-100A-2 2.0	SFT-100A 1.9	SFT-100A-2 2.3
1" x 3/16"	GAL-100 2.6	GAL-100-2 2.8	SFT-100 2.7	SFT-100-2 3.1
1-1/4" x 1/8"	GAL-125A 2.1	GAL-125A-2 2.4	SFT-125A 2.3	SFT-125A-2 2.7
1-1/4" x 3/16"	GAL-125 3.2	GAL-125-2 3.5	SFT-125 3.3	SFT-125-2 3.7
1-1/2" x 1/8"	GAL-150A 2.5	GAL-150A-2 2.8	SFT-150A 2.8	SFT-150A-2 3.2
1-1/2" x 3/16"	GAL-150 3.8	GAL-150-2 3.9	SFT-150 4.4	SFT-150-2 4.4
1-3/4" x 3/16"	GAL-175 4.3	GAL-175-2 4.4	SFT-175 4.6	SFT-175-2 5.0
2" x 3/16"	GAL-200 4.9	GAL-200-2 5.0	SFT-200 5.0	SFT-200-2 5.7
2-1/4" x 3/16"	GAL-225 5.3	GAL-225-2 5.6	SFT-225 5.8	SFT-225-2 6.2
2-1/2" x 3/16"	GAL-250 5.8	GAL-250-2 6.1	SFT-250 6.5	SFT-250-2 6.9

**PANEL WIDTHS: GAL, SFT**

#Bars	Rectangular	#Bars	Rectangular	#Bars	Rectangular
	GAL, SFT		GAL, SFT		GAL, SFT
2	1-3/8"	15	16-13/16"	28	32-1/4"
3	2-9/16"	16	18"	29	33-7/16"
4	3-3/4"	17	19-3/16"	30	34-5/8"
5	4-15/16"	18	20-3/8"	31	35-13/16"
6	6-1/8"	19	21-9/16"	32	Deduct 1/16" from widths shown for bearing 1/8" bearing bars.
7	7-5/16"	20	22-3/4"	33	
8	8-1/2"	21	23-15/16"	34	
9	9-11/16"	22	25-1/8"	35	
10	10-7/8"	23	26-5/16"	36	
11	12-1/16"	24	27-1/2"	37	
12	13-1/4"	25	28-11/16"	38	
13	14-7/16"	26	29-7/8"	39	
14	15-5/8"	27	31-1/16"	40	



LOCKED BY SWAGING BAR GRATING (Continued)

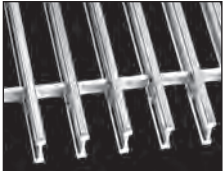

GIA SERIES

**GIA SERIES** WEB CODE: GBL4

I-Bar GIA Series Grating has I-shaped bearing bars that are locked in place by swaging the cross bars, making this grating series an economical solution for applications requiring high strength and rigidity and ideal for light pedestrian traffic. Made of aluminum, it is also lightweight and corrosion resistant.

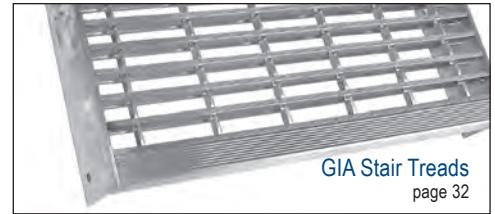

GIA Stair Treads  
page 32

**PRODUCT OPTIONS**

- Materials: Aluminum
- Surface: Grooved
- Bar Heights: 1" to 2" (2-1/4", 2-1/2" by special order)
- Bar Thickness: 1/4"
- Standard Sizes: 2'x20', 2'x24', 3'x20', 3'x24'

**ALUMINUM LOAD TABLE: GIA, GIA-2**

Bearing Bar Size		SPAN (1-3/16" Center to Center Bar Spacing)										
		2'	2'6"	3'	3'6"	4'	4'6"	5'	5'6"	6'	7'	8'
1" I-Bar	U	632	404	281	206	158	125	To determine load for SGIA, SGIA-2, multiply value at left by the load factor of 1.27. Deflection under the factored loads will be same as shown in the load table.				
	D	.144	.225	.324	.440	.576	.730					
	C	632	505	421	361	316	281					
	D	.115	.180	.259	.353	.461	.584					
1-1/4" I-Bar	U	987	632	439	322	247	195	158	130	110	81	
	D	.115	.180	.259	.353	.461	.583	.720	.868	1.040	1.419	
	C	987	789	658	564	493	439	395	359	329	282	
	D	.092	.144	.207	.282	.368	.467	.576	.697	.830	1.129	
1-1/2" I-Bar	U	1421	909	632	464	355	281	227	188	158	116	89
	D	.096	.150	.216	.294	.384	.487	.599	.726	.865	1.176	1.539
	C	1421	1137	947	812	711	632	568	517	474	406	355
	D	.077	.120	.173	.235	.307	.389	.480	.581	.692	.941	1.228
1-3/4" I-Bar	U	1934	1238	860	632	484	382	309	256	215	158	121
	D	.082	.129	.185	.252	.329	.417	.514	.623	.741	1.009	1.318
	C	1934	1547	1289	1105	967	860	774	703	645	553	484
	D	.066	.103	.148	.202	.263	.333	.412	.498	.593	.807	1.054
2" I-Bar	U	2526	1617	1123	825	632	499	404	334	281	206	158
	D	.072	.113	.162	.221	.288	.364	.450	.544	.649	.881	1.153
	C	2526	2021	1684	1444	1263	1123	1011	919	842	722	632
	D	.058	.090	.130	.176	.230	.292	.360	.436	.518	.706	.922
2-1/4" I-Bar	U	3197	2046	1421	1044	799	632	512	423	355	261	200
	D	.064	.100	.144	.196	.256	.324	.400	.484	.576	.784	1.025
	C	3197	2558	2132	1827	1599	1421	1279	1163	1066	914	799
	D	.051	.080	.115	.157	.205	.259	.320	.387	.461	.628	.819
2-1/2" I-Bar	U	3947	2526	1754	1289	987	780	632	522	439	322	247
	D	.058	.090	.130	.176	.230	.292	.360	.436	.519	.705	.923
	C	3947	3158	2632	2256	1974	1754	1579	1435	1316	1128	987
	D	.046	.072	.104	.141	.184	.233	.288	.348	.415	.565	.737

Theoretical values based on F (Allowable bending stress) = 12,000 psi, E (Modulus of elasticity) = 10,000,000 psi gross section of bearing bar. U - Safe Uniform Load - # per sq. ft., D - Deflection in inches, C - Concentrated Load - # per ft. width at mid span  
Spans shaded in blue produce a deflection of 1/4" or less under a uniform load of 100 lbs. per square foot. This deflection is recommended as the maximum to provide pedestrian comfort. It can be exceeded at the discretion of the engineer.  
This technical information provided is as a reference for evaluation by technically skilled persons only, with any use thereof to be at their independent discretion and risk. McNichols shall have no responsibility or liability for results obtained or damages resulting from improper evaluation or use of grating.  
Not recommended for wheel traffic or barefoot pedestrian.

**CLIPS & FASTENERS**

For a list of clips and fasteners and their purpose please see page 42.



**BAR SPACING: GIA, SGIA**

SERIES	GIA	GIA-2	SGIA	SGIA-2
Bar Spacing				
End View (showing 1/4" bearing bars)				
Bearing Bar Size	Series No. #/SF	Series No. #/SF	Series No. #/SF	Series No. #/SF
1"x1/4"	GIA-100 2.0	GIA-100-2 2.1	SGIA-100 2.3	SGIA-100-2 2.5
1-1/4"x1/4"	GIA-125 2.3	GIA-125-2 2.5	SGIA-125 2.8	SGIA-125-2 2.9
1-1/2"x1/4"	GIA-150 2.6	GIA-150-2 2.8	SGIA-150 3.2	SGIA-150-2 3.4
1-3/4"x1/4"	GIA-175 3.0	GIA-175-2 3.3	SGIA-175 3.7	SGIA-175-2 3.9
2"x1/4"	GIA-200 3.4	GIA-200-2 3.7	SGIA-200 4.2	SGIA-200-2 4.4
2-1/4"x1/4"	GIA-225 3.8	GIA-225-2 4.0	SGIA-225 4.6	SGIA-225-2 4.9
2-1/2"x1/4"	GIA-250 4.0	GIA-250-2 4.2	SGIA-250 4.9	SGIA-250-2 5.1

**PANEL WIDTHS: GIA, SGIA**

#Bars	GIA, GIA-2	SGIA	#Bars	GIA, GIA-2	SGIA	#Bars	GIA, GIA-2	SGIA
2	1-7/16"	1-3/16"	15	16-7/8"	13-1/16"	28	32-5/16"	25"
3	2-5/8"	2-1/8"	16	18-1/16"	14"	29	33-1/2"	25-15/16"
4	3-13/16"	3"	17	19-1/4"	14-15/16"	30	34-11/16"	26-13/16"
5	5"	3-15/16"	18	20-7/16"	15-13/16"	31	35-7/8"	27-3/4"
6	6-3/16"	4-13/16"	19	21-5/8"	16-3/4"	32		28-11/16"
7	7-3/8"	5-3/4"	20	22-13/16"	17-5/8"	33		29-9/16"
8	8-9/16"	6-11/16"	21	24"	18-9/16"	34		30-1/2"
9	9-3/4"	7-9/16"	22	25-3/16"	19-1/2"	35		31-7/16"
10	10-15/16"	8-1/2"	23	26-3/8"	20-3/8"	36		32-5/16"
11	12-1/8"	9-7/16"	24	27-9/16"	21-5/16"	37		33-1/4"
12	13-5/16"	10-5/16"	25	28-3/4"	22-1/4"	38		34-3/16"
13	14-1/2"	11-1/4"	26	29-15/16"	23-3/16"	39		35-1/16"
14	15-11/16"	12-3/16"	27	31-1/8"	24-1/16"	40		36"



GIA Stair Treads and Grating



LOCKED BY SWAGING BAR GRATING (Continued)

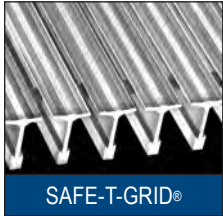

SAFE-T-GRID®

**SAFE-T-GRID®** WEB CODE: GPG1

SAFE-T-GRID® Grating is configured with extruded T-shaped bearing bars and extruded cross bars that are locked together by swaging for a high strength and rigid construction. The large T-bar surface makes it ideal for pedestrian traffic.



Stair Treads  
page 32

**PRODUCT OPTIONS**

Materials: Aluminum  
 Surface: Groove (Grip Tight surface available)  
 Bar Heights: 1", 1-1/4", 1-1/2" (2" special)

Widths: 36-1/4" (TB626), 36-9/16" (TB940)  
 Lengths: 24'

**ALUMINUM LOAD TABLE: SAFE-T-GRID®**

HEIGHT	TYPE	2'	2' 6"	3'	3' 6"	4'	4' 6"	5'	5' 6"	6'	6' 6"	7'	7' 6"	8'	
1"	TB626	U	.990	.634	.440	.323	.248	.196	.158	.131	.110	.94	.81	.70	.62
		D	.136	.212	.305	.415	.544	.688	.846	1.027	1.221	1.437	1.666	1.897	2.175
		C	.990	.792	.660	.566	.495	.440	.396	.360	.330	.305	.283	.264	.248
		D	.109	.170	.244	.333	.434	.549	.678	.821	.977	1.148	1.330	1.526	1.961
1" TB940 6710316324	TB940	U	1.051	.673	.467	.343	.263	.208	.168	.139	.117	1.00	.86	.75	.66
		D	.125	.195	.281	.382	.500	.633	.779	.944	1.125	1.325	1.532	1.761	2.006
		C	1.051	.841	.701	.601	.526	.467	.420	.382	.350	.323	.300	.280	.263
		D	.100	.156	.225	.306	.400	.505	.623	.755	.898	1.053	1.222	1.403	1.599
1-1/4"	TB626	U	1.516	.970	.674	.495	.379	.299	.243	.200	.168	.144	.124	.108	.95
		D	.108	.169	.243	.331	.432	.546	.676	.815	.969	1.145	1.326	1.522	1.733
		C	1.516	1.213	1.011	.866	.758	.674	.606	.551	.505	.466	.433	.404	.379
		D	.086	.135	.194	.265	.346	.438	.540	.653	.777	.912	1.058	1.214	1.382
1-1/4" TB940 6704209034	TB940	U	1.738	1.112	.772	.568	.435	.343	.278	.230	.193	.165	.142	.124	.109
		D	.097	.151	.218	.297	.387	.489	.605	.732	.870	1.025	1.186	1.365	1.553
		C	1.738	1.391	1.159	.993	.869	.773	.695	.632	.579	.535	.497	.464	.435
		D	.077	.121	.174	.237	.310	.392	.484	.585	.696	.817	.949	1.090	1.240
1-1/2"	TB626	U	2.021	1.293	.898	.660	.505	.399	.323	.267	.225	.191	.165	.144	.126
		D	.091	.142	.205	.279	.364	.461	.569	.689	.822	.961	1.117	1.284	1.455
		C	2.021	1.617	1.347	1.155	1.011	.898	.808	.735	.674	.622	.577	.539	.505
		D	.073	.114	.164	.223	.292	.369	.455	.551	.657	.770	.892	1.025	1.166
1-1/2" TB940 6715316324	TB940	U	2.344	1.500	1.042	.766	.586	.463	.375	.310	.260	.222	.191	.167	.147
		D	.082	.128	.184	.251	.327	.414	.512	.619	.736	.865	1.001	1.153	1.314
		C	2.344	1.876	1.563	1.340	1.172	1.042	.938	.853	.781	.721	.670	.625	.586
		D	.065	.102	.147	.200	.262	.332	.410	.496	.589	.692	.803	.921	1.048
2"	TB626	U	3.173	2.031	1.410	1.036	.793	.627	.508	.420	.353	.300	.259	.226	.198
		D	.069	.108	.156	.212	.277	.351	.434	.525	.625	.731	.849	.977	1.108
		C	3.173	2.538	2.115	1.813	1.587	1.410	1.269	1.154	1.058	.976	.907	.846	.793
		D	.055	.087	.125	.170	.222	.281	.347	.420	.499	.586	.680	.780	.887
2"	TB940	U	3.719	2.380	1.653	1.214	.930	.735	.595	.492	.413	.352	.304	.264	.232
		D	.063	.098	.141	.192	.251	.318	.392	.475	.565	.663	.770	.881	1.003
		C	3.719	2.975	2.479	2.125	1.859	1.653	1.488	1.352	1.240	1.144	1.063	.992	.930
		D	.050	.078	.113	.154	.201	.254	.314	.380	.452	.530	.616	.707	.804

Spans shaded in blue produce a deflection of 1/4" or less under a uniform load of 100 lbs. per square foot. This deflection is recommended as the maximum to provide pedestrian comfort. It can be exceeded at the discretion of the engineer.

Theoretical values based on F (Allowable bending stress) = 12,000 psi, E (Modulus of elasticity) = 10,000,000 psi gross section of bearing bar. U - Safe Uniform Load - pounds per sq. ft.; D - Deflection in Inches; C - Safe Concentrated Load - pounds per ft. width at mid span

This technical information provided is as a reference for evaluation by technically skilled persons only, with any use thereof to be at their independent discretion and risk. McNICHOLS shall have no responsibility or liability for results obtained or damages resulting from improper evaluation or use of grating.

Not recommended for wheel traffic or barefoot pedestrian.

**BAR SPACING: SAFE-T-GRID®**

SERIES	TB626	TB940						
Bar Spacing								
End View								
Bearing Bar Height	Bar Thickness	Bar Spacing	#/SF	Widths	Bar Thickness	Bar Spacing	#/SF	Widths
1"	.626	.5615	2.6	36-1/4"	.940	.2475	3.0	36-9/16"
1-1/4"	.626	.5615	3.1	36-1/4"	.940	.2475	4.0	36-9/16"
1-1/2"	.626	.5615	3.3	36-1/4"	.940	.2475	4.3	36-9/16"
2"	.626	.5615	3.8	36-1/4"	.940	.2475	4.8	36-9/16"

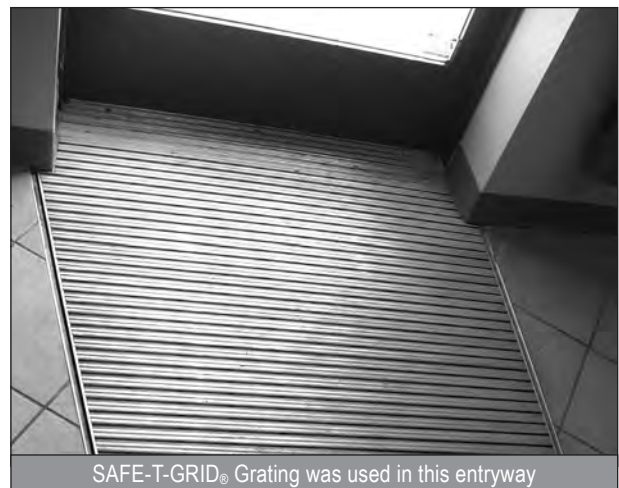

SAFE-T-GRID® Grating was used in this entryway

**McNICHOLS® FABRICATION SERVICES**

Each of our nationwide service centers is equipped with a team of experienced welders and a variety of specialized processing equipment so that your job can be cut-to-size quickly and accurately!

See page 56 for a list of our Fabrication Services.



Unique stairway has SAFE-T-GRID® stairs and perforated risers

PRESS-LOCKED/CLOSE MESH BAR GRATING

Press-Locked Grating cross bars and bearing bars are notched and pressed together through a high pressure manufacturing process. The result is a bidirectional flush surface that assures a firm, rigid connection and makes it aesthetically appealing for architectural applications.



GAA & GCM SERIES WEB CODE: GBL1

Press-Locked GAA Series grating is formed by pressing the cross bars into the bearing bars flush top under tremendous pressure, laterally displacing 1/16" of cross bar material into the dovetail slot.

Close Mesh GCM Series is formed by pressing the cross bars and bearing bars together through a high pressure process. The GCM Series offers bearing bar spacings that are ADA compliant.

**PRODUCT OPTIONS**

**Materials:** Aluminum, Plain Steel, Stainless Steel, (GAA also available in Galvanized Steel)

**Surface:** Smooth or Serrated

**Bar Heights:** 3/4" to 2-1/2"

**Bar Thickness:** 3/16" (1/8" special order)

**Standard Sizes:** 3'x12', 3'x20' (GAA is also available at 3'x24')

**STEEL LOAD TABLE: GAA**

SPAN (1-3/16" Center to Center Bar Spacing)

Bearing Bar Size	SPAN (1-3/16" Center to Center Bar Spacing)										
	2'	2'6"	3'	3'6"	4'	4'6"	5'	5'6"	6'	7'	8'
3/4" x 1/8"	U	.355	.227	.158	.116	.089	.070				
	D	.099	.155	.223	.304	.397	.503				
	C	.355	.284	.237	.174	.178	.158				
	D	.079	.124	.179	.243	.319	.402				
3/4" x 3/16"	U	.533	.341	.237	.174	.133	.105				
	D	.099	.155	.223	.304	.397	.502				
	C	.533	.426	.355	.305	.266	.237				
	D	.079	.124	.179	.244	.318	.403				
1" x 1/8"	U	.632	.404	.281	.206	.158	.125	.101	.84		.70
	D	.075	.116	.168	.228	.298	.378	.466	.563	.670	
	C	.632	.505	.421	.361	.316	.281	.253	.230	.211	
	D	.060	.093	.134	.183	.239	.302	.372	.451	.536	
1" x 3/16"	U	.947	.606	.421	.309	.237	.187	.152	.125	.105	
	D	.074	.116	.168	.228	.298	.377	.467	.563	.670	
	C	.947	.758	.632	.541	.474	.421	.379	.344	.316	
	D	.060	.093	.134	.182	.239	.302	.372	.451	.536	
1-1/4" x 1/8"	U	.987	.632	.439	.322	.247	.195	.158	.130	.110	.81
	D	.060	.093	.134	.182	.239	.302	.372	.451	.538	.730
	C	.987	.789	.658	.564	.493	.439	.395	.359	.329	.282
	D	.048	.074	.107	.146	.191	.241	.298	.360	.429	.584
1-1/4" x 3/16"	U	1.480	.947	.658	.483	.370	.292	.237	.196	.164	.121
	D	.060	.093	.134	.182	.238	.302	.373	.451	.536	.731
	C	1.480	1.184	.987	.846	.740	.658	.592	.538	.493	.423
	D	.048	.074	.107	.146	.191	.241	.298	.360	.429	.584
1-1/2" x 1/8"	U	1.421	.909	.632	.464	.355	.281	.227	.188	.158	.116
	D	.050	.078	.112	.152	.199	.252	.310	.376	.447	.608
	C	1.421	1.137	.947	.812	.711	.632	.568	.517	.474	.406
	D	.040	.062	.089	.122	.159	.201	.248	.300	.358	.487
1-1/2" x 3/16"	U	2.132	1.364	.947	.696	.533	.421	.341	.282	.237	.174
	D	.050	.078	.112	.152	.199	.251	.310	.376	.447	.608
	C	2.132	1.705	1.421	1.218	1.066	.947	.853	.775	.711	.609
	D	.040	.062	.089	.122	.159	.201	.248	.300	.358	.487
1-3/4" x 3/16"	U	2.901	1.857	1.289	.947	.725	.573	.464	.384	.322	.237
	D	.043	.067	.096	.130	.170	.215	.266	.322	.383	.521
	C	2.901	2.321	1.934	1.658	1.451	1.289	1.161	1.055	.967	.829
	D	.034	.053	.077	.104	.136	.172	.213	.257	.306	.417
2" x 3/16"	U	3.789	2.425	1.684	1.237	.947	.749	.606	.501	.421	.309
	D	.037	.058	.084	.114	.149	.189	.233	.282	.335	.456
	C	3.789	3.032	2.526	2.165	1.895	1.684	1.516	1.378	1.263	1.083
	D	.030	.047	.067	.091	.119	.151	.186	.225	.268	.365
2-1/4" x 3/16"	U	4.796	3.069	2.132	1.566	1.199	.947	.767	.634	.533	.392
	D	.033	.052	.074	.101	.132	.168	.207	.250	.298	.406
	C	4.796	3.837	3.197	2.741	2.398	2.132	1.918	1.744	1.599	1.370
	D	.026	.041	.060	.081	.106	.134	.166	.200	.238	.324
2-1/2" x 3/16"	U	5.921	3.789	2.632	1.933	1.480	1.170	.947	.783	.658	.483
	D	.030	.047	.067	.091	.119	.151	.186	.225	.268	.365
	C	5.921	4.737	3.947	3.383	2.961	2.632	2.368	2.153	1.974	1.692
	D	.024	.037	.054	.073	.095	.121	.149	.180	.215	.292

Spans shaded in blue produce a deflection of 1/4" or less under a uniform load of 100 lbs. per square foot. This deflection is recommended as the maximum to provide pedestrian comfort. It can be exceeded at the discretion of the engineer.

This technical information provided is as a reference for evaluation by technically skilled persons only, with any use thereof to be at their independent discretion and risk. McNichols shall have no responsibility or liability for results obtained or damages resulting from improper evaluation or use of grating.

Not recommended for wheel traffic or barefoot pedestrian.

**BAR SPACING: GAA, GCM**

SERIES	GAA (19P4)	GCM (7P4)	GCM-2 (8P4)	GCM-4 (11P4)
Bar Spacing				
End View (showing 3/16\"/>				
Bearing Bar Size (height x thickness)	Series No. #/SF	Series No. #/SF	Series No. #/SF	Series No. #/SF
3/4" x 1/8"	GAA-75A 4.4 --	--	GCM-2-75A 8.6 --	--
3/4" x 3/16"	GAA-75 5.7	GCM-1-75 13.7	GCM-2-75 12.3	GCM-4-75 9.0
1" x 1/8"	GAA-100A 5.2 --	--	GCM-2-100A 11.5 --	--
1" x 3/16"	GAA-100 7.5	GCM-1-100 18.1	GCM-2-100 16.5	GCM-4-100 11.9
1-1/4" x 1/8"	GAA-125A 6.3 --	--	GCM-2-125A 14.2 --	--
1-1/4" x 3/16"	GAA-125 9.1	GCM-1-125 22.6	GCM-2-125 20.7	GCM-4-125 14.8
1-1/2" x 1/8"	GAA-150A 7.6 --	--	GCM-2-150A 17.2 --	--
1-1/2" x 3/16"	GAA-150 11.0	GCM-1-150 27.2	GCM-2-150 25.0	GCM-4-150 17.8
1-3/4" x 3/16"	GAA-175 12.7	GCM-1-175 31.6	GCM-2-175 29.4	GCM-4-175 20.8
2" x 3/16"	GAA-200 14.3	GCM-1-200 36.2	GCM-2-200 33.2	GCM-4-200 23.8
2-1/4" x 3/16"	GAA-225 16.0	GCM-1-225 40.1	GCM-2-225 37.3	GCM-4-225 26.5
2-1/2" x 3/16"	GAA-250 17.7 --	--	GCM-2-250 41.4	GCM-4-250 29.3

**PANEL WIDTHS: GAA, GCM**

#Bars	GAA	GCM	GCM-2	GCM-4	#Bars	GAA	GCM	GCM-2	GCM-4
2	1-3/8"	GCM also available in widths up to 83 bars, GCM-2 available in widths up to 72 bars, GCM-4 available in widths up to 52 bars.	Wider areas will be made in two or more panels. Panels are available up to 48" by special order. All other widths are cut-to-size. Deduct 1/16" from width for 1/8" bearing bars.	NOTE: Width and length tolerance ± 1/4"	18	20-3/8"	7-5/8"	8-11/16"	11-5/8"
3	2-9/16"				19	21-9/16"	8-1/16"	9-3/16"	12-9/16"
4	3-3/4"				20	22-3/4"	8-1/2"	9-11/16"	13-1/4"
5	4-15/16"				21	23-15/16"	8-15/16"	10-3/16"	13-15/16"
6	6-1/8"	22	25-1/8"	9-3/8"	10-11/16"	14-5/8"			
7	7-5/16"	23	26-5/16"	9-13/16"	11-3/16"	15-5/16"			
8	8-1/2"	24	27-1/2"	10-1/4"	11-11/16"	16"			
9	9-11/16"	25	28-11/16"	10-11/16"	12-3/16"	16-11/16"			
10	10-7/8"	26	29-7/8"	11-1/8"	12-11/16"	17-3/8"			
11	12-1/16"	27	31-1/16"	11-9/16"	13-3/16"	18-1/16"			
12	13-1/4"	28	32-1/4"	12"	13-11/16"	18-3/4"			
13	14-7/16"	29	33-7/16"	12-7/16"	14-3/16"	19-7/16"			
14	15-5/8"	30	34-5/8"	12-7/8"	14-11/16"	20-1/8"			
15	16-13/16"	31	35-13/16"	13-5/16"	15-3/16"	20-13/16"			
16	18"	32	--	13-3/4"	15-11/16"	21-1/2"			
17	19-3/16"	7-3/16"	8-3/16"	11-3/16"					

BAR GRATING STAIR TREADS

McNICHOLS® Bar Grating Stair Treads are a top choice for strength, safety, and long-term cost savings. Below are some of the most popular selections.

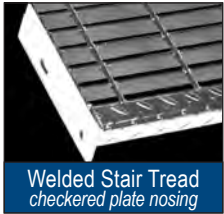

Welded Stair Tread  
checkered plate nosing

**GW SERIES**

GW Series Grating will handle most moderate loads and light wheel traffic with its standard bearing bar centers of 1-3/16".

For more details on GW Series Grating please see page 26.

**PRODUCT OPTIONS**

- Materials:** Plain, Galvanized and Stainless Steel, (Plain Steel available with standard black painted coat)
- Surface:** Smooth or Serrated
- Bar Heights:** 1", 1-1/4", 1-1/2"
- Bar Thickness:** 1/8", 3/16"
- Widths:** 8-9/16", 9-3/4", 10-15/16", 12-1/8"
- Lengths/Span:** 30", 36", 48" (other sizes available)



Welded Stair Tread  
cast abrasive nosing

**GHB SERIES**

GHB Series can handle heavier load requirements with a bearing bar thickness of 1/4" and bar heights from 1" to 3".

For more details on GHB Series Grating please see page 27.

**PRODUCT OPTIONS**

- Materials:** Plain and Galvanized Steel, (Plain Steel available with standard black painted coat)
- Surface:** Smooth or Serrated
- Bar Heights:** 3/4", 1", 1-1/4", 1-1/2"
- Bar Thickness:** 1/4"
- Widths:** 8-9/16", 9-3/4", 10-15/16", 12-1/8"
- Lengths/Span:** 30", 36", 48" (other sizes available)



Swaged Stair Tread  
corrugated angled nosing

**GAL SERIES**

GAL Series is an economical solution for applications requiring high strength and rigidity. GAL Series is lightweight and corrosion-resistant.

For more details on GAL Series Grating please see page 28.

**PRODUCT OPTIONS**

- Materials:** Aluminum
- Surface:** Smooth or Serrated
- Bar Heights:** 1", 1-1/4", 1-1/2", 1-3/4"
- Bar Thickness:** 3/16"
- Widths:** 8-9/16", 9-3/4", 10-15/16", 12-1/8"
- Lengths/Span:** See bearing bar size chart below



I-Bar Stair Tread  
corrugated angled nosing

**GIA SERIES**

I-Bar GIA Series Grating is an economical solution for applications requiring high strength and rigidity and is ideal for light pedestrian traffic. Its properties are lightweight and corrosion resistant.

For more details on GIA Series Grating please see page 29.

**PRODUCT OPTIONS**

- Materials:** Aluminum
- Surface:** Grooved
- Bar Heights:** 1", 1-1/4", 1-1/2", 1-3/4"
- Bar Thickness:** 1/4"
- Widths:** 8-5/8", 9-13/16", 11", 12-3/16"
- Lengths/Span:** See bearing bar size chart below



SAFE-T-GRID®  
Stair Tread

**SAFE-T-GRID®**

SAFE-T-GRID® Stair Treads provide a measure of safety and a comfortable, affordable and corrosion resistant walking surface ideal for water and waste water treatment plants, pedestrian bridges, walkways and similar uses.

For more details on SAFE-T-GRID® Grating please see page 30.

**PRODUCT OPTIONS**

- Materials:** Aluminum
- Surface:** Grooved (Grip Tight surface available)
- Bar Heights:** 1", 1-1/4", 1-1/2"
- Bar Thickness:** See bar spacing chart, page 30
- Widths:** 9-1/4", 10-1/2", 11-3/4", 12-3/4"
- Lengths/Span:** Lengths up to 42"

Information shown is for TB-940 SAFE-T-GRID® only

RECOMMENDED BEARING BAR SIZES					
	RECTANGULAR BAR 1-3/16" CTC BB		I-BAR 1-3/16" CTC BB		Max. Tread Span*
	Bearing Bar Size	Maximum Tread Span* Plain	Serrated	Bearing Bar Size	
ALUMINUM	1" x 3/16"	2'-4"	-----	1" x 1/4"	2'-4"
	1-1/4" x 3/16"	2'-10"	2'-7"	1-1/4" x 1/4"	2'-10"
	1-1/2" x 3/16"	3'-6"	3'-2"	1-1/2" x 1/4"	3'-6"
	1-3/4" x 3/16"	4'-3"	3'-10"	1-3/4" x 1/4"	4'-3"
	3/4" x 3/16"	2'-4"	-----		
STEEL	1" x 3/16"	3'-5"	2'-10"	*Maximum tread length/span based on 300 lb. concentrated load on front 5 inch of tread at center of tread length.	
	1-1/4" x 3/16"	4'-8"	4'-2"		
	1-1/2" x 3/16"	5'-6"	5'-3"		

ENDPLATE DIMENSIONS				
	GW/GAL		GIA	
	1-3/16" CTC BB		1-3/16" CTC BB	
	Width	A	Width	A
5"	2-1/2"		5-1/16"	2-1/2"
6-3/16"	2-1/2"		6-1/4"	2-1/2"
7-3/8"	4-1/2"		7-7/16"	4-1/2"
8-9/16"	4-1/2"		8-5/8"	4-1/2"
9-3/4"	7"		9-13/16"	7"
10-15/16"	7"		11"	7"
12-1/8"	7"		12-3/16"	7"

