



Installation Guide:  
Oct. 2014  
Rev. C

<b>Model Number:</b>	<b>K3150-X2-XX-XX-03-C</b>	<b>K3127-X2-XX-XX-03-C</b>
	<b>S3150-X2-XX-XX-03-C</b>	<b>S3127-X2-XX-XX-03-C</b>
	<b>K3150-X2-XX-XX-02-C</b>	<b>K3127-X2-XX-XX-02-C</b>
	<b>S3150-X2-XX-XX-02-C</b>	<b>S3127-X2-XX-XX-02-C</b>

Thank you for buying the world's most innovative fan. Please take a few moments to register your fan with us online at [www.haikufan.com/warrantyregistration](http://www.haikufan.com/warrantyregistration).



This product is sold by a plant whose Management System is certified as being in conformity with ISO 9001:2008.



Conforms to UL STD 507—Electric Fans  
Certified to CSA C22.2 No. 113—Fans & Ventilators



This device complies with Part 15 of the FCC Rules. This device complies with Canada ICES-003, Class B.

**May be protected by one or more of the following patents: [www.bigasssolutions.com/patents](http://www.bigasssolutions.com/patents)**

Haiku and the Haiku logo are trademarks of Delta T Corporation, registered in the United States and/or other countries. The information contained in this document is subject to change without notice.

# CONTENTS

---

## INTRODUCTION

- 1** | About Haiku  
Technical specifications
- 2** | Parts and hardware  
Fan diagram

## PREPARATION

- 3** | Unpacking the fan  
Determining fan location
- 4** | Tools needed  
Preparing the mounting location

## INSTALLATION

- 5** | Installing the airfoils
- 6** | Installing the lower cover (fans without SenseME™)
- 7** | Installing the lower cover (fans with SenseME)
- 8** | Installing the extension tube  
Connecting the safety cable & ground wire  
Preparing the wiring cover & canopy
- 9** | Installing the mounting ball  
Installing the mounting bracket  
Wiring the fan
- 10** | Hanging the fan  
Connecting the fan to power
- 11** | Securing the safety cable  
Installing the canopy

## ELECTRICAL

- 12** | Wire color chart  
Wiring diagram  
(without EMI filter)
- 13** | Wire color chart  
Wiring diagram  
(with EMI filter)

## OPERATION

- 14** | Powering the fan  
Replacing remote battery  
Changing fan speed  
Sleep mode  
Timer mode  
Whoosh mode
- 15** | Operating the light  
Reversing fan rotation  
Fan mode indicators

## TROUBLESHOOTING

- 16** | General troubleshooting

## MAINTENANCE

- 17** | Annual maintenance

# IMPORTANT SAFETY INSTRUCTIONS



**Read and save these instructions prior to installing and operating your Haiku®. Retain this installation guide for maintenance and troubleshooting information. If you have further questions, contact Haiku Customer Service at [www.haikufan.com/service](http://www.haikufan.com/service).**

**WARNING:** To reduce the risk of fire, electric shock, and serious bodily injury to persons, observe the following:

- Installation work and electrical wiring must be done by qualified person(s) in accordance with all applicable codes and standards.
- When cutting or drilling into ceiling, do not damage electrical wiring and other hidden utilities.
- Use this fan only in the manner intended by the manufacturer.

**CAUTION:** The installation of this fan must be in accordance with the requirements specified in this installation manual and with all national and local electrical codes. Code compliance is ultimately YOUR responsibility!

**CAUTION:** Exercise caution and common sense when powering the fan. Do not connect the fan to a damaged power source. Do not attempt to resolve electrical malfunctions or failures on your own.

**WARNING:** The fan must be used with the supplied remote control. Other parts cannot be substituted.

**CAUTION:** When service or replacement of a component in the fan requires the removal or disconnection of a safety device, the safety device must be reinstalled or remounted as previously installed.

**WARNING:** Power must be disconnected before installation and servicing, cleaning, and other user-maintenance. Failure to disconnect power creates risk of fire, electric shock, and serious bodily injury.

**CAUTION:** The product warranty will not cover equipment damage or failure that is caused by improper installation or operation.

**WARNING:** To reduce the risk of fire, electric shock, or serious bodily injury when mounting the fan to an outlet box, mount the fan to an outlet box that is suitable for fan support, and use the mounting screws provided with the outlet box. Outlet boxes used for luminaires are usually not acceptable for fan support and may need to be replaced. If in doubt, consult a qualified electrician.

**CAUTION:** The fan must be mounted a minimum of 7 ft (2.1 m) from the floor and 2 ft (0.6 m) from the nearest wall. The ceiling should be stable with no shaking, high vibrations, or heavy impacts.

**WARNING:** Do not install the fan in an environment that is excessively dusty, conductive, corrosive, or gas-filled, is exposed to open flames (e.g., gas-burning stoves), is near strong chemicals or solvents, or where there is excessive heat, shock, or vibration.

**WARNING:** Do not bend the airfoils when installing or servicing the fan. Do not insert foreign objects in between the rotating fan airfoils.

**CAUTION:** This fan is not intended for use by persons (including children) with reduced physical, sensory, or mental capabilities, or lack of experience and knowledge, unless they have been given supervision or instruction concerning the use of the fan by a person responsible for their safety. Children should be supervised to ensure that they do not play with the fan.

**WARNING:** Before installing or servicing the fan, ensure power is disconnected.

**CAUTION:** Haiku is rated for use in damp environments and can be operated indoors or outdoors. Haiku Bamboo is not rated for damp environments and must be operated indoors only.

**CAUTION:** The fan will begin rotating when power is applied.

**CAUTION:** Do not use the fan with a dimmer switch.

# INTRODUCTION

Thank you for your Haiku purchase and congratulations on your selection of an elegant, efficient, and cost-effective way to stay cool! We are proud to assure you that the fan you have chosen is backed by extensive research, thorough testing, and quality manufacturing.

If you have any questions or comments, please contact Customer Service by visiting our Web site at [www.haikufan.com/support](http://www.haikufan.com/support).

## About Haiku®

Haiku products are inspired by the seamless integration of natural forms and materials with the latest technologies. Haiku fans consume up to 80% less energy than traditional ceiling fans and maximize the sustainable use of global resources so you can now help save the planet in STYLE. Backed by the engineering resources of Big Ass Fans, the fan of choice for smaller spaces that need extraordinary air movement is crystal clear—it's Haiku.

## Technical specifications

Before assembling and installing your fan, review the technical specifications in the table below. A fan diagram and parts list can be found on the following page.

Model number	K3150-X2-XX-XX-03-C	S3150-X2-XX-XX-03-C	K3150-X2-XX-XX-02-C	S3150-X2-XX-XX-02-C
Fan diameter	60 in. (1.5 m)	60 in. (1.5 m)	60 in. (1.5 m)	60 in. (1.5 m)
Number of airfoils	3	3	3	3
Weight	15 lb (6.8 kg)	15 lb (6.8 kg)	15 lb (6.8 kg)	15 lb (6.8 kg)
Number of fan speeds	7	7	7	7
Operating voltage	100–240 VAC, 1 Φ	100–240 VAC, 1 Φ	100–240 VAC, 1 Φ	100–240 VAC, 1 Φ
Operating frequency	50–60 Hz	50–60 Hz	50–60 Hz	50–60 Hz
Full load amps	0.36 A	0.36 A	0.25 A	0.17 A
Wattage	Max: 32 Watts Min: 2 Watts	Max: 22 Watts Min: 2 Watts	Max: 29.93 Watts Min: 2.05 Watts	Max: 19.86 Watts Min: 1.97 Watts
Ambient operational temperature range	32 to 104°F (0 to 40°C)	32 to 104°F (0 to 40°C)	32 to 104°F (0 to 40°C)	32 to 104°F (0 to 40°C)
Operational humidity range	20–90% non-condensing	20–90% non-condensing	20–90% non-condensing	20–90% non-condensing

Model number	K3127-X2-XX-XX-03-C	S3127-X2-XX-XX-03-C	K3127-X2-XX-XX-02-C	S3127-X2-XX-XX-02-C
Fan diameter	52 in. (1.3 m)	52 in. (1.3 m)	52 in. (1.3 m)	52 in. (1.3 m)
Number of airfoils	3	3	3	3
Weight	13 lb (6 kg)	13 lb (6 kg)	13 lb (6 kg)	13 lb (6 kg)
Number of fan speeds	7	7	7	7
Operating voltage	100–240 VAC, 1 Φ	100–240 VAC, 1 Φ	100–240 VAC, 1 Φ	100–240 VAC, 1 Φ
Operating frequency	50–60 Hz	50–60 Hz	50–60 Hz	50–60 Hz
Full load amps	0.26 A	0.17 A	0.27 A	0.18 A
Wattage	Max: 30.67 Watts Min: 1.82 Watts	Max: 19.99 Watts Min: 1.69 Watts	Max: 31.51 Watts Min: 2.39 Watts	Max: 20.95 Watts Min: 2.27 Watts
Ambient operational temperature range	32 to 104°F (0 to 40°C)	32 to 104°F (0 to 40°C)	32 to 104°F (0 to 40°C)	32 to 104°F (0 to 40°C)
Operational humidity range	20–90% non-condensing	20–90% non-condensing	20–90% non-condensing	20–90% non-condensing

## Parts and hardware

If you are missing any parts or hardware required for the installation or operation of your Haiku, contact Haiku Technical Service. Note: Drawings below are not to scale.

- |                               |                                     |                                    |
|-------------------------------|-------------------------------------|------------------------------------|
| ① Mounting bracket            | ⑪ Mounting hardware                 | ⑫ Airfoil hardware                 |
| ② Canopy                      | • 4 mm Self tapping screw           | • (6) M5 Airfoil screw             |
| ③ Mounting ball & wedge       | • 6 mm Steel pin                    | • (6) 5 mm Lock washer             |
| ④ Extension tube <sup>1</sup> | • (6) M4 x 6 mm Screw <sup>3</sup>  | • (6) Airfoil grommet <sup>5</sup> |
| ⑤ Lower cover                 | • (2) M4 Lock washer                | ⑬ Wiring hardware                  |
| ⑥ (3) Airfoil                 | • Safety cable shackle <sup>4</sup> | • (4) Wire nut                     |
| ⑦ Fan hub                     | • (2) Motor bracket                 | • Cable tie                        |
| ⑧ Wiring cover                | • M6 x 32 mm Bolt                   |                                    |
| ⑨ Remote control              | • M6 x 28 mm Bolt                   |                                    |
| ⑩ EMI filter <sup>2</sup>     | • (2) M6 Nut                        |                                    |

1. Both 7-inch (17.8 cm) and 20-inch (50.8 cm) extension tubes included.
2. If the EMI filter is included with your fan (country dependent), please install it with your fan.
3. Use (2) unpainted screws in step 4. Use (4) painted screws in step 12.
4. Safety cable not shown.
5. Haiku Bamboo only.

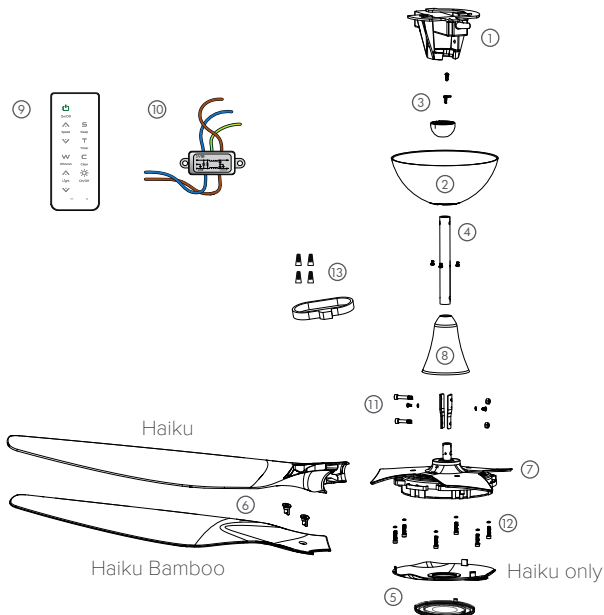

# PREPARATION

---

Before assembling and operating your fan, review the following tips and guidelines to ensure a safe and easy installation, particularly the safety guidelines on page ii. If you are not completely comfortable or have questions about any aspect of the installation process, consult a structural engineer or electrical contractor or contact Haiku Technical Service before beginning installation.

## Unpacking the fan

As you remove the fan from its packaging, make sure you are not missing any components required for assembly and operation. Refer to the fan diagram and the Parts and Hardware section for a list of components. If you are missing a part required for installation, contact Haiku Technical Service.



**If you ordered multiple fans, be sure to keep the components of each fan together! Certain fan components are not interchangeable.**

## Determining fan location

Consider the following guidelines as you decide where to install your Haiku:

- Do not mount the fan in an environment that is excessively dusty, conductive, corrosive, or gas-filled, near strong chemicals or solvents, or where there is excessive heat, shock, or vibration.
- Do not install the fan near open flames such as those from a gas stove.
- The ceiling should be stable with no high vibrations, shaking, or heavy impacts.
- Install the fan so that the airfoils are at least 7 ft (2.1 m) above the floor.
- Make sure the space around the fan has a clearance of at least 2 ft (0.6 m) from obstructions such as cabinets, doors, or lighting fixtures.
- Install the fan where there is an outlet box or ceiling joist that is suitable for fan support.
- The fan can be mounted on ceilings with a slope up to 33° (8:12 pitch) using an extension tube that is 20 inches (50.8 cm) or longer. If you are installing the fan with the 7-inch (17.8 cm) extension tube, the slope of the ceiling can be no more than 10° (2:12 pitch).
- If mounting the fan with the 7-inch (17.8 cm) extension tube, install the fan where it will be protected from strong winds.

## Tools needed

You will need the following tools to install the fan. If you are installing an outlet box, additional tools may be necessary. Consult the outlet box manufacturer's instructions.

- Ladder
- #1 Phillips screwdriver
- Adjustable wrench
- 5 mm Hex key (provided)
- 4 mm Hex key (provided)

## Preparing the mounting location

For mounting methods not covered in this manual, contact Haiku Customer Service.

If you are mounting your fan to a ceiling-mounted outlet box, the outlet box must be suitable for fan support. If there is not an outlet box at the location where you are installing your fan, one must be installed on a ceiling joist or beam and properly wired. At least 8" (20 cm) of wiring should be hanging from the outlet box. The illustration below shows a typical outlet box used for fan installations.

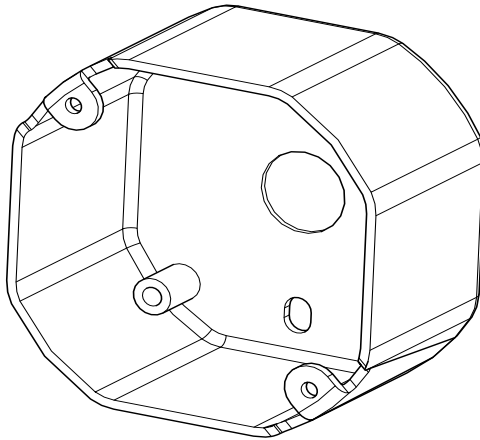



# INSTALLATION

Review the safety guidelines (p. ii) and fan location guidelines (p. 3) before installation. If you are not completely comfortable or have questions about any aspect of the installation process, consult a structural engineer or electrical contractor or contact Haiku Technical Service for assistance.

## Step 1. Installing the airfoils

Position the fan upside-down. Remove the plastic protective cover and tape from the bottom of the fan unless you are installing Haiku® with SenseME™. If installing Haiku with SenseME, leave the plastic protective cover and (4) screws on the bottom of the fan until you are ready to install the lower cover.

Moving clockwise around the fan, align each airfoil with a fan hub tab and firmly press it into place.

**Make sure that the colored stickers match the colors of the stickers on the fan hub tab.** Loosely secure the airfoils with the provided (6) airfoil screws and grommets. Once the airfoils are in position, fully tighten the screws to secure the airfoils to the fan hub.

**tip!** Visit [www.haikufan.com](http://www.haikufan.com) to view installation videos illustrating the airfoil installation process.

**!** Be careful not to damage the circuit board while installing airfoils!

### Haiku® Bamboo

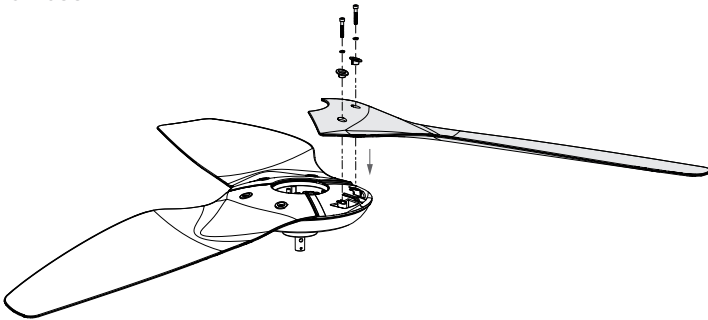

### Haiku®

**tip!** To ease airfoil installation, the (3) motor top screws can be loosened. Do not forget to retighten them!

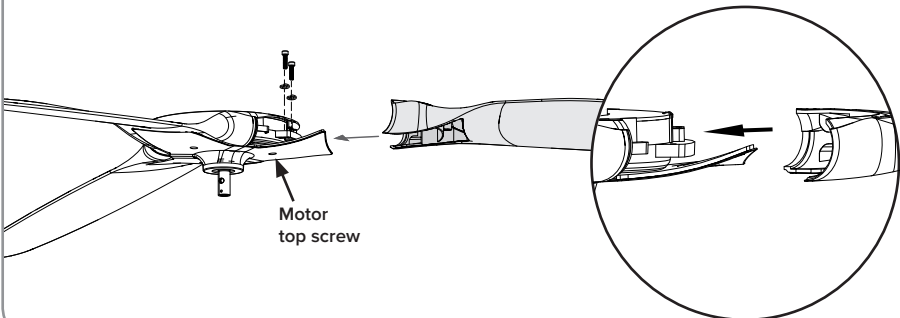

## Step 2a. Installing the lower cover (fans without SenseME™)

**!** If you purchased the wall control kit or LED light kit, proceed to the instructions included with the kit. **If installing both kits, install the wall control kit first.** Return to these instructions once the kits are installed.

### Haiku® Bamboo

*For Haiku® Bamboo, simply snap the lower cover to the bottom of the fan hub.*

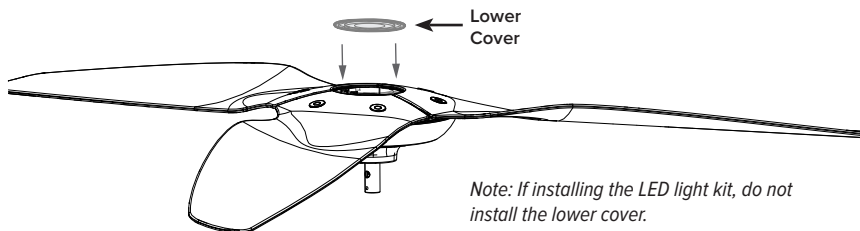

### Haiku®

*For Haiku®, position the lower cover, and then place both hands flat on the cover and turn clockwise to lock the lower cover into place.*

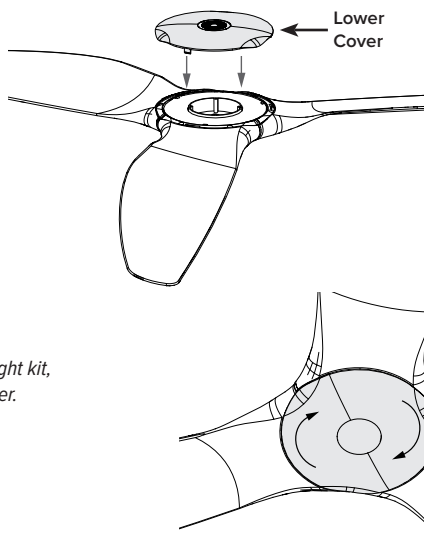

*Note: If installing the LED light kit, do not install the lower cover.*

## Step 2b. Installing the lower cover (fans with SenseME™)

**⚠** If you purchased the LED light kit, proceed to the instructions included with the kit. Return to these instructions once the kit is installed.

### Haiku® Bamboo with SenseME™

For Haiku® Bamboo with SenseME™, remove the plastic protective cover from the bottom of the fan by unscrewing the four (4) screws. Please recycle the protective cover.

Align the four slots on the lower cover with the four small round tabs on the bottom of the fan hub, and turn the lower cover clockwise to lock it into place.

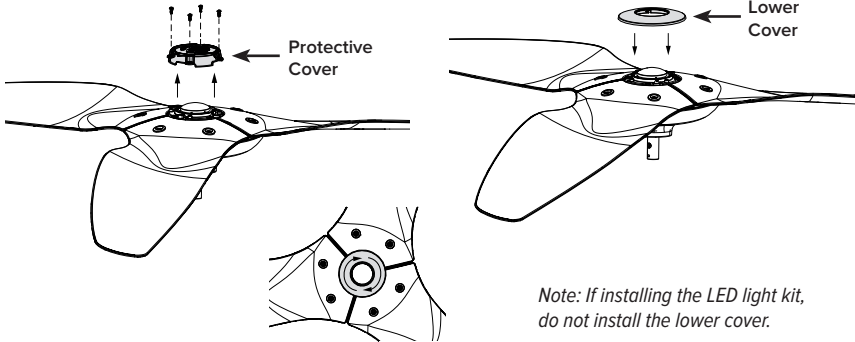

### Haiku® with SenseME™

For Haiku with SenseME, remove the plastic protective cover from the bottom of the fan by unscrewing the four (4) screws. Please recycle the protective cover.

Position the lower cover, and then place both hands flat on the cover and turn clockwise to lock the lower cover into place.

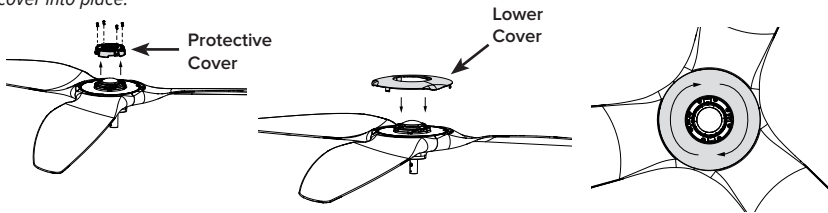

Align the four slots on the lower cover trim with the four small round tabs on the bottom of the fan hub, and turn the trim clockwise to lock it into place.

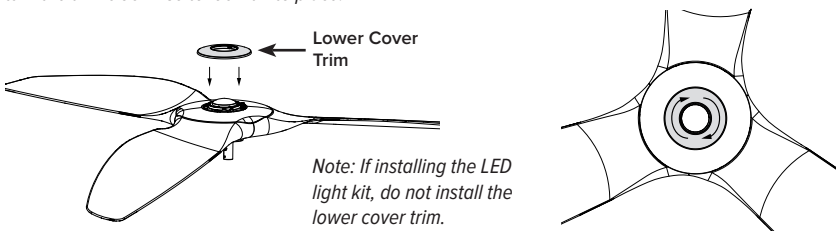

Note: If installing the LED light kit, do not install the lower cover trim.

### Step 3. Installing the extension tube

With the fan placed carefully in the upright position, loosely secure the motor brackets to the motor with M6 x 28 mm bolt (A). Install the extension tube with the M6 x 32 mm bolt (B). Securely tighten both bolts. ***Make sure the tube is installed so that the wiring connector properly mates with the connector from the fan hub.***

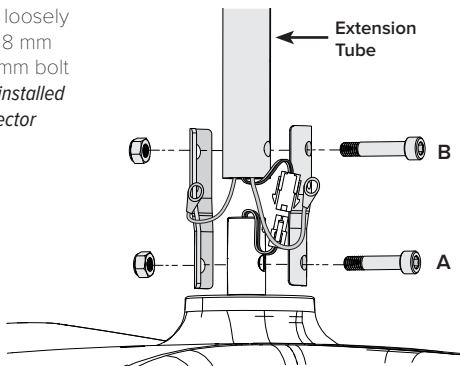

### Step 4. Connecting the safety cable and ground wire

Install the safety cable and ground wire lugs to the motor brackets with the (2) unpainted M4 x 6mm screws and lock washers. Plug the wiring harness from the extension tube into the wiring harness from the fan.

Secure the wiring harness to the motor brackets with the provided zip tie. Make sure the wires are tightly secured against the motor brackets so that the wiring cover seats properly.

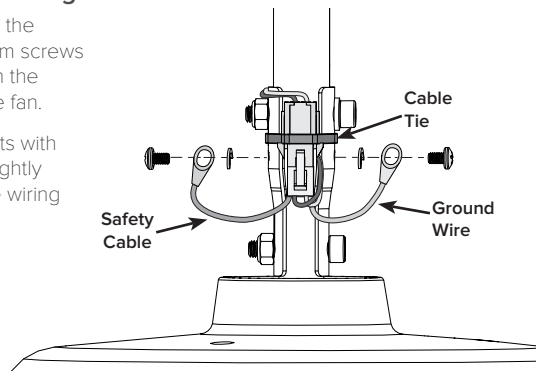

### Step 5. Preparing the wiring cover and canopy

Slide the wiring cover over the extension tube, resting it on the fan hub. Make sure there are no wires visible between the cover and the fan hub. Slide the canopy over the extension tube, temporarily resting it on the wiring cover.

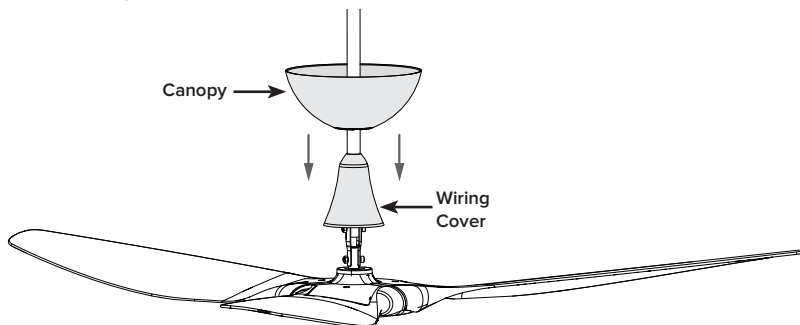

## Step 6. Installing the mounting ball

Slide the mounting ball over the extension tube (A). Insert the 6 mm steel pin into the hole at the top of the extension tube, and then slide the mounting ball upward, seating the steel pin in the inner slots (B). Insert the mounting ball wedge into the mounting ball (C). Secure the mounting wedge with the 4 mm self tapping screw. Tighten the screw enough to prevent movement between the mounting ball and extension tube. **Do not overtighten the screw.**

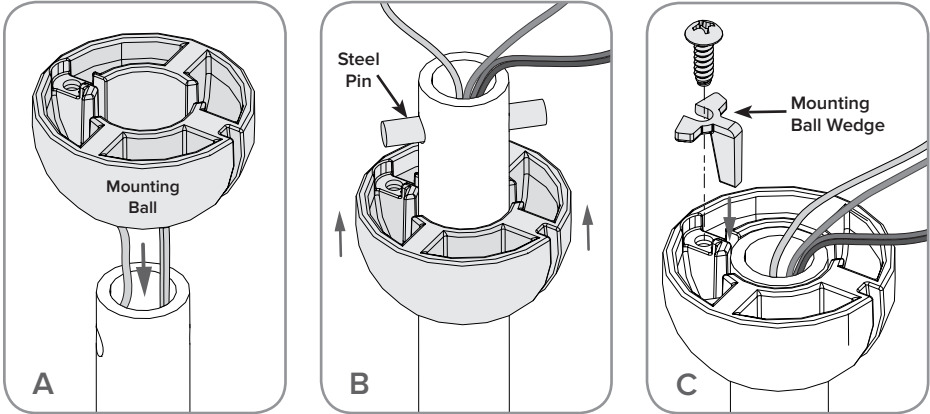

## Step 7. Installing the mounting bracket

**WARNING:** Ensure main power is disconnected from the fan location before installing the mounting bracket!

**!** The ceiling-mounted outlet box must be suitable for fan support.

Secure the mounting bracket to the outlet box with the hardware provided with the outlet box. Note: If mounting the fan to a sloped ceiling, secure the mounting bracket so that the open side of the bracket is facing upward with the slope.

## Step 8. Wiring the fan

**tip!** Allow the ground wire to hang through the mounting bracket for easy access after the extension tube is installed.

Connect the fan wires to the EMI filter (if used) and the ceiling wires by twisting the ends together and securing them with wire nuts. Refer to the charts and wiring diagrams on the following pages to determine the wire connections. Test the connection by lightly tugging on the wire nuts. **Install the fan on a switched circuit so that you can turn off the fan using a wall switch in addition to using the remote control.**

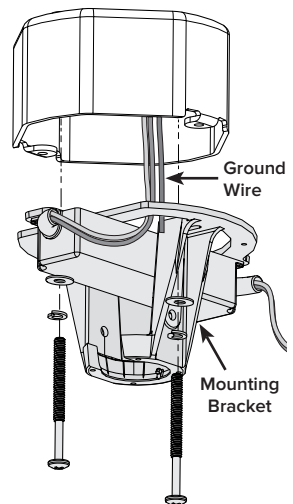

## Step 9. Hanging the fan

Raise the fan to the mounting bracket. Align the slot in the mounting ball to the rib in the mounting bracket, and then let the fan hang freely.

**Tip!** Gently twist the mounting ball to ensure it is properly seated and will not move during fan operation.

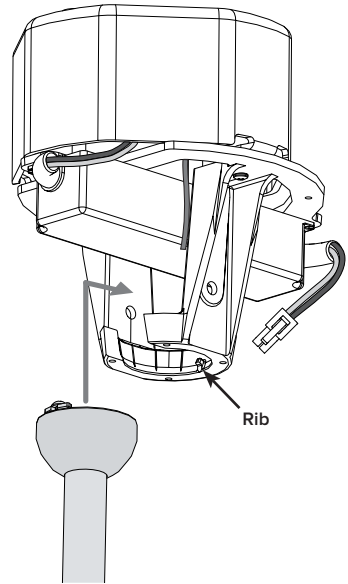
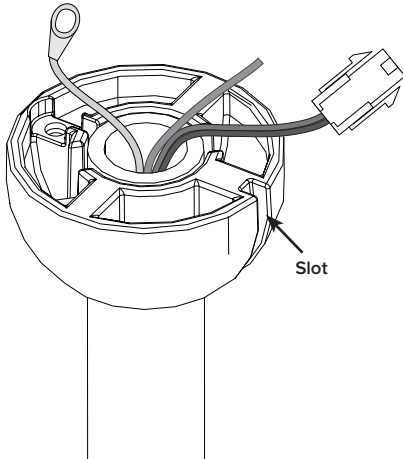

## Step 10. Connecting the fan to power

**WARNING:** Do not connect the fan to a damaged power source! Do not attempt to resolve electrical failures on your own. Consult a qualified electrician if you are uncertain about the electrical installation of this fan.

Connect the wiring harness from the power supply to the wiring harness from the extension tube as shown in the wiring diagrams on the following pages. Secure the green ground wire from the extension tube to the ground wire hanging through the mounting bracket.

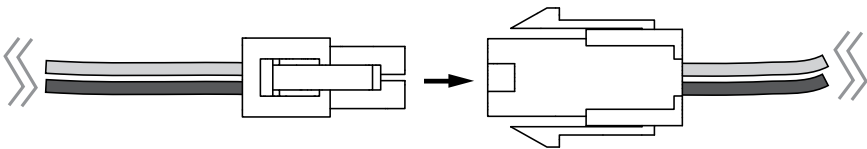

## Step 11. Securing the safety cable

Loop the safety cable around the mounting bracket, and then secure it with the safety cable shackle as shown.

**Special Note:** If you are installing the fan in **Canada**, the safety cable must be secured to an existing part of the building structure instead of the outlet box. Examples of acceptable building structures include a wooden beam or a metal mounting brace secured between two beams. In some cases, it may be necessary to install additional structural material to provide attachment points. If you have concerns about installing the safety cable, consult a structural engineer.

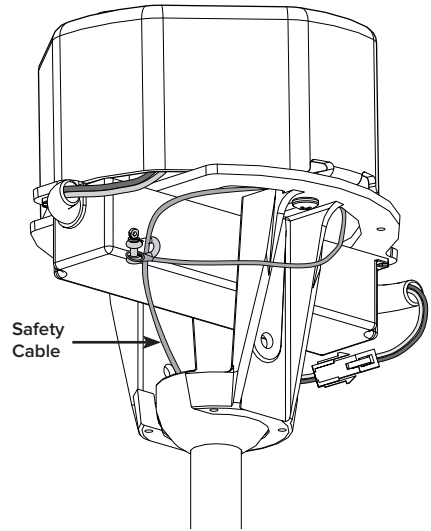

## Step 12. Installing the canopy

After connecting the fan's power supply, raise the canopy to the mounting bracket, lining up the four holes on the canopy to the holes on the bracket.

Secure the canopy to the mounting bracket with the (4) painted M4 x 6 mm screws. Ensure no wires or the safety cable are showing. Test the fan.

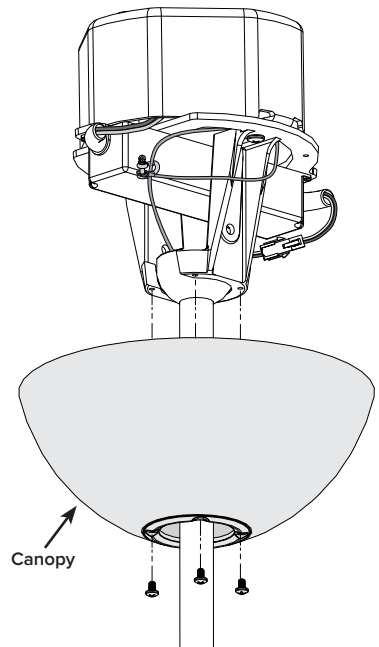

# ELECTRICAL

**WARNING:** Disconnect power to the fan location before wiring the fan!

- ⚠** Install the fan on a switched circuit so that you can turn off the fan using a wall switch in addition to the remote control.
- ⚠** Do not use the fan with a dimmer switch.

## Wiring diagram (without EMI filter)

If the EMI filter is included with your fan, follow the wiring diagram on the following page.

### Wire color chart

50/60 Hz Compatible Fan Power Supply Wire Color	AC Line (L1) Brown	AC Line/Neutral (L2/N) Blue	Earth/PE (connected to fan chassis) Green with Yellow Tracer
North America 100–120 V System	Black	White	Green or Bare Copper
North America 208–240 V System	Black, Red, or Blue	Red, Blue, or Black	Green or Bare Copper
European Union (EU), United Kingdom 220–240 V System	Brown, Black, or Grey	Blue	Green with Yellow Tracer

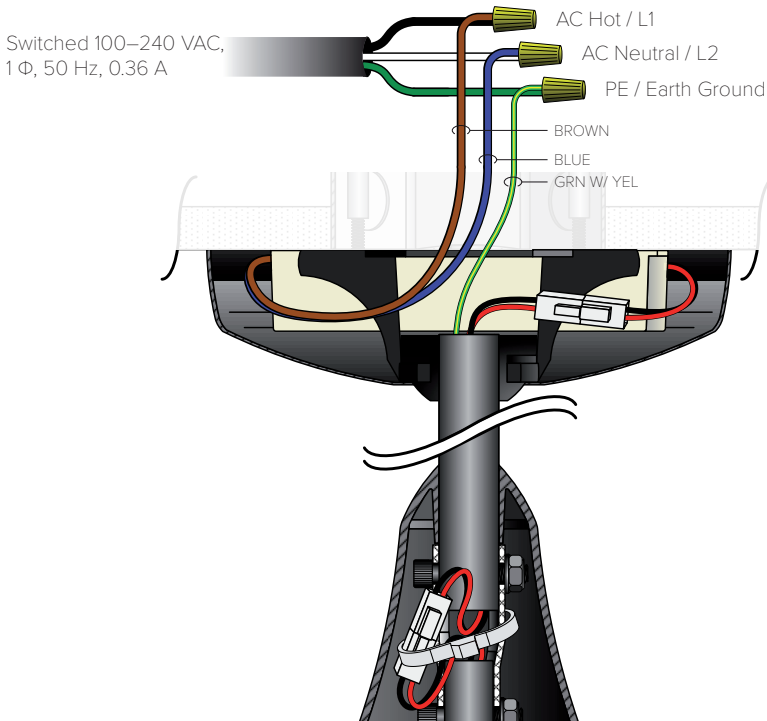



**WARNING:** Disconnect power to the fan location before wiring the fan!

- ⚠ Install the fan on a switched circuit so that you can turn off the fan using a wall switch in addition to the remote control.
- ⚠ Do not use the fan with a dimmer switch.

Wiring diagram (with EMI filter)

If the EMI filter is included with your fan (country dependent), install it with your fan.

Wire color chart

50/60 Hz Compatible Fan Power Supply Wire Color	AC Line (L1) Brown	AC Line/Neutral (L2/N) Blue	Earth/PE (connected to fan chassis) Green with Yellow Tracer
North America 100–120 V System	Black	White	Green or Bare Copper
North America 208–240 V System	Black, Red, or Blue	Red, Blue, or Black	Green or Bare Copper
European Union (EU), United Kingdom 220–240 V System	Brown, Black, or Grey	Blue	Green with Yellow Tracer

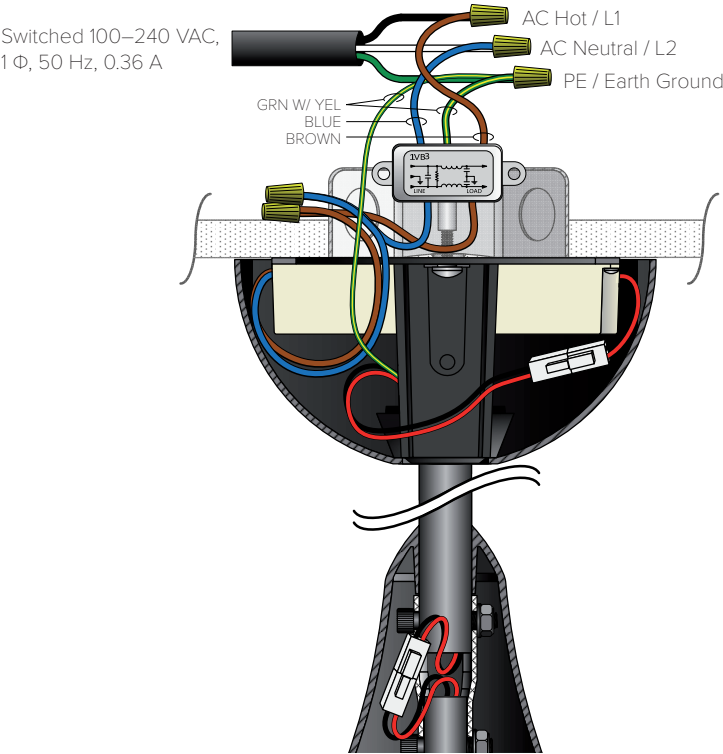

# OPERATION

Before using the Haiku remote control, remove the plastic tab in the battery tray.



*The fan mode indicators are located on the underside of the fan hub when viewed from the floor.*

## Powering the fan

To turn the fan on or off, press the On/Off button on the fan remote. This button can also be used to reset the fan's speed. *The remote must be pointing toward the fan mode indicators to function properly.*



**The fan will automatically restart at the last operating speed upon connection to the power source!**

## Replacing the remote control battery

The Haiku remote control operates on a CR 2025 3V lithium battery.

To replace the battery, on the bottom of the remote, push the small tab to the right while sliding the battery tray outward. Replace the battery, and then close the battery tray. Recycle or dispose of the old battery properly.

## Changing fan speed

Fan speed is increased or decreased by pressing the Up or Down Speed button on the remote. Seven fan speeds are available to accommodate your comfort level.

To change the fan speed, press a Speed button. The Up Speed button increases fan speed; the Down Speed button decreases fan speed. Press and hold a Speed button to step through the speeds automatically. The fan mode indicators will illuminate and a short beep will be heard until speed 7 (high) or 0 (off) is reached.

## Sleep mode

Sleep mode reduces the fan speed by one increment every hour until the lowest speed is reached. When the programmed time period ends, the fan automatically turns off. *Sleep mode is only active when Timer mode is used.*

To activate Sleep mode, set the fan speed and Timer mode, and then press the Sleep button. The Sleep indicator will illuminate. To exit Sleep mode, press the Sleep, Clear, or On/Off button.

## Timer mode

In Timer mode, the fan runs at a set speed until the programmed time period ends. Note: Timer mode is disabled if the fan speed is 0 (off) or if the fan is not running.

To set Timer mode, press the Timer button 1–7 times (once for each hour) to program the end time. During adjustment, the fan mode indicators will flash, and then the Timer setting is displayed on the speed indicator bar. To exit Timer mode, press the Clear button.

## Whoosh mode

Whoosh mode simulates natural, relaxing breezes by automatically varying the fan speed in a quasi-sinusoidal pattern.

To activate Whoosh mode, set the desired maximum fan speed, and then press the Whoosh button. The top Speed indicator will flash to indicate that Whoosh mode is active. To exit Whoosh mode, press the Whoosh, Speed, or On/Off button once.

Remote Front



Remote Back

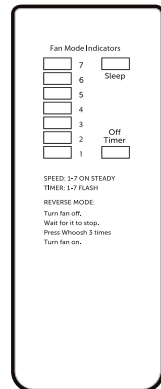

## Operating the light

The Haiku light accessory operates independently from the fan. Brightness is increased or decreased by pressing the Up or Down Light button on the remote.

**To turn the light on or off**, press the Light On/Off button on the remote. The Up Light button increases brightness; the Down Light button decreases brightness. Press and hold the Up or Down Light button to quickly increase or decrease the brightness until the desired level of illumination is reached.

## Reversing the direction of rotation

Haiku reduces heating costs in the winter by pushing warm air at the ceiling level down to floor level. Because of the aerodynamic design of Haiku's airfoils, this is done most efficiently by operating the fan in the forward direction (counterclockwise when viewed from the floor) with the speed at the slowest setting so that you do not feel a draft from the fan. If, at the slowest speed setting, a draft is still felt, the fan can be operated in the reverse direction to eliminate the draft.

**To reverse the direction of rotation**, press the On/Off button to turn off the fan. When the fan is at a complete stop, press the Whoosh button on the remote control three (3) times, and then press the On/Off button. Repeat to return the fan to forward operation. Note: The fan only operates up to speed 4 in reverse.

## Fan mode indicators

Each operating mode is indicated by a pattern on the fan mode indicator display, which is located on the bottom of the fan and is visible from the floor. The display includes an LED (light emitting diode) bar graph to indicate fan speed and Whoosh mode, and separate LEDs to indicate Timer mode and Sleep mode.

All indicators automatically turn off approximately one minute after the last button is pressed to minimize power consumption and prevent nuisance lighting at night. The indicators will display the current speed setting by default.

 *The indicators can be reactivated by pressing any button on the remote control except the On/Off button. This will not change the current operating setting.*

### Speed indicators

When the fan is running, the Speed indicator LEDs show the current fan speed (1—7). Whoosh mode is indicated when the highest set speed indicator is flashing. When all indicators are simultaneously flashing, Timer mode is active.

You can toggle the display from Speed mode to Timer mode by pressing the Timer button once. To toggle from the Timer mode to Speed mode, simultaneously press the Speed button and Whoosh button once. See the previous page for instructions on changing fan speed.

### Sleep mode indicator

The Sleep LED indicates that Sleep mode is active. A flashing Sleep LED indicates that the Timer mode is being adjusted. See the previous page for instructions on using Sleep mode.

### Timer mode indicator

The Timer LED indicates that Timer mode is active. A flashing Timer LED indicates that the Timer mode is being adjusted. See the previous page for instructions on using Timer mode.

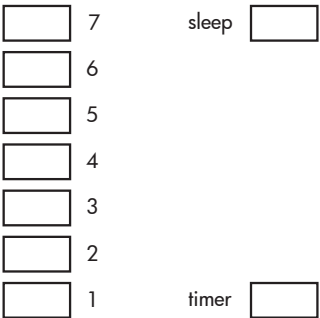

# TROUBLESHOOTING

**WARNING: To avoid electric shock, remove power from the fan before servicing!**  
**WARNING: Risk of fire, electric shock, or injury to persons during cleaning and servicing!**  
**WARNING: Do not operate fan with missing or damaged components!**

## General troubleshooting

Some issues can be resolved before requesting service. Review the below troubleshooting tips before contacting Haiku Customer Service for support.

Symptom	Possible Solution(s)
<i>The fan will not start.</i>	<ul style="list-style-type: none"><li>• Verify that supply power is adequate. Check your circuit breaker or fuse and wall switch for functionality.</li><li>• Make sure that all wires are securely connected and the fan is properly wired to a grounded outlet box.</li></ul>
<i>The fan is noisy during operation.</i>	<ul style="list-style-type: none"><li>• Check all mounting and fan hardware. If loose, tighten.</li><li>• For Haiku Bamboo fans, remove the airfoil to ensure the colored sticker matches the sticker on the fan hub. For Haiku fans, remove the bottom cover and ensure the colored sticker on the bottom of the airfoil matches the sticker on the fan tab. If necessary, move the airfoils to the matching hub attachment points.</li><li>• Make sure that all mounting hardware is secure and tight.</li><li>• Make sure that all the airfoils are aligned properly and securely fastened to the fan hub.</li><li>• If an airfoil is damaged, contact Haiku Customer Service. Note: Airfoils must be replaced as a set. Do not replace individual airfoils.</li><li>• If you installed multiple fans, ensure the serial numbers on the airfoils match the serial number on the fan hub.</li><li>• Ensure the mounting ball is properly seated in the mounting bracket.</li></ul>
<i>The fan does not produce airflow.</i>	<ul style="list-style-type: none"><li>• Make sure the airfoils are aligned properly.</li><li>• Make sure the fan is rotating counterclockwise when viewed from the floor.</li></ul>
<i>The fan jerks upon startup.</i>	<ul style="list-style-type: none"><li>• This is normal and may happen occasionally upon startup. An initial slight jerking forward and backward does not affect fan operation.</li></ul>

# MAINTENANCE

**WARNING: Disconnect the fan from power before servicing!**

## Annual maintenance

Please take a few moments each year to perform the following preventative maintenance procedures on your fan to ensure its safe and efficient operation. If you have any questions, require assistance with your fan, or need replacement parts, contact Haiku Customer Service at [www.haikufan.com/service](http://www.haikufan.com/service).

Note: Actual fan setup may differ from the illustration below.

- Check that the safety cable is properly installed by sliding the canopy down the extension tube, and then examining the safety cable and hardware.
- Make sure the mounting hardware is securely fastened to the outlet box.
- Make sure the hardware securing the airfoils to the fan hub is securely fastened.
- Dust the airfoils regularly. If the fan becomes dirty, clean it with a damp cloth and ordinary soap and water. Do not use solvents, gasoline, or any other chemical cleaners! These may cause surface distortion and damage to the fan.
- Make sure the wiring harnesses are secure and the ground wire is securely connected.

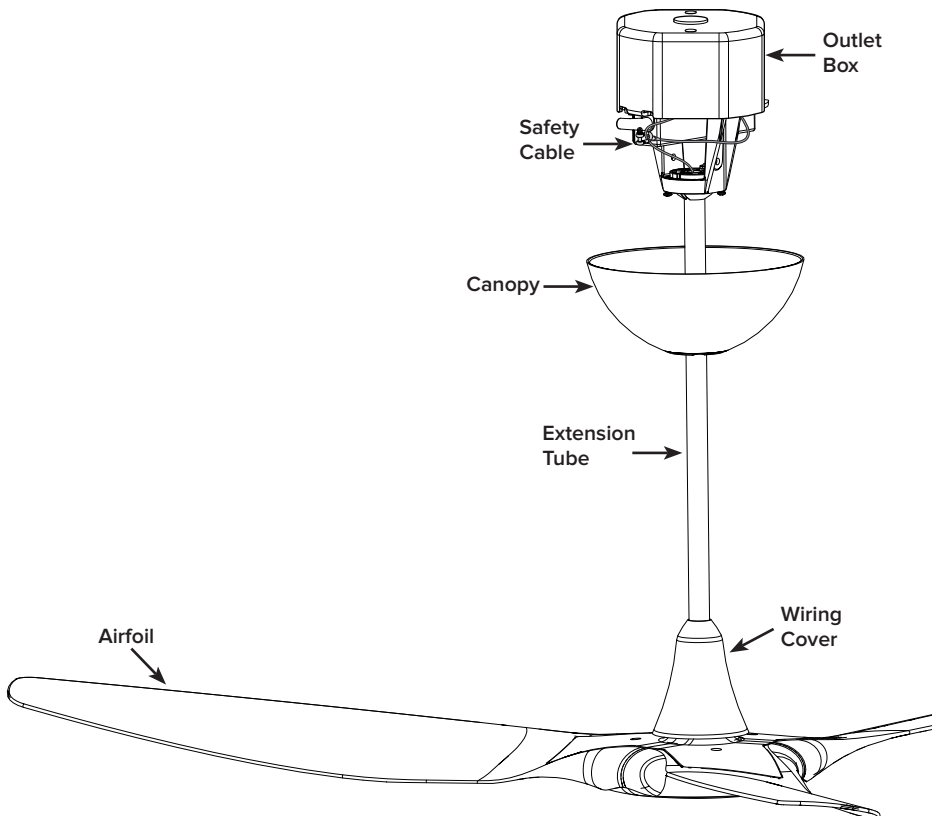







**BIGASS<sup>®</sup>**  
FANS

*No Equal*

[www.haikufan.com](http://www.haikufan.com)

© 2013 Delta T Corporation



004446-01