



STUCCO CEMENT BOARD COATINGS

09 93 63

STUCCO CEMENT BOARD COATINGS ARE APPLIED OVER A HIGH STRENGTH WATER-MANAGED ASTM C1325 OR C1186 CEMENT BOARD. THE APPLICATION PROVIDES HIGH IMPACT AND WEATHER RESISTANCE WHERE EXTERIOR INSULATION VALUE IS NOT REQUIRED.

THE CEMENT BOARD INSTALLS EASILY OVER APPROVED FRAMING AND SUBSTRATES USING ONE OF TWO METHODS:

- OVER AN APPROVED STRUCTURAL SHEATHING IN CONDITIONED NORTHERN CLIMATES.
- DIRECTLY TO STRUCTURALLY-CONTROLLED FRAMING IN SOUTHERN CLIMATES (BELOW 4000 HEATING DEGREE DAYS) OR UNCONDITIONED NORTHERN CLIMATES.

FEATURES & BENEFITS

- EASILY APPLIED
- DURABLE SURFACING SYSTEM
- IMPACT RESISTANT

SYSTEM USES

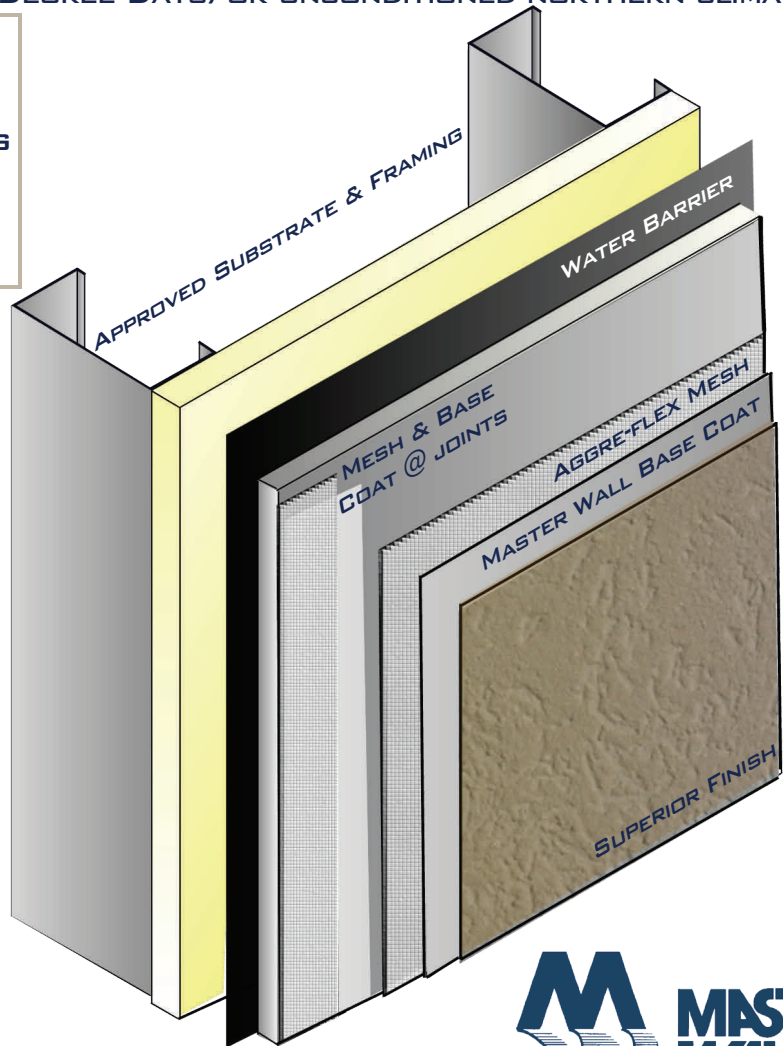

FULL SPECIFICATIONS & DETAILS AVAILABLE AT
WWW.MASTERWALL.COM



P. O. Box 397
 FORTSON, GA 31808
 800-755-0825
 TECHNICAL 800-760-2861
WWW.MASTERWALL.COM

STUCCO CEMENT BOARD COATINGS SHORT FORM SPECIFICATION

09 93 63



1.0 GENERAL

THIS IS A SHORT FORM SPECIFICATION. REFER TO STUCCO CEMENT BOARD COATINGS SPECIFICATIONS AND DETAILS FOR ADDITIONAL INFORMATION.

1.1 SYSTEM DESCRIPTION

THE MASTER WALL STUCCO CEMENT BOARD COATINGS CONSISTS OF A REINFORCED BASE COAT AND TEXTURED FINISH APPLIED OVER A CEMENT BOARD SUBSTRATE MEETING ASTM C-1325 SUCH AS NATIONAL GYPSUM PERMABASE®, JAMES HARDIE HARDIPANEL® SMOOTH OR USG DUROCK®.

1.2 DESIGN REQUIREMENTS:

- A. REFERENCE MASTER WALL SUGGESTED DETAILS AND ARCHITECTURAL DRAWINGS FOR SPECIFIC DETAIL REQUIREMENTS.
- B. STUCCO CEMENT BOARD COATINGS INSTALLED BELOW THE 4000 HEATING DEGREE DAY LINE AND UNCONDITIONED INSTALLATIONS IN NORTHERN CLIMATES MAY BE APPLIED DIRECTLY TO THE FRAMING/WEATHER-RESISTIVE BARRIER.
- C. SLOPE ALL TRIM BANDS AND SURFACES A MINIMUM OF 1:2 (6" IN 12") TO SHED WATER, MAXIMUM 12" (305MM) WIDE.
- D. MAXIMUM DEFLECTION OF SUBSTRATES AND FRAMING SHALL NOT EXCEED L/240.
- E. TYPICAL ACCEPTABLE SHEATHINGS FOR STRUCTURAL OR FIRE RESISTANCE INCLUDE DENS GLASS GOLD® (ASTM C-1177), FIBERROCK® OR EXTERIOR GYPSUM SHEATHING (ASTM C-79).
- F. A CODE-APPROVED WEATHER-RESISTIVE BARRIER IS REQUIRED OVER THE FRAMING OR SHEATHING AND BEFORE CEMENT BOARD APPLICATION.
- G. EXPANSION JOINTS ARE REQUIRED AT BUILDING EXPANSION JOINTS, PANEL JOINTS, FLOOR LINES IN WOOD FRAMED CONSTRUCTION, AND OTHER AREAS WHERE SIGNIFICANT MOVEMENT OCCURS.
- H. CONTROL JOINTS ARE REQUIRED TO BE LOCATED BY THE DESIGNER. REFERENCE MASTER WALL SPECIFICATIONS FOR SPECIFIC RECOMMENDATIONS.
- I. DETAIL AND INSTALL TRIM ACCESSORIES ACCORDING TO THE APPROVED TRIM MANUFACTURER'S REQUIREMENTS (PLASTIC COMPONENTS, VINYL CORP. OR APPROVED EQUAL).

1.3 LIMITATIONS:

- A. CRACKING DUE TO DIMENSIONAL STRESS AT BOARD JOINTS MAY APPEAR IN THE FINISHED EXTERIOR SURFACE IF CONTROL JOINTS ARE NOT PROPERLY LOCATED FOR THE REGIONAL CLIMATE CONDITIONS AND STRUCTURAL MOVEMENT.
- B. PLANAR IRREGULARITIES IN FRAMING MAY BE MORE VISIBLE THAN WITH OTHER APPLICATIONS.
- C. SECONDARY WEATHER-RESISTIVE BARRIER IS REQUIRED UNDER THE CEMENT BOARD.

1.3 LIMITATIONS (CONTINUED):

- D. CEMENT BOARD MANUFACTURER SHOULD BE CONSULTED FOR STRUCTURAL REQUIREMENTS.
- E. DEPENDING UPON FRAMING AND CLIMATE, SOME READ-THROUGH OF FRAMING AND/OR FASTENERS MAY OCCUR.
- F. APPLICATIONS ARE LIMITED TO RESIDENTIAL AND LOW-RISE COMMERCIAL INSTALLATIONS.

1.4 QUALITY ASSURANCE

- A. COATINGS SHALL BE TESTED FOR: ACCELERATED WEATHERING, MILDEW RESISTANCE, SALT SPRAY RESISTANCE AND STRUCTURAL PERFORMANCE.
- B. COATINGS SHALL HAVE BEEN TESTED FOR FIRE PERFORMANCE IN ACCORDANCE WITH ASTM E-84.

1.5 JOB CONDITIONS

- A. STORE ALL MATERIALS PROTECTED FROM WEATHER AND DIRECT SUNLIGHT AT TEMPERATURES ABOVE 40°F (5°C).
- B. THE AMBIENT AND WALL TEMPERATURE SHALL BE A MINIMUM OF 40°F (5°C) AND SHALL REMAIN SO FOR AT LEAST 24 HOURS AFTER INSTALLATION.

2.0 PRODUCTS

ALL COMPONENTS OF THE STUCCO CEMENT BOARD COATINGS SHALL BE MANUFACTURED BY MASTER WALL AND SUPPLIED BY AN AUTHORIZED DISTRIBUTOR.

A. MASTER WALL BASE COATS:

- 1. *FOAM & MESH ADHESIVE (F&M)*: A 100% PURE ACRYLIC-BASED ADHESIVE THAT IS FIELD MIXED WITH PORTLAND CEMENT.
- 2. *F&M PLUS*: A HIGH-BUILD 100% PURE ACRYLIC-BASED FIBER REINFORCED ADHESIVE THAT IS FIELD MIXED WITH PORTLAND CEMENT.
- 3. *MASTER WALL BAGGED BASE (MBB)*: A READY TO USE DRY BASE THAT IS FIELD MIXED WITH WATER.

B. *AGGRE-FLEX MESH*: SELF ADHESIVE MESH AND STANDARD MESH.

C. *SUPERIOR FINISH*: 100% PURE ACRYLIC FORMULATION WITH INTEGRAL COLOR AND TEXTURE. PERFECT, SPRAY, DESERT SAND, R-COARSE AND REFINISH TEXTURES.

D. MASTER WALL COATINGS:

- 1. *PRIMECOAT*: A WATER-BASED PRIMER.
- 2. *ROLLER-FLEX*: A WATER-BASED ARCHITECTURAL FINISH COATING.

3.0 INSTALLATION

- A. INSPECT THE CEMENT BOARD TO ENSURE THAT IT IS FREE OF ALL FOREIGN MATERIALS THAT WOULD AFFECT THE ADHESION OF MASTER WALL PRODUCTS.
- B. APPLY THE PRODUCTS IN STRICT ACCORDANCE WITH MASTER WALL SPECIFICATIONS, PRODUCT DATA SHEETS, ARCHITECTURAL DRAWINGS AND ARCHITECTURAL SPECIFICATIONS.

SEE FULL SPECIFICATIONS AND
DETAILS EITHER ON THE WEB AT
WWW.MASTERWALL.COM OR ON OUR
ELECTRONIC PRODUCT BINDER CD