

GENERAL NOTES

- *SEAL ALL SEAMS WITH DUPONT TYVEK® TAPE
- *FASTEN DUPONT™ TYVEK® COMMERCIALWRAP® WITH DUPONT™ TYVEK® WRAP CAPS
- *LOCAL LAWS, ZONING, AND BUILDING CODES VARY AND THEREFORE GOVERNS OVER MATERIAL SELECTION AND DETAILING SHOWN BELOW.

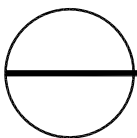
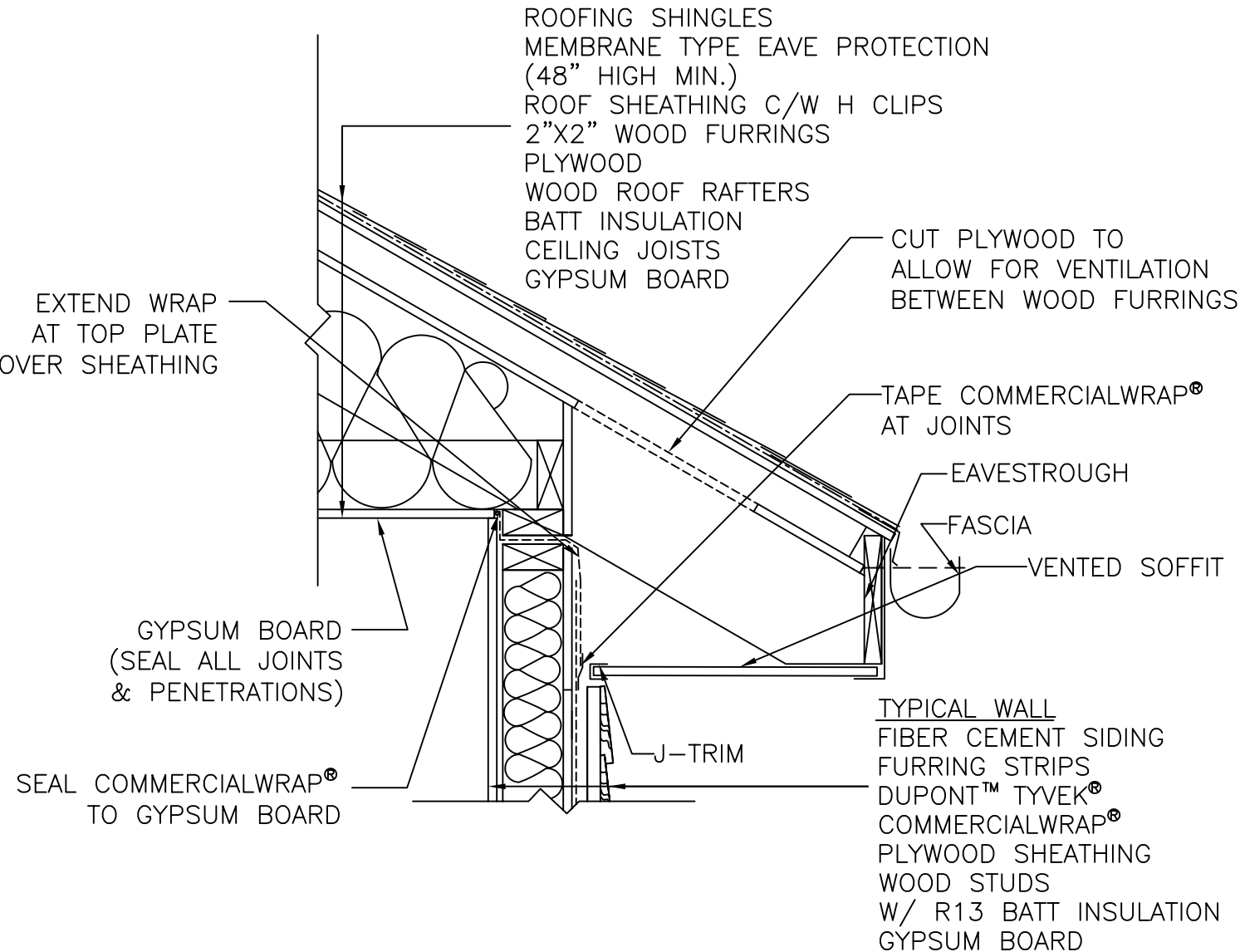

ROOF/ WALL INTERFACE DETAIL

WOOD FRAME STRUCTURE W/ FIBER CEMENT SIDING (COOLING CLIMATE)