

PROFESSIONAL RAILING SYSTEMS & COMPONENTS



TACO METALS CONTEMPORARY DESIGN, HIGH QUALITY STAINLESS STEEL & GLASS RAILING SYSTEMS ARE SLEEK AND TIMELESS!

LOGICAL CHOICE FOR PROFESSIONAL RAILING SYSTEMS



- TACO railing systems and components are engineered to meet the highest international quality standard.
- Innovation, style and workmanship that is in a class of it's own.
- High tolerance machined components mean consistent quality for optimum fit and function.
- Faster and more profitable projects with reduced labor and installation time.
- Recognized by leading designers and contractors worldwide.

LARGE INVENTORY FOR IMMEDIATE AVAILABILITY



- All products shown are well stocked and ready for immediate availability.
- TACO's 168,000 square foot main manufacturing & distribution facility is located in Sparta, TN for service to 70% of the U.S. within 1-2 shipping days.
- Additional TACO regional sales and distribution facilities are located in Taunton, MA and Orlando, FL
- 24-hour turn around service on most orders.
- Special packaging and handling to ensure quality care.
- On-time and complete shipments to meet tight schedules.
- TACO-dedicated transport carriers deliver direct.



TACO METALS 50 YEARS OF QUALITY ARCHITECTURAL PRODUCTS

IN-HOUSE TECHNICAL SERVICE AND SUPPORT



- Knowledgeable TACO technical sales and service representatives are available for assistance with design and installations specific to customer's project needs.
- Test data and recommended specifications are available to meet code requirements and allow for a safe and professional installation.

VALUE-ADDED MANUFACTURING CAPABILITIES



- TACO offers fast turn around in-house services to simplify your fabrication needs.
- Special order cut to length, drilling, finishing, assembly and packaging available.

TACORAILING.COM



- Visit TACOrailing.com for all the information needed for your next design project, including CAD drawings, CSI specifications and Technical support.

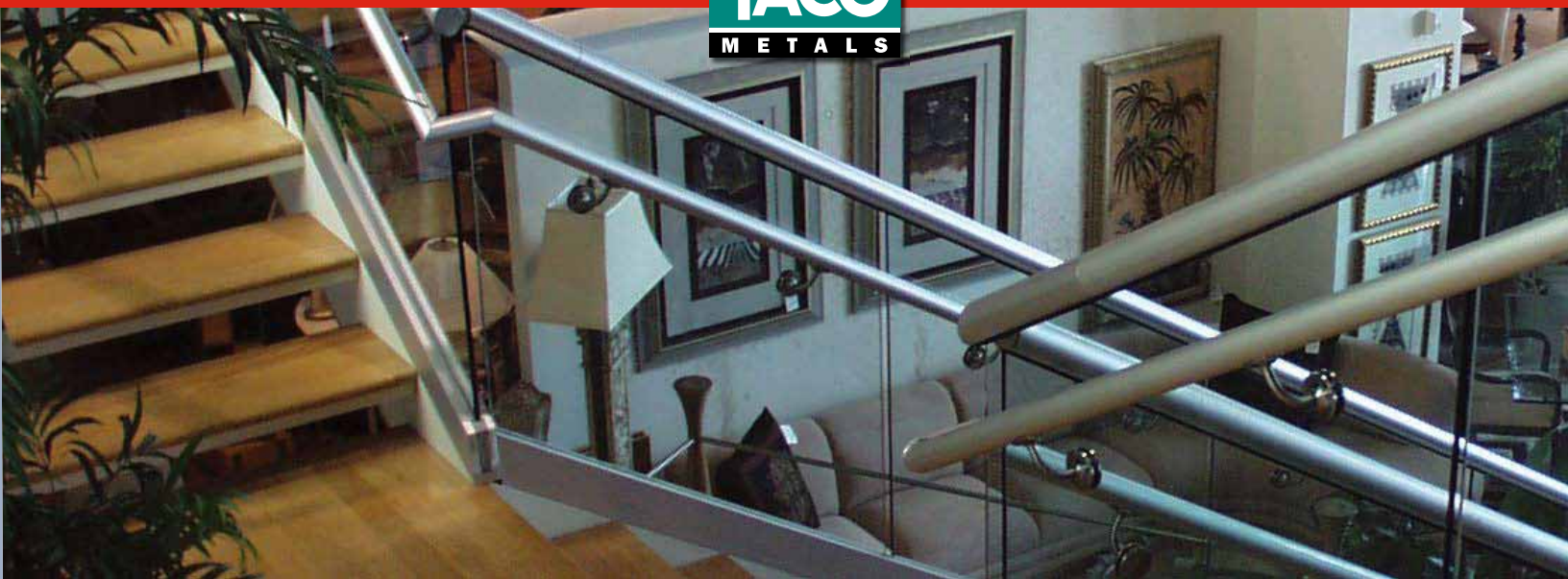

TABLE OF CONTENTS

RAILING SYSTEMS

6-17

Railing Components.....6

Handrail Brackets.....	8
Flush Mount Adapters.....	10
End Caps	11
Flush Angles	12
Outlets, Tees & Connectors	13
Baluster Brackets.....	14
Baluster Post & Accessories	15

Tube16

Value-Added Fabrication17

GLASS INFILL SYSTEMS

18-27

Glass Clamps20

Stainless Steel	20
Zinc Die Cast.....	22

Glass Fittings & Adapters24

Glass Clamp Accessories26

CABLE INFILL SYSTEM

28-29

Cable Railing Components.....29

Cable.....	29
Turnbuckle Assemblies.....	29

TABLE OF CONTENTS

GLASS RAILING SYSTEMS

30-37



Rail Base & Components.....32

Rail Base 32

Glasswedge™ Base System 33

Cladding, Trim & End Caps 33

Top Rail & Components.....34

Top Rail 34

Corners 35

End Caps 36

Connectors 36

Glass Railing Components37

Glass Mount Handrail Brackets 37

GLASS CANOPY SYSTEMS

38-39



Glass Canopy System.....39

Glass Canopy System Components 39

REFERENCE DATA

40-43

Metric Converter 40

Terms & Conditions 41

Index.....42-43

Sample Displays43



TACO introduces Q-Railing Systems: Professional railing systems that are uniquely designed and manufactured to make your railing projects easier, faster and more profitable.

Our railing components are designed to fit precisely without welding for clean and easy installations and in-field layouts.

These precision railing components can be cleanly connected with glue, eliminating the hazard, expense and time associated with welding.

All TACO tube and railing components must pass extensive quality standards and ensure consistent quality components that is guaranteed.



RAILING SYSTEMS

RAILING SYSTEMS



PART NUMBER

14 - XXXX - 000 - 12

Finish
Tube (mm)
Model
Material

MATERIAL

10 = ZINC 13 = STAINLESS STEEL 304 14 = STAINLESS STEEL 316

FINISH

10 = Mirror Polished STAINLESS STEEL (Special Order) **12 = Brushed STAINLESS STEEL** **00 = Unfinished ZINC** **19 = Brushed Stainless Look ZINC**

SYMBOLS



STANDARD PACKAGING



HANDRAIL BRACKETS

STAINLESS STEEL, BRUSHED*



MODEL 0138

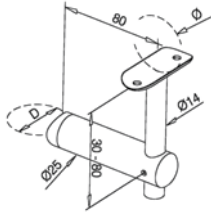

TUBE MOUNT

STAINLESS STEEL 304

PART #	TUBE (D)	SADDLE TYPE	SADDLE TUBE (Ø)
13-0138-038-12	1.5"	Tube	1.5"
13-0138-050-12	2.0"	Tube	2.0"



MODEL 0111

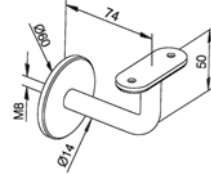

WALL MOUNT W/ CONCEALED FASTENER

STAINLESS STEEL 316

PART #	SADDLE TYPE	SADDLE TUBE (Ø)
14-0111-000-12	Flat	—
14-0111-038-12	Tube	1.5"
14-0111-050-12	Tube	2.0"



MODEL 0111

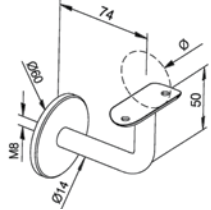

MODEL 0112

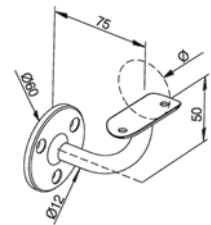

WALL MOUNT

STAINLESS STEEL 316

PART #	SADDLE TYPE	SADDLE TUBE (Ø)
14-0112-038-12	Tube	1.5"
14-0112-050-12	Tube	2.0"

INFORMATION

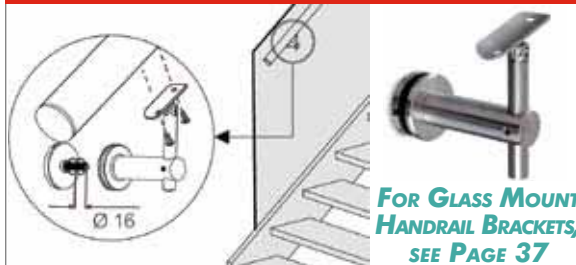

HANDRAIL BRACKETS

STAINLESS STEEL 316, BRUSHED*

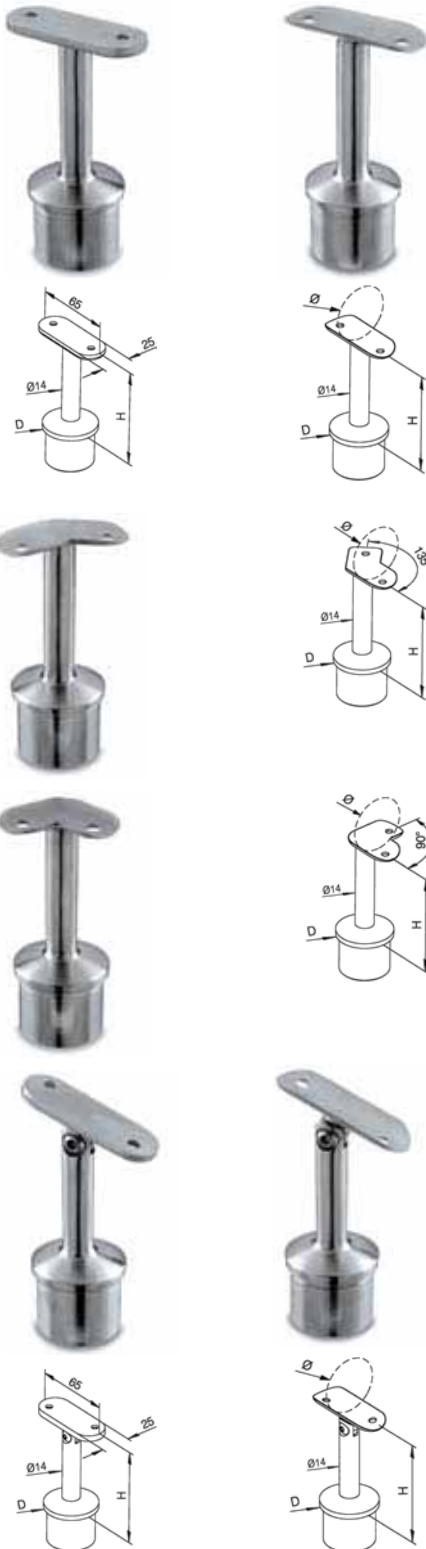

POST MOUNT

PART #	TUBE (D)	HEIGHT (H)	SADDLE TYPE	SADDLE TUBE (Ø)
14-0702-000-12	Ø 1.5" x .078"	80 mm (3.15")	Flat	—
14-0702-038-12	Ø 1.5" x .078"	80 mm (3.15")	Tube	1.5"
14-0702-050-12	Ø 1.5" x .078"	80 mm (3.15")	Tube	2.0"
14-0703-000-12	Ø 2.0" x .078"	80 mm (3.15")	Flat	—
14-0703-050-12	Ø 2.0" x .078"	80 mm (3.15")	Tube	2.0"

POST MOUNT W/135° SADDLE

PART #	TUBE (D)	HEIGHT (H)	SADDLE TYPE	SADDLE TUBE (Ø)
14-0702-338-12	Ø 1.5" x .078"	80 mm (3.15")	Tube	1.5"
14-0702-350-12	Ø 1.5" x .078"	80 mm (3.15")	Tube	2.0"
14-0703-350-12	Ø 2.0" x .078"	80 mm (3.15")	Tube	2.0"

POST MOUNT W/90° SADDLE

PART #	TUBE (D)	HEIGHT (H)	SADDLE TYPE	SADDLE TUBE (Ø)
14-0702-838-12	Ø 1.5" x .078"	80 mm (3.15")	Tube	1.5"
14-0702-850-12	Ø 1.5" x .078"	80 mm (3.15")	Tube	2.0"
14-0703-850-12	Ø 2.0" x .078"	80 mm (3.15")	Tube	2.0"

POST MOUNT W/ADJUSTABLE SADDLE

PART #	TUBE (D)	HEIGHT (H)	SADDLE TYPE	SADDLE TUBE (Ø)
14-0705-000-12	Ø 1.5" x .078"	80 mm (3.15")	Flat	—
14-0706-000-12	Ø 2.0" x .078"	80 mm (3.15")	Flat	—
14-0705-038-12	Ø 1.5" x .078"	80 mm (3.15")	Tube	1.5"
14-0705-050-12	Ø 1.5" x .078"	80 mm (3.15")	Tube	2.0"
14-0706-050-12	Ø 2.0" x .078"	80 mm (3.15")	Tube	2.0"

INFORMATION

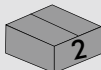

All drawings shown in metric.
See Metric Converter, Page 40



• POLISHED STAINLESS STEEL
MIRROR FINISH
AVAILABLE AS SPECIAL ORDER

FLUSH MOUNT ADAPTERS

STAINLESS STEEL 316, BRUSHED*



MODEL 0739

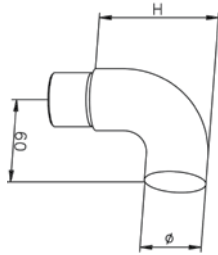

FLUSH RADIUS ENDS

PART #	TUBE (Ø)	HEIGHT (H)
14-0739-038-12	1.5" x .078"	81 mm (3.19")
14-0739-050-12	2.0" x .078"	84 mm (3.30")



MODEL 0505

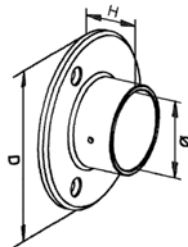

FLUSH WALL BASES

PART #	TUBE (Ø)	HEIGHT (H)
14-0505-038-12	1.5" x .078"	30 mm (1.18")
14-0505-050-12	2.0" x .078"	35 mm (1.38")

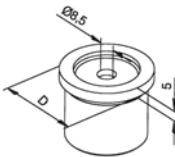

FLUSH MOUNT ADAPTER, TOP MOUNT

PART #	TUBE (D)	SADDLE TYPE
14-0722-000-12	1.5" x .078"	Flat
14-0721-000-12	2.0" x .078"	Flat

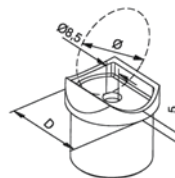

FLUSH MOUNT ADAPTER, SIDE MOUNT

PART #	TUBE (D)	SADDLE TUBE (Ø)
14-0722-038-12	1.5" x .078"	1.5"
14-0722-050-12	1.5" x .078"	2.0"
14-0721-050-12	2.0" x .078"	2.0"

INFORMATION

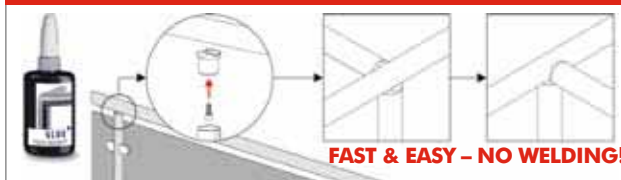

END CAPS

STAINLESS STEEL 316, BRUSHED*



MODEL 5730

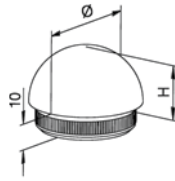

MODEL 5732

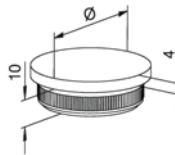

MODEL 5729

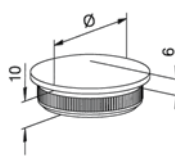

MODEL 0729

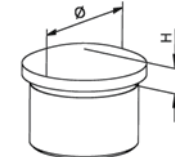

MODEL 0732

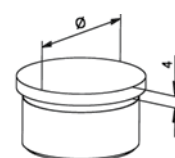

EASY-HIT END CAPS

PART #	TUBE (Ø)	HEIGHT (H)	CAP TYPE
14-5730-038-12	1.5" x .078"	21 mm (.827")	Dome
14-5730-050-12	2.0" x .078"	24 mm (.945")	Dome
14-5732-038-12	1.5" x .078"	4 mm (.157")	Flat
14-5732-050-12	2.0" x .078"	4 mm (.157")	Flat
14-5729-038-12	1.5" x .078"	6 mm (.236")	Arched
14-5729-050-12	2.0" x .078"	6 mm (.236")	Arched

INFORMATION



END CAPS

PART #	TUBE (Ø)	HEIGHT (H)	CAP TYPE
14-0729-038-12	1.5" x .078"	9 mm (.354")	Arched
14-0729-050-12	2.0" x .078"	10 mm (.393")	Arched
14-0732-038-12	1.5" x .078"	4 mm (.157")	Flat
14-0732-050-12	2.0" x .078"	4 mm (.157")	Flat

INFORMATION

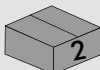

All drawings shown in metric.
See Metric Converter, Page 40



PAGE 40

•POLISHED STAINLESS STEEL
MIRROR FINISH
AVAILABLE AS SPECIAL ORDER

FLUSH ANGLES

STAINLESS STEEL 316, BRUSHED*



MODEL 0301

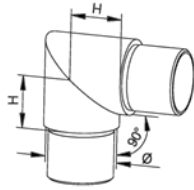

MODEL 0305

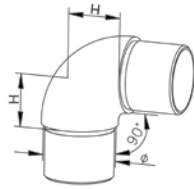

MODEL 0300

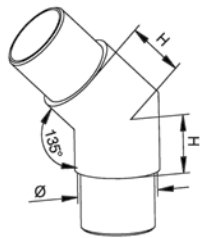

MODEL 0302

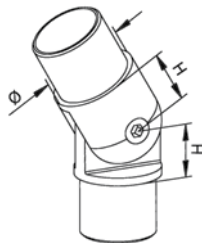

FLUSH MOUNT 90° ANGLE

PART #	TUBE (Ø)	HEIGHT (H)	ANGLE TYPE
14-0301-038-12	1.5" x .078"	30 mm (1.18")	Square
14-0301-050-12	2.0" x .078"	35 mm (1.38")	Square
14-0305-038-12	1.5" x .078"	30 mm (1.18")	Radius
14-0305-050-12	2.0" x .078"	35 mm (1.38")	Radius

FLUSH MOUNT 135° ANGLE

PART #	TUBE (Ø)	HEIGHT (H)	ANGLE TYPE
14-0300-038-12	1.5" x .078"	30 mm (1.18")	Square
14-0300-050-12	2.0" x .078"	35 mm (1.38")	Square

FLUSH MOUNT W/ADJUSTABLE ANGLE

PART #	TUBE (Ø)	HEIGHT (H)
14-0302-038-12	1.5" x .078"	27 mm (1.06")
14-0302-050-12	2.0" x .078"	30 mm (1.18")

OUTLETS & TEES

STAINLESS STEEL 316, BRUSHED*



MODEL 0304

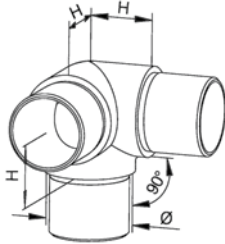

FLUSH MOUNT SIDE OUTLET 90°

PART #	TUBE (Ø)	HEIGHT (H)	ANGLE TYPE
14-0304-038-12	1.5" x .078"	30 mm (1.18")	Square
14-0304-050-12	2.0" x .078"	35 mm (1.38")	Square



MODEL 0307

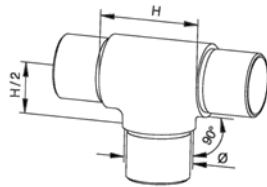

FLUSH MOUNT 90° TEE

PART #	TUBE (Ø)	HEIGHT (H)	H/2
14-0307-038-12	1.5" x .078"	60 mm (2.36")	30 mm (1.18")
14-0307-050-12	2.0" x .078"	70 mm (2.76")	35 mm (1.38")



MODEL 0790

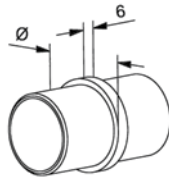

CONNECTOR

PART #	TUBE (Ø)
14-0790-038-12	1.5" x .078"
14-0790-050-12	2.0" x .078"

INFORMATION



FAST & EASY - NO WELDING!

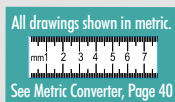
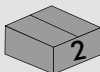

All drawings shown in metric.
See Metric Converter, Page 40



PAGE 40

*POLISHED STAINLESS STEEL
MIRROR FINISH
AVAILABLE AS SPECIAL ORDER

RAILING SYSTEMS RAILING COMPONENTS

BALUSTER BRACKETS

STAINLESS STEEL 316, BRUSHED*

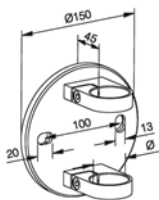

MODEL 0551

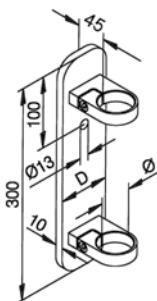

MODEL 0553

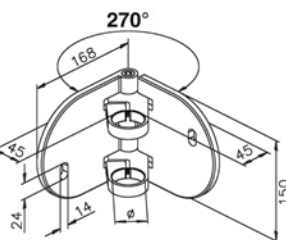

MODEL 0555

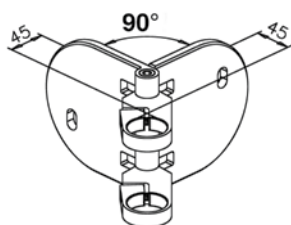

MODEL 0555

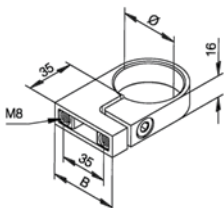

MODEL 3507

FASCIA MOUNT, ROUND

PART #	TUBE (Ø)
14-0551-038-12	1.5"
14-0551-050-12	2.0"



FASCIA MOUNT, ELONGATED

PART #	TUBE (Ø)
14-0553-038-12	1.5"
14-0553-050-12	2.0"



CORNER FASCIA MOUNT

PART #	TUBE (Ø)
14-0555-038-12	1.5"
14-0555-050-12	2.0"



CUSTOM FASCIA MOUNT

PART #	TUBE (Ø)
14-3507-038-12	1.5"
14-3507-050-12	2.0"



INFORMATION



BALUSTER POST & ACCESSORIES

STAINLESS STEEL 316, BRUSHED*

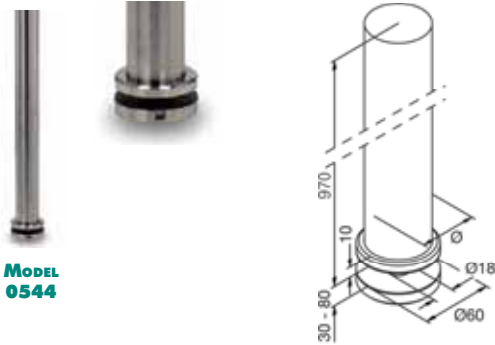

MODEL 0544

INFORMATION

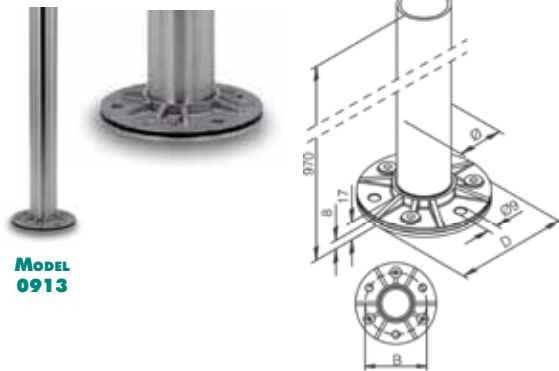
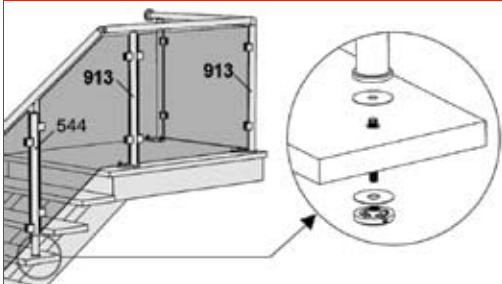

MODEL 0913

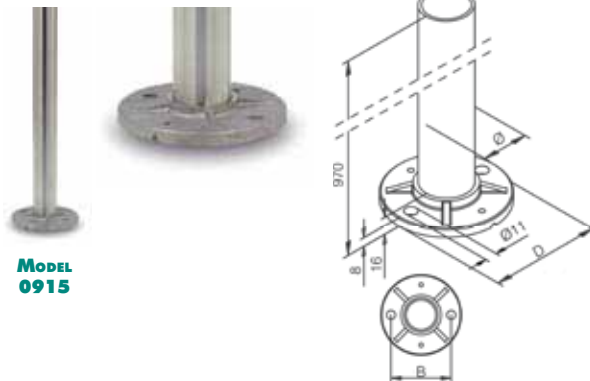

MODEL 0915

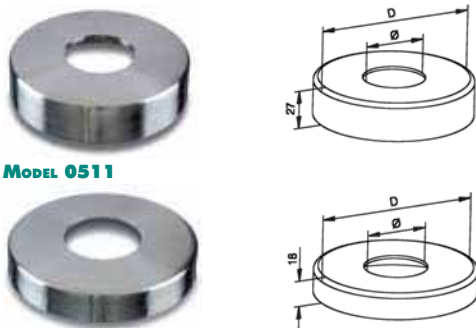

MODEL 0511

MODEL 0513

BALUSTER POST & BASE

PART #	TUBE (Ø)	B	D
14-0544-038-12	1.5" x .078"	—	—
14-0913-038-12	1.5" x .078"	80 mm (3.15")	105 mm (4.13")
14-0913-050-12	2.0" x .078"	90 mm (3.54")	115 mm (4.53")
14-0915-038-12	1.5" x .078"	90 mm (3.54")	120 mm (4.72")
14-0915-050-12	2.0" x .078"	90 mm (3.54")	120 mm (4.72")
14-0913-438-12	1.5" x .156"	80 mm (3.15")	105 mm (4.13")
14-0913-450-12	2.0" x .156"	90 mm (3.54")	115 mm (4.53")
14-0915-438-12	1.5" x .156"	90 mm (3.54")	120 mm (4.72")
14-0915-450-12	2.0" x .156"	90 mm (3.54")	120 mm (4.72")



BALUSTER CANOPY

PART #	TUBE (Ø)	D	MATES W/MODEL
14-0511-038-12	1.5"	110 mm (4.33")	0913
14-0511-050-12	2.0"	120 mm (4.72")	0913
14-0513-038-12	1.5"	125 mm (5")	0915
14-0513-050-12	2.0"	125 mm (5")	0915



All drawings shown in metric.
See Metric Converter, Page 40

• POLISHED STAINLESS STEEL
MIRROR FINISH
AVAILABLE AS SPECIAL ORDER

TUBE

STAINLESS STEEL, BRUSHED •



STAINLESS STEEL TUBE

FITS RAILING SYSTEMS' COMPONENTS

STAINLESS STEEL 316

PART #	A	B	LENGTH
S14-1278SS164B	1.5"	.078"	5 m (16' 4")
S14-2078SS164B	2.0"	.078"	5 m (16' 4")

STAINLESS STEEL 304

PART #	A	B	LENGTH
S14-1278SS164	1.5"	.078"	5 m (16' 4")
S14-2078SS164	2.0"	.078"	5 m (16' 4")



TACO offers superior quality tube. Our tube has a significantly lower tolerance than standard commercial tube. The welding seam has been specially adapted for our fittings to ensure a perfect fit. Each tube section is packaged to prevent damage and ensure quality.



• POLISHED STAINLESS STEEL
MIRROR FINISH
AVAILABLE AS SPECIAL ORDER

VALUE-ADDED FABRICATION

*TACO provides value-added fabrication services to simplify job installations.
Contact a TACO representative for more information.*

Cut to length



Pre-drilled holes for mounting hardware



Automated CNC for precision
cutting & machining

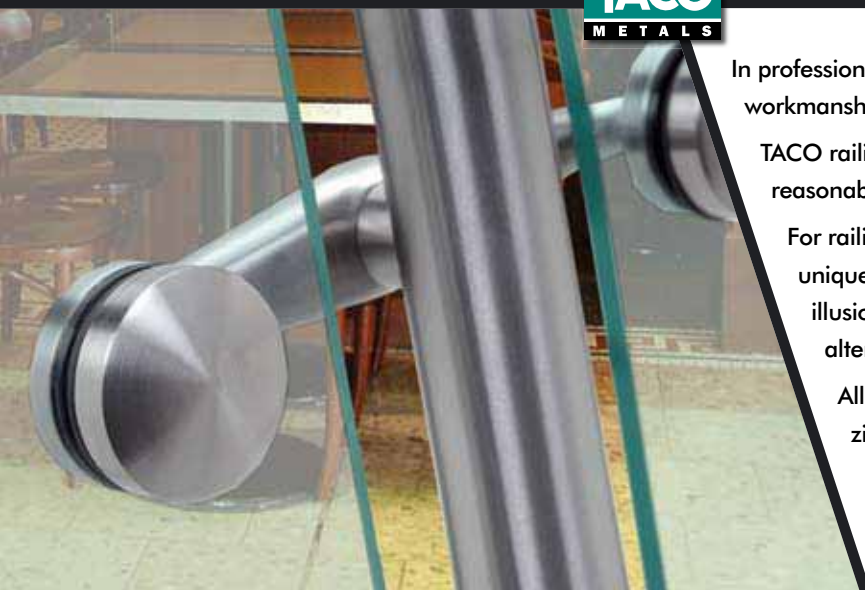

In professional railing systems, TACO's innovation, style and workmanship stands out.

TACO railing systems and components offer versatility at a reasonable cost, and simple installations.

For railing systems with glass infill, TACO Glass Clamps are uniquely designed to hold securely without drilling glass. For the illusion of floating glass, stainless steel Spider Fittings are an alternative to glass clamps.

All railing components are fabricated from stainless steel or zinc and are available in a variety of finishes.

GLASS INFILL SYSTEMS

GLASS INFILL SYSTEMS

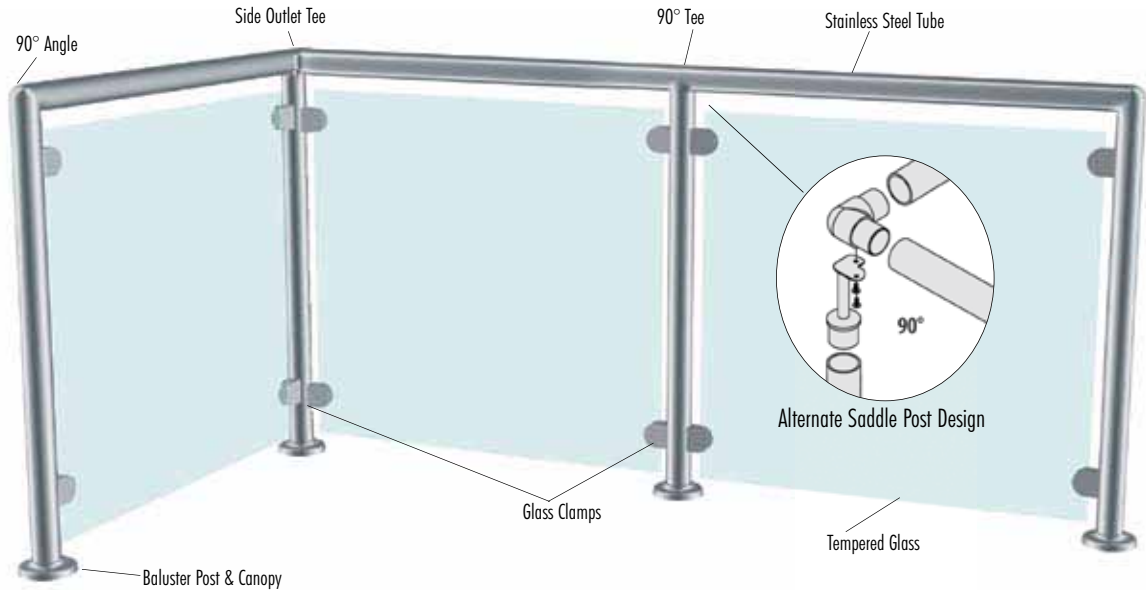

PART NUMBER

Part number-system for glass clamps

14 - **xx** **06** - **038** - **12**

- Finish
- Tube (mm)
- Glass thickness
- Model number
- Material

MATERIAL

10 = ZINC

13 = STAINLESS STEEL 304

14 = STAINLESS STEEL 316

FINISH

10 = Mirror Polished STAINLESS STEEL (Special Order)

12 = Brushed STAINLESS STEEL

00 = Unfinished ZINC

19 = Brushed Stainless Look ZINC

SYMBOLS



Screw-fastened products (socket head wrench)



Shows what accessories or products need to be purchased



Indoor use only



Indoor use only



Both indoor & outdoor use

STANDARD PACKAGING

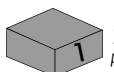

1 per package

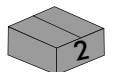

2 per package

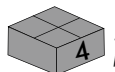

4 per package



8 per package



50 per package

GLASS CLAMPS – ROUND

STAINLESS STEEL 316, BRUSHED*

→ ALL MODELS HOLD SECURELY WITHOUT DRILLING GLASS

MODEL 20



MODEL 20

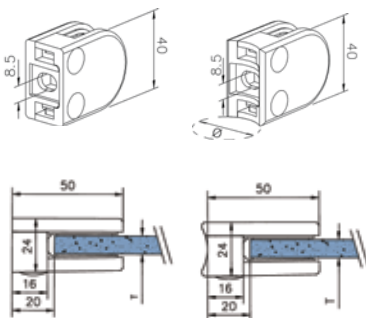

PART #	MOUNT TYPE	TUBE (Ø)	GLASS (T)
14-2006-000-12	Flat	—	1/4" (6 mm)
14-2008-000-12	Flat	—	5/16" (8 mm)
14-2006-038-12	Tube	1.5"	1/4" (6 mm)
14-2008-038-12	Tube	1.5"	5/16" (8 mm)

MODEL 22



MODEL 22

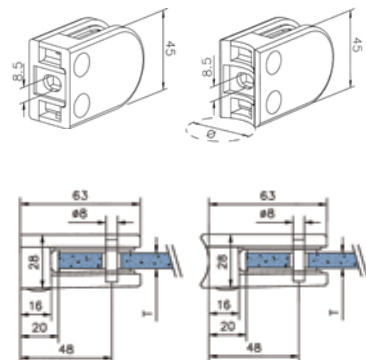

PART #	MOUNT TYPE	TUBE (Ø)	GLASS (T)
14-2206-000-12	Flat	—	1/4" (6 mm)
14-2208-000-12	Flat	—	5/16" (8 mm)
14-2244-000-12	Flat	—	3/8" (10 mm)
14-2206-038-12	Tube	1.5"	1/4" (6 mm)
14-2208-038-12	Tube	1.5"	5/16" (8 mm)
14-2244-038-12	Tube	1.5"	3/8" (10 mm)
14-2206-050-12	Tube	2.0"	1/4" (6 mm)
14-2208-050-12	Tube	2.0"	5/16" (8 mm)
14-2244-050-12	Tube	2.0"	3/8" (10 mm)

MODEL 25



MODEL 25

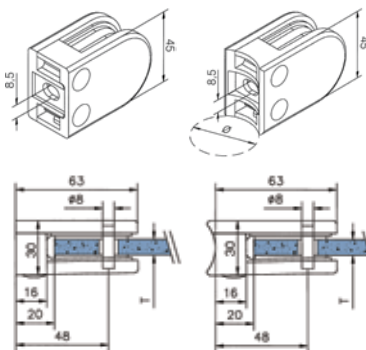

PART #	MOUNT TYPE	TUBE (Ø)	GLASS (T)
14-2513-000-12	Flat	—	1/2" (12 mm)
14-2513-038-12	Tube	1.5"	1/2" (12 mm)
14-2513-050-12	Tube	2.0"	1/2" (12 mm)

Optional Security Pins available, see Page 26

GLASS CLAMPS – SQUARE

STAINLESS STEEL 316, BRUSHED*

→ ALL MODELS HOLD SECURELY WITHOUT DRILLING GLASS

MODEL 21

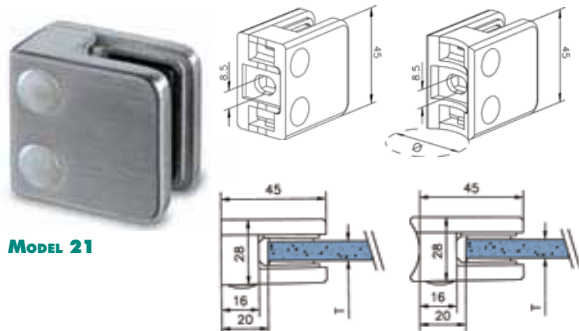

MODEL 21

PART #	MOUNT TYPE	TUBE (Ø)	GLASS (T)
14-2106-000-12	Flat	—	1/4" (6 mm)
14-2108-000-12	Flat	—	5/16" (8 mm)
14-2144-000-12	Flat	—	3/8" (10 mm)
14-2106-038-12	Tube	1.5"	1/4" (6 mm)
14-2108-038-12	Tube	1.5"	5/16" (8 mm)
14-2144-038-12	Tube	1.5"	3/8" (10 mm)

MODEL 26

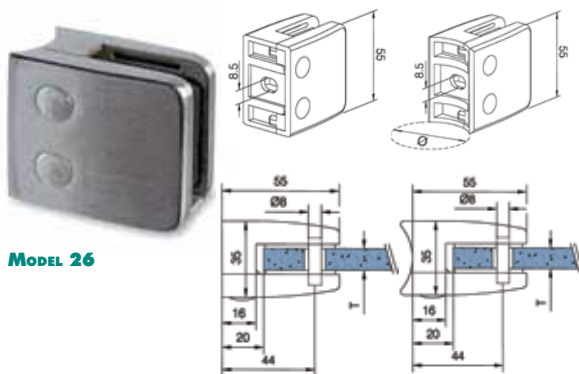

MODEL 26

PART #	MOUNT TYPE	TUBE (Ø)	GLASS (T)
14-2613-000-12	Flat	—	1/2" (12 mm)
14-2644-000-12	Flat	—	3/8" (10 mm)
14-2613-038-12	Tube	1.5"	1/2" (12 mm)
14-2644-038-12	Tube	1.5"	3/8" (10 mm)
14-2613-050-12	Tube	2.0"	1/2" (12 mm)
14-2644-050-12	Tube	2.0"	3/8" (10 mm)

Optional Security Pins available, see Page 26



SECURITY PLATE
(INCLUDED FOR MODEL 26 ONLY)

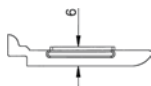

INFORMATION



14-XX06-038-12

- Finish
- Tube (mm)
- Glass thickness
- Model number
- Material

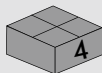

All drawings shown in metric.
See Metric Converter, Page 40



• POLISHED STAINLESS STEEL
MIRROR FINISH
AVAILABLE AS SPECIAL ORDER

GLASS CLAMPS – ROUND

ZINC DIE CAST



MODEL 20

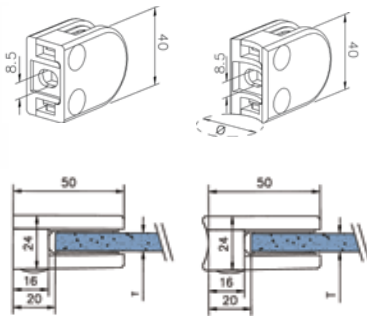

→ALL MODELS HOLD SECURELY WITHOUT DRILLING GLASS

MODEL 20

PART #	MOUNT TYPE	TUBE (Ø)	GLASS (T)	FINISH
10-2006-000-00	Flat	—	1/4" (6 mm)	Unfinished
10-2008-000-00	Flat	—	5/16" (8 mm)	Unfinished
10-2006-000-19	Flat	—	1/4" (6 mm)	Brushed SS Look
10-2008-000-19	Flat	—	5/16" (8 mm)	Brushed SS Look
10-2006-038-00	Tube	1.5"	1/4" (6 mm)	Unfinished
10-2008-038-00	Tube	1.5"	5/16" (8 mm)	Unfinished
10-2006-038-19	Tube	1.5"	1/4" (6 mm)	Brushed SS Look
10-2008-038-19	Tube	1.5"	5/16" (8 mm)	Brushed SS Look



MODEL 22

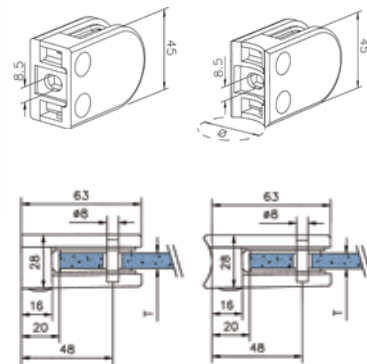

MODEL 22

PART #	MOUNT TYPE	TUBE (Ø)	GLASS (T)	FINISH
10-2206-000-00	Flat	—	1/4" (6 mm)	Unfinished
10-2208-000-00	Flat	—	5/16" (8 mm)	Unfinished
10-2244-000-00	Flat	—	3/8" (10 mm)	Unfinished
10-2206-000-19	Flat	—	1/4" (6 mm)	Brushed SS Look
10-2208-000-19	Flat	—	5/16" (8 mm)	Brushed SS Look
10-2244-000-19	Flat	—	3/8" (10 mm)	Brushed SS Look
10-2206-038-00	Tube	1.5"	1/4" (6 mm)	Unfinished
10-2208-038-00	Tube	1.5"	5/16" (8 mm)	Unfinished
10-2244-038-00	Tube	1.5"	3/8" (10 mm)	Unfinished
10-2206-038-19	Tube	1.5"	1/4" (6 mm)	Brushed SS Look
10-2208-038-19	Tube	1.5"	5/16" (8 mm)	Brushed SS Look
10-2244-038-19	Tube	1.5"	3/8" (10 mm)	Brushed SS Look
10-2206-050-00	Tube	2.0"	1/4" (6 mm)	Unfinished
10-2208-050-00	Tube	2.0"	5/16" (8 mm)	Unfinished
10-2244-050-00	Tube	2.0"	3/8" (10 mm)	Unfinished
10-2206-050-19	Tube	2.0"	1/4" (6 mm)	Brushed SS Look
10-2208-050-19	Tube	2.0"	5/16" (8 mm)	Brushed SS Look
10-2244-050-19	Tube	2.0"	3/8" (10 mm)	Brushed SS Look



MODEL 25

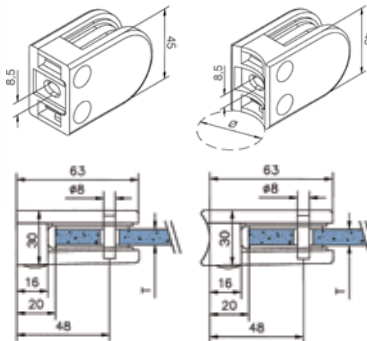

MODEL 25

PART #	MOUNT TYPE	TUBE (Ø)	GLASS (T)	FINISH
10-2513-000-00	Flat	—	1/2" (12 mm)	Unfinished
10-2513-000-19	Flat	—	1/2" (12 mm)	Brushed SS Look
10-2513-038-00	Tube	1.5"	1/2" (12 mm)	Unfinished
10-2513-038-19	Tube	1.5"	1/2" (12 mm)	Brushed SS Look
10-2513-050-00	Tube	2.0"	1/2" (12 mm)	Unfinished
10-2513-050-19	Tube	2.0"	1/2" (12 mm)	Brushed SS Look

Optional Security Pins available, see Page 26

GLASS CLAMPS – SQUARE

ZINC DIE CAST

→ALL MODELS HOLD SECURELY WITHOUT DRILLING GLASS

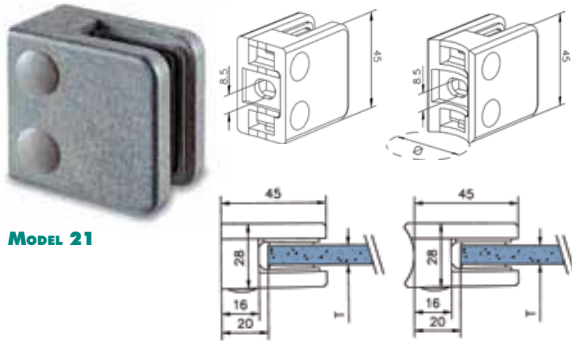

MODEL 21

MODEL 21

PART #	MOUNT TYPE	TUBE (Ø)	GLASS (T)	FINISH
10-2106-000-00	Flat	—	1/4" (6 mm)	Unfinished
10-2108-000-00	Flat	—	5/16" (8 mm)	Unfinished
10-2144-000-00	Flat	—	3/8" (10 mm)	Unfinished
10-2106-000-19	Flat	—	1/4" (6 mm)	Brushed SS Look
10-2108-000-19	Flat	—	5/16" (8 mm)	Brushed SS Look
10-2144-000-19	Flat	—	3/8" (10 mm)	Brushed SS Look
10-2106-038-00	Tube	1.5"	1/4" (6 mm)	Unfinished
10-2108-038-00	Tube	1.5"	5/16" (8 mm)	Unfinished
10-2144-038-00	Tube	1.5"	3/8" (10 mm)	Unfinished
10-2106-038-19	Tube	1.5"	1/4" (6 mm)	Brushed SS Look
10-2108-038-19	Tube	1.5"	5/16" (8 mm)	Brushed SS Look
10-2144-038-19	Tube	1.5"	3/8" (10 mm)	Brushed SS Look

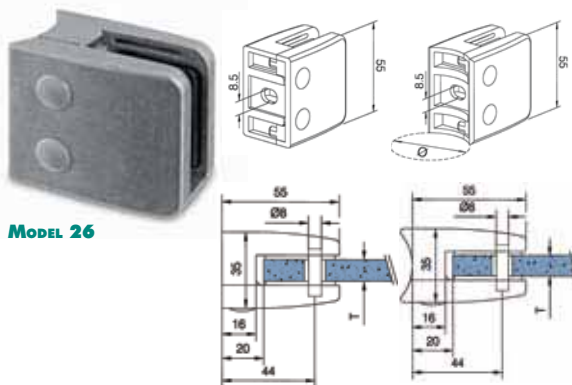

MODEL 26

MODEL 26

PART #	MOUNT TYPE	TUBE (Ø)	GLASS (T)	FINISH
10-2613-000-00	Flat	—	1/2" (12 mm)	Unfinished
10-2644-000-00	Flat	—	3/8" (10 mm)	Unfinished
10-2613-000-19	Flat	—	1/2" (12 mm)	Brushed SS Look
10-2644-000-19	Flat	—	3/8" (10 mm)	Brushed SS Look
10-2613-038-00	Tube	1.5"	1/2" (12 mm)	Unfinished
10-2644-038-00	Tube	1.5"	3/8" (10 mm)	Unfinished
10-2613-038-19	Tube	1.5"	1/2" (12 mm)	Brushed SS Look
10-2644-038-19	Tube	1.5"	3/8" (10 mm)	Brushed SS Look
10-2613-050-00	Tube	2.0"	1/2" (12 mm)	Unfinished
10-2644-050-00	Tube	2.0"	3/8" (10 mm)	Unfinished
10-2613-050-19	Tube	2.0"	1/2" (12 mm)	Brushed SS Look
10-2644-050-19	Tube	2.0"	3/8" (10 mm)	Brushed SS Look



SECURITY PLATE
(INCLUDED FOR MODEL 26 ONLY)

Optional Security Pins available, see Page 26

INFORMATION

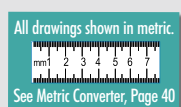
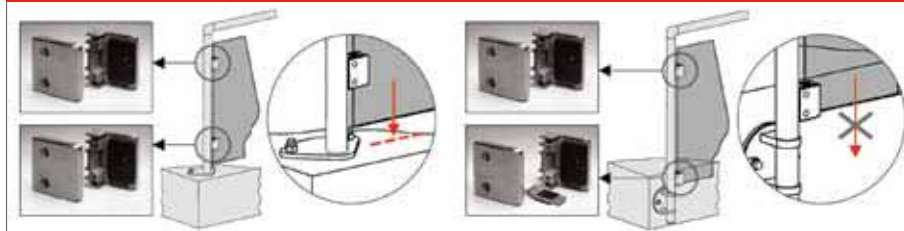

SPIDERS

STAINLESS STEEL 304, BRUSHED

SPIDERS

PART #	GLASS (T)
13-0750-000-12	3/8" - 1/2" (8.76 - 13.52 mm)
13-0751-000-12	3/8" - 1/2" (8.76 - 13.52 mm)

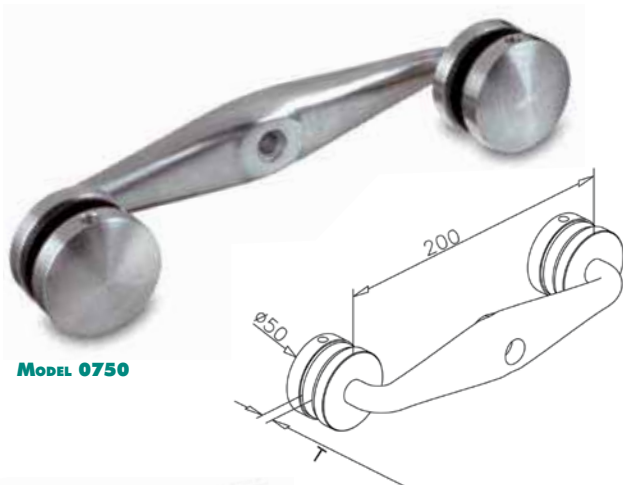

MODEL 0750

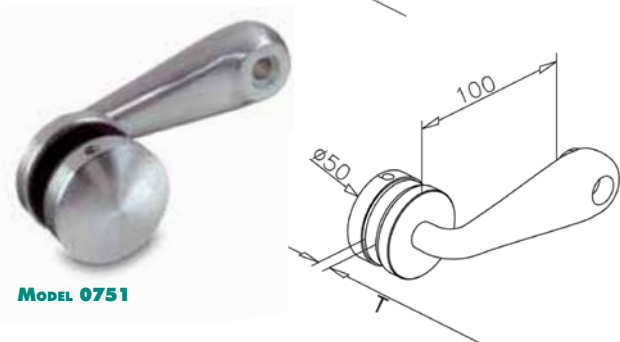

MODEL 0751

SPIDER TUBE FITTING

PART #	MOUNT TYPE	TUBE (Ø)
13-0724-038-12	Tube	1.5"
13-0724-050-12	Tube	2.0"

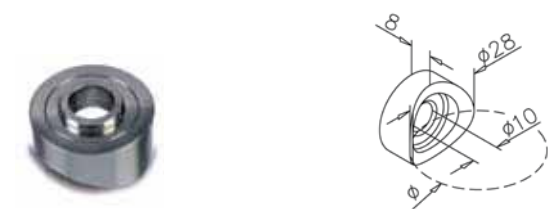

MODEL 0724

INFORMATION

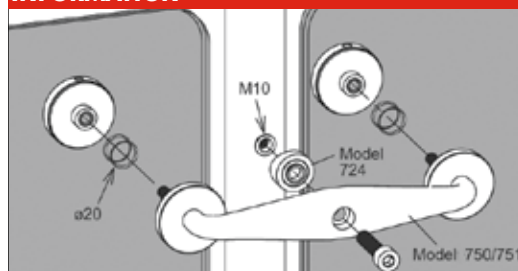

GLASS ADAPTERS

STAINLESS STEEL, BRUSHED



MODEL 0746

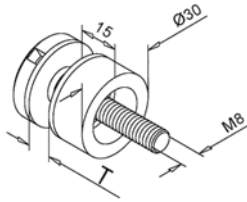

MODEL 0746

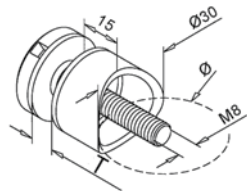

MODEL 0747

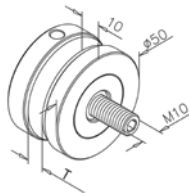

MODEL 0747

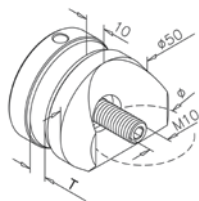

MODEL 0746

STAINLESS STEEL 316

PART #	MOUNT TYPE	TUBE (Ø)	GLASS (T)
14-0746-000-12	Flat	—	1/4" - 5/8" (6 - 16 mm)
14-0746-038-12	Tube	1.5"	1/4" - 5/8" (6 - 16 mm)
14-0746-050-12	Tube	2.0"	1/4" - 5/8" (6 - 16 mm)



MODEL 0747

STAINLESS STEEL 304

PART #	MOUNT TYPE	TUBE (Ø)	GLASS (T)
13-0747-000-12	Flat	—	5/16" - 11/16" (8 - 18 mm)
13-0747-038-12	Tube	1.5"	5/16" - 11/16" (8 - 18 mm)
13-0747-050-12	Tube	2.0"	5/16" - 11/16" (8 - 18 mm)



MODEL 0747

STAINLESS STEEL 316

PART #	MOUNT TYPE	TUBE (Ø)	GLASS (T)
14-0747-000-12	Flat	—	5/16" - 11/16" (8 - 18 mm)
14-0747-038-12	Tube	1.5"	5/16" - 11/16" (8 - 18 mm)
14-0747-050-12	Tube	2.0"	5/16" - 11/16" (8 - 18 mm)



INFORMATION

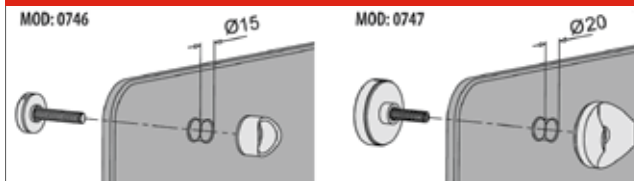

All drawings shown in metric.
See Metric Converter, Page 40



• POLISHED STAINLESS STEEL
MIRROR FINISH
AVAILABLE AS SPECIAL ORDER

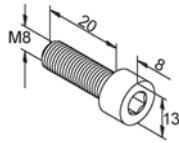

HEXAGON SOCKET HEAD CAP SCREW

PART #	NOTE
F92-4500	For all models in Stainless Steel 304 and 316
F92-4501	For all models in Zinc



INFORMATION

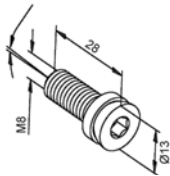

ADJUSTABLE SCREW

ALLOWS GREATER DRILLING ALIGNMENT TOLERANCE

PART #	NOTE
F92-4502	For all models in Stainless Steel 304 and 316
F92-4503	For all models in Zinc



INFORMATION

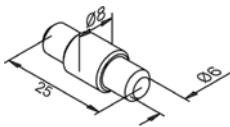
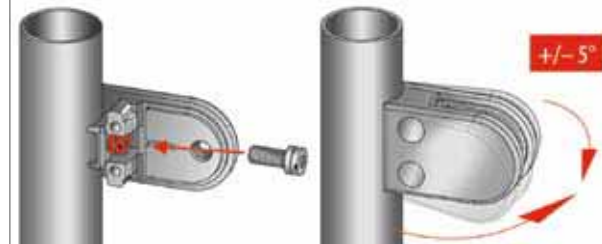

SECURITY PIN

PART #	GLASS CLAMP MODEL
19-5015-025-00	25, 26



INFORMATION

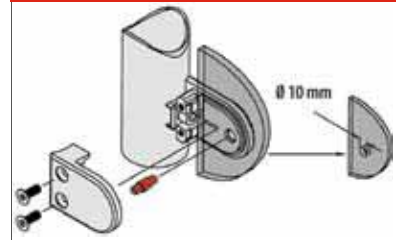

REPLACEMENT ACCESSORIES

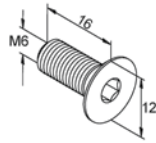

INFORMATION



HEXAGON SOCKET COUNTERSUNK HEAD CAP SCREW

PART #	NOTE
F92-4600	For models 20, 21, 22, 25, 40, 41 in Stainless Steel 304 and 316
F92-4601	For models 24, 26 in Stainless Steel 304 and 316
F92-4602	For models 20, 21, 22, 25, 40, 41 in Zinc
F92-4603	For models 24, 26 in Zinc



CAPS FOR LATERAL SCREWS (NYLON COVERED)

FOR ALL GLASS CLAMP MODELS

PART #	COLOR	PIECES PER CLAMP
19-5010-000-00	Raw (grey)	2
19-5010-000-19	Stainless Steel Look	2



RUBBER INLAYS

FOR ALL GLASS CLAMP MODELS

PART #	MODEL	GLASS (T)	PIECES PER CLAMP
19-5000-006-00	20	1/4" (6 mm)	2
19-5000-008-00	20	5/16" (8 mm)	2
19-5002-006-00	21	1/4" (6 mm)	2
19-5002-008-00	21	5/16" (8 mm)	2
19-5002-044-00	21	3/8" (9.52 mm)	2
19-5004-006-00	22	1/4" (6 mm)	2
19-5004-008-00	22	5/16" (8 mm)	2
19-5004-044-00	22	3/8" (9.52 mm)	2
19-5009-013-00	25	1/2" (12.76 mm)	2
19-5011-013-00	26	1/2" (12.76 mm)	2
19-5011-044-00	26	3/8" (9.52 mm)	2



FOR GLASS ADAPTERS

PART #	MODEL	GLASS (T)	PIECES PER CLAMP	PACKAGE
19-5030-025-00	0746 (Ø 25 mm)	1/4" - 1/2" (6 - 12 mm)	2	8
19-5060-025-00	0746 (Ø 25 mm)	1/4" - 1/2" (6 - 12 mm)	2	8
19-5030-030-00	0746 (Ø 30 mm)	1/4" - 1/2" (6 - 12 mm)	2	8
19-5031-050-00	0747 (Ø 50 mm)	5/16" - 45/64" (8 - 18 mm)	1	2
19-5032-050-00	0747 (Ø 50 mm)	5/16" - 45/64" (8 - 18 mm)	1	2



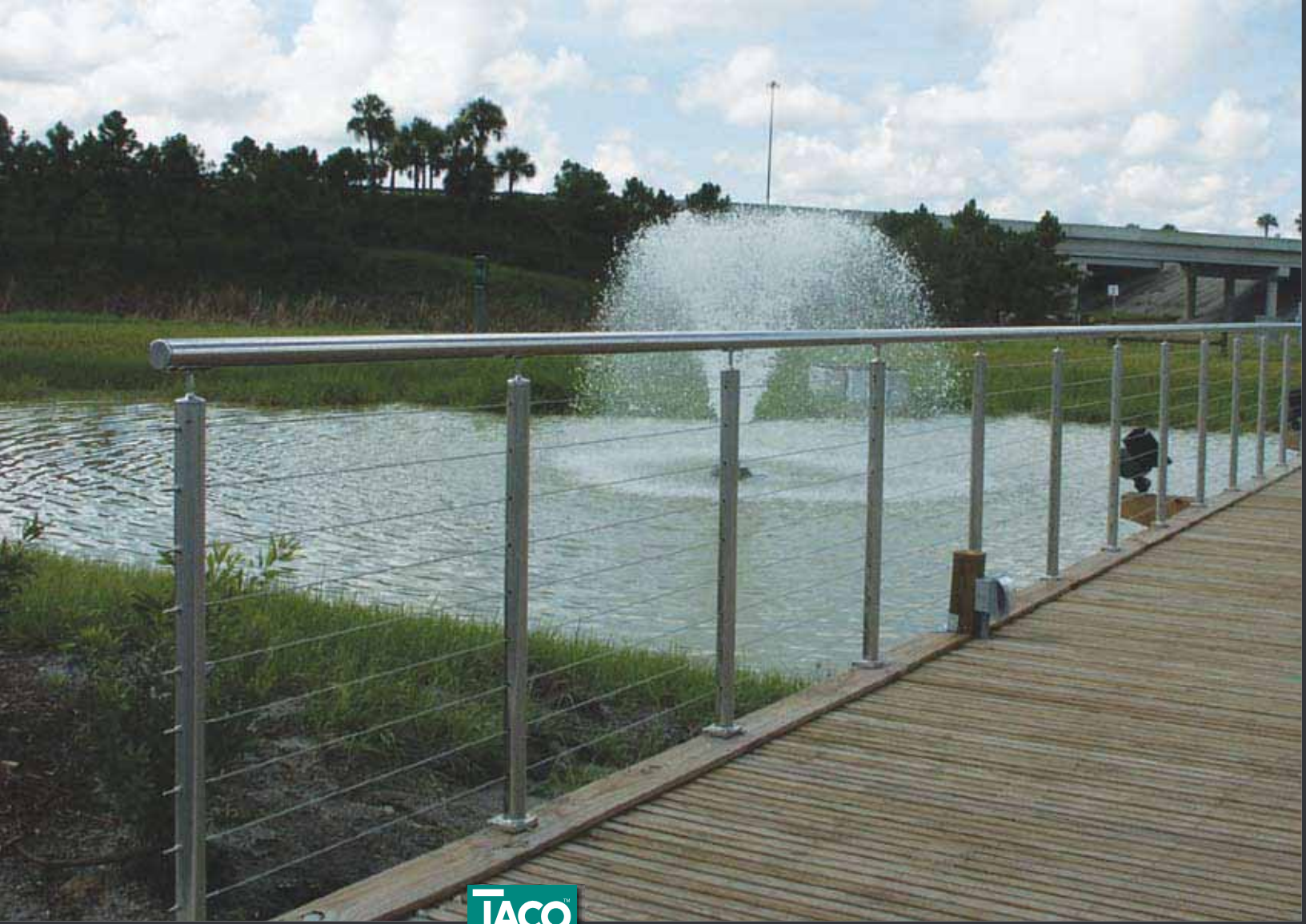

TACO Railing System with cable in-fill offers a unique style and look. TACO's Cable-Easy turnbuckle 5/32" cable system installs without special tooling or swedging. Articulating base and compression cone offer easy connection with adjustable tension for quick installations.



CABLE RAILING SYSTEM

CABLE RAILING SYSTEM

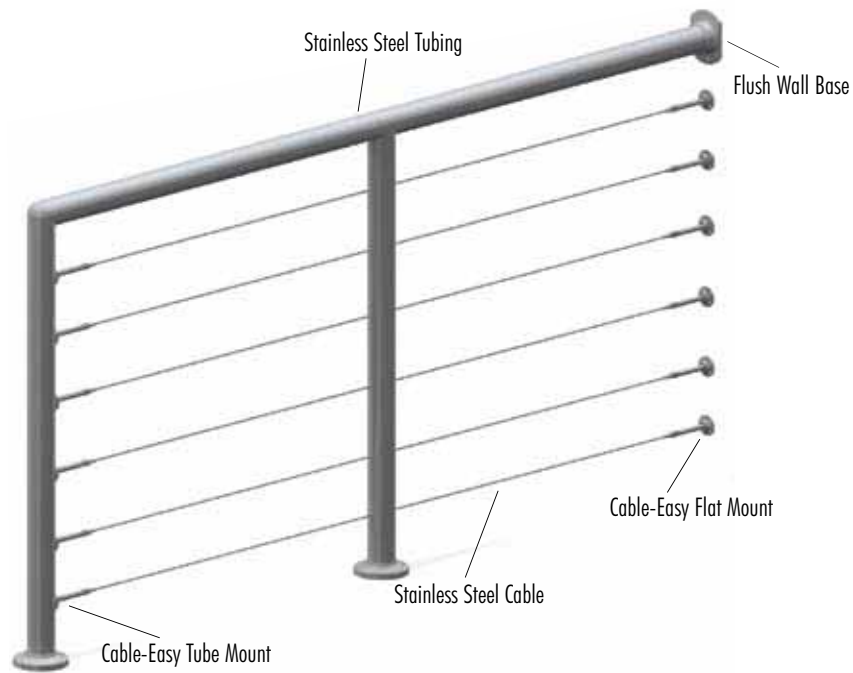

COMPONENTS

STAINLESS STEEL 316

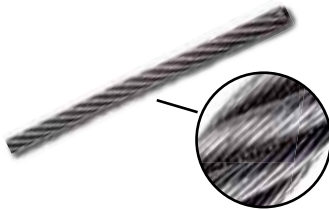

C10-0701



C10-0981



C10-0982

CABLE

PART #	DESCRIPTION
C10-0701	5/32" Cable-Easy Wire Rope

TURNBUCKLES

PART #	DESCRIPTION	MOUNT TYPE	TUBE (Ø)	FINISH
C10-0981	Cable-Easy Turnbuckle Assy	Flat	—	Polished
C10-0982	Cable-Easy Turnbuckle Assy	Tube	2.0"	Polished



TACO Glass Railing is a component system highly regarded for its see-through design, versatility and basic simplicity and features a continuous aluminum base for receiving 1/2" or 3/4" tempered glass panels as structural balusters.

TACO's top rail and handrail components for railing systems are ADA-compliant.

For base installations with flat surfaces and stairways, TACO introduces an alternative to wet glaze systems that utilize cement.

The Patented Glasswedge™ is a dry glaze glass mount system that utilizes a high impact plastic Isolator and a high strength aluminum wedge that lock the glass in place without cement.

This system installs from the floor side and offers reduced labor time by up to 50%. The Glasswedge™ can be removed if required. Both base systems are available with stainless steel cladding and end caps for a polished, professional look.



GLASS RAILING SYSTEM

GLASS RAILING SYSTEM

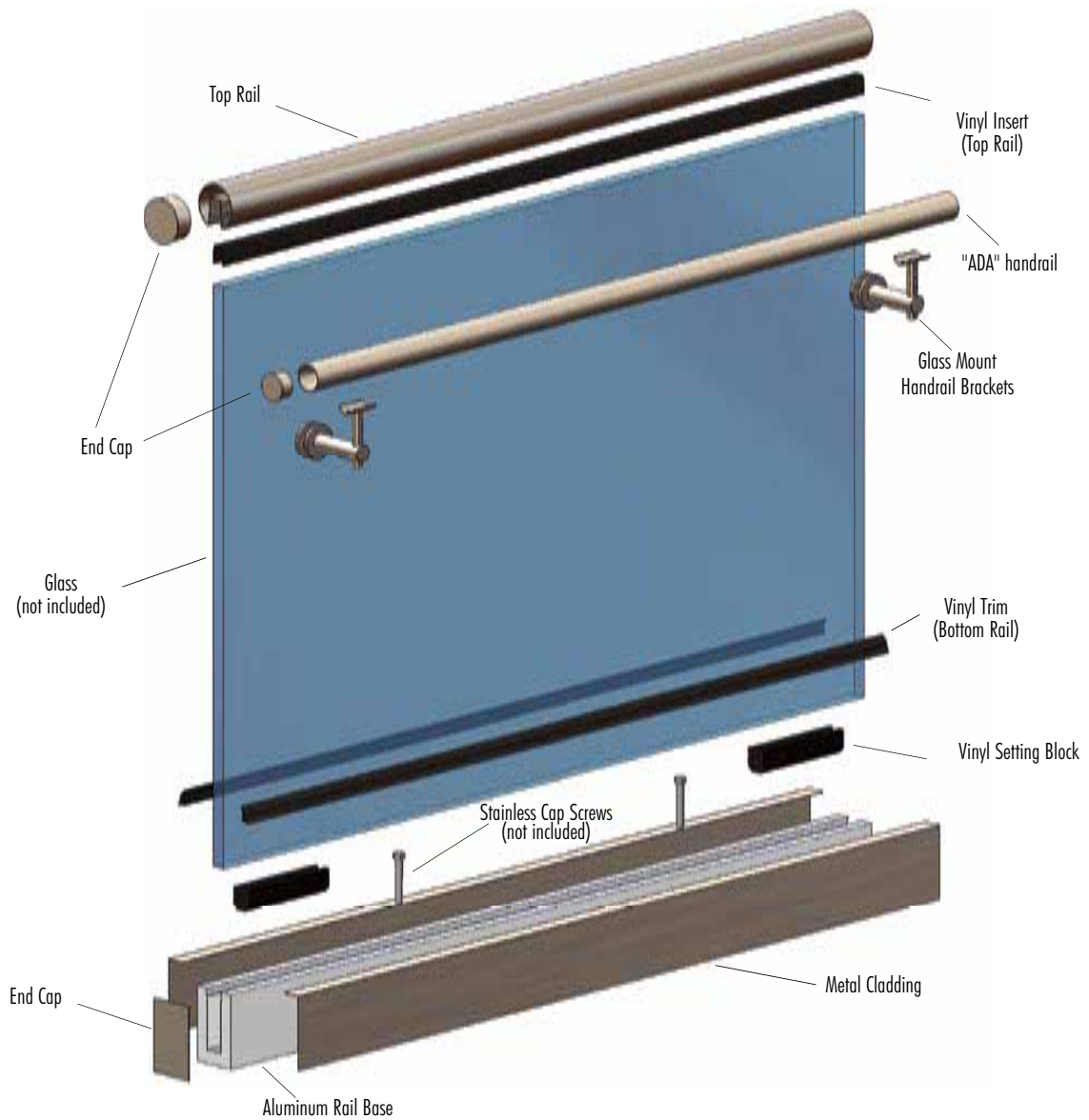

MATERIALS

ALUMINUM 6063-T5

STAINLESS STEEL 304

FINISH

**AEY = Mill Finish
ALUMINUM**

**VEL = Clear Satin Anodized
ALUMINUM**

**LS = Linear Brushed #4
STAINLESS STEEL**

**PM = Polished Mirror #8
STAINLESS STEEL**

SYMBOLS



*Screw-fastened
products
(socket head
wrench)*



*Shows what
accessories
or products
need to be
purchased*

STANDARD PACKAGING

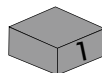

*1 per
package*

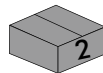

*2 per
package*

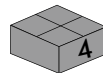

*4 per
package*

RAIL BASE

ALUMINUM, MILL FINISH

TACO Railing bases are manufactured to meet code regulations. The Uniform Building Codes call for a Glass Rail System to be Engineered by a Professional (i.e.: Architect, Structural, or Professional Engineer). It must meet load requirements at a minimum of 50lb/ft or 200lb concentrated load per section. This is applied to the handrail at a distance of 42" above floor elevation. The local in place codes will supersede all Uniform Building Codes. Rail Base attachment is based on clamping torque as it relates to what it is attached to (i.e.: Concrete Surface, Wood Deck or Embedded Steel Angles/Plates).

The Aluminum Rail Base is an extruded mill finish product made from 6063-T5 Alloy/Temper. We offer several different designs to support 1/2" or 3/4" Glass Baluster. This base can be supplied with pre-drilled holes or standard undrilled sections that require field or shop drilling.

RAIL BASE

1/2" GLASS

PART #	LENGTH
A42-0090AEY12	12'
A42-0090AEY12D [◇]	12'
A42-0090AEY20	20'

[◇]Drilled and counter bored on 12" centers for 1/2" fasteners



A42-0090

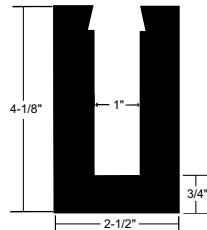

3/4" GLASS

PART #	LENGTH
A42-0531AEY12	12'



A42-0531

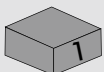
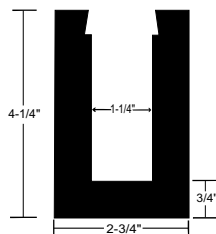

RAIL BASE & GLASS RAILING SYSTEM COMPONENTS

GLASSWEDGE™ SYSTEM

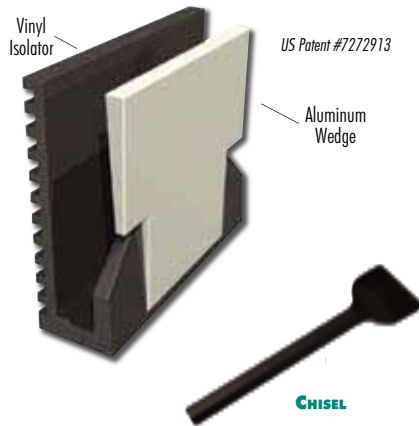

GLASSWEDGE™ DRY GLAZE SYSTEM

- Labor time reduced by 50%
- No messy cement
- Removable if necessary
- Installs from floor side

PART #	GLASS (T)
GW-0090	1/2" (12 mm) ^Δ

^ΔFor use with 1/2" tempered glass only

WEDGE SETTING CHISEL

PART #
GW-0099

INFORMATION: GLASSWEDGE™ SPACING GUIDELINES

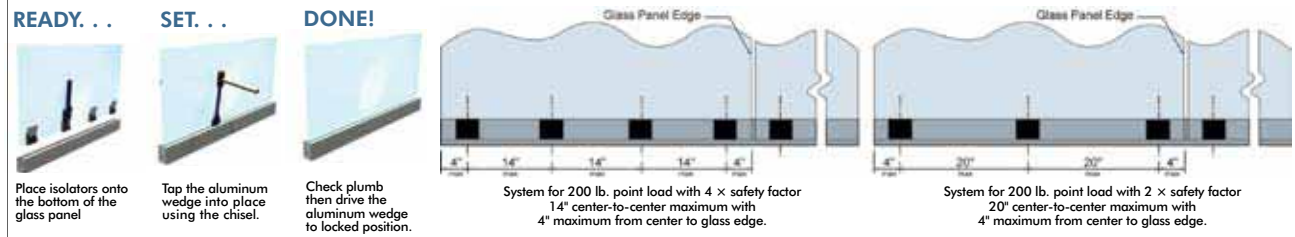

BASE
w/INSERT



BASE w/
SETTING BLOCK



VINYL TRIM

- Seals between glass & rail base

PART #	COLOR	LENGTH
V30-0396BKA250-A	Black	250'

VINYL SETTING BLOCK

- Provides secure fit after application of non-shrink grout
- Setting block allows elevation change above cap screw heads

PART #	FITS	GLASS SIZE	COLOR	LENGTH
V50-0002BKA25	A42-0090	1/2"	Black	25'
V50-0004BKA25	A42-0531	3/4"	Black	25'

RAIL BASE CLADDING

PROVIDES MATCHING BASE RAIL WITH TOP RAIL (STAINLESS STEEL 316 AVAILABLE ON REQUEST)

PART #	MATERIAL	RAIL BASE	FINISH	LENGTH	GAUGE
A50-0090VEL12	Aluminum	A42-0090	Satin Anodized	12'	.035"
S16-0090PM12	Stainless Steel 304	A42-0090/A42-0531	Polished #8	12'	.035"
S16-0090LS12	Stainless Steel 304	A42-0090/A42-0531	Brushed #4	12'	.035"
A56-0090VEL-EC	Aluminum	A42-0090	Satin Anodized	—	—
S16-0090PM-EC	Stainless Steel 304	A42-0090	Polished #8	—	—
S16-0090LS-EC	Stainless Steel 304	A42-0090	Brushed #4	—	—

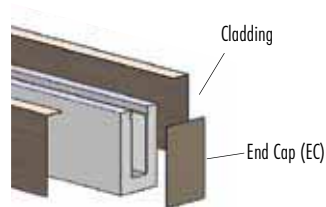

GLASS RAILING SYSTEM TOP RAIL & COMPONENTS

Top Rail



Top Rail, STAINLESS STEEL

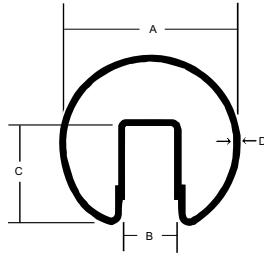

Top Rail

- Precision roll-formed and welded every 3" for added strength & stability

STAINLESS STEEL 304 (316 AVAILABLE ON REQUEST)

PART #	A	B	C	D	FINISH	LENGTH
S16-0150LS10	1-1/2"	5/8"	1"	0.050"	Linear Brushed #4	10'
S16-0150PM10	1-1/2"	5/8"	1"	0.050"	Polished #8	10'
S16-0200LS10	2"	3/4"	1-1/2"	0.050"	Linear Brushed #4	10'
S16-0200PM10	2"	3/4"	1-1/2"	0.050"	Polished #8	10'
S16-0236LS8	2-3/8"	1-11/32"	1-11/32"	0.060"	Linear Brushed #4	8'2"
S16-0250LS10	2-1/2"	3/4"	1-1/2"	0.065"	Linear Brushed #4	10'
S16-0250PM10	2-1/2"	3/4"	1-1/2"	0.065"	Polished #8	10'



Top Rail, ALUMINUM

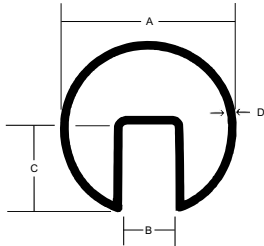

ALUMINUM SATIN ANODIZED, 6063-T5

PART #	A	B	C	D	FINISH	LENGTH
A42-0068VEL24	2-1/2"	3/4"	1-1/4"	0.125"	Satin Anodized	24'

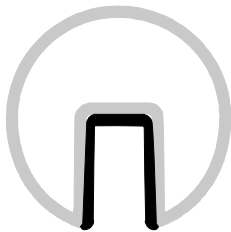

Top Rail INSERT



VINYL INSERT

PROTECTIVE TOP RAIL INSERT FOR 1/2" GLASS

Provides secure fit between glass and top rail. Application calls for wet glazing in place

PART #	COLOR	LENGTH
V50-0001BKA6	Black	6'

INFORMATION

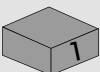

MITERED CORNERS



**TOP RAIL CORNER 90°
STAINLESS STEEL**

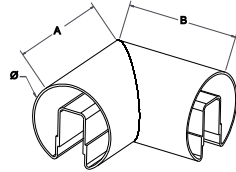

HORIZONTAL 90°

STAINLESS STEEL 304 (316 AVAILABLE ON REQUEST)

PART #	TOP RAIL SIZE	A	B	FINISH
S16-0150LS-HH	1-1/2"	1-1/2"	3-3/4"	Brushed #4
S16-0150PM-HH	1-1/2"	1-1/2"	3-3/4"	Polished #8
S16-0200LS-HH	2"	2"	4"	Brushed #4
S16-0200PM-HH	2"	2"	4"	Polished #8
S16-0250LS-HH	2-1/2"	2-1/2"	4-1/2"	Brushed #4
S16-0250PM-HH	2-1/2"	2-1/2"	4-1/2"	Polished #8

Vertical corners in both 90° and 135° available on request



**TOP RAIL CORNER 135°
STAINLESS STEEL**

HORIZONTAL 135°

STAINLESS STEEL 304 (316 AVAILABLE ON REQUEST)

PART #	TOP RAIL SIZE	A	B	FINISH
S16-0150LS-HH-135	1-1/2"	1-1/2"	2-1/2"	Brushed #4
S16-0150PM-HH-135	1-1/2"	1-1/2"	2-1/2"	Polished #8
S16-0200LS-HH-135	2"	2"	2-3/4"	Brushed #4
S16-0200PM-HH-135	2"	2"	2-3/4"	Polished #8
S16-0250LS-HH-135	2-1/2"	2-1/2"	3"	Brushed #4
S16-0250PM-HH-135	2-1/2"	2-1/2"	3"	Polished #8

Vertical corners in both 90° and 135° available on request



**TOP RAIL CORNER 90°
ALUMINUM**

HORIZONTAL 90° & 135°

ALUMINUM

PART #	TOP RAIL SIZE	A	B	ANGLE	FINISH
A56-0068VEL-HH	2-1/2"	2-1/2"	5-1/8"	90°	Satin Anodized
A56-0068VEL-HH-135	2-1/2"	2-1/2"	4-1/2"	135°	Satin Anodized

Vertical corners in both 90° and 135° available on request



**TOP RAIL CORNER 135°
ALUMINUM**

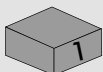

GLASS RAILING SYSTEM TOP RAIL COMPONENTS

END CAPS



END CAPS

STAINLESS STEEL 304 (316 AVAILABLE ON REQUEST)

PART #	MATERIAL	TUBE (Ø)	FINISH
A56-0068VEL-EC	Aluminum	2.5"	Satin Anodized
S16-0150LS-EC	Stainless Steel	1.5"	Brushed #4
S16-0150PM-EC	Stainless Steel	1.5"	Polished #8
S16-0200LS-EC	Stainless Steel	2"	Brushed #4
S16-0200PM-EC	Stainless Steel	2"	Polished #8
S16-0250LS-EC	Stainless Steel	2.5"	Brushed #4
S16-0250PM-EC	Stainless Steel	2.5"	Polished #8

CONNECTORS



CONNECTOR SLEEVE

PART #	TOP RAIL SIZE	TOP RAIL MATERIAL
A56-0068-CS	2.5"	Aluminum
S16-0150-CS	1.5"	Stainless Steel
S16-0200-CS	2"	Stainless Steel
S16-0250-CS	2.5"	Stainless Steel

INFORMATION

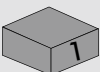
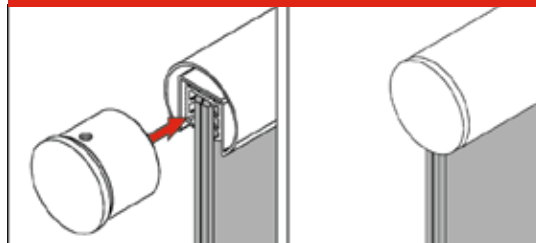

GLASS RAILING SYSTEM GLASS RAILING COMPONENTS

HANDRAIL BRACKETS

STAINLESS STEEL 316



MODEL 0150

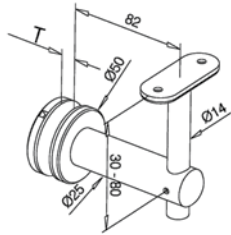

MODEL 0150

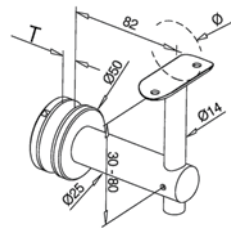

MODEL 0155

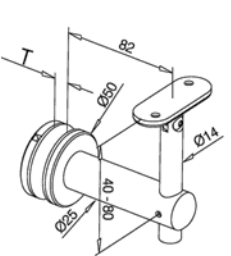

MODEL 0155

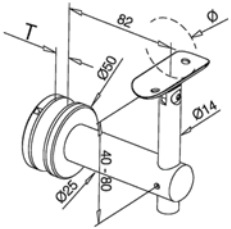

GLASS MOUNT

PART #	SADDLE TYPE	SADDLE TUBE (Ø)	GLASS (T)
14-0150-000-12	Flat	—	1/2" - 1-3/16" (12 - 30 mm)
14-0150-038-12	Tube	1.5"	1/2" - 1-3/16" (12 - 30 mm)
14-0150-050-12	Tube	2.0"	1/2" - 1-3/16" (12 - 30 mm)

GLASS MOUNT W/ADJUSTABLE SADDLE

PART #	SADDLE TYPE	SADDLE TUBE (Ø)	GLASS (T)
14-0155-000-12	Flat	—	1/2" - 1-3/16" (12 - 30 mm)
14-0155-038-12	Tube	1.5"	1/2" - 1-3/16" (12 - 30 mm)
14-0155-050-12	Tube	2.0"	1/2" - 1-3/16" (12 - 30 mm)

INFORMATION

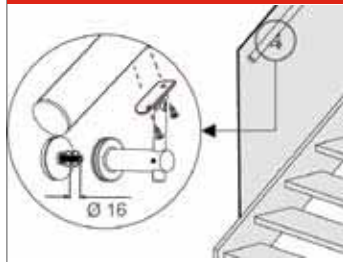

FOR ADDITIONAL
HANDRAIL BRACKETS,
SEE PAGE 8

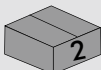

All drawings shown in metric.
See Metric Converter, Page 40



The TACO glass canopy system captivates your imagination with its charm and unobtrusive architecture. Made of corrosion resistant stainless steel 316, the glass canopy system guarantees a long life and weather protection that meets all demands. It is designed for 3/4" heat strengthened or laminated safety glass. Complete design, technical support and data specifications are available. Glass not included.



GLASS CANOPY SYSTEM

GLASS CANOPY SYSTEM

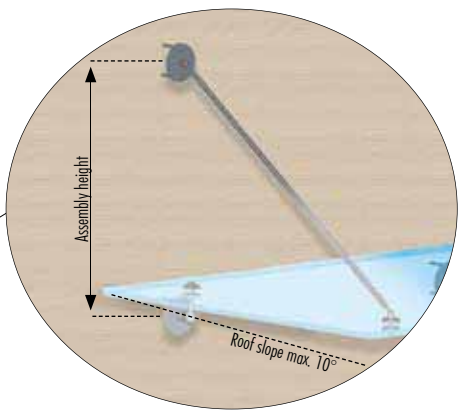
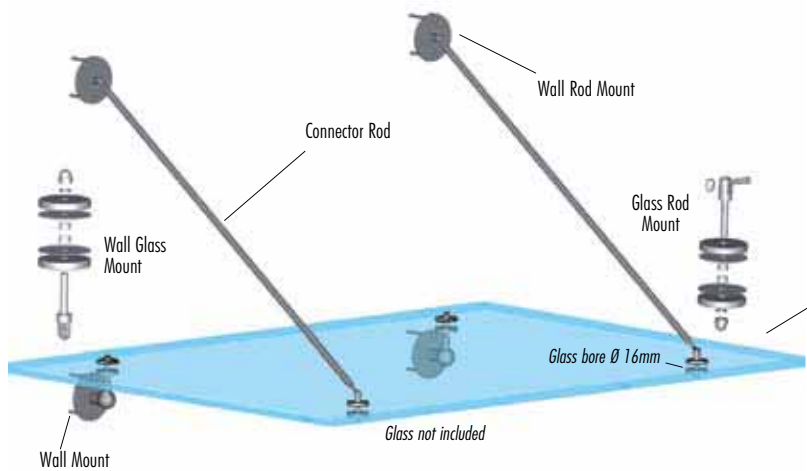

**DIMENSIONS
REQUIRED TO
CALCULATE THE
CONNECTOR
ROD LENGTH**

- Assembly height (center-to-center)
- Canopy glass dimensions (length x width x thickness)
- Glass slope (maximum 10°)

ASSEMBLIES

STAINLESS STEEL 316, BRUSHED

PART #	DESCRIPTION
F10-1945	2-Rod Mount System
F10-1944	3-Rod Mount System

CONNECTOR ROD W/EYELETS

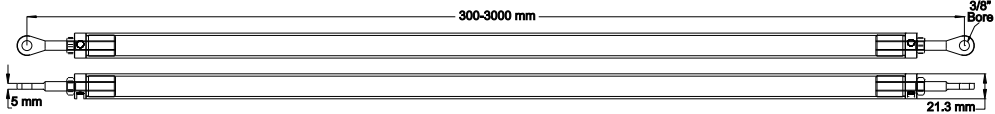

GLASS ROD MOUNT

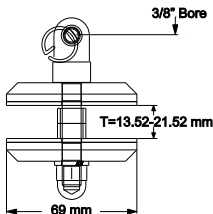

GLASS WALL MOUNT

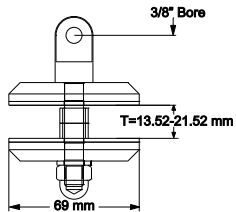

WALL ROD MOUNT

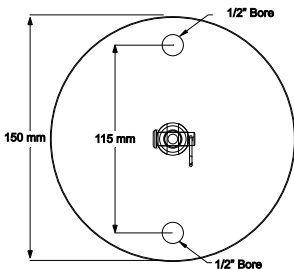

WALL MOUNT

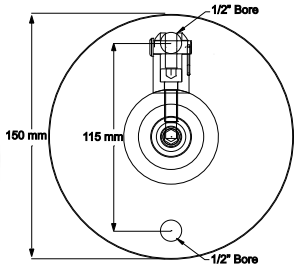

REFERENCE DATA METRIC CONVERSION & RECOMMENDATION

Metric Conversion Chart

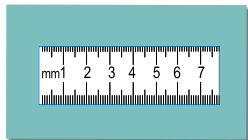

FOR YOUR CONVENIENCE, PLEASE FIND BELOW A METRIC CONVERTER CHART TO ASSIST YOU WITH THE MEASUREMENTS OF ALL ITEMS IN THE CATALOG.

fraction (")	decimal (")	millimeter (mm)
1/64	0.0156	0.3969
1/32	0.0313	0.7938
3/64	0.0469	1.1906
1/16	0.0625	1.5875
5/64	0.0781	1.9844
3/32	0.0938	2.3813
7/64	0.1094	2.7781
1/8	0.125	3.175
9/64	0.1406	3.5719
5/32	0.1563	3.968
11/64	0.1719	4.3656
3/16	0.1875	4.7625
13/64	0.2031	5.1594
7/32	0.2188	5.5563
15/64	0.2344	5.9531
1/4	0.25	6.35
17/64	0.2656	6.7469
9/32	0.2813	7.1438
19/64	0.2969	7.5406
5/16	0.3125	7.9375
21/64	0.3281	8.3344
11/32	0.3438	8.7313
23/64	0.3594	9.1281
3/8	0.375	9.525
25/64	0.3906	9.9219
13/32	0.4063	10.3188
27/64	0.4219	10.7156
7/16	0.4375	11.1125
29/64	0.4531	11.5094
15/32	0.4688	11.9063
31/64	0.4844	12.3031
1/2	0.500	12.7000

fraction (")	decimal (")	millimeter (mm)
33/64	0.5156	13.0969
17/32	0.5313	13.4938
35/64	0.5469	13.8906
9/16	0.5625	14.2875
37/64	0.5781	14.6844
19/32	0.5938	15.0813
39/64	0.6094	15.4781
5/8	0.625	15.875
41/64	0.6406	16.2719
21/32	0.6563	16.6688
43/64	0.6719	17.0656
11/16	0.6875	17.4625
45/64	0.7031	17.8594
23/32	0.7188	18.2563
47/64	0.7344	18.6531
3/4	0.75	19.05
49/64	0.7656	19.4469
25/32	0.7813	19.8438
51/64	0.7969	20.2406
13/16	0.8125	20.6375
53/64	0.8281	21.0344
27/32	0.8438	21.4313
55/64	0.8594	21.8281
7/8	0.875	22.225
57/64	0.8906	22.6219
29/32	0.9063	23.0188
59/64	0.9219	23.4156
15/16	0.9375	23.8125
61/64	0.9531	24.2094
31/32	0.9688	24.6063
63/64	0.9844	25.0031
1	1.000	25.4000

TACO Recommends . . .



LOCTITE™ 326 ADHESIVE OR EQUIVALENT

- Permanent bond with holding power up to 2,700 psi.
- Offers handling strength in 60 seconds, full cure in 24 hours.

LEAD TIMES

TACO's lead times are based on product availability and the time it will take to prepare and package products to avoid freight damage.

Unless otherwise stipulated, TACO will ship most stock orders the same day if they are received before 10:00 a.m. Orders received after 10:00 a.m. will ship the following day.

If requested, orders will be confirmed via telephone call, e-mail or fax by Customer Service. If a product is out of stock, you will be advised of the anticipated ship date.

FREIGHT PROGRAM

TACO's freight program has been designed to minimize the amount of damage that can occur in transit while ensuring efficient delivery time for your needs.

The options available are:

- **TACO direct orders within the regional areas serviced by a company owned vehicle will be delivered for a nominal charge.**
- **Common carrier.** Orders will ship on the carrier of your choice. If preferred, TACO can assist in recommending a carrier and providing freight quotes. Unless otherwise requested, to avoid carrier collect fees TACO will ship your order freight prepaid with freight charges added to the invoice.
- **TACO EZ-Freight Program.** This program allows a quick turn around for one lineal profiles package between 144" and 240" in length anywhere in the continental US. Non-lineal packages are recommended to ship via UPS (see below). For your convenience, freight charges will be prepaid and added to the invoice. The fee schedule for this program is a flat rate assigned as follows:

Weight	Freight Rate
1 to 100 lbs.	\$130
- **UPS.** Orders will ship prepaid and freight charges will be added to the invoice. Orders can also ship as "Consignee billing" (recipient of goods will be paying for freight) or "Third Party billing". Each of these instances requires an open account with the carrier. TACO will advise on weight and size limitations at the time shipping arrangements are being made. The current standards are 130 inches in combined length and girth and/or 108 inches in length.
- **Please note that packaging weight is not included in product weight but will be added to total product weight before freight fee calculations are made.**

Shipments exceeding any weight limits or dimensions listed above will require a special quote by Customer Service. Rates apply to major metropolitan areas only; additional charges may apply in rural and residential areas.

DAMAGE, LOSS AND/OR SHORTAGE

TACO exercises the utmost care when packaging and shipping products to ensure your order is received in good condition. Any visible damage or lost packages noticed at the time of delivery must be communicated to the freight carrier immediately and a claim should be filed (TACO recommends adding a written note to the freight bill). TACO can assist with the process of filing a claim by providing information on the number of packages, shipment details and tracking but is unable to file a claim directly with the carrier once the goods have been received and accepted. It is also important that goods are inspected quickly to discover any hidden damages or shortages. Any additional shortages or damages should be communicated to Customer Service within five (5) days of receipt to ensure a replacement order is promptly processed.

RETURNED GOODS POLICY

TACO products are all carefully tested and inspected to ensure optimal levels of performance. It is the responsibility of the receiving party to check all materials to ensure form & fitness for the application for which product was purchased. In the event that material is not fit for application, TACO's liability is limited to material cost only. Once product is altered in any fashion, TACO's liability ends. It is TACO's discretion whether product will be repaired or replaced without charge, subject to the performance guarantees stated in TACO's warranty.

All returns require prior authorization from Customer Service. An RM (Returned Materials) number will be issued for goods that appear to be defective or shipped in error. TACO will pay return freight within the continental US and replace the goods in these two instances. On all other instances, a minimum restocking charge of 20% will be applied and TACO requires the goods to be shipped back freight prepaid. Please contact Customer Service for more information.

The following requirements are also applicable for returned goods:

- **A copy of the original invoice must accompany all returns.**
- **TACO is unable to accept special order products (made to order, cut to length, etc.) for return or credit.**
- **Goods must be returned in original condition and packaging to avoid additional charges.**

BUSINESS HOURS

Offices hours are from 8:00 am to 5:00 pm, Eastern Standard Time, Monday through Friday.

PAYMENT TERMS

The accepted terms of payment are prepaid by Credit Card prior to shipping or Net 30 upon proper credit approval. To obtain a credit application and a list of credit requirements contact Customer Service.

MINIMUM ORDERS

TACO does its best to be easy to do business with. Therefore, a minimum order requirement has been eliminated for architectural trade customers. However, any orders below \$200 will be charged a \$20 handling fee. Additional charges may apply for cutting, coiling or special packaging.

A NOTE TO VALUED CUSTOMERS

TACO sells exclusively to architectural trade customers. TACO trade customers consist of architects, builders, glazing contractors, metal fabricators, designers, facility managers as well as construction product wholesalers and major retailers. Changes in production techniques and deviations in measurements may occur. Actual products may differ very slightly from the photo illustrations shown in this catalog. TACO is not responsible for any printing errors that may appear.

Railing systems shown are designed to meet industry standards for safety and code requirements in most areas. Since the codes and safety regulations are subject to local regulations and change without prior notice TACO Metals is not responsible for determining the proper system or components for your application. It is necessary to consult with a local licensed engineer to determine if the products you are using meet the required codes and structural requirements for your application. TACO Metals can provide test reports and data on demand or through our website at TACOrailing.com

NUMERICAL INDEX

Part Number	Page Number
10-2006-000-00	22
10-2006-000-19	22
10-2006-038-00	22
10-2006-038-19	22
10-2008-000-00	22
10-2008-000-19	22
10-2008-038-00	22
10-2008-038-19	22
10-2106-000-00	23
10-2106-000-19	23
10-2106-038-00	23
10-2106-038-19	23
10-2108-000-00	23
10-2108-000-19	23
10-2108-038-00	23
10-2108-038-19	23
10-2144-000-00	23
10-2144-000-19	23
10-2144-038-00	23
10-2144-038-19	23
10-2206-000-00	22
10-2206-000-19	22
10-2206-038-00	22
10-2206-038-19	22
10-2206-050-00	22
10-2206-050-19	22
10-2208-000-00	22
10-2208-000-19	22
10-2208-038-00	22
10-2208-038-19	22
10-2208-050-00	22
10-2208-050-19	22
10-2244-000-00	22
10-2244-000-19	22
10-2244-038-00	22
10-2244-038-19	22
10-2244-050-00	22
10-2244-050-19	22
10-2513-000-00	22
10-2513-000-19	22
10-2513-038-00	22
10-2513-038-19	22
10-2513-050-00	22
10-2513-050-19	22
10-2613-000-00	23
10-2613-000-19	23
10-2613-038-00	23
10-2613-038-19	23
10-2613-050-00	23
10-2613-050-19	23
10-2644-000-00	23
10-2644-000-19	23
10-2644-038-00	23
10-2644-038-19	23
10-2644-050-00	23
10-2644-050-19	23
13-0138-038-12	8
13-0138-050-12	8
13-0724-038-12	24
13-0724-050-12	24
13-0747-000-12	25
13-0747-038-12	25
13-0747-050-12	25
13-0750-000-12	24
13-0751-000-12	24
14-0300-038-12	12
14-0300-050-12	12
14-0301-038-12	12

Part Number	Page Number
14-0301-050-12	12
14-0302-038-12	12
14-0302-050-12	12
14-0305-038-12	12
14-0305-050-12	12
14-0111-000-12	8
14-0111-038-12	8
14-0111-050-12	8
14-0112-038-12	8
14-0112-050-12	8
14-0150-000-12	37
14-0150-038-12	37
14-0150-050-12	37
14-0155-000-12	37
14-0155-038-12	37
14-0155-050-12	37
14-0304-038-12	13
14-0304-050-12	13
14-0307-038-12	13
14-0307-050-12	13
14-0505-038-12	10
14-0505-050-12	10
14-0511-038-12	15
14-0511-050-12	15
14-0513-038-12	15
14-0513-050-12	15
14-0544-038-12	15
14-0551-038-12	14
14-0551-050-12	14
14-0553-038-12	14
14-0553-050-12	14
14-0555-038-12	14
14-0555-050-12	14
14-0702-000-12	9
14-0702-038-12	9
14-0702-050-12	9
14-0702-338-12	9
14-0702-350-12	9
14-0702-838-12	9
14-0702-850-12	9
14-0703-000-12	9
14-0703-050-12	9
14-0703-350-12	9
14-0703-850-12	9
14-0705-000-12	9
14-0705-038-12	9
14-0705-050-12	9
14-0706-000-12	9
14-0706-050-12	9
14-0721-000-12	10
14-0721-050-12	10
14-0722-000-12	10
14-0722-038-12	10
14-0722-050-12	10
14-0729-038-12	11
14-0729-050-12	11
14-0732-038-12	11
14-0732-050-12	11
14-0739-038-12	10
14-0739-050-12	10
14-0746-000-12	25
14-0746-038-12	25
14-0746-050-12	25
14-0747-000-12	25
14-0747-038-12	25
14-0747-050-12	25
14-0790-038-12	13
14-0790-050-12	13

Part Number	Page Number
14-0913-038-12	15
14-0913-050-12	15
14-0913-438-12	15
14-0913-450-12	15
14-0915-038-12	15
14-0915-050-12	15
14-0915-438-12	15
14-0915-450-12	15
14-2006-000-12	20
14-2006-038-12	20
14-2008-000-12	20
14-2008-038-12	20
14-2106-000-12	21
14-2106-038-12	21
14-2108-000-12	21
14-2108-038-12	21
14-2144-000-12	21
14-2144-038-12	21
14-2206-000-12	20
14-2206-038-12	20
14-2206-050-12	20
14-2208-000-12	20
14-2208-038-12	20
14-2208-050-12	20
14-2244-000-12	20
14-2244-038-12	20
14-2244-050-12	20
14-2513-000-12	20
14-2513-038-12	20
14-2513-050-12	20
14-2613-000-12	21
14-2613-038-12	21
14-2613-050-12	21
14-2644-000-12	21
14-2644-038-12	21
14-2644-050-12	21
14-3507-038-12	14
14-3507-050-12	14
14-5729-038-12	11
14-5729-050-12	11
14-5730-038-12	11
14-5730-050-12	11
14-5732-038-12	11
14-5732-050-12	11
19-5000-006-00	27
19-5000-008-00	27
19-5002-006-00	27
19-5002-008-00	27
19-5002-044-00	27
19-5004-006-00	27
19-5004-008-00	27
19-5004-044-00	27
19-5009-013-00	27
19-5010-000-00	27
19-5010-000-19	27
19-5011-013-00	27
19-5011-044-00	27
19-5015-025-00	26
19-5030-025-00	27
19-5030-030-00	27
19-5031-050-00	27
19-5032-050-00	27
19-5060-025-00	27
A42-0068VEL24	34
A42-0090AEY12	32
A42-0090AEY12D	32
A42-0090AEY20	32
A42-0531AEY12	32

Part Number	Page Number
A50-0090VEL12	33
A56-0068-CS	36
A56-0068VEL-EC	36
A56-0068VEL-HH	35
A56-0068VEL-HH-135	35
A56-0090VEL-EC	33
C10-0701	29
C10-0981	29
C10-0982	29
Connector Rod with Eyelets	39
F10-1944	39
F10-1945	39
F92-4500	26
F92-4501	26
F92-4502	26
F92-4503	26
F92-4600	27
F92-4601	27
F92-4602	27
F92-4603	27
Glass Rod Mount	39
Glass Wall Mount	39
GW-0090	33
GW-0099	33
S14-1278SS164	16
S14-2078SS164	16
S14-1278SS164B	16
S14-2078SS164B	16
S16-0090LS12	33
S16-0090LS-EC	33
S16-0090PM12	33
S16-0090PM-EC	33
S16-0150-CS	36
S16-0150LS10	34
S16-0150LS-EC	36
S16-0150LS-HH	35
S16-0150LS-HH-135	35
S16-0150PM10	34
S16-0150PM-EC	36
S16-0150PM-HH	35
S16-0150PM-HH-135	35
S16-0200-CS	36
S16-0200LS10	34
S16-0200LS-EC	36
S16-0200PM-EC	36
S16-0200LS-HH	35
S16-0200LS-HH-135	35
S16-0200PM10	34
S16-0200PM-HH	35
S16-0200PM-HH-135	35
S16-0236LS8	34
S16-0250-CS	36
S16-0250LS10	34
S16-0250LS-EC	36
S16-0250LS-HH	35
S16-0250LS-HH-135	35
S16-0250PM10	34
S16-0250PM-EC	36
S16-0250PM-HH	35
S16-0250PM-HH-135	35
V30-0396BKA250-A	33
V50-0001BKA6	34
V50-0002BKA25	33
V50-0004BKA25	33
Wall Mount	39
Wall Rod Mount	39

ALPHABETICAL INDEX

Item	Page Number
Accessories	26-27, 33
Glass Clamp	26
Glass Clamp, Replacement	27
Glasswedge™ Chisel	33
Baluster Brackets	14
Fascia Mount	14
Corner, Fascia Mount	14
Custom, Fascia Mount	14
Baluster Post & Accessories	15
Baluster Posts	15
Baluster Canopy	15
Cable Railing System	28-29
Cable Wire Rope	29
Cable Turnbuckle Assemblies	29
Cladding, Rail Base	33
Corners, Mitered Top Rail	35
90°	35
135°	35
Stainless Steel	35
Aluminum	35
End Caps	11, 33, 36
Railing	11
Railing, Easy-Hit	11
Cladding	33
Top Rail	36
Flush Angles	12
90°	12
135°	12
Adjustable Angle	12
Flush Mount Adapters	10
Radius Ends	10
Wall Base	10
Top Mount	10
Side Mount	10
Glasswedge™ Dry Glaze System	33
Glass Adapters	25

Item	Page Number
Glass Canopy System	38-39
Glass Canopy Assemblies	39
Glass Clamps, Stainless Steel	20-21
Round Body	20
Square Body	21
Glass Clamps, Zinc Die Cast	22-23
Round Body	22
Square Body	23
Glass Clamp Security Pin	26
Glass Infill Railing Systems & Components	18-27
Glass Railing System & Components	30-37
Handrail Brackets	8, 9, 37
Tube Mount	8
Wall Mount	8
Post Mount	9
Glass Mount	37
Adjustable Saddle	37
Adjustable Saddle	9
Metric Converter	40
Outlets & Tees	13
Side, 90°	13
Tee, 90°	13
Connector	13
Rail Base	32
Security Pin	26
Spider Glass Fittings	24
Spider Tube Fitting	24
Top Rail	34
Aluminum	34
Stainless Steel	34
Tube, Stainless Steel	16
Value-Added Fabrication	17
Vinyl Trim, Rail Base	33
Vinyl Setting Block, Rail Base	33
Vinyl, Top Rail Insert	34

SAMPLE DISPLAYS (AVAILABLE ON REQUEST)



GLASS CLAMPS STAINLESS STEEL 15-0001-000-00



HANDRAIL BRACKETS STAINLESS STEEL 15-0005-000-00



RAILING SYSTEM STAINLESS STEEL 15-0004-000-00



—TACOrailing.com—

TACO Metals, Inc.
Headquarters:
50 NE 179th Street
Miami, FL 33162

Main Distribution and Manufacturing
1922 Smithville Highway
Sparta, TN 38583

Regional Distribution and Sales
1100 Charles Street
Longwood, FL 32750

580 Myles Standish Blvd.
Taunton, MA 02780

Contact Information
Please Call 800.743-3803 or 305.770.2328
Please Fax 305.770.2390

TACOrailing.com
info@TACOrailing.com

Member of:

NGA
NATIONAL GLASS ASSOCIATION

