



## Gerkin Windows & Doors

P.O Box 3203

Sioux City IA. 51102

Phone: (402) 494-6000 (800) 475-5061

Fax: (402) 494-6765

Web site: [www.gerkin.com](http://www.gerkin.com) E-Mail: [gerkin@gerkin.com](mailto:gerkin@gerkin.com)



### Rhino series thermally broken 2 3/8" aluminum windows Information book

- Page RC1 Sizing guidelines for 1-lite openings (All Rhino Windows)
- Page RC2 Sizing guidelines for multiple lites in 1 frame (Awning, casement, fixed & hoppers)
- Page RC3 Sizing guidelines for multiple lite openings side-stacked with no structural mullions (Awning, casement, fixed & hoppers)
- Page RC4 Sizing guidelines for multiple lite openings side-stacked with structural mullions (Awning, casement, fixed & hoppers)
- Page RC5 Sizing guidelines for multiple sliders side-stacking (Rhino sliding windows)
- Page RC6 Sizing guidelines for sliders with head-staking (Rhino sliding windows)
- Page RC7 Sizing guidelines for multiple singlehung side-stacking (Rhino singlehung windows)
- Page RC8 Sizing guidelines for singlehung with head-staking (Rhino singlehung windows)
- Page RC9 Accessories Gerkin panning system (All Rhino windows)
- Page RC10 Accessories Gerkin subframe system (All Rhino windows)
- Page RC11 Accessories Miscellaneous pieces (All Rhino windows)
- Page RC12-RC15 Warranty (All Rhino windows)





# RHINO THERMALLY BROKEN 2 3/8" ALUMINUM WINDOWS

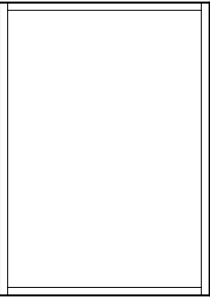

5500  
FIXED

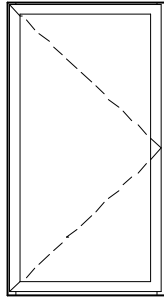

5300  
CASEMENT

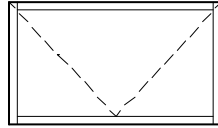

5200  
HOPPER

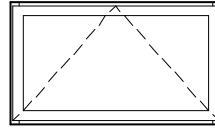

5100  
AWNING

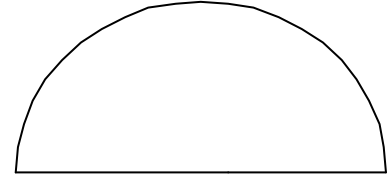

5700  
1/2 ROUND

**5500 FIXED**

72" X 72" MAX. CERTIFIED R.O  
12 3/4" X 12 3/4" MIN. R.O

**5700 1/2 ROUND FIXED**

72" X 36" MAX. R.O  
24" X 12" MIN. RO.

**5300 CASEMENT**

36" X 72" MAX. CERTIFIED RO.  
15 3/4" X 21 3/4" MIN. RO. W/ROTO HARDWARE    13 1/4" X 21 3/4" MIN. RO. W/PUSH/PULL HARDWARE

**5200 HOPPER**

61 1/2" X 33 1/2" MAX. CERTIFIED, MAX. NOT CERTIFIED RO. 60" X 36" OR 47" X 45"  
13 1/4" X 13 1/4" MIN. RO.

**5100 AWNING**

61 1/2" X 33 1/2" MAX. CERTIFIED, MAX. NOT CERTIFIED RO. 60" X 36" OR 47" X 45"  
21 3/4" X 17 1/2" MIN. R.O W/ROTO HARWARE    13 1/4" X 17 1/2" MIN. RO. W/PUSH/PULL HARWARE

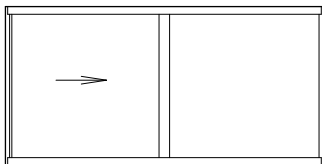

5000 2-LITE SLIDER

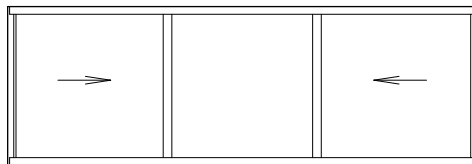

5000 3-EQUAL LITE SLIDER

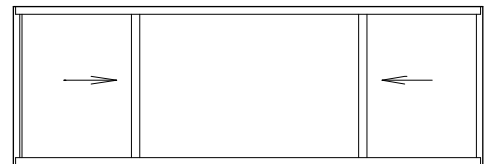

5000 3-LITE PICTURE SLIDER

**ALUMINUM 2-LITE SLIDERS**

5022 104" X 72" MAX. CERTIFIED R.O,  
5045 80" X 64" MAX. CERTIFIED R.O,  
18 3/4" X 12 3/4" MIN R.O

**ALUMINUM 3- EQUAL LITE SLIDERS**

5022 156" X 72" MAX. CERTIFIED R.O  
5045 120" X 64" MAX. CERTIFIED R.O

**ALUMINUM 3-LITE PICTURE SLIDERS**

5022 104" X 72" MAX. CERTIFIED R.O, 120" X 72" OR 132" X 60" MAX. NOT CERTIFIED  
5045 104" X 64" MAX. CERTIFIED R.O, 120" X 72" OR 132" X 60" MAX. NOT CERTIFIED

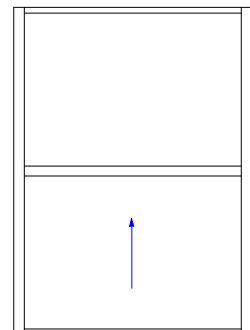

**5900 SINGLEHUNG**

54" X 90" MAX. CERTIFIED R.O  
16 1/2" X 30" MIN R.O

5900 SINGLEHUNG



# One frame window with multiple configurations

## Awning , Casement, Fixed & Hoppers



Gerkin Aluminum thermally broken commercial windows with 2 3/8" frame depth. Can be glazed with 5/8" or 1" units. Standard colors available: clear anodized, dark bronze anodized, white painted or bronze painted. Custom colors are available upon request.

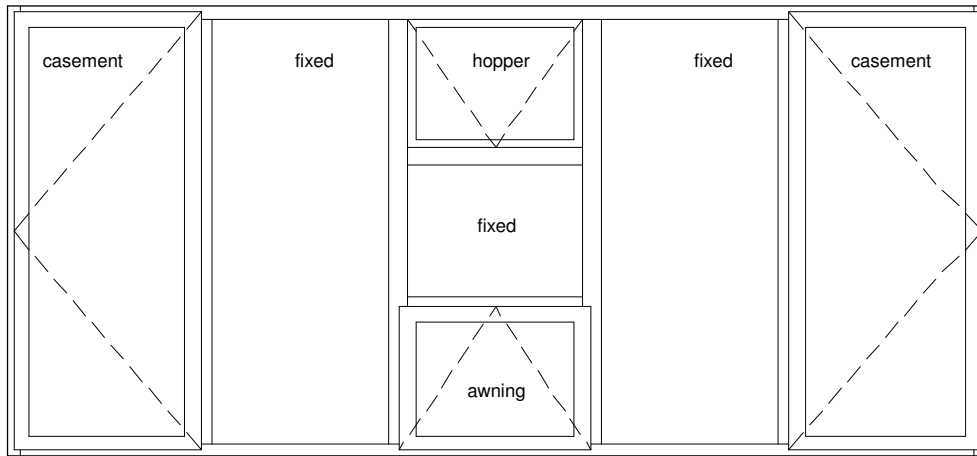

There are many different configurations that can be used in the Gerkin stand alone system. When choosing your configuration you must use the following guidelines.

### 1. The rails can not be crossed in a 1 frame configuration

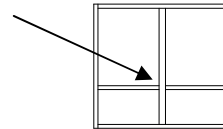

### 2. Maximum rough opening can not exceed 144" width X 72" height or 72" width X 144" height

### 3. Reference dimensions must conform to the following:

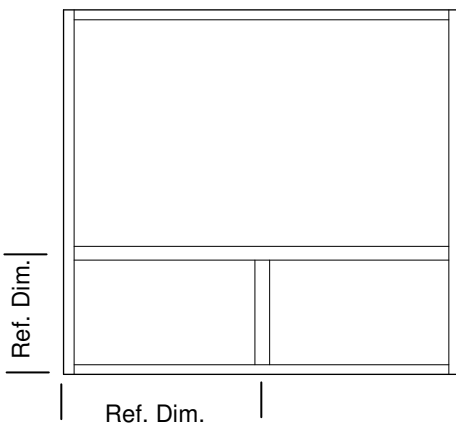

	max size	min size roto	min size push / pull
5100 Awning	60" x 30"	21" x 17 1/2"	12 1/2" x 17 1/2"
5200 Hopper	60" x 30"	N/A	12 1/2" X 12 1/2"
5300 Casement	36" x 72"	15" x 21 3/4"	12 1/2" x 21 3/4"
5500 Fixed	48" x 72"	N/A	12 1/2" x 12 1/2"



# Side-stack configurations with no structural mull

## Awning, Casement, Fixed & Hoppers

Gerkin Aluminum thermally broken commercial windows with 2 3/8" frame depth. Can be glazed with 5/8" or 1" units. Standard colors available: clear anodized, dark bronze anodized, white painted or bronze painted. Custom colors are available upon request.



### Caulk interior & exterior leg of stack rail

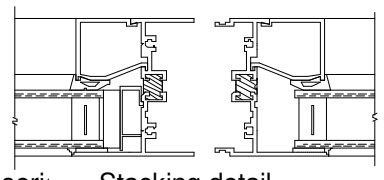

Rhino series Stacking detail (A)

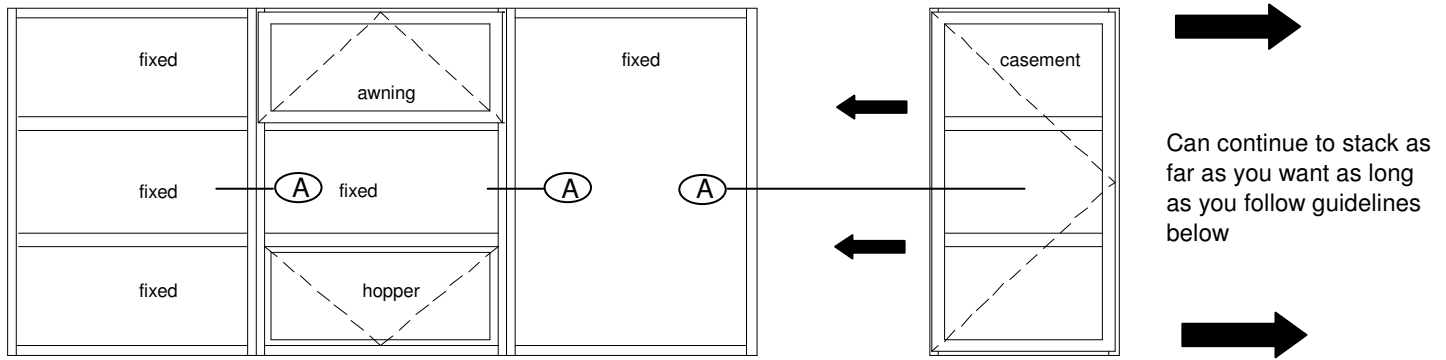

There are many different configurations that can be used in the Gerkin side stack system. When choosing your configuration you must use the following guidelines.

### 1. The rails can not be crossed in a 1 frame configuration

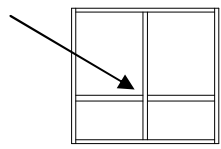

### 2. Individual frame cannot exceed 48" wide X 72" tall

### 3. Reference dimension must conform to the following:

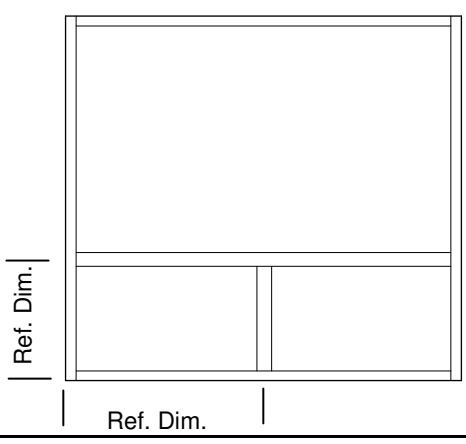

	max size	min size roto	min size push / pull
5100 Awning	48" x 30"	21" x 17 1/2"	12 1/2" x 17 1/2"
5200 Hopper	48" x 30"	N/A	12 1/2" x 12 1/2"
5300 Casement	36" x 72"	15" x 21 3/4"	12 1/2" x 21 3/4"
5500 Fixed	48" x 72"	N/A	12 1/2" x 12 1/2"

# Side-stack configurations with structural mull

## Awning , Casement, Fixed & Hoppers

Gerkin Aluminum thermally broken commercial windows with 2 3/8" frame depth. Can be glazed with 5/8" or 1" units. Standard colors available: clear anodized, dark bronze anodized, white painted or bronze painted. Custom colors are available upon request.

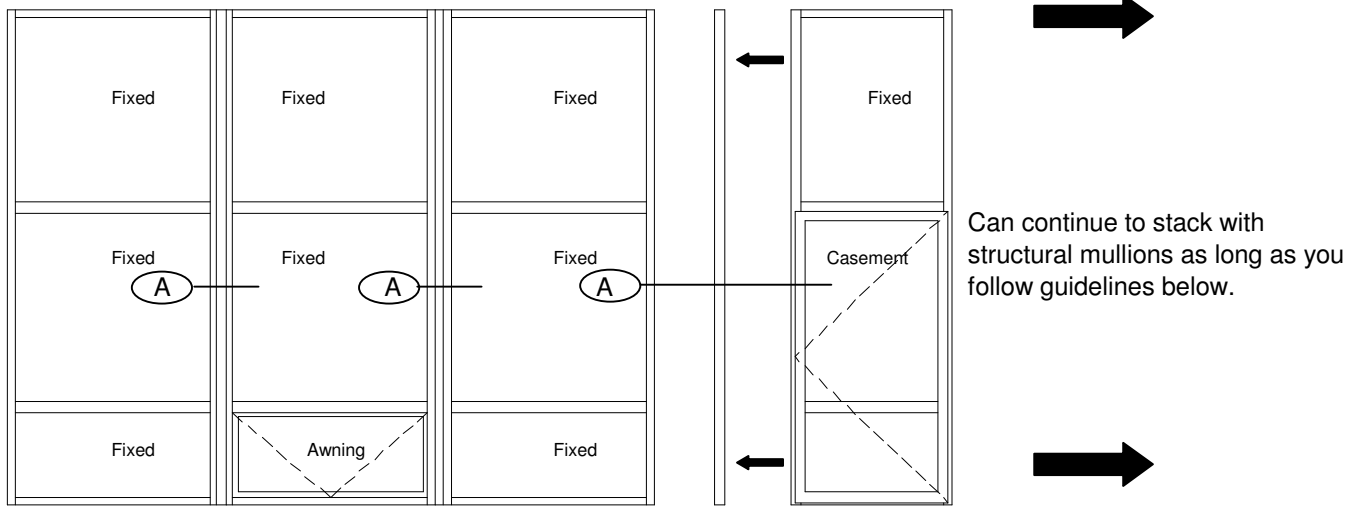
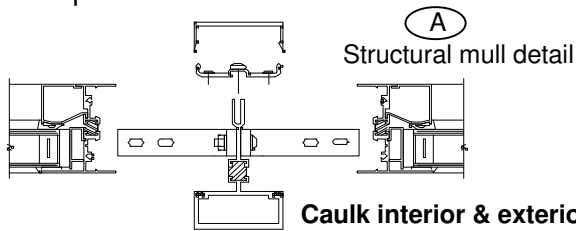

There are many different configurations that can be used in the Gerkin stack system. When choosing your configuration you must use the following guidelines.

**1. The rails can not be crossed in a 1 frame configuration**

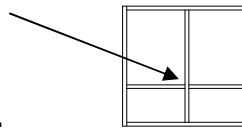

**2. Individual frames up to 96" tall can not exceed 48" wide.**

**OR**

**2. Individual frames up to 120" tall can not exceed 36" wide.**

**3. Reference dimension must conform to the following:**

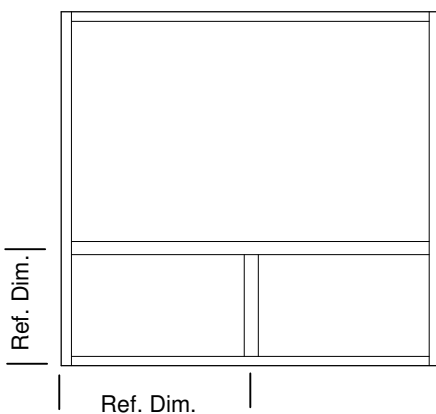

	max size	min size roto	min size push / pull
5100 Awning	48"/36" x 30"	21" x 17 1/2"	12 1/2" x 17 1/2"
5200 Hopper	48"/36" x 30"	N/A	12 1/2" x 12 1/2"
5300 Casement	36" x 72"	15" x 21 3/4"	12 1/2" x 21 3/4"
5500 Fixed	48"/36" x 72"	N/A	12 1/2" x 12 1/2"

## Side-stack configurations with stacking H channel

### Rhino sliding windows

Gerkin Aluminum thermally broken commercial windows. 2 3/8" frame depth. 5/8" overall insulated glass. Standard colors available clear anodized, dark bronze anodized, white painted or bronze painted. Custom colors are available upon request.

Caulk full perimeter interior & exterior of H channel

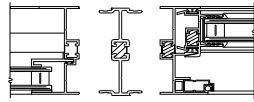

Rhino series thermally

(A)

Stacking H channel detail

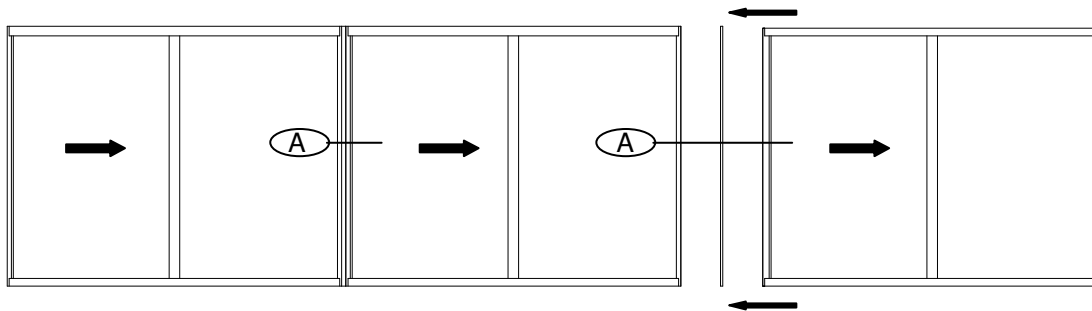

Can continue to stack as long as an individual slider does not exceed 72" wide X 72" tall.

## Side stack configurations with structural mullions

### Rhino sliding windows

Caulk full perimeter interior & exterior of structural mullion

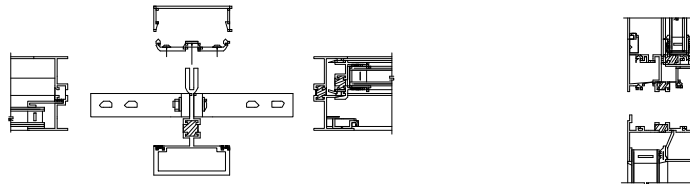

(B)

Structural mullion detail

(C)

Head stack detail

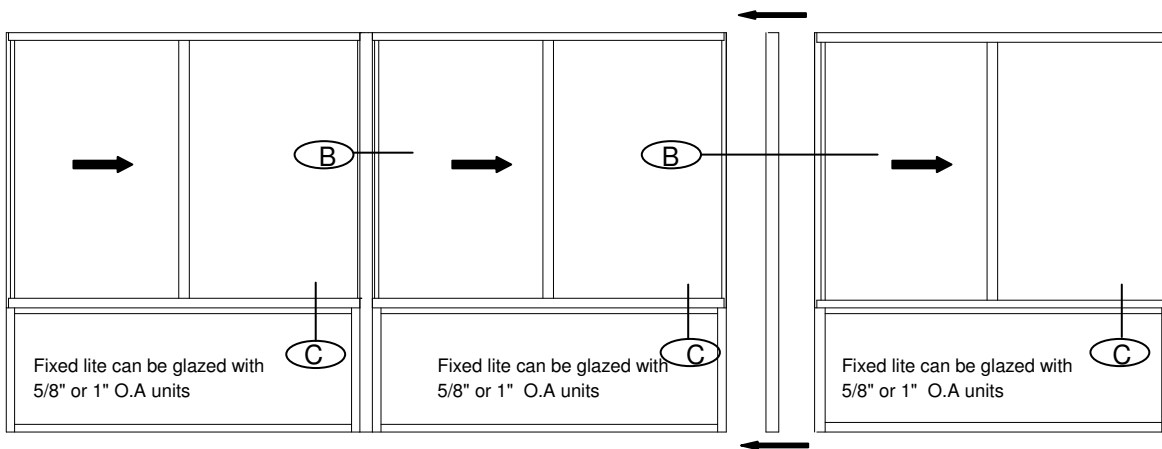

Can continue to stack as long as slider-fixed, head/sill stacked combination does not exceed 48" wide X 96" tall

# Head & sill stack configurations

## Rhino sliding windows

Gerkin Aluminum thermally broken commercial windows with 2 3/8" frame depth. 5/8" overall insulated glass. Standard colors available clear anodized, dark bronze anodized, white painted or bronze painted. Custom colors are available upon request.

**Caulk full perimeter interior & exterior of stack rails**

Head stack detail

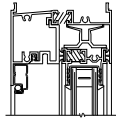
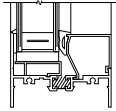

A

Head stack detail

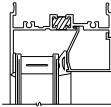
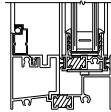

C

Head stack detail

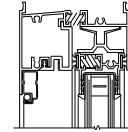
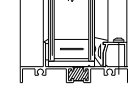

B

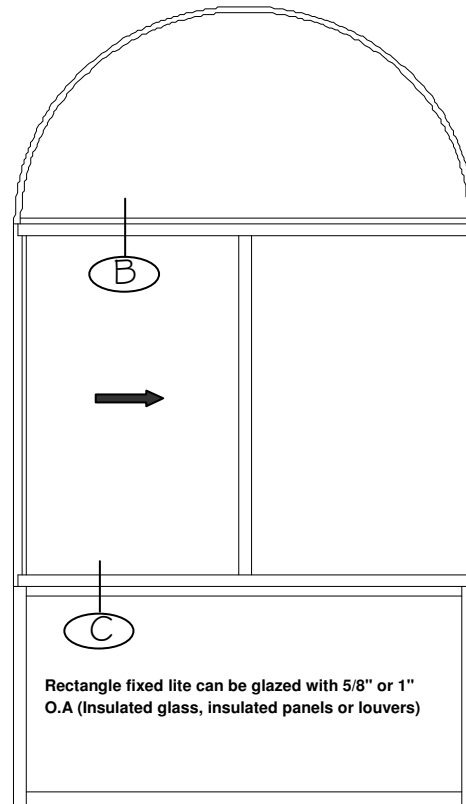
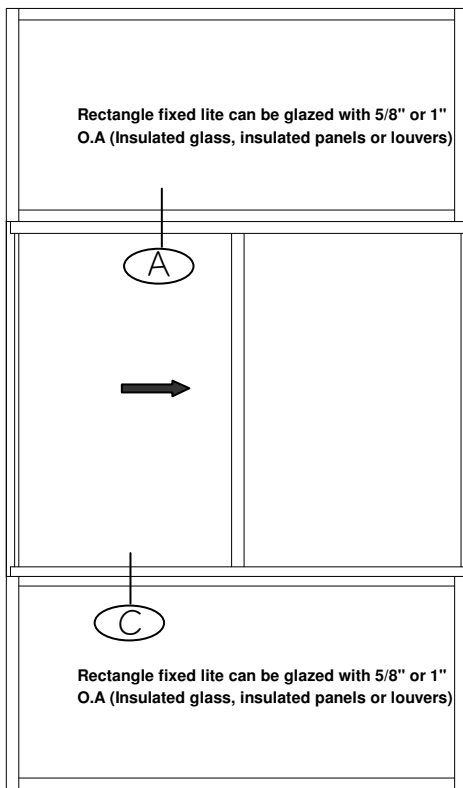

- Slider can not exceed 72" wide X 60" tall max. R.O
- Slider can not be below 18 1/2" wide X 12 1/2" tall min. R.O
- Transom can not exceed 72" wide X 36" tall max. R.O
- Transom can not be below 18 1/2" wide X 12 1/2" tall min. R.O
- Bottom fixed can not exceed 72" wide X 36" tall min. R.O
- Bottom fixed can not be below 18 1/2" wide X 12 1/2" tall min. R.O

- Slider can not exceed 72" wide X 60" tall max. R.O
- Slider can not be below 36" wide X 12 1/2" tall min. R.O
- 1/2 Round can not exceed 72" wide max. R.O
- 1/2 Round can not be below 36" wide min. R.O
- Bottom fixed can not exceed 72" wide X 36" tall min. R.O
- Bottom fixed can not be below 18 1/2" wide X 12 1/2" tall min. R.O

## Side-stack configurations with stacking H channel

### Rhino singlehung windows

Gerkin Aluminum thermally broken commercial windows. 2 3/8" frame depth. 5/8" overall insulated glass. Standard colors available clear anodized, dark bronze anodized, white painted or bronze painted. Custom colors are available upon request.

Caulk full perimeter interior & exterior of H channel

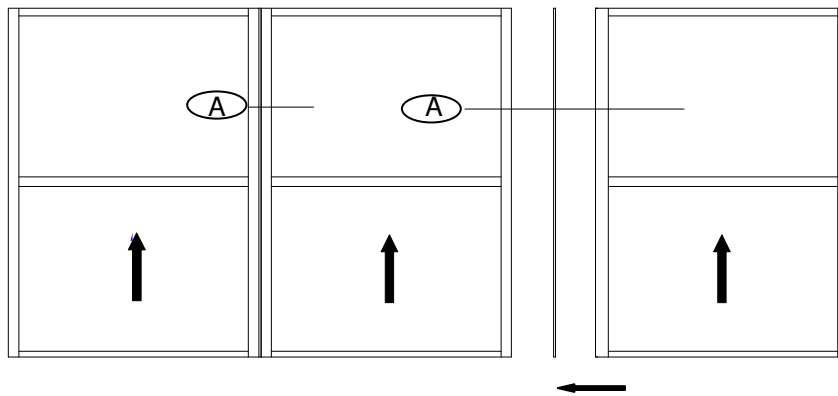
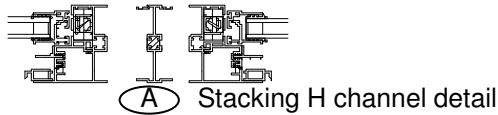

Can continue to stack as long as an individual singlehung does not exceed 48" wide X 72" tall.

## Side stack configurations with structural mullions

### Rhino singlehung windows

Caulk full perimeter interior & exterior of structural mullion

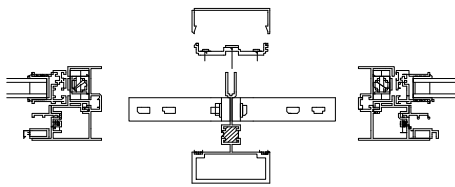

(B) Structural mullion detail

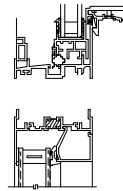

(C) Head stack detail

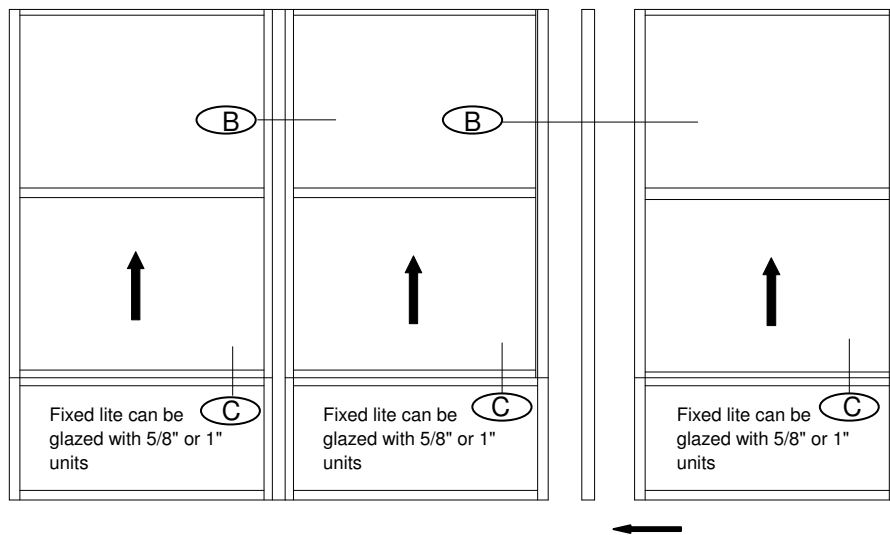

Can continue to stack as long as singlehung-fixed, head/sill stacked combination does not exceed 48" wide X 96" tall  
Or  
36" wide X 120" tall



# Head & sill stack configurations

## Rhino singlehung windows

Gerkin Aluminum thermally broken commercial windows with 2 3/8" frame depth. 5/8" overall insulated glass. Standard colors available clear anodized, dark bronze anodized, white painted or bronze painted. Custom colors are available upon request.

**Caulk full perimeter interior & exterior of stack rails**

Head stack detail

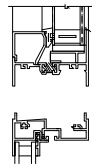

A

Head stack detail

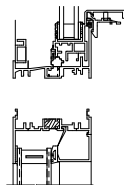

C

Head stack detail

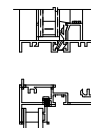

B

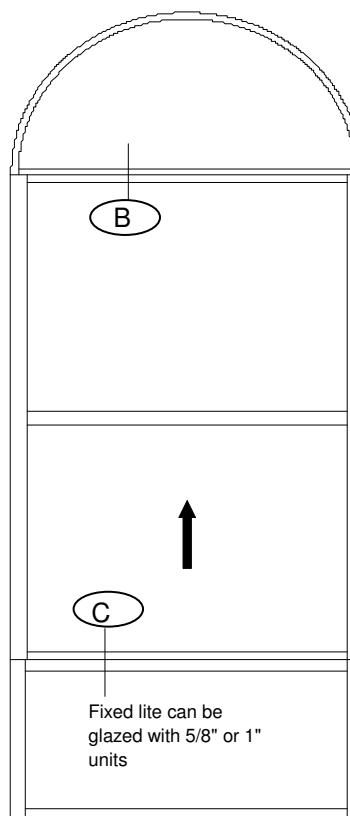
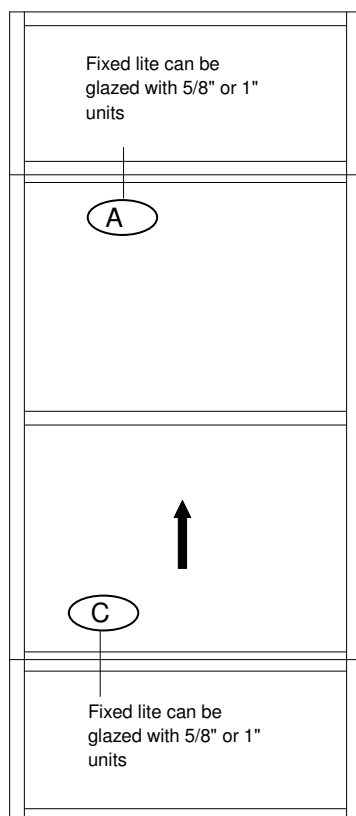

Overall unit cannot exceed 48" x 108"

- Singlehung can not exceed 48" wide X 72" tall max.R.O
- Singlehung can not be below 16 1/2" wide X 30" tall min. R.O
- Transom can not exceed 48" wide X 36" tall max. R.O
- Transom can not be below 18 1/2" wide X 12 1/2" tall min. R.O
- Bottom fixed can not exceed 48" wide X 36" tall min. R.O
- Bottom fixed can not be below 18 1/2" wide X 12 1/2" tall min. R.O

- Singlehung can not exceed 48" wide X 72" tall max.R.O
- Singlehung can not be below 16 1/2" wide X 30" tall min. R.O
- 1/2 Round can not exceed 48" wide max. R.O
- 1/2 Round can not be below 24" wide min. R.O
- Bottom fixed can not exceed 48" wide X 36" tall min. R.O
- Bottom fixed can not be below 18 1/2" wide X 12 1/2" tall min. R.O



**caulk full perimeter**

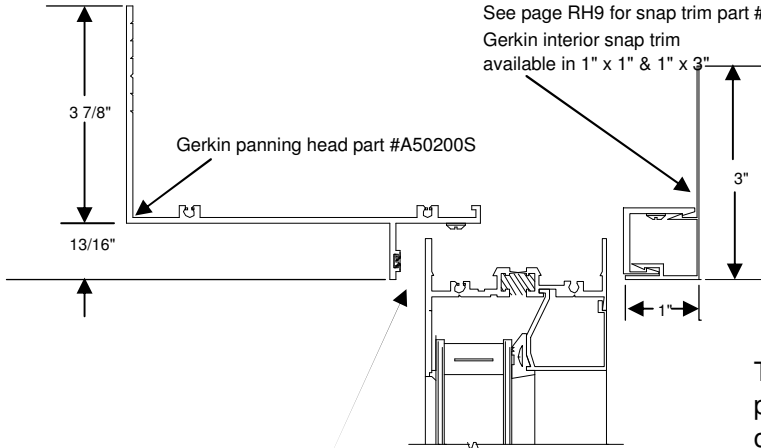

The Gerkin panning system is ideal for retrofit projects where you can't remove existing frames or there is some irregularities in the opening. The panning system is designed to cover unsightly conditions. On some projects panning can save labor when replacing old inefficient unsightly windows with thermally broken energy efficient windows that have a new and clean look. When using the panning system check out our interior snap trims that can be adapted to many conditions and will give you a nice finished look both interior and exterior.

**caulk full perimeter**

Vinyl bulb is for tolerance only, it is not a weather stripping.  
(Caulk full perimeter)

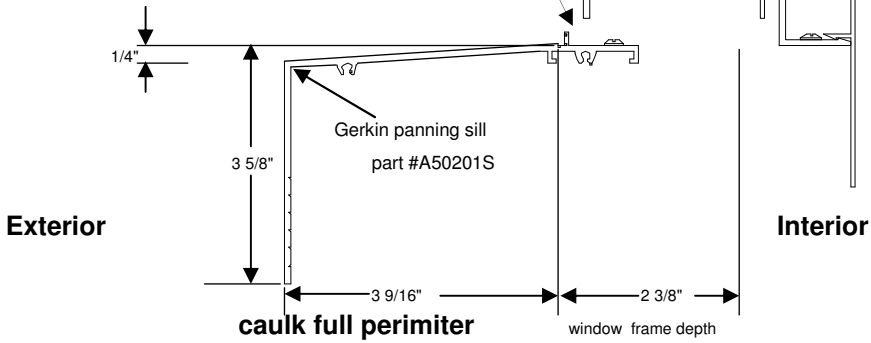

**caulk full perimeter**

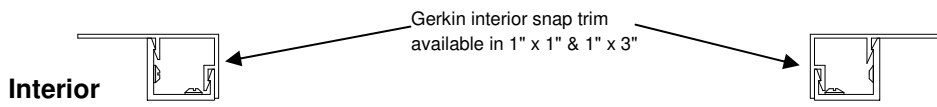

Interior



**caulk full perimeter**

vinyl bulb part #V50350BK

Vinyl bulb is for tolerance only, it is not a weather stripping.  
(Caulk full perimeter)

Gerkin panning jamba same as head

Gerkin panning jamba same as head

**caulk full perimeter**

**caulk full perimeter**

Exterior

# RHINO SERIES SUBFRAME SYSTEM



The Gerkin subframe system is ideal for new construction or retrofit projects where you don't want to set up bulky scaffolding or rent expensive lifts for window installations. The subframe is a two piece receptor system that is thermally broken and allows you to install windows from the interior of the building. When used the subframe system can save both time and money

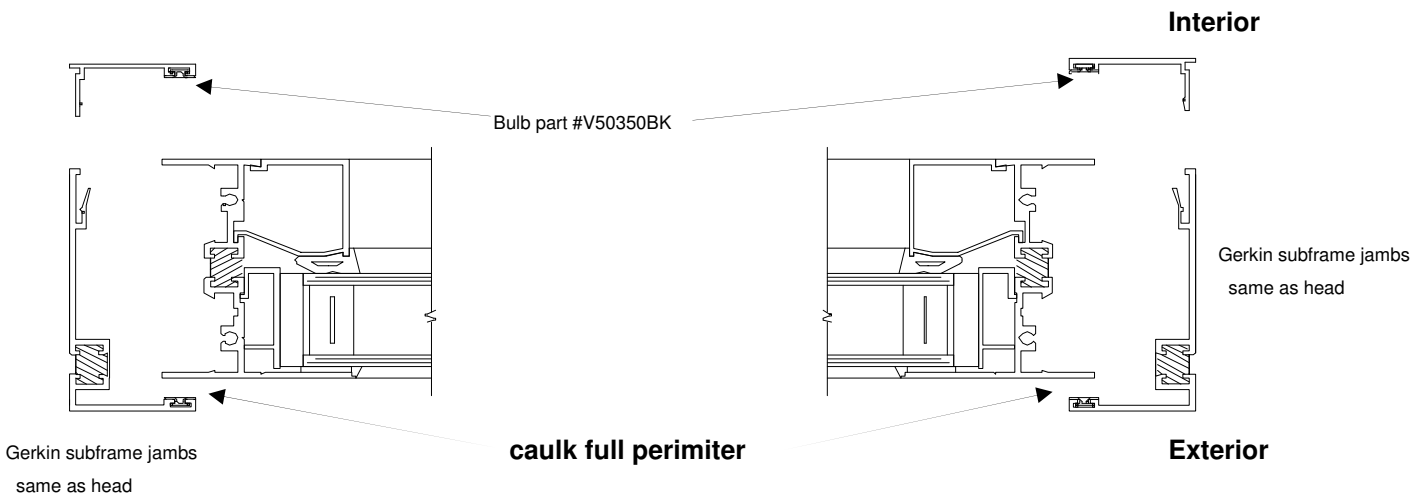
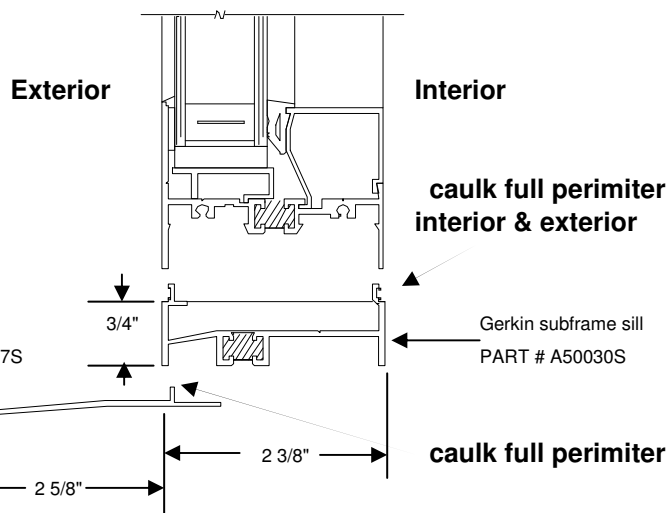
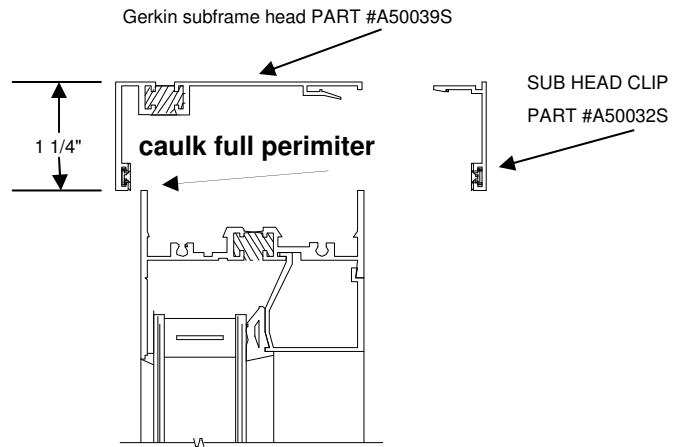



# RHINO SERIES ACCESSORIES



## GERKIN STRUCTURAL MULLION

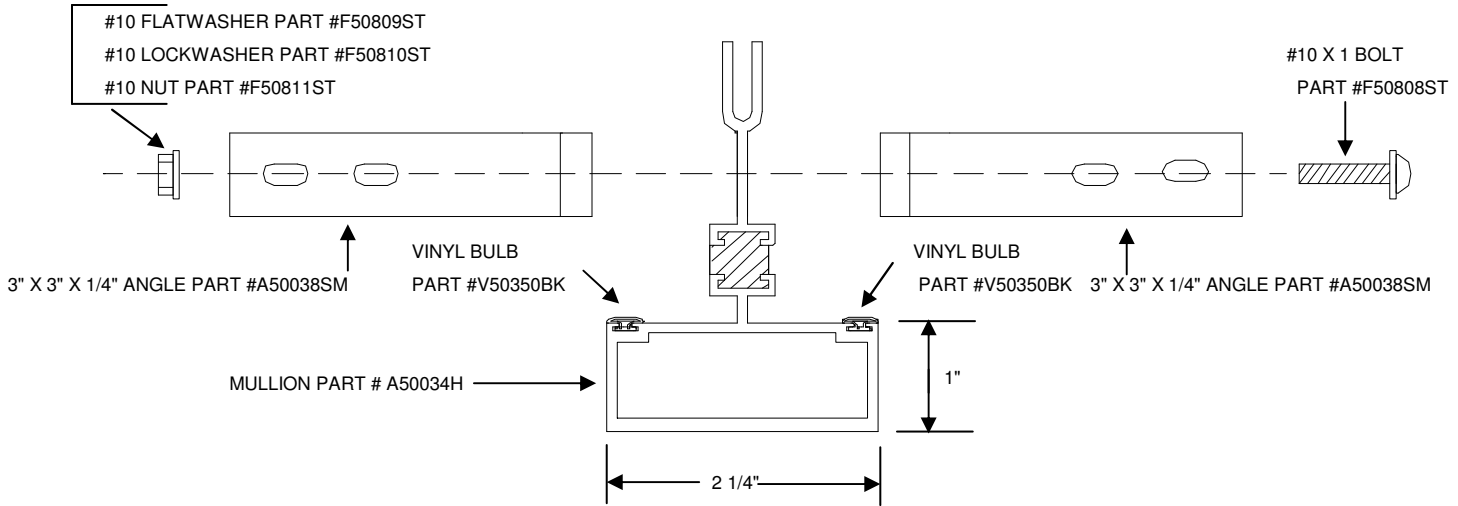
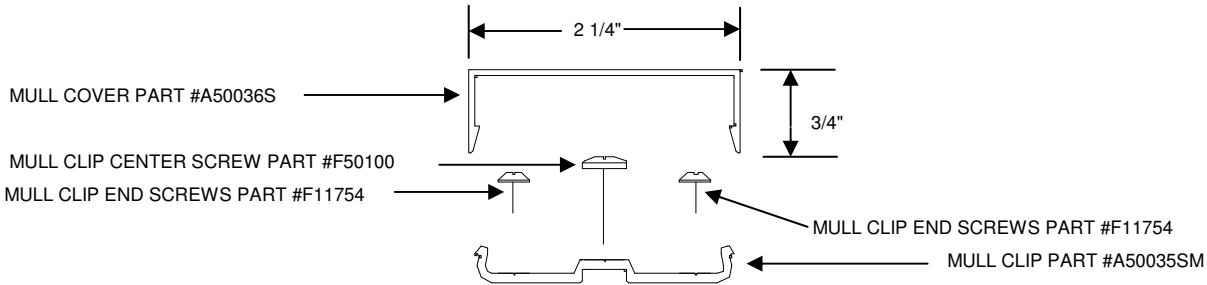

### GERKIN SILL FLASHING

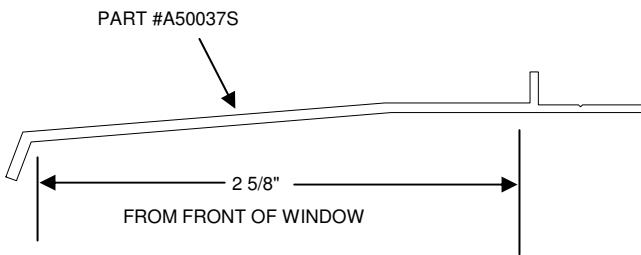

### GERKIN STACKING H CHANNEL

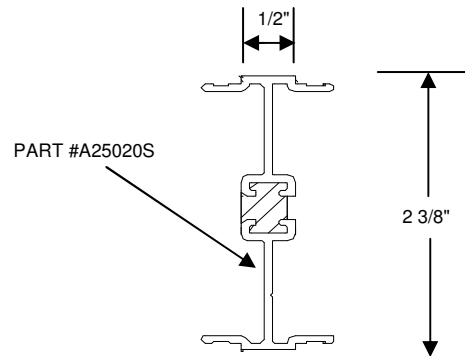

### GERKIN 1" X 3" INTERIOR SNAP TRIM

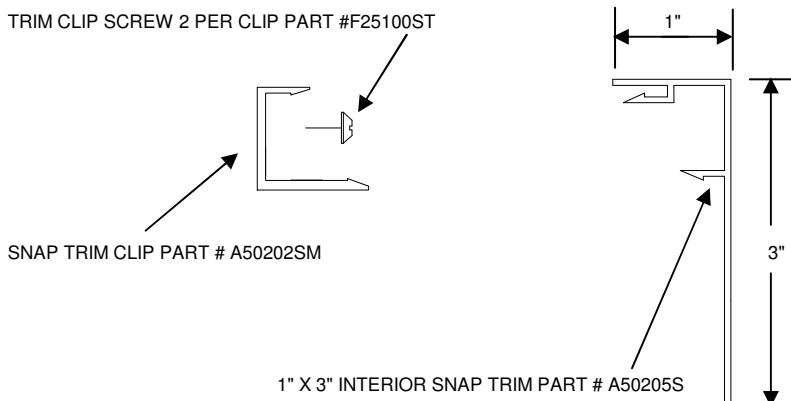

### GERKIN STRUCTURAL STACK

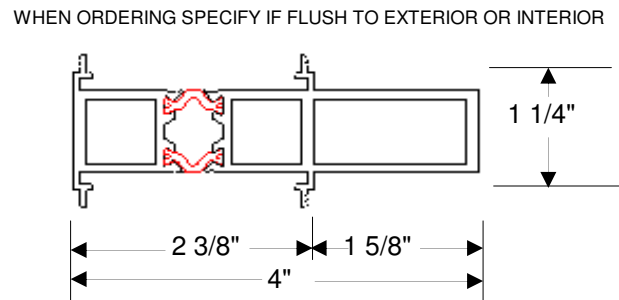



## **Gerkin Windows and Doors Rhino Limited Warranty as of February 1, 2012.**

### **This Limited Warranty Covers the Following Areas:**

Gerkin Windows and Doors warrants each product manufactured by it to be free from defects in materials or workmanship (excluding installation) that would materially impair the function and proper operation of the aluminum window and door products we manufactured for use in the United States as hereafter set forth. Any defects that arise from or relate to conditions that are beyond our control are excluded from this warranty including without limitation those found in the "Conditions and Exclusions" and "This Warranty Does Not Cover" sections below.

### **Limited Warranty Coverage:**

This warranty covers only the owner of the building in which the product is initially installed and is non-transferable.

### **Limited Warranty Information:**

This warranty extends only to the original consumer of the product and is limited to repair or replacement of defective parts. If a problem under this warranty requires total replacement of a window or patio door, which is already installed, the purchaser is responsible for removal of the defective unit and reinstallation of the new unit. Gerkin is also not responsible for any other incidental costs related to removal or reinstallation.

### **Limited Warranty Time Limits:**

The time limits for the Gerkin limited warranty all commence as of the time of initial sale and are as follows:

1. Weatherstripping is limited to repair or replacement of defective parts for a period of three (3) years.
2. Hardware is limited to repair or replacement of defective parts for a period of three (3) years.
3. The Hermetic seal of insulated glass shall be free from failure except breakage for a period of twenty (20) years for an owner occupied single family residence and (10) years if the product is installed in a building other than an owner occupied single family residence. The stress crack warranty is one (1) year.
4. The hermetic seal and stress crack warranty includes labor for the first year.
5. The frame and sash, including factory applied accessories, is warranted for ten (10) years for an owner occupied single family residence. If the product is installed in a building other than an owner occupied single family residence, the frame and sash warranty shall be for a period of five (5) years.
6. A standard finish warranty is limited to five (5) years and covers cracking, chipping, and peeling. The warranty on custom finishes shall be as included with the product. If there is no separate warranty included with the product, then the standard finish warranty shall apply.
7. The electric hardware warranty is one (1) year.
8. For windows that are manufactured by Gerkin Windows and Doors with aluminum louvers manufactured by others, the louvers carry a one (1) year warranty.
9. For windows manufactured by Gerkin Windows and Doors with insulated panels manufactured by others, the panels carry a five (5) to twenty-five (25) year warranty

depending on finish. Contact the factory for details.

**Product Advancements:**

It is the policy of Gerkin Windows and Doors to constantly strive to improve its products. The right therefore is reserved to make changes in design and improvements whenever it is believed the efficiency of the product will be improved thereby, but without incurring obligation to incorporate such improvements in product, which has been shipped or is in service. Because manufacturing materials and techniques can change, replacement products may not be an exact aesthetic match to the original.

**Customer Responsibility:**

Even though Gerkin products are of superior quality, this limited warranty applies only if the Gerkin product has been properly installed, used and maintained.

**Conditions and Exclusions:**

1. The limited warranties set forth in this document are the only expressed warranties (whether written or oral) applicable to Gerkin Windows and Doors products, and no one is authorized to modify or expand these written warranties. All warranty claims must be made during the applicable warranty period.

2. Custom sized windows built to customer specifications that exceed the size limitations of Gerkin Windows and Doors as per its AAMA test and certification results are not rated or certified and may or **may not meet specifications or code requirements for a specific job. These windows will have no warranty related to air, water, and structural issues.**

3. Windows that are manufactured at Gerkin Windows & Doors unglazed and are to be glazed by others will have **no warranty on the insulated glass unit or on the seal of the glass unit to the window frame.**

**DISCLAIMER OF UNSTATED WARRANTIES: THE WARRANTIES PRINTED ABOVE ARE THE ONLY WARRANTIES APPLICABLE TO THE PURCHASE OF GERKIN PRODUCTS. ALL OTHER WARRANTIES, EXPRESS OR IMPLIED, INCLUDING BUT NOT LIMITED TO, THE IMPLIED WARRANTIES OF MERCHANTABILITY AND FITNESS FOR A PARTICULAR PURPOSE ARE DISCLAIMED.**

**LIMITATION OF LIABILITY: IT IS UNDERSTOOD AND AGREED THAT GERKIN WINDOWS AND DOORS LIABILITY, WHETHER IN CONTRACT, IN TORT, UNDER ANY WARRANTY, IN NEGLIGENCE OR OTHERWISE, SHALL NOT EXCEED THE RETURN OF THE AMOUNT OF THE PURCHASE PRICE PAID BY PURCHASER, AND UNDER NO CIRCUMSTANCES SHALL GERKIN WINDOWS AND DOORS BE LIABLE FOR SPECIAL, INDIRECT, OR CONSEQUENTIAL DAMAGES. THE PRICE STATED FOR THE PRODUCT IS A CONSIDERATION IN LIMITING GERKIN WINDOWS AND DOORS' LIABILITY. NO ACTION, REGARDLESS OF FORM, ARISING OUT OF THE TRANSACTIONS UNDER THIS AGREEMENT MAY BE BROUGHT BY PURCHASER MORE THAN ONE (1) YEAR AFTER THE CAUSE OF ACTION HAS ACCRUED.**

**This Warranty Does Not Cover the Following Areas:**

This warranty does not cover, and Gerkin Windows and Doors is not liable for:

- Broken or torn screens
- Screen fabric

- Color change, fading or chalking whether or not due to natural weathering or other atmospheric conditions, such as pollution, and extreme heat and/or UV exposure. High humidity or airborne pollutants such as salt or acid rain
- Fading of surfaces and/or hardware finishes.
- Loss of functionality because of corrosion.
- Glass breakage; Not responsible for spontaneous breakage, failure due to misuse, abuse or accident; and damage caused by failure to perform periodic maintenance; by alteration or modification to the product (such as tints, films, paint or security systems applied or attached to the product); by improper or insufficient ventilation which causes excessive heat build up, such as blinds or window treatments; or any other cause beyond our control (including without limitation fire, flood, earthquake and other acts of nature).
- Not responsible for damage after goods are received
- Minor imperfections in the glass that do not affect structural integrity, product performance or that do not significantly obscure normal vision, including minor scratches, curvature or waviness of the glass and minor variations in glass color.
- Inert gas loss due to the natural process of gas migration over time. It is known that inert gases within an insulated unit will naturally dissipate over time. No warranty is made specifying the amount of inert gas present in an insulated glass unit.
- Improper handling, installation, maintenance or operation not in conformance with our installation instructions; problems related to water and/or air infiltration or leaking caused by improper use or installation; flaws in building design or construction or sloped glazing or other non-vertical installation.
- Damage or poor product performance resulting from installation into a condition that fails to meet product design standards and/or certified performance specifications and/or is not in compliance with building codes; or from settling or movement of the building.
- Condensation. (Condensation problems should be addressed by a qualified heating/air-conditioning specialist.)
- Labor and materials for the installation of a complete replacement product.
- Any repainting or finishing required in connection with warranty work.
- Product that has not been paid for.
- Installation or handling or any damage caused by such installation or handling.
- Accidents
- Acts of God
- Minor scratches or color variations in metal finish
- Labor to replace sash or door panels, glass or other components
- Labor and materials to paint or stain any repaired or replaced product, component, trim or other carpentry work that may be required
- Products not manufactured by Gerkin (unless otherwise noted)
- Service trips to provide instruction on product use or to inspect product claims
- Applicable taxes and freight
- Any product that has been changed, modified, or serviced by someone other than a Gerkin Windows and Doors authorized technician.

#### **How to Get Service:**

Notify the company in writing (to the address shown below) describing the defect or problem, provide proof of purchase, original date of installation, name, address and telephone number of person making claim and the order number which can be found on the inside of the frame or sash of the window. The obligations under this warranty will be completed by the company within 90 days after the notice of defect has been received by Gerkin, unless there are extenuating circumstances to deal with.

Gerkin Windows and Doors  
P.O. Box 3203  
Sioux City, IA 51102  
or reach us by phone at 1-800-475-5061

**Correcting the Problem:**

Upon notification, we will investigate the problem. If, in our sole discretion, the product is found to be defective, and is covered under the provisions of this warranty, we will repair the product or provide replacement parts necessary to repair the product at no charge. If the defect cannot be repaired in our sole judgment, we will provide a replacement product and ship it to the original delivery site. Installation or reinstallation of repaired or replacement product is not covered if replacement products are provided. All in-place service under this warranty will be performed at the site of the initial installation.

**Other Important Legal Information:**

The limited warranty stated herein is in no way intended to be a statement of the useful life of the products of Gerkin Windows and Doors. The original purchaser of this product agrees that it has read this warranty and understands it, is bound by its terms and will provide this warranty to the original owner of the structure into which the product is installed.

**How State Law Relates to This Warranty:**

Some states do not allow the exclusion or limitation of incidental or consequential damages or limitation of the duration of an implied warranty, so the above limitations and exclusions may not apply to you.

This limited warranty is only applicable in the USA (i.e. the fifty states and the District of Columbia). This limited warranty gives you specific legal rights, and you may also have other rights, which may vary from state to state.