



## Gerkin Windows & Doors

P.O Box 3203

Sioux City IA. 51102

Phone: (402) 494-6000 (800) 475-5061

Fax: (402) 494-6765

Web site: [www.gerkin.com](http://www.gerkin.com) E-Mail: [gerkin@gerkin.com](mailto:gerkin@gerkin.com)



### Rhino series thermally broken aluminum windows Information book

- Page RC1 Sizing guidelines for 1-lite openings (All Rhino Windows)
- Page RC2 Sizing guidelines for multiple lites in 1 frame ( Awning, casement, fixed & hoppers)
- Page RC3 Sizing guidelines for multiple lite openings side-stacked with no structural mullions ( Awning, casement, fixed & hoppers)
- Page RC4 Sizing guidelines for multiple lite openings side-stacked with structural mullions ( Awning, casement, fixed & hoppers)
- Page RC5 Sizing guidelines for multiple sliders side-stacking ( Rhino sliding windows)
- Page RC6 Sizing guidelines for sliders with head-staking ( Rhino sliding windows)
- Page RC7 Sizing guidelines for multiple singlehung side-stacking ( Rhino singlehung windows)
- Page RC8 Sizing guidelines for singlehung with head-staking ( Rhino singlehung windows)
- Page RC9 Accessories Gerkin panning system (All Rhino windows)
- Page RC10 Accessories Gerkin subframe system (All Rhino windows)
- Page RC11 Accessories Miscellaneous pieces (All Rhino windows)
- Page RC12 Warranty (All Rhino windows)



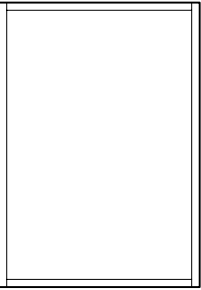

5500  
FIXED

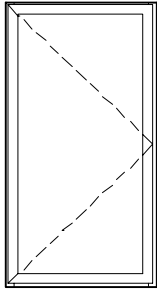

5300  
CASEMENT

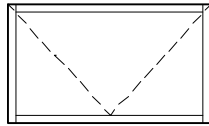

5200  
HOPPER

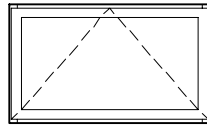

5100  
AWNING

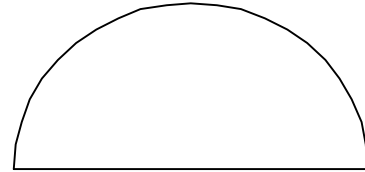

5700  
1/2 ROUND

**5500 FIXED**

72" X 72" MAX. CERTIFIED R.O  
12 3/4" X 12 3/4" MIN. R.O

**5700 1/2 ROUND FIXED**

72" X 36" MAX. R.O  
24" X 12" MIN. RO.

**5300 CASEMENT**

36" X 72" MAX. CERTIFIED RO.  
15 3/4" X 21 3/4" MIN. RO. W/ROTO HARDWARE    13 1/4" X 21 3/4" MIN. RO. W/PUSH/PULL HARDWARE

**5200 HOPPER**

61 1/2" X 33 1/2" MAX. CERTIFIED, MAX. NOT CERTIFIED RO. 60" X 36" OR 47" X 45"  
13 1/4" X 13 1/4" MIN. RO.

**5100 AWNING**

61 1/2" X 33 1/2" MAX. CERTIFIED, MAX. NOT CERTIFIED RO. 60" X 36" OR 47" X 45"  
21 3/4" X 17 1/2" MIN. R.O W/ROTO HARWARE    13 1/4" X 17 1/2" MIN. RO. W/PUSH/PULL HARWARE

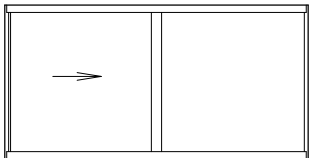

5000 2-LITE SLIDER

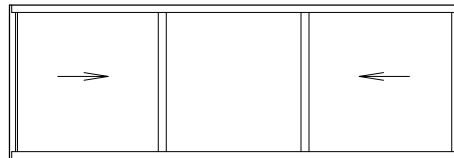

5000 3-EQUAL LITE SLIDER

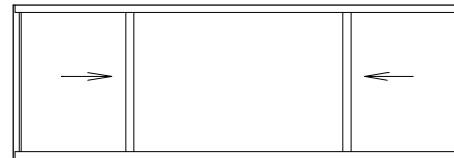

5000 3-LITE PICTURE SLIDER

**ALUMINUM 2-LITE SLIDERS**

C-30 96" X 72" MAX. CERTIFIED R.O, MAX NOT CERTIFIED 104" X 64"  
C-45 96" X 64" MAX. CERTIFIED R.O, MAX NOT CERTIFIED 96" X 72"  
18 3/4" X 12 3/4" MIN R.O

**ALUMINUM 3- EQUAL LITE SLIDERS**

C-30 156" X 72" MAX. CERTIFIED R.O  
C-45 156" X 64" MAX. CERTIFIED R.O  
C-45 156" X 72" MAX. NOT CERTIFIED R.O

**ALUMINUM 3-LITE PICTURE SLIDERS**

C-30 104" X 72" MAX. CERTIFIED R.O, 120" X 72" OR 132" X 60" MAX. NOT CERTIFIED  
C-45 104" X 64" MAX. CERTIFIED R.O, 120" X 72" OR 132" X 60" MAX. NOT CERTIFIED

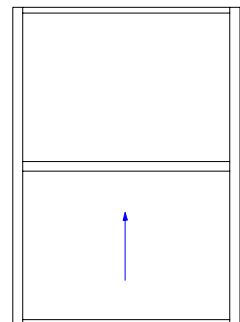

**5900 SINGLEHUNG**

54" X 90" MAX. CERTIFIED R.O  
16 1/2" X 30" MIN R.O

5900 SINGLEHUNG



# One frame window with multiple configurations

## Awning , Casement, Fixed & Hoppers



Gerkin Aluminum thermally broken commercial windows with 2 3/8" frame depth. Can be glazed with 5/8" or 1" units. Standard colors available: clear anodized, dark bronze anodized, white painted or bronze painted. Custom colors are available upon request.

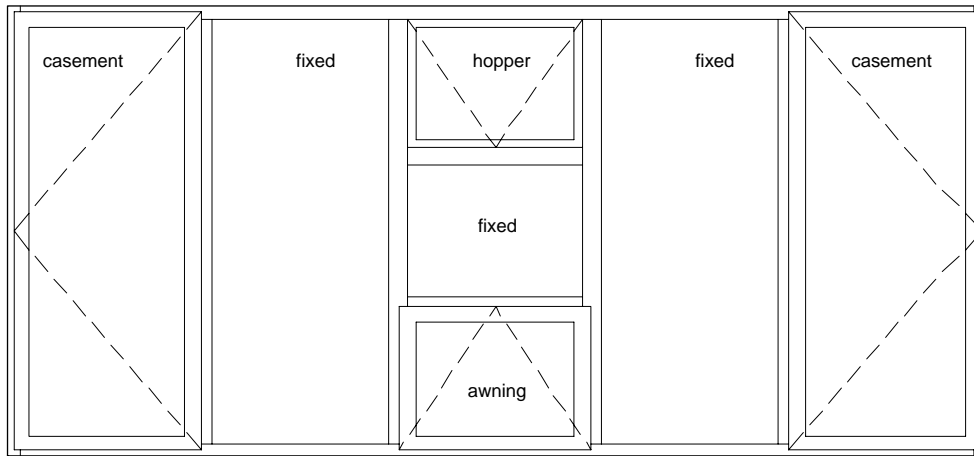

There are many different configurations that can be used in the Gerkin stand alone system. When choosing your configuration you must use the following guidelines.

**1. The rails can not be crossed in a 1 frame configuration**

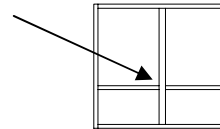

**2. Maximum rough opening can not exceed 144" width X 72" height or 72" width X 144" height**

**3. Reference dimensions must conform to the following:**

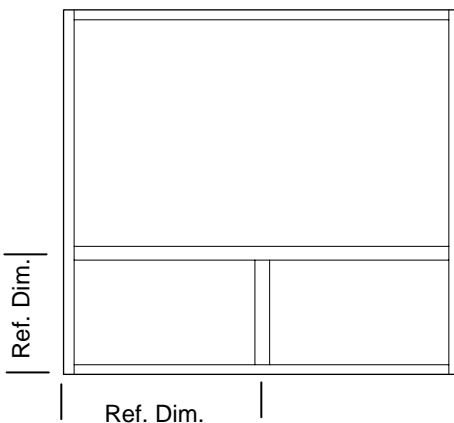

	max size	min size roto	min size push / pull
5100 Awning	60" x 30"	21" x 17 1/2"	12 1/2" x 17 1/2"
5200 Hopper	60" x 30"	N/A	12 1/2" X 12 1/2"
5300 Casement	36" x 72"	15" x 21 3/4"	12 1/2" x 21 3/4"
5500 Fixed	48" x 72"	N/A	12 1/2" x 12 1/2"

# Side-stack configurations with no structural mull

## Awning , Casement, Fixed & Hoppers

Gerkin Aluminum thermally broken commercial windows with 2 3/8" frame depth. Can be glazed with 5/8" or 1" units. Standard colors available: clear anodized, dark bronze anodized, white painted or bronze painted. Custom colors are available upon request.

### Caulk interior & exterior leg of stack rail

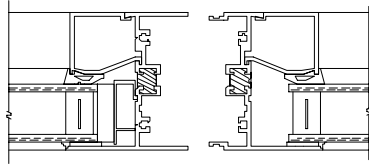

Stacking detail

(A)

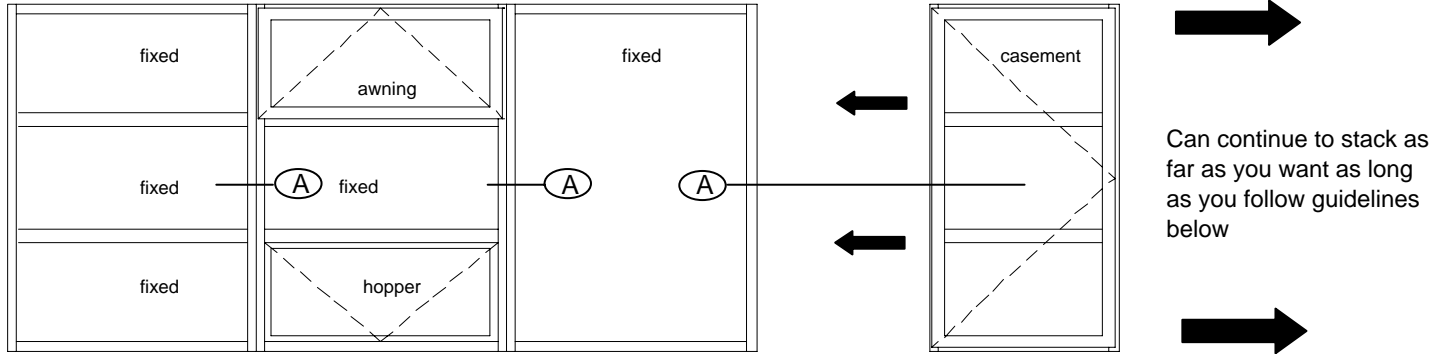

There are many different configurations that can be used in the Gerkin side stack system. When choosing your configuration you must use the following guidelines.

### 1. The rails can not be crossed in a 1 frame configuration

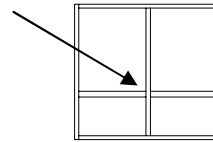

### 2. Individual frame cannot exceed 48" wide X 72" tall

### 3. Reference dimension must conform to the following:

	max size	min size roto	min size push / pull
5100 Awning	48" x 30"	21" x 17 1/2"	12 1/2" x 17 1/2"
5200 Hopper	48" x 30"	N/A	12 1/2" x 12 1/2"
5300 Casement	36" x 72"	15" x 21 3/4"	12 1/2" x 21 3/4"
5500 Fixed	48" x 72"	N/A	12 1/2" x 12 1/2"

# Side-stack configurations with structural mull

## Awning , Casement, Fixed & Hoppers

Gerkin Aluminum thermally broken commercial windows with 2 3/8" frame depth. Can be glazed with 5/8" or 1" units. Standard colors available: clear anodized, dark bronze anodized, white painted or bronze painted. Custom colors are available upon request.

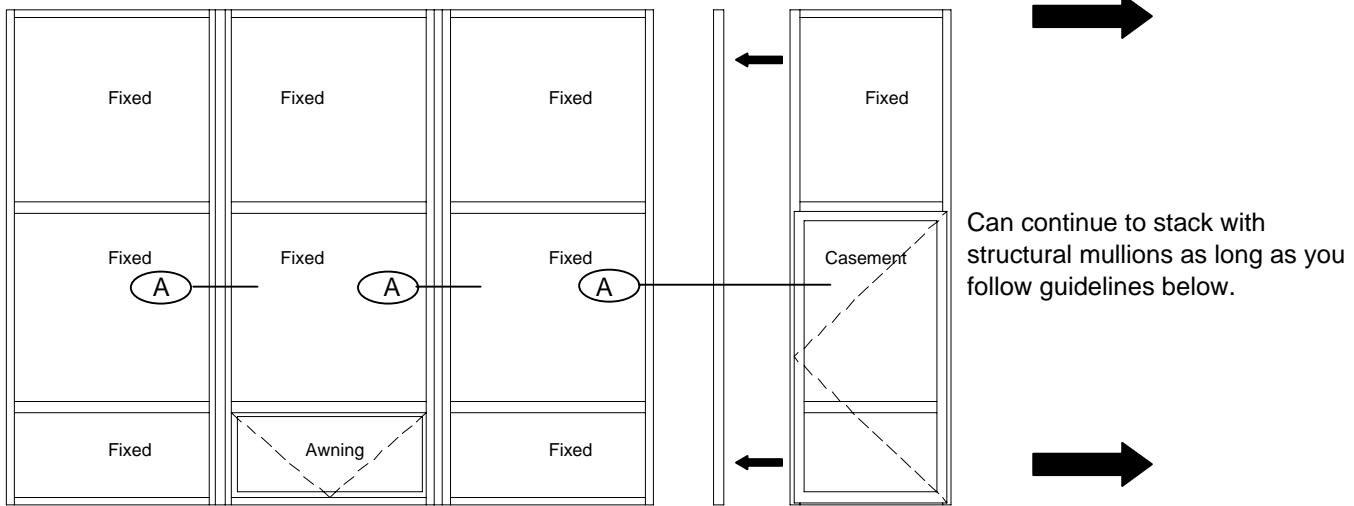
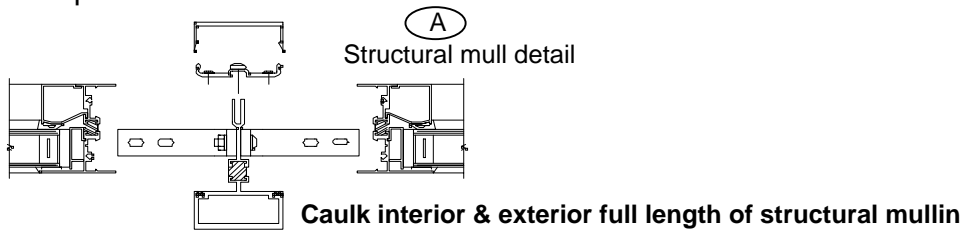

There are many different configurations that can be used in the Gerkin stack system. When choosing your configuration you must use the following guidelines.

**1. The rails can not be crossed in a 1 frame configuration**

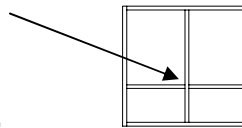

**2. Individual frames up to 96" tall can not exceed 48" wide.**

OR

**2. Individual frames up to 120" tall can not exceed 36" wide.**

**3. Reference dimension must conform to the following:**

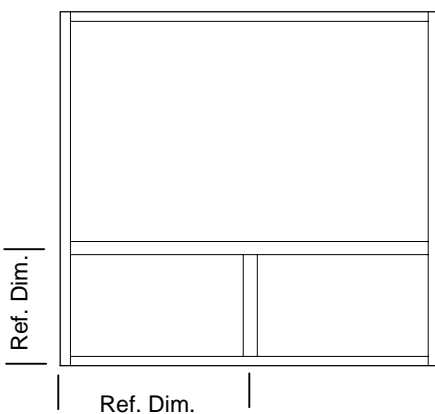

	max size	min size roto	min size push / pull
5100 Awning	48"/36" x 30"	21" x 17 1/2"	12 1/2" x 17 1/2"
5200 Hopper	48"/36" x 30"	N/A	12 1/2" x 12 1/2"
5300 Casement	36" x 72"	15" x 21 3/4"	12 1/2" x 21 3/4"
5500 Fixed	48"/36" x 72"	N/A	12 1/2" x 12 1/2"

## Side-stack configurations with stacking H channel

### Rhino sliding windows

Gerkin Aluminum thermally broken commercial windows. 2 3/8" frame depth. 5/8" overall insulated glass. Standard colors available clear anodized, dark bronze anodized, white painted or bronze painted. Custom colors are available upon request.

Caulk full perimeter interior & exterior of H channel

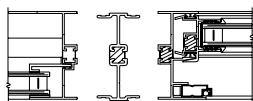

(A) Stacking H channel detail

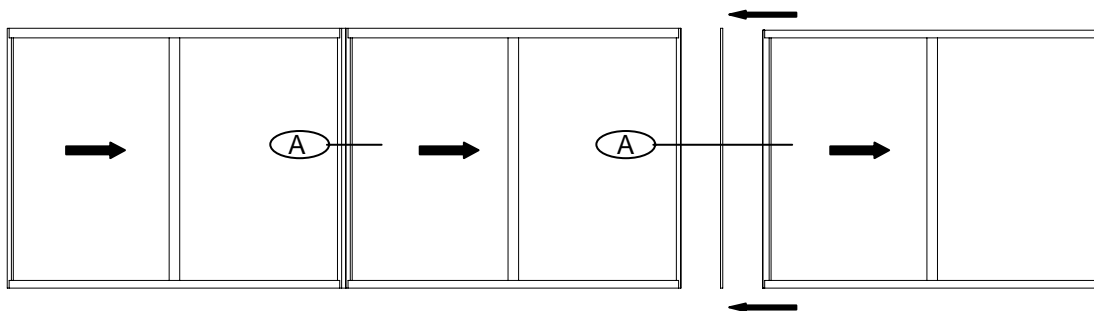

Can continue to stack as long as an individual slider does not exceed 72" wide X 72" tall.

## Side stack configurations with structural mullions

### Rhino sliding windows

Caulk full perimeter interior & exterior of structural mullion

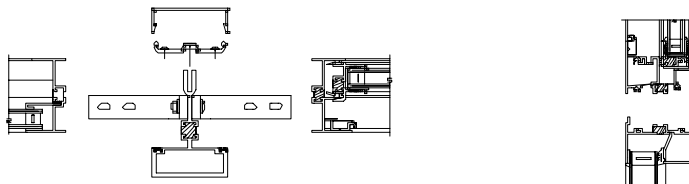

(B) Structural mullion detail

(C) Head stack detail

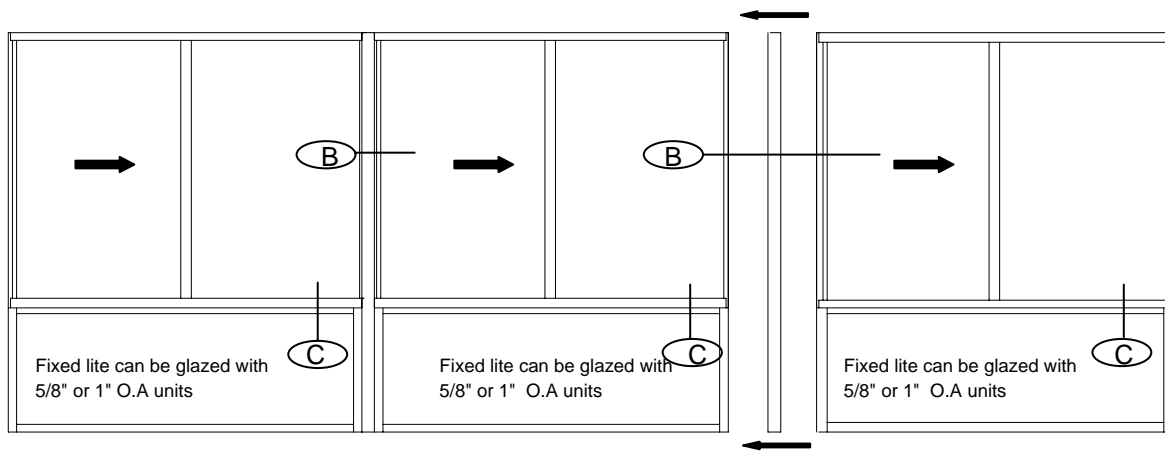

Can continue to stack as long as slider-fixed, head/sill stacked combination does not exceed 48" wide X 96" tall

# Head & sill stack configurations

## Rhino sliding windows

Gerkin Aluminum thermally broken commercial windows with 2 3/8" frame depth. 5/8" overall insulated glass. Standard colors available clear anodized, dark bronze anodized, white painted or bronze painted. Custom colors are available upon request.

**Caulk full perimeter interior & exterior of stack rails**

Head stack detail

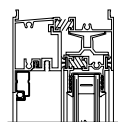
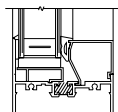

A

Head stack detail

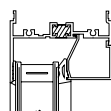
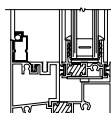

C

Head stack detail

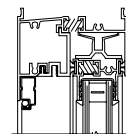
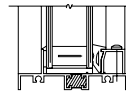

B

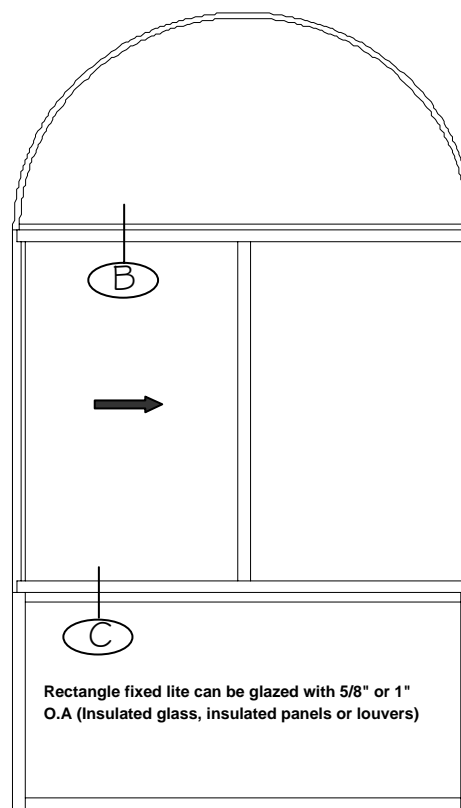
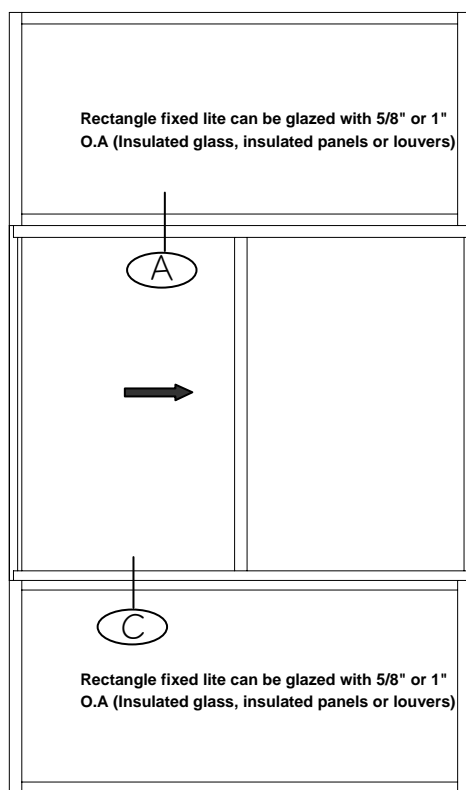

- Slider can not exceed 72" wide X 60" tall max.R.O
- Slider can not be below 18 1/2" wide X 12 1/2" tall min. R.O
- Transom can not exceed 72" wide X 36" tall max. R.O
- Transom can not be below 18 1/2" wide X 12 1/2" tall min. R.O
- Bottom fixed can not exceed 72" wide X 36" tall min. R.O
- Bottom fixed can not be below 18 1/2" wide X 12 1/2" tall min. R.O

- Slider can not exceed 72" wide X 60" tall max.R.O
- Slider can not be below 36" wide X 12 1/2" tall min. R.O
- 1/2 Round can not exceed 72" wide max. R.O
- 1/2 Round can not be below 36" wide min. R.O
- Bottom fixed can not exceed 72" wide X 36" tall min. R.O
- Bottom fixed can not be below 18 1/2" wide X 12 1/2" tall min. R.O

## Side-stack configurations with stacking H channel

### Rhino singlehung windows

Gerkin Aluminum thermally broken commercial windows. 2 3/8" frame depth. 5/8" overall insulated glass. Standard colors available clear anodized, dark bronze anodized, white painted or bronze painted. Custom colors are available upon request.

Caulk full perimeter interior & exterior of H channel

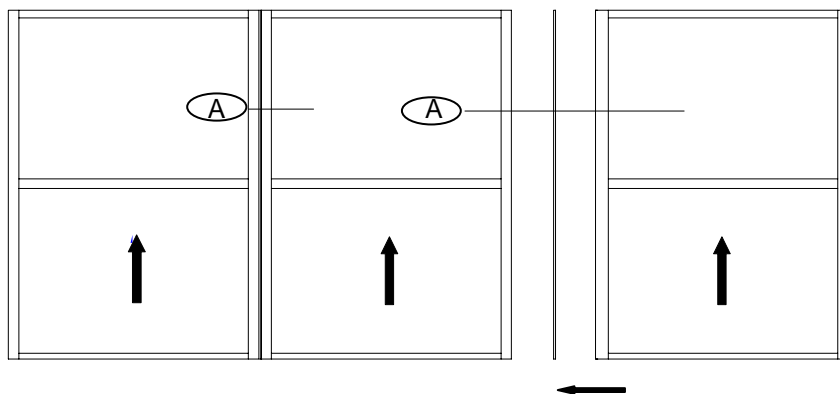
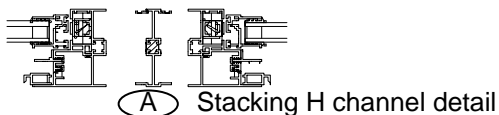

Can continue to stack as long as an individual singlehung does not exceed 48" wide X 72" tall.

## Side stack configurations with structural mullions

### Rhino singlehung windows

Caulk full perimeter interior & exterior of structural mullion

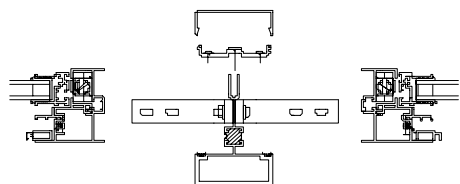

(B) Structural mullion detail

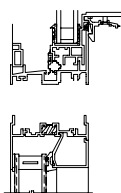

(C) Head stack detail

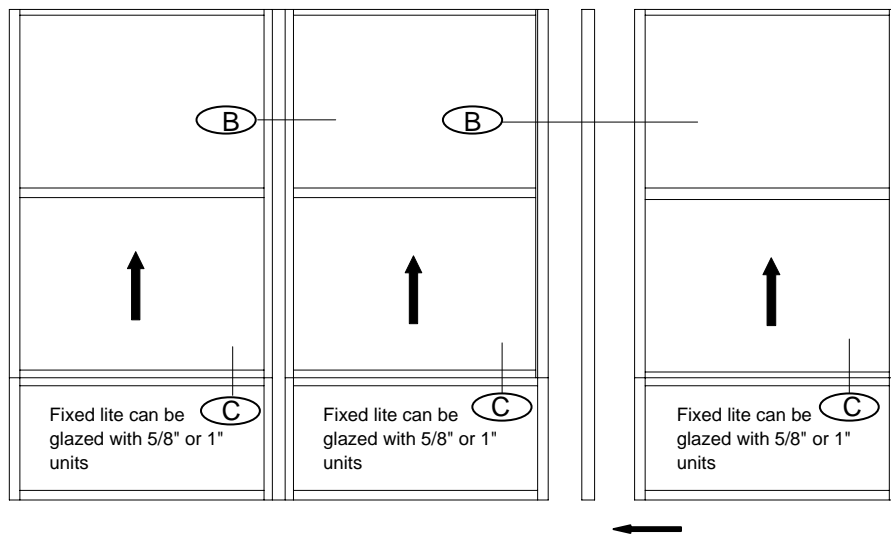

Can continue to stack as long as singlehung-fixed, head/sill stacked combination does not exceed 48" wide X 96" tall Or 36" wide X 120" tall



# Head & sill stack configurations

## Rhino singlehung windows

Gerkin Aluminum thermally broken commercial windows with 2 3/8" frame depth. 5/8" overall insulated glass. Standard colors available clear anodized, dark bronze anodized, white painted or bronze painted. Custom colors are available upon request.

**Caulk full perimeter interior & exterior of stack rails**

Head stack detail

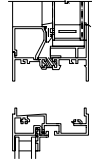

A

Head stack detail

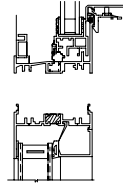

C

Head stack detail

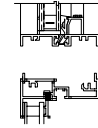

B

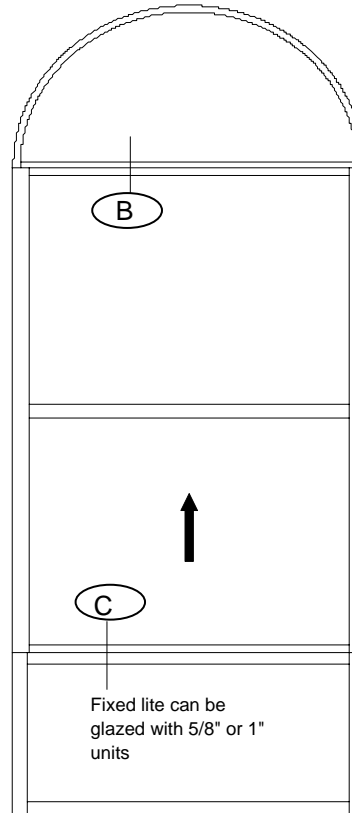
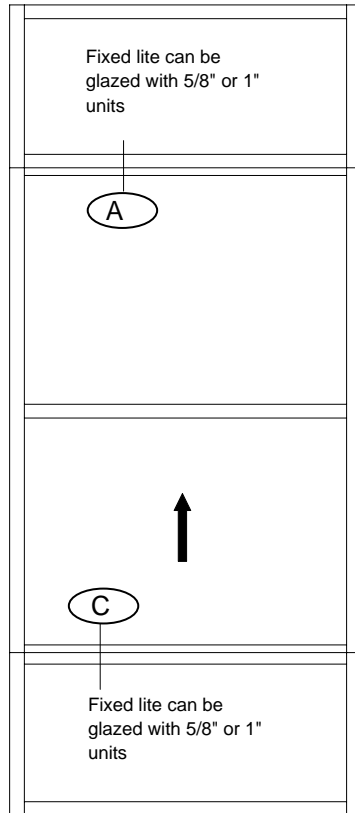

Overall unit cannot exceed 48" x 108"

- Singlehung can not exceed 48" wide X 72" tall max.R.O
- Singlehung can not be below 16 1/2" wide X 30" tall min. R.O
- Transom can not exceed 48" wide X 36" tall max. R.O
- Transom can not be below 18 1/2" wide X 12 1/2" tall min. R.O
- Bottom fixed can not exceed 48" wide X 36" tall min. R.O
- Bottom fixed can not be below 18 1/2" wide X 12 1/2" tall min. R.O

- Singlehung can not exceed 48" wide X 72" tall max.R.O
- Singlehung can not be below 16 1/2" wide X 30" tall min. R.O
- 1/2 Round can not exceed 48" wide max. R.O
- 1/2 Round can not be below 24" wide min. R.O
- Bottom fixed can not exceed 48" wide X 36" tall min. R.O
- Bottom fixed can not be below 18 1/2" wide X 12 1/2" tall min. R.O



**caulk full perimeter**

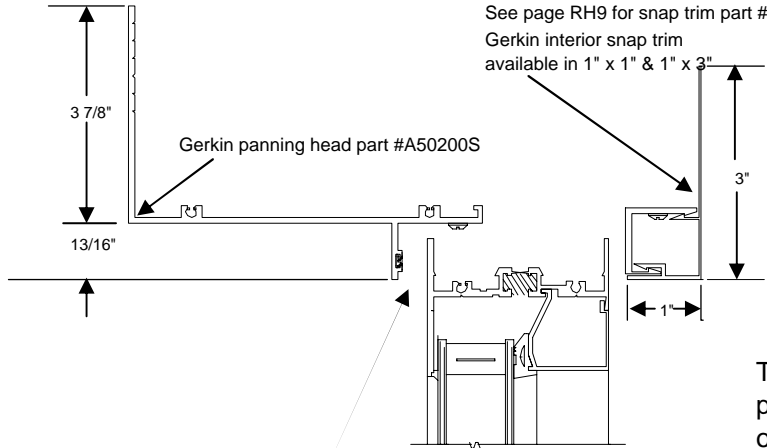

The Gerkin panning system is ideal for retrofit projects where you can't remove existing frames or there is some irregularities in the opening. The panning system is designed to cover unsightly conditions. On some projects panning can save labor when replacing old inefficient unsightly windows with thermally broken energy efficient windows that have a new and clean look. When using the panning system check out our interior snap trims that can be adapted to many conditions and will give you a nice finished look both interior and exterior.

**caulk full perimeter**

Vinyl bulb is for tolerance only, it is not a weather stripping.  
(Caulk full perimeter)

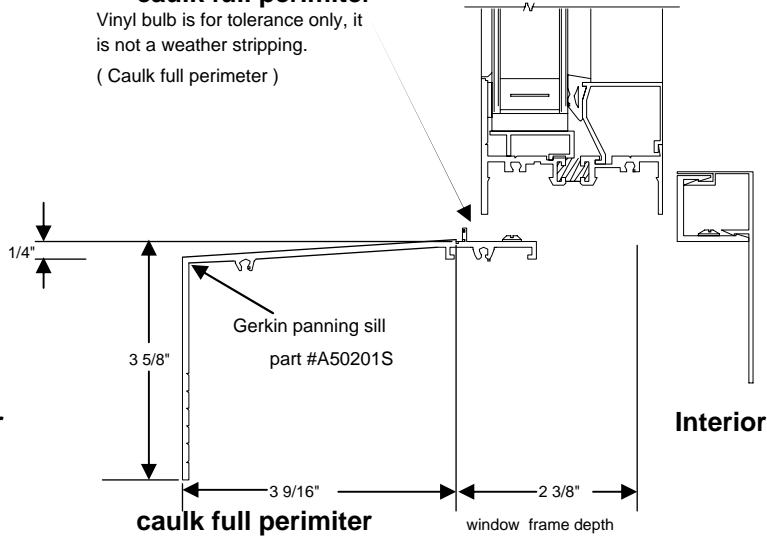

**caulk full perimeter**

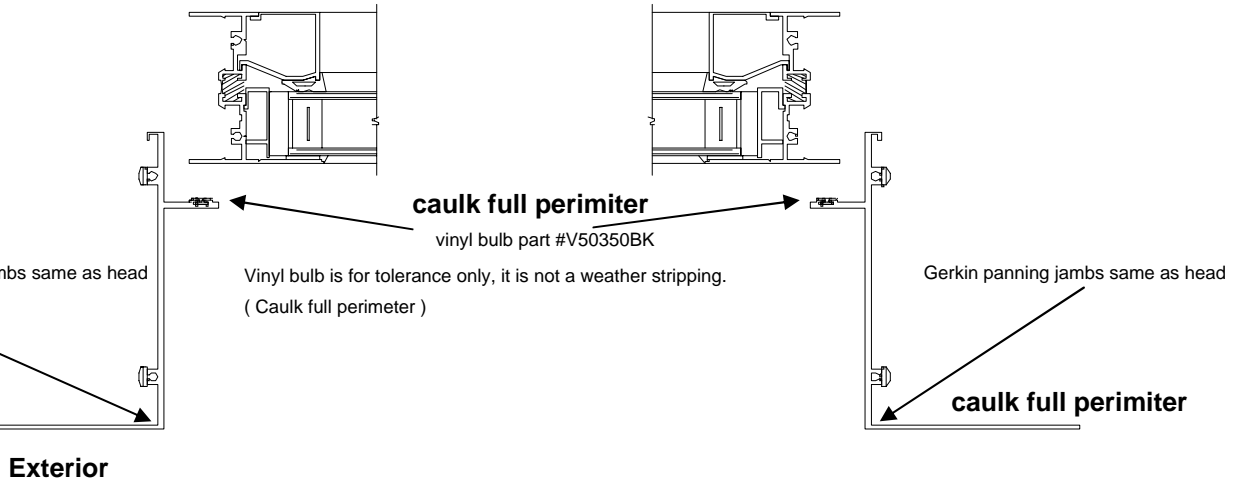
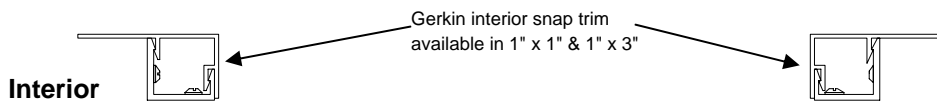

# RHINO SERIES SUBFRAME SYSTEM



The Gerkin subframe system is ideal for new construction or retrofit projects where you don't want to set up bulky scaffolding or rent expensive lifts for window installations. The subframe is a two piece receptor system that is thermally broken and allows you to install windows from the interior of the building. When used the subframe system can save both time and money

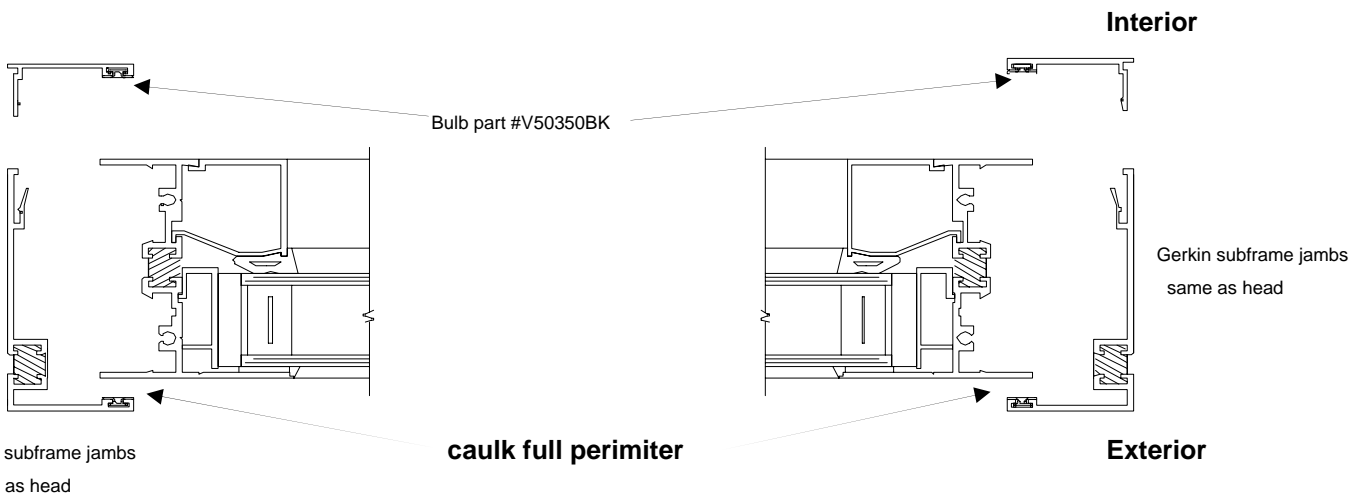
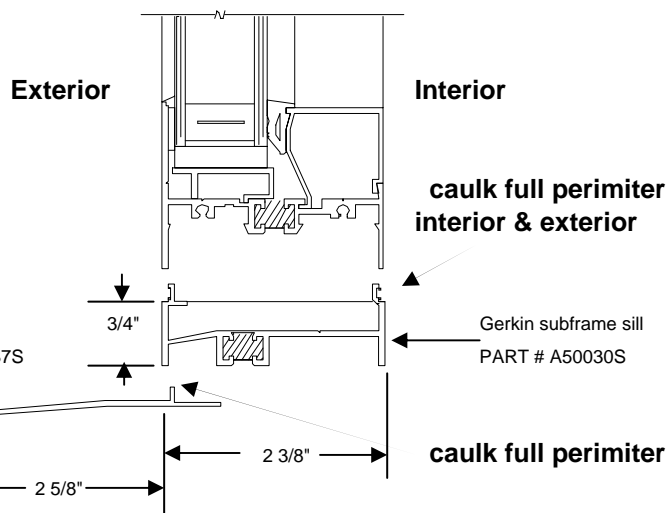
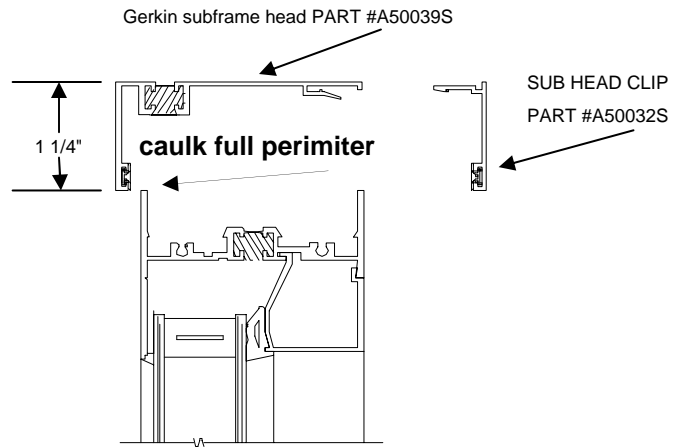



# RHINO SERIES ACCESSORIES



## GERKIN STRUCTURAL MULLION

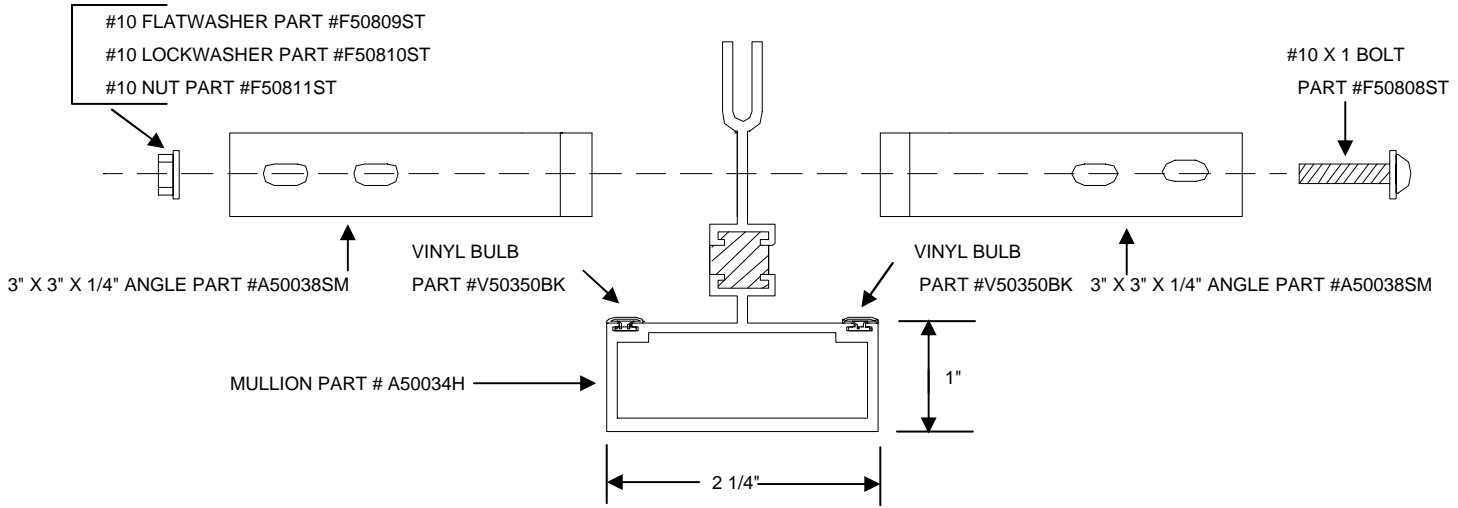
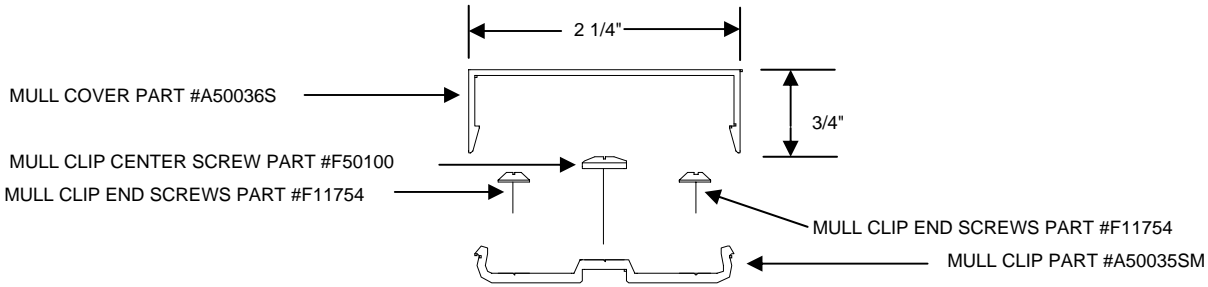

## GERKIN SILL FLASHING

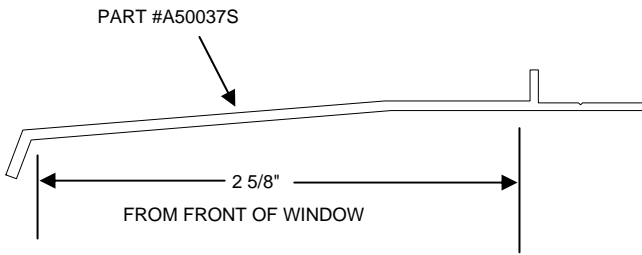

## GERKIN STACKING H CHANNEL

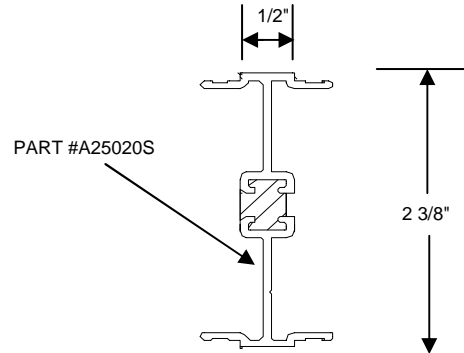

## GERKIN INTERIOR SNAP TRIM 1" X 1" OR 1" X 3"

