



Schindler 3300

Distinctive design. Cost-effective solution.
Green technology made easy.



A woman with long brown hair and black-rimmed glasses is looking out a window. She is wearing a red V-neck sweater over a white collared shirt. The background is a blurred view of a city or landscape through the window.

Smart

The Schindler 3300 provides enlightened engineering

Easy to order. Accelerated lead times. Simple to install. And a pleasure to design. That's the Schindler 3300. From its distinctive aesthetic options to its machine room-less configuration, this elevator's features are thoughtful of the needs of architects, general contractors and passengers alike.



Spacious

The Schindler 3300 provides more space

We have designed the cab to create more room and more comfort. Since there's no need for a machine room or control closet, there's more usable building space. The Schindler 3300 fits neatly into the footprint of a hydraulic elevator.



Smooth

**The Schindler 3300 provides
a more comfortable ride**

Noticeably quiet. Beautifully fluid. Reliably safe. Schindler's exclusive engineering provides smooth, quiet operation for the most comfortable ride experience—floor by floor, stop by stop.



Sophisticated

The Schindler 3300 provides an understated elegance

Refined without being pretentious. Stylish without being trendy. Energy efficient without being mundane. The Schindler 3300 seamlessly integrates Italian design with precision Swiss engineering.



Value has a new, intelligent design

The world's most enlightened elevator

The Schindler 3300 has proven itself globally as the smartest choice for low- to mid-rise commercial and residential buildings.

That's because it is engineered like no other everyday elevator. It offers a distinctive range of design and aesthetic options along with an amazingly smooth performance that uses less energy and makes less noise. All in a smaller, easy to fit footprint.

It's setting the new global standard.

More room. More usable space.

As architects and engineers around the world can attest, the Schindler 3300 is designed to minimize the space required for technical equipment, while maximizing the square footage of the cab interior.

Thanks to our new easy-to-install suspension traction media, hoistways designed for a hydraulic elevator can now accommodate a more spacious traction elevator.

Also, because the control is distributed throughout the system, and inspection and test panels are located in the top landing hoistway door jamb, the Schindler 3300 needs no machine room. What's more, it requires minimum overhead, eliminating unsightly structures on your roof. All told, the Schindler 3300 gives you more space and reduces construction costs.

Smooth to the eyes and ears

Schindler cabs are constructed using only high-quality materials. And with standard palettes that are anything but "standard," we can provide exceptional looks, while keeping lead times and costs down. From stainless steel to a distinctive collection of attractive color laminates, your design choices are easier than ever before.

To add to the aura, we are also working to reduce noise. Our suspension traction media enables the Schindler 3300 to glide peacefully through your building. Elevator movements go virtually unnoticed – which will certainly be appreciated by guests in your building.

Sophisticated design for our passengers and our planet

With automatic evacuation, we've elevated our focus on safety. In the event of a power failure, you will be taken safely to the next floor.

We're also setting a new standard in conservation. The Schindler 3300 is economical in its use of energy, which contributes to lower operating costs and a smaller carbon footprint. The effects are highly visible.

Fast facts

Capacity	2100–3500 lbs., 14-23 passengers
Travel height	Max. 98'- 5", max. 8 stops
Door width	36-42 inches
Door height	84 inches
Drive	Gearless/frequency controlled
Speed	100/150 FPM
Control	Selective collective
Interior	Baked enamel, plastic laminate or brushed stainless steel



Efficient mobility Sustainable technology

In architecture, in engineering, in everyday life, there is a global movement toward sustainability. There is a growing demand for solutions that benefit the planet as much as they do people. At Schindler, we are proud to be at the forefront of this initiative. In every facet of our business, we are looking for ways to become better stewards of the planet.

The Schindler 3300 is the hallmark of our environmental efforts. When designing this elevator, sustainability was not an afterthought, but the driving force behind every decision we made. As a result, the Schindler 3300 offers more eco-friendly features than one might have thought possible.

Drive

- Gearless machine designed to save energy and avoid power loss
- Stable start uses energy more efficiently and reduces electric costs
- Frequency converter with standby power mode allows elevator to return safely to nearest floor in the event of a building power outage
- Compact, lightweight and durable design.

Control

- Controls automatically switch car lights to standby mode to save energy
- Car panel and floor indicators all operate with low power, LED lights
- Multi-bus control architecture reduces cabling, material and waste
- Smart controls provide more efficient passenger transportation.

Cab and hoistway

- Car lighting equipped with energy-efficient lamps
- Central guiding system reduces friction and overall energy consumption
- Door drive with standby mode uses less electricity
- Overall design provides more usable space for enhanced passenger comfort.

Environmentally-responsible company

We are working to make our entire operation more eco-friendly. We have instituted more ecologically responsible production systems and material usage. We are able to manage installations faster and more efficiently. And our products and services are designed to provide energy-efficient and eco-friendly options to architects, contractors, building owners and managers.

What's more, Schindler is a member of the U.S. Green Building Council and supports the LEED® Green Building Rating System.

The following categories of the LEED rating system are areas where Schindler can assist you in obtaining the necessary credits for accreditation.



LEED RATING SYSTEM VERSIONS 3 AND 2.2

Energy and Atmosphere

Prerequisite 1
Fundamental Commissioning of the Building Energy Systems

Credit 1
Optimize Energy Performance

Materials and Resources

Credit 2.1 and 2.2
Construction Waste Management

Indoor Environmental Quality

Credit 4.1
Low – Emitting Materials: Adhesives and Sealants

Credit 4.2
Low – Emitting Materials: Paints and Coats

Credit 4.4
Low – Emitting Materials: Composite Wood and Agrifiber Projects

Technology advanced Perfection attainable

Drive system

The Schindler 3300 requires a small hoist machine and inverter. This saves more space compared to previous drive systems; it is installed directly in the overhead and does not require a separate machine room. The system stops the car with precision. Cab and landing floor line up very accurately to ensure that passengers get in and out safely. The system is economical in energy consumption and causes minimal noise due to the material of the suspension traction media (STM) in the elevator and in the entire building. Real comfort.

Suspension Traction Media (STM)

The STM consists of thin metal cables sheathed in a non-circular EPDM (Ethylene Propylene Diene Monomer) jacket. They replace conventional steel cables, weigh less, require less space and run quieter. Thanks to the STM, there is room for the machine and drive directly in the elevator hoistway, allowing hydraulic-sized shafts to be utilized.

Inspection and test panel

In the Schindler 3300, the inspection and test panel is built directly into a standard door frame at the top landing. This highly functional solution is a vital achievement. It simplifies elevator installation, provides practical handling and saves space.

Doors

Doors are equipped with a frequency-controlled drive for fast and reliable operations. Two-speed side-opening doors opening to the left or right, as well as single-speed center-opening doors are available.

Cab

Technology does not take much space in the Schindler 3300. This is an obvious benefit that allows hydraulic elevator-sized shafts to be utilized while providing a larger cab interior. This is a striking advantage.

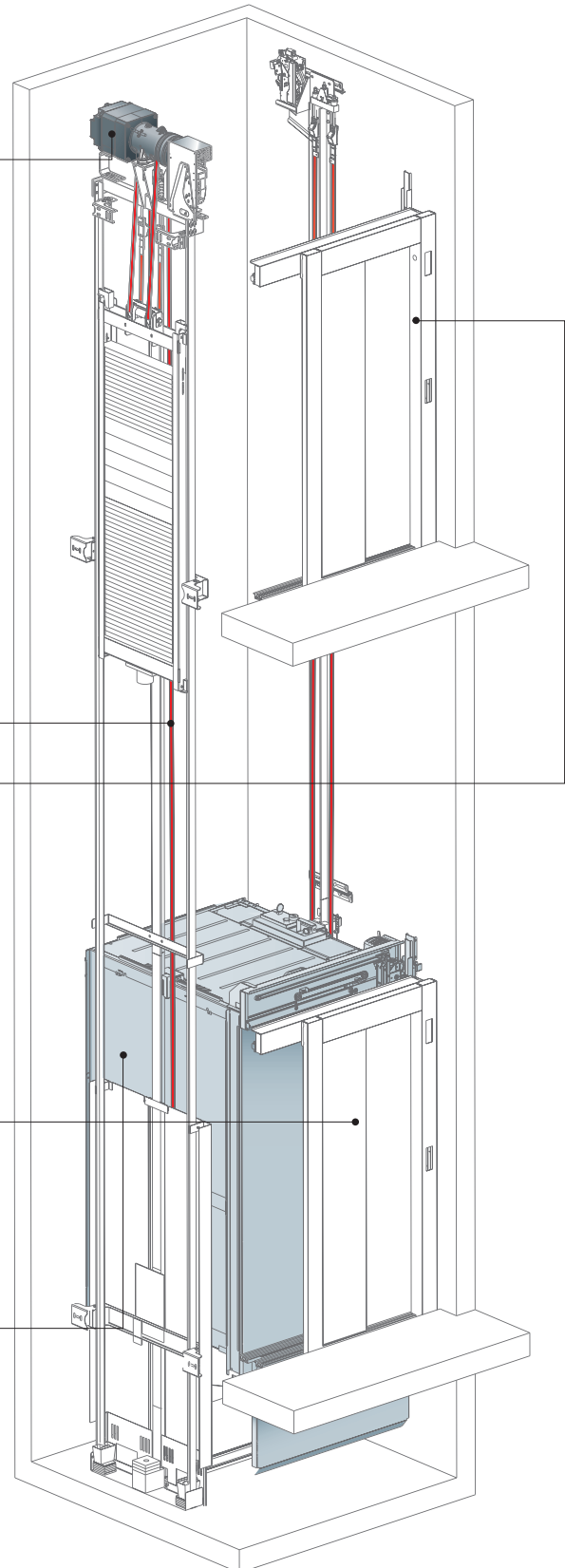

Previously: steel cables

Steel cables are relatively inelastic. They need a traction sheave diameter of at least 12 inches with the cable diameters required for elevators. The complete conventional motor, including drive gears, must be large enough to match. A system that requires space.

New: Suspension Traction Media (STM)

Suspension traction media are flexible. They use a much smaller traction pulley diameter than steel cables. 4.25 inches is enough, requiring a much smaller motor. A design that saves space.

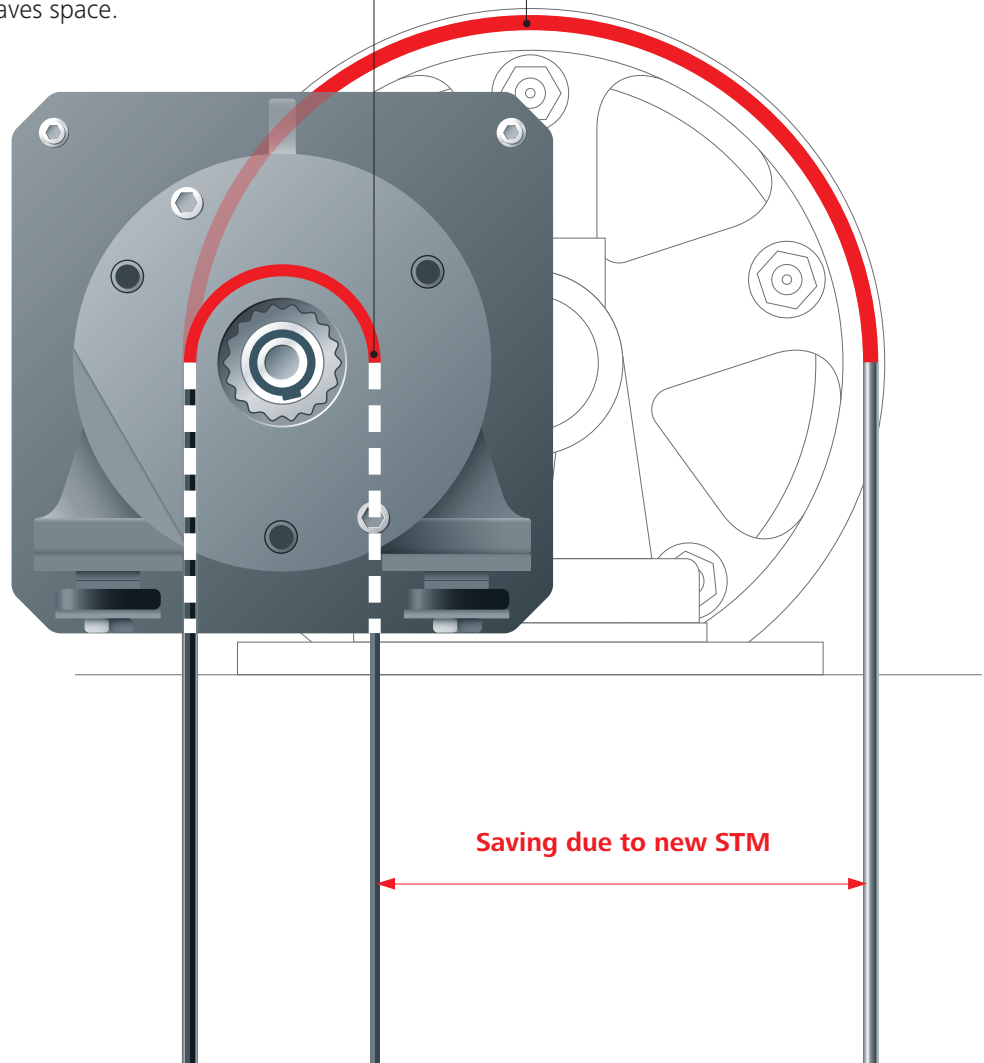

We put a premium on design, without charging a premium

All around the world, architects and designers are discovering a new creative outlet. Conceptualized by an Italian designer, the Schindler 3300's sleek cab design is impressive yet understated. Simple, yet refined, with design palettes to suit any style or building décor.

- Cab walls are available in stainless steel, baked enamel or a choice of plastic laminates.
- The unique ceiling design is available in a choice of brushed stainless steel or silver-metallic baked enamel.
- Ceiling lighting is refined, yet illuminating, with compact fluorescent light fixtures.
- The elegant curved handrail is available in painted, brushed or polished aluminum finishes.
- Landing doors are available in brushed stainless steel, various colors of durable baked enamel or primer. Doors are available in center-opening or side-opening configurations, with left-hand or right-hand openings.
- Hall fixtures are composed of tempered safety glass panels, back-printed in white, to give the Schindler 3300 a contemporary, modern look.

Note: For more information on the high fashion details we designed into the Schindler 3300, be sure to ask for a copy of our Deco brochure, which includes all décor and accessory options. The car specifications, options and colors in this brochure are representative only and are subject to change. Sample shown may vary from the original in color and material.



Laminate – Long Beach Blue



Brushed stainless steel



Landing doors - Available in 11 baked enamel colors or stainless steel



Hall fixtures



Painted



Brushed



Polished

Handrails



Ceiling lighting

If you can envision it, you can create it

From the fun, fresh colors of Tribeca to the subdued natural tones of Willamette, the Schindler 3300 gives you a wide selection of durable baked enamel or colorful laminate finishes, as well as a sleek brushed stainless steel cab. Create a look and feel that is truly one of a kind.

Tribeca

Fresh, flashy and multifaceted



Montreal Blue



Baked enamel colors

South Beach

Warm, distinguished and genuine



Tampa Tangerine



Matte finish laminates with subtle, wavelike design

River Walk

Clean, cool and cutting edge



Miami Bottle Glass



Matte or gloss finish laminates with glassy sheen; swatches are a representation of the gloss finish.

Great Lakes

Steely, sophisticated and elegant



Toronto Grey



Choose from gloss finish laminates with subtle, monochromatic patterns or a distinctive brushed stainless steel cab.

Willamette

Rich, natural and classic



Baltimore Cherry



Matte and gloss finish laminates with rich, wood-grain colors; swatches are a representation of the gloss finish.

The perfect fusion of people-centered design and technology

The features and components of the Schindler 3300 are smartly designed to enhance the rider experience, improve safety and minimize downtime. From the low-energy multiprocessor controls to the stylish, tempered safety glass operating panels, you'll find the latest technological advances.

Control

The control system is based on low-energy multiprocessor technology. The compact main inspection and test panel of the decentralized system is integrated in the door frame.

Control functions

- Miconic® NX microprocessor
- On-board diagnostics, self testing
- Light curtain
- Overload detection
- Two-way, hands-free emergency communication
- Firefighter's Service operation
- Independent service
- Automatic car light
- Automatic evacuation to nearest floor.

Schindler Remote Monitoring™

Supports Schindler predictive maintenance, anticipating difficulties before they occur and allowing rapid response to service calls.

Fixtures

The stylish, tempered safety glass panels are back-printed in white to give the elevator a contemporary, modern look while meeting all applicable codes. Please refer to our deco brochure for more information on all decor and accessory options.



State-of-the-art planning, installation and support



Planning

The Schindler 3300 requires no machine room. For you, this means less planning. Only one space, the elevator shaft, has to be designed. Standardized plans simplify the process, making it fast and efficient.



Order

The design of the Schindler 3300 is sophisticated, yet simple. The key factors are quickly established. Since there are no complicated specifications, it is easy to place an order. You will quickly and effortlessly find the product that fits your needs.



Delivery

We deliver the Schindler 3300 complete and all at once, just in time for when the building is ready for the elevator installation.



Installation

The elevator is quickly installed. No cranes or scaffoldings are required. The system is ready in about two weeks. A well-thought-out process.

Keeping it all running smoothly

The Schindler 3300 combines proven engineering and smooth performance with the best service in the industry, from our integrated maintenance delivery technology to our highly trained technicians. So you can be confident of fewer callbacks, fewer inconveniences and less downtime.

- On-board sensors monitor your equipment 24 hours a day with Schindler Remote Monitoring™ (SRM). It's a powerful diagnostic tool that can identify a problem, map out a solution and dispatch a technician to your site – often before you're even aware of the issue.
- One toll-free call to the Schindler Customer Service Network (SCSN) provides fast dispatching at any time, day or night.
- Schindler FieldLink™ gives your technician unlimited access to virtually any information needed to complete your maintenance quickly and accurately.
- Genuine manufacturer's replacement parts from extensive local and national inventories are available within 24 hours if need be.
- Exclusive Schindler Customer Score Card™ allows you to track trends, view performance reports and service records in real time at www.us.schindler.com.





Ever greener



Keeping the environment in mind

Schindler is committed to helping you reduce the environmental footprint of your buildings and qualify for LEED® certification by incorporating sustainable green features into our elevator and escalator systems. Improving the environmental impact of our products and processes, particularly our consumption of energy and materials, is fundamental to our corporate responsibility as an industry leader. Schindler 3300 is a prime example of our continuing commitment to improve mobility while preserving resources.

LEED is a registered trademark of the U.S. Green Building Council.

For more information, including location of the Schindler office nearest you, please visit:

U.S. Headquarters
Morristown, New Jersey
Tel. 973.397.6500
www.us.schindler.com

Canada Headquarters
Scarborough, Ontario
Tel. 416.332.8280
www.ca.schindler.com



Schindler is a member organization of the U.S. Green Building Council.



Schindler has received renewal to ISO 14001:2004 and ISO 9001:2008 certificates.



Schindler prints with vegetable-based ink on paper containing post-consumer waste fiber.



Mixed Sources
Product group from well-managed forests, controlled sources and recycled wood or fiber
www.fsc.org Cert. no. SCS-COC-08947
©1996 Forest Stewardship Council