

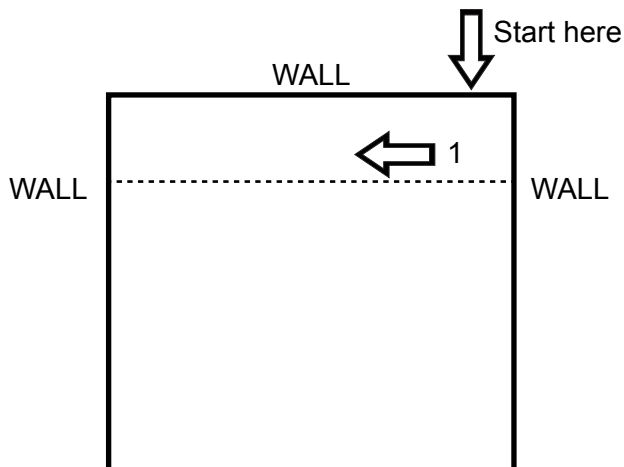

LOCKER INSTALLATION INSTRUCTIONS

Installation Hardware Supplied by Others



WALL TO WALL STRAIGHT RUN

- Measure locker area between walls. Determine that correct # of lockers will fit.
- Start install with the lockers on the right.
- If space remaining after lockers installed, use fillers to fill space. Install the fillers to left of lockers (if applicable).
- Install top fillers last. Install a support on the wall and rest top filler on support and top of locker.
- Tighten all nuts and bolts.
- Adjust doors.

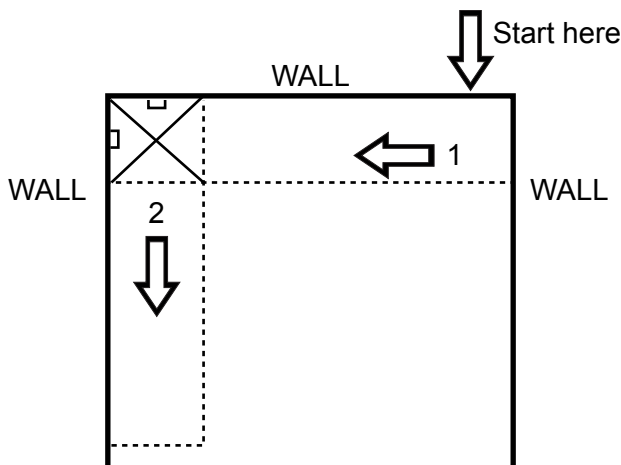

L SHAPE OPEN END

- Measure locker area.
- Start with the lockers from the back wall right side (if layout is the reverse from shown, start from the left side).
- Install fillers to left of lockers (if applicable).
- Install some type of blocking on both walls in the corner for top corner fillers to rest on.
- Install side wall lockers.
- Install top fillers last.
- Tighten all nuts and bolts.
- Adjust doors.

ASI Storage Solutions

2171 Liberty Hill Road, Eastanollee, GA 30538
Phone: 706.827.2720 Fax: 706.827.2710
E-Mail: info@asilockers.com Web: asilockers.com



LOCKER INSTALLATION INSTRUCTIONS

Installation Hardware Supplied by Others

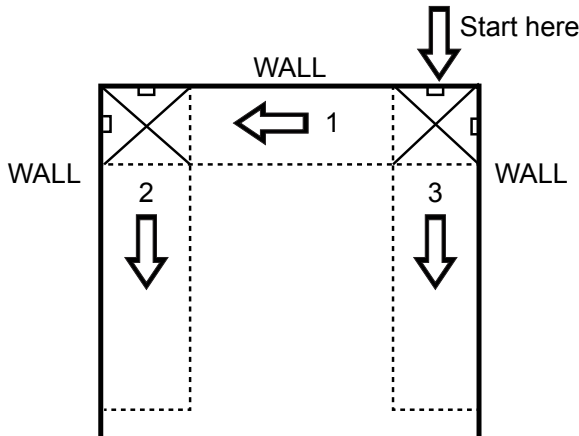

U SHAPE

- A. Measure locker area.
- B. Start install of lockers on back wall.
- C. Center back wall lockers.
- D. Install some type of blocking on both walls in the corner for top corner fillers to rest on.
- E. Install fillers.
- F. Install top fillers last.
- G. Tighten all nuts and bolts.
- H. Adjust doors.

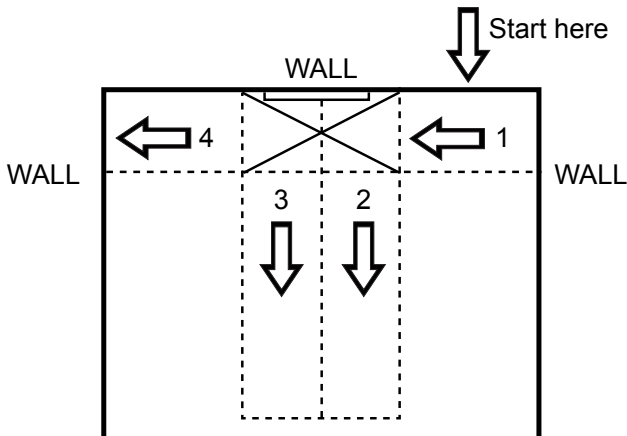

AREA WITH ISLANDS

- A. Measure locker area.
- B. Start install lockers on back wall right side.
- C. Install fillers to left of lockers (if applicable).
- D. Install some type of blocking on both walls in the corner for top corner fillers to rest on.
- E. Install fillers.
- F. Install island lockers. Alternate sides, bolt back to back.
- G. Install top fillers last.
- H. Tighten all nuts and bolts.
- I. Adjust doors.

* Note: Fillers to fill open spaces next to lockers can be purchased separately through your local dealer.

ASI STORAGE SOLUTIONS RECOMMENDS THAT ALL LOCKERS SHALL BE ANCHORED TO THE WALL AND/OR FLOOR SECURELY WITH APPROPRIATE FASTENERS.

ASI Storage Solutions

2171 Liberty Hill Road, Eastanollee, GA 30538
Phone: 706.827.2720 Fax: 706.827.2710
E-Mail: info@asilockers.com Web: asilockers.com