



MARKER AND
CHALK BOARDS

TACK BOARDS

COMBINATION
BOARDS

PORTABLE BOARDS

HORIZONTAL
SLIDERS

VERTICAL SLIDERS

PRESENTATION
WALLS

LECTURE CABINETS

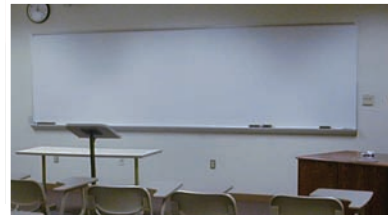
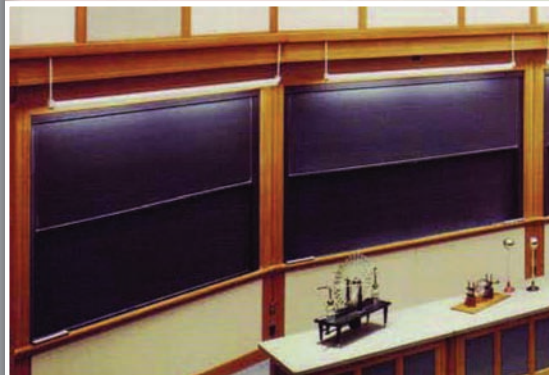

"Quality Visual Communication Surfaces for Every Environment"

PROSTEEL CHALK AND MARKER BOARDS FEATURE THE NEW PORCELAIN ON STEEL PRESENTATION SURFACE WITH QUALITY AND PERFORMANCE CHARACTERISTICS UNSURPASSED IN THE MARKETPLACE:

- Excellent chalk and marker pen adherence
- Erases easily with soft dry cloth or felt eraser
- Very little glare with minimal surface distortion
- Porcelain Ceramic surface is Acid, Fire, Stain and Scratch resistant
- Porcelain Ceramic surface will maintain its qualities for 50 years or the LIFE of its installation
- Requires minimal care and maintenance
- Steel substrate holds magnets and magnetic teaching aids
- Resurfacing grade sheets available
- Available in a variety of colors

Marker & Chalk Boards

ANY Size in one piece up to 5' high or 16' wide. For oversized, see Combination Boards & Presentation Walls.

Facing Options:

- 28GA or 24 GA porcelain steel
- Marker or Chalk colors
- Porcelain Fused Graphics

Core Options:

- Fiberboard
- Particleboard

Trim Options:

- Satin, Bronze or Black anodized or painted aluminum
- Wood Framed

Deluxe Trim EZ Hang trim

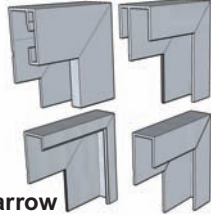

Narrow trim J-Trim

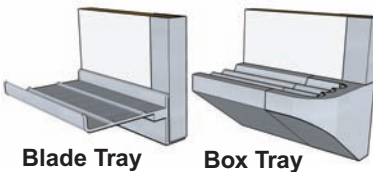

Blade Tray Box Tray

1" Maprail

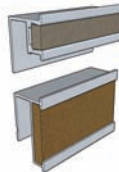

Available with tan or gray insert

2" Maprail

More options at www.K-ProSteel.com



Portables

Custom built mobile presentation units designed for versatility and durability. Weather resistant with all aluminum frame.

Features:

- Static or Reversible Board with lock-pin system
- 4' high double-sided magnetic panels
- 6' tall & up to 10' wide overall
- Locking Caster Wheels

Facing Options:

- (pick any two)
- ProSteel Marker
- ProSteel Chalk
- ProCork Colors
- ProTak Fabric or Vinyl
- Graphics

Options:

- Telescopic Legs (extra stability)
- Attached Tray
- Magnetic Tray



Combination Boards

Typical configurations of surfaces:

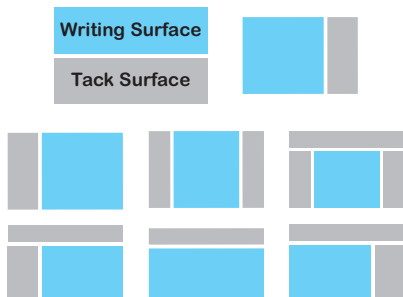

Presentation Walls

Virtually unlimited sizes of marker, chalk or tack surfaces in satin, bronze or painted trim with inside & outside corners installed floor to ceiling.

Installation Systems:

- Snap On Trim
- JTrim (shown)
- EZ Hang & Clip

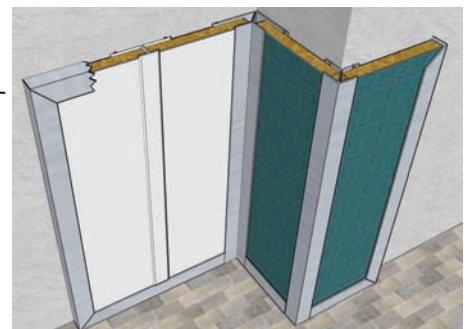

PROSTEEL Markerboard Colors

938	White
413	Almond
826	Silver
605	Blue
002	Black

PROSTEEL Chalkboard Colors

001	Black
814	Slate
515	Green
601	Sapphire

Vertical Sliders

Sliding units are designed to maximize your workspace by adding multiple levels of working area ... custom built to your specifications. Sliding panels glide with ease on precise counter-weight & bearing/track systems. Typical Vertical System consist of 4 1/2" wide aluminum frame, fixed rear panel with 2 sliding panels. **Slim Housing** available with 2.75" face.

Housing Options:

- Wall or floor mounted
- Surface mounted or recessed
- Manually Operated or Motorized.
- Box or Blade tray
- Satin anodized aluminum or painted
- Headerless (uprights only)

Panel Options:

- 1-3 Sliding panels made with HoneyComb core
- Backpanel
- Kick Panel

Panel Facing Options:

- Marker or Chalk
- Laminate
- Cork
- Fabric or Vinyl



Horizontal Sliders

Housing is constructed with heavy gauge aluminum. Sliding panels glide easily with its roller-bearing & guide systems.

Sliding Panel Versions:

A. Top-Hung:

- Panels travel on a roller/track system with guides at the bottom.
- Housing size up to 24' Wide.
- Up to 4 sliding tracks.

B. Bottom Supported:

- Panels ride on a sheave bearing system along a bottom track with roller guides at the top.
- Sizes vary by weight & field conditions.
- Ideal for full wall height sliding panels.

Housing Options:

- Satin anodized or painted
- 3" to 6" deep with 1.75" to 2" face

Other Options:

- Maprail with tan or gray cork insert
- Box or Blade Trays
- Marker, Chalk or tack surfaces

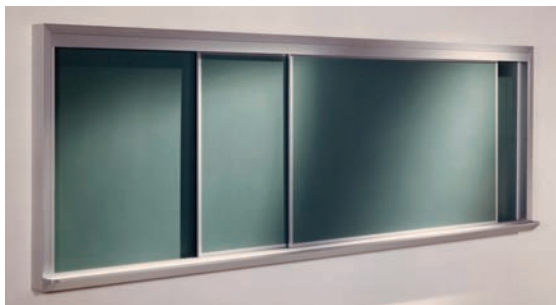

Tack Boards



All Tackboards made in one piece up to 4' high or 16' wide. Larger sizes require custom quotation.

Facing Options:

- 1/4" ProCork colors
- 1/8" or 1/4" ProCork Natural
- ProTak Vinyl: 24 colors available at 22oz./sq.yd.
- ProTak Fabric: woven polyester

Core Options:

- Fiberboard
- Hardboard
- 1/8" or 1/4" Cork Underlamine

Trim Options:

- J-Trim, EZ Hang, Deluxe or other
- Satin or Bronze anodized aluminum or painted
- Wood Frame



Lecture Cabinets



Housing Options:

- Plywood/veneer, Plywood/laminate, or finished hardwood
- Custom sizes up to 6' wide
- Optional Projection Screen & roller cover panel (shown)

Panel Options:

- Doors in-set panel: Marker Board, or fabric covered Tack Board
- Center panel typically marker board

Accessories:

Tack strip with Tan or Gray cork, map hooks, flip chart, markers & erasers

POPULAR PRO-CORK Colors



PRO-CORK Natural



POPULAR PRO-TAK Fabrics

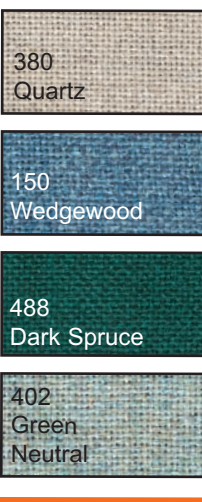

POPULAR PRO-TAK Vinyls

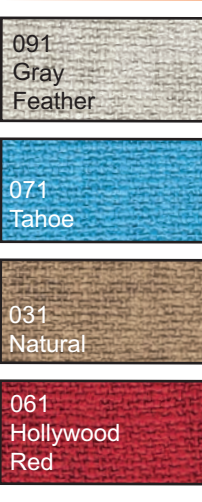

Display Rail & Accessories

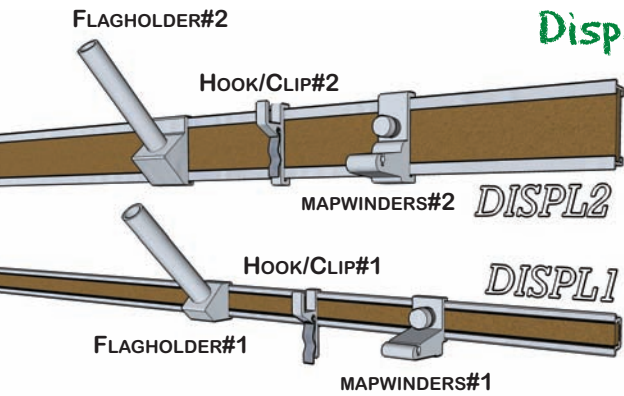

Eco Clean - ACMI AP Certified Markerboard Cleaner



Dry Erase Markers & Erasers
custom imprinting available

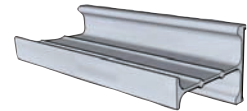

MAGNETIC TRAY
up to 12' long

Cleaning and Maintenance

An initial cleaning of your PROSTEEL MARKER or CHALK BOARD should be performed to ensure that no residual film or abrasive residues are present to damage the surface. NEVER use any abrasive materials on these surfaces as they would cause permanent damage.

Erasing

Use a soft cloth or felt eraser of #2 quality or better.

Writing

Markerboards: use only DRY ERASE MARKERS. **Chalkboards:** use CHALK designed for easy erasure. We strongly recommend white chalk with 95% chalk content and only 5% binder. Low dust and color chalks have higher binder content and can leave permanent marks.

Cleaning

Wash your marker or chalkboard periodically to eliminate problems from built up dust or other contaminants. **Markerboards:** use any liquid ammonia- added cleaner. RINSE with clear water and DRY your board with a soft towel. **Chalkboards:** use clear cool water. RINSE with clear water and DRY your board with a soft towel. Note that the writing and erasing qualities will improve with time as your new product "seasons" through continued use. For stubborn residue, use mild solvent or denatured rubbing alcohol. Gently work on your stain in a circular motion.

PROSTEEL Marker and Chalk Board Specifications¹

Coating Thickness	≥ 60 microns face ≥ 15 microns base
Base Metal	Ultra Low Carbon Steel
Firing Temperature	1440° F (800° C)
Surface Hardness	POH 6.0+
Solvent Resistance	Not Affected
Acid Resistance	Not Affected
Alkali Resistance	Not Affected
Surface Abrasion / Scratch Resistance	60 MG @ 1000 RPM
Surface Smoothness	25-29 Wd Wave ScaN

Notes
1 Meets or exceeds Porcelain Enamel Institute requirements for the factors listed

Limited Warranty

PROSTEEL is warranted to maintain its original writing and erasing qualities for the next 50 years or the life of its original installation. IN ADDITION, the surface is warranted to remain intact, without crazing, cracking or peeling over the same warranty period. THIS WARRANTY is LIMITED to manufacturer's defects and does not cover malicious destruction, improper handling or maintenance, and use or wear other than the original purpose for which it was intended.

Should a defect occur, the MANUFACTURER will repair or replace, at its discretion, the writing surface. OBLIGATION will be limited to the delivery of repaired or new parts to the original installation site, without charge.

If you should encounter any problem, please contact our office directly, or the office of the installing dealer / contractor.

PROSTEEL Manufacturing PROCESS

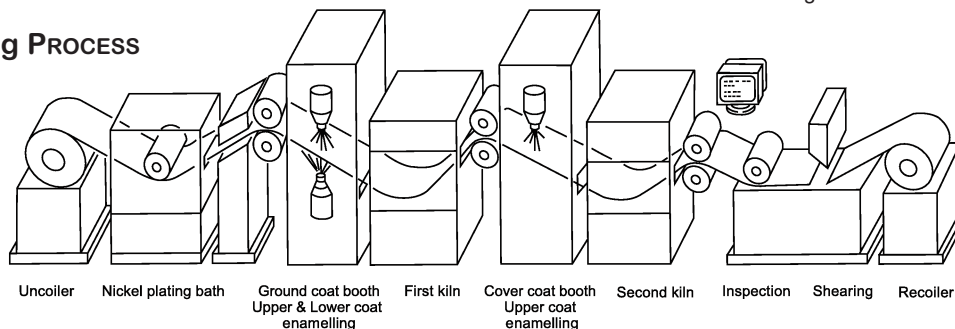

For additional information, contact us via e-mail, visit our website or www.sweets.com



P.O. BOX 731
BATH, OHIO 44210-0731
T 330-668-1515
F 330-668-1513

Web: www.k-prosteel.com
E-mail: info@k-prosteel.com

see us at
Sweets.com