

Series MSD-375 StormMax™ — impact-resistant medium stile entrance doors by Oldcastle BuildingEnvelope™

The Series MSD-375 is an **impact-resistant medium stile entrance door**. This entrance system meets the most demanding requirements of the Florida and International Building Codes. The series MSD-375 offers the largest variety of hardware options in the industry. The most prominent names in retail and Corporate America rely on **Oldcastle BuildingEnvelope™** to make an unforgettable first impression from standard, custom and impact-resistant storefronts.



Testing

- Miami / Dade County
- Florida Building Code TAS-201, TAS-202, TAS-203
- ASTM E 1886, E 1996



Myrtle Beach Convention Center, Myrtle Beach, SC
Architects: Cannon Associates

Features

Standard

- 3-point lock mechanism
- 1-1/2" pair of stainless steel butt hinges
- MIG welded corner construction
- 1-3/4" deep rail & stile
- 4-3/4" vertical stile, 4" top rail, 9" bottom rail
- Available for use with the FG-5000 / FG-5100 storefront systems and the HR-250 / HR-251 curtain wall systems

Optional

- Panic Devices: A variety of options available
- Continuous gear hinge
- 7-1/2" top rail
- 8-1/2" or 10" mid rail
- Concealed overhead closer



Details

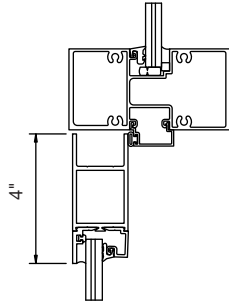

Standard Top Rail

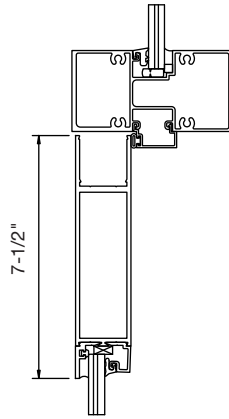

Optional Top Rail

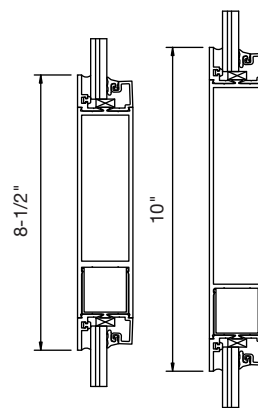

Optional Mid Rail

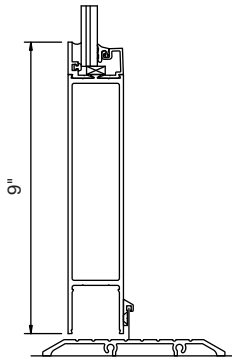

Standard Threshold

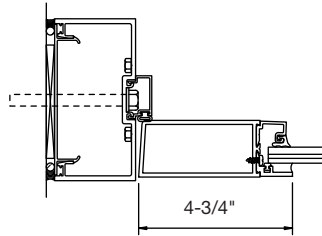

Standard Stiles

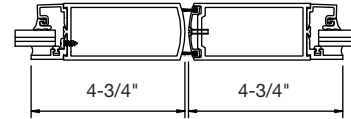

Performance

- Air Infiltration – Passed per TAS-202 and ASTM E 283

- Forced Entry Resistance Test – Passed at 300 lbs. Per SFBC 3603.2

- Structural Load – +70 / -80 PSF per TAS-202 and ASTM E 330

- Large Missile and Cycling – +70 / -80 per TAS-201, TAS-203 and ASTM E 1886, E 1996

