

Award Series
Platinum Edition

MODELS RHT 710, 770, 780, 790
Insulated Residential Garage Doors



The RHT 700 Models are available in four architecturally pleasing panel designs, all with the natural look of deep embossed wood grain and the durability of steel. The Platinum Edition is the premier residential door in the Award Series, offering exceptional quality and craftsmanship. These doors are urethane insulated for maximum energy efficiency, while the embossed galvanized steel will give years of use without rusting, warping, or cracking. The RHT 700 Models are the perfect balance of beauty and practicality.

1 3/4" Thick • R-Value 16.18



320 Sycamore • Wauseon, Ohio 43567
www.haasdoor.com

Award Series

Platinum Edition

MODELS RHT 710, 770, 780, 790 Insulated Residential Garage Doors

Invest in Beauty & Value

An individual's single most important investment is a home. A garage door can do more than just add beauty to your home; it can insulate, save you money, and increase value.

In visually appealing, wood grained embossed steel, the quality of the Platinum Edition RHT Models is far greater than meets the eye. Each door is carefully finished on both the interior and exterior with a tough epoxy primer and a durable polyester protective coating to ensure years of lasting distinction, despite the harsh effects of weather and frequent use. The RHT Models have a calculated **R-Value of 16.18** and use CFC-FREE, **1 3/4"** thick polyurethane foam that is environmentally safe. The RHT Models boast one of the highest energy ratings of any garage door in the industry, giving it six times the insulating value of wood or non-insulated doors.

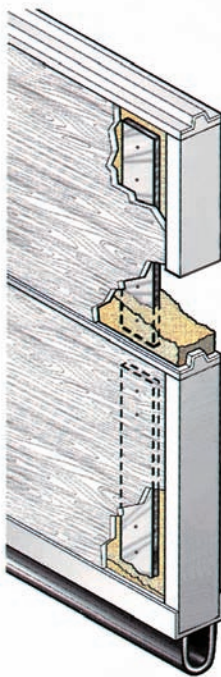

- Vinyl top cap provides thermal barrier and foam protector.
- Full thermal break on ALL sections insulates from extreme temperatures.
- Embossed galvanized steel skins assure protection from warping, rotting, and rusting.
- Attractive deep wood grain embossed steel is factory pre-finished and painted on both the exterior and interior with epoxy primer and polyester finish coat.
- Rigid vinyl end caps protect and seal the foam core and provide a smooth surface for door stops.
- Weather seals between each section joint keep out wind and rain.
- 1 3/4" polyurethane insulation is pressure injected and leaves no voids when bonding to both exterior and interior skins.
- Heavy 20-gauge galvanized back-up plates extending the full height of each section give superior hardware support.
- Flexible vinyl bottom astragal fits contour of floor providing a weather seal and is easily replaced if damaged.

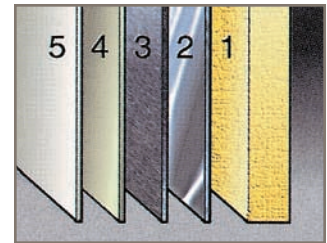

Protective Paint System

This three-tier, corrosion-resistant protection is designed to repel even the most hostile weather conditions. The protective layers found on both the interior and exterior are:

1. Foam-injected polyurethane
2. 26-gauge steel
3. Galvanizing
4. Epoxy primer
5. Polyester top coat

Standard heights:

6'6", 7'0", 7'6", 8'0"

Standard widths:

8', 9', 10', 12', 14', 15', 16', 18'

Standard panel (widths):

8', 9' @ 4 Panels

10' @ 5 Panels

12' @ 6 Panels

14', 15' @ 7 Panels

16', 18' @ 8 Panels

Practical, Efficient, Economical

The investment of an RHT Model steel garage door is a value with a return. Virtually maintenance free, it won't rust, rot, or warp and is highly energy efficient, insulating your home from extreme temperatures, wind, and rain.

Four Models To Choose From

Available in a variety of colors, the RHT Models require no painting unless field painting is desired to match the color scheme of your house. For added beauty, window options are available. All four models are available in white, almond, brown, sandstone, hunter green and gray. The Platinum Edition features three panel designs: flush wood grain, raised-panel wood grain, and sculptured-panel wood grain.

All RHT Models are covered by a limited lifetime warranty. Just one more feature that gives you peace of mind for the lifetime of your Platinum Edition RHT Models.



RHT 710

Provides an attractive true flush embossed wood grain appearance that will emphasize the styling of your home.



RHT 770 – RANCH FOUR PANEL

RHT 780 – COLONIAL EIGHT PANEL

This raised-panel door is accented with an embossed wood grain, raised-panel design. This handsomely detailed door is a great addition to any home.



RHT 790

This sculptured, raised-panel, wood grain door is crafted with embossed panels that accentuate its stylish design. This elegant model perfectly matches the popular French Provincial design used in many of today's upscale homes.



RANCH FOUR PANEL DESIGN

© Haas Door 2002



320 Sycamore
Wauseon, OH 43567
www.haasdoor.com

