

# Motorized Window Covering Systems



Drapery Systems



Vertical Blinds



Roller • Roman Shades



Skylight Systems



Every BTX system is the product of a strong commitment to excellence in system and control design, engineering and manufacturing. BTX systems have been specifically engineered for luxury residential homes and custom commercial applications. Its unmatched technology has made BTX the choice of those who design the most prestigious hotels, restaurants, galleries, corporate centers and luxury homes throughout the world. (See page 4 for a listing of some recent installations.)



The **Motorized Drapery System 5060** fits all drapery applications, whether straight, curved or reverse curved. The 5060 is available with either Pinch Pleat, Ripplefold® or Accordiafold® carrier systems. BTX offers a choice of motor combinations for the 5060 systems up to a capacity of 280 lbs. of drapery weight. This system can span up to 50-foot widths and can be precision curved to match building contours.

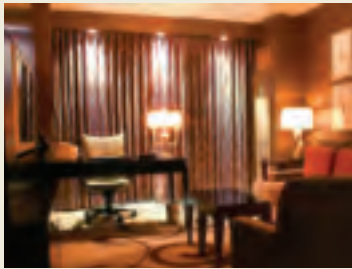

The **MotorDrape™** is ideal for medium to lightweight draperies. The system is available with Pinch Pleat carriers only. It can span up to 18-foot widths and has a 60 lb. drapery capacity. The motor features built-in low voltage contact for integration into control networks, as well as a built-in remote control receiver.

Visit [www.btxinc.com](http://www.btxinc.com) and click on the icons for detailed information on ...

**Product Info**

**Specifications**

**CAD Drawings**

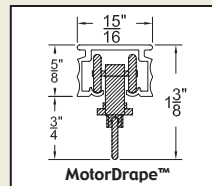
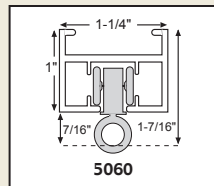

	5060™ Systems					MotorDrape™ Systems		
	Classic™ 30	Classic™ 45	Sofia™ 30	Sofia™ 45	Sofia™ 60	Model 1000	Model 2000	Model 3000 Cord Drive
<b>Max. Width</b>	23 ft. (unspliced) 50 ft. (spliced)	23 ft. (unspliced) 50 ft. (spliced)	23 ft. (unspliced) 50 ft. (spliced)	23 ft. (unspliced) 50 ft. (spliced)	23 ft. (unspliced) 50 ft. (spliced)	18 ft.	18 ft.	18 ft.
<b>Max. Weight</b>	80 lbs (single) 160 lbs. (double)	160 lbs (single) 280 lbs. (double)	70 lbs (single) 140 lbs. (double)	150 lbs (single) 250 lbs. (double)	240 lbs (single)	60 lbs.	60 lbs.	25 lbs.
<b>Min. Radius</b>	14" (pinch pleat) 20" (ripple/accordiafold)	14" (pinch pleat) 20" (ripple/accordiafold)	14" (pinch pleat) 20" (ripple/accordiafold)	14" (pinch pleat) 20" (ripple/accordiafold)	14" (pinch pleat) 20" (ripple/accordiafold)	Not curvable	Not curvable	Not curvable
<b>Motor Speed</b>	6"/sec	6"/sec	6"/sec	6"/sec	6"/sec	12"/per 1.2 sec	12"/per 1.2 sec	12"/per 1.2 sec
<b>Motor Info</b>	120/240 V AC	120/240 V AC	120/240 V AC	120/240 V AC	120/240 V AC	Power Supply: 12 V DC	Power Supply: 12 V DC	Power Supply: 12 V DC



# Automated Solar Screens and Shading Systems

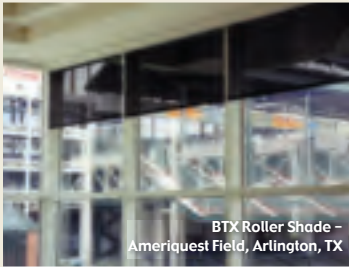

BTX offers one of the most complete lines of motorized roller shades on the market. It ranges from the compact RS-10 system for small shades weighing up to 10 lbs., up to the RS-30 and the RS-40 that can accommodate shades up to 20 feet in width. **The RS-20 Easy-Set™ program** consists of four series: **"S-series" standard** motors rated at 4 sec./ft. lifting speed, **"HS-series" of high speed** motors rated at 1.5 sec./ft., **"SQ-series", a super quiet DC motor** rated at a 42 decibel sound level, and the **"Supertronic-series"** of electronic RF controlled motors.

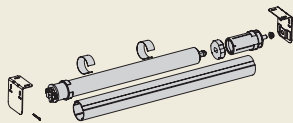

Easy-Set™  
Bracket Hardware

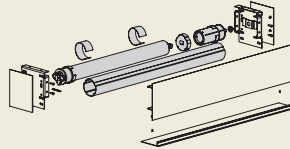

Easy-Set™  
Fascia Hardware

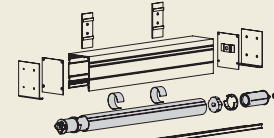

Easy-Set™  
Cassette Hardware

	Standard Speed	High Speed	Super Quiet	Built-in RF Receiver	Compact DC Motor	Compact AC Motor	Large Applications
Motor Type	Easy-Set™ "S"	Easy-Set™ "HS"	Easy-Set™ "SQ"	Easy-Set™ "Supertronic"	RS-10	RS-15	RS-30
Max. Shade Size	12' x 15' **	10' x 10' **	10' x 10' **	12' x 15' **	5' x 6' **	7' x 9' **	15' x 17' **
Max. Weight of Shade	50 or 70 lbs. (depending on motor chosen)	35 lbs.	25 lbs.	50 or 70 lbs. (depending on motor chosen)	10 lbs.	30 lbs.	49 lbs.
Max. Drop	180"	120"	120"	180"	72"	108"	204"
Optional Enclosure Size	4" x 4-3/4"	4" x 4-3/4"	4" x 4-3/4"	4" x 4-3/4"	3" x 3"	3" x 3"	—
Motor Speed	30 rpm	80 rpm	28 rpm	30 rpm	40 rpm	27 rpm	30 rpm
Motor Info	120/230 V AC	120/230 V AC	12 V DC	120/230 V AC	24 V DC	110/230 V AC	110/230 V AC

\* Patent pending

\*\* Depending on fabric type and weight

For more information on manual systems, see our website or contact factory.

## Automated Specialty Shading Systems

Click on these icons at [www.btxinc.com](http://www.btxinc.com)



**Vertical Blind Systems** which rotate and traverse. They can span up to 23 feet one way or a 46-ft. split draw (by making tandem tracks), and can handle a weight of up to 60 lbs.



**Roman Shade Systems** which utilize a powerful tubular motor, can span widths beyond 20 feet, and can handle weights in excess of 150 lbs.



**Pleated/Cellular Shade and Horizontal Blind Systems** which can automate the pleated shades, cellular shades, wood blinds and mini-blinds of almost all major manufacturers.



**Skylight Shading Systems** which include the Sky Control™ 5066 Motorized Roman-style System, Sky Control™ A2 Motorized Louvered System, and the Sky Control™ 5070 Motorized Pleated/Cellular System.

# Recent Installations of BTX Motorized Systems Worldwide

## HOTELS IN THE UNITED STATES

### **Biltmore Hotel**

Coral Gables, FL  
Product: 5060 Drapery

### **The Coeur d'Alene Resort**

Coeur d'Alene, ID  
Product: 5060 Sofia

### **Conrad Indianapolis**

Indianapolis, IN  
Product: 5060 Sofia

### **Four Seasons Hotel**

New York, NY  
Product: 5060 Drapery/Roman Shades

### **Four Seasons Hotel**

Silicon Valley at East Palo Alto, CA  
Product: 5060 and Roller Shades

### **Hilton La Jolla Torrey Pines**

La Jolla, CA  
Product: 5060 Drapery

### **Hilton Las Vegas**

Las Vegas, NV  
Product: 5060 Drapery

### **Hilton San Francisco**

Union Square, San Francisco, CA  
Product: Verticals

### **Hyatt Regency Chicago**

Chicago, IL  
Product: 5060 Drapery

### **Loews Philadelphia Hotel**

Philadelphia, PA  
Product: 5060 Drapery

### **Mandarin Oriental Hotel**

Miami, FL  
Product: 5060 and Roller Shades

### **Mandarin Oriental Hotel**

New York, NY  
Product: 5060 Drapery, Roman  
Shades and Roller Shades

### **The Peninsula Chicago**

Chicago, IL  
Product: 5060 Drapery

### **RIO Palazzo Suites**

Las Vegas, NV  
Product: 5060 and Roman Shades

### **Sheraton Sacramento**

Sacramento, CA  
Product: 5060 Drapery

### **St. Regis Hotel**

Los Angeles, CA  
Product: 5060 Drapery

### **St. Regis Hotel**

San Francisco, CA  
Product: 5060 Sofia

### **Sofitel Philadelphia**

Philadelphia, PA  
Product: 5060 Drapery

### **Westin NY at Times Square**

New York, NY  
Product: RS-20 Roller Shades

### **The Westin Seattle**

Seattle, WA  
Product: 5060 Drapery

### **Wyndham Harbour Island**

Tampa, FL  
Product: 5060 and Roller Shades

## INTERNATIONAL HOTELS

### **Al Faisaliah Hotel**

Riyadh, Saudi Arabia  
Product: MotorDrape™

### **CLC Cruiseship Lines**

International Cruise Line  
Product: 5060 Drapery

### **The Fairmont Vancouver Airport**

Vancouver, B.C. Canada  
Product: MotorDrape™

### **The Peninsula Bangkok**

Bangkok, Thailand  
Product: 5060 Drapery

### **Shangri-La Hotel**

Bangkok, Thailand  
Product: 5060 Drapery

### **The Taj Mahal Hotel**

New Delhi, India  
Product: 5060 Drapery

### **Taj West End Hotel**

Bangalore, India  
Product: 5060 Drapery

### **Taj Coromandel Hotel**

Chennai, India  
Product: 5060 Drapery

### **The Westin Chosun**

Seoul, Korea  
Product: 5060 Drapery

## CORPORATE OFFICES

### **American Airlines Headquarters**

Dallas/Fort Worth, TX  
Product: Verticals

### **Harrah's Corporate Offices**

Las Vegas, NV  
Product: 5060 Drapery

### **Lucent Technologies**

Chicago, IL  
Product: Roller Shades

### **Nike World Headquarters**

Beaverton, OR  
Product: 5060 Drapery

### **Nippondenso**

Southfield, MI  
Product: Sky Control™ 5066

### **Oracle Computers**

Las Colinas, TX  
Product: Verticals

### **Rockwell International**

Milwaukee, WI  
Product: 5060 Drapery

### **Shell Oil**

Houston, TX  
Product: Verticals

### **Warner Bros. Executive Offices**

Los Angeles, CA  
Product: 5060 Drapery/Verticals

## PUBLIC BUILDINGS & SCHOOLS

### **Acosta School District**

Seattle, WA  
Product: Sky Control™ A2

### **The Ballpark in Arlington**

Diamond Club, Arlington, TX  
Product: Roller Shades

### **Evangelical Lutheran Church**

Chicago, IL  
Product: 5060 Drapery

### **Maryland Statehouse**

Annapolis, MD  
Product: Sky Control™ 5066

### **Mercedes-Benz Plant**

Vance, AL  
Product: Verticals/Roller Shades

### **Penn State University**

University Park, PA  
Product: 5060 Drapery

### **United Nations Building Secretary General's Office**

New York, NY  
Product: Verticals

### **University of Utah**

Salt Lake City, UT  
Product: Roller Shades



For full technical details or specifications, please contact us:  
10763 Sanden Dr. • Dallas, TX 75238 • (214) 340-2800 • (800) 422-8839  
FAX (214) 343-2252 • [www.btxinc.com](http://www.btxinc.com) • [btwindow@btxinc.com](mailto:btwindow@btxinc.com)

