

# Panning Trim-All™ Replacement System

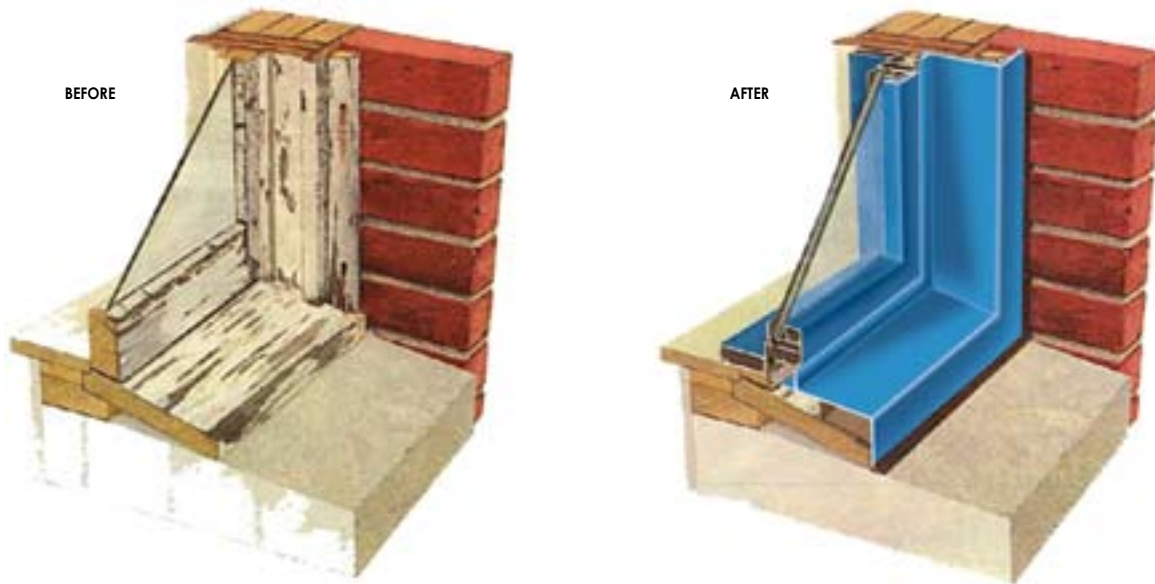

The EFCO Trim-All™ system provides a preferred alternative to replacing windows in existing structures. For replacing old, inefficient, single glazed wood and steel windows, the EFCO Trim-All replacement window system is clean, cost effective, and is highly customizable to fit your application. It's one of the best methods to install new windows quickly and begin reducing the costs of heating, cooling and maintenance. In addition, the Trim-All replacement system improves the aesthetic quality and value of the structure.

The Trim-All system is based on an aluminum exterior frame or "pan" that covers the old wooden or steel window frame after the sash or ventilator has been removed. The pan is anchored and caulked in place against the masonry or facade material. It will then accept any standard EFCO window or any custom window built to your design and specifications. Stainless-steel spring clips around the perimeter of the pan allow the window of your choice to be snapped-in and held snugly in place against weather stripping in the Trim-All pan. Those windows include: fixed, single or double hung, sliding, casement, projected, pivoted or Roto-Vent™. The Trim-All interior covers are then snapped in place over the anchors and the job is complete and clean with no repainting or exposed screws or fasteners. All work is done from inside the building eliminating the cost of scaffolding and reducing room downtime.

## Features

- Steel spring clip
- Minimal tear out
- Extensive selection of square and scroll panning extrusions
- Anodized or painted finishes available

## Benefits

- Facilitates installation from interior of the building
- Allows old perimeter window frame to remain in place
- Allows matching of existing sight lines in restoration projects
- Multiple options to answer economic and aesthetic concerns



# Panning Trim-All™ Replacement System

## HISTORICAL REPLACEMENT

EFCO has the technology to match nearly any architectural style, manufacturing complex historical windows in accordance with stringent federal, state and local preservation regulations. EFCO's dedication to historical window replication has positioned the company as the leader in this highly specialized industry. EFCO has the proven ability to design and create new extrusion dies for complex panning frames, muntins and interior trims. As a result, EFCO can assure the architect that even the most intricate window details can be matched.

EFCO is especially equipped to recreate the complex pans for round top windows, arch tops, brick molds and flutes. EFCO can also recreate unique muntin patterns and unequal sash proportions.

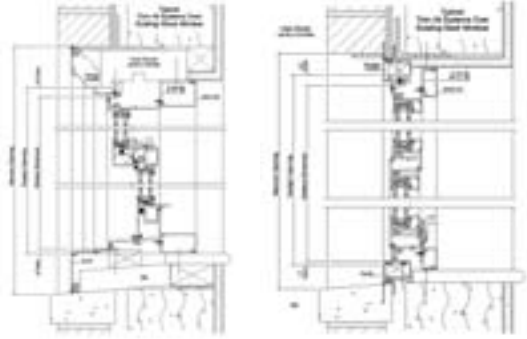

## 5 STEPS TO THE SOLUTION

### Step 1 - Remove The Old Sash

From inside the building, remove the interior trim stop (A), lower sash (B), parting strip (C), and upper sash (D). Utilizing the Trim-All no tear-out feature the old wood frame, interior and exterior trim and window weights remain in place, avoiding structural changes, downtime and expense.

### Step 2 - Install Exterior Pan

The Trim-All panning frame is quickly installed from the inside, eliminating expensive scaffolding, stages and room downtime. Minimal shimming is required; every Trim-All frame is individually designed for each opening. The frame is pulled tightly against the wood for firm support and provides a backing for caulking. Trim-All panning/receptor frames are fabricated from extruded aluminum with .062" minimum wall thickness of 6063-T6 alloy. Most frames are of screw spline construction. However, all frames can be welded for improved structural performance. Many extrusion profiles are available or custom profiles can be made to match historical designs.

### Step 3 - Anchor The Pan

The Trim-All panning frame is shimmed plumb and true, then fastened to the wood frame through predrilled holes. Once the Trim-All frame is anchored securely, it is caulked around the entire exterior perimeter for an effective weather seal.

### Step 4 - Window Installation

The selected EFCO replacement window is lifted over the bottom retaining leg of the Trim-All frame. After the window is properly seated, it is snapped in place utilizing Trim-All spring steel clips that hold the window unit in the panning frame prior to installing interior trim clips. This feature allows the entire installation to be completed from the interior of the building, eliminating the need for stages and scaffolds. All joints and cracks are sealed water tight, keeping out moisture and drafts and increasing energy savings.

### Step 5 - The Finishing Touches

Interior trim that covers the sill, jambs, and head complete the Trim-All installation. The trim is simply snapped in place over interior trim clips that hide rough edges and virtually eliminate replastering or painting for a smooth, professional look.

Interior trim is designed as a two-part, snap-together system. Trim clips are extruded aluminum with .094" minimum wall thickness of 6063-T6 alloy. The clips are 3" in length and placed around the opening perimeter at 16" on center. The clips provide the primary structural support for the window unit. Trim is field cut to exact opening dimensions and snapped onto the clips, concealing all anchorage fasteners.

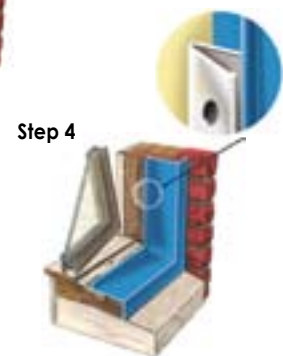

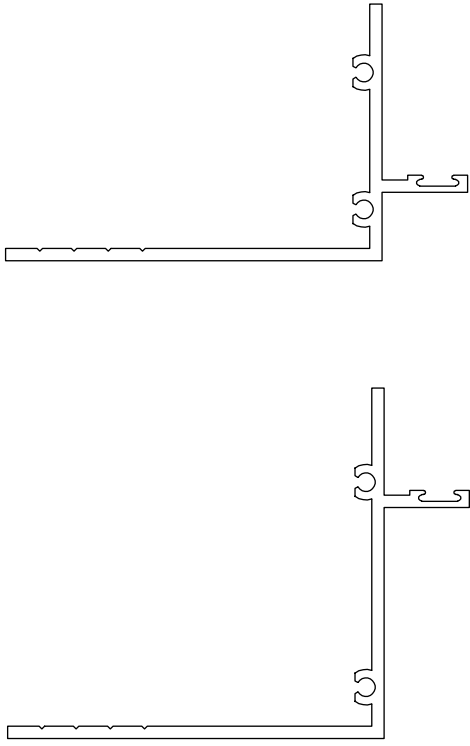

**Trim-All™ Square Panning**

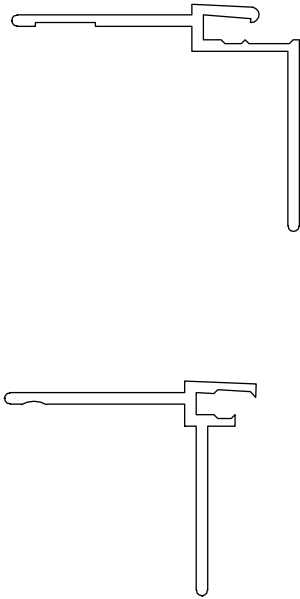

**Trim-All™ Nailfins**

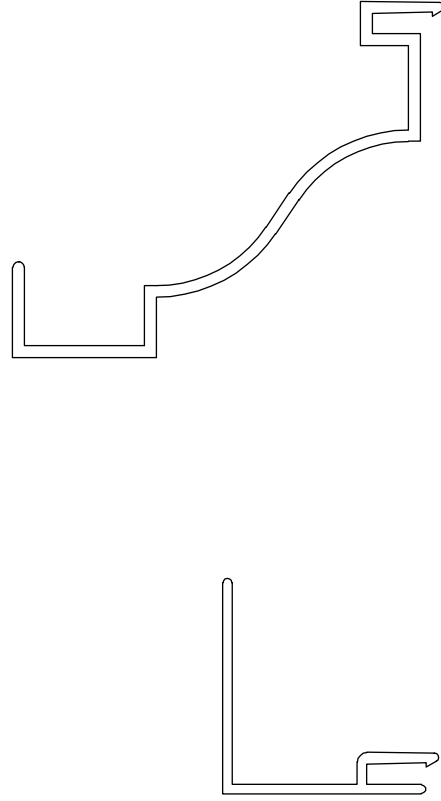

**Trim-All™ Extenders**

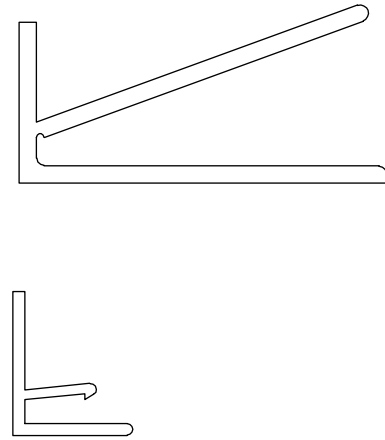

**Trim-All™ Caulk**

**Trim-All™ Exterior Covers**

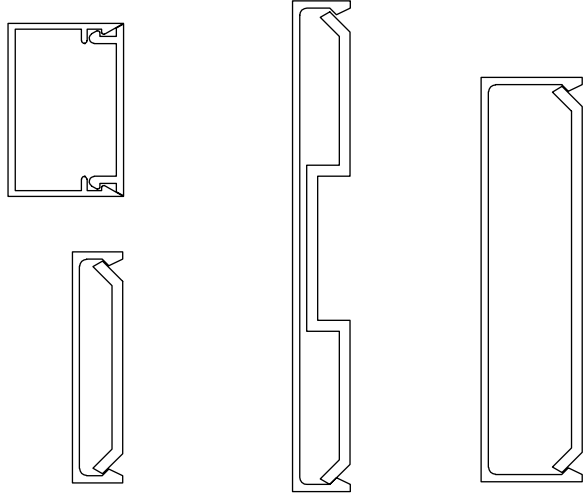

**Trim-All™ Exterior Stools**

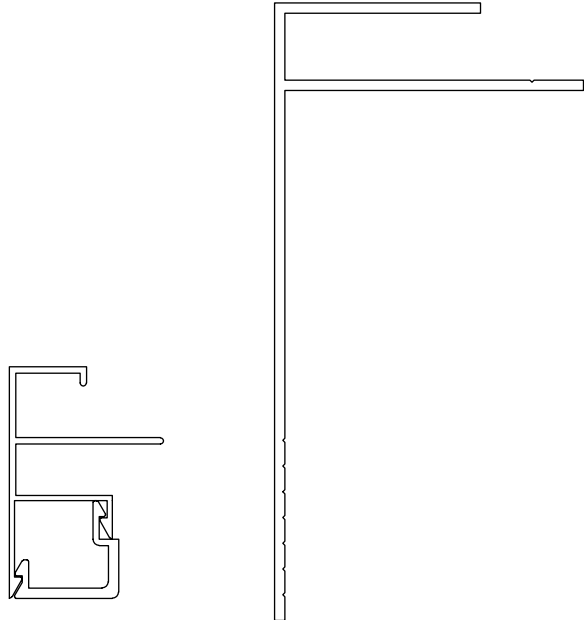

**Trim-All™ Scroll Panning**

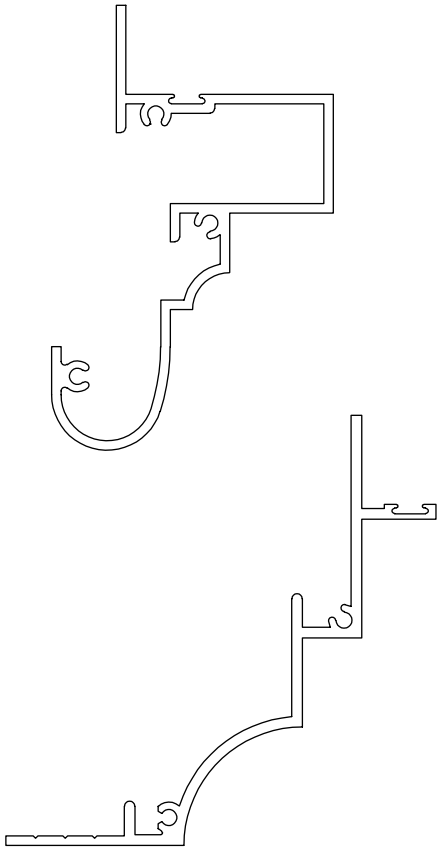

**Trim-All™ Interior Trim**

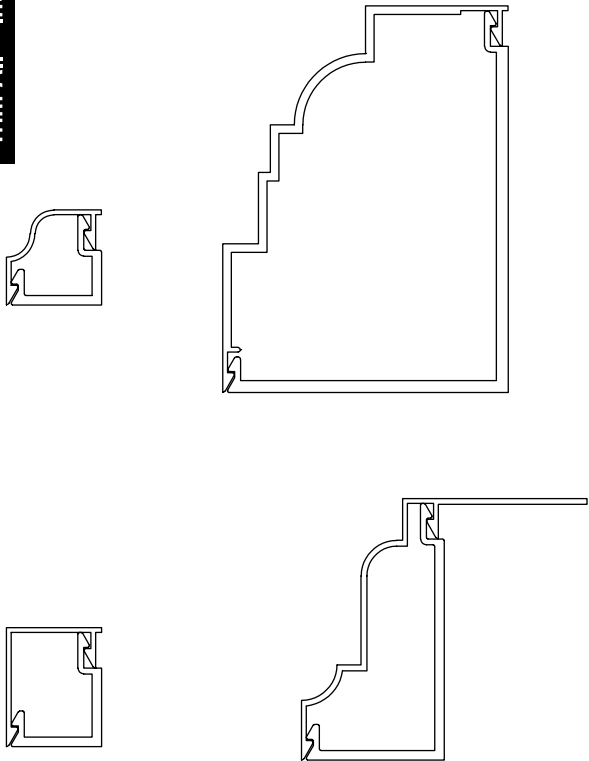

\* Visit [efcocorp.com](http://efcocorp.com) for more options