

SOUND SOAK® – Standard

Acoustical Wall Systems



Soundsoak® Acoustical Wall System in Lido Oak Bluffs with white field-painted Easel Ledge

Standard Finishes

Standard Soundsoak Acoustical Wall Panels are available in two substrates and 53 fabrics/vinyl colors.

Woven Fabric Surface

Available in Mineral Fiber and Fiberglass substrates and on Custom Fiberglass panels.

FR-701 (FR)

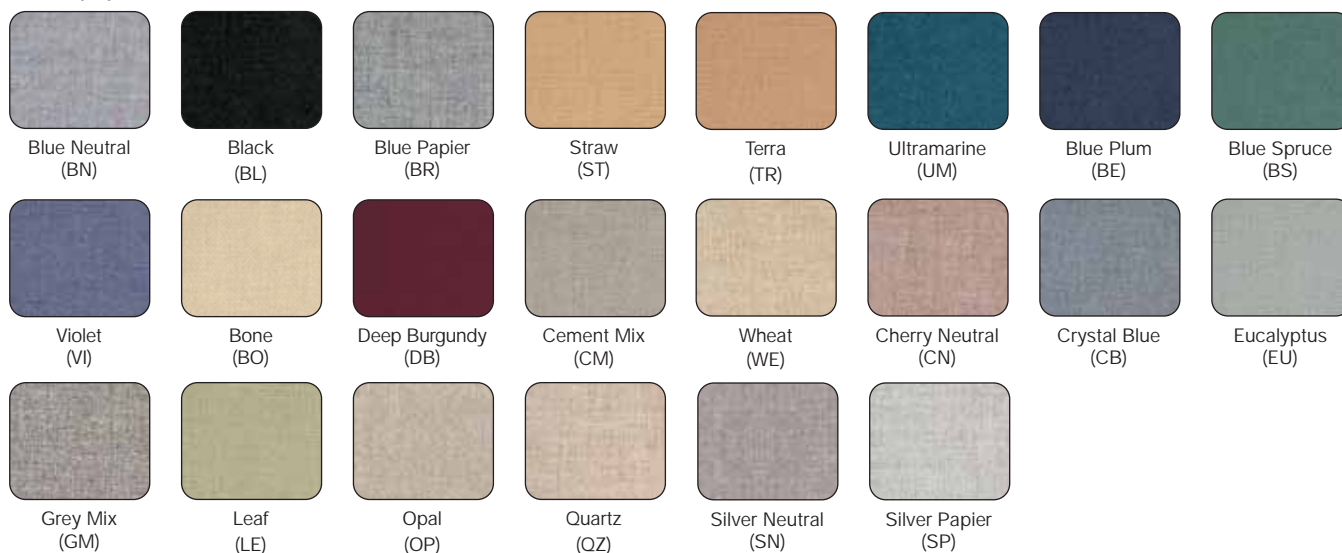

Due to printing limitations, color may vary from actual product.

Colored fabrics are dye-lotted and should be segregated by dye lot. Do not mix.

NOTE: Standard Soundsoak panel item numbers include references to size, fabric and substrate. Consult page 4 for assistance identifying item numbers.



SOUND SOAK® – Standard

Acoustical Wall Systems

Woven Fabric Surface

Available in Mineral Fiber and Fiberglass substrates and on Custom Fiberglass panels.

LIDO (LD)



Bryce Canyon
(BC)



Balboa
(BA)



Hermosa
(HE)



Oak Bluffs
(OB)

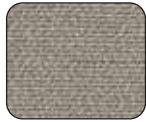

Padre
(PA)

CARRARA (CA)



Casein
(CS)



Beeswax
(BW)



Crackleglaze
(CG)



Gesso
(GE)



Malachite
(MA)

SPINEL (SP)



Tiger Eye
(TE)



Emery
(EM)



Opal
(OP)



Peridot
(PD)



Sandstone
(SS)

ZIRCONIA (ZC)



Tiger Eye
(TE)



Emery
(EM)



Guilden
(GU)



Opal
(OP)



Sandstone
(SS)

Soundsoak Acoustical Wall System in Lido Bryce Canyon with Maple Chair Rail



Composed Fabric Surface

Non-woven fabrics available in Mineral Fiber and Fiberglass Substrates (standard sizes only)

- Soundsoak 60/85 (random spaced grooves)
- Rhythms (evenly spaced grooves)

RHYTHMS (RH)/ SOUND SOAK (SK)



Blue Mauve
(BM)



Desert Sand
(DS)



Flagstone
(FL)



Frost Blue
(FB)



Mist
(MI)

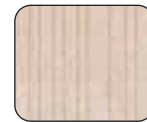

Oatmeal
(OA)



Pearl Gray
(PG)



Summer Wheat
(SW)

NOTE: Rhythms (RH) and Soundsoak (SK) patterns are available in all 8 colors shown above.

Standard Vinyl Finishes

Mineral Fiber Substrate only (standard sizes only)

SIGNATURE (SV)



Concrete
(CC)



Sand
(SA)

CLASSIC (CV)



Linen
(LN)

Due to printing limitations, color may vary from actual product.

Colored fabrics are dye-lotted and should be segregated by dye lot. Do not mix.

NOTE: Standard Soundsoak panel item numbers include references to size, fabric and substrate. Consult page 4 for assistance identifying item numbers.

SOUND SOAK® – Standard Acoustical Wall Systems

Soundsoak acoustical wall panels effectively control unwanted noise. The key feature of this engineered system is an acoustical inner core covered with your choice of woven fabric, composed fabric or easy-care vinyl.

Soundsoak acoustical wall panels absorb 50% to 90% of the sound striking the surface – 3 to 6 times the sound absorption of fabric-covered gypsum board typically used. Soundsoak 60 also minimizes sound transmission from space to space for increased speech privacy.

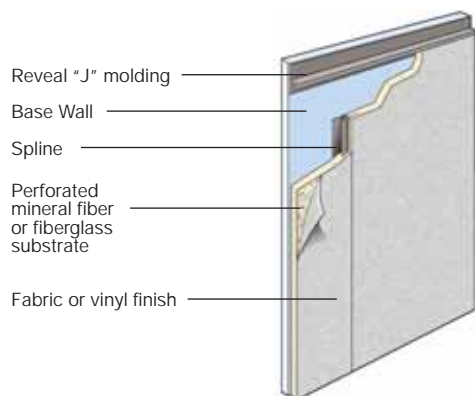

Broad Application

Soundsoak panels are ideal for use in commercial, institutional and educational buildings – anywhere noise reduction and sound privacy are a concern. They can be used in any room or hallway, even exit corridors. Unlike ordinary fabric covered wall panels, Soundsoak can be used in buildings without sprinklers.

Standard Sizes

Soundsoak acoustical wall panels are available in a wide range of sizes. Standard panel widths are 24" and 30". Standard panel heights are 6', 8', 9' and 10'.

- Panel widths and thicknesses:
 - Mineral fiber w/fabric – 30" wide, 3/4" thick
 - Mineral fiber w/vinyl – 24" wide, 5/8" thick
 - Fiberglass w/fabric – 24" wide, 1" thick

Standard Finishes

The product is available in two substrates and 53 fabrics/vinyl colors:

1. Woven Fabric Surface
 - Lido
 - Spinel
 - Zirconia
 - Carrara
 - FR-701
2. Composed Fabric Surface (a non-woven fabric made of 50% polyester & 50% polypropylene)
 - Rhythms (evenly spaced grooves)
 - Soundsoak 60/85 (randomly spaced grooves)
3. Vinyl Surface (Mineral fiber substrate only)
 - Classic
 - Signature

Custom Options

Custom Soundsoak acoustical walls offer more flexibility and expanded design options. Flat capabilities up to 4' wide and 10' high are offered on 1" and 2" thick fiberglass panels. Panels can be manufactured to order for your project in square or rectangular shapes and sizes. In addition to the Woven fabrics listed on pages 1 and 2, customer-specific and alternative non-woven fabrics can be considered. Impact-resistant panels are also available. For more information, view the Custom Soundsoak data page, CS-3888.

Acoustical Choices

Soundsoak panels absorb 50% to 90% of sound striking the surface – reducing noise within a space and reducing noise transfer between spaces. Two types of substrate or acoustical core options are available:

1. Fiberglass for superior sound absorption in situations like perimeter walls in open plan applications.
2. Mineral fiber for excellent acoustical performance in closed offices and places desiring the practicality of a tackable surface.

Acoustical Performance

NRC Rating	Mounting			Mounting	
	A	D		A	D
Soundsoak 60 (MF)	0.65	0.70	Zirconia 60 (MF)	0.65	0.70
Soundsoak 85 (FG)	0.80	0.90	Zirconia 85 (FG)	0.80	0.90
Rhythms 60 (MF)	0.65	0.70	Carrara 60 (MF)	0.65	0.70
Rhythms 85 (FG)	0.80	0.90	Carrara 85 (FG)	0.80	0.90
Lido 60 (MF)	0.65	0.70	FR701 60 (MF)	0.65	0.70
Lido 85 (FG)	0.80	0.90	FR701 85 (FG)	0.80	0.90
Spinel 60 (MF)	0.65	0.70	Classic Vinyl 60 (MF)	0.50	0.50
Spinel 85 (FG)	0.80	0.90	Signature Vinyl 60 (MF)	0.50	0.50

MF – Mineral fiber substrate

FG – Fiberglass substrate

Acoustics are certified by Factory Mutual (FM).

For more detailed acoustical information, including frequency data and STC levels, visit our web site at armstrong.com/soundsoak.

Easy Installation

Soundsoak panels are easy to install over existing walls or directly to studs with minimal workplace disruption. Soundsoak panels can be mounted directly on an existing surface ("A" mounting) or spaced 3/4" from the existing surface ("D" mounting) using 1" x 3" wood furring strips or metal furring channel. Impact corners are available to shield from collisions. Standard J-moldings simplify installation.



Chair Rail Accessories

Chair Rail accessories are now available in a variety of finishes to provide more design and durability options for your Soundsoak installation. For more information, see the following page or visit armstrong.com/soundsoak.

Environmentally Friendly

Soundsoak woven fabrics are constructed from 100% post-consumer recycled materials. The substrate's recycled composition is:

- Vinyl 78%
- Mineral fiber 65%
- Fiberglass 25%

Insulation Value

Mineral fiber – R 2.00, Fiberglass – R 4.00

Safety

- Factory Mutual Approvals certificate (Corner Burn Test meets UBC Standard 8-2 and NFPA 265, fully lined protocol)
- MEA # 162-87-M
- Tested to ASTM E84 – 25/200
- Tested to CAN/ULC SIO2* – 25/250
- Composite Class A rating per IBC (fabric, substrate and adhesive)
- For more details on Soundsoak fire performance, visit our web site at armstrong.com/soundsoak

* The ASTM E84 or CAN/ULC SIO2 standard should be used to measure and describe the properties of materials, products or assemblies in response to heat and flame under controlled laboratory conditions and should not be used to describe or appraise the fire hazard or fire risk of materials, products or assemblies under actual fire conditions. However, results of this test may be used as elements of a fire risk assessment, which takes into account all of the factors, which are pertinent to an assessment of the fire hazard of a particular end use. Values are reported to the nearest 5 rating.

Warranty

Project specific one (1) year warranty available upon request. Visit armstrong.com/warranty for more information.

SOUND SOAK® – Standard

Acoustical Wall Systems

Visual Selection

Item #*	Description	Dimensions			Surface Type	Surface Color
		Panel Width	Panel Thickness	Panel Height Options		
32 _____	Soundsoak 85 Woven/Composed Panel	24"	1"	6', 8', 9', 10'	FR, LD, CA, SP, ZC, RH, SK	See pages 1 & 2
40 _____	Soundsoak 60 Woven/Composed Panel	30"	3/4"	6', 8', 9', 10'	FR, LD, CA, SP, ZC, RH, SK	See pages 1 & 2
42 _____	Soundsoak 60 Vinyl Panel	24"	5/8"	6', 8', 9', 10'	SV, CV	See pages 1 & 2

* Specify panel height, surface type and surface color when ordering. Use surface suffixes from pages 1 and 2.

EXAMPLES:

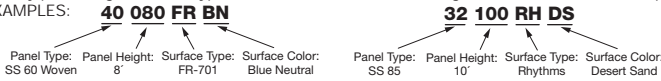

J-Molding Colors



Accessories

Item #	Description	Lengths	Colors
3856_ _ _ *	Impact Corner	10'	See pages 1 & 2
4062_ _ **	1" J-Molding	10'	BL, GW, FG, LT, SA
4064_ _ **	3/4" J-Molding	10'	BL, GW, FG, LT, SA
4065A	3/4" Low-Profile J-Molding	10'	BL

* Insert four-letter color suffix using surface type and color suffixes from pages 1 and 2. EXAMPLE: 3856LDOB – Impact Corner Lido Oak Bluffs

** Insert two-letter color suffix. EXAMPLE: 4062BL – 1" J-Molding in Black

Chair Rail Accessory Colors



Item #*	Description	Lengths	Colors*	Substrate
5861_ _	Mounting Rail	8'-4"	MP, LC, DC, HG, XX	Solid Wood
5862_ _	Rail Spacer for Soundsoak 85	8'-4"	XX	Solid Wood
5863_ _	Rail Insert	8'-4"	MP, LC, DC, HG, BL, XX	Solid Wood
5963NA	Rail Insert Aluminum Finish	8'-0"	NA	Solid Wood and Aluminum
5864_ _	Rail Cap	8'-4"	MP, LC, DC, HG, XX	Solid Wood
5865_ _	Extended Rail Cap for Soundsoak 85	8'-4"	MP, LC, DC, HG, XX	Solid Wood
5866_ _	Easel Ledge	8'-4"	MP, LC, DC, HG, XX	Solid Wood

* Insert two-letter color suffix for all Chair Rail item orders, except 5963NA. EXAMPLE: 5861HG – Mounting Rail in Mahogany

◆ NOTE: XX is unfinished wood, which can be field-painted.

Easy to Install



Soundsoak 60 panel with Chair Rail – Mounting Rail with Rail Insert

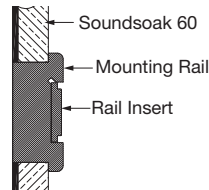

Soundsoak 60 panel with Chair Rail – Mounting Rail with Easel Ledge (field painted)

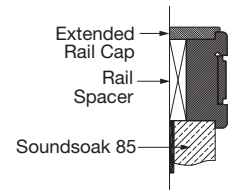
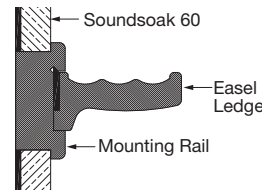

Soundsoak 85 panel with Chair Rail – Mounting Rail with Rail Insert, Extended Rail Cap and Rail Spacer