

# DURALAST Detectable Warning Plate

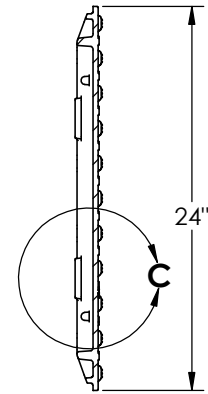

**SECTION B-B**

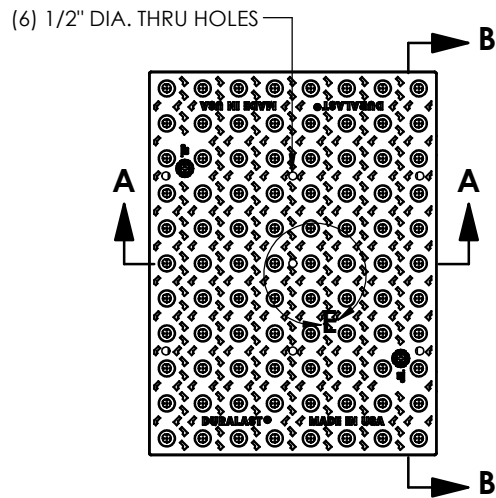
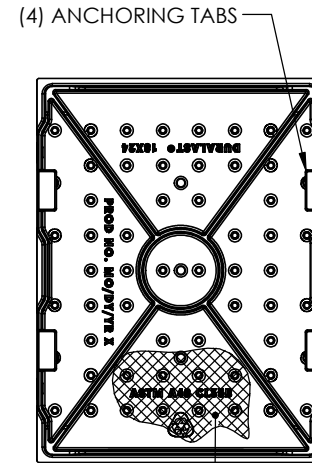

**BOTTOM VIEW**

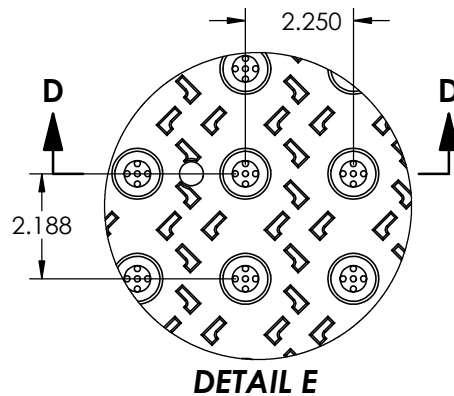

**DETAIL E**

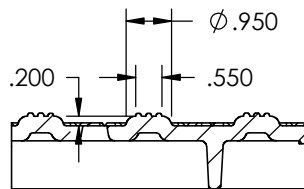

**SECTION D-D  
SCALE 1 : 4**

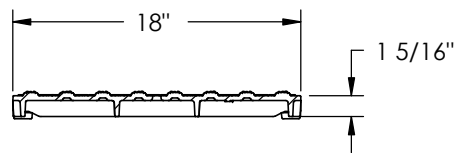

**SECTION A-A**

1/2" DIA. HOLES (4)  
PLACES (FOR BOLTING)  
HAND TIGHTEN ONLY

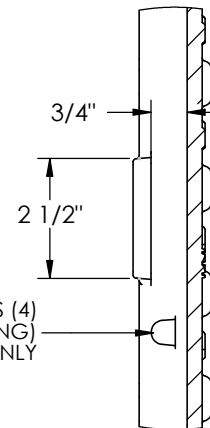

**DETAIL C**

**Product Number**

00700561

**Design Features**

- Materials  
Gray Iron (CL35)
- Design Load  
Non-Traffic
- Open Area  
n/a
- Coating  
Undipped
- √ Designates Machined Surface
- Slip Resistant Surface  
with the LLLL® registered trademark

**Certification**

- ASTM A48
- 
- Country of Origin: USA

**Drawing Revision**

11/23/2009 Designer: JIJ  
3/29/2012 Revised By: KK

**Disclaimer**

Weights (lbs/kg), dimensions (inches/mm) and drawings provided for your guidance. We reserve the right to modify specifications without prior notice.

CONFIDENTIAL: This drawing is the property of EJ Group, Inc. and embodies confidential information, registered marks, patents, trade secret information, and/or know how that is the property of EJ Group, Inc. Copyright © 2011 EJ Group, Inc. All rights reserved.

**Contact**

800 626 4653  
ejco.com

# DURALAST Detectable Warning Plate

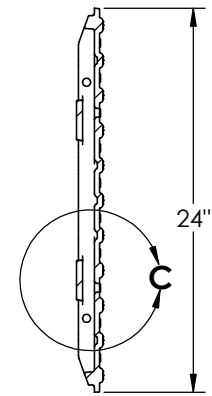
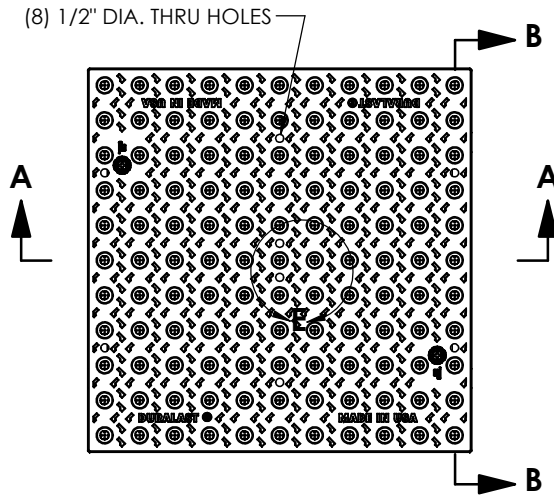

SECTION B-B

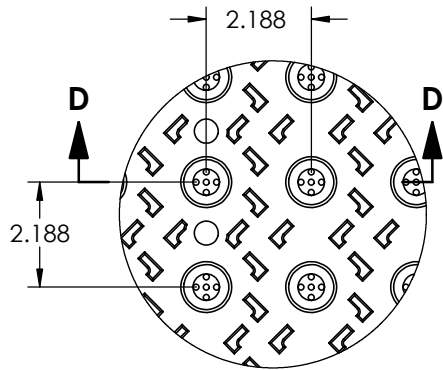

DETAIL E

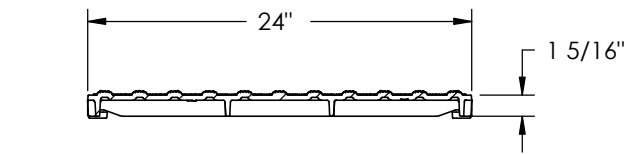

SECTION A-A

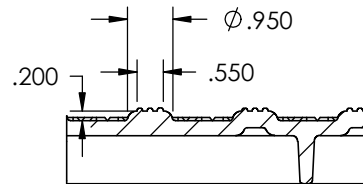

SECTION D-D  
SCALE 1 : 4

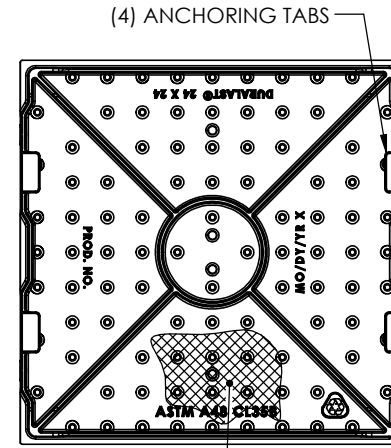

BOTTOM VIEW

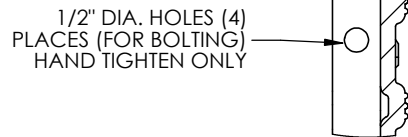

DETAIL C

1/2" DIA. HOLES (4)  
PLACES (FOR BOLTING)  
HAND TIGHTEN ONLY

**Product Number**

00700571

**Design Features**

- Materials  
Gray Iron (CL35B)
- Design Load  
Non-Traffic
- Open Area  
n/a
- Coating  
Undipped
- √ Designates Machined Surface

**Certification**

- ASTM A48
- 
- Country of Origin: USA

**Estimated Weight**

65.00 lbs.

**Drawing Revision**

11/23/2009 Designer: JIJ  
2/8/2013 Revised By: DEF

**Disclaimer**

Weights (lbs/kg), dimensions (inches/mm) and drawings provided for your guidance. We reserve the right to modify specifications without prior notice.

CONFIDENTIAL: This drawing is the property of EJ Group, Inc. and embodies confidential information, registered marks, patents, trade secret information, and/or know how that is the property of EJ Group, Inc. Copyright © 2011 EJ Group, Inc. All rights reserved.

**Contact**

800 626 4653  
ejco.com

# DURALAST Detectable Warning Plate

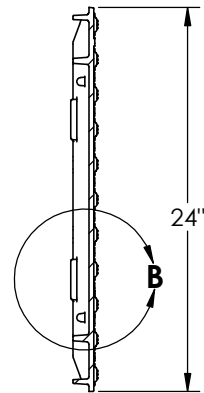
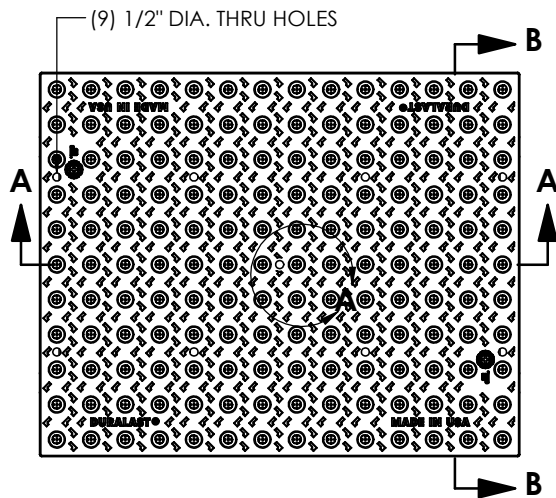

SECTION B-B

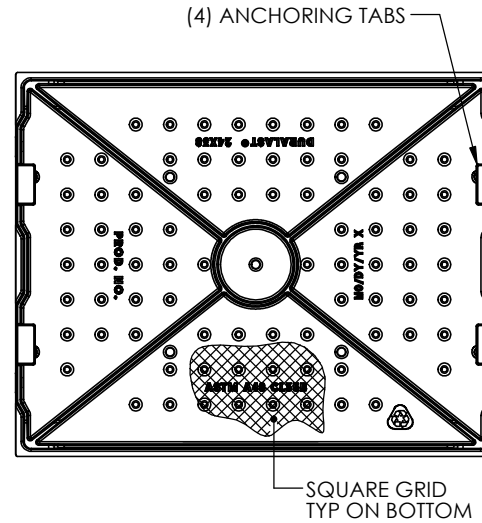

BOTTOM VIEW

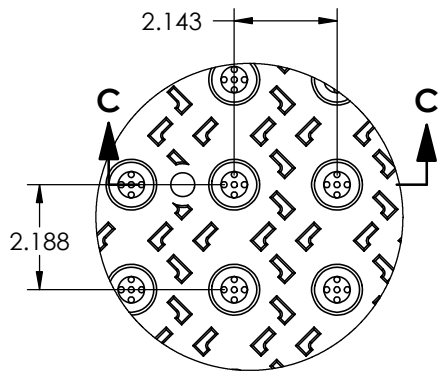

DETAIL A

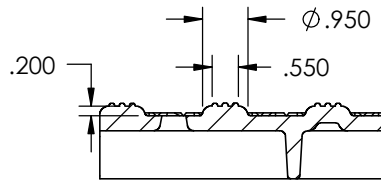

SECTION C-C  
SCALE 1 : 4

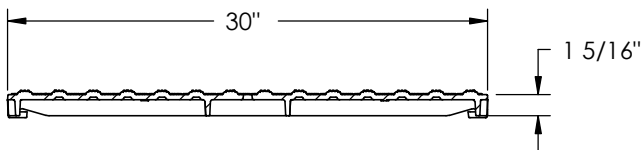

SECTION A-A

1/2" DIA. HOLES (4)  
PLACES (FOR BOLTING)  
HAND TIGHTEN ONLY

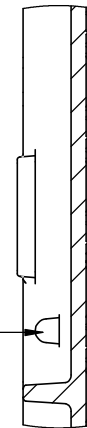

DETAIL B

## Product Number

00700721

## Design Features

- Materials  
Gray Iron (CL35B)
- Design Load  
Heavy Duty
- Open Area  
n/a
- Coating  
Undipped
- √ Designates Machined Surface

## Certification

- ASTM A48
- ADAAG
- Country of Origin: USA

## Drawing Revision

6/23/2009 Designer: DEW  
7/30/2012 Revised By: SDC

## Disclaimer

Weights (lbs/kg), dimensions (inches/mm) and drawings provided for your guidance. We reserve the right to modify specifications without prior notice.

CONFIDENTIAL: This drawing is the property of EJ Group, Inc. and embodies confidential information, registered marks, patents, trade secret information, and/or know how that is the property of EJ Group, Inc. Copyright © 2011 EJ Group, Inc. All rights reserved.

## Contact

800 626 4653  
ejco.com

# DURALAST Detectable Warning Plate



**NOTE: TAKES (8) COVERS TO COMPLETE FULL 90° TURN**

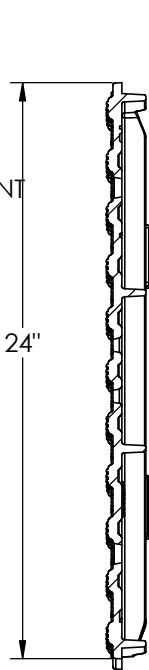
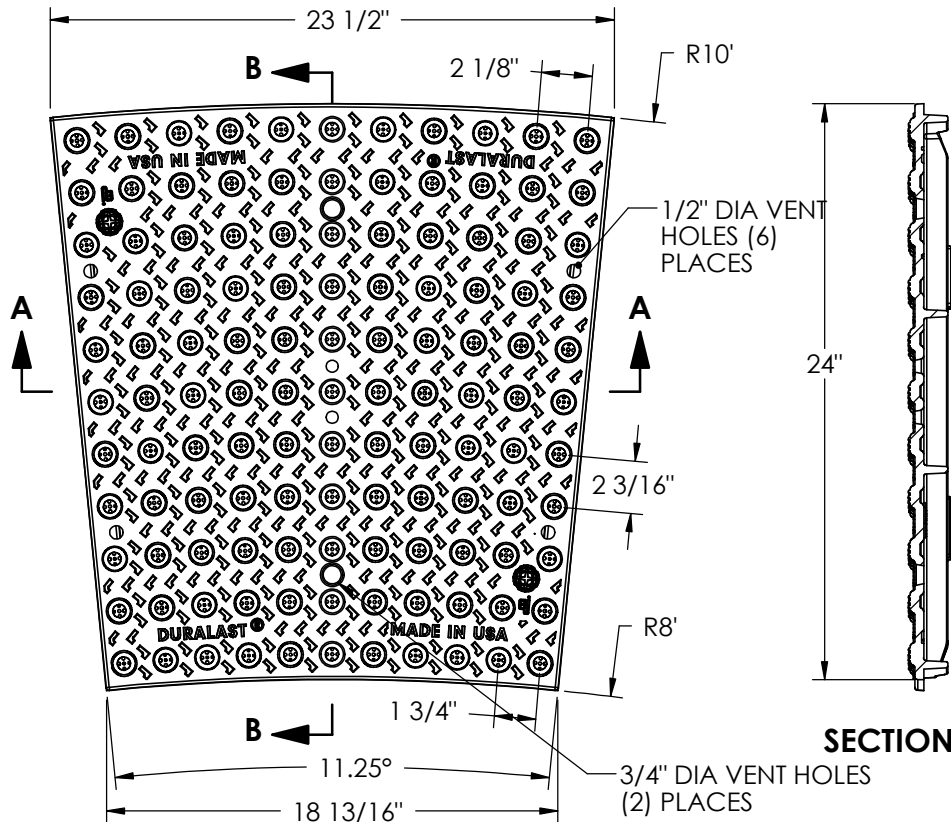

**SECTION B-B**

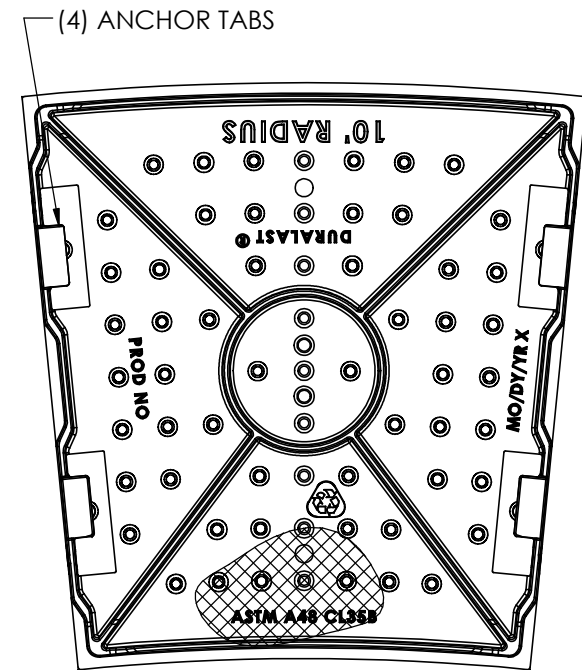

**BOTTOM VIEW**

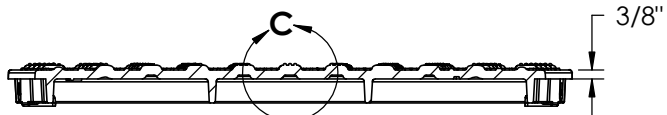

**SECTION A-A**

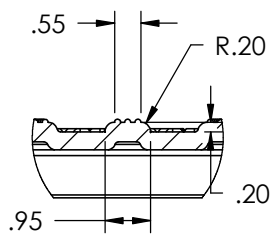

**DETAIL C  
SCALE 1 : 4**

**Product Number**

00700611

**Design Features**

- Materials  
Gray Iron (CL35B)
- Design Load  
Non-Traffic
- Open Area  
n/a
- Coating  
Undipped
- √ Designates Machined Surface
- Slip Resistant Surface  
with the LLLL® registered trademark

**Certification**

- ASTM A48
- 
- Country of Origin: USA

**Drawing Revision**

2/2/2010 Designer: DEW  
7/16/2013 Revised By: DJH

**Disclaimer**

Weights (lbs/kg), dimensions (inches/mm) and drawings provided for your guidance. We reserve the right to modify specifications without prior notice.

CONFIDENTIAL: This drawing is the property of EJ Group, Inc. and embodies confidential information, registered marks, patents, trade secret information, and/or know how that is the property of EJ Group, Inc. Copyright © 2011 EJ Group, Inc. All rights reserved.

**Contact**

800 626 4653  
ejco.com

# DURALAST Detectable Warning Plate



**NOTE: TAKES (15) COVERS TO COMPLETE FULL 90° TURN**

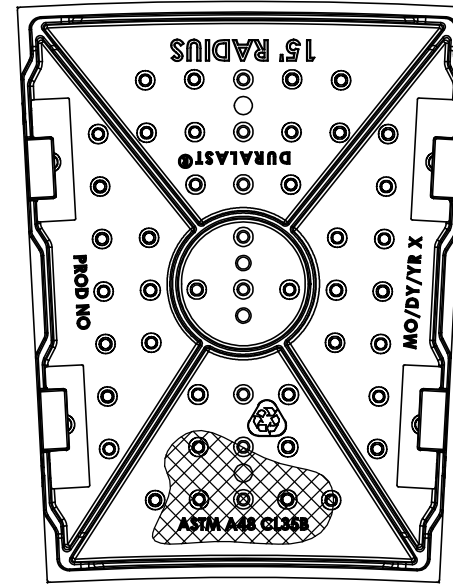
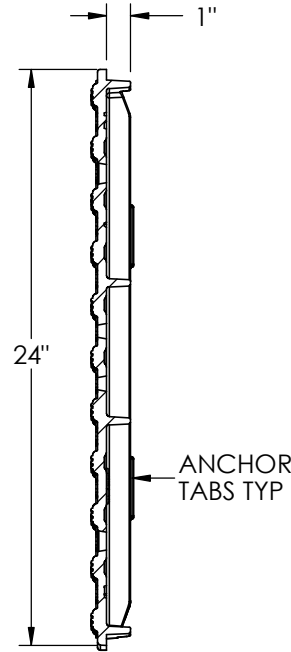
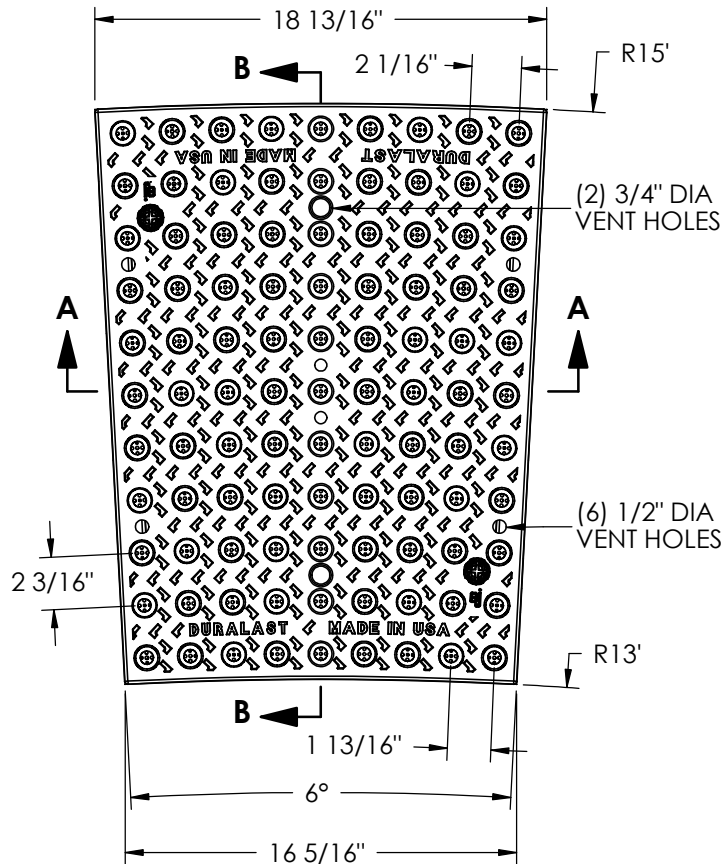

SECTION B-B

BOTTOM VIEW

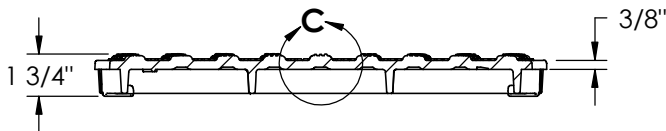

SECTION A-A

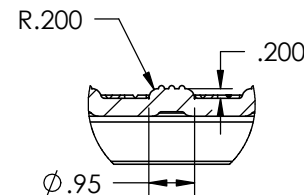

DETAIL C  
SCALE 1 : 4

## Product Number

00700615

## Design Features

- Materials  
Gray Iron (CL35B)
- Design Load  
Non-Traffic
- Open Area  
n/a
- Coating  
Undipped
- √ Designates Machined Surface
- Slip Resistant Surface  
with the LLLL® registered trademark

## Certification

- ASTM A48
- 
- Country of Origin: USA

## Drawing Revision

2/2/2010 Designer: DEW  
7/26/2013 Revised By: DAE

## Disclaimer

Weights (lbs/kg), dimensions (inches/mm) and drawings provided for your guidance. We reserve the right to modify specifications without prior notice.

CONFIDENTIAL: This drawing is the property of EJ Group, Inc. and embodies confidential information, registered marks, patents, trade secret information, and/or know how that is the property of EJ Group, Inc. Copyright © 2011 EJ Group, Inc. All rights reserved.

## Contact

800 626 4653  
ejco.com

# DURALAST Detectable Warning Plate



**NOTE: TAKES (18) COVERS TO COMPLETE FULL 90 ° TURN**

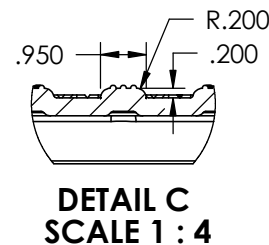
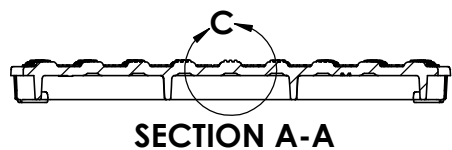
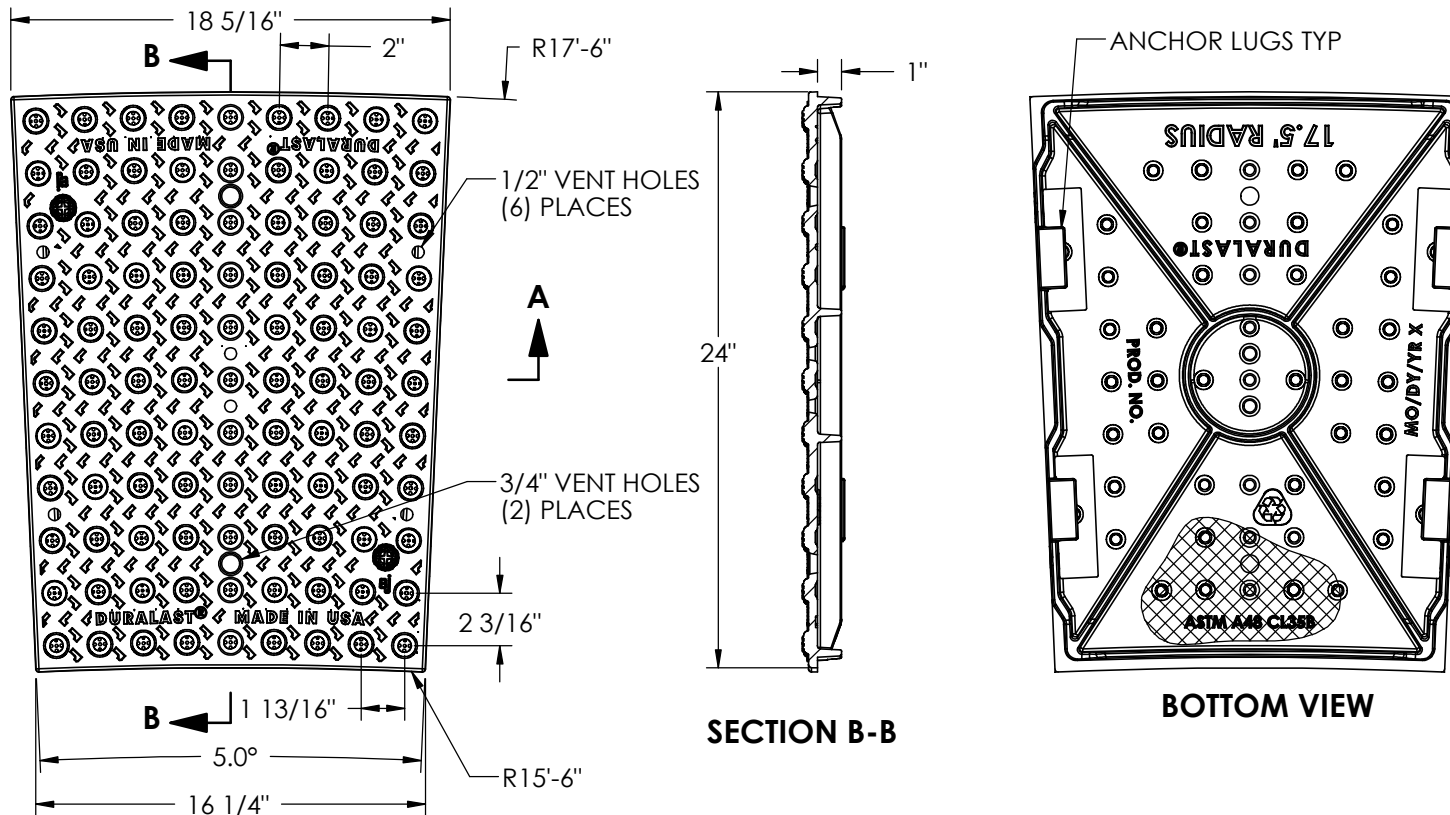

## Product Number

00700617

## Design Features

- Materials  
Gray Iron (CL35B)
- Design Load  
Non-Traffic
- Open Area  
n/a
- Coating  
Undipped
- √ Designates Machined Surface
- Slip Resistant Surface  
with the LLLL® registered trademark

## Certification

- ASTM A48
- 
- Country of Origin: USA

## Drawing Revision

2/2/2010 Designer: DEW  
7/29/2013 Revised By: DAE

## Disclaimer

Weights (lbs/kg), dimensions (inches/mm) and drawings provided for your guidance. We reserve the right to modify specifications without prior notice.

CONFIDENTIAL: This drawing is the property of EJ Group, Inc. and embodies confidential information, registered marks, patents, trade secret information, and/or know how that is the property of EJ Group, Inc. Copyright © 2011 EJ Group, Inc. All rights reserved.

## Contact

800 626 4653  
ejco.com



# DURALAST Detectable Warning Plate



**NOTE: TAKES (20) COVERS TO COMPLETE FULL 90° TURN**

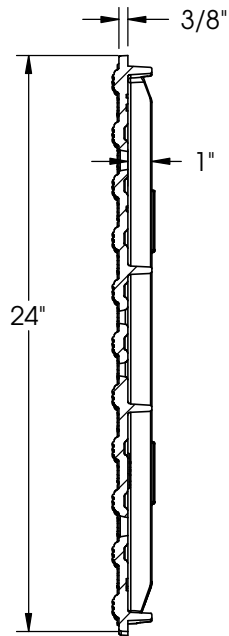
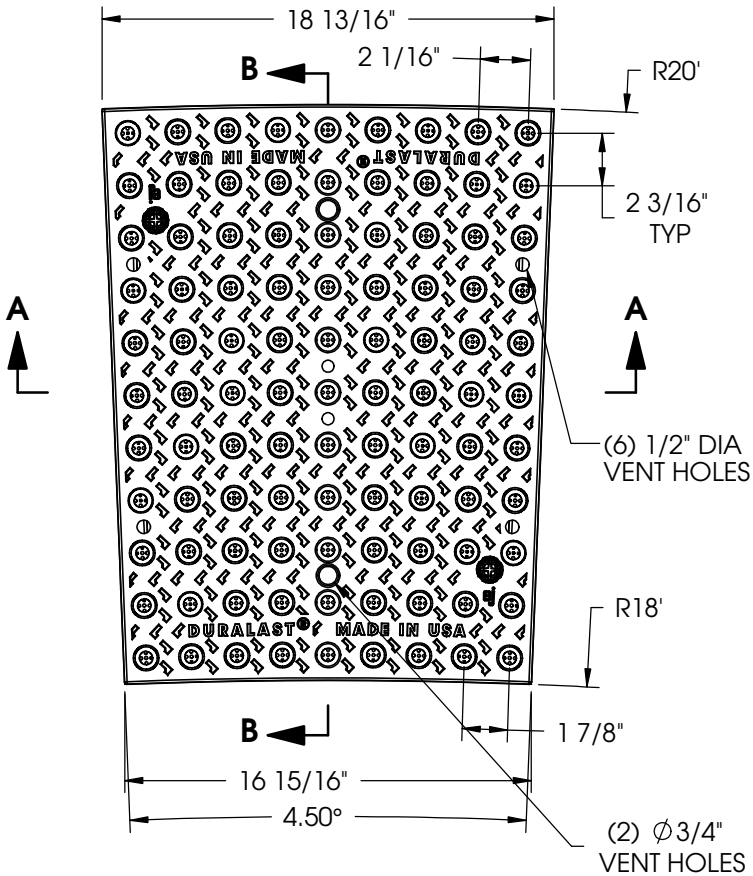

**SECTION B-B**

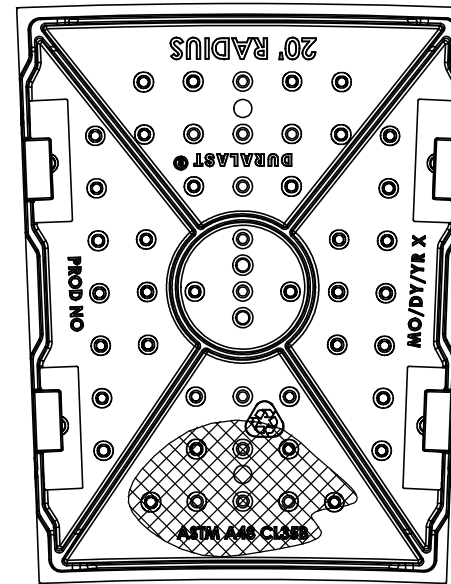

**BOTTOM VIEW**

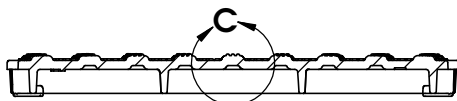

**SECTION A-A**

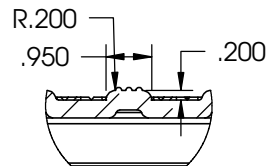

**DETAIL C  
SCALE 1 : 4**

**Product Number**

00700621

**Design Features**

- Materials  
Gray Iron (CL35B)
- Design Load  
Non-Traffic
- Open Area  
n/a
- Coating  
Undipped
- √ Designates Machined Surface
- Slip Resistant Surface  
with the LLLL® registered trademark

**Certification**

- ASTM A48
- 
- Country of Origin: USA

**Drawing Revision**

2/2/2010 Designer: DEW  
7/30/2013 Revised By: DAE

**Disclaimer**

Weights (lbs/kg), dimensions (inches/mm) and drawings provided for your guidance. We reserve the right to modify specifications without prior notice.

CONFIDENTIAL: This drawing is the property of EJ Group, Inc. and embodies confidential information, registered marks, patents, trade secret information, and/or know how that is the property of EJ Group, Inc. Copyright © 2011 EJ Group, Inc. All rights reserved.

**Contact**

800 626 4653  
ejco.com

# DURALAST Detectable Warning Plate



**NOTE: TAKES (23) COVERS TO COMPLETE FULL 90° TURN**

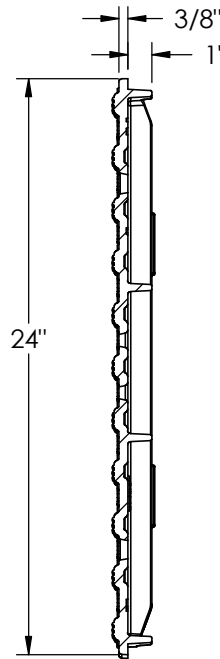
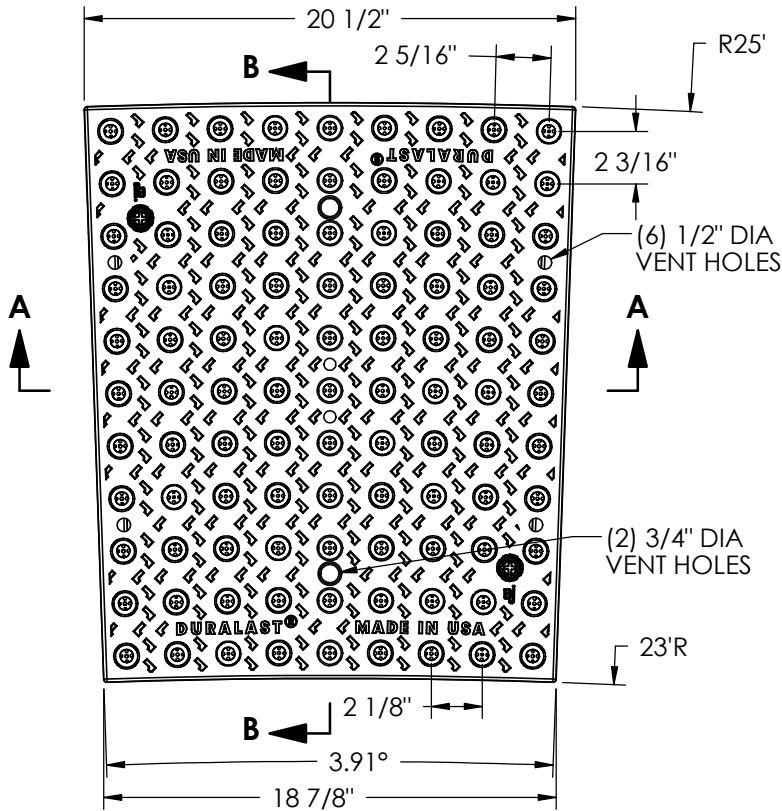

**SECTION B-B**

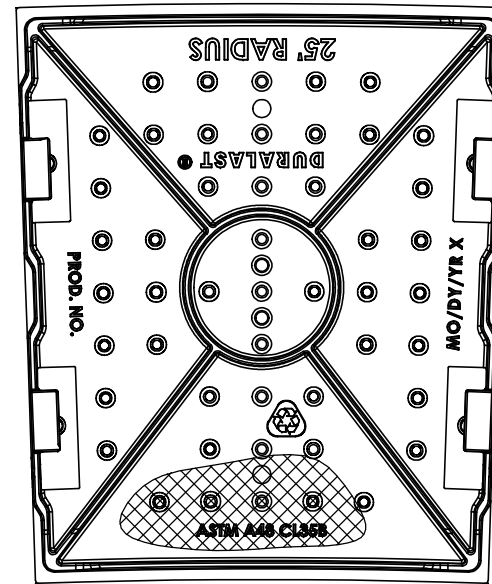

**BOTTOM VIEW**

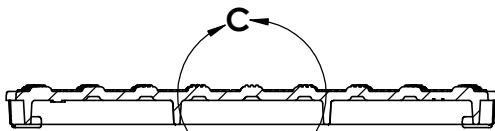

**SECTION A-A**

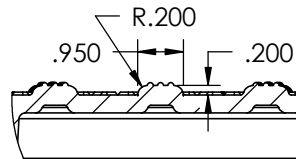

**DETAIL C  
SCALE 1 : 4**

**Product Number**

00700625

**Design Features**

- Materials  
Gray Iron (CL35B)
- Design Load  
Non-Traffic
- Open Area  
n/a
- Coating  
Undipped
- √ Designates Machined Surface
- Slip Resistant Surface  
with the LLLL® registered trademark

**Certification**

- ASTM A48
- 
- Country of Origin: USA

**Drawing Revision**

- 2/3/2010 Designer: DEW
- 7/30/2013 Revised By: DAE

**Disclaimer**

Weights (lbs/kg), dimensions (inches/mm) and drawings provided for your guidance. We reserve the right to modify specifications without prior notice.

CONFIDENTIAL: This drawing is the property of EJ Group, Inc. and embodies confidential information, registered marks, patents, trade secret information, and/or know how that is the property of EJ Group, Inc. Copyright © 2011 EJ Group, Inc. All rights reserved.

**Contact**

800 626 4653  
ejco.com



# DURALAST Detectable Warning Plate



**NOTE: TAKES (25) COVERS TO COMPLETE FULL 90 ° TURN**

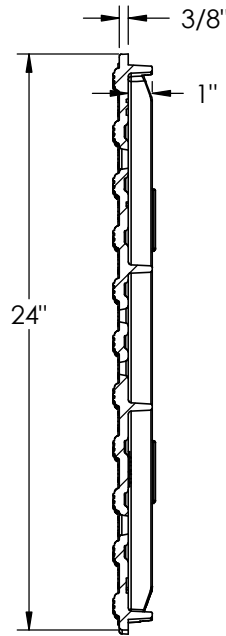
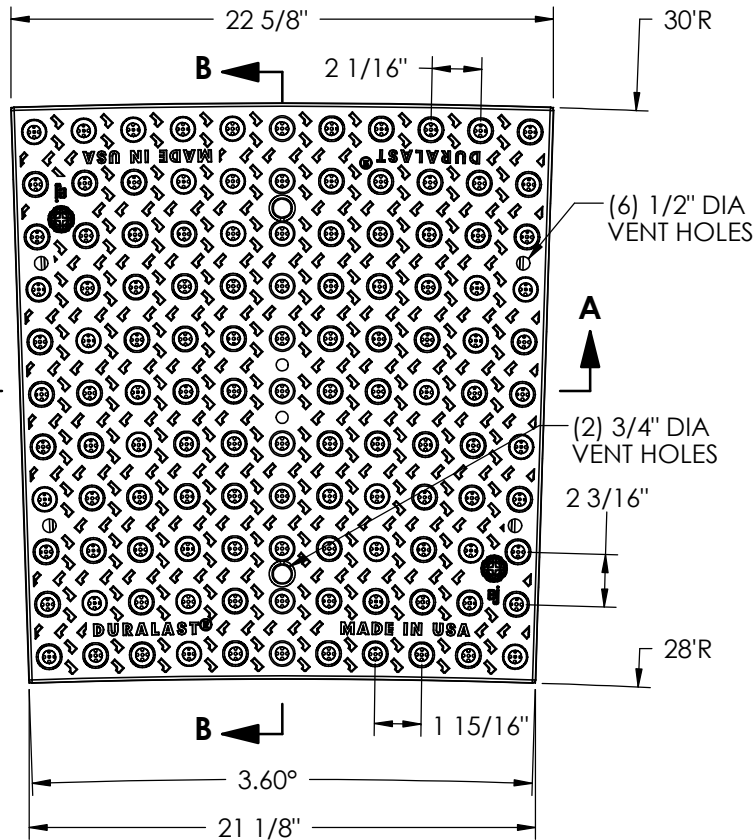

**SECTION B-B**

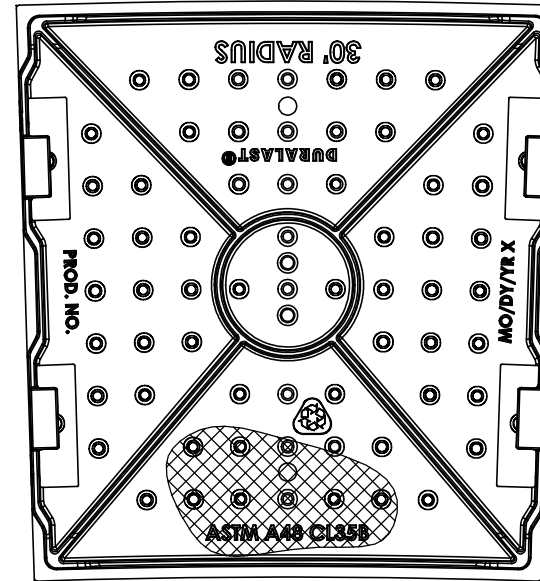

**BOTTOM VIEW**

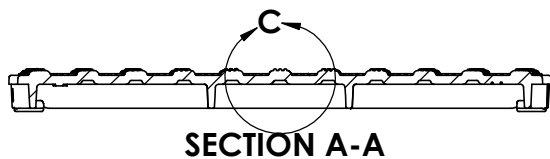

**SECTION A-A**

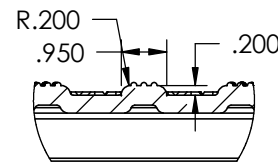

**DETAIL C  
SCALE 1 : 4**

**Product Number**

00700631

**Design Features**

- Materials  
Gray Iron (CL35B)
- Design Load  
Non-Traffic
- Open Area  
n/a
- Coating  
Undipped
- √ Designates Machined Surface
- Slip Resistant Surface  
with the LLLL® registered trademark

**Certification**

- ASTM A48
- 
- Country of Origin: USA

**Drawing Revision**

2/3/2010 Designer: DEW  
7/31/2013 Revised By: DAE

**Disclaimer**

Weights (lbs/kg), dimensions (inches/mm) and drawings provided for your guidance. We reserve the right to modify specifications without prior notice.

CONFIDENTIAL: This drawing is the property of EJ Group, Inc. and embodies confidential information, registered marks, patents, trade secret information, and/or know how that is the property of EJ Group, Inc. Copyright © 2011 EJ Group, Inc. All rights reserved.

**Contact**

800 626 4653  
ejco.com

# DURALAST Detectable Warning Plate



**NOTE: TAKES (30) COVERS TO COMPLETE FULL 90 ° TURN**

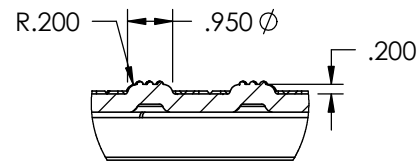
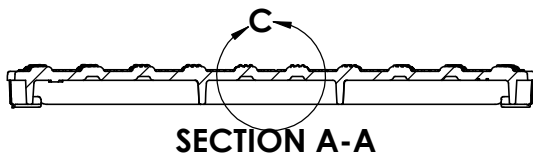
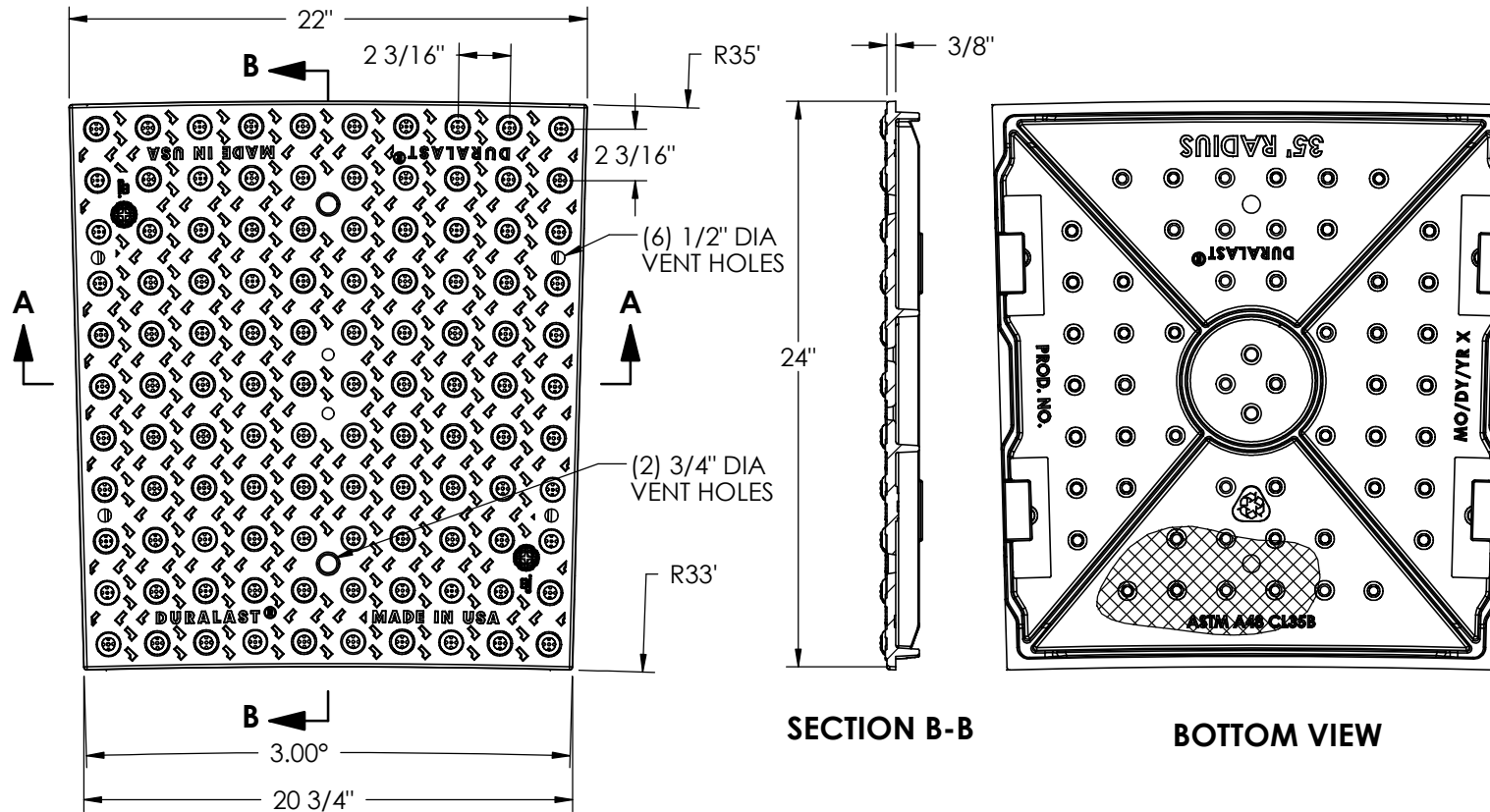

**DETAIL C  
SCALE 1 : 4**

## Product Number

00700635

## Design Features

- Materials  
Gray Iron (CL35B)
- Design Load  
Non-Traffic
- Open Area  
n/a
- Coating  
Undipped
- √ Designates Machined Surface
- Slip Resistant Surface  
with the LLLL® registered trademark

## Certification

- ASTM A48
- 
- Country of Origin: USA

## Drawing Revision

2/3/2010 Designer: DEW  
7/30/2013 Revised By: DAE

## Disclaimer

Weights (lbs/kg), dimensions (inches/mm) and drawings provided for your guidance. We reserve the right to modify specifications without prior notice.

CONFIDENTIAL: This drawing is the property of EJ Group, Inc. and embodies confidential information, registered marks, patents, trade secret information, and/or know how that is the property of EJ Group, Inc. Copyright © 2011 EJ Group, Inc. All rights reserved.

## Contact

800 626 4653  
ejco.com