

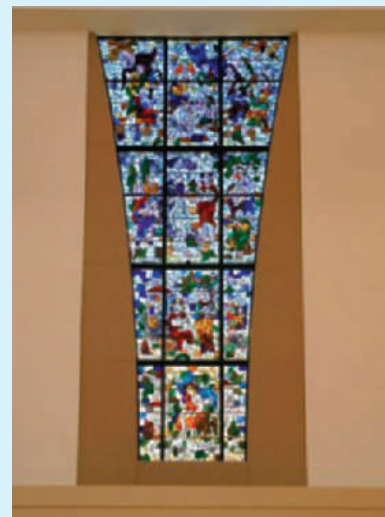

**America's Finest Custom Aluminum Windows for Churches, Chapels, Synagogues, Memorial Buildings, Schools, Hotels, Office Buildings, Libraries, Restaurants, etc.**

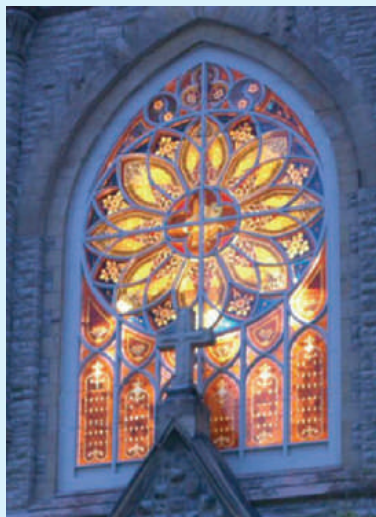

[www.jsussmaninc.com](http://www.jsussmaninc.com)



**J. SUSSMAN, INC.**

Since 1906

MANUFACTURERS OF AMERICA'S FINEST ARCHITECTURAL METAL PRODUCTS AND SERVICES

**Cover Photos:**

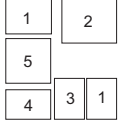

**1. St. Thomas Moore Church  
St John's University, Queens NY**  
Rohlf's Stained Glass, Mt. Vernon NY  
Architect: Martin A. DeSapio, AIA  
Photo: Taylor Photo

**2. St Martin's Episcopal Church  
Houston TX**  
Willet Hauser Architectural Glass, Winona MN  
Glazing Contractor: Admiral Glass, Houston TX  
Jackson & Ryan Architects, Houston TX

**3. St Lawrence Church  
Cincinnati OH**  
Harmon Inc., Cincinnati OH  
Thomas Gormley  
GBBN Architects, Cincinnati, OH 45202  
BeauVerre/Riordan Studios, Middletown OH  
Photo courtesy of The Catholic Telegraph

**4. Foster Family Chapel at  
Congregation Beth Israel, San Diego CA**  
Discount Glass, San Diego CA  
Austin Veum Robbins Parshalle, Architects  
Photos: Stuart Simmons

**5. Southwestern Baptist Theological  
Seminary Convention Center, Ft. Worth TX**  
Foster Stained Glass, Bryan TX

**J. Sussman, Inc.** windows can be produced in virtually any shape or size, with or without thermal breaks and with true muntins. They can be configured with combinations of fixed, projected and casements. Our 300 Series is even available with the historical church window standard, the Horizontally Center Pivoted ventilator.

**J. Sussman, Inc.** has the largest selection of systems specifically designed for church windows providing the best product in the right price range to suit every budget.

With an ever-increasing emphasis on color and aesthetics in the construction industry, **J. Sussman, Inc.** has developed two new window systems to help meet this demand. **J. Sussman, Inc.** now has the in house ability to produce windows with different colors and finishes to the exterior and interior. This is done with the use of *Thermal Strip® technology*. Two different aluminum extrusions can be finished independent of each other and then joined together with two 6/6 polyamide nylon thermal strips. Besides being thermally efficient, these high strength strips have the same coefficient of expansion as aluminum so that dry shrinkage is eliminated and the structural integrity of the window is intact. The result is a stronger thermally improved window with capability of different colors and finishes inside and out.



**Yeshiva of Spring Valley, Spring Valley NY**  
Glazing Contractor: Ailamos, Bronx NY

**Triple Glazed Thermal Church Windows for Stained and Insulated Protective Glass**

**6400 Series - 3 1/2" Deep (replaces 5600 Series)**

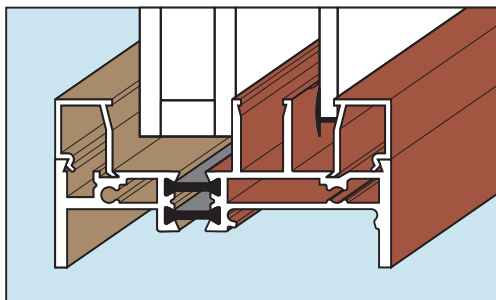
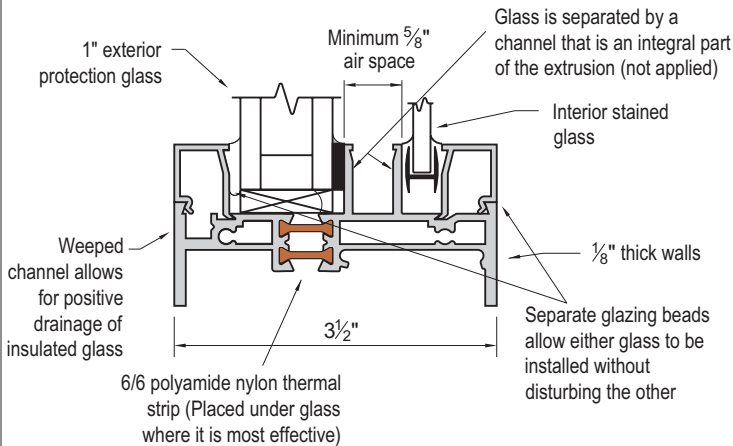

Our in-house Thermal Strip system gives us Dual Color finishing capability. (Interior/ Exterior)

- Main frame and sash members are a full 3 1/2" deep with double tubular ventilators, frame, muntins and meeting rails.
- Triple glazed thermal barrier design that can accommodate 1" protective insulated glass with another 5/8" airspace between the art glass insulates the cold outside temperatures from the warmer inside temperature and helps eliminate condensation and noise infiltration. Insurance costs can be substantially lower as a result.
- The separation of art and protective glass is achieved by a channel that is an integral part of the extrusion. (Not an add on piece.) This channel acts as a condensation gutter and helps prevent air and water infiltration.
- Separate glazing beads allow either glass to be installed without disturbing the other. Protective glass can be installed at time of erection and art glass can be installed at the owner's convenience. (Stained glass can be an excellent fund raiser)
- Ventilators have 3 rows of continuous weatherstripping.
- Windows can also accommodate interior faceted glass and an exterior protective glass or 1/4" protective glass and stained glass.
- **Special Feature:** Large sections of insulated glass can be installed on the exterior and for the art glass special narrow sideline muntins can be placed in the interior of the frame in virtually any shape or size to suit the design and help keep costs down. (These interior muntins can also be installed at a later date to fit the design.)



**J. SUSSMAN, INC.**

**2** Since 1906

See us on the internet [www.jsussmaninc.com](http://www.jsussmaninc.com)



## Double Glazed Custom Church Windows for Stained and Protective Glass

### 300 Series - 2 1/2" Deep

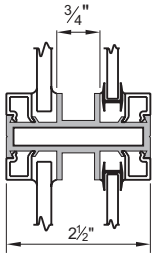

- 2 1/2" Deep
- Designed to receive protection glass on the exterior and art glass on the interior with a minimum 3/4" air space in between.
- Either glass can be installed or replaced without disturbing the other.
- Glass is separated by a channel that is an integral part of the extrusion and also acts as a condensation gutter.
- Narrow sightlines to maximize the exposure of art glass.

## Dual Color Thermal Windows 4200 Series - 2 1/2" Deep

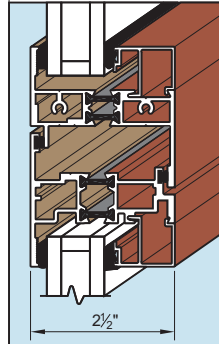

- Full 2 1/2" deep frame with double tubular sash, muntins and intermediate rails. (Consult factory for full specifications)
- Thermal Strip technology for added strength and Dual Color finishing capability. (Interior/Exterior)
- All corners are fastened on each side of the thermal break. Sash corners are mitered, heavy angle reinforced and hydraulically crimped and epoxy welded.
- Flush design eliminates dust shelves and water traps and helps create a clean, neat appearance.

## Monumental Custom Thermal Windows 3600 Series - 2 1/4" Deep

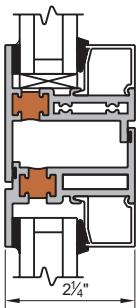

- Full 2 1/4" deep frame with 1/8" walls and tubular sash will meet and/or exceed AAMA HC-65 and GS-001 monumental performance specifications.
- One piece extrusion with poured in place structural polyurethane thermal barrier placed closest to exterior will insulate best and help eliminate condensation.
- All muntins and intermediate rails are tubular.
- Flush design eliminates dust shelves and water traps and helps create a clean, neat appearance.

## Custom Thermal Windows 3200 Series - 2 1/4" Deep

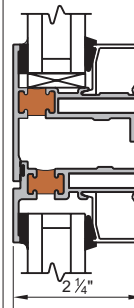

- Full 2 1/4" deep frame with tubular sash will meet and/or exceed AAMA HC-65 and GS-001 monumental performance specifications.
- Metal strategically placed to give maximum strength.
- One piece extrusion with poured in place structural polyurethane thermal barrier placed closest to exterior will insulate best and help eliminate condensation.
- All muntins and intermediate rails are tubular.
- Flush design eliminates dust shelves and water traps and helps create a clean, neat appearance.

## Monumental Non-Thermal Windows 2400 Series - 2" Deep

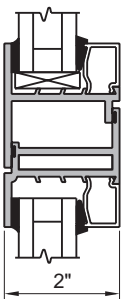

- Full 2" deep frame with 1/8" walls and tubular sash will meet and/or exceed AAMA HC-65 and GS-001 monumental performance specifications.
- All corners are either fully welded or heavy angle reinforced, epoxy welded and hydraulically crimped.
- Flush design eliminates dust shelves and water traps and helps create a clean, neat appearance.
- Windows can accept up to 1" thick insulated glass or slab glass (dalle de verre).

## Non-Thermal Custom Windows 200X Series - 1 5/8" Deep

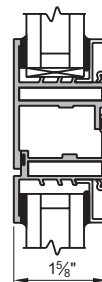

- Full 1 5/8" deep frame with tubular sash will meet and/or exceed AAMA C-50 commercial performance specifications.
- Metal strategically placed to give maximum strength.
- All muntins and intermediate rails are tubular.
- Flush design eliminates dust shelves and helps create a clean, neat appearance.

## Thermal Terrace Doors 4800 Series

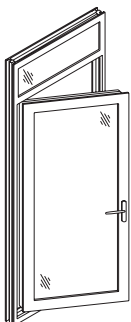

- Full 2 1/2" deep tubular frame and door sash
- Thermal Strip technology for added strength and Dual Color finishing capability. (Interior/Exterior)
- Door corners are mitered, heavy angle reinforced, epoxy welded and hydraulically crimped.
- Flush design eliminates dust shelves and helps create a clean, neat appearance.
- Multi-point locking system with three way adjustable hinges.

J. Sussman, Inc.'s other services and products include **Custom Glass and Metal Bending, Skylights, Walkways, and Sunbilt Sunrooms.**

For more information see us on the internet at [www.jsussmaninc.com](http://www.jsussmaninc.com)



Immaculate Heart of Mary Catholic Church  
Grand Junction, CO  
Bratton Window and Door, Grand Junction CO  
Slater-Paul & Associates, Denver, CO



**J. SUSSMAN, INC.**

Since 1906

# Installations

J. Sussman, Inc. manufactures windows for renovation work in standard as well as landmark buildings. In addition, from St. Patrick's Cathedral in New York City to The Most Holy Mother of God Parish in Vladivostock, Russia there are many thousands of specialized Sussman church windows installed throughout the world. The following is a partial list of recent installations. For further assistance Call, Write, Fax or E-mail us.



**Madison St. United Methodist Church, Clarksville, TN**  
Wall Bros. Glass, Inc., Clarksville, TN  
Architect: Everton, Oglesby, Askew Architects

**First United Methodist Church, Fort Payne, AL**  
Groat Construction Company, Inc., Fort Payne, AL  
Architect: Alan L. Williamson

**Saint Kathryn's Church, Hudson, NH**  
Saint Michel Liturgical Arts, Inc., Norwood, MA  
Architect: Keefe Associates, Inc. Architects

**Beth Shalom Congregation, Rockville, MD**  
Rure Associates, Middlesex, NJ  
Architect: Levin/Brown and Associates Inc.

**St. Augustine Church, Barberton OH**  
Conrad Schmitt Studios, New Berlin, WI  
Architect: Zita Smith

**Family Court, Philadelphia PA** Keystone  
Aluminum and Glass Co., Pennel, PA  
Architect: Murphy Quigley Co., Inc

**St. Boniface Church, Lidgerwood, ND**  
Glass Unlimited Inc., Fargo, ND  
Architect: Curtis Construction

**Mary Queen of the Universe Shrine, Orlando, FL**  
Rogers, Lovelock and Fritz, Inc., Winter Park, FL  
Architect: Jack Rogers of R.L.F. Architects Inc.

**St. Thomas Moore Church St.**  
John's University, Queens NY  
Rohlf's Stained Glass  
Architect: Martin A. DeSapio, AIA

**Our Lady of Sorrows C.C., Victoria, TX**  
Mitchell Glass Co., Victoria, TX  
Architect: Rawley McCoy and Associates

**Grace Lutheran Church, New Orleans, LA**  
City Glass and Mirror Co., New Orleans, LA  
Architect: The Mathes Group

**St. Gregory the Great, Seward, NE**  
Builders Inc., Lincoln, NE  
Architect: Sinclair Hille and Associates Inc.

**Sam Nunn Federal Center, Atlanta, GA**  
Quaking Aspen Stained Glass, Porter, ME

**Ascension of Our Lord Catholic Church, Laplace, LA**  
Southern Wall and Windows, New Orleans, LA  
Architect: Blich/Knevel Architects

**Cathedral of the Madeline, Salt Lake City, UT**  
Intermountain Glass, Salt Lake City, UT  
Architect: Beyer, Blinder, Belle

**Episcopal Church of the Nativity, Dothan, AL**  
Dothan Glass Company, Dothan, AL  
Architect: Barganier, Davis, Sims

**St. Ann's Parish Church, Kaneohe, HI**  
Fuller Glass Co., Inc., Honolulu, HI  
Architect: Matsushita and Associates

**St. Bridget of Ireland, Berryville, VA**  
Roy's Glass Service, Inc., Kearneysville, WV  
Architect: Balzer and Associates

**White's Chapel United Methodist Church, Southlake, TX**  
DGB Glass Inc., Aledo, TX  
Architect: Hesson Andrews Sotomeyer Sprinkle/Robey

**The Salvation Army, Brooklyn Park, MN**  
United Glass Inc., Roseville, MN  
Architect: Timothy O'Brien and Associates Architects

**St. Mary's Church, Huntley, IL**  
Century Art Glass Co., St. Louis, MO  
Architect: Charles E. Pease



**St. Martin's Episcopal Church, Houston, TX**  
Admiral Glass, Houston, TX  
Willett Hauser Architectural Glass, Winona MN  
Architect: Jackson and Ryan Architects

**New Chapel for Dominican Sisters, Fair Lawn, NJ**  
Midway Glass and Metal Installers, Inc., Fair Lawn, NJ  
Architect: Martin Holub Architects and Planners

**Immaculate Conception Parish, Pittsburgh, PA**  
Hunt Studios, Pittsburgh, PA  
Architect: Belli & Belli

**St. Thomas Moore Church, Lake Ariel, PA**  
Mesko Glass Co., East Stroudsburg, PA  
Architect: V.S.Riggi A.I.A.

**Ward Presbyterian Church, Northville, MI**  
Huron Valley Glass, Ypsilanti, MI  
Architect: Lindhout Associates A.I.A. P.C.

**St. Thomas A. Becket Church, Eugene, OR**  
Beyer Stained Glass, Philadelphia, PA

**Congregation Beth Israel, San Diego, CA**  
Discount Glass & Mirror, San Diego, CA  
Architect: Austin Veum Robbins Parshalle

**Catholic Church of Christ The King, Singapore**  
Derix Art Glass, Oakland, CA  
Designer: John Calligan

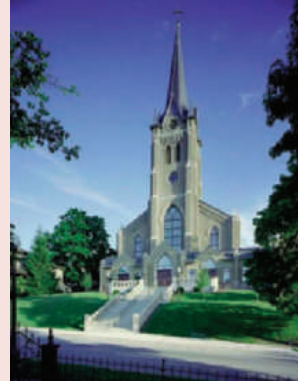

**The Cathedral of St. Mary, Lafayette, IN**  
Kaleidoscope Stained Glass, Inc., Lafayette, IN  
Architect: Scholer Corporation

**St. Elizabeth Annseton Chapel, Whiting, NJ**  
Hiemer & Co., Clifton, NJ  
Architect: Mloy, Duffe, and Foran

**Holy Family Catholic Church, Port St. Lucie, FL**  
Chauncey's Glass Co., Fort Pierce, FL  
Architect: Moreu and Associates P.A.

**St. Joseph's Church, Marksville, LA**  
Mobile Glass Service, Inc., Marksville, LA  
Architect: Weimer and Boudreaux Architects

**St. Killian's Parish, Farmingdale, NY**  
Durhan Studios, West Hempstead, NY  
Architect: Ira Haspel, Architects, P.C.

**Seventh Day Adventist Church, Berrien Springs, MI**  
Midwest Glass & Mirror, Stevensville, MI  
Architect: Helard and Helard Architects

**United Methodist Church, Genera, IL**  
Franklin Glass, Glendale Heights, IL  
Architect: Cone-Kalb-Wonderlick

**Upton Baptist Church, Upton, KY**  
Peter K. Eichorn Stained Glass, Louisville, KY  
Architect: George Torello

**All Saint's Church, Knoxville, TN**  
Holston Glass Co., Kingsport, TN  
Architect: G.C. Blaine Construction

**St. Catherine's House, Charleston, MA**  
Burnham and Laroche Associates, Medford, MA  
Architect: Kevin M. Bryan

**St. Joseph Parish, Cottleville, MO**  
Missouri Valley Glass Co., St. Charles, MO  
Architect: LePique and Orne Architects

**Mid City Church, Midland, TX**  
Foster Stained Glass, Bryan, TX  
Architect: Heath Aikan

**First United Methodist Church, Oklahoma City, OK**  
Karen Hendrix and Associates, Oklahoma City, OK

**Lake Magdalene United Methodist Church, Tampa, FL**  
Precise Construction, Inc., Tampa, FL  
Architect: R.B.K. Architect Inc.

[www.jsussmaninc.com](http://www.jsussmaninc.com)

*and thousands more. . .*

MANUFACTURERS OF AMERICA'S

FINEST ARCHITECTURAL METAL PRODUCTS AND SERVICES

# J. SUSSMAN, INC.

Since 1906

109-10 180th Street, Jamaica, New York 11433

Tel: 718-297-0228

Fax: 718-297-3090