

# CavClear® CavClear® Masonry Mat Installation Directions

Take it to the top.

**Storage: CavClear® products must be properly stored off ground in a clean, dry, sheltered area until used.**

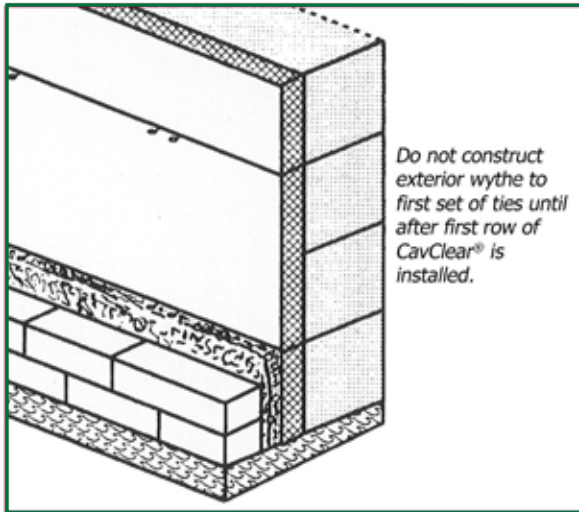

## Step 1 - Flashing Level

1. Install first one or two courses of exterior wythe. Allow mortar to set and cure as required.
2. Remove mortar and debris from cavity spaces, wall ties, flashings and reinforcing.
3. Remove all mortar droppings and protrusions from face of concrete masonry to ensure direct and flush contact between backup and insulation (if applicable).
4. Place 16"x96" sheets of CavClear® Masonry Mat at flashing level or cut to fit first row of ties.
5. IMPORTANT - If airspace width permits, place two sheets of masonry mat at flashing level. Extend extra mat at least to top of base flashing or first course of masonry ties.
6. IMPORTANT - Completely fill all joints with proper amount of mortar in accordance with specifications.

**For information regarding installation of CavClear® products, call 888-436-2620.**

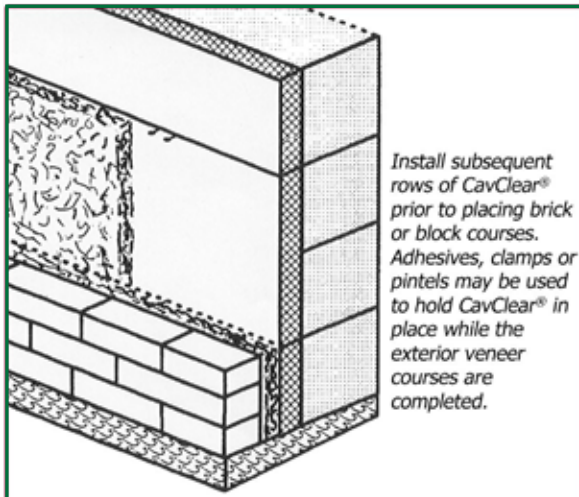

## Step 2 - Additional Courses

1. Prior to construction of subsequent courses, place 16"x96" sheets of CavClear® Masonry Mat between wall ties.
2. If using adjustable masonry reinforcing, install tab ties or pintel ties temporarily to secure mat. With other types of ladder reinforcing, temporarily secure masonry mat with adhesive, clamps, tie wire or other similar means and methods. Any adhesive used must be compatible with substrate. Do not staple, nail or otherwise compress in order to secure masonry mat to insulation or interior wythe.
3. Stagger end joints in adjacent rows. Tightly butt adjacent pieces. Do not allow gaps or voids where mortar can accumulate.
4. IMPORTANT - If airspace width permits, use multiple layers above all through-wall flashings. Extend extra masonry mat to top of flashing.
5. Where airspace between CavClear® Masonry Mat and brick facade is greater than 3/8", use multiple layers of masonry mat in accordance with project specifications.
6. CavClear® performs properly when installed continuously throughout full-height of airspace.
7. Repeat this process until brickwork is completed. Do not install more CavClear® Masonry Mat than can be covered by brick in same day.

## CavClear® Products...Ideal For All Masonry Drainage Walls.

### Limited Warranty

All products presented herein are warranted to the Buyer to be free from defects relating to manufacturing for a period of 5 years after the date of purchase. The foregoing warranty is non-assignable and is in lieu of any other warranty, expressed or implied, including but not limited to any implied warranty of merchantability, or fitness for a particular purpose. This warranty shall not extend to storage, handling, installation, workmanship, accessory materials or conditions of application or the performance or results of an installation containing the product. The buyer's sole and exclusive remedy against Archovations, Inc. shall be for the replacement, but not the installation, of defective products. Archovations, Inc. will also deliver replacement products to the location where the defective products were originally delivered. The Buyer agrees that no other remedy (including, but not limited to, incidental or consequential damages for lost profits, lost sales or injury to person or property) shall be available to the Buyer, regardless of the theory of liability upon which any such damages are claimed. This warranty supercedes all prior warranties and representations regarding Archovations, Inc. All details and specifications presented are intended as a general guide for the use of CavClear® brand products. These products should not be used without evaluation by a qualified engineer or architect to determine their suitability for a specific use. Archovations, Inc. assumes no responsibility for failure resulting from use of its details or specifications or for failure resulting from improper application or installation of these products.