

ECO*surfaces*[®]
COMMERCIAL FLOORING

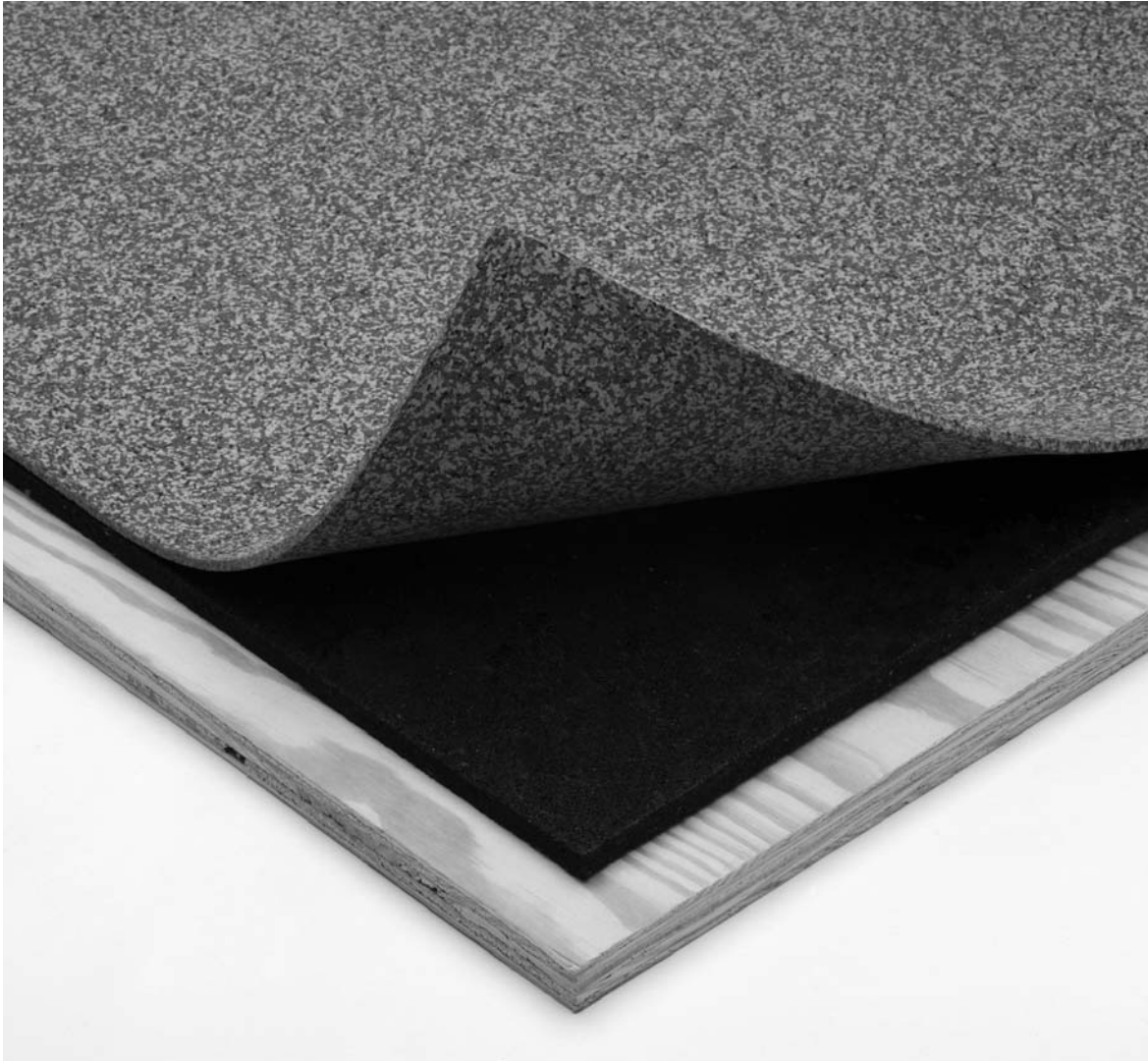

ECOsilence[™]

TECHNICAL MANUAL

Installation • Maintenance • Warranty

TABLE OF CONTENTS

Part I	Required Materials
Part II	Subfloor Preparation
Part III	Placing and Trimming ECOsilence
Part IV	Installing ECOsilence
Part V	Installation of Topping
Part VI	Installation of Baseboard
Part VII	Recommended Materials

The following recommendations for applications and installation are based on our extensive experience and on current technological practice. Our liability and responsibility in the event of damages are limited to the extent defined in our General Terms and Conditions of Business and are not in any way increased by these recommendations or by advice given by our sales representatives or applications engineering staff.

WARRANTY

ECOsurfaces is guaranteed by ECORE International™ to be free of manufacturing defects in both material and workmanship. If such a defect is discovered, the customer must notify ECORE directly or through the contracting installer or distributor. If found to be defective within five years, the sole remedy against the seller will be either the replacement or repair of the defective goods, or at the seller's option, credit may be issued not exceeding the selling price of the defective goods.

The ECOsurfaces warranty shall not cover dissatisfaction due to improper maintenance or installation, damage from improper maintenance or usage or general misuse, including, without limitation, burns, cuts, tears, scratches, scuffs, indentation damage from high heels, rolling loads, damage or discoloration from floor care products not recommended by either Gerbert Ltd. or ECORE, extended exposure to direct sunlight or differences in color between samples or photographs and actual flooring.

PART I – REQUIRED MATERIALS

GENERAL: ECOsilence™ Underlayments can be installed under most types of grouted and non-grouted flooring installations including ceramic tile, stone, marble, brick, pavers, hardwood, wood, engineered laminate, parquet, vinyl and carpet.

A. ECOsilence™ Impact Sound Insulation Material (underlayment)

B. ECOsilence™ Perimeter Isolation Strip

C. Duct tape

D. Carpet or utility knife

NOTE: When using grouted flooring materials, such as ceramic tile, paver, brick, marble and stone, adhesive is also required.

E. Materials for Glue-Down Method:

1. A urethane adhesive. Select from approved adhesives listed in Part VII.
2. Trowel or brush, as required by adhesive manufacturer.
3. 50-75 lb. roller

F. Materials for Thin-Set Method:

1. Thin-set mortars. Select from list in Part VII.
2. Trowel, as required by mortar manufacturer.
3. 100 lb. roller

PART II – SUBFLOOR PREPARATION

GENERAL: ECOsilence™ Impact Sound Insulation can be installed under most types of grouted and non-grouted flooring installations including ceramic tile, stone, marble, brick, pavers, hardwood, engineered wood, laminate, parquet, vinyl and carpet. ECOsilence™ may be installed over wood, concrete and masonry-type surfaces.

A. Wood Subfloors

1. Wood subfloors must be a minimum 1" thick double construction. Qualify deflection according to ANSI standards, as required by the finish floor manufacturer.

B. Concrete Floors

1. Slabs must be covered and wet-cured for a minimum of 28 days prior to the installation of ECOsilence.
2. Areas that are to receive finished flooring, installed by the thin-set method, must have a wood-float finish -- true to within 1/8" (3 mm) in 10' (3 m) and pitched toward drains where required.

3. Any concrete subfloor can be a source of moisture related flooring failures. It is the installer's responsibility to test the concrete for moisture.

4. Areas requiring fill, patching or leveling must be prepared by the general contractor using a self-leveling underlayment or a skim coat and patching compound in accordance with the manufacturer's instructions.

- C. Subfloors should be dry, clean, smooth, level and structurally sound. Subfloors must be free of dust, oil, solvent, paint, wax, oil, grease, asphalt, sealers, curing and hardening compounds, alkaline salts, old adhesive, residue and other extraneous materials according to ASTM F710.

- D. If a vapor barrier is required, specify any of the following products:

1. ARDEX MC
2. DURABOND D250-D261
3. SIKA MB

PART III – PLACING AND TRIMMING ECOSILENCE

GENERAL: ECOSilence™ Impact Sound Insulation can be installed under most types of grouted and non-grouted flooring installations including ceramic tile, stone, marble, brick, pavers, hardwood, engineered wood, laminate, parquet, vinyl and carpet.



It is essential to install the ECOSilence Perimeter Isolation Strip prior to placing and trimming ECOSilence Impact Sound Insulation Material! Do not install baseboard until finished topping is installed.

- E. Lay the ECOSilence material perpendicular to the subsequent installation direction of the topping material (see diagram #2).

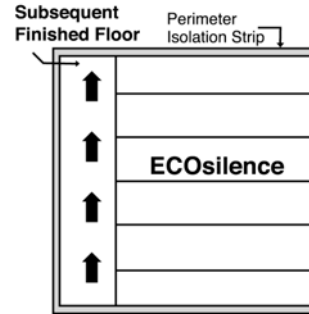

Diagram #2

- A. Glue the ECOSilence Perimeter Isolation Strip to the wall perimeter of the entire subfloor, as well as around the perimeter of any protrusions, in order to isolate or break the vibration transmission path between the floor and the wall (see diagram #1).

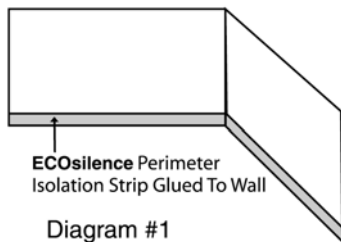

Diagram #1

- F. The ends of each section may be trimmed as necessary in order to fit the surface area to be covered. Trim section ends to exact dimensions required (e.g. joints with walls, etc.).
- G. Maintain the required ambient conditions for adhesive application and bonding.

- B. Fasten the ECOSilence Perimeter Isolation Strip in place with tape or spot gluing. The PIS will later be trimmed flush with the new top layer of finished flooring.
- C. Make the assumption that the walls you are butting up against are not square. Using a chalk line, create a starting point for an edge of the material to follow.
- D. Remove the shrink-wrap from the roll of ECOSilence and unroll it onto the floor. Lay the material in such a way that you will use your cuts efficiently. Cut each roll to the required length.

PART IV – INSTALLING ECOSILENCE

GENERAL: ECOSilence™ Impact Sound Insulation can be installed under most types of grouted and non-grouted flooring installations including ceramic tile, stone, marble, brick, pavers, hardwood, engineered wood, laminate, parquet, vinyl and carpet.

A. Method #1: Glue Down

NOTE: Full glue-down of ECOSilence is required for all types of finished flooring materials unless the floor is considered to be floating.

1. Roll out a section of ECOSilence and fold the material back halfway.
2. Depending on the type of adhesive used, choose a suitable applicator (see Part I) and apply the adhesive evenly over the substrate.
3. Lay the ECOSilence into the wet adhesive. **Do not** allow the material to “flop” into place. This may cause air entrapment.
4. Immediately roll the floor using a 50-75 lb. roller to ensure proper adhesive transfer. Overlap each roll of the roller 50% of the previous pass. Roll the width first, then the length.
5. Fold the second half of the roll back over the first half of the material. Spread the adhesive at right angles to the seams in order to prevent the adhesive from oozing up through the seam.
6. Make sure the lengthwise edge of the material is aligned exactly with that of the neighboring section. Edges must contact but not overlap (see diagram 3).

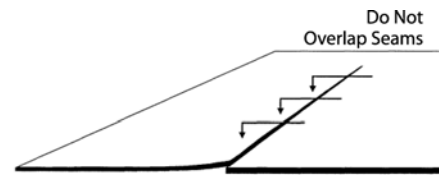

Diagram #3

7. Repeat procedure for the next section of ECOSilence.
8. Fix problem areas (e.g. over stairs, contours and edges) in place using adhesive.

B. Method #2: Thin-Set Polymer Modified Mortar (Alternative to Method #1)

1. Apply specified mortar (see Part VII) as directed.
2. Apply only enough mortar as can be covered with ECOSilence within a 20-30 minute time period.
3. Roll ECOSilence into place. Once set, use a 100 lb. roller to set ECOSilence in place.

C. Method #3: Tape Down

NOTE: Glue or thin-set fixing of the ECOSilence is not required but is recommended for non-grouted, floating flooring material installations.

1. Dry lay the rolls onto the subfloor using the Placing and Trimming Method described in Part III.
2. Use duct tape or a high-quality carpet tape to secure the butt joints and seams.

PART V – INSTALLATION OF TOPPING

GENERAL: ECOsilence™ Impact Sound Insulation can be installed under most types of grouted and non-grouted flooring installations including ceramic tile, stone, marble, brick, pavers, hardwood, engineered wood, laminate, parquet, vinyl and carpet.

A. Plywood / Cement board

1. The plywood or cement board should be glued down using an approved adhesive or thin-set (see Part VII for list of adhesives).
2. Apply adhesive to or thin-set to the ECOsilence using the manufacturer's recommended trowel size.

NOTE: Do not mechanically fasten the boards to the ECOsilence using nails or staples. Any hard connection may transmit vibration and, therefore, sound through to the building structure compromising the construction.

B. Vinyl

When installing vinyl or linoleum directly over ECOsilence, a layer of E-Grip™ II adhesive shall be back troweled onto its surface. This process seals the ECOsilence to prevent any chemical migration.

C. Ceramic Tile or Stone

1. Apply selected mortar (Part VII) over ECOsilence, as directed by mortar manufacturer.
2. Do not spread more mortar than can be covered in a 20-30 minute time period.
3. Tap or beat the tile into place to ensure 90-100% coverage. Remove a tile periodically to check for adequate coverage

D. Wood

1. Place and fix floor covering, carefully observing floor covering manufacturer's instructions.
2. Follow all manufacturers' recommendations and instructions for the adhesive cement.

PART VI – INSTALLATION OF BASEBOARD

GENERAL: ECOsilence™ Impact Sound Insulation can be installed under most types of grouted and non-grouted flooring installations including ceramic tile, stone, marble, brick, pavers, hardwood, engineered wood, laminate, parquet, vinyl and carpet.

NOTE: If a baseboard is required, install the baseboard *after* the finished floor has been installed.

- A. After the finished floor is installed, trim the excess ECOsilence Perimeter Isolation Strip around the entire perimeter of the finished floor (see **diagram #4**).

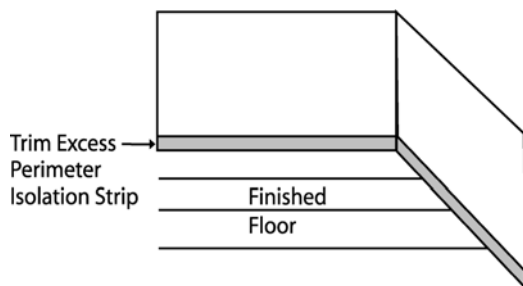
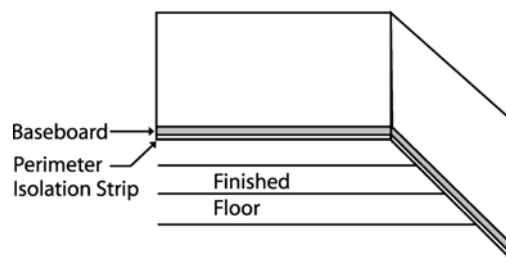

Diagram #4

- B. Nail the baseboard to the wall above the Perimeter Isolation Strip. In order to isolate or break the vibration transmission path between floor and wall, the baseboard must not touch the finished floor (see **diagram #5**).



Do Not Allow Baseboard To Touch Finished Floor

Diagram #5

- C. Seal the entire perimeter with a permanently flexible acoustical caulk.

PART VII – RECOMMENDED MATERIALS

NOTE: All materials shall be delivered to the job site in the original containers with the manufacturer's identification on each package. Unauthorized modification to any product is not permitted. The following materials are listed because of their extensive testing and field experience with ECOsilence products. If you would like us to evaluate any materials as alternatives, please call ECORE Technical Services at (800) 322-1923.

A. Urethane Adhesives

1. E-Grip™ II by ECORE
(800) 322-19232
2. Bostik's Best® by Bostik®
(800) 592-88583
3. DriTac 7500/7600 by DriTac
(800) 394-93104
4. Henry #971
(800) 232-4832

B. Thin-Set Materials

1. ARDEX FB9L
(724) 203-5000
2. ARDEX X701
3. ARDEX X7G Plus

4. ARDEX S16
5. Bostik® Hydroment® Single-Flex™ Mortar
6. TEC™ 1Flex® (800) 832-9002
7. TEC Super Flex™
8. TEC Full Flex®
9. Custom Building Products' VersaBond®
(800) 272-8786
10. Custom Building Products' FlexBond®
11. Custom Building Products'
Masterblend® with CustomFlex™

C. Grout Materials

1. ARDEX Flex Grout
2. TEC 100% Solids Epoxy Grout
3. TEC Accucolor® Premium Grout
4. Custom Building Products' 100% Solid
Epoxy Grout
5. Custom Building Products' PolyBlend®
6. Bostik Hydroment Joint Filler

©2007 All designs and colors are copyrighted by ECORE Intl. ECOsurfaces is a registered trademark of ECORE Intl. E-Grip, ECOunderlayments and ECOsilence are trademarks of ECORE Intl. Bostik, Hydroment and Bostik's Best are registered trademarks of Bostik. Single-Flex is a trademark of Bostik. Custom Building Products, MasterBlend, PolyBlend, VersaBond and FlexBond are registered trademarks of Custom Building Products. CustomFlex is a trademark of Custom Building Products. TEC and Super Flex are trademarks of Specialty Construction Brands. Full Flex, 1Flex and Accucolor are registered trademarks of Specialty Construction Brands. ECOsilence is a licensed patented product.