



BATTEN SEAM BS15

www.dmimetals.com

BS15 PANEL PROFILE:

SMOOTH STANDARD

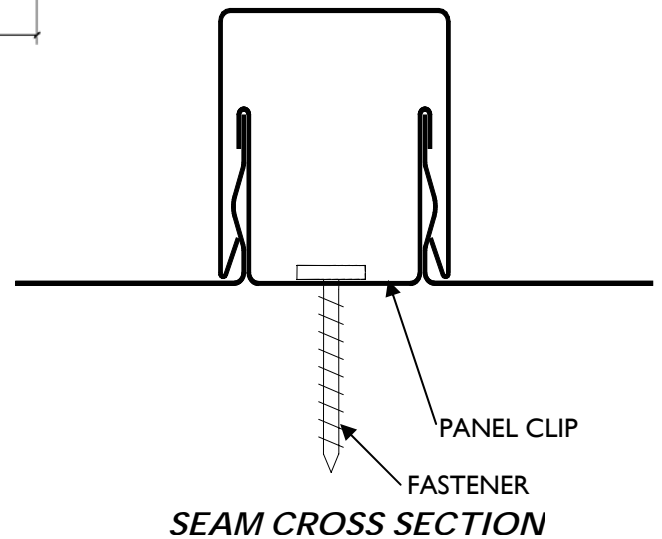

OPTIONAL STIFFENER PATTERNS:

STRIATIONS



HIGH BEAD



LOW BEAD

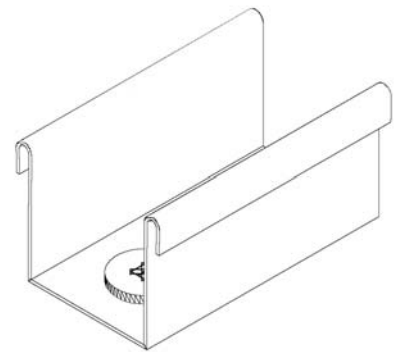

BS15 PANEL CLIP

BATTEN SEAM BS15 (continued)

STANDARD PRODUCT OFFERING

24 ga. Steel and .032 Aluminum:

| <u>MODEL NO.</u> | <u>BATTEN ON-CENTER</u> |
|------------------|-------------------------|
| BS1512 | 12" |
| BS1515 | 15" |
| BS1518 | 18" |
| BS1520 | 20" |

Custom panel widths are available. Consult DMI for costs and lead times.

PRODUCT: BATTEN-SEAM BS15 is an advanced design non-structural snap-on-batten system. The system is designed with two components: the panel pan and the batten cap. BATTEN-SEAM BS15 is a non-directional panel system allowing installers more control during installation over batten layout and symmetry of the panel area.

NOTE: Continuous lengths up to 70'-0" is standard. Lengths over 53' require additional crating fees and special hauling permits. Contact DMI for details.

BATTEN-SEAM BS15 is not available with a watertightness warranty.

.032 aluminum is not stocked in all colors. Minimum order quantities and extended lead times may accompany panel orders when utilizing these substrates

Oil-canning, the slight waviness inherent with light gauge metal, does not affect the finish or structural integrity of the panel and is therefore not cause for rejection

See front for optional stiffener patterns.

ROOF ASSEMBLIES: BATTEN-SEAM requires a solid substrate since it is a non-structural panel system. This system may be installed over plywood sheathing, nail base insulation, or corrugated metal deck.

PRODUCT USES AND APPLICATIONS: Product uses include roofing with roof slopes as low as 3:12, vertical fascia, mansards and equipment screens. This system may be installed on tapered roof areas.

ADVANTAGES:

1. Continuous Interlocking Batten: high batten hold-down strength
2. High Vertical Panel Leg: allows system to be used on lower sloped roof areas
3. Expansion Clips: allows for unlimited thermal expansion and contraction
4. Square Batten Design: an aesthetic design alternate to the SNAP-ON-SEAM
5. Anti-Siphoning Seam Design: prevents water infiltration
6. Continuous Rollformed Lengths: eliminates need for panel lap joints

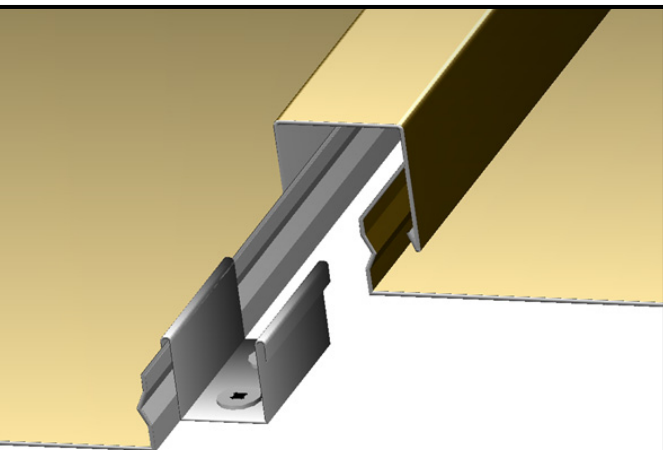

DIMENSIONAL METALS, INC.

DMI has specialized in the manufacturing of Architectural Metal Panel Systems and Fabricated Architectural Sheet Metal for the construction industry for over 17 years. We use the most technologically advanced Fixed Base Roll-Forming Equipment with in house quality control so that we can offer the highest product quality available.

Please contact our Engineering Department today for technical assistance.

Headquarters
58 Klema Drive North
Reynoldsburg, OH 43068
Tel: 800-828-1510
Fax: 740-927-3319

North Carolina
Tel: 800-919-1510

Web: www.dmimetals.com
E-mail: sales@dmimetals.com

