



Parrish Medical Center, Cocoa, FL  
Photography ©Raymond Martinot

> Specify  
Quality

## Entrance & Storefront Systems



Entrances | Storefronts | Curtain Wall | Windows | Sun Controls | Balcony Doors



# YKK AP America — The Company



*YKK AP maintains a state-of-the-art ISO 14001 certified manufacturing facility in Dublin, Georgia.*

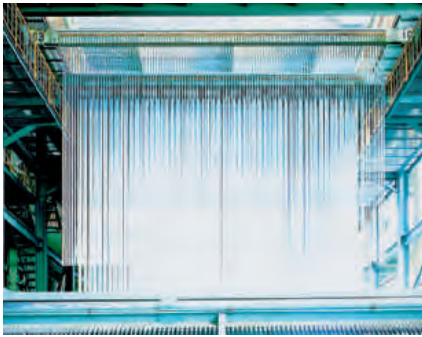

The Architectural Products division of YKK is today a world leader in the manufacture of aluminum building products. YKK AP is committed to producing architectural products of the highest quality and at the lowest possible cost. To this end, YKK AP

has built one of the newest and most technologically advanced manufacturing facilities in the United States in Dublin, Georgia. There, all manufacturing is vertically integrated to ensure control of quality, delivery and cost.

YKK AP America's slogan "Quality inspires™", expresses our belief that quality goes far beyond the products we ship from the plant. Quality is the driver behind every YKK AP product — including every action, every process and every service for every YKK AP customer.

To provide years of dependable use, a new building must have excellence built-in from the beginning. That is why architects, developers and construction engineers are specifying architectural aluminum entrance, storefront, curtain wall, window and balcony door systems from YKK AP.

YKK AP has a long track record of enhancing the exterior envelope of all types of buildings, including office buildings, stadiums, malls, schools, hospitals, hotels, condominiums, and more. Our products ensure users a safe, sustainable and comfortable environment. For example, YKK AP pioneered the introduction of **YKK AP ProTek™** — a unique family of systems that mitigate risks associated with natural and man-made disasters.

As Architects and builders employ "green" design, they are turning to YKK AP for custom-crafted, sustainable building products.

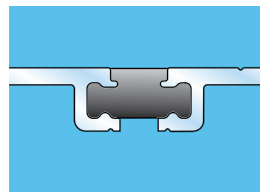

## **ThermoBond Plus®**

(poured and debridged thermal break)

Combining science and technology, YKK AP employs a patented process, ThermoBond Plus, to greatly improve the adhesion of the polyurethane to the aluminum extrusion.

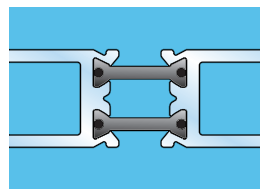

## **MegaTherm®**

YKK AP also offers an integral thermal barrier system that employs the use of 6/6 nylon polyamide glass fiber reinforced pressure extruded bars. This has several advantages over the more commonly used poured and debridged

polyurethane barriers. It will not shrink or degrade over time. It will not crack if penetrated by screws or if weep holes are cut into it. Its lineal expansion is very close to that of aluminum, virtually eliminating creeping, thermal expansion and internal stresses. It also offers greater design versatility by allowing the use of different finish options from interior to exterior surfaces.

## **Anodized Plus®**

YKK AP has the only finish that meets all of the requirements of AAMA 612, the newest standard for anodized finishes. It combines the beauty of anodizing with performance characteristics that resist damage from mortar, alkali and other chemicals. Your building is protected from harsh construction conditions as well as other environmental elements for the lifetime of the building. Anodized Plus is available in clear, dark bronze, medium bronze, black, champagne and white finishes.

In addition, YKK AP offers a variety of painted finishes that are applied at our environmentally friendly Dublin facility which meet or exceed the requirements of AAMA 2603, 2604 and 2605.

For additional information about the full line of quality products and services offered by YKK AP, call 1-800-955-9551 or visit our web site at [www.ykkap.com](http://www.ykkap.com).



*School of the Future, Philadelphia, Pennsylvania*  
 Architect: The Prisco Group  
 Glazing Contractor: US Glass and Metal  
 Systems Used: YCW 750 OG, ThermaShade™, & Model 50D  
 LEED Gold Certified

## Standard Entrance Doors

### Model 20D Narrow Stile Door:

Standard commercial entrance designed for light to medium traffic

### Model 35D Medium Stile Door:

Designed for medium traffic areas, ideally suited for institutional installations

### Model 50D Wide Stile Door:

Designed for medium to high traffic areas, well suited for monumental applications

### Model 40D Heavy Duty Door:

Engineered to handle high abuse traffic areas such as sports arenas, airports, hospitals and schools

- Can be configured to meet ADA guidelines as well as state and local building codes
- Mechanically joined and welded corners come with a lifetime warranty
- VersaJamb®, our unique reinforced tubular door frame, allows for sidelite glazing without shear blocks or exposed fasteners
- Optional mid rails, high bottom rails, muntins, and custom hardware allow for custom entrances
- Accepts 1/4" to 1" glazing
- Standard hardware includes Smart Series push/pulls, and Dor-O-Matic® touch bar exit devices
- YKK AP patented VersaJamb® tubular door frames for added strength

### YES 40/45 FS

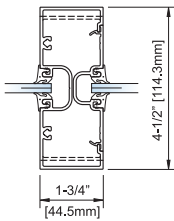

### YES 40/45 FI

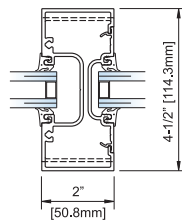

### 20D/35D/50D & VersaJamb® Frame

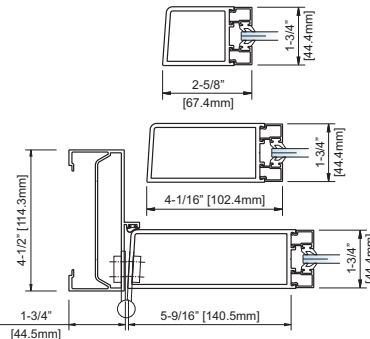

### 40D

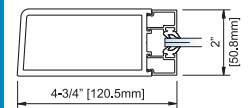

*Arby's #8047, Cottondale, Alabama*  
 Architect: Arie Kohn  
 Glazing Royal Glass & Glazing  
 Systems Used: YCW 750 OG, YES 45 FS, YES 45 TU,  
 & Model 20D



## YES 40 FS/FI & YES 45 FS/FI

### | Center set, storefront framing system for insulating glass.

- YES 40 FS – 1-3/4" x 4" framing
- YES 45 FS – 1-3/4" x 4-1/2" framing
- YES 40 FI – 2" x 4" framing
- YES 45 FI – 2" x 4-1/2" framing
- Flush glazed from the exterior or interior
- YES 40 & 45 FS accept 1/4" to 3/8" glazing
- YES 40 & 45 FI accept 1" insulating glass, as well as other infills
- Glazing gaskets with stretch resistant cord
- YES 45 FS/FI is compatible with YKK AP hinged and flexible mullions
- Integral entrance door frames

## YES 45 TU

**Thermally broken, center set storefront framing system for insulating glass.**

- ThermaBond Plus® thermal break
- Screw spline or shear block assembly
- Standard exterior glazing, with options for interior glazing
- Accepts 1" insulating glass
- 2" x 4-1/2" storefront system
- Integral entrance door frames

## YES 45 FT

**Thermally broken, center set storefront framing system for insulating glass.**

- Screw spline or shear block assembly
- Flush glazed from the exterior
- MegaTherm® thermal break
- Dual interior/exterior finish option
- Accepts 1" insulating glass, as well as other infills of varying thicknesses
- 2-1/4" x 4-1/2" storefront system
- Integral entrance door frames

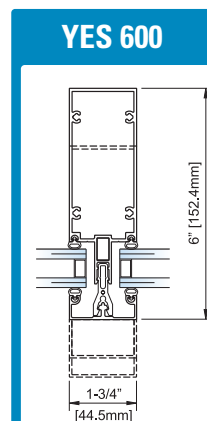
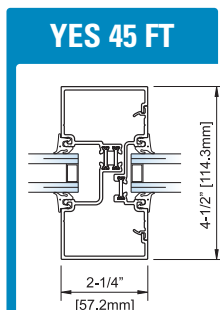
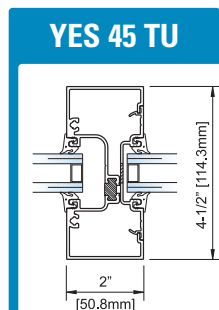

## YES 600

**Thermally broken, front loaded storefront framing system for insulating glass.**

- Screw spline or shear block assembly
- Front loaded glazing
- Thermally broken using a unique nylon clip that locks the exterior and interior members together
- Various snap-on face covers available to meet design requirements
- Dual interior/exterior finish option
- Accepts 1" insulating glass, as well as other infills of varying thicknesses
- Narrow 1-3/4" sightline by 4-1/2" or 6" storefront system
- Integral entrance door frames



*The Shops 600, Phase II, at Abercorn Common  
Savannah, Georgia  
Architect: Ozell Stankus  
Glazing Contractor: Specified Systems, Inc.  
Systems Used: YES 45 TU, & Model 50D doors  
LEED Silver (Core and Shell) Certified*

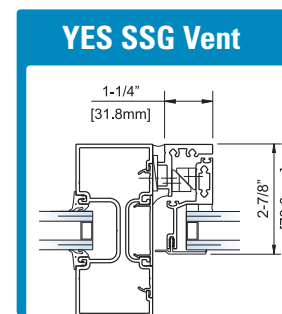

## YES SSG Vent

**Minimal sightline vent for use with storefront framing systems.**

For further information please visit [www.ykkap.com](http://www.ykkap.com), or see our Sweets Window & Balcony Door Systems catalog 08 51 13/YKK Buyline 9372.

*Findlay Market, Cincinnati, Ohio  
Architect: City of Cincinnati Historic Conservation Office  
Glazing Contractor: Harmon Contracting, Inc.  
Systems Used: YES 600 & Model 35D*





*BMW Automotive, Columbus, Ohio*  
 Architect: URS  
 Glazing Contractor: Anderson Aluminum  
 Systems Used: YCW 750, & YWW 45 TU

## YSG 40/50/50 T

**Two-sided, structural silicone glazed ribbon window framing system designed to eliminate the obtrusive sightlines of vertical exterior covers.**

- YSG 40 – 2" x 4-3/16" framing
- YSG 50 – 2" x 4-15/16" framing
- YSG 50 T – 2" x 4-15/16" framing
- Exterior or interior glazing
- MegaTherm® thermal break, dual interior/exterior finish option for YSG 50 T
- YSG 40 accepts 1/4" monolithic glazing
- YSG 50 & 50 T accepts 1" insulating glass, or 1/4" glazing with adapters

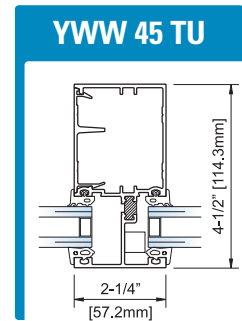
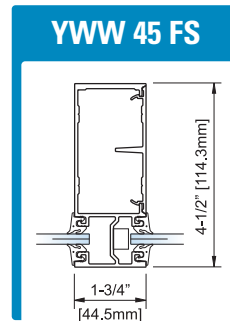

## YWW 45 FS/FI/TU

**Economical, high performance, front loaded window wall system that offers many design options.**

- YWW 45 FS – 1-3/4" x 4-1/2" framing
- YWW 45 FI – 2-1/4" x 4-1/2" framing
- YWW 45 TU – 2-1/4" x 4-1/2" framing
- Exterior or interior glazing
- Thermabond Plus® thermal break for YWW 45 TU
- YWW 45 FS accepts 1/4" monolithic glazing
- YWW 45 FI & TU accepts 1" insulating glass
- Continuous head and sill, or vertical through frame construction
- Optional head and sill anchors allow for ease of installation into punched openings
- Optional two-sided structural silicone glazing at intermediate verticals

*The Vue at Harbor East, Baltimore, Maryland*  
 Architect: Beatty, Harvey & Associates  
 Glazing Contractor: Emmitsburg Glass  
 Systems Used: YCW 750 OG, IG, YWE 60T, YCW 750CV, YES SSG Vent, YSW 400T, YVS 410TU, YSD 600T, & Model 50D



## YWE 40 T/60 T

**Thermally improved, front loaded window wall system designed and engineered to meet the challenges of today's buildings.**

- YWE 40 T – 2" x 4" framing, designed for low-rise applications
- YWE 60 T – 2-1/4" x 6" framing, capable of spanning floor to floor
- Screw spline or shear block assembly
- Interior glazing reduces field labor
- Accepts 1" insulating glass
- Optional head and sill anchors allow for ease of installation into punched openings
- Optional two-sided structural silicone glazing at intermediate verticals

# YKK AP ProTek™ Impact Resistant & Blast Mitigation Systems

## IMPACT RESISTANT SYSTEMS

All YKK AP ProTek™ systems are engineered to create a protective envelope around your building – protecting it from fierce cyclical pressures and projectiles associated with hurricane force winds.

## BLAST MITIGATION SYSTEMS

YKK AP has applied all the knowledge and experience that we gained in leading the development of hurricane impact resistant systems to providing protection for building occupants from man-made disasters. The majority of YKK AP ProTek™ systems meet the requirements of the Unified Facilities Criteria (UFC) and the requirements of the GSA. Several Systems have been fully tested in accordance with ASTM F-1642 to provide proven performance at higher loads without reinforcements.

SYSTEMS <sup>(1)</sup>	Protection Levels		Comments
	ASTM F 1642 <sup>(2)</sup>	GSA-TS01	
<b>Model 35H</b> (wet glazing)	<b>No Break</b>	<b>1</b>	6psi/41 psi-ms
<b>Model 35H</b> (dry glazing)	<b>Low Hazard</b>	<b>3b</b>	6psi/41 psi-ms
<b>YHS 50 TU</b> (wet glazing)	<b>Minimal Hazard</b>	<b>3b</b>	6psi/41 psi-ms
<b>YHS 50 TU</b> (dry glazing)	<b>Low Hazard</b>	<b>3b</b>	6psi/41 psi-ms
<b>YES 45 TU</b> (dry glazing)	<b>Low Hazard</b>	<b>3b</b>	4psi/28 psi-ms
<b>YHS 50 FS</b>	Meets UFC 4-010-01 prescriptive standard in accordance with 2007 revisions	Must be analyzed using dynamic analysis by a blast consultant	
<b>YHS 50 FI</b>			

<sup>(1)</sup>-Contact YKK AP for glazing requirements

<sup>(2)</sup>-Tested in accordance with ASTM F 1642 for compliance with UFC 4-010-01



*Four Seasons, Miami, Florida*  
 Architect: Bermello, Ajamil & Partners  
 Glazing Contractor: N.R. Windows, Inc.  
 Systems Used: YHC 300 OG & Model 35H

## 35H Doors

**Non-shuttered, hurricane impact resistant door for both Large and Small Missile requirements.**

- ASTM E-1886/E-1996, TAS 201, 202, and 203 +70/-90 PSF (Large & Small Missile Impact)
- Miami Dade NOA and Florida state-wide product approval
- Integrates with YHS and YHC systems
- Accepts 9/16" glazing
- Large Missile dry glazing option
- Blast Mitigation Testing – ASTM F 1642
- YKK AP patented VersaJamb® tubular door frames for added strength



### Destruction

*Hurricane Rita's destructive power rolls furiously across the Gulf of Mexico, headed for the helpless Louisiana and Texas coastal areas during the record breaking 2005 hurricane season.*

## 35H Door & VersaJamb® Frame

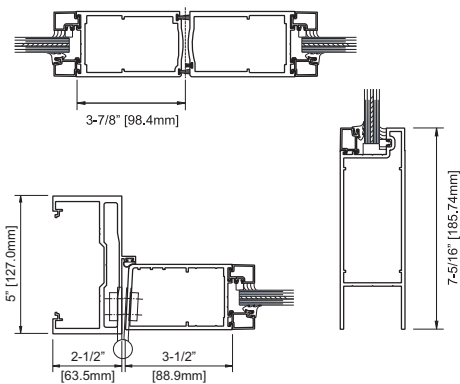

### Detonation

*YHS 50 TU was tested at 6psi/41psi-ms resulting in a GSA level 3-B (Medium Level) of protection.*





*Parrish Medical Center, Cocoa, Florida*

*Architect: RTKL*

*Glazing Contractor: Architectural Aluminum Techniques*

*Systems Used: YHC 300 OG, YHS 50 & Model 35H*

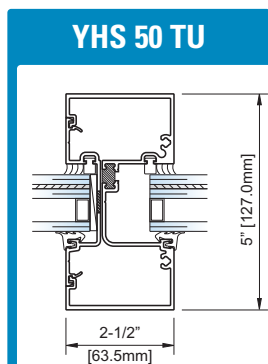
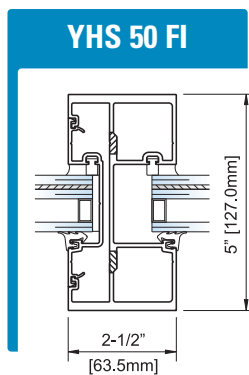

*Miramar Centre III, Miramar, Florida*

*Architect: Tewes Design Group*

*Systems Used: YHS 50 TU & Model 35H*



## YHS 50

**Non-shuttered, center set, flush glazed storefront framing system for monolithic glazing.**

- ASTM E-1886/E-1996, TAS 201, 202, and 203 +70/-90 PSF (Large & Small Missile Impact)
- Miami Dade NOA and Florida state-wide approval
- Accepts 1-5/16" glazing
- Large Missile dry glazing option
- 2-1/2" x 5" storefront system
- Integral entrance door frames
- Blast Mitigation Testing – ASTM F 1642

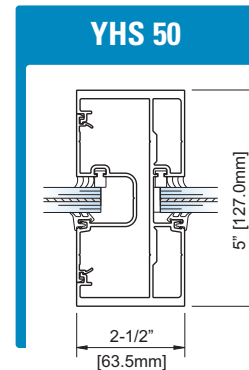

## YHS 50 FI

**Non-shuttered, center set, flush glazed storefront framing system for monolithic & insulating glass.**

- ASTM E-1886/E-1996, TAS 201, 202, and 203 ±70 PSF (Large & Small Missile Impact)
- Miami Dade NOA and Florida state-wide approval
- Accepts 1-5/16" glazing
- Large Missile dry glazing option
- 2-1/2" x 5" storefront system
- Integral entrance door frames

## YHS 50 TU

**Thermally broken, non-shuttered impact resistant storefront framing system for insulating glass.**

- ASTM E-1886/E-1996, TAS 201, 202, and 203 ±70 PSF (Large & Small Missile Impact)
- Miami Dade NOA and Florida state-wide approval
- ThermaBond Plus® thermal break
- Accepts 1-5/16" glazing
- Large Missile dry glazing option
- 2-1/2" x 5" storefront system
- Integral entrance door frames
- Blast Mitigation Testing – ASTM F 1642

# Additional Information

## Service Centers

### Atlanta

5610 Gwaltney Drive  
Atlanta, GA 30336  
Tel: 404-629-3870  
Fax: 404-629-3899

### Boston

Eight Connector Road  
Andover, MA 01810  
Tel: 978-749-9554  
Fax: 978-749-2915

### Baltimore

8680 Greenwood Place  
Savage, MD 20763  
Tel: 301-498-3650  
Fax: 301-498-3755

### Chicago

1000 Stevenson Court  
Suite 100  
Roselle, IL 60172-4314  
Tel: 630-582-9602  
Fax: 866-955-2441

### Cincinnati

5406 Spellmire Drive  
Cincinnati, OH 45246  
Tel: 513-942-7200  
Fax: 513-682-2123

### Dallas

2025 W. Belt Line Road  
Suite 130  
Carrollton, TX 75006  
Tel: 972-245-9551  
Fax: 972-245-9522

### Greensboro

4524 Green Point Drive  
Suite 106  
Greensboro, NC 27410  
Tel: 336-665-1963  
Fax: 336-665-1965

### Houston

3550 Brittmoore Road  
Suite 200  
Houston, TX. 77043  
Tel: 713 329-9551  
Fax: 713 939-0811

### Orlando

7608 Currency Drive  
Orlando, FL 32809  
Tel: 407-856-0660  
Fax: 407-856-0090

### Headquarters

7680 The Bluffs  
Suite 100  
Austell, GA 30168  
Tel: 678-838-6000  
Fax: 678-838-6001

Download these brochures and more at [www.ykkap.com](http://www.ykkap.com)



Hurricane Impact Resistant

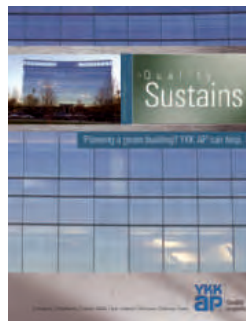

Environmental (LEED)



Blast Mitigation

For architectural specifications, details and warranty information, call 1-800-955-9551 or visit our website at [www.ykkap.com](http://www.ykkap.com).

The contents of this catalog are intended for product information only. All information and details within this catalog are subject to change without notice.

see us at  
**Sweets**.com

©2008 YKK Corporation of America  
16-1004-00

YKK AP America Inc.  
7680 The Bluffs, Suite 100  
Austell, GA 30168  
1-800-955-9551  
[www.ykkap.com](http://www.ykkap.com)

**YKK**  
**ap** Quality  
inspires™