

QUANTITY	HEIGHT

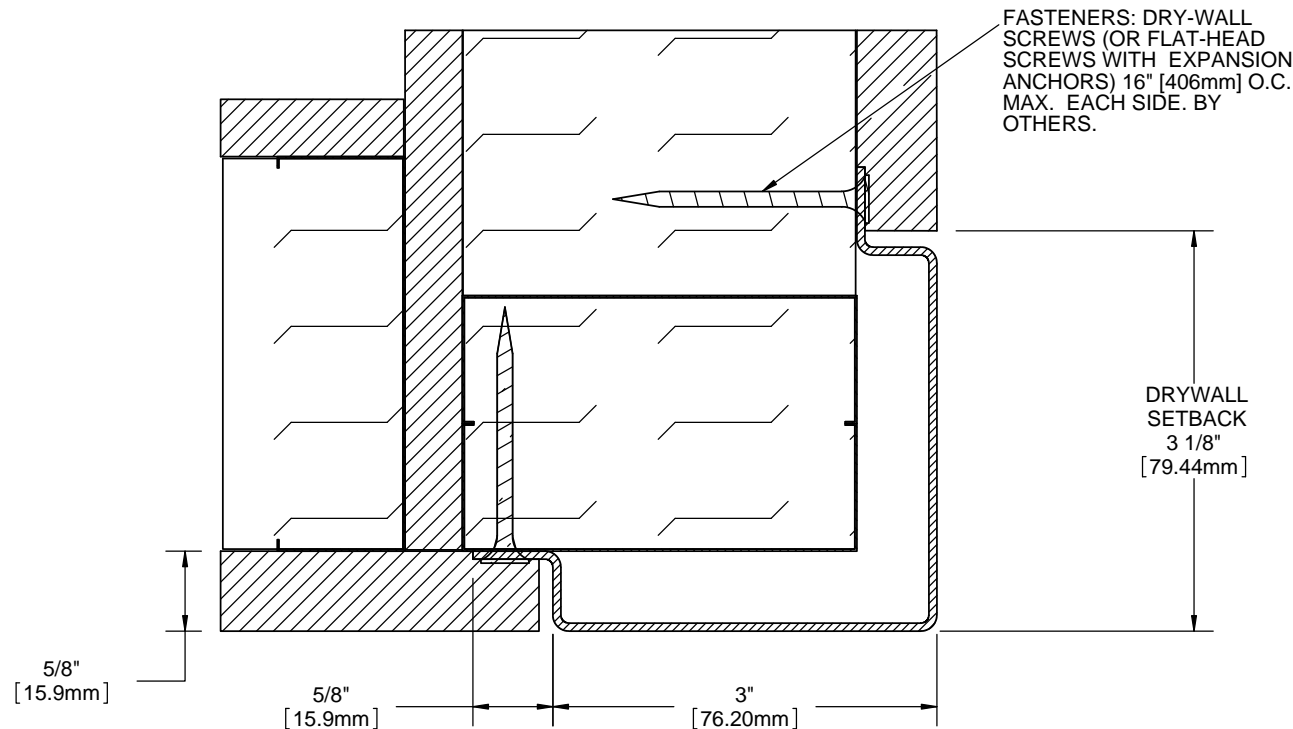

NOTES:

- MECHANICALLY FASTENED APPLICATION
- MATERIAL: TYPE 304 STAINLESS STEEL, 16 GAUGE WITH ROUNDED EDGES.
- FINISH: SATIN #4 WITH REMOVABLE PROTECTIVE COATING.
- AVAILABLE IN 90° (STANDARD), CUSTOM ANGLES AVAILABLE.
- CONTINUOUS LENGTHS AVAILABLE 10' MAXIMUM.
- EMBOSSED PATTERNS AVAILABLE IN 304 STAINLESS STEEL ONLY. GAUGE AND LENGTH MAY VARY DEPENDING ON PATTERN.
- FASTENERS AND PARTITION COMPONENTS BY OTHERS.

PROJECT:			
ARCHITECT:			
CONTRACTOR:			
 9300 73rd Avenue North Brooklyn Park, MN 55428		TITLE:	
		CORNER GUARD, STAINLESS STEEL, TYPE 304, 3" X 3" WINGS, DRILLED, RECESS MOUNT, 90 DEGREE, 16 GAUGE	
NAME	DATE	SIZE	DWG. NO.
DKL	9/30/12	A	BCGSR3SD
RELEASED	PGE	10/22/12	WEIGHT: 2.66 LB/LF
			REV A
			SHEET 1 OF 1