



COMMERCIAL & INDUSTRIAL  
PRODUCT SHOWCASE



PIONEERING INSULATED  
METAL PANEL TECHNOLOGY

## THE METL-SPAN® COMPANY



### A RECOGNIZED LEADER

Metl-Span® is a dynamic industry innovator dedicated to manufacturing and marketing the highest quality insulated building panel products. Since our origination in 1968, we have been pioneers in research, design, production, and sales of state-of-the-art insulated metal panels and building materials serving the commercial, industrial, and cold storage industries.

We are a recognized leader in the advancement of insulated metal panel technology. With our history of visionary product design – and by consistently setting the highest standards in technological advances – architects, designers, and builders trust Metl-Span panel products to perform reliably, be aesthetically pleasing, and come with a proven sustainability track record. Structural integrity, tireless testing, and a determination to exceed expectations are of primary focus to Metl-Span. At Metl-Span, form meets function in the most reliable, cost-effective, and energy-efficient manner possible.

Partnering with Metl-Span ensures on-time and on-budget delivery of superior building products. Our highly trained and educated group of project managers, engineers, and customer service pros provide guidance to you and your team from start to finish. Metl-Span is committed to providing you with the tools needed to incorporate our insulated panel products into virtually any building design.

### TABLE OF CONTENTS

The Metl-Span Company	2
Environmentally Connected	3
Architectural Insulated Metal Wall Panel	4–5
Profiled Insulated Metal Wall Panels	6–8
Tuff Wall® & Tuff-Cast™ Insulated Metal Wall Panels	9
CFR Insulated Metal Roof Panel	10
LS-36™ Insulated Metal Roof & Wall Panel	11
ThermalSafe® Fire Resistant Insulated Panel	12–13
HPCI Barrier™ Insulated Metal Wall Panel	14
Single-Skin Steel Panels	15–18
Colors for the Commercial & Industrial Market	19



**>> Our mission is clearly defined:** Deliver the highest quality energy-efficient solutions to insulate and protect our world.



# ENVIRONMENTALLY CONNECTED

## INSULATED METAL PANELS FOR SUSTAINABILITY AND ENERGY EFFICIENCY

Metl-Span has made available an Environmental Product Declaration (EPD) detailing the company's environmental footprint based on an ISO-compliant Life Cycle Assessment. The comprehensive declaration provides descriptions of Metl-Span products according to ISO 14025 standards and discloses all relevant environmental information.

Given today's emphasis on sustainable design and energy efficiency, there has been a proliferation of products that claim to optimize building performance. Certified EPDs provided by quality manufacturers such as Metl-Span help designers, contractors and owners accurately assess a product's impact on the environment through all phases of its life cycle.

### LEED® Gold

PROJECT: **Aerzen USA**, Coatesville, PA  
ARCHITECT: Vision Architecture, Philadelphia, PA



### LEED® Gold

PROJECT: **MCC Automotive Tech**, Manchester, NH  
ARCHITECT: Yeaton Associates, Littleton, NH



### LEED® Silver

PROJECT: **Ballard Blocks**, Seattle, WA  
ARCHITECT: Clark Design Group, Seattle, WA



### LEED® Silver

PROJECT: **Hope Lake Lodge**, Cortland, NY  
ARCHITECT: RBA Group, Charlotte, NC





## ARCHITECTURAL INSULATED METAL WALL PANEL



The Metl-Span® Architectural wall panel is ideal for high-profile applications, and may be installed vertically or horizontally. Attached with concealed clips and fasteners in the side joint, Architectural wall panels provide a beautiful flush appearance. Horizontally applied panels are available with varying side joint reveals of 1/4", 1/2", 3/4", and up to 3" in 1/2" increments.

Metl-Span is dedicated to manufacturing and marketing the finest insulated building panel products. As a pioneer in insulated metal panel development for over 45 years, we continue to make many of the product design innovations and technology improvements that shape industry standards. We are constantly expanding our research and process capabilities to provide the highest quality product.

Metl-Span insulated metal panels are manufactured to exacting specifications to assure uniform quality and product consistency. The panels have an advanced urethane core with zero ozone-depleting properties which is injected in-line between two steel face sheets. The all-in-one single element panels for wall, partition, ceiling, and roof applications are economical, offer unlimited design flexibility, and are durable and quick to install.



### FEATURES & BENEFITS

The foamed-in-place technology by Metl-Span offers the most thermally efficient architectural panel available. Unlike more traditional insulation products, Metl-Span insulated metal panels are placed outboard of the structural supports, creating a continuous barrier for maximum thermal efficiency with no compressed insulation or thermal bridges.

Architectural wall panels have a specially formed barrier side joint that permits hidden application of the vapor sealant within recessed grooves. This protects the sealant from the harmful effects of extreme weather, will not attract dirt, and provides for an impenetrable water and vapor seal.

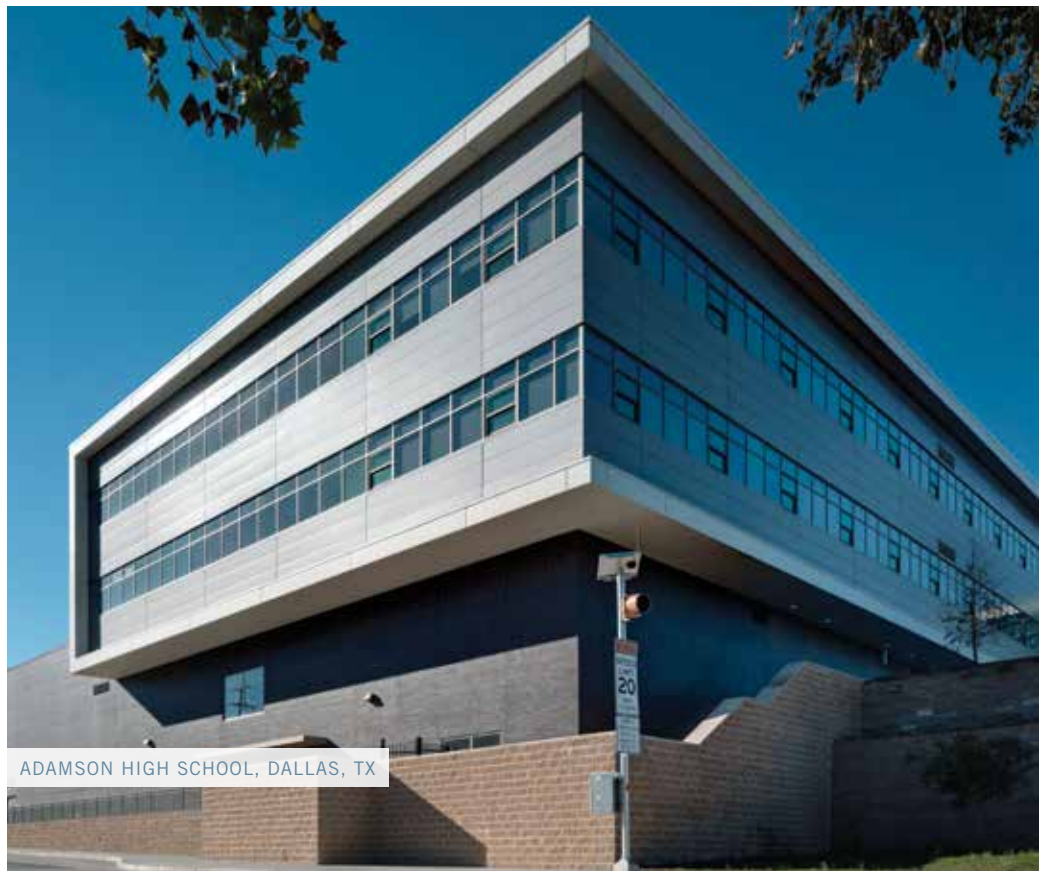

ADAMSON HIGH SCHOOL, DALLAS, TX



### HORIZONTAL APPLICATION

Trimless ends complement the high-profile appearance of horizontally installed panels. The vertical joint in horizontal applications of the Architectural wall panel utilizes a dry gasket that helps maintain a clean, weathertight seal and remains in place even under the most severe weather conditions.

Coordinated with a variety of module widths, reveals, numerous standard colors, and post fabrication choices, the Architectural wall panel creates virtually limitless building design options.

### PANEL SPECIFICATIONS

MODULE WIDTH: 24", 30", 36"

THICKNESS: 2", 2-1/2", 3", 4"

LENGTHS: 8'-0" to 32'-0"

EXTERIOR FACE: Stucco-embossed, G-90 galvanized and/or AZ-50 aluminum-zinc coated steel in 22 Ga.

INTERIOR FACE: Light Mesa profile, stucco-embossed, G-90 galvanized, and/or AZ-50 aluminum-zinc coated steel in 26 Ga., 24 Ga., and 22 Ga.

PANEL JOINT: Offset double tongue and groove with extended metal shelf for positive face fastening





## PROFILED INSULATED METAL WALL PANELS

### USES & APPLICATIONS

In new and retrofit construction, Metl-Span panels function as walls, ceilings, and roofing for all types of architectural, commercial, and industrial applications. They are ideally suited for:

#### ARCHITECTURAL

- Low- and Mid-Rise Offices
- Mid-Rise Office Spandrel Panels
- Convention Centers
- Performing Arts Centers
- Arenas
- Airport Terminal Buildings
- Schools & Universities
- Religious Facilities
- Hospitals

#### COMMERCIAL & INDUSTRIAL

- Retail Buildings
- Hangars
- Prison Facilities
- Equipment Maintenance Buildings
- Manufacturing Facilities
- Warehouses
- Distribution Centers
- Self-Storage Complexes
- Utility Buildings
- Controlled Environment Buildings where temperature control and insulation values are critical

*All Metl-Span panels can be easily adapted to pre-engineered metal building designs for almost any end-use as walls and roofing – saving material, time, and labor costs.*

### FEATURES & BENEFITS

Metl-Span® profiled panels have a standard FM Approved Class 1 foam core and offer the best insulating values available today. The metal and foam composite construction creates a rigid panel far stronger than the individual parts. This increases the span capability of the panels and reduces the need for secondary structural steel components.

- Panels are lightweight and quick to install, significantly reducing construction time.
- A double tongue-and-groove offset side joint permits concealed fastening.
- Consistent insulating values are achieved with built-in thermal breaks, saving energy.



DAVIDSON CENTER FOR SPACE  
EXPLORATION, HUNTSVILLE, AL



### STRIATED WALL PANEL

The Striated insulated metal wall panel combines the aesthetics of a flat wall panel and high insulation values of a urethane core. The exterior face is lightly profiled with narrow longitudinal striations to a nominal 1/2" depth and exhibits a virtual flat appearance at a short distance.

#### PANEL SPECIFICATIONS

MODULE WIDTH: 30", 36", 42"

THICKNESS: 2", 2-1/2", 3", 4"  
(2-3/4" thickness available from Nevada plant)

LENGTHS: 8'-0" to 40'-0" for the 30" & 36" widths, 8'-0" to 32'-0" for the 42" width

EXTERIOR FACE: Stucco-embossed, G-90 galvanized and/or AZ-50 aluminum-zinc coated steel in 24 Ga. and 22 Ga.

INTERIOR FACE: Mesa or Light Mesa profile, stucco-embossed, G-90 galvanized and/or AZ-50 aluminum-zinc coated steel in 26 Ga., 24 Ga., and 22 Ga.

PANEL JOINT: Offset double tongue and groove with extended metal shelf for positive face fastening



### CF MESA & LIGHT MESA WALL PANELS

The CF Mesa and Light Mesa insulated metal wall panels are well suited for exterior wall and interior partition applications. The lightly corrugated profile on both faces of the panel ensures symmetry from outside the building to inside, and from room to room in partition applications.

#### PANEL SPECIFICATIONS

MODULE WIDTH: For the CF Mesa and Light Mesa wall panel: 36", 42"

THICKNESS: CF Mesa profile, 2", 2-1/2", 3", 4", 5", 6"; CF Light Mesa profile, 2", 2-1/2", 3", 4" (2-3/4" thickness available from Nevada plant)

LENGTHS: 8'-0" to 53'-0"

EXTERIOR FACE: Stucco-embossed, G-90 galvanized and/or AZ-50 aluminum-zinc coated steel in 26 Ga., 24 Ga., and 22 Ga.

INTERIOR FACE: Mesa or Light Mesa profile, stucco-embossed, G-90 galvanized and/or AZ-50 aluminum-zinc coated steel in 26 Ga., 24 Ga., and 22 Ga.

PANEL JOINT: Offset double tongue and groove with extended metal shelf for positive face fastening



### CF FLUTED WALL PANEL

The ribbed profile of the CF Fluted insulated metal wall panel provides bold vertical lines complementary to almost any commercial or industrial building. Like the other Metl-Span CF panels, the fluted design is installed with concealed clips and fasteners in the side joint.

#### PANEL SPECIFICATIONS

MODULE WIDTH: 42"

THICKNESS: 2", 2-1/2", 3", 4", 5", 6"  
(2-3/4" thickness available from Nevada plant)

LENGTHS: 8'-0" to 53'-0"

EXTERIOR FACE: Stucco-embossed, G-90 galvanized and/or AZ-50 aluminum-zinc coated steel in 26 Ga., 24 Ga., and 22 Ga.

INTERIOR FACE: Mesa or Light Mesa profile, stucco-embossed, G-90 galvanized and/or AZ-50 aluminum-zinc coated steel in 26 Ga., 24 Ga., and 22 Ga.

PANEL JOINT: Offset double tongue and groove with extended metal shelf for positive face fastening



SHELBURNE GREEN OFFICE PARK, SHELBURNE, VT





## PROFILED INSULATED METAL WALL PANELS



### SANTA FE® WALL PANEL

The Santa Fe® insulated metal wall panel has a flat exterior profile with a heavy stucco-embossed texture that mimics the look of conventional masonry stucco. The profile is further enhanced with concealed side joint fasteners.

#### PANEL SPECIFICATIONS

MODULE WIDTH: 36", 42"

THICKNESS: 2", 2-1/2", 3", 4"

(2-3/4" thickness available from Nevada plant)

LENGTHS: 8'-0" to 40'-0"

EXTERIOR FACE: Heavy stucco-embossed, G-90 galvanized and/or AZ-50 aluminum-zinc coated steel in 24 Ga. and 22 Ga.

INTERIOR FACE: Mesa or Light Mesa profile, stucco-embossed, G-90 galvanized and/or AZ-50 aluminum-zinc coated in 26 Ga., 24 Ga., and 22 Ga.

PANEL JOINT: Offset double tongue and groove with extended metal shelf for positive face fastening

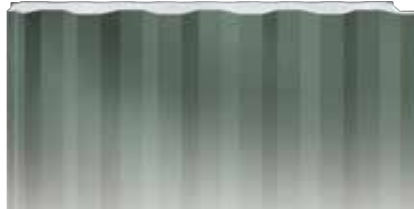

### 7.2 INSUL-RIB™ WALL PANEL

The 7.2 Insul-Rib™ insulated metal wall panel combines a traditional 7.2" rib panel design with a urethane foam core. For the first time, this widely used profile is now available with exceptional insulating properties in various thicknesses.

#### PANEL SPECIFICATIONS

MODULE WIDTH: Nominal 36"

THICKNESS: 2-1/2", 3", 4", 5", 6"

LENGTHS: 8'-0" to 36'-0"

EXTERIOR FACE: Stucco-embossed, G-90 galvanized and/or AZ-50 aluminum-zinc coated steel in 26 Ga., 24 Ga., and 22 Ga.

INTERIOR FACE: Mesa or Light Mesa profile, stucco-embossed, G-90 galvanized and/or AZ-50 aluminum-zinc coated steel in 26 Ga., 24 Ga., and 22 Ga.

PANEL JOINT: Offset double tongue and groove with extended metal shelf for positive face fastening



### CF PARTITION WALL PANEL

The CF Partition insulated metal wall panel is the most economical choice for interior partition applications. For added strength on both faces, the lightly corrugated profile ensure symmetry from outside the building to inside; from room to room. (Note: not intended for exterior walls)

#### PANEL SPECIFICATIONS

MODULE WIDTH: 44-1/2"

THICKNESS: 2", 2-1/2", 3", 4", 5", 6"

(2-3/4" thickness available from Nevada plant)

LENGTHS: 8'-0" to 53'-0"

EXTERIOR FACE: Stucco-embossed, G-90 galvanized and/or AZ-50 aluminum-zinc coated steel in 26 Ga., 24 Ga., and 22 Ga.

INTERIOR FACE: Mesa or Light Mesa profile, stucco-embossed, G-90 galvanized and/or AZ-50 aluminum-zinc coated steel in 26 Ga., 24 Ga., and 22 Ga.

PANEL JOINT: Offset double tongue and groove (The extended metal shelf is eliminated on the Partition wall panel)

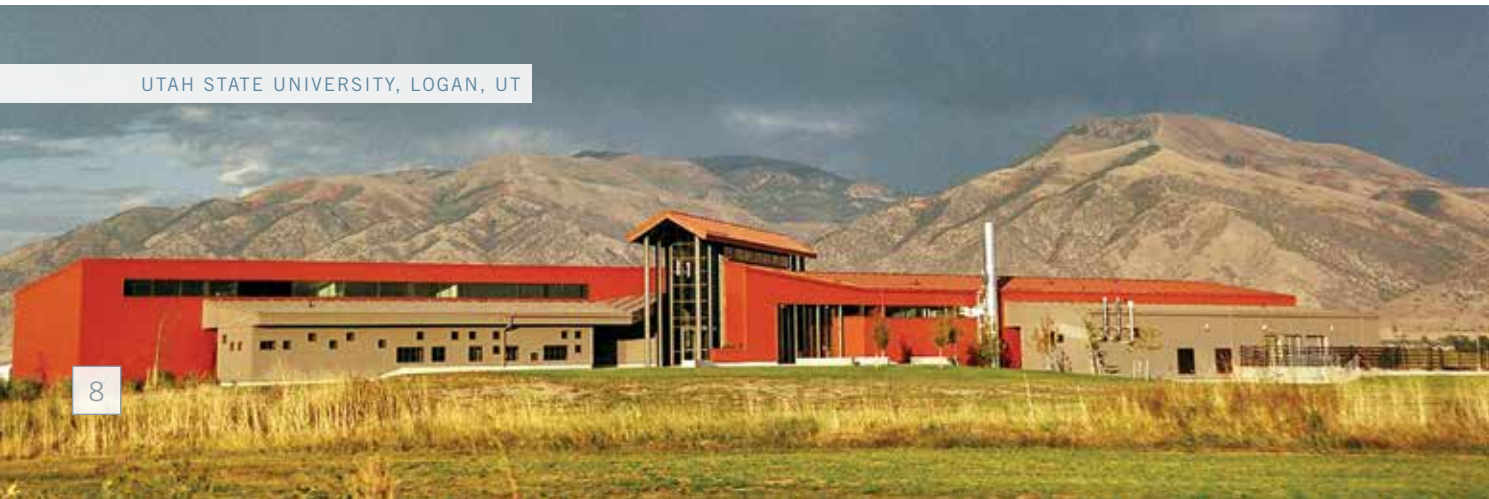



TUFF WALL® PANEL



TUFF-CAST™ PANEL



## TUFF WALL® & TUFF-CAST™ INSULATED METAL WALL PANELS

Tuff Wall® is an insulated metal wall panel with an attractive stucco-like appearance, whereas Tuff-Cast™ has the look of finished precast concrete. Both products feature an exterior finish of Tuff Cote® fiber-reinforced polymer, which is heat cured under controlled conditions to ensure a strong bond to the metal surface.

### FEATURES & BENEFITS

Tuff Wall and Tuff-Cast combine the masonry look of stucco and finished precast concrete walls with the thermal efficiency of an insulated metal panel.

The durable finish on Tuff Wall and Tuff-Cast panels is highly resistant to impact and abrasion and maintains its attractive color for many years.

Field-tested and proven, the Tuff Cote finish comes with a 10-year limited finish warranty.

The stucco and precast textures conform to the aesthetic demands required by many communities and business developments.

Tuff Wall and Tuff-Cast panels can be erected in virtually any weather condition since the Tuff Cote finish is unaffected by damp or cold weather, unlike field-applied stucco materials.

### PANEL SPECIFICATIONS

MODULE WIDTH: 36", 42"

THICKNESS: 2", 2-½", 3", 4", 5", 6"

LENGTHS: 8'-0" to 40'-0"

EXTERIOR FACE: Stucco-embossed, G-90 galvanized and/or AZ-50 aluminum-zinc coated steel in 24 Ga. and 22 Ga. with factory-applied Tuff Cote finish system

EXTERIOR TEXTURE: Tuff Cote finish system – a hard aggregated fiber-reinforced polymer coating

INTERIOR FACE: Mesa or Light Mesa profile, stucco-embossed, G-90 galvanized and/or AZ-50 aluminum-zinc coated steel in 26 Ga., 24 Ga., and 22 Ga.

PANEL JOINT: Offset double tongue and groove with extended metal shelf for positive face fastening



## CFR INSULATED METAL ROOF PANEL

Metl-Span® CFR is an insulated metal standing seam roof panel and is the preeminent innovation in all-in-one composite panel design, combining durable interior and exterior faces with our unmatched polyurethane core.

The CFR roof panels have wide coverage areas between side joint connections and a mechanically closed standing seam that is 2" high. Profiling between the seams is a Mesa pattern with stucco embossing for added strength and superior appearance.

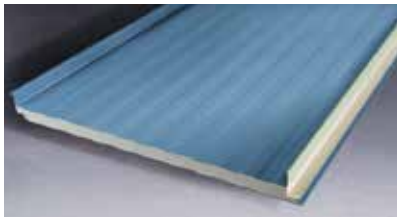

The CFR roof panel's diaphragm strength can be integrated into many steel-framed building bracing designs by attaching panels with exclusive Clinch Clip® by

Metl-Span. Adjacent roof panels are interlocked without fastener penetrations that compromise weathertightness or costly below-roof installation.

### UNIQUE FEATURES & BENEFITS

The CFR roof panel provides a standing seam exterior face for unsurpassed weathertight performance. CFR roof panels are installed completely from the top side with concealed clips and fasteners placed in the side joint. Factory-cut panel ends, factory notching, and factory-swaged ends eliminate critical and extensive field reworking. Factory-installed backer plates at the endlaps also eliminate pre-drilling for special fasteners and tools. Careful design parameters have enabled Metl-Span to create an incomparable roof system that is easily and quickly installed without dependence on highly skilled labor.

### PANEL SPECIFICATIONS

MODULE WIDTH: 30", 36", 42"

EXTERIOR PROFILE: 2" high standing seam with a Mesa profile between the seams

INTERIOR PROFILE: Mesa profile, nominal 1/8" deep

THICKNESS: 2", 2-1/2", 3", 4", 5", 6"

LENGTHS: Standard 9'-6" to 53'-0"; contact Metl-Span for custom length availability

EXTERIOR FACE: Stucco-embossed, G-90 galvanized and/or AZ-50 aluminum-zinc coated steel in 24 Ga. and 22 Ga.; or AZ-55 aluminum-zinc coated steel with a clear acrylic coating in 24 Ga.

INTERIOR FACE: Stucco-embossed, G-90 galvanized and/or AZ-50 aluminum-zinc coated steel in 26 Ga., 24 Ga., and 22 Ga.

PANEL JOINT: Mechanically closed single-lock standing seam at the exterior side joint. The interior side joint is a single tongue-and-groove interlock

UPLIFT PERFORMANCE: UL 90 rated, FM Approvals Standard 4471, and Florida Building Code approved. Dade County NOA No. 09-0310.10



HOPE LAKE LODGE, CORTLAND, NY



## LS-36™ INSULATED METAL ROOF & WALL PANEL

The versatility of the Metl-Span LS-36™ insulated metal roof and wall panel offers a multitude of design options. The overlapping, through-fastened joint allows for quick installation in roof or wall applications that results in reduced labor costs and earlier business starts. Owners will also appreciate the energy cost savings that an insulated metal panel provides.

### FEATURES & BENEFITS

Insulated metal panels consist of two single-skin metal panels and a foamed-in-place core. The foam insulation is made of zero ODP polyurethane foam. IMPs are sealed to each other at the side laps and to the substructure at all perimeter



boundaries, which make them the ideal choice for applications where a continuous air barrier is required. The special foam insulation of IMPs offers superior R-values that provide enhanced energy performance. An overlapping rib on the top face, and single tongue and groove on the bottom face, coupled with vapor seal mastic in the mastic grooves, provides superior resistance to air and moisture intrusion, allowing for increased thermal performance of the building envelope.

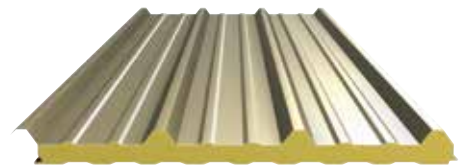

### PANEL SPECIFICATIONS

MODULE WIDTH: 36"

EXTERIOR PROFILE: 1-¼" high major ribs at 12" o.c. with Mesas in between ribs at 4" o.c.

INTERIOR PROFILE: Mesa profile, nominal ½" deep

THICKNESS: 1-½", 2", 2-½", 3", 4", 5", 6"

LENGTHS: Standard 8'-0" to 50'-0"

EXTERIOR FACE: Stucco-embossed, G-90 galvanized and/or AZ-50 aluminum-zinc coated steel in 26 Ga., 24 Ga. and 22 Ga.

INTERIOR FACE: Stucco-embossed, G-90 galvanized and/or AZ-50 aluminum-zinc coated steel in 26 Ga., 24 Ga., and 22 Ga.

PANEL JOINT: Overlapping with a single tongue and groove

FASTENING: Exposed through fasteners

### USES & APPLICATIONS

In new and retrofit construction, Metl-Span panels function as walls and roofing for all types of commercial, and industrial applications. They are ideally suited for:

#### COMMERCIAL & INDUSTRIAL

- Retail Buildings
- Hangars
- Prison Facilities
- Equipment Maintenance Buildings
- Manufacturing Facilities
- Warehouses
- Distribution Centers
- Self-Storage Complexes
- Utility Buildings
- Controlled Environment Buildings where temperature control and insulation values are critical



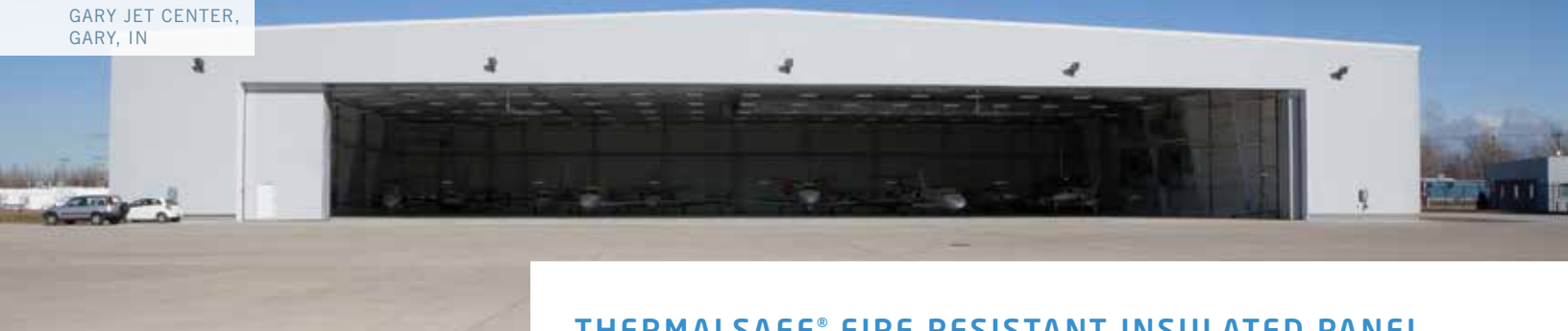

### USES & APPLICATIONS

ThermalSafe fire resistant insulated panels are ideal for industrial buildings like manufacturing plants, auxiliary buildings at refineries, and other building installations at risk for fire.

Warehouses of all types are excellent structures for mineral wool panels, where they can be installed as exterior fire resistant separation walls or as fire partitions and barriers inside tilt-up buildings that contain multiple-tenant leased space. High occupancy structures like sports arenas and gymnasiums, cold storage warehouses, bakeries, and other food processing facilities are well suited for ThermalSafe panels.

## THERMALSAFE® FIRE RESISTANT INSULATED PANEL



ThermalSafe® from Metl-Span® is a fire resistant insulated panel consisting of metal facings bonded to a structural mineral wool core. ThermalSafe combines the latest technology in panel design with our advanced manufacturing expertise to create a composite panel that achieves one-, two- and three-

hour fire resistance ratings for non-load bearing walls and a 90-minute fire resistance rating for a non-load bearing ceiling.

ThermalSafe panels with the exclusive LockGuard® side joint have one-, two-, and three-hour fire resistance ratings without installation of field-applied silicate splines in the panel joint. This unique design speeds the installation process and enhances the fire resistance of the panel.

### ENVIRONMENTALLY FRIENDLY

ThermalSafe panels are made from recyclable raw materials. The mineral wool core is a natural product that contains no VOCs or CFCs that affect the ozone layer or add to global warming potential. No poisonous gases are released during a fire.

### FEATURES & BENEFITS

- The structural mineral wool core resists high temperatures and will not burn.
- Fire resistant exterior and interior walls can be installed in one step with ThermalSafe mineral wool panels. They provide good thermal performance as well, eliminating the need for additional insulation.
- ThermalSafe panels can be installed without sealant in the side joint for partition wall applications when a vapor seal is not required, greatly enhancing installation speed.
- For interior applications, partitions can be disassembled and reinstalled rather than having to be demolished and completely rebuilt.
- Mineral wool panels have good sound transmission acoustical properties compared to many other insulated metal panel products.
- The ThermalSafe core is dimensionally stable, water repellent, and will not expand. Mineral wool, however, is a fibrous material with a high perm rating, so the ThermalSafe panel edges must be protected from moisture.

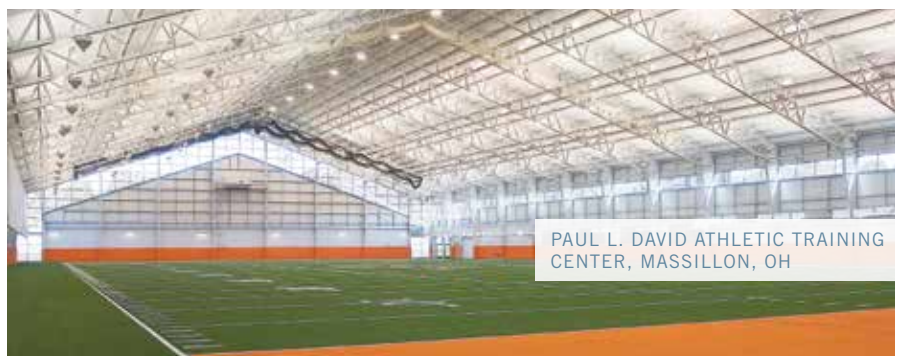



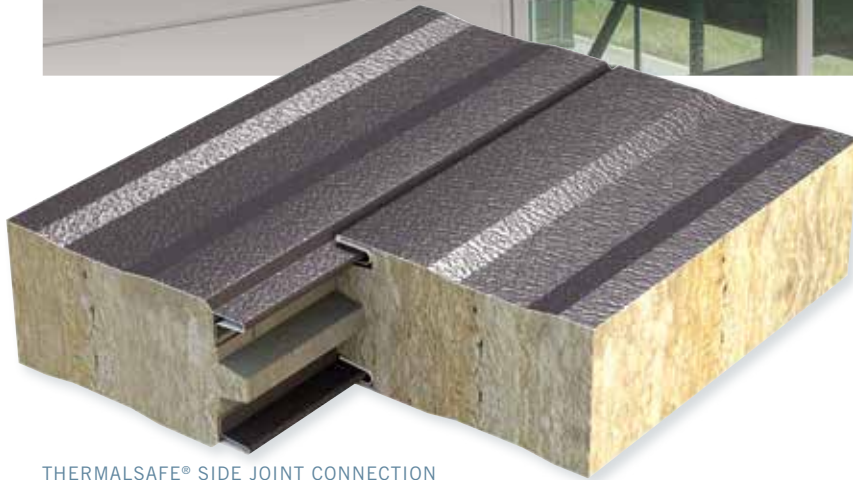

THERMALSAFE® SIDE JOINT CONNECTION

**PANEL SPECIFICATIONS**

FACE PROFILE: Light Mesa profile, nominal 1/32" deep

MODULE WIDTH: 42"

THICKNESS: Nominal 4", 5", 6", 7", 8"

LENGTHS: Minimum is 8'-0"; maximum available length is variable by thickness, weight, end use, and orientation; contact Metl-Span for custom length availability

EXTERIOR FACE: Stucco-embossed, G-90 galvanized and/or AZ-50 aluminum-zinc coated steel in 26 Ga. and 24 Ga.

INTERIOR FACE: Stucco-embossed, G-90 galvanized and/or AZ-50 aluminum-zinc coated steel in 26 Ga. and 24 Ga.

CORE: Non-combustible structural mineral wool

PANEL JOINT: Exclusive LockGuard® side joint has a flush, double tongue-and-groove connection of the metal faces with an advanced integral spline to join the mineral wool core

R-VALUE: The core insulating value is 3.61 "R" per inch

**FIRE RESISTANCE DATA**

- UL fire resistance ratings of the finished panel for non-bearing walls are: one-hour fire rating in a 4" thickness, two-hour fire rating in a 7" thickness, and three-hour fire rating in an 8" thickness.
- To see the complete fire resistance approvals data and for more complete fire resistance rating data, go to [metlspan.com/fire-resistance-approvals](http://metlspan.com/fire-resistance-approvals).
- Wall framing support members and adjacent construction may require fire protection as specified by applicable building code. The customer is responsible for specifying the appropriate fire protection in these areas.

**HANDLING**

Because of ThermalSafe's heavy weight-to-strength ratio, use of specialized vacuum-actuated lifting equipment is suggested to ensure safe and controlled handling. Refer to the ThermalSafe Installation Guide for complete instructions.



FALLSVIEW INDOOR WATER PARK EXTERIOR AND INTERIOR, NIAGARA FALLS, ON

# DAVENPORT MOTOR COMPANY

## HPCI BARRIER™ INSULATED METAL WALL PANEL

The HPCI Barrier™ insulated metal wall panel pushes the exterior building envelope to new standards of cost savings, design integrity, and sustainability.

With efficient one-step installation and all-in-one construction, the HPCI Barrier saves time and money. Its innovative design provides superior air, water, thermal, and vapor protection in a single-panel component that far surpasses outdated multiple-step systems. In addition, the HPCI Barrier can be used behind any type of facade, such as metal or brick – and its high level of recycled content makes it a sound choice for architects, designers, builders, and contractors seeking an environmentally sustainable product.

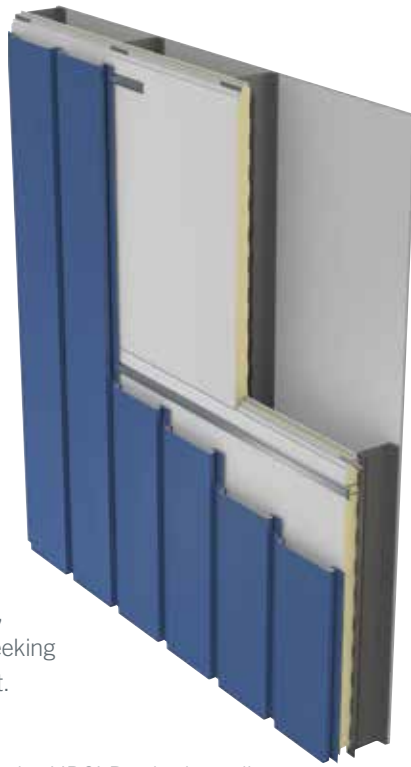

### PANEL SPECIFICATIONS

MODULE WIDTH: 42"

EXTERIOR PROFILE: No profile embossed

INTERIOR PROFILE: Light Mesa embossed

THICKNESS: 2", 3", 4"

LENGTHS: 8'-0" to 24'-0"

EXTERIOR & INTERIOR FACE: Minimum .016" thick HPCI galvanized steel

PANEL CORE: Foamed-in-place, zero ozone-depleting polyurethane (zero ODP)

THERMAL VALUES: K-factor, Btu in/ft<sup>2</sup> hr. °F @ 75°F (24°C) mean core temperature = 0.140

COLOR: White Polyester

### HOW IT WORKS

Unlike traditional backup wall systems, the HPCI Barrier is easily and quickly installed in a single step – eliminating the need for multiple work crews, minimizing construction debris, and reducing the likelihood of improper installation that could strike any stage of a traditional multi-layer scenario. In addition, the HPCI Barrier back-up panel is installed in a horizontal orientation completely outside the structural supports, so there are no thermal bridges to reduce energy efficiency. It's an advanced all-in-one insulated metal composite solution – backed by the industry innovation of Metl-Span.

THE HPCI BARRIER™ CAN BE USED  
BEHIND TRADITIONAL FACADES







## CONCEALED FASTENER SINGLE-SKIN STEEL PANELS

### DESIGNER™ SERIES

The Designer Series panels provide the toughness of metal while creating an attractive, flexible and functional wall or fascia panel. The Designer Series is offered in fluted and flat panels, which are equally effective for new construction or retrofitting existing buildings.



### DESIGNER™ SERIES 12\"/>

The Designer Series 12" flat panel provides an elegant, clean design for any building with the toughness of metal. The panel offers a 1-3/4" deep leg that is the perfect cavity for rigid board insulation.

#### PANEL SPECIFICATIONS

PROFILE: Flat with a 1-3/4" deep leg

MODULE WIDTH: 12"

LENGTHS: 5'-0" to 30'-0"

EXTERIOR FACE: Smooth as standard G-90 galvanized and/or AZ-50 aluminum-zinc coated steel in 24 Ga. and 22 Ga.

STANDARD EXTERIOR: Full-strength 70% PVDF Fluoropolymer or Siliconized Polyester coating

FASTENING: Concealed Fastening System

FINISHES & COLORS: See [metlspan.com](http://metlspan.com) for full information regarding available colors and order requirements



### DESIGNER™ SERIES 16\"/>

The Designer Series 16" fluted panel provides an elegant, clean design for any building with the toughness of metal. The panel offers a continuous rib design with a hidden sidelap where the panels join together. The ribs provide interesting shadow lines along the length of the wall. The panel legs are 1-3/4" deep, allowing ample space for rigid board, blanket, or batt insulation in the cavity.

#### PANEL SPECIFICATIONS

PROFILE: Flat with a 1-3/4" deep leg

MODULE WIDTH: 12"

LENGTHS: 5'-0" to 30'-0"

EXTERIOR FACE: Smooth as standard G-90 galvanized and/or AZ-50 aluminum-zinc coated steel in 24 Ga. and 22 Ga.

STANDARD EXTERIOR: Full-strength 70% PVDF Fluoropolymer or Siliconized Polyester coating

FASTENING: Concealed Fastening System

FINISHES & COLORS: See [metlspan.com](http://metlspan.com) for full information regarding available colors and order requirements





## CONCEALED FASTENER SINGLE-SKIN STEEL PANELS



FW 120-0

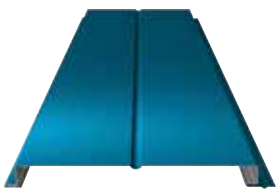

FW 120-1



FW 120-2

**FW-120 METAL WALL PANELS**

The FW-120 Panel by Metl-Span is a concealed fastener wall and liner panel that provides a flat appearance. FW-120 is commonly used for architectural, commercial and industrial markets. The heavy gauge offering provides for large spanning capabilities, particularly in composite wall applications. The panel is available in a flat profile, with one or two beads.

### PANEL SPECIFICATIONS

- PROFILE: Flat with options of one bead at 6" o.c. or two beads, 4" apart
- MODULE WIDTH: 12"
- LENGTHS: 5'-0" to 30'-0"
- EXTERIOR FACE: Smooth as standard G-90 galvanized and/or AZ-50 aluminum-zinc coated steel in 24 Ga., 22 Ga. and 20 Ga.
- STANDARD EXTERIOR: Full-strength 70% PVDF Fluoropolymer Coating
- FASTENING: Concealed Fastening System
- FINISHES & COLORS: See metlspan.com for full information regarding available colors and order requirements







### NUWALL® METAL WALL PANEL

NuWall® by Metl-Span combines the ease of installation in both new and retrofit applications with the pleasing aesthetic appeal of a clean, uninterrupted wall. For retrofit construction, all installation work is performed outside with no disruption to the interior workplace. The NuWall® Panel can be installed over an existing R panel wall; other panel profiles may require the use of subgirts.

### PANEL SPECIFICATIONS

PROFILE: 2-1/2" deep panel with 1/2" deep fluting

MODULE WIDTH: 12"

LENGTHS: 5'-0" to 40'-0"

EXTERIOR FACE: Smooth as standard G-90 galvanized and/or AZ-50 aluminum-zinc coated steel in 24 Ga. and 22 Ga.

STANDARD EXTERIOR: Full-strength 70% PVDF Fluoropolymer Coating or Siliconized Polyester coating

FASTENING: Concealed Fastening System

FINISHES & COLORS: See metlspan.com for full information regarding available colors and order requirements

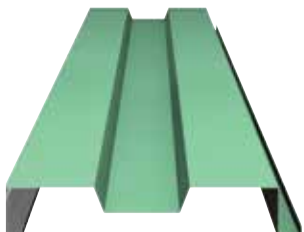

### SHADOWRIB™ METAL WALL PANEL

The ShadowRib™ Panel by Metl-Span is a proven performer and versatile tool for designers. The panel has superior structural strength that does not sacrifice appearance or design flexibility. The deep flutes featured on this panel create distinctive shadow lines on your structure.

### PANEL SPECIFICATIONS

PROFILE: 3" deep panel with 1-1/2" deep by 5-1/4" wide fluting

MODULE WIDTH: 16"

LENGTHS: 5'-0" to 40'-0"

EXTERIOR FACE: Smooth as standard G-90 galvanized and/or AZ-50 aluminum-zinc coated steel in 24 Ga. and 22 Ga.

STANDARD EXTERIOR: Full-strength 70% PVDF Fluoropolymer Coating or Siliconized Polyester coating

FASTENING: Concealed Fastening System

FINISHES & COLORS: See metlspan.com for full information regarding available colors and order requirements



### ARTISAN® SERIES METAL SOFFIT PANEL

The simplicity of the Artisan® Series Soffit Panel by Metl-Span is its best design feature. Uniform dimensions and clean appearance allow the designer to plan modules, eliminate complicated pieces and follow wall curvatures. The Artisan Panel can be vertical, horizontal, perpendicular or skewed to the building line, allowing the designer multi-dimensional freedom to create.

### PANEL SPECIFICATIONS

PROFILE: Flat panel

MODULE WIDTH: 8", 10" or 12"

LENGTHS: 8" Panel: 4'-0" to 20'-0"; 10" Panel: 4'-0" to 20'-0"; 12" Panel: 4'-0" inquire about longer lengths

EXTERIOR FACE: Smooth as standard G-90 galvanized and/or AZ-50 aluminum-zinc coated steel in 26 Ga., 24 Ga. and 22 Ga.

STANDARD EXTERIOR: Full-strength 70% PVDF Fluoropolymer Coating or Siliconized Polyester coating

FASTENING: Concealed Fastening System

FINISHES & COLORS: See metlspan.com for full information regarding available colors and order requirements



## EXPOSED FASTENER SINGLE-SKIN METAL WALL PANELS

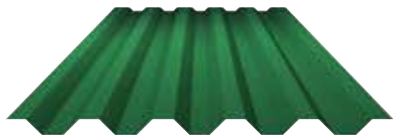

**7.2 METAL WALL PANEL**

When a design calls for a commercial or industrial thru-fastener panel, the 7.2 Panel offers versatility and functionality. The 7.2 Panel is a 36" wide panel with symmetrical 1-1/2" high ribs on 7.2" centers. This rugged panel also offers excellent spanning capability.



**PBR METAL WALL PANEL**

The PBR Panel is used for a wide variety of architectural, commercial, and industrial applications. PBR is a structural panel with exposed fasteners used on wall applications.



**PBU METAL WALL PANEL**

The PBU Panel is an exposed fastener system that can be used both horizontally and vertically for wall applications. It can be installed directly over purlins or joists and gives designers a contemporary appearance for their building project.

### PANEL SPECIFICATIONS

**7.2 PROFILE:** Traditional high rib height at 7.2" o.c

**PBR PROFILE:** 1-1/4" rib height at 12" o.c.

**PBU PROFILE:** 3/4" rib height at 6" o.c.

**WIDTH:** 36"

**LENGTHS:** 5'-0" to 50'-0"

**EXTERIOR FACE:** Smooth as standard G-90 galvanized and/or AZ-50 aluminum-zinc coated steel in 26 Ga., 24 Ga. and 22 Ga.

**STANDARD EXTERIOR:** Full-strength 70% PVDF Fluoropolymer Coating or Siliconized Polyester Coating

**FASTENING:** Exposed Fastening System

**FINISHES & COLORS:** See metlspan.com for full information regarding available colors and order requirements



**PBC METAL WALL PANEL**

The PBC Panels are attached to a building structure with exposed fasteners. It can be installed vertically or horizontally, but most commonly used in horizontal wall applications.

### PANEL SPECIFICATIONS

**PBC PROFILE:** 7/8" rib height at 2-2/3" o.c

**PBD PROFILE:** 5/8" rib height at 2-2/3" o.c

**MODULE WIDTH:** 32"

**LENGTHS:** 5'-0" to 50'-0"

**EXTERIOR FACE:** Smooth as standard G-90 galvanized and/or AZ-50 aluminum-zinc coated steel in 26 Ga., 24 Ga. and 22 Ga.

**STANDARD EXTERIOR:** Full-strength 70% PVDF Fluoropolymer Coating or Siliconized Polyester coating

**FASTENING:** Exposed Fastening System

**FINISHES & COLORS:** See metlspan.com for full information regarding available colors and order requirements



**PBD METAL WALL PANEL**

The PBD Panel is an exposed fastener wall panel with symmetrical ribs from top to bottom.



# COLORS FOR THE COMMERCIAL & INDUSTRIAL MARKET

## STANDARD I EXTERIOR COLORS

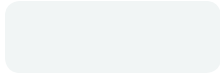

Polar White



Sandstone

## STANDARD II EXTERIOR COLORS



Regal Gray



Brownstone



Almond

Standard I & II Colors in 22 Ga. will incur an additional material charge. Please inquire.

## PREMIUM I EXTERIOR COLORS



Harbor Blue



Pacific Blue



Colonial Red



Brite Red



Slate Gray



Tundra

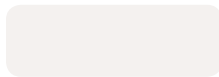

Snow White



Natural Patina



Spruce



Hunter Green



Classic Green



Medium Bronze



Terra Cotta



Smoke Gray



Aegean Blue



Gallery Blue

## PREMIUM II METALLIC & PEARLESCENT EXTERIOR COLORS



Weathered Zinc\*



Copper Metallic\*



Silver Metallic\*



Champagne\*



Dark Gray Metallic\*

## STANDARD SP EXTERIOR COLORS

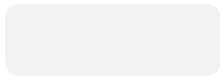

Winter White



Light Stone



Ash Gray

## POLYESTER EXTERIOR COLORS



Igloo White\*\*

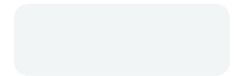

Polyester Polar White

## PREMIUM SP EXTERIOR COLORS



Hawaiian Blue



Crimson Red



Fern Green



Saddle Tan



Desert Sand



Burnished Slate



Koko Brown



Charcoal Gray



Rustic Red

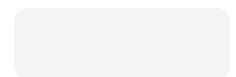

Solar White

Prices will vary by color, coating system, gauge, and quantity of metal. Please contact your Metl-Span representative for complete information. All colors shown here approximate actual finish colors as accurately as possible.

\* Metallic paint finishes will exhibit color shift, shade variances, striations, and longitudinal patterning that are inherent characteristics and are not a product defect or cause for rejection.

\*\* Igloo White is standard interior color for all panels.

Not all colors displayed are available for Single-Skin Panels. To determine color availability, please visit [metlspan.com](http://metlspan.com).



**PIONEERING INSULATED  
METAL PANEL TECHNOLOGY**

1720 Lakepointe Drive  
Suite #101  
Lewisville, Texas 75057  
TOLL-FREE: 877.585.9969  
TEL: 972.221.6656  
FAX: 972.420.9382  
EMAIL: [panel@metlspan.com](mailto:panel@metlspan.com)  
WEB: [metlspan.com](http://metlspan.com)

## COATINGS & SURFACINGS

To ensure a lasting quality appearance, the exterior face sheet of all Metl-Span® insulated wall, CFR, and ThermalSafe® panels is treated with a base primer, followed by a premium, full-strength 70 percent PVDF fluoropolymer coating. A siliconized polyester coating is available in a limited palette of standard colors for projects where economy is the primary consideration. **For specific information about our available colors and coatings, visit [metlspan.com](http://metlspan.com) for a comprehensive selection.**

## AVAILABILITY & COST

Metl-Span panels are available through a network of independent representatives, independent contractors, and design-build companies. Since cost is a factor that varies with each installation based on panel profile, insulation thickness, coatings, and quantity, contact Metl-Span for the name of your nearest representative for pricing. For more complete information on panel specifications, technical data, detail library, and the location of your nearest sales representative, please visit us online at [metlspan.com](http://metlspan.com).

## WARRANTY

Metl-Span insulated wall, CFR, and ThermalSafe panels are warranted to be free from defects in material and workmanship for a period of two years from the date of substantial completion. Ensuring watertightness and/or vaportightness is a function of the installer and is not covered by the warranty from Metl-Span. Complete standard limited warranty information is available upon request.

Metl-Span is not responsible for selection and application of colors, coatings, or other products, and reserves the right to substitute, delete, or change gauges, widths, thicknesses, finishes, profiles, and colors on its products at its discretion – at any time and without notice.

