

# 101 Series Recess Mount

A01 - Floor to Floor

A02 - Floor to Wall

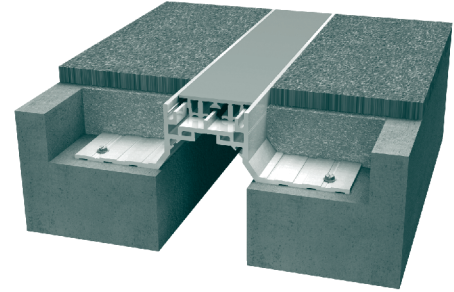

**Movement Rating ± 25%**

## Product Guide

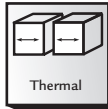

- ▶ Dual durometer seal provides secure fit and optimal flexibility
- ▶ Seals absorb limited serviceable seismic movement
- ▶ Recessed modular frames for minimal sight line
- ▶ Adaptable to many finishes, including ceramic tile, marble, stone, vinyl tile and carpet
- ▶ Seamlessly integrates with the following wall and ceiling systems

- ▶ Easy to clean flush seals. No dirt or water traps
- ▶ Snap-fit design for easy on site assembly
- ▶ Mill finish aluminum
- ▶ Load rated
- ▶ Optional decorative caps in brass or stainless steel
- ▶ Integral vapor barrier option available
- ▶ Standard seal colors: black, beige, gray, off white and bright white. Custom colors available upon request.

Wall	Ceiling
101-A07/A09	101-A07/A09
112-A07/A09	112-A07/A09
113-A07/A09	113-A07/A09

## SYSTEM DATA

Application	System	W Joint Width		H1 Frame Height 1		H2 Height 2		S Sightline		B Blockout		Movement +/- Horizontal Vertical				Load	
		US	mm	US	mm	US	mm	US	mm	US	mm	US	mm	US	mm	US ton	kN
Floor/Floor	101-A01-025	1"	25	1 1/2"	38	*	*	1"	25	2 1/2"	64	1/4"	6	1/4"	6	2.8	25
	101-A01-038	1 1/2"	38	1 1/2"	38	*	*	1 7/16"	36	2 1/2"	64	3/8"	10	3/8"	10	2.7	24
	101-A01-050	2"	51	1 1/2"	38	*	*	1 7/8"	47	2 1/2"	64	1/2"	13	1/2"	13	1.7	15
	101-A01-075	3"	76	1 1/2"	38	*	*	2 7/8"	73	2 1/2"	64	3/4"	19	3/4"	19	1.7	15
Floor/Wall	101-A02-025	1"	25	1 1/2"	38	*	*	1"	25	2 1/2"	64	1/4"	6	1/4"	6	2.8	25
	101-A02-038	1 1/2"	38	1 1/2"	38	*	*	1 7/16"	36	2 1/2"	64	3/8"	10	3/8"	10	2.7	24
	101-A02-050	2"	51	1 1/2"	38	*	*	1 7/8"	47	2 1/2"	64	1/2"	13	1/2"	13	1.7	15
	101-A02-075	3"	76	1 1/2"	38	*	*	2 7/8"	73	2 1/2"	64	3/4"	19	3/4"	19	1.7	15

Standard frame height 1 1/2" (38mm)

IPC.802/REV.4

# 101 Series Recessed Mount Floor Systems

## 101-A01 Floor/Floor (1" (25mm) system shown)

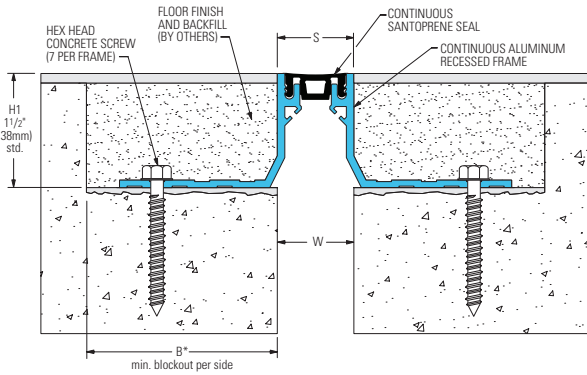

## 101-A01 Floor/Floor (2" (50mm) system shown)

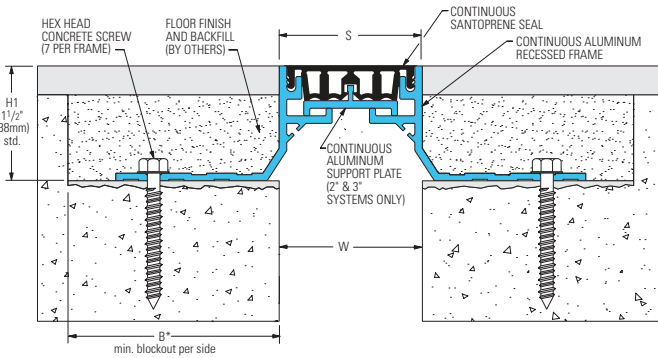

## 101-A02 Floor/Wall (1" (25mm) system shown)

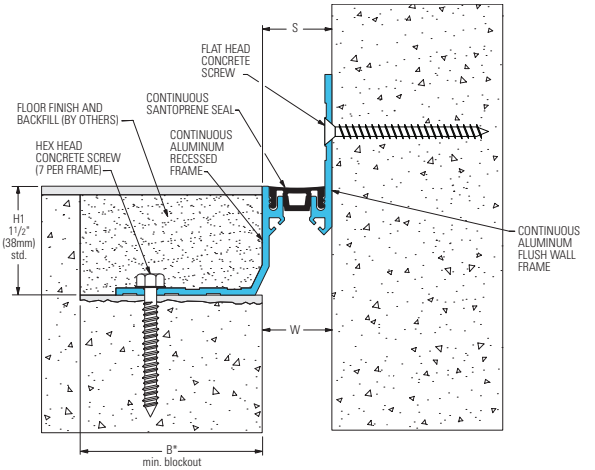

### Wall Frame Options

#### 101-A03 (3/8" Finishes)

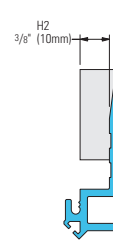

#### 101-A04 (5/8" Finishes)

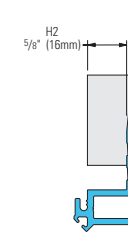

#### 101-A05 (1" Finishes)

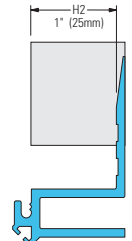

## 101 Series Options

### Reactofire Mineral Wool & Sealant Fire Barrier System (101-A01-025 system shown)

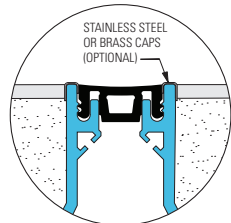
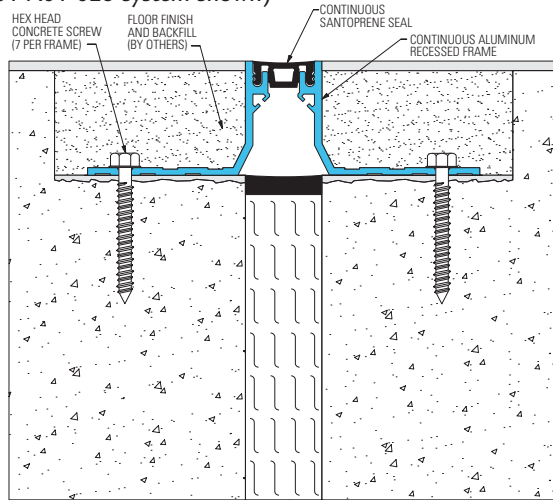

Decorative Caps  
(101-A01-025 system shown)

### Integral Vapor Barrier (101-A01-050 system shown)

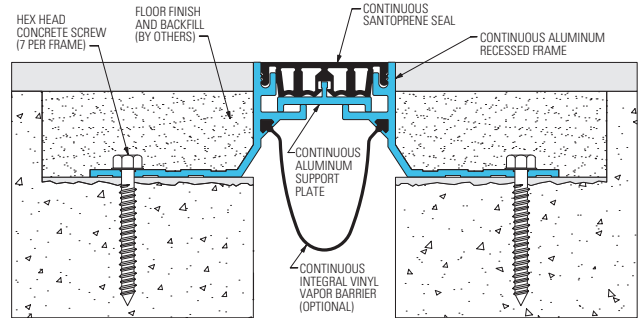

### Reactofire Fire Blanket System (101-A01-050 system shown)

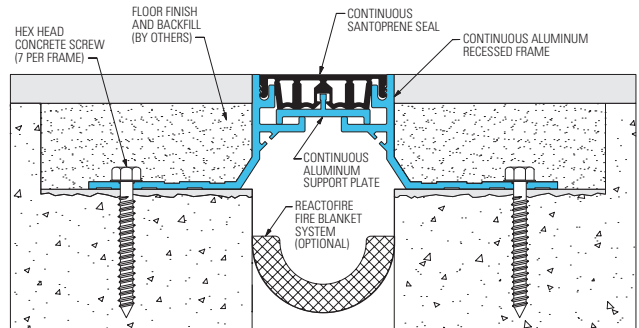

P.O. Box 406 · Muskego, Wisconsin 53150 USA

www.inprocorp.com

Nationwide 800.222.5556/Fax 888.715.8407

International Sales 262.679.5521 / Fax 262.679.5524