

BioPrism™

Solid Surface Wall Panels & Cladding

- Easy to clean surface to maintain a sanitary environment
- Protects walls from cart, wheelchair and pedestrian traffic
- Provide a cohesive appearance with available accessories
- Add a decorative element by adding shapes or logos in the wall panels
- Surface is non-porous and does not promote the growth of mold, mildew or bacteria
- Surface is solid throughout making it easy to renew and repair
- Tested and certified per ANSI standards to ensure product longevity
- Meets the emission level requirements of GREENGUARD® Certification
- 1/4" thick panels are available in 30", 36" and 48" widths and 72", 96", 120" and 144" lengths
- The composition of BioPrism™ produces slight color variation between production cycles due to the innate and complex blending of natural minerals and man-made resin. InPro Corporation does not guarantee color match.

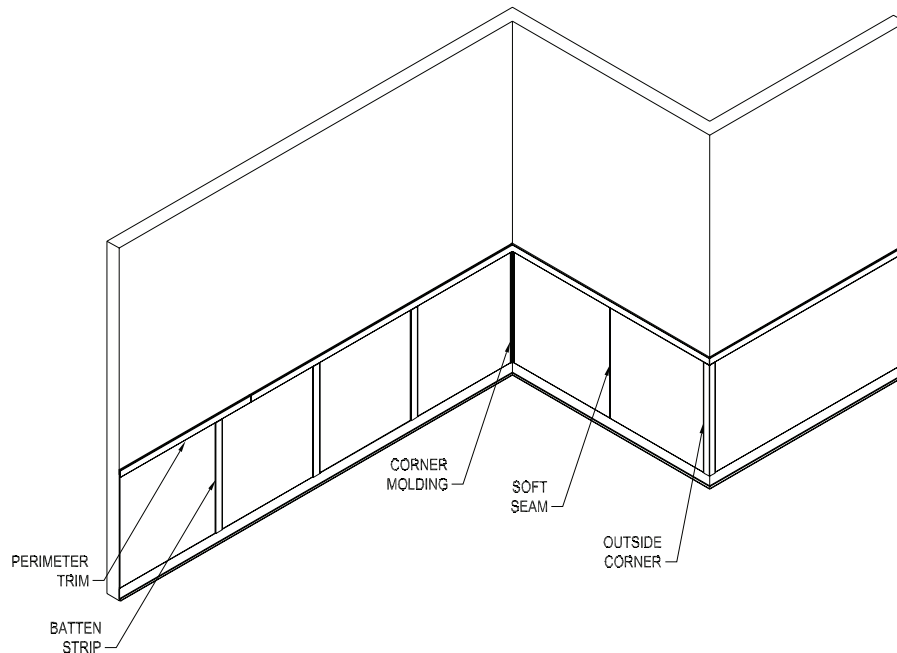

IPC.717/REV.7

BioPrism™ Solid Surface Wall Panels & Cladding

Suggested Specifications

PART 1 – GENERAL

1.01 SUMMARY

- A. Wall Cladding from BioPrism Material

1.02 SECTION INCLUDES

- A. Wall cladding/wainscoting

1.03 REFERENCES

- A. American National Standards Institute (ANSI)
B. International Cast Polymer Alliance (ICPA)
C. National Fire Protection Association (NFPA)

1.04 SYSTEM DESCRIPTION

- A. Provide wall cladding that conform to the following requirements of regulatory agencies and the quality control of IPC Door and Wall Protection.
1. Provide solid surface material that conforms to ANSI/ICPA SS-1 for workmanship and finish, structural integrity and material characteristics.
 2. Fungal and Bacterial Resistance: Provide BioPrism Solid Surface Inconspicuous Hygienic Wall System that does not support fungal or bacterial growth as tested in accordance with ASTM G-21 and ASTM G-22.
 3. Fire Performance Characteristics: Provide BioPrism Solid Surface Wall Cladding conforming with the NFPA class A fire rating as determined by ASTM E-84.

1.05 SUBMITTALS

- A. Product Data: Manufacturer's printed product data for each type of wall cladding specified.
B. Samples: Color samples a minimum of 2" x 2" indicating color and pattern.
C. Manufacturer's Installation Instructions: Printed installation instructions for each type of wall cladding specified.

1.06 DELIVERY STORAGE AND HANDLING

- A. Deliver materials in unopened factory packaging to the jobsite.
B. Inspect materials at delivery to assure that specified products have been received.
C. Store in original packaging in an interior climate controlled location away from direct sunlight.

1.07 PROJECT CONDITIONS

- A. Environmental Requirements: Products must be installed in an interior climate controlled environment.

1.08 WARRANTY

- A. Standard BioPrism™ Solid Surface Limited 10 Year Warranty against material and manufacturing defects.

PART 2 – PRODUCTS

2.01 MANUFACTURER

- A. Acceptable Manufacturer:
IPC Door and Wall Protection, InPro Corporation,
PO Box 406 Muskego, WI 53150 USA;
Telephone: 800.222.5556, Fax: 888.715.8407,
www.inprocorp.com
- B. Substitutions: Not permitted
- C. Provide all Solid Surface Fabrications from a single source.

2.02 SOLID SURFACE FABRICATIONS

- A. Wall cladding/wainscoting: Provide wall cladding/wainscoting from 1/4", panels of BioPrism Solid Surface. Panels shall have butt joints or 1/16" joints sealed with color matched silicone sealant. Panels are to be adhered with adhesive.
1. Edge Options: Wavy Edge.
 1. Panel options: Provide BioPrism Solid Surface Panels with the following decorative options.
 - f. 1/8" Ball Nose, .015" deep, Bead Board, double lines, 2.75" O.C.

2.03 ACCESSORIES

- A. BioPrism Corner Molding, 3/4" x 3/4" x 1/4" x 96"
B. BioPrism Batten Strip, 2 1/4" x 1/4" x 96"
C. BioPrism Perimeter Trim, 2 1/4" x 1/4" x 96"
D. L-shaped corner molding, DSOC196, 1" x 1" x 1/4" x 96"
E. Angle-shaped corner molding, DSICP196, 1 5/16" x 1/4" x 96"
F. BioPrism Panel Molding, DSPMP96225, 2-1/4" h x 7/8" deep x 96", for 1/4" panels.
G. BioPrism L-shaped Inside Corner Molding, DSICPL196, 1" x 1" x 96"
H. BioPrism Inside Cove Corner, DSICCP396, 3" x 3" x 96", for 1/4" panels.
I. Solid Surface Bonding Adhesive
J. Adhesive Cartridge Dispenser
K. Adhesive Mixing Tips
L. Silicone Sealant

2.04 MATERIALS

- A. Solid Surface: BioPrism Solid Surface material shall be manufactured from polyester/acrylic/bio-resin blended with natural filler material.

2.05 FINISHES

- A. The composition of BioPrism™ produces slight color variation between production cycles due to the innate and complex blending of natural minerals and man-made resin.

2.06 FABRICATION

- A. Fabricator should be familiar with the cutting, machining, sanding polishing and seaming of solid surface materials.
B. Produce joints connecting components using manufacturer's joint adhesive. Joints shall be inconspicuous in appearance.
C. Finish: Finish all surfaces uniformly.

PART 3 – EXECUTION

3.01 EXAMINATION

- A. Examine areas and conditions in which wall cladding will be installed.

3.02 PREPARATION

- A. General: Prior to installation, clean area to remove dust, debris and loose particles.

3.03 INSTALLATION

- A. General: Install components plumb and level, scribe adjacent finishes, in accordance with approved shop drawings and recommended installation instructions.

3.04 CLEANING

- A. At completion of the installation, clean surfaces in accordance with the IPC Door and Wall Protection clean-up and maintenance instructions.