

**CENTRIA**  
PRODUCT CATALOG  
**REIMAGINE METAL**



**CENTRIA**

REIMAGINING THE BUILDING ENVELOPE

# CONTENTS

4	Formawall® Dimension Series®
6	Formawall® Graphix Series™
8	Formawall® Dimension Series® Product Details
10	Formawall® Graphix Series Product Details
11	Formavue™ Integrated Window System
12	Smart-R™ Wall Solution
14	Formawall® Integrated Options
16	Versawall® & Versapanel® Wall & Roof Panel Systems
18	FormaBond® & FormaBond® II Metal Composite Wall Systems
20	MetalWrap™ Series Insulated Composite Backup Panel
22	Profile Series Concept Series®
24	Profile Series IW Series
25	Profile Series Exposed Fastener Panels
25	Profile Series Liner Panels
26	Profile Series Concept Series® Product Details
27	Profile Series IW Series Product Details
28	Profile Series Exposed Fastener Panels Product Details
28	Profile Series Liner Panels Product Details
29	EcoScreen® Perforated Screenwall
30	Profile Series Design Options
31	Quietwall & Firewall Systems
32	SRS® Structural Standing Seam Roof Systems
34	Ventilation Systems
35	Coating Systems & Substrates
36	Prismatic Series, Sundance Series & Duracast
37	Kolorshift™ Series & Allusion
38	Product Finish Availability
39	Project Index

## Reimagine Performance

## Reimagine Aesthetics

## Reimagine Sustainability

## Reimagine Value

CENTRIA's collection of metal wall and roof systems offers the highest levels of performance, aesthetics, sustainability and value — and are designed to help architects, building owners and contractors **Reimagine Metal.**

We offer one of the widest product ranges of any metal wall and roof manufacturer — many that incorporate our innovative Advanced Thermal and Moisture Protection (ATMP®) technology for the highest levels of performance. Our products also offer beautiful aesthetics with a wide range of panel lengths, widths, reveals and textures—creating clean, crisp lines, shadows and reliefs. Many panels also offer seamless integration with our wide selection of accessories. Manufactured using recycled content, and with our recycle, reuse, repurpose program for our foam insulated products, CENTRIA demonstrates our commitment to sustainability and helps ensure the built environment doesn't harm the natural one. Finally, our products provide outstanding value, both at the jobsite and over the long term with reduced maintenance costs and long life-cycles.

From a support standpoint, our national and international sales network provides a consultative approach that leads to innovative project solutions. Their expertise helps architects and other members of the building team achieve excellence with:

- A commitment to exceeding expectations and customer satisfaction
- An in-house design and development group to assist in selecting the best options when considering metal wall and roofs
- Unique project details and specifications
- Access to our trained installer network for quality installations
- Thermal efficiency and moisture control
- Consulting services for substrates, coatings and coils
- Comprehensive in-house coil coating services

North Carolina National Guard Headquarters  
Raleigh, NC  
O'Brien Atkins Architecture



# FORMAWALL®

## The Complete Wall System

Devon Boathouse  
and Finish Line Tower  
Oklahoma City, OK  
Elliot and Associates

Formawall Dimension Series reimagines metal as a wall system that provides thermal efficiency and moisture control in a single panelized component.

Compared to traditional multi-component wall construction, which typically requires five or more separate components, such as a rainscreen, an air barrier, exterior gypsum sheathing, fiberglass insulation and a vapor barrier, Formawall Dimension Series' single panel has a factory foamed-in-place core, minimizing insulation gaps. Combined with CENTRIA's ATMP® technology, Formawall Dimension Series provides thermal performance and value that is second to none.

With a wide range of lengths, thicknesses, reveals and profiles, along with integrated wall components like windows, louvers and sunshades, Formawall Dimension Series provides virtually unlimited design possibilities.

### FEATURES & BENEFITS

- May be installed horizontally or vertically
- Available in a variety of interchangeable reveals, thickness and profile configurations
- Concealed clips, fasteners and sealants plus vertical dry gaskets or insulated metal vertical joints provide a clean, uninterrupted appearance
- Factory foamed-in-place core to ensure no insulation gaps within the panel
- Panels integrate with CENTRIA Formavue™ window systems and are compatible with most other glass wall and window systems
- Pressure-equalized horizontal joinery to help prevent water infiltration
- Optional Pressure Equalized Vertical Seal Plate
- Extruded aluminum or factory-formed metal trim available
- Panels can be easily curved
- Mitered panels permit clean, sharp corners, beam and column wraps
- Trimless ends eliminate overlapping trim at panel end details
- Thermal break between face and liner offers efficient panel R-values
- High strength panels offer increased span capability and save support costs with less framing required
- Lightweight — as low as 2.7 psf — easy to handle and install and minimizes foundation load
- Striated, variable striated, smooth, embossed and precast-like surface treatments available
- Integrated louvers and sunshades available

# DIMENSION SERIES®



For product details refer to pages 6-7

## DESCRIPTION

Factory foam-insulated architectural wall panel system

### SUBSTRATE & CORE

- Standard — 22/26 gage G-90 galvanized steel face and liner with HCFC-free polyurethane or polyisocyanurate foam-insulated core
- Optional gages available — consult CENTRIA
- Optional stainless steel face sheet, 304 stainless steel, 22 or 20 gage, smooth, embossed or striated\*
- Optional .040" [1mm] Aluminum Face (2" [51mm] thick only), flat embossed or smooth striated\*

### JOINERY

- Horizontal oriented panel — Rainscreen, pressure-equalized and drainable joinery, 1/2" [13mm] nom. joint — standard
- Vertical oriented panel — Double tongue-and-groove, 1/8" [3mm] nom. joint — standard
- Optional Pressure Equalized Vertical Seal Plate
- Optional Formawall IMV insulated metal vertical joint 5/8" [16mm] joint — standard

### SURFACE FINISH

- Exterior
  - Non-directional embossed flat or striated
  - Smooth flat or striated
- Interior
  - Non-directional embossed planked or flat
  - Smooth planked

## COATINGS & COLORS

- Advanced Fluorofinish PVDF, metallic and mica color coatings in standard & custom colors
- Duragard & Duragard Plus premium high build architectural coatings
- Duracast® — a natural appearing textured finish
- Versacor® Ultra Premium Multi-Layered Coating System
- Kolorshift™ Iridescent Coating System
- Allusion

## PANEL WIDTH

- Flat panels available from 10" [254mm] to 40" [1016mm]

Consult CENTRIA for profiled panel information.

## PANEL LENGTH

- Smooth — 16' [4.88m] max.
- Embossed striated — 37' [11.28m] max.
- Embossed — 37' [11.28m] max.
- Smooth striated — 20' [6.10m] max.
- Duracast — 28' [8.53m] max.
- Stainless — 16' [4.88m] max.
- Aluminum — 12' 6" [3.81m] max.

## PANEL THICKNESS/DEPTH OF REVEAL

- 2" [51mm] with 1-3/16" [30mm] deep reveal — standard
- 2.5" [63.5mm] with 1-3/16" [30mm] reveal
- 3" [76mm] with 2-3/16" [56mm] deep reveal
- 3"-T [76mm] with 1-3/16" [30mm] deep reveal

## "R" VALUE

- 2" [51mm] panel with 1/2" [13mm] reveal — R14
- 2" [51mm] DS-59 panel with 1/2" [13mm] reveal — R10
- 2" [51mm] DS-60 panel with 1/2" [13mm] reveal — R10
- 2.5" [63.5mm] panel with 1/2" [13mm] reveal — R17
- 2.5" [63.5mm] DS-59 panel with 1/2" [13mm] reveal — R13
- 2.5" [63.5mm] DS-60 panel with 1/2" [13mm] reveal — R13
- 3" [76mm] panel with 1/2" [13mm] reveal — R21
- 3"-T [76mm] panel with 1/2" [13mm] reveal — R22
- 3"-T [76mm] DS-59 panel with 1/2" [13mm] reveal — R16
- 3"-T [76mm] DS-60 panel with 1/2" [13mm] reveal — R16

R-Values are based on ASTM C1363 testing. Air films are included.

All data shown for flat panels only.

Patent No.: US 6,253,511; 6,627,128; 6,968,659; 8,261,494 Canada 2,351,846

\*Length restrictions apply, please consult CENTRIA

## FORMAWALL DIMENSION SERIES



FWDS	vs.	TRADITIONAL MULTI-COMPONENT WALL
1 component required	vs.	7 components required
1 installer required	vs.	Up to 3 installers required
Works for all climates	vs.	Climate specific design required
Superior thermal efficiency	vs.	Thermally inefficient
Total air & moisture control	vs.	Questionable air & moisture control
Contains no mold food sources	vs.	May contain mold food sources
Integrated windows, louvers and sunshades	vs.	No integrated components
Proven systematized long-term performance	vs.	Unknown — dependant on installation quality

## TRADITIONAL STUD INSULATED MULTI-COMPONENT WALL CONSTRUCTION



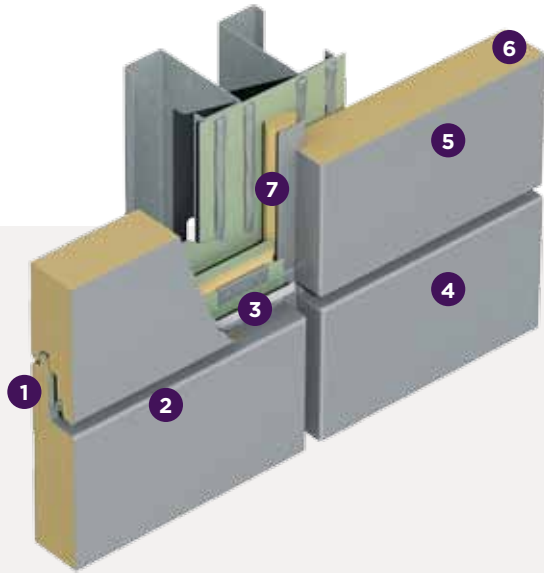

**THE COMPLETE WALL SYSTEM**

- 1 Pressure equalized horizontal joint with concealed sealant protects against water penetration
- 2 Variable reveal sizes, 1/2" [13mm] to 6" [152mm]
- 3 Concealed clips and fasteners provide a sleek exterior appearance with proven long-term performance
- 4 High performance coatings offer long-term coverage, minimal maintenance and excellent color selection for your building's exterior
- 5 Durable metal skins provide impact resistance, strength for increased span capability and a built-in vapor barrier on the interior liner
- 6 Insulating foam core, factory foamed-in-place, provides a thermally efficient exterior wall in either 2" [51mm], 2-1/2" [64mm], or 3" [76mm] thickness
- 7 Unique insulated metal vertical joint (IMV)

**BUILDING CODE APPROVALS**

**FIRE TESTS:**

- Tunnel Test, ASTM E84;
  - a. Flame Spread 25 max.
  - b. Smoke Developed 450 max.
- UL Room Corner Test, UL 1715
- Factory Mutual Approval: FM 4880
- Factory Mutual Approval: FM 4881
- SwRI: Multistory Fire Test, NFPA 285(ISMA)
- ASTM D2015; BTU Content Test
- ASTM D1929; Ignition Properties
- UL Fire Wall Designs: 1 hr, 2 hr, 3 hr, U017, U617, U645, U605

**SPECIAL APPROVALS:**

- Dade County (Missile Impact Resistance)

Consult CENTRIA for test reports.



2" [51mm]  
Horizontal Flat



DS59 2" [51mm]  
Horizontal Profile



2-1/2" [64mm]  
Horizontal Flat



DS59 2-1/2" [64mm]  
Horizontal Profile



3"-T [76mm]  
Horizontal Flat



DS59 3"-T [76mm]  
Horizontal Profile



3" [76mm]  
Horizontal Flat



3" [76mm]  
Vertical Flat



For more information about CENTRIA's high performance wall system, watch our video, *The Rainscreen Principle of Performance*.



**DS60 2" [51mm]**  
Horizontal Profile



**2" [51mm]**  
Vertical Flat



**DS59 2" [51mm]**  
Vertical Profile



**DS60 2" [51mm]**  
Vertical Profile



**DS60 2-1/2" [64mm]**  
Horizontal Profile



**2-1/2" [64mm]**  
Vertical Flat



**DS59 2-1/2" [64mm]**  
Vertical Profile



**DS60 2-1/2" [64mm]**  
Vertical Profile



**DS60 3"-T [76mm]**  
Horizontal Profile



**3"-T [76mm]**  
Vertical Flat



**DS59 3"-T [76mm]**  
Vertical Profile



**DS60 3"-T [76mm]**  
Vertical Profile



Wolfe Center for Performing Arts  
Bowling Green State University  
Bowling Green, OH  
Snohetta/The Collaborative

North Seattle Community College  
Seattle, WA  
Schacht Aslani Architects





# GRAPHIX SERIES™

Formawall Graphix Series wall system provides outstanding performance in a single panelized component. Graphix Series reimagines innovative aesthetics and value and takes them to the next level by making a single panel look like 12 smaller ones—and by offering the ability to choose how the panel length is segmented. This segmented construction makes distinctive designs both easy and economical.

For product details refer to page 10.

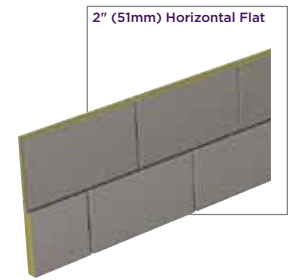

## FEATURES & BENEFITS

- Graphix Series panels can be segmented as frequently as every 12" [305mm] and can be installed both vertically and horizontally
- Distinguish your design further by adding horizontal panel to panel reveals of varying widths — from 1/2" [13mm] to 6" [152mm]
- Customization continues as you select panel finishes with enough options that your Graphix Series design may never be duplicated
- CENTRIA offers advanced coating systems that provide outstanding durability and corrosion resistance — available in over 70 standard colors, including micas and metallics, and unlimited custom colors
- Formawall Graphix Series is a single-component wall system — a steel face and liner, using foamed-in-place CFC-free foam insulation. Panels are joined with CENTRIA's proven pressure equalized vented and dry-sealed joinery. The result is the most advanced thermal and moisture protection available
- Combined with Formawall's integrated components including windows, louvers and sunshades, it's all you need to build the complete wall in any climate
- Optional Pressure Equalized Vertical Seal Plate

## DESCRIPTION

### SUBSTRATE & CORE

- Standard — 22/26 gage G-90 galvanized steel face and liner with HCFC-free polyurethane or polyisocyanurate foam-insulated core
- Optional gages available — consult CENTRIA
- Optional .040" [1mm] Aluminum face (2" [51mm] thick only), embossed and smooth



### JOINERY

- Horizontal oriented panel — Rainscreen, pressure-equalized and drainable joinery, 1/2" [13mm] nom. joint — standard
- Vertical oriented panel — Double tongue-and-groove, 1/8" [3mm] nom. joint — standard
- Segmented joint — 5/8" x 3/4" [16mm x 19mm] deep embossment with factory applied black gasket, standard

- Max. segments per panel — 12
- Min. length of segment — 1' [305mm]
- Formawall IMV insulated metal vertical joint 5/8" [16mm] joint — standard

### SURFACE FINISH

- Exterior
  - Non-directional embossed
  - Smooth flat
- Interior
  - Non-directional embossed, planked or flat
  - Smooth planked

### COATINGS AND COLORS

- Advanced Fluorofinish PVDF, metallic, and mica color coating systems are available in standard and custom colors
- Duragard® & Duragard® Plus premium high build architectural coatings
- Duracast® a natural appearing textured finish
- Versacor® Ultra Premium Multi-Layered Coating System
- Kolorshift™ Iridescent Coating System

### PANEL WIDTH

- Available from 10" [254mm] to 40" [1016mm]

### PANEL LENGTH (Steel Face)

- 20' [6.10m] max.

### PANEL LENGTH (Aluminum Face)

- Embossed, Flat — Overall Max. Length — 12'6" [3.81m]
  - Max. Length of Segment — 11'6" [3.51m]
  - Min. Length of Segment — 12" [305mm]
  - Max. Number of Segments — 12
- Smooth, Flat — Overall Max. Length — 12'6" [3.81m]
  - Max. Length of Segment — 4' [1.22m]
  - Min. Length of Segment — 12" [305mm]
  - Max. Number of Segments — 12

### PANEL THICKNESS

- 2" [51mm] standard
- 2-1/2" [64mm] (Steel face)
- 3"-T [76mm] standard (Steel face)

### "R" VALUE

- 2" [51mm] panel with 1/2" [13mm] reveal — R14
- 2-1/2" [63.5mm] panel with 1/2" [13mm] reveal — R17
- 3"-T [76mm] panel with 1/2" [13mm] reveal — R22

R-Values are based on ASTM C1363 testing. Air films are included.

Patent No.: 7.895.807; 7.678.219

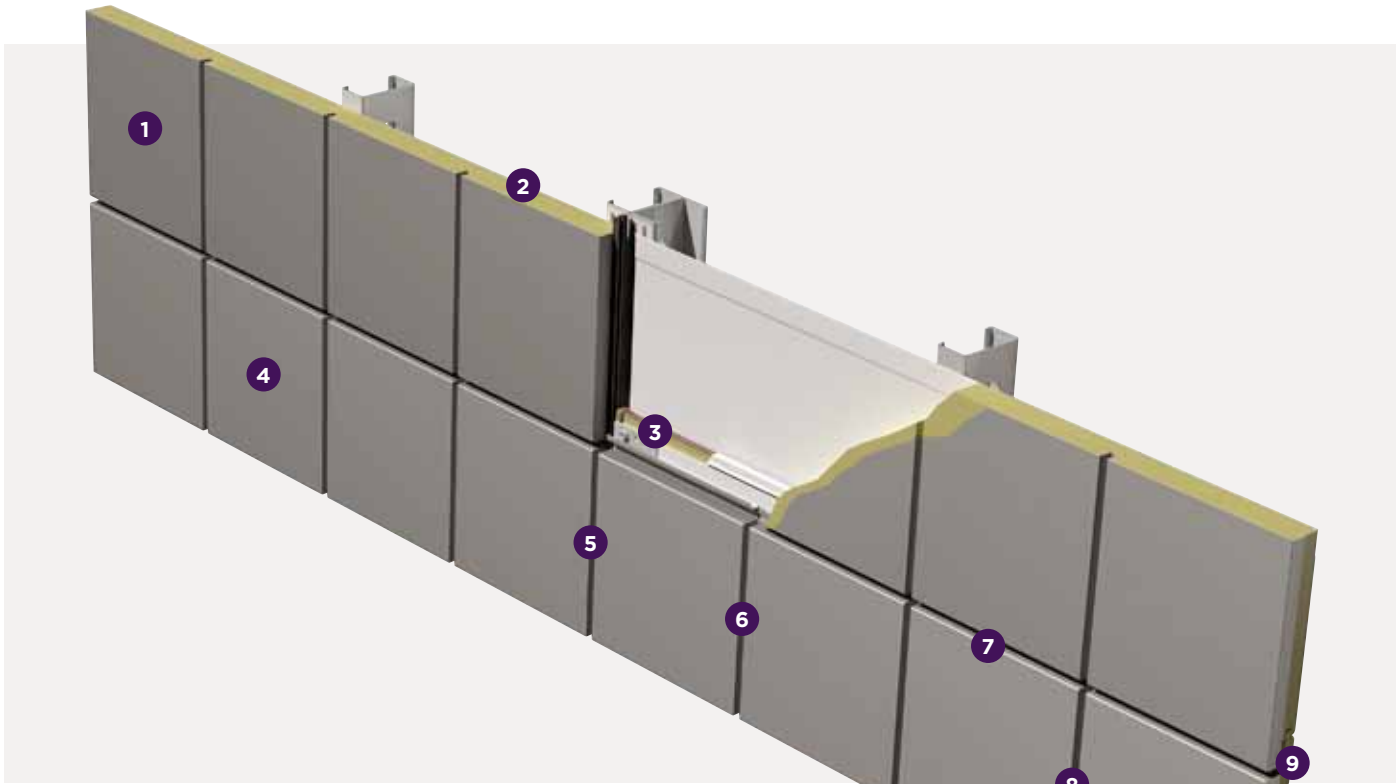

- 1 High performance coatings offer long-term performance, minimal maintenance and excellent color selection for your building's exterior
- 2 Insulating foam core, factory foamed-in-place, provides a thermally efficient exterior wall in either 2" [51mm] or 3" [76mm] thickness
- 3 Concealed clips and fasteners provide a sleek exterior appearance with proven long-term performance
- 4 Durable metal skins provide impact resistance, strength for increased span capability and a built-in vapor barrier
- 5 Gasketed Joint or Insulated Metal Vertical (IMV) Joint (optional)
- 6 Placement of segments are specified by designer
- 7 Optional reveals of varying widths
- 8 Segmented joints are treated to match actual joint
- 9 Vented, pressure-equalized and drainable joinery with concealed sealant prohibits water penetration

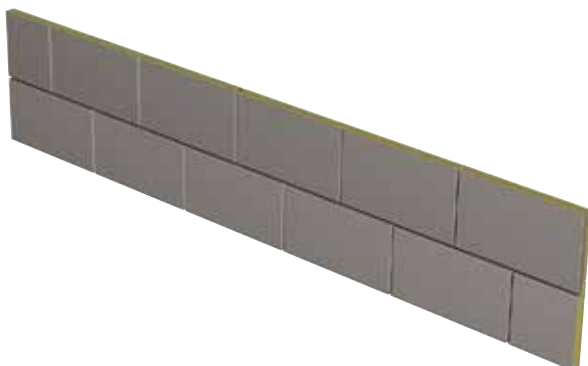

**2" (51mm) Horizontal Flat Running Bond Option**



**2" (51mm) Vertical Flat Grid Option**

# FORMAVUE™

Formavue window systems reimagine integration and are designed to provide a high performance, thermally efficient window/panel interface with Formawall Dimension Series and Formawall Graphix Series panels.

The Formavue window system offers integrated head, sill and jamb details that feature large thermal breaks aligned with the panel insulation, as well as additional insulation in the head of the window frame for one of the most efficient systems on the market today.

System	Window Descriptions	Integrates With	Exterior Sightlines
<b>FV 100</b>	Vertical Panels with Spandrel Supports Strip Window applications and Punched Windows with single lite and stacked glass options. Full and vertical structural glazed mullions.	2" Formawall Vertical or 2" Versawall panels	3" [76mm]
<b>FV 200</b>	Horizontal Panels with Spandrel Supports Strip Window applications and Punched Windows with single lite and stacked glass options. Full and vertical structural glazed mullions.	2" & 3" panels	3" [76mm]
<b>FV 300</b>	Horizontal Panels with Steel or Aluminum Thru-Tube Supports Strip Window applications and Punched Windows with single lite and stacked glass options. Full and vertical structural glazed mullions.	2" & 3" panels	3" [76mm]
<b>FV 400</b>	Horizontal Panels with Steel or Aluminum Thru-Tube Supports Strip Window applications and Punched Windows with single lite and stacked glass options. Full and vertical structural glazed mullions. Exterior pressure bar glazing with snap-on covers. Unique integral gutter at head is standard.	2" & 3" panels	2-1/2" [64mm]
<b>FV 500</b>	Horizontal Panels with Spandrel Supports for Punched Windows Horizontal Panels with Thru-Tube Supports for Strip Windows, Shop-assembled frames for faster installation. Single lite and stacked glass options, full mullions.	2" & 3" panels	3" [76mm]
<b>FV 600</b>	Horizontal Panels with Spandrel or Thru-Tube Support Systems, Punched or Strip Windows, Shop-assembled frames for faster installation. Single lite, stacked glass or ribbon windows. Full and structural silicone glazed mullions. Seamlessly integrates with FWDS 3"-T only and FWGS 3"-T only.	3"-T panels	3" [76mm]
<b>FV 650</b>	Horizontal Panels with Spandrel or Thru-Tube Support Systems, Punched or Strip Windows, Shop-assembled frames for faster installation. Single lite, stacked glass or ribbon windows. Full and structural silicone glazed mullions. Integrates with FWDS and FWGS 2-1/2" only.	2-1/2" panels	3" [76mm]

All Formavue window systems are designed to accept 1" [25mm] insulating glass. FV 100-FV 500 integrate with 2" [51mm] and 3" [76mm] Formawall Dimension and Graphix Series.

## FV 600 Formavue window

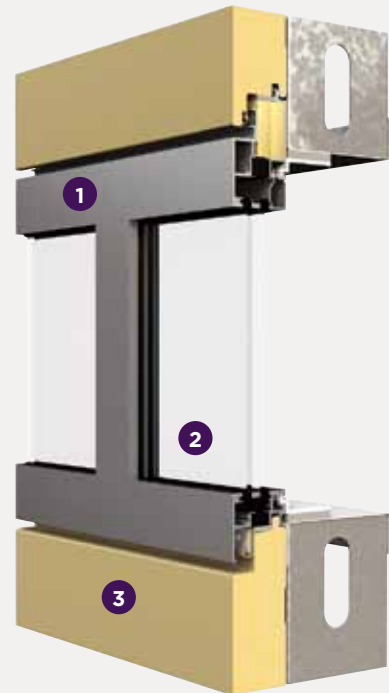

- 1** Window system eliminates receptor extrusions, provides easier and faster jobsite coordination, and is system tested to ensure superior weather resistance
- 2** Inside glazing options allow easier access for installation or glass replacement; R-value up to 3.5
- 3** Advanced, thermally-improved design features a thermal barrier that minimizes through-metal conductivity, while maintaining structural integrity tested CRF value of 65

FORMAWALL

# SMART-R™ WALL SOLUTION

CENTRIA's Smart-R Wall Solution offers the ultimate combination of aesthetics, sustainability and value, along with the best metal wall thermal performance on the market today. This superior thermal efficiency is achieved through a combination of innovative components and integrated solutions, such as wall panels, windows, louvers and sunshades.

Families, Inc.  
Jonesboro, AR  
Cahoon Steiling Studio Architecture



The Smart-R Wall Solution incorporates CENTRIA's Advanced Thermal and Moisture Protection (ATMP®) technology by utilizing factory foamed-in-place insulated composite metal panels, pressure equalized vertical and horizontal joinery and integrated components specifically engineered to work together to maintain a high level of thermal and moisture protection. The system also specifically addresses air infiltration through the use of shop and field-applied concealed sealants that will not degrade over time.

The aesthetics of the system feature a myriad of options in color, texture, profile and shape. Consistent sight lines are maintained without the use of additional receptors when integrating system components such as Formavue panels and Formavue windows.

Finally, the Smart-R Wall Solution is a sustainable choice, providing a high performance thermal envelope by minimizing the amount of materials used to build a wall while reducing scrap generated at the jobsite.

## FEATURES & BENEFITS

### DESIGN

- Systems approach to high-performance architectural cladding
- Seamless integration of panels, windows, louvers and sunshades provides sleek sightlines at component joinery intersections
- All-metal joinery provides unrivaled architectural foam panel aesthetics
- Design flexibility with 2.5" [64mm] and 3"-T [76mm] thick Formavall Dimension Series DS-59 and DS-60 profiles and Formavall Graphix Series panels

### PERFORMANCE

- The 2.5" [64mm] FWDS panels and FV 650 window platform along with the 3"-T [76mm] FWDS panels and FV 600 window platform offer enhanced thermal performance
- A combination of concealed shop and field applied sealants as well as the PE Seal plate specifically address critical air and water seals by providing consistency and redundancy as well as a degree of post inspection.
- Shop-assembled windows reduce the risk of air and water failures by simplifying the installation process

### SUSTAINABILITY

- Integrated wall system reduces the amount of material used
- Engineered composite foam panels, integrated accessories and factory-assembled windows reduce jobsite waste
- High-performance wall system improves the overall air, water and thermal performance

## SMART-R WALL COMPONENTS



### 1 Formawall IMV insulated metal vertical joint

- Offers a 4-sided metal joint option
- Added aesthetic flexibility
- Added insulation at the vertical joint
- Also available with pressure-equalized (PE) seal plate



### 2 2.5" [64mm] and 3"-T [76mm] Formawall Dimension Series insulated metal panels

- Available with all popular Formawall profiles
- Seamlessly integrates with louvers and sunshades
- 2.5" [64 mm] panels integrate with FV 650 windows and 3"-T [76 mm] panels integrate with FV 600 windows
- Pressure-equalized, thermally maximized horizontal joinery
- 2.5" [64 mm] - R17 and 3"-T [76 mm] - R22 per ASTM C 1363



### 3 FV 600 and FV 650 Formavue windows

- Shop-assembled, integrated punched or strip window system
- Available on studs or thru-tube supports
- Seamlessly integrates with 2.5" [64mm] and 3"-T [76mm] Formawall
- Enhanced thermal performance
- R3.5\*

\* 1" IGU with soft coat Low-E and argon gas



### 4 2.5" [64 mm] and 3"-T [76 mm] Formawall Graphix Series insulated metal panels

- Aesthetic flexibility
- Reduced chance of air and water infiltration
- Installation savings

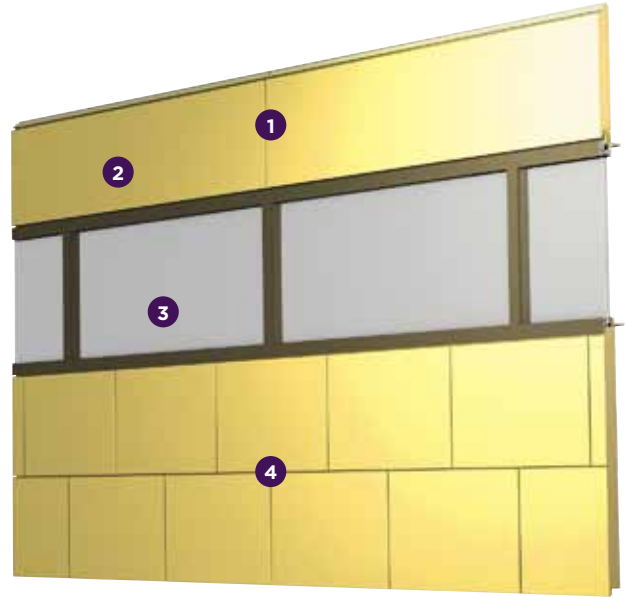

Smart-R Wall

## PERFORMANCE OPTION FOR 3"-T, FV 600 AND IMV



### Formawall PE Seal Plate\*

- Multiple lines of defense against water infiltration
- Vented, pressure-equalized drain channel minimizes the force that may drive water through the wall system
- An inspectable seal on the interior after the panels are installed

Patent No.: US 8,261,499

\*Available only with 3" [76 mm] panels and FV 600 windows. Contact CENTRIA for availability.

# INTEGRATED OPTIONS

CENTRIA's performance, aesthetics, sustainability and value extend beyond the wall panel — we offer a complete wall system with integration options that include windows, sunshades and louvers; finishes like Duracast®, stainless steel and aluminum; design options like variable striations; and performance options like Formawall Dimension Series PE for two lines of defense against water intrusion.



## INTEGRATED OPTIONS

### FORMAVUE™ WINDOWS

Seven distinct styles of Formavue windows integrate seamlessly with Dimension Series panels and accommodate a variety of fenestrations and construction types.

### C/S SUNSHADES

CENTRIA and Construction Specialties, Inc. (C/S Group) join forces to provide a wide selection of sunshades, engineered for seamless and thermally isolated integration with Formavue windows and Dimension Series panels.

### C/S LOUVERS

CENTRIA and C/S Group also provide a full line of fixed, drainable and storm-resistant louvers engineered for seamless integration with Dimension Series panels.

### KALWALL® TRANSLUCENT WINDOWS

CENTRIA and Kalwall Corporation have co-designed this Formawall Dimension Series Integrated Translucent Window System. Designed to install easily with CENTRIA 2", 2-1/2", 3" or 3"-T Formawall Dimension Series panels, these lightweight and strong window systems combine the beauty and good sense of diffused, natural interior lighting with the functional qualities of high insulation, shatterproof construction and low maintenance.

## FINISH OPTIONS

### DURACAST® TEXTURED FINISH SYSTEM

Dimension Series panels coated with CENTRIA Duracast finish, which uses a silica aggregate, provides a rugged, natural look. Duracast is available in eight natural earthtones and comes with an exclusive 20-year warranty.

### STAINLESS STEEL

Choice of:

- No. 4 — A brushed finish
- Embossed, smooth or striated

### ALUMINUM

- 0.040" [1mm] face
- Available on 2" [51mm] Formawall Dimension Series and Graphix Series
- Non-directional embossed flat or smooth striated
- Lengths up to 12'6" [3.81m]



## DESIGN OPTIONS

### VARIABLE STRIATIONS

- Striation bands are 6" [152mm] wide
- A minimum 1" [25mm] smooth band between striation bands
- Striations can run out to both edges
- Striations can be as far from the face edge as desired in 1/4" [6mm] increments



## AESTHETIC OPTIONS

### VARIABLE REVEALS

A variable reveal adds visual appeal and accentuates scale for CENTRIA's Formawall Dimension Series metal wall panels. The ability to adjust the width of the reveals from 1/8" [13mm] to 6" [152mm] in half inch increments is one more way CENTRIA helps architects create truly innovative aesthetics.



# VERSAWALL & VERSAPANEL

Wall & Roof Systems

Faribault Energy Park  
Faribault, MN  
Nelson Architects

Versawall and Versapanel reimagine versatility and flexibility by offering a metal panel solution for both walls and roofs.

The lightweight insulated metal composite panels feature concealed fasteners and can be installed vertically for long, sleek sight lines. The wall panels can also be coated with CENTRIA's Duracast finish for a natural textured look. Designed with double tongue-and-groove joinery, both systems provide outstanding weather resistance and can be installed quickly and easily.

Versapanel's bold standing seam offers an outstanding seamless insulated roofing solution with a water-tight snap-on batten cap that conceals the joint for a sleek, continuous visual.



Versawall 2"  
[51mm] Striated

Versawall 2.75"  
[70mm] Planked



Versawall 2.75"  
[70mm] Striated

Versapanel 1.75"  
[44mm] Planked



## FEATURES & BENEFITS

- Lightweight panels lower installation costs
- Increased span capability reduces support steel requirements
- CFC-free foam insulation
- Thermal break between face and liner saves energy
- Versawall can be used for interior partitions
- Available with factory-formed sheet metal flashing or extruded aluminum trim
- Versapanel's snap-on cap conceals joint for a seamless appearance (required on roofs)

## DESCRIPTION

Factory foam-insulated wall and roof panel system

### SUBSTRATES

- Standard — 26/26 G-90 galvanized steel face and liner with HCFC-free foam insulated core
- Optional gages available, consult CENTRIA

### JOINERY

- Double tongue-and-groove joinery with factory-applied air and vapor seal

### SURFACE FINISH

- Versawall Exterior — Non-directional embossing, flat, striated or planked.
- Versapanel Exterior — Non-directional embossing, planked or flat
- Interior — Non-directional embossing, planked
- Optional Duracast textured finish is available for Versawall and Versapanel wall applications, consult CENTRIA for panel length options

### PANEL WIDTH

- Versawall — 30" [762mm], 36" [914mm]
- Versapanel — 36" [914mm]

### PANEL LENGTH

- 6' to 40' [1.83m to 12.19m] standard
- 48' [14.63m] max. Consult CENTRIA

### PANEL THICKNESS

- Versawall — 2" [51mm], 2-3/4" [70mm], 4" [102mm] nom.
- Versapanel — 1-3/4" [44mm], 2-1/2" [64mm], 4" [102mm]

### "R" VALUE

#### Versawall

- 2" [51mm] depth — R14
- 2-3/4" [70mm] — R20
- 4" [102mm] — R26

#### Versapanel

- 1-3/4" [44mm] — R14
- 2-1/2" [64mm] — R19
- 4" [102mm] — R32

R-values are based on ASTM C1363 testing.  
Air films are included.

## COATINGS & COLORS

- Advanced Fluorofinish PVDF, metallic and mica color coatings in standard & custom colors
- Duragard & Duragard Plus premium high build architectural coatings
- Duracast® — a natural appearing textured finish
- Versacor Ultra, multi-layered coating system
- Kolorshift™ Iridescent Coating System

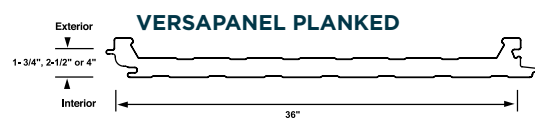
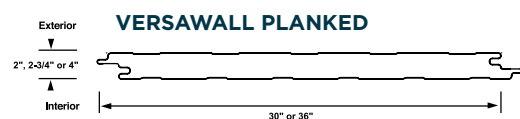
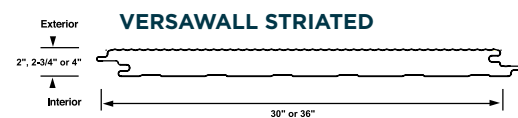
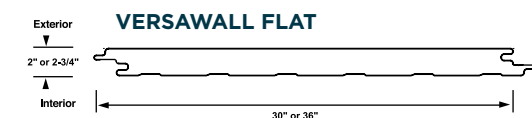

# FORMABOND® & FORMABOND® II

## Metal Composite Wall System

Baylor Charles A. Sammons Cancer Center  
Dallas, TX  
Perkins + Will

CENTRIA reimagines metal composite material (MCM) wall panel systems with FormaBond and FormaBond II.

### FormaBond

CENTRIA's FormaBond revolutionizes the thin aluminum composite panel (ACM) industry. Unlike the traditional ACM process that involves lamination and then fabrication into panels by a second party, FormaBond is manufactured entirely by CENTRIA using a proprietary reaction injection molding process. This means that the panels are stronger and flatter with excellent bond strength and superior impact resistance, along with having pressure-equalized joinery. Plus, CENTRIA's patented dry joinery eliminates wet seals and provides optimum venting. This process means that wall cavities dry effectively and keep rainwater out, thereby reducing the chance of entrapped moisture, material degradation and mold.

### FormaBond II

CENTRIA's FormaBond II is a complete metal composite material (MCM) wall system that delivers dependability, convenience and value. A smooth, sleek panel, FormaBond II offers superior flatness and sharp, crisp sight lines, and is available with a fire resistant core. Plus, it's lightweight, installation ready, and, with its dry seal construction, costly exterior wet seal maintenance isn't required.

FormaBond II also incorporates CENTRIA's unique horizontal dry seal joinery to minimize water penetration and maximize ventilation. This innovative design improves the integrity of the application by reducing the chance of entrapped moisture behind the rainscreen, which minimizes the potential for material degradation and mold.

## FormaBond

### FEATURES & BENEFITS

- Provides super-flat, sharp and crisp exterior sight lines
- Value-added dry seal installation
- Low maintenance and no costly re-caulking
- Pressure-equalized rainscreen with no water entry behind the screen at 15 psf.
- Ventilated cavity along each horizontal joint
- Excellent bond strength and superior impact resistance
- Proprietary polymeric core meets fire code requirements for all building heights
- 8mm sheet thickness provides superior impact resistance



PRESSURE-EQUALIZED RAINSCREEN JOINERY

\*Patent No.: US 7,007,433 B2

### DESCRIPTION

Pre-formed aluminum composite architectural wall panel system

#### SUBSTRATE & CORE

- Metal — 0.032" [.8mm] nominal aluminum face and liner
- Core — Highly cross-linked polymer that meets fire core requirements
- 8mm sheet thickness
- Smooth — flat ACM panel system

#### JOINERY

- All dry construction that is pressure equalized and provides ventilation to the inner wall cavity

#### SURFACE FINISH

- Smooth, Embossed, Braided or Fusion Surface Finish



#### PANEL WIDTH

- Up to 60" [1.52m] Smooth
- Up to 45" [1.14m] for Fusion, Braided and Embossed textures

#### PANEL LENGTH

- Up to 180" [4.57m]

#### VARIABLE REVEALS

- From 1/2" [13mm] to 6" [152mm] in 1/2" [13mm] increments. May also be colorized

#### COATINGS

- Available in micas, metallics, Fluorofinish and Kolorshift™

#### PERFORMANCE

- High performance air and water ratings
- Pressure-equalized joinery
- AAMA 508-05

## FormaBond II

### FEATURES & BENEFITS

- Superior flatness
- Sharp, crisp sight lines
- Fire resistant core available
- Lightweight
- No maintenance dry seal joinery
- Metal spline or gaskets available at vertical joint

### DESCRIPTION

Available in a variety of colors and coating systems, CENTRIA FormaBond II is a smooth panel with a sleek, flat design offering crisp corner transitions or soft, flowing curves.

#### SUBSTRATE & CORE

- Metal — 0.020" [.5mm] nominal thickness aluminum face and liner
- Polyethylene and fire-rated cores available
- 4mm panel thickness, 2 Ø" [64mm] system

- 6mm panel thickness, 2 Ø" [64mm] system
- Flat MCM panel

#### JOINERY

- All dry construction
- High performance drained and back ventilated system
- Open side joint allows ventilation behind the rainscreen
- Drain shelf at top edge of panel minimizes water penetration
- Metal spline and gasket vertical joint options

#### SURFACE FINISH

- Smooth

#### PANEL WIDTH

- Up to 60" [1.52m]

#### PANEL LENGTH

- Up to 180" [4.57m]

#### PANEL REVEALS

- Ø" [13mm] Horiz., Ø" [13mm] Vert.

Contact CENTRIA for other size options.

#### PERFORMANCE

- High performance air and water ratings
- AAMA 508-07
- AAMA 509-09

#### COATINGS

- Fluorofinish — Durable PVDF coating system
- Sundance MICA — 2-coat pearlescent PVDF coating system
- Sundance AM — 3-coat metallic PVDF coating system

Contact CENTRIA for coating options.



# METALWRAP™ SERIES

Insulated Composite Backup Panel System

CENTRIA's MetalWrap Series reimagines building envelope technology.

MetalWrap Series is more than an insulated composite backup panel—it's the ultimate backup wall that provides superior thermal performance and minimizes moisture and air penetration for nearly any type of exterior rainscreen system, from single skin metal and ACM to brick, terra cotta and others.

Designed with CENTRIA's innovative ATMP® building envelope science, MetalWrap Series includes an air and vapor barrier, along with insulation and a metal drain plane—controlling moisture without sacrificing thermal efficiency.

Heart of the City Health System  
Grand Rapids, MI  
Design Plus

## METALWRAP SERIES

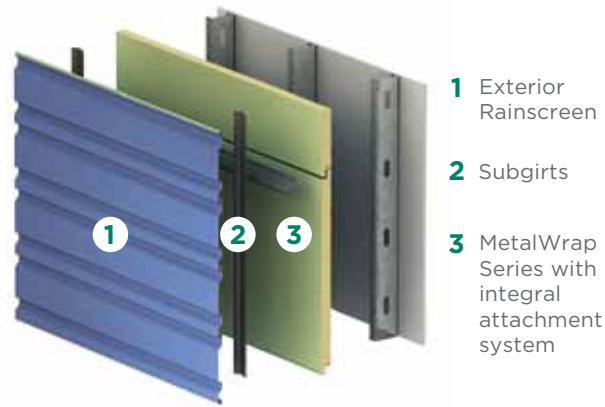

## TYPICAL BACKUP SYSTEM

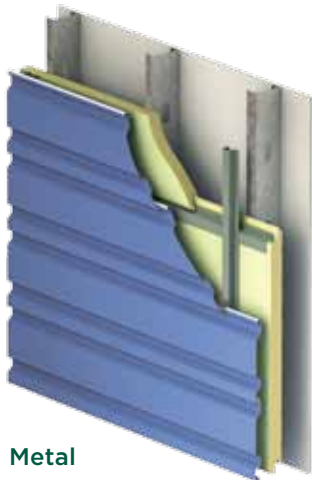
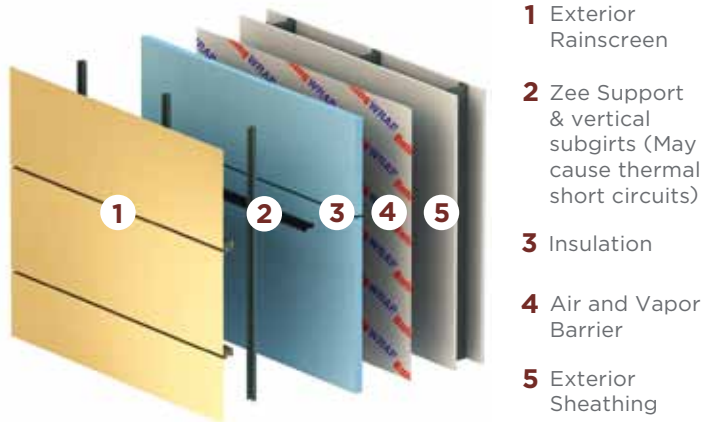

## FEATURES & BENEFITS

- Provides an air barrier, vapor and moisture control, drain plane and thermal performance in one composite assembly.
- Minimizes the potential for water penetration, air infiltration and thermal bridges.
- Encloses the building faster in all weather conditions.
- Works well for all building types in all climates.
- The flexibility to be installed both horizontally and vertically.
- Assembly thermal performance achieves U-factors that meet or exceed ASHRAE requirements.
- MetalWrap with different wall assemblies meets requirements for NFPA 285 multi-story fire test.
- Fully tested for air and water infiltration.

## DESCRIPTION

### HORIZONTAL INSTALLATION

	METAL   BRICK   TERRA COTTA
Thickness	2", 3"
Width	36"   32"   36"
Length (Std.)*	12' or 20'
Face	29 gage Galvalume with primer
Liner	29 gage Galvalume with primer
Foam Insulation	Min. 2.4 pcf polyisocyanurate
R Value	2" - R-14 3" - R-21

### VERTICAL INSTALLATION

	METAL   TERRA COTTA
Thickness	2.75", 4"
Width	36"
Length (Std.)*	12' or 20'
Face	26 gage G90 galvanized steel with primer
Liner	26 gage G90 galvanized steel with primer
Foam Insulation	Min. 2.4 pcf polyisocyanurate
R Value	2.75" - R-20 4" - R-26

\*Custom lengths 6' - 45' available. Consult CENTRIA.

# PROFILE SERIES

Reimagining Contemporary Design

Sherwood Middle School  
Shrewsbury, MA  
Lamoureux Pagano Architects

Profile Series takes the single-skin profile panel and elevates it to new levels of aesthetics, innovation and performance—in a highly cost-effective way.

With CENTRIA Profile Series, which includes Concept Series®, IW Series, Exposed Fastener Profiles, as well the unique fabrication of EcoScreen® Perforated Screenwall, your creativity knows no bounds. You have complete access to our full range of standard and custom colors, along with unlimited combinations of articulations, shadows, sight lines, and detail options—plus all of the panels can be installed vertically or horizontally. In addition, the panels work well for both new construction and retrofit projects, along with having the all-weather installation capability that keeps projects on time and on budget.

As part of a comprehensive system, additional design options include the Quietwall™ System, Firewall System, MicroSeam® Corners, MicroLine™ Extrusions, Profile Louvers and unique curved panels. Together, these are just a few more ways CENTRIA helps you reimagine contemporary design by reimagining metal.

PROFILE SERIES

# CONCEPT SERIES®

## Concealed Fastener Profiles



Concept Series single-skin panels have concealed fasteners and a common lock joint that allows the panels to be interchanged for interesting custom aesthetics.

Available in a wide range of profiles, Concept Series panels are perfect for insulated or uninsulated field-assembled walls.

For product profile options refer to page 26.

### FEATURES & BENEFITS

- Panels may be installed vertically and horizontally\*
- Common lock joint allows panels to be mixed freely for custom-like aesthetics
- Concealed clips and fasteners
- Cost effective with a clean, unbroken appearance allowing for interesting visual effects
- Excellent for new construction and retrofit projects
- All-weather installation capability shortens installation time, permits fast-track scheduling
- Panels are available with stucco-embossed or smooth finishes
- May be insulated to meet many levels of thermal protection
- Concealed extended leg option
- EcoScreen for CS-260 and CS-660 profiles
- Profile Louvers for CS-260 and CS-660 profiles

\*Horizontal applications require a backup with exterior sheathing and a weather-resistant air barrier.

### DESCRIPTION

#### SUBSTRATES

- Standard 24\*\*-18 gage G-90 galvanized steel
- Galvanized steel, galvalume® steel, aluminum or stainless steel — optional
- Smooth or embossed surface texture

#### CONCEPT SERIES PROFILES

- Lengths up to 30' [9.14m]
- Concealed clips and fasteners
- Stand-off clips provide ventilation cavity and continuous drain plane behind panel
- Horizontal or vertical wall installation
- Common joint design permits multiple profile integration
- Concealed extended leg option

Patent No.: US D538,948; D527,834

"Oil canning" is an inherent part of light gage cold-formed metal products, particularly those with broad flat areas. CENTRIA takes every precaution, as defined by MCA, to minimize the effects of oil canning. Lack of flatness or waviness due to oil canning is not sufficient cause for rejection of material

\*\* 24 gage only available in certain profiles. Consult CENTRIA.

**Davie West Building**  
Florida Atlantic University/  
University of Florida  
Davie, FL  
Schenkel Shultz



PROFILE SERIES

# IW SERIES

## Concealed Fastener Profiles

IW Series panels have no exposed fasteners for a clean, unbroken aesthetic in a variety of finishes. The panels also feature a common lock-joint design that makes interesting visual effects possible.

For product profile options refer to page 27.



### FEATURES & BENEFITS

- No exposed panel fasteners
- Cost effective, with a clean, unbroken appearance
- All panels are interchangeable because of the common lock-joint design which allows for interesting visual effects
- Excellent for new construction and retrofit projects
- All-weather installation capability shortens installation time; permits fast-track scheduling
- May be insulated to meet many levels of thermal protection
- Panels are available with stucco-embossed or smooth finishes and in flush, ribbed, striated and stepped profiles

NOTE: Swaged ends of 2" [51mm] length are available in 20 and 22 gages only. Not available in IW-12A, IW-14A, and IW-15A.

### DESCRIPTION

#### SUBSTRATE

- Standard 22-18 gage G-90 galvanized steel
- Galvalume® steel, aluminum or stainless steel – optional
- Smooth or embossed surface textures

#### IW SERIES PROFILES

- Lengths up to 30' [9.14m]
- Horizontal or vertical wall installation
- Lock-joint design of IW-10A through IW-41A makes panels interchangeable
- Horizontal applications require a backup with exterior sheathing and a weather-resistant air barrier
- Now available with MicroSeam® corners



PROFILE SERIES

# EXPOSED FASTENER PROFILES

Exposed Fastener Profiles are extremely versatile panels that can be used as exterior or interior walls, roofs and soffits with ribs that run horizontally or vertically.

For product profile options refer to page 28.



## FEATURES & BENEFITS

- Extremely versatile panels can be used as exterior or interior walls, roofs and soffits
- Ribs can be run either horizontally\* or vertically
- May be insulated to meet many levels of thermal protection
- Excellent negative wind load properties
- All-weather installation capability minimizes delays; permits fast-track scheduling
- Panels are available in stucco-embossed or smooth finishes

\* Horizontal applications require a backup with exterior sheathing and a weather-resistant air-barrier.

## DESCRIPTION

### SUBSTRATES

- Standard 24\*\* - 18 gage G90 Galvanized Steel
- Galvalume® Steel, aluminum or stainless steel - optional
- Smooth or embossed surface textures

\*\* 24 gage only available in certain profiles. Consult CENTRIA



### EXPOSED FASTENER PROFILES

- Horizontal or vertical wall installation
- Wall and roof installation
- Lengths up to 40' [12.19m], consult CENTRIA

PROFILE SERIES

# LINER PANELS

For product profile options refer to page 28.



## FEATURES & BENEFITS

- Incorporate liner panel, subgirts, varying thicknesses of noncombustible fiberglass insulation and any CENTRIA exposed fastener or concealed fastener panel for a complete field assembled wall system
- High "R" Values, depending upon insulation
- Provides a flush appearance to building interiors
- Perforated liner panels available for tested acoustical performance
- Firewall systems

## DESCRIPTION

Minimize heat loss or gain to conserve valuable energy with CENTRIA liner panels

### SUBSTRATE

- 24-18 gage G-90 galvanized steel

### PANEL WIDTH

- 24" [610mm]

### PANEL LENGTH

- 30'-0" [9.14m] max.

### PANEL THICKNESS

- L2 - 1-3/8" [35mm]
- L2-2 - 2" [51mm]
- L2-3 - 3" [76mm]
- L-21A - 1-1/2" [38mm] (for interior partitions)

**CS-200**

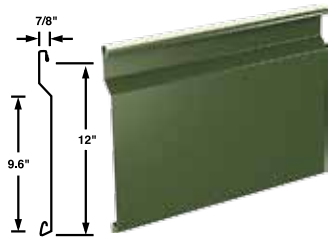

**CS-210**

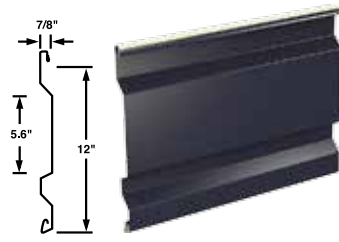

**CS-220**

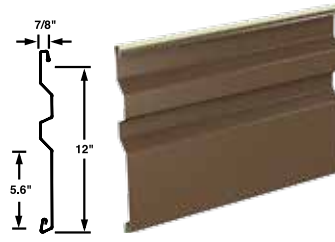

**CS-260**

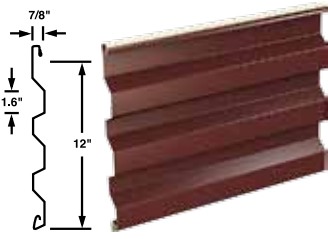

**CS-610**

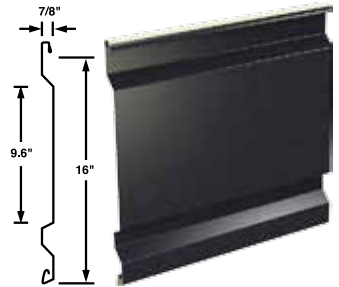

**CS-620**

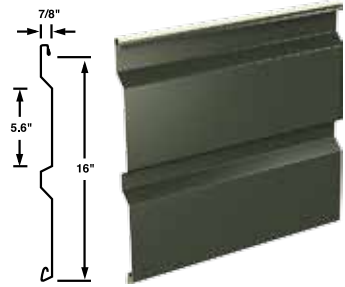

**CS-630**

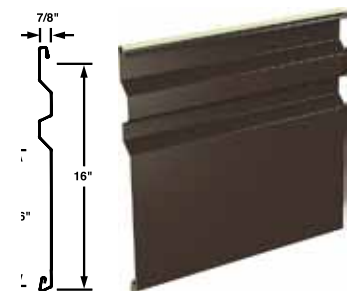

**CS-660**

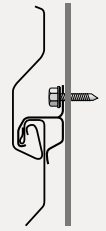
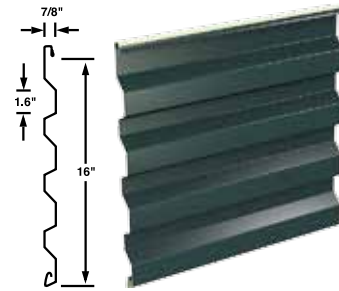

Concealed Clip Fastener (standard)



Concealed Extended Fastener Leg (optional)



South Texas Research Facility  
San Antonio, TX  
Rafael Vinoly Architects

IW-10A

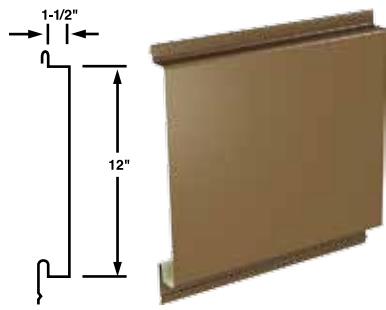

IW-11A

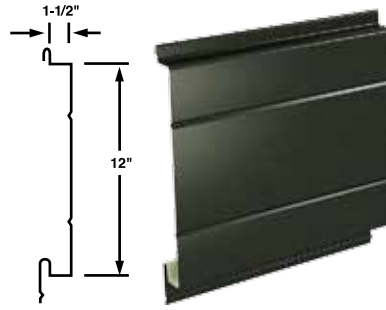

IW-12A

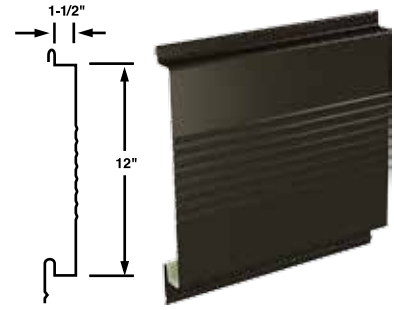

IW-13A

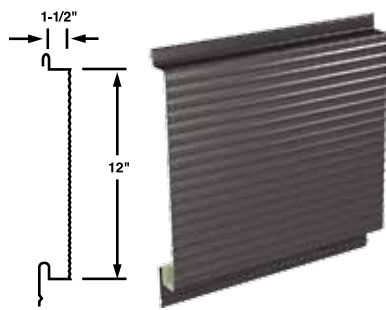

IW-14A

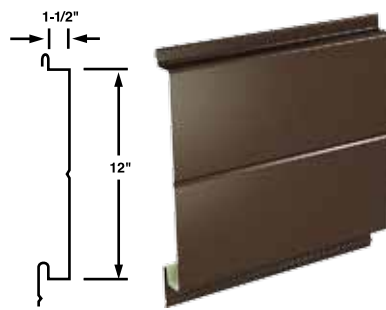

IW-15A

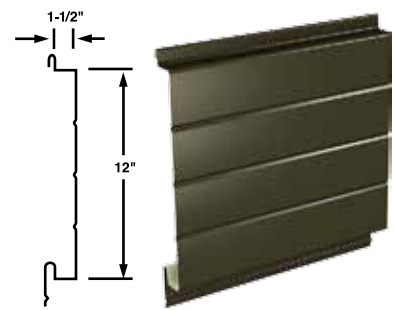

IW-20A

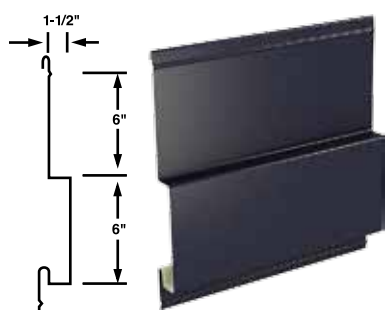

IW-21A

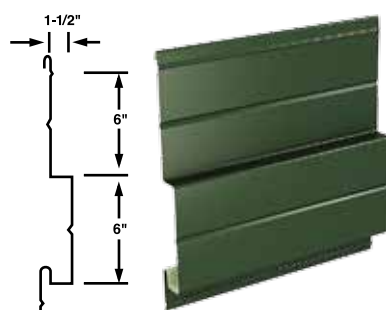

IW-30A

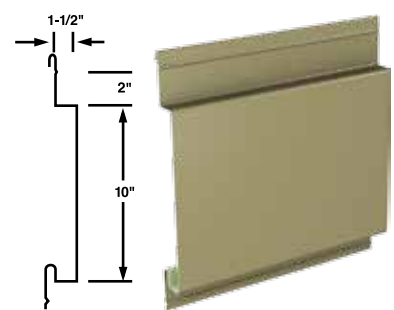

IW-31A

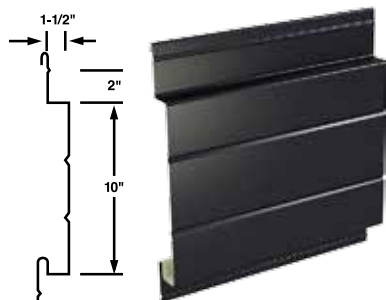

IW-40A

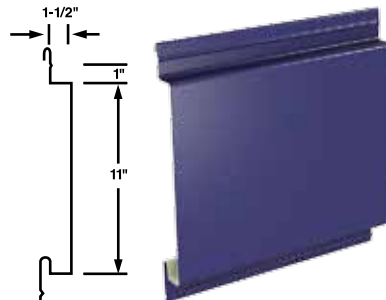

IW-41A

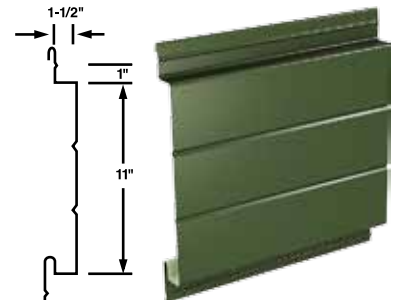

For information about product width in metric, please consult CENTRIA or visit CENTRIA.com.

**ECONOLAP 1/2"**

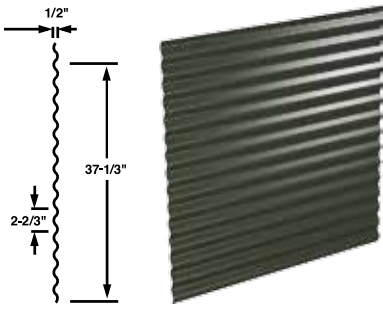

**ECONOLAP 3/4"**

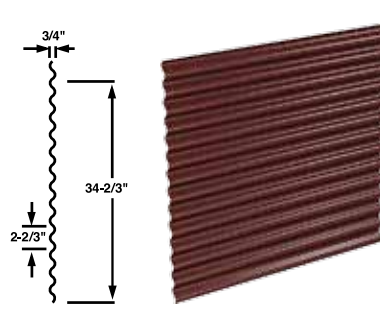

**MR3-36**

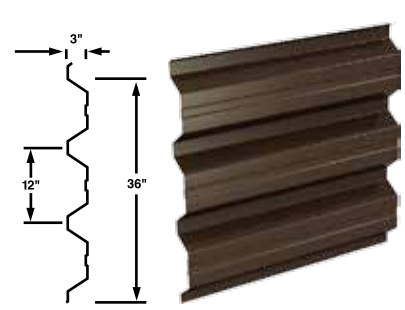

**TR4-36**

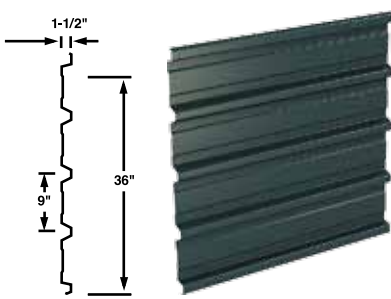

**STYLE-RIB**

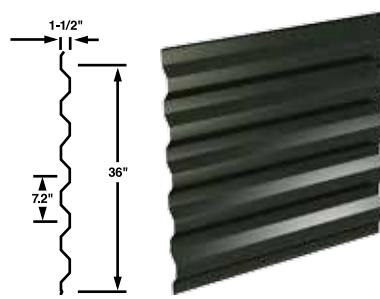

**BR5-36**

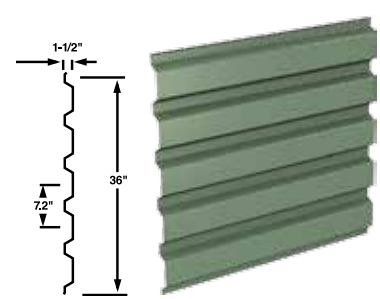

PROFILE SERIES **LINER PANELS** Product Details

**SUPER-RIB**

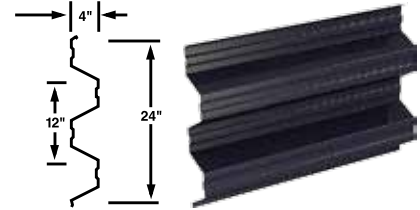

**L2**



**L2-2**



**L2-3**



**L-21A**



**L2**

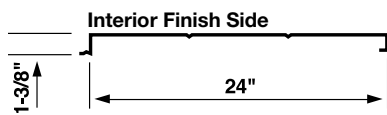

**L2-2**

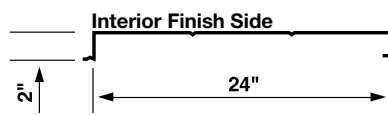

**L2-3**

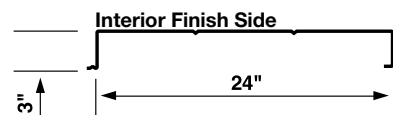

**L-21A**

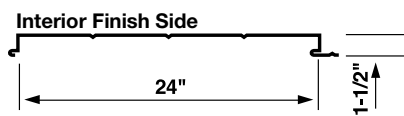

PROFILE SERIES

# ECOSCREEN®

## Perforated Screenwall

Through the use of a unique fabrication process, EcoScreen perforated screen walls provide an airy aesthetic and outstanding performance that elegantly blends industrial and other applications with their surroundings.

BR5-36

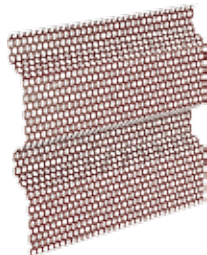

CS-260



CS-660



ECONOLAP 3/4"

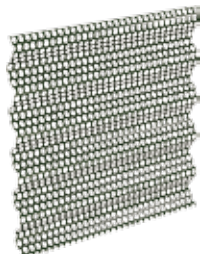

MR3-36

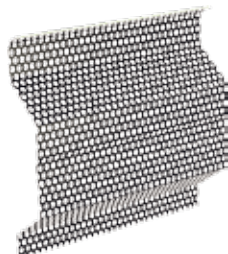

STYLE-RIB

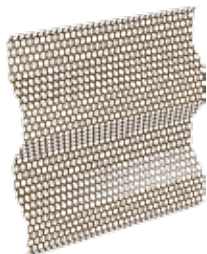

Images showing standard 40% open area staggered pattern, 3/8" [10mm] diameter, 9/16" [14mm] spacing.

### ECOSCREEN PERFORATION PATTERN OPTIONS

Open/Free Area	Pattern	Diameter (in)	Spacing (in)
10	Reverse	1/8	3/8
23	Staggered	1/8	1/4
23	Reverse	1/4	1/2
30	Staggered	1/8	7/32
33	Staggered	3/16	5/16
40	Staggered	1/8	3/16
<b>40</b>	<b>Staggered</b>	<b>3/8</b>	<b>9/16</b>

Bold lines are standard. For additional patterns, contact CENTRIA.



# DESIGN OPTIONS



## MICROSEAM® CORNERS

MicroSeam Corners use cutting edge structural bonding techniques to produce corners that appear virtually seamless. Manufactured from the same metal substrate coil as the panels, MicroSeam corners employ no welding and no pop rivets. Like all CENTRIA panels, they are fully tested for performance. MicroSeam Corners are available on BR5-36, Econolap 3/4", MR3-36, Style-Rib, Super-Rib, TR4-36, all Concept Series profiles and all IW Series profiles. They are also available in CENTRIA's full palette of nearly 100 colors, including metallics and Versacor Ultra.

## MICROLINE™ EXTRUSIONS

MicroLine details incorporate aluminum extrusions designed to integrate visually and mechanically with CENTRIA Profile Series Concept Series panels. Slim 2" [51mm] wide MicroLine extrusions make it a snap to trim and finish around windows and doors, inside or outside corners, and at the base of walls; or to create clean vertical joints. MicroLine details enable you to replace wide obtrusive flashing and exposed fasteners with narrower, crisper and cleaner finished lines, and can be finished to match or complement wall panels. Also available for horizontal IW Series, Style-Rib, BR5-36, Econolap 3/4" and TR4-36. MicroLine details are available for Concept Series profiles in horizontal and vertical applications.

## PROFILE LOUVERS

CENTRIA Profile Louvers come in gages, colors and finishes to match corresponding panels and blend invisibly into a wall, eliminating visual breaks in site lines. Profile Louvers are available for horizontal installation with BR5-36, Inverted BR5-36, MR3-36, CS-260, CS-660, Style-Rib or Super-Rib wall panels. Variable blade depths from 1-1/2" to 8" [38mm to 203mm] create free area from 10% to 49% for air intake or exhaust.

## CURVED PANELS

With CENTRIA curved panels you can add radius design elements to your projects. Available in a wide selection of exposed fastener profiles, finishes and colors to match virtually any architectural, commercial or industrial application. Curved panels are ideal for canopies and awnings, roofing, fascia, walls, curved parapets, curved trim, column and beam wraps, where they can be used to add bold visual statements or innovative special effects.

CENTRIA fabricates curved panels from a variety of architectural panel profiles. They are available in a number of finishes to match your application, and in the full CENTRIA color palette.

PROFILE SERIES

# QUIETWALL™ & FIREWALL

Systems

## QUIETWALL SYSTEM

CENTRIA Quietwall systems help you select a wall system with specific sound absorption or transmission loss values that your design requires — more economically and more efficiently.

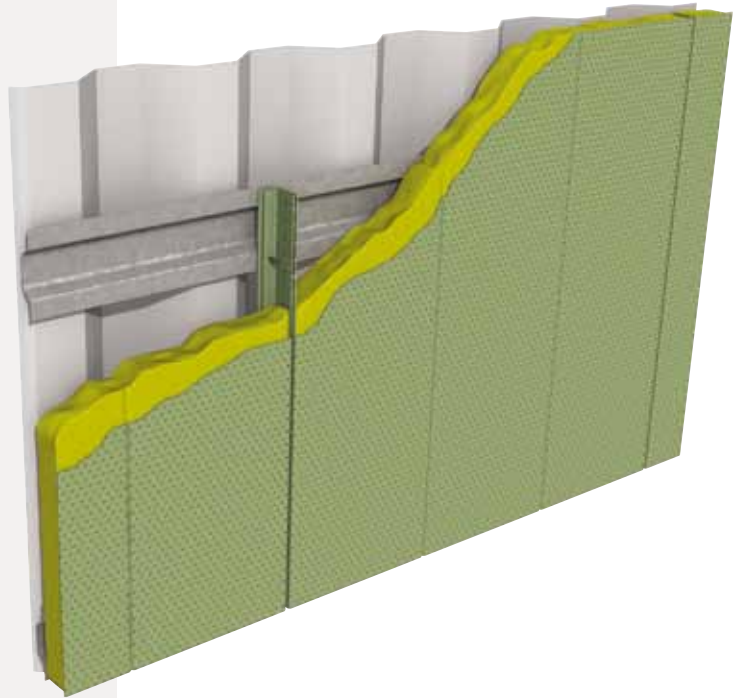

## FIREWALL SYSTEM

With the CENTRIA firewall system, layers of gypsum board between the exterior Profile panel and the insulation and liner panel create UL one-hour through four-hour firewalls based on ASTM E119 fire tests.

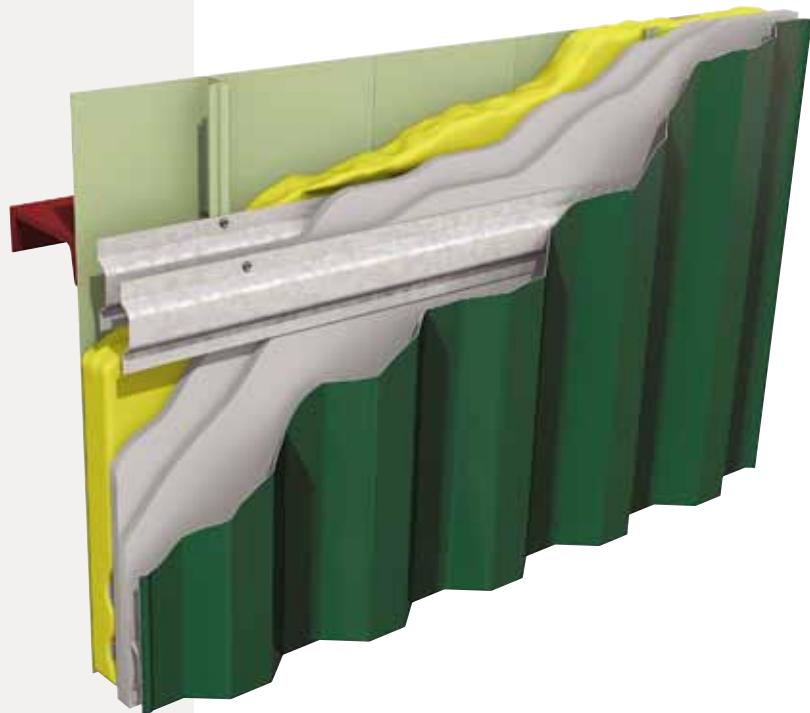

## OTHER SYSTEMS

- Explosion Release
- RF Shielding

# SRS®

## Structural Standing Seam Roof Systems

Harrison County Hospital  
Corydon, IN  
Laughlin Millea Hillman Architecture, Inc.  
Walker Architects, Inc.

### CENTRIA reimagines the classic structural standing seam roof system (SRS)

Designed to provide clean, unbroken lines with minimal exposed fasteners, continuous transitions and long panel lengths, CENTRIA's SRS offers dynamic aesthetic possibilities.

CENTRIA's SRS also provides outstanding performance with a unique concealed clip and panel interlock design that allows unimpeded thermal movement without damage. In addition, the mechanical seaming of roof panels in the field ensures superior weather resistance.





## FEATURES & BENEFITS

- Long panel lengths eliminate transition flashing, enhance weather resistance
- Unique concealed clip and panel interlock design allows unimpeded thermal movement without damage
- Mechanical seaming of roof panels in the field ensures weather resistance and enhances appearance
- UL 580 Class 90 listing
- FM 1-90 and FM-180 for SRS 3
- Dade County NOA for SRS 3
- Low slope applications:  
1/2:12 [2.40°] without endlaps  
1:12 [4.76°] with endlaps
- Can be field roll-formed, eliminating endlaps
- SRS 3 can be curved to various radii

## DESCRIPTION

Structural standing seam roof systems

### SUBSTRATES

- SRS 3 — 24-18 gage
- G90 galvanized steel, Galvalume, stainless steel\*, and aluminum

### PANEL WIDTH

- 12" [305mm], 16" [406mm], 18" [457mm]

### PANEL DEPTHS

- SRS 3 — 3" [76mm]

### PANEL LENGTH

- Factory-formed — up to 48'0" [14.63m] max.  
– standard, up to 60'0" [18.29m] — optional
- Field-formed — 220'0" [67.06m] max.

Oil canning within industry standard guidelines as defined by MCA is not a cause for rejection.

\* SRS 2 is not available in stainless steel.

## SRS 3 CURVED

- SRS 3 mechanical curving process
- Available in 12" [305mm], 16" [406mm] and 18" [457mm] widths
- Curving performed on-site or in the plant, using CENTRIA-supplied equipment
- Consult CENTRIA for the minimum radius available for each gage

### SRS 3 PLANKED

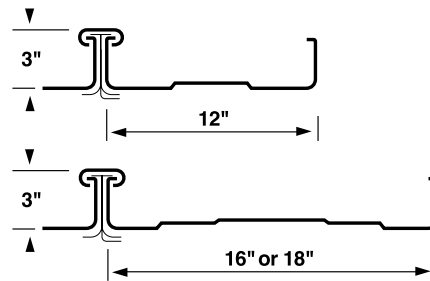

### Architectural Design Panels

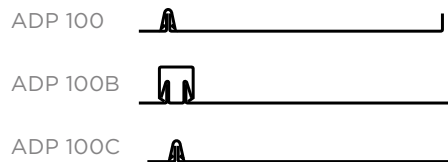

### Structural Design Panels



Parkway Central High School Science Lab  
Chesterfield, MO  
Parsons Brinkerhoff



# VENTILATION

## Systems

University of Louisville Ralph Wright Natatorium  
Louisville, KY  
Browning Day Mullins Dierdorf Architects

CENTRIA offers a range of ventilation systems to complete any wall system.

Choose from profile louvers, C/S louvers, continuous ridge ventilators, continuous clamshell ventilators and small streamline ventilators.

### FEATURES & BENEFITS

#### PROFILE LOUVERS

Matched to CENTRIA BR5-36, Inverted BR5-36, MR3-36, Concept Series, CS-260/CS-660, Style-Rib and Super-Rib panels.

- Integrate architecturally with horizontal building panel lines

#### C/S LOUVERS

CENTRIA and C/S Group also provide a full line of fixed, drainable and storm-resistant louvers engineered for seamless integration with Dimension Series panels.

#### CONTINUOUS RIDGE VENTILATORS (CRV)

Energy-saving products that use gravity to provide maximum air flow

- Available with throat openings from 2'-0" [610mm] to 20'-0" [6.10m]
- Weathertight, low maintenance, self-cleaning
- Available accessories include dampers, screens and operators

#### CONTINUOUS CLAMSHELL VENTILATORS (CSV)

Function like CRVs while offering increased capabilities

- For extreme heat areas, throat openings of up to 32'-0" [9.75m] are possible using double CSVs on a monitor roof
- Available from 8'-0" [2.44m] through 16'-0" [4.88m]

#### SMALL STREAMLINE VENTILATORS (SSV)

Factory-assembled in 10' [3.05m] sections with fixed or operable dampers

- Factory assembled in 10'-0" [3.05m] sections
- Fixed or operable dampers

# COATING SYSTEMS & SUBSTRATES

CENTRIA has been reimagining the art and science of producing richly hued and textured, high performance, high value color coated metal walls and roofs. This includes a wide variety of innovative coating systems, a full range of colors including custom color matching, and an array of substrates and surface textures to meet the most challenging environmental conditions.

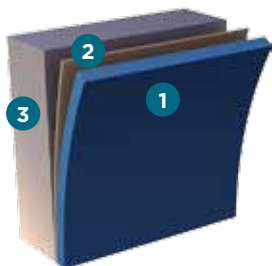

## FLUOROFINISH®\*

A Kynar 500® or Hylar 5000® coating that provides good durability.

- 1 0.8 mil [20 micron] nominal Color Coat
- 2 0.2 mil [5.1 micron] nominal Primer
- 3 Substrate

## DURAGARD® PLUS

A premium, high build architectural coating that provides the ultimate in color retention and fade resistance.

- 1 0.8 mil [20 micron] nominal Polyvinylidene Fluoride Clear Coat\*
- 2 0.8 mil [20 micron] nominal Polyvinylidene Fluoride Color Coat\*
- 3 0.8 mil [20 micron] nominal Primer
- 4 Substrate

## DURAGARD®

0.8 mil [20 micron] nominal Polyvinylidene Fluoride Color Coat\*

0.8 mil [20 micron] nominal Primer

## SUNDANCE MICA\* 2-COAT FINISH

A high performance PVDF coating that provides good durability.

- 1 0.8 mil [20 micron] nominal Color Coat
- 2 0.2 mil [5.1 micron] nominal Primer
- 3 Substrate

## SUNDANCE AM-ALUMINIUM METALLIC 3-COAT FINISH

A quality, durable coating that provides the iridescence and reflectivity of a metallic surface.

- 1 0.5 mil [12.7 micron] nominal Polyvinylidene Fluoride Clear Coat\*
- 2 0.8 mil [20 micron] nominal Polyvinylidene Fluoride Color Coat\*
- 3 0.2 mil [5.1 micron] nominal Primer
- 4 Substrate

## DURACAST® TEXTURED FINISH SYSTEM\*\*

Factory-applied coating with natural aggregate matrix providing the look and feel of precast. Available exclusively for Formawall Dimension Series, Formawall Graphix Series and Versawall panels.

- 1 Acrylic and Natural Aggregate Matrix
- 2 0.8 mil [20 micron] nominal Polyester
- 3 0.2 mil [5.1 micron] nominal Primer
- 4 Substrate

## VERSACOR® ULTRA

A premium, high build, multi-layer coating for applications where corrosion and abrasion resistance is more important.

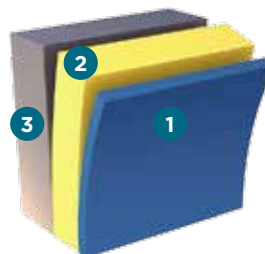

## VERSACOR® ULTRA PF and MX

Excellent coatings for corrosive architectural applications. Versacor Ultra MX has a PVDF coat with mica, providing a pearlescent appearance.

- 1 0.8 mil [20 micron] nominal PVDF Coat
- 2 3.0 mil [75 micron] nominal Versacor Ultra Barrier Coat Primer
- 3 Substrate

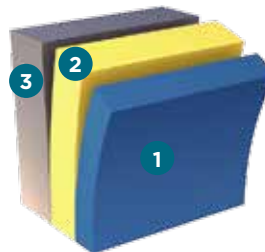

## VERSACOR® ULTRA TF and HF

A coating merging the superior corrosion resistance of the Versacor Barrier Coat Primer with the durability of a Urethane Finish.

- 1 1.5 or 3.0 mil [38 or 75 micron] nominal Urethane Coat
- 2 3.0 mil [75 micron] nominal Versacor Ultra Barrier Coat Primer
- 3 Substrate

## WHAT IS REVERSE SIDE COATING PROTECTION?

On CENTRIA's Profile Series panels with a Versacor Ultra Coating System, an additional Versacor Ultra Barrier Coat Primer is applied to the interior of the metal substrate. A wash coat is applied over the barrier coat and other top coats are available, such as PVDF, urethane or polyester. This additional coating provides superior protection against corrosion from the interior and at lap conditions.

## AVAILABLE SUBSTRATES

- Standard G-90 hot-dip galvanized steel conforming to ASTM A924 and ASTM A653 structural quality
- Galvalume steel, unpainted hot-dip coated with aluminum-zinc alloy conforming to ASTM A924 and ASTM A792
- Stainless Steel\*\*, Type 304 AISI architectural grade alloy; austenitic, non-magnetic, non-glare surface; slight variation in surface finish
- Aluminum Alloy 3003 or 5052 and for standing seam roof panels, 3004\*\*, available in smooth surface as a substrate
- Galvalume steel not available with Versacor Ultra

\* Polyvinylidene Fluoride (PVDF) coat contains 70% Kynar 500 or Hylar 5000 resin. Kynar 500 is a Reg. TM of Atofina Chemicals, Inc. Hylar 5000 is a Reg. TM of Solvay Solexix, Inc. Galvalume is a Reg. TM of BIEC International, Inc.

\*\* Subject to minimum quantity requirements.

# COLORS

## PRISMATIC™ SERIES COLORS — FLUOROFINISH, DURAGARD AND DURAGARD PLUS

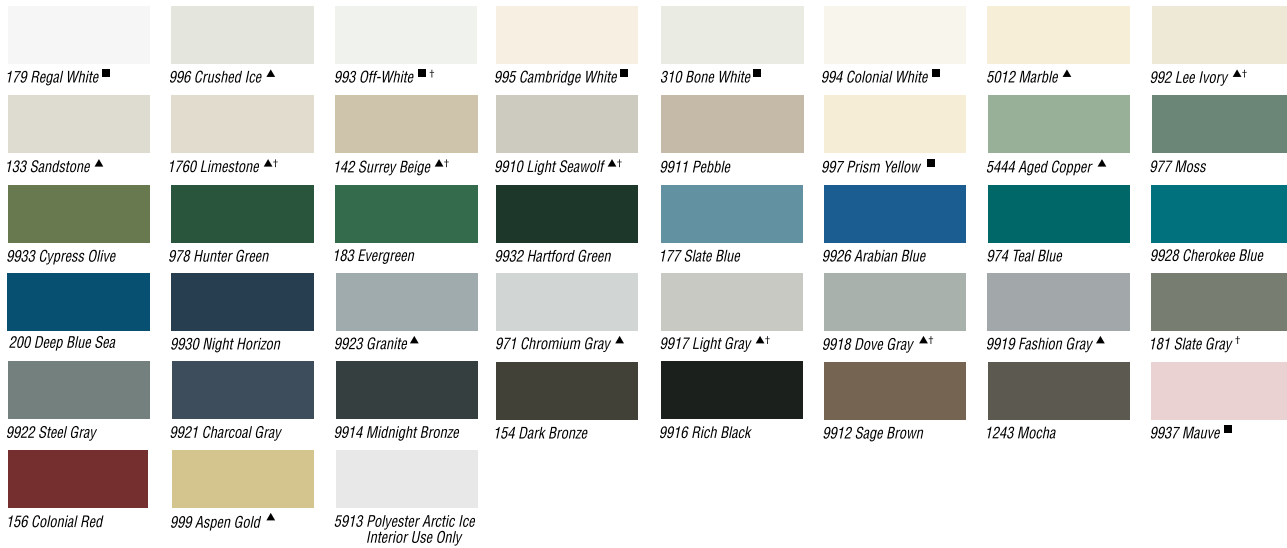

Unless specified otherwise, CENTRIA will provide a standard backer coat on the reverse side of single skin panels. Color may vary.

Polyester Arctic Ice is the standard finish offering for the interior surfaces of foam panels. Other finishes available upon request.

■ These colors meet the low-slope and steep slope SRI requirements for LEED-NC SS Credit 7.2.

▲ These colors meet the steep-slope SRI requirements for LEED-NC SS Credit 7.2.

† Standard Duracast finish color. Consult CENTRIA for custom colors.

Colors shown are for preliminary selection only. Printed colors can vary from actual painted material.

Contact CENTRIA for painted metal samples before final selection.

NOTE: Because of the differences in the formulation and application properties of spray-applied coatings versus coil coatings, a slight color variation is likely to occur when matching coatings of these different types.

## SUNDANCE™ SERIES COLORS

### Sundance Mica 2-coat

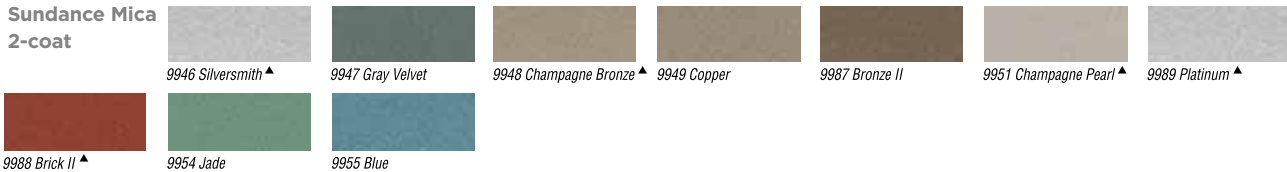

### Sundance AM Aluminum Metallic 3-coat



Custom colors may require an additional clear and/or barrier coat. Consult CENTRIA for details.

## DURACAST®



NOTE: Galvalume, Stainless and Aluminum may not be available for all product profiles or coating systems. Consult CENTRIA sales. Galvalume offers improved heat resistance only when used unpainted.

# KOLORSHIFT™ SERIES

The KolorShift Series truly reimagines the design possibilities of color with exterior metal walls that shift in color depending on the viewing angle or direction of sunlight. The end result is a continuous iridescent color gradient.

KolorShift Series paints are formulated as a polyvinylidene fluoride (PVDF) coating system with 70% Kynar 500®/Hylar 5000® resins, which provide lasting durability. They are available with a standard 20-year warranty.

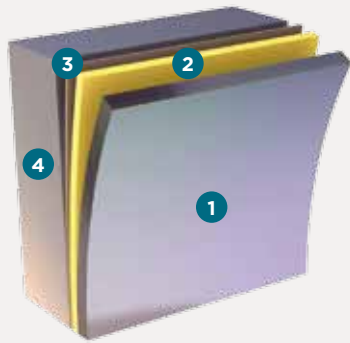

## KOLORSHIFT

An iridescent polyvinylidene (PVDF) architectural coating

- 1 0.8 mil [20 micron] nominal PVDF Color Coat
- 2 0.5 mil [12.7 micron] Polyester Base Coat
- 3 0.2 mil [5.1 micron] Polyester Primer
- 4 Substrate

Kynar 500 is a Registered Trademark of Atofina Chemicals, Inc.  
Hylar 5000 is a Registered Trademark of Solvay Solvents, Inc.

Kolorshift paints are applied by coil coating to provide consistency of color. Spray coating matches are not available. It is recommended that trim required for Kolorshift coated projects use brake-formed trim or a complimentary color in a standard PVDF for extrusions. Contact CENTRIA for availability of MicroSeam® corners with a Kolorshift finish.

valspar

## COLORS AVAILABLE

BASE COLOR FLOP COLOR



731 Hemlock



732 Dusty Rose



733 Green Shimmer



734 Purple Rain



735 Lightning Storm

# ALLUSION™

The Allusion pre-finished decorative paint system is one more way CENTRIA helps architects reimagine metal for their designs. The system accurately simulates expensive natural finishes, including wood and specialty metals, using high performance print coating technology that is less expensive and lower maintenance than natural materials.

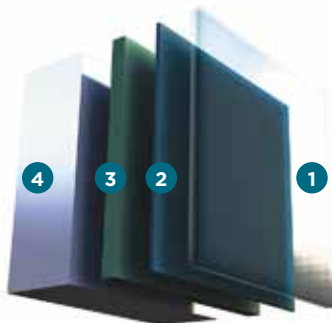

A pre-coated finish system using polyvinylidene (PVDF) print pattern colors

- 1 45 mil [11.475 micron] nominal PVDF Clear Top Coat
- 2 05 mil nominal PVDF ink
- 3 65 mil [16.575 micron] nominal Color Base Coat (also acts as primer)
- 4 Metal Substrate



761 Light Oak

762 Dark Oak



763 Rust

764 Slate



765 Antique Bronze

# PRODUCT FINISH AVAILABILITY

PANELS	FINISHES									SUBSTRATES			
	Fluorofinish	Duragard	Duragard Plus	Sundance Mica	Sundance A-M-Metallic	Duracast	Versacor Ultra PF, TF, HF, MX	Kolorshift	Allusion	G90 Galvanized	Galvalume	Aluminum	Stainless Steel
FW Dimension Series	X	X	X	X	X	X	X <sup>2</sup>	X	X	X		X <sup>1</sup>	X <sup>1</sup>
FW Graphix Series	X	X	X	X	X	X	X <sup>2</sup>	X	X	X		X <sup>1</sup>	
Formavue	X	X	X	X	X			X	X			X	
FWDS Louvers	X	X	X	X	X			X	X			X	
FWDS Sunshades	X	X	X	X	X			X	X			X	
Versapanel	X	X	X	X	X	X	X <sup>2</sup>	X	X	X			
Versawall	X	X	X	X	X	X	X <sup>2</sup>	X	X	X			
FormaBond	X			X	X			X	X			X	
FormaBond II	X			X	X							X	
Concept Series	X	X	X	X	X		X <sup>2</sup>	X	X	X	X	X	X
IW Series	X	X	X	X	X		X <sup>2</sup>	X	X	X	X	X	X
BR5-36	X	X	X	X	X		X <sup>2</sup>	X	X	X	X	X	X
Econolap 1/2"	X	X	X	X	X		X <sup>2</sup>	X	X	X	X	X	X
Econolap 3/4"	X	X	X	X	X		X <sup>2</sup>	X	X	X	X	X	X
MR3-36	X	X	X	X	X		X <sup>2</sup>	X	X	X	X	X	X
Style-Rib	X	X	X	X	X		X <sup>2</sup>	X	X	X	X	X	X
Super-Rib	X	X	X	X	X			X	X	X	X	X	
TR4-36	X	X	X	X	X		X <sup>2</sup>	X	X	X	X	X	X
Profile Louvers	X	X	X	X	X		X <sup>2</sup>	X	X	X	X		
L2	X	X	X	X	X		X <sup>2</sup>	X	X	X	X		
L2-2	X	X	X	X	X		X <sup>2</sup>	X	X	X	X		
L2-3	X	X	X	X	X		X <sup>2</sup>	X	X	X	X		
L-21A	X	X	X	X	X		X <sup>2</sup>	X	X	X	X		
ADP-100	X			X				X	X	X	X		
ADP-100B	X			X				X	X	X	X		
ADP-100C	X			X				X	X	X	X		
SDP-175	X			X	X		X <sup>2</sup>	X	X	X	X		
SDP-200	X			X	X		X <sup>2</sup>	X	X	X	X		
SRS 3	X	X	X	X	X		X <sup>2</sup>	X	X	X	X	X	X

Certain panel profiles and options may not be available in all finish and gage combinations. Contact CENTRIA for availability.

<sup>1</sup>Stainless and aluminum are available for face elements only and not liner elements.

<sup>2</sup>Consult CENTRIA for profile, gage and finish availability.

# PROJECT INDEX



Cover, Page 3  
**North Carolina National Guard Headquarters**  
 Raleigh, NC  
 A: O'Brien Atkins Architecture  
 C: Shelco Inc.  
 D: Steel Clad



Page 4  
**Devon Boathouse and Finish Line Tower**  
 Oklahoma City, OK  
 A: Elliot and Associates  
 C: Timberlake Construction/Smith & Pickel  
 D: W.J. Coe & Company, Inc.



Page 7  
**Wolfe Center for Performing Arts**  
**Bowling Green State University**  
 Bowling Green, OH  
 A: Snohetta/The Collaborative  
 C: Rudolph Libbe  
 D: C.L. Rieckhoff



Page 8  
**North Seattle Community College**  
 Seattle, WA  
 A: Schacht Aslani Architects  
 D: Snyder Architectural Systems



Page 12  
**Families, Inc.**  
 Jonesboro, AR  
 A: CahoonSteiling Studio Architecture  
 C: Tate General Contractors, Inc.  
 D: Sold Direct



Page 16  
**Faribault Energy Park**  
 Faribault, MN  
 A: Nelson Architects  
 C: Dahlen Berg & Co.  
 D: Armetex



Page 18  
**Baylor Charles A. Sammons Cancer Center**  
 Dallas, TX  
 A: Perkins + Will  
 C: MEDCO Construction  
 D: National Panel Systems, Inc.



Page 20  
**Heart of the City Health System**  
 Grand Rapids, MI  
 A: Design Plus  
 C: Pioneer Construction  
 D: Architectural Metals, Inc.



Page 22  
**Sherwood Middle School**  
 Shrewsbury, MA  
 A: Lamoureaux Pagano Architects  
 C: Gilbane Building Company  
 D: LYMO Construction



Page 23  
**Davie West Building**  
**Florida Atlantic University/University of Florida**  
 Davie, FL  
 A: Schenkel Shultz  
 C: Pirtle Construction Company  
 D: Cladding Systems



Page 24  
**Mazda Dealership**  
 Elk Grove, CA  
 A: Martin Consulting Group  
 C: Chatfield Construction Inc.  
 D: Blackwood Associates, Inc.



Page 25  
**Lincoln Elementary**  
 Louisville, KY  
 A: Bravura Architects  
 D: D T & Associates, Inc.



Page 26  
**South Texas Research Facility**  
 San Antonio, TX  
 A: Rafael Vinoly Architects  
 C: Vaughn Construction  
 D: Wade Architectural Systems



Page 29  
**Interurban Transit Partnership**  
**Wealthy Street Operations Expansion**  
 Grand Rapids, MI  
 A: Progressive AE  
 C: Christman Company  
 D: Architectural Metals Inc.



Page 32  
**Harrison County Hospital**  
 Corydon, IN  
 A: Laughlin Millea Hillman/Walker Architects, Inc.  
 C: Whittenberg Construction Co.  
 D: J.C. Industries Inc.



Page 34  
**Parkway Central High School Science Lab**  
 Chesterfield, MO  
 A: Parsons Brinkerhoff  
 C: ICS Construction Services  
 D: Mays Maune McWard Inc.



Page 34  
**University of Louisville**  
**Ralph Wright Natatorium**  
 Louisville, KY  
 A: Browning Day Mullins Dierdorf Architects  
 C: Wittenberg Construction Company  
 D: J.C. Industries Inc.



To view photos of these and many more CENTRIA projects, visit our portfolio.



**CENTRIAPerformance.com**  
1.800.759.7474

1005 Beaver Grade Road  
Moon Township  
PA 15108-2944  
Phone: 412.299.8000  
Fax: 412.299.8317  
Office of Business Development  
Phone: 860.490.2670

**NORTHEAST  
REGION**

**1.800.586.1372**

Baltimore, MD  
P: 410.549.6018  
F: 410.795.5984

Boston, MA  
P: 978.779.7929  
F: 978.779.7930

Cincinnati, OH  
P: 513.793.9160  
F: 513.793.9161

Hartford, CT  
P: 860.659.4045  
F: 860.659.4034

Newark, NJ  
P: 973.860.8804  
F: 973.744.2041

New York, NY  
P: 914.834.7697  
F: 914.833.1843

Philadelphia, PA  
P: 215.643.6040  
F: 215.643.0629

Pittsburgh, PA  
P: 412.299.8175  
F: 412.299.8016

Syracuse, NY  
P: 315.214.3753  
F: 315.214.3753

Washington, DC  
P: 703.406.9588  
F: 703.406.9457

**SOUTH CENTRAL  
REGION**

**1.800.586.1372**

Atlanta, GA  
P: 770.778.7997  
F: 770.518.8693

Charlotte, NC  
P: 704.341.0202  
F: 704.341.0204

Chicago, IL  
P: 262.538.4415  
F: 262.538.4417

Detroit, MI  
P: 734.516.6929 (cell)  
F: 734.529.7257

Greenville, SC  
P&F: 803.569.1212

Indianapolis, IN  
P&F: 317.456.7920

Memphis, TN  
P: 901.550.0355  
F: 901.861.8144

Minneapolis, MN  
P&F: 763.577.1417

Sarasota, FL  
P&F: 941.893.3411

Western Michigan  
P&F: 248.486.8939

**WEST  
REGION**

**1.888.745.8527**

Dallas, TX  
P: 972.422.5856  
F: 972.390.9103

Denver, CO  
P: 303.743.7430  
F: 303.743.7451

Houston, TX  
P: 281.397.9900  
F: 281.397.6363

Phoenix, AZ  
P: 480.282.2799  
F: 602.997.7062

Sacramento, CA  
P: 408.768.9595  
F: 408.243.6182

San Francisco, CA  
P: 650.369.9400  
F: 650.369.9483

St. Louis, MO  
P: 314.432.3434  
F: 314.432.6863

Seattle, WA  
P: 253.460.3779  
F: 253.460.1664

Southern California  
(Los Angeles)  
P: 949.589.0997  
F: 562.690.1610

Due to CENTRIA's policy of continuous improvement, we reserve the right to change, discontinue or modify our products, specifications and designs without notice and without incurring obligations.

