



CENTRIA

VERSAPANEL[®]

INSULATED METAL COMPOSITE WALL & ROOF SYSTEM



Versapanel

STRENGTH, BEAUTY

CENTRIA Versapanel is both a wall and a structural standing seam roof system. These composite insulated metal panels are formed with a galvanized steel face and liner with preformed joinery and thick, rigid CFC-free foam insulation. The result is a remarkably strong but lightweight panel with an extraordinary spanning capability. Lengths are available up to 48' [14.63m] with insulation values as high as R 27 [RSI 4.90].

Virtually all building types, including office buildings, schools, hospitals, arenas and stadiums can benefit from the strength, beauty and efficiency of Versapanel.

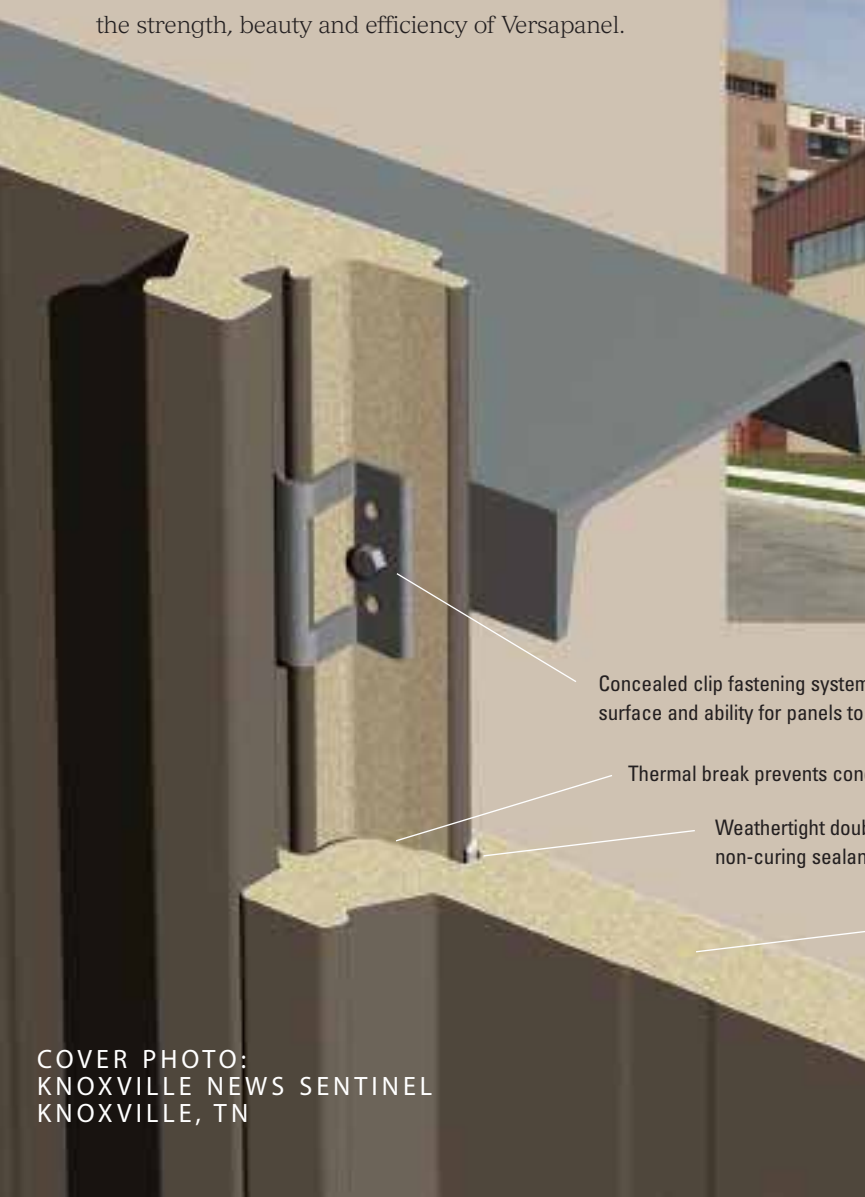

Concealed clip fastening system provides a clean uninterrupted surface and ability for panels to accommodate seismic forces

Thermal break prevents conduction between face and liner panels

Weathertight double tongue-and-groove vertical joinery with factory-applied non-curing sealant that provides a complete air and vapor barrier

High-efficiency 94% closed cell CFC-free foam insulation

QUALITY, EFFICIENCY

all in one

U.S. NAVY WAREHOUSE
NORFOLK, VA



SPECIFICATIONS

SUBSTRATES

- Standard 26/26 [.45mm/.45mm] gage, ASTM A653, Grade 37, G-90 galvanized steel face and liner with CFC-free isocyanurate foam insulated core
- Optional gages available – consult CENTRIA

JOINERY

- Double tongue-and-groove joinery with factory-applied air and vapor seal
- Snap-on batten required for roofing applications

SURFACE FINISH

- Exterior – Non-directional embossing, flat or planked
- Interior – Non-directional embossing, planked
- 1-3/4" [44mm] high rib, 3' [914mm] on center

PANEL WIDTH – 36" [914mm]

PANEL LENGTH

- 6' [1.829m] to 40' [12.192m] standard
- 48' [14.63m] max. consult CENTRIA

PANEL THICKNESS – 1-3/4" [44mm], 2-1/2" [64mm], 4" [102mm]

"R" VALUE

- 1-3/4" [44mm] – R14* [R_{SI} 2.54]
- 2-1/2" [64mm] – R19* [R_{SI} 3.41]
- 4" [102mm] – R27* [R_{SI} 4.83]

FINISHES AND COLORS

- Available in the industry's widest variety of durable finish systems in over 70 standard and unlimited custom colors, including micas and metallics

*Testing based on ASTM C 1363 test procedures.
Air films included.

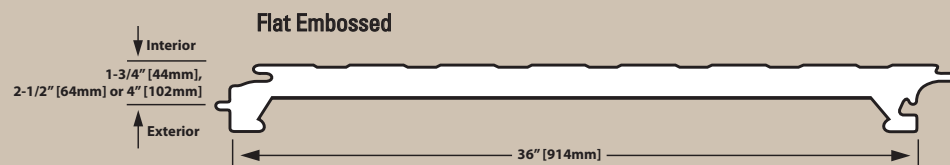
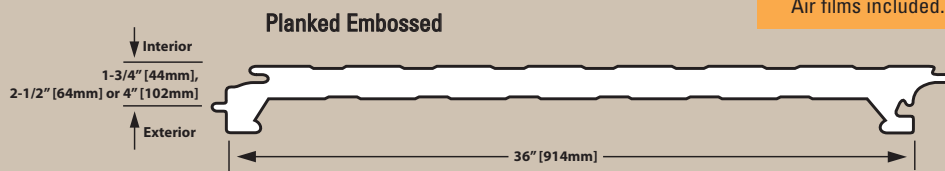

Versapanel FRIENDLIER

to our world



Architects frequently use the interior side of Versapanel as the finished interior wall – further reducing material usage.



LINCOLN FINANCIAL FIELD
PHILADELPHIA, PA

Architects and owners also appreciate the environmental benefits of Versapanel. In just one component – comprised of a limited amount of material, with a high degree of both recycled and recyclable content – a complete, long-lasting, energy-efficient exterior wall or roof is created. As a wall, Versapanel eliminates batt insulation, gypsum sheathing and building wrap. As a roof, it eliminates a plywood or steel deck substrate.



VERSAPANEL WALL AND ROOFS MEET OR EXCEED REQUIREMENTS OF THESE TESTS:

ASTM E 72	Structural performance test
ASTM C 1363	Thermal transmission test
ASTM 283-73	Air infiltration test
ASTM E 1646	Water penetration test
ASTM E 84 (UL 723)	Burning characteristic test
ASTM D 1929	Ignition temperature test
UL 263	Fire resistant rating test
UL 1256	Building units for roof panel construction test
FM 4880	Class 1 insulated wall or ceiling panel
FM Class 1-60	Windstorm Classification
FM Class 1-90	Windstorm Classification
FM Class 1-120	Windstorm Classification
MEA #64-95-M	New York City approval

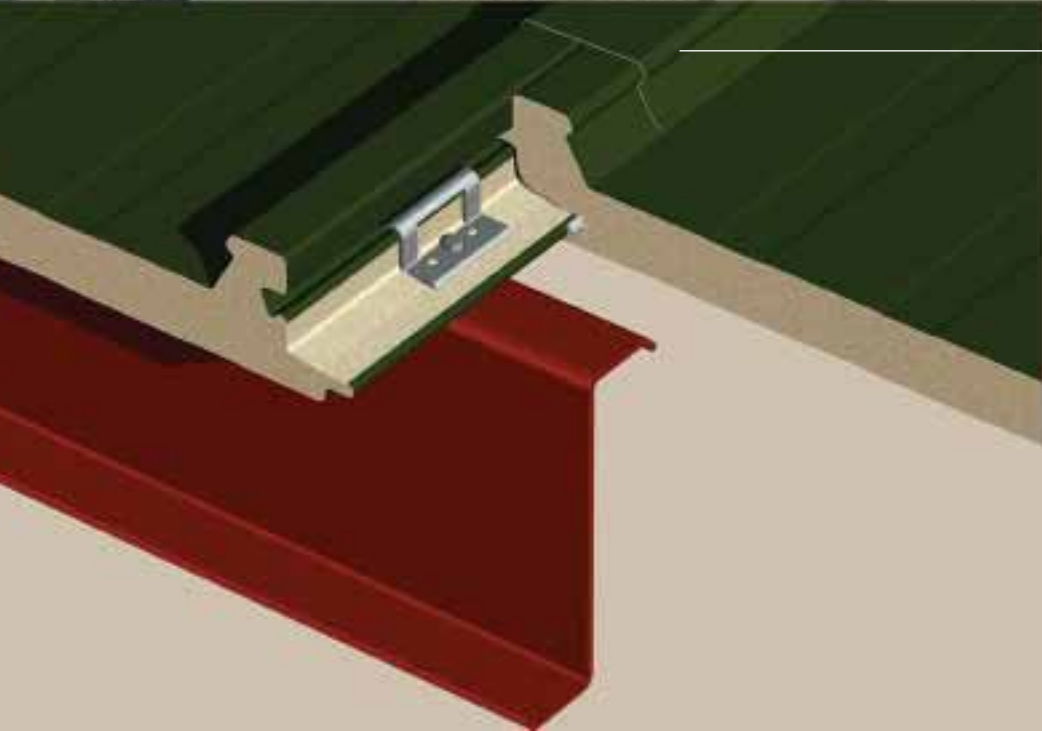

When used as an insulated roof, Versapanel incorporates a snap-on batten.

Versapanel

DURABILITY

that begins with protective coatings

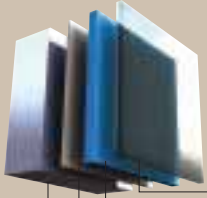

METALLIC 3-COAT

A quality, durable coating providing the iridescence and reflectivity of a metallic surface.

- .5 mil nominal Polyvinylidene Fluoride Coat (clear)*
- .8 mil nominal Polyvinylidene Fluoride Coat (color)*
- .2 mil nominal Primer Coat
- Substrate

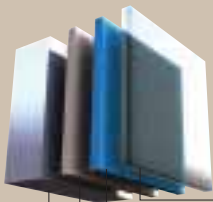

DURAGARD® PLUS

A premium, high build architectural coating providing the ultimate in color retention and fade resistance.

- .8 mil nominal Polyvinylidene Fluoride Coat (clear)*
- .8 mil nominal Polyvinylidene Fluoride Coat (color)*
- .8 mil nominal Primer Coat
- Substrate

DURAGARD®

- .8 mil nominal Polyvinylidene Fluoride Coat (color)*
- .8 mil nominal Primer Coat

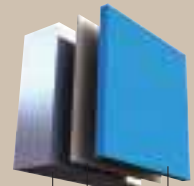

FLUOROFINISH®*, MICA* AND BRILLIANT SERIES

Economical Kynar 500®, Hylar 5000® or FEVE-based coating providing good durability.

- .8 mil nominal Color Coat
- .2 mil nominal Primer Coat
- Substrate

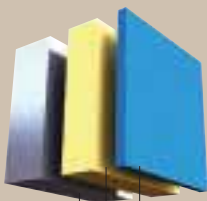

VERSACOR® ULTRA PF

A premium, high build, multi-layer coating for applications where corrosion resistance is more important.

- .8 mil nominal PVDF Coat
- 3.0 mil nominal Versacor Ultra Barrier Coat
- Substrate

VERSACOR® ULTRA TF, RF AND HF

- 1.5, 2.0 or 3.0 mil nominal Urethane Coat (color)*
- 3.0 mil nominal Versacor Ultra Barrier Coat

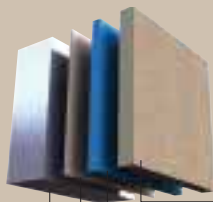

DURACAST

A textured coating consisting of a permanent, non-absorbent acrylic and silica coating. (Available on Versapanel walls only)

- Acrylic and Natural Aggregate Matrix
- .8 mil nominal Polyester
- .2 mil nominal Primer
- Substrate

BENEFITS OF VERSAPANEL

- Provides excellent thermal efficiency and moisture protection in a single component
- Lightweight panels with long spanning capability reduce the building's structural support requirements and reduce installation costs
- Faster and easier installation in any type of weather or climate
- Concealed clip fasteners provide a clean uninterrupted surface
- Available with pre-formed sheet metal flashing or extruded aluminum trim
- Creates a complete, thermally efficient exterior wall, using far less material
- Made of 100% recyclable steel with a high degree of recycled content
- No substrate is required when used as a structural roofing panel
- CENTRIA nationwide network of certified Versapanel dealers and installers
- Backed by CENTRIA, with over a century of experience and excellence

Versapanel Details

INDEX

PRODUCT INFORMATION

Versapanel – Wall	8, 9
Versapanel - Roof.....	10, 11

PRODUCT PROFILES

Versapanel Planked face	12
Versapanel Flat face.....	13
Versapanel Joint – 1.75	14
Versapanel Joint – 2.50	15
Versapanel Joint – 4.00	16

VERSAPANEL APPLICATION DETAILS

Base at Curb	17
Base at Slab	18
Stack Joint	19
Parapet.....	20
Head.....	21
Jamb.....	22
Sill.....	23
Soffit to Wall	24
Wall to Soffit	25
Jamb at Masonry	26
Inside Corner	27
Outside Corner	28
Expansion Joint	29
Eave to Versapanel Wall	30
Peak to Versapanel Wall	31
Rake to Versapanel Wall	32
Side Wall to Versapanel	33
Head Wall to Versapanel	34
Ridge	35
Valley	36
Eave to Versawall Wall.....	37
Peak to Versawall Wall.....	38
Rake to Versawall Wall.....	39

Side Wall to Versawall Wall	40
Head Wall to Versawall Wall	41
End Lap	42
Pipe Penetrations	43
Roof Curb Penetration	44

LOAD / SPAN TABLES

Versapanel Wind Load	45, 46
Versapanel Gravity Load	47, 48

CENTRIA reserves the right to change information in this manual without prior notice.

This manual illustrates design information and application details for CENTRIA Versapanel products. The information contained herein is not intended to assure performance for each particular application. CENTRIA accepts no liability arising from the use of this information and excludes any implied warranty of fitness for a particular purpose or merchantability with respect to the products described.

VERSAPANEL WALL

PROMOTIONAL
DATA # 001

Versapanel wall panels incorporate a finished interior liner, factory applied air and vapor seal, insulating foam core and finished exterior weathering surface into a single building unit. The composite action resulting from the chemical bond between the poured in place foam core and the steel skins creates a lightweight, rigid unit with excellent spanning capacity.

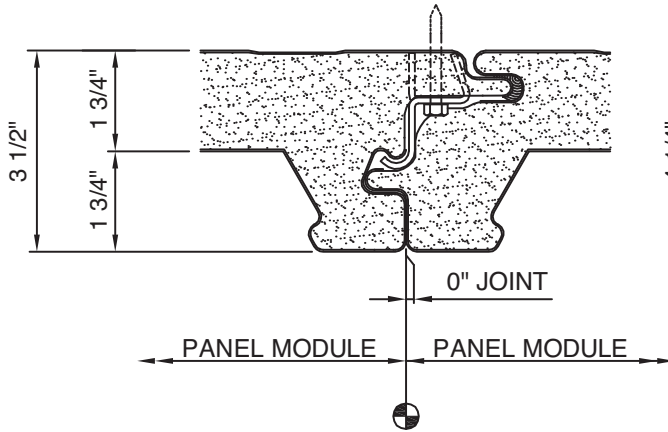

1.75 PANEL JOINT

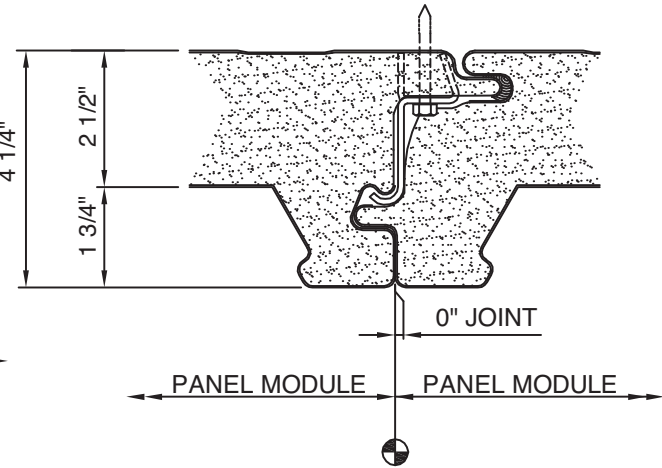

**2.50 PANEL JOINT
(4.00 PANEL JOINT SIMILAR)**

Panel Availability

Panel Thickness 1 3/4", 2 1/2", or 4"
Panel Module (standard) ... 36"

Side Joint Double Tongue & Groove
End Joint Butt - see Details

Core Material Urethane-modified Isocyanurate foam
Base Material (standard) ... G-90 galvanized steel

Thermal Properties Versapanel 1.75 - U=0.069 (R=14.44)
Versapanel 2.50 - U=0.052 (R=19.34)
Versapanel 4.00- U=0.036 (R=27.41)

Exterior Face (standard) ... 26 ga. embossed, planked
(optional) ... 20, 22, 24 ga. embossed, planked
(optional) ... 22 ga. embossed

Interior Liner (standard) ... 26 ga. embossed, planked
(optional) ... 20, 22, 24 ga. embossed, planked

Lengths (standard) ... 6 ft. to 40 ft.
(optional) ... 1 ft. min. to 6 ft.
(optional) ... 40 ft. to 48 ft. max.
Texture (standard) ... Non-directional embossing
Finishes See Finishes Brochure

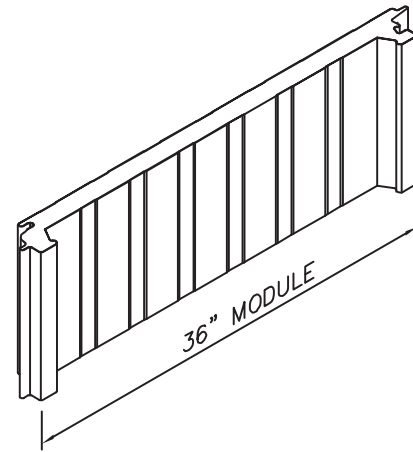

Accessories

1. Sealants
2. Fasteners
3. Brake-formed flashings
4. Flat stock
5. Attachment clips
6. Others as required for job completion

Special Applications

Information is available on special applications such as fire-rated walls, corrosive exposure considerations, pressure release walls, special material and coating requirements as well as many other pertinent subjects; contact your local CENTRIA Sales Representative.

Notes

1. Maximum support spacing & panel length may be limited for medium & dark colors due to thermal stress, consult CENTRIA Design & Development.



CENTRIA
CENTRIA Architectural Systems

PRODUCT INFORMATION

VERSAPANEL WALL SI UNITS

PROMOTIONAL
DATA # 001_m

Versapanel wall panels incorporate a finished interior liner, factory applied air and vapor seal, insulating foam core and finished exterior weathering surface into a single building unit. The composite action resulting from the chemical bond between the poured in place foam core and the steel skins creates a lightweight, rigid unit with excellent spanning capacity.

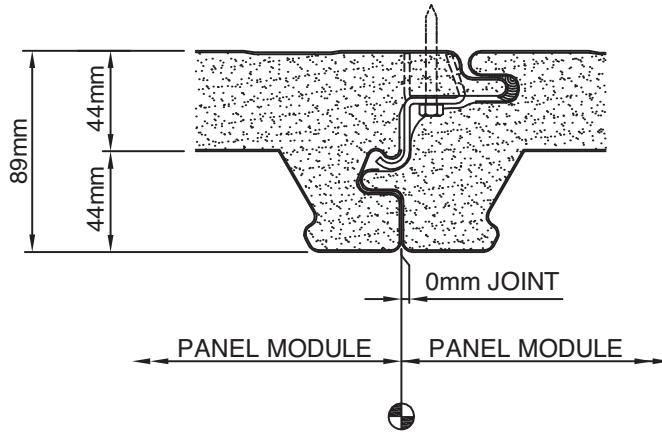

1.75 PANEL JOINT

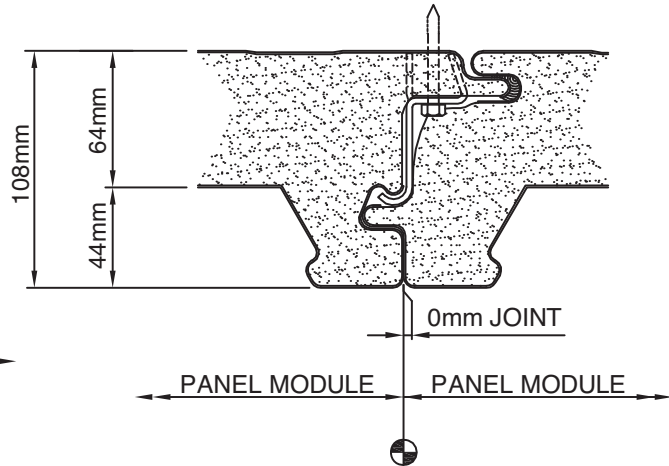

**2.50 PANEL JOINT
(4.00 PANEL JOINT SIMILAR)**

Panel Availability

Panel Thickness 44mm, 64mm or 102mm
Panel Module (standard) 914mm

Side Joint Double Tongue & Groove
End Joint Butt - see Details

Core Material Urethane-modified Isocyanurate foam
Base Material (standard) G-90 galvanized steel

Thermal Properties Versapanel 1.75 - U=0.391 (Rsi=2.55)
U{W/(m² K)} Versapanel 2.50 - U=0.295 (Rsi=3.39)
..... Versapanel 4.00 - U=0.204 (Rsi=4.90)

Exterior Face (standard)45mm embossed, planked
(optional)90mm, .75mm, .60mm embossed, planked
(optional)75mm embossed

Interior Liner (standard)45mm embossed, planked
(optional)90mm, .75mm, .60mm embossed, planked

Lengths (standard) 1.83m to 12.19m
(optional)30m min. to 1.83m
(optional) 12.19m to 14.63m max.

Texture (standard) Non-directional embossing
Finishes See Finishes Brochure

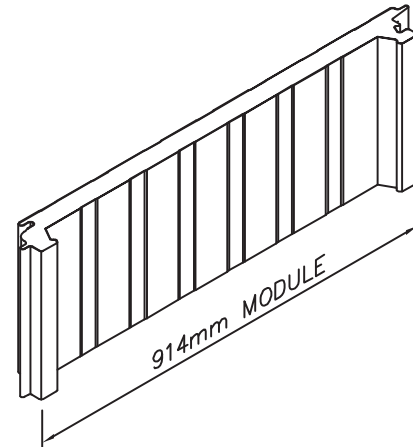

Accessories

1. Sealants
2. Fasteners
3. Brake-formed flashings
4. Flat stock
5. Attachment clips
6. Others as required for job completion

Special Applications

Information is available on special applications such as fire-rated walls, corrosive exposure considerations, pressure release walls, special material and coating requirements as well as many other pertinent subjects; contact your local CENTRIA Sales Representative.

Notes

1. Maximum support spacing & panel length may be limited for medium & dark colors due to thermal stress, consult CENTRIA Design & Development.



CENTRIA
CENTRIA Architectural Systems

PRODUCT INFORMATION

VERSAPANEL ROOF

PROMOTIONAL
DATA # 002

Versapanel roof panels incorporate a finished interior liner, factory applied air and vapor seal, insulating foam core and finished exterior weathering surface into a single building unit. The composite action resulting from the chemical bond between the poured in place foam core and the steel skins creates a lightweight, rigid, walkable unit with excellent spanning capacity.

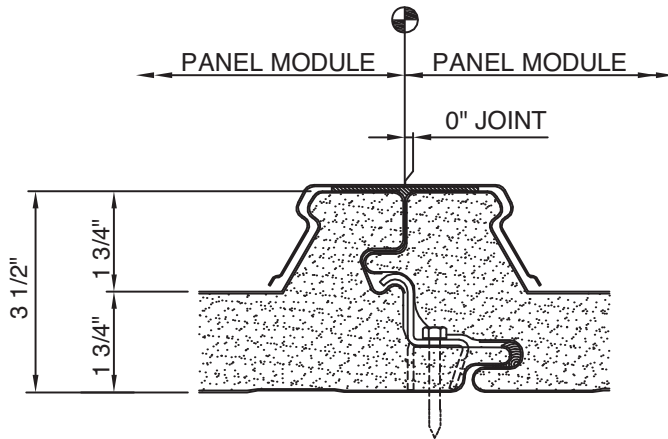

1.75 PANEL JOINT

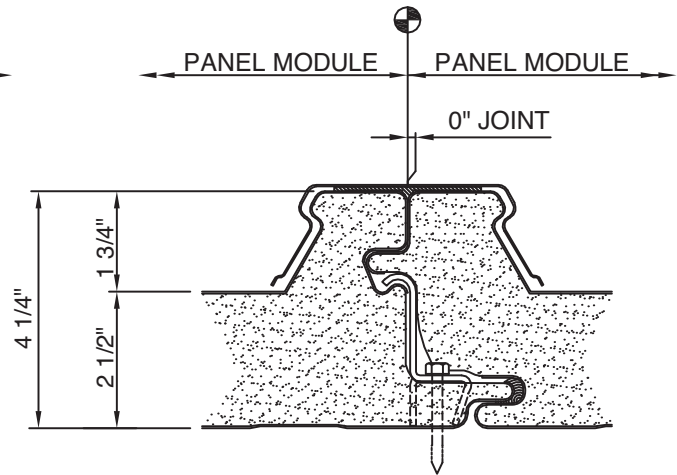

2.50 PANEL JOINT

(4.00 PANEL JOINT SIMILAR)

Panel Availability

Panel Thickness 1 3/4", 2 1/2", 4"
Panel Module (standard) 36"

Side Joint Double Tongue & Groove
End Joint Cope & overlap - see Details

Core Material Urethane-modified Isocyanurate foam
Base Material (standard) G-90 galvanized steel

Thermal Properties Versapanel 1.75 - U=0.069 (R=14.44)
Versapanel 2.50 - U=0.052 (R=19.34)
Versapanel 4.00 - U=0.036 (R=27.41)

Exterior Face (standard) 26 ga. embossed, planked
(optional) 20, 22, 24 ga. embossed, planked
(optional) 22 ga. embossed

Interior Liner (standard) 26 ga. embossed, planked
(optional) 20, 22, 24 ga. embossed, planked

Lengths (standard) 6 ft. to 40 ft.
(optional) 1 ft. to 6 ft.

(optional) 40 ft. to 48 ft. max.
Texture (standard) Non-directional embossing

Finishes See Finishes Brochure

Wind uplift testing FM 1-90 and FM 1-120 rating
UL 580 class 90 rating

Special Applications

Information is available on special applications such as high uplift loading, corrosive exposure considerations, retrofit roof, special material and coating requirements as well as many other pertinent subjects; contact your local CENTRIA Sales Representative.

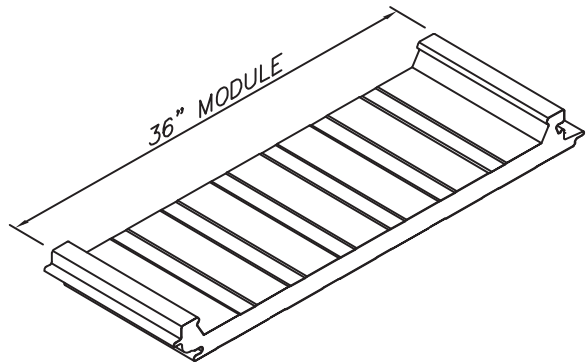

Accessories

1. Sealants
2. Fasteners
3. Brake-formed flashings
4. Flat stock
5. Attachment clips
6. Others as required for job completion

Notes

1. Minimum roof slope: 1/2" : 12" without end laps
1" : 12" with end laps.
2. Maximum support spacing & panel length may be limited for medium & dark colors due to thermal stress, consult CENTRIA Design & Development.



CENTRIA
CENTRIA Architectural Systems

PRODUCT INFORMATION

VERSAPANEL ROOF SI UNITS

PROMOTIONAL
DATA # 002_m

Versapanel roof panels incorporate a finished interior liner, factory applied air and vapor seal, insulating foam core and finished exterior weathering surface into a single building unit. The composite action resulting from the chemical bond between the poured in place foam core and the steel skins creates a lightweight, rigid, walkable unit with excellent spanning capacity.

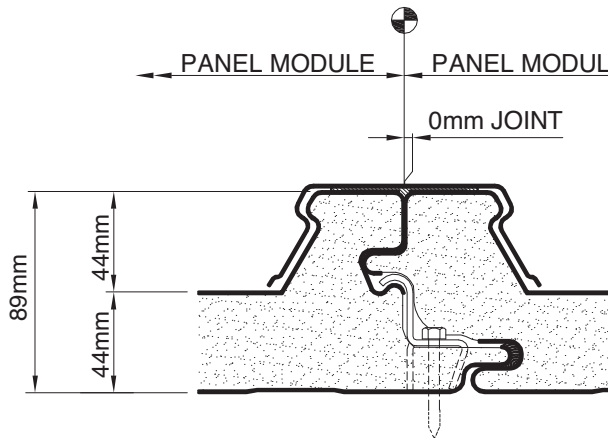

1.75 PANEL JOINT

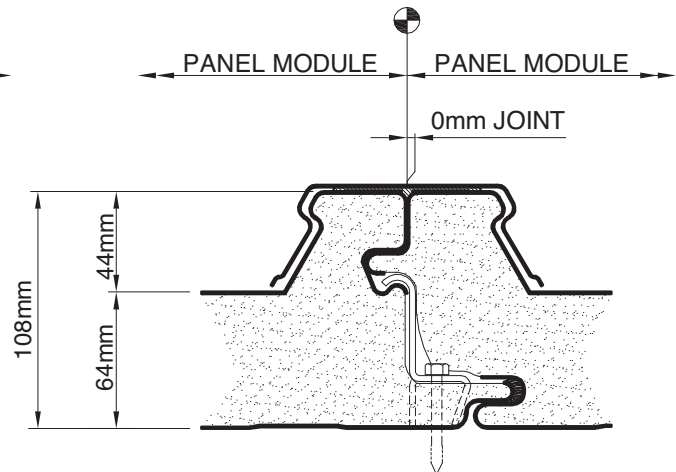

2.50 PANEL JOINT

(4.00 PANEL JOINT SIMILAR)

Panel Availability

Panel Thickness 44mm, 64mm, 102mm
Panel Module (standard) 914mm

Side Joint Double Tongue & Groove
End Joint Cope & overlap - see Details

Core Material Urethane-modified Isocyanurate foam
Base Material (standard) G-90 galvanized steel

Thermal Properties Versapanel 1.75 - U=0.391 (Rsi=2.55)
U{W/(m²·K)} Versapanel 2.50 - U=0.295 (Rsi=3.39)
Versapanel 4.00 - U=0.204 (Rsi=4.90)

Exterior Face (standard)45mm embossed, planked
(optional)90, .75, .60mm embossed, planked
(optional)75mm embossed

Interior Liner (standard)45mm embossed, planked
(optional)90, .75, .60mm embossed, planked

Lengths (standard) 1.83m to 12.19m
(optional)30m min. to 1.83m
(optional) 12.19m to 14.63m max.

Texture (standard) Non-directional embossing
Finishes See Finishes Brochure

Wind uplift testing FM 1-90 and FM 1-120 rating
UL 580 class 90 rating

Special Applications

Information is available on special applications such as high uplift loading, corrosive exposure considerations, retrofit roof, special material and coating requirements as well as many other pertinent subjects; contact your local CENTRIA Sales Representative.

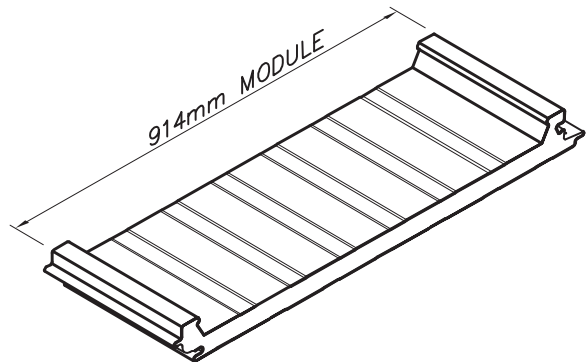

Accessories

1. Sealants
2. Fasteners
3. Brake-formed flashings
4. Flat stock
5. Attachment clips
6. Others as required for job completion

Notes

1. Minimum roof slope: 13 : 305mm without end laps
25 : 305mm with end laps.
2. Maximum support spacing & panel length may be limited for medium & dark colors due to thermal stress, consult CENTRIA Design & Development.



CENTRIA
CENTRIA Architectural Systems

PRODUCT INFORMATION

VERSAPANEL

PROMOTIONAL
PROFILE # 001

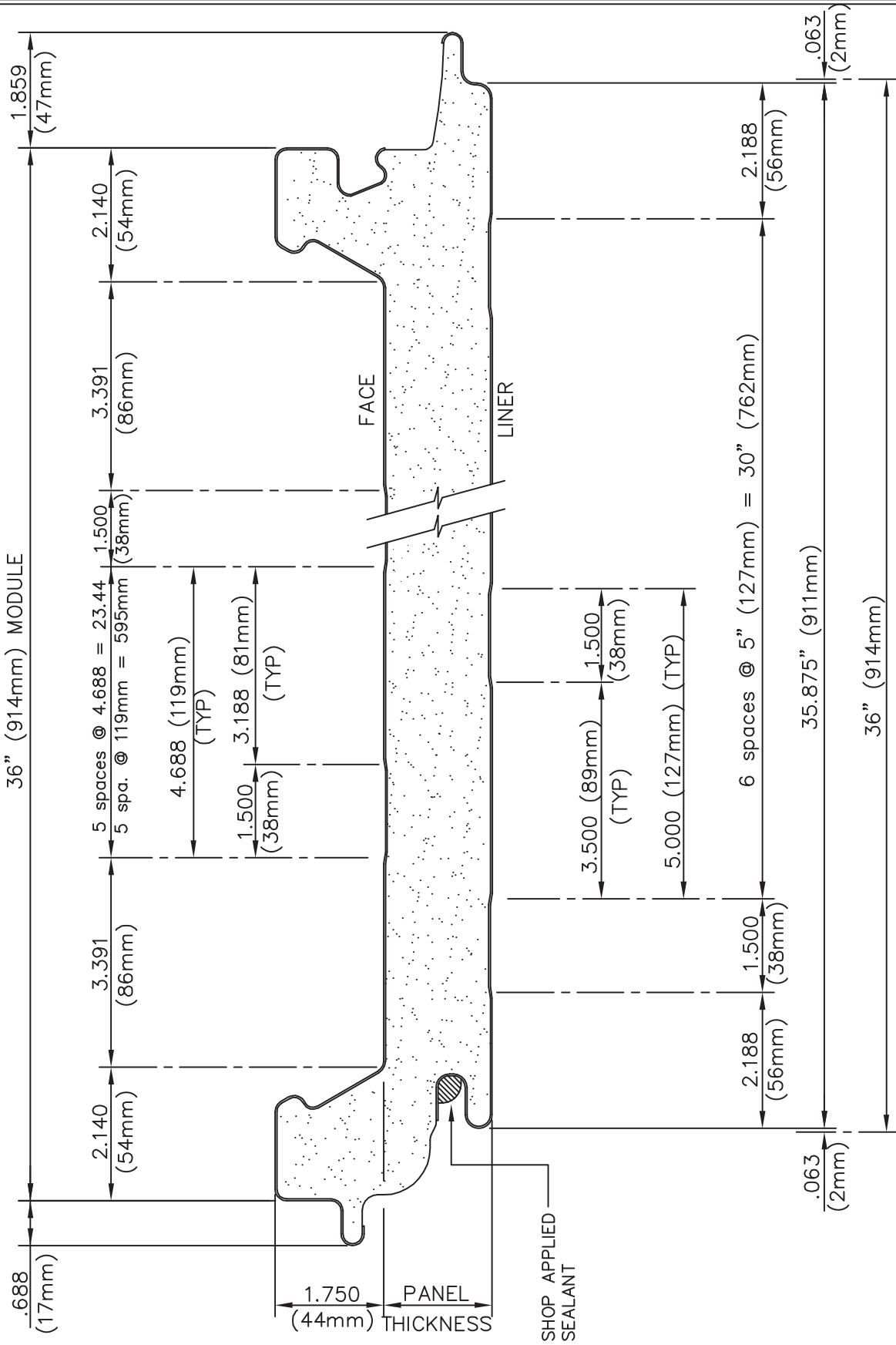

VERSAPANEL ROOF / WALL



CENTRIA
CENTRIA Architectural Systems

VERSAPANEL ROOF / WALL

VERSAPANEL

PROMOTIONAL
PROFILE #002

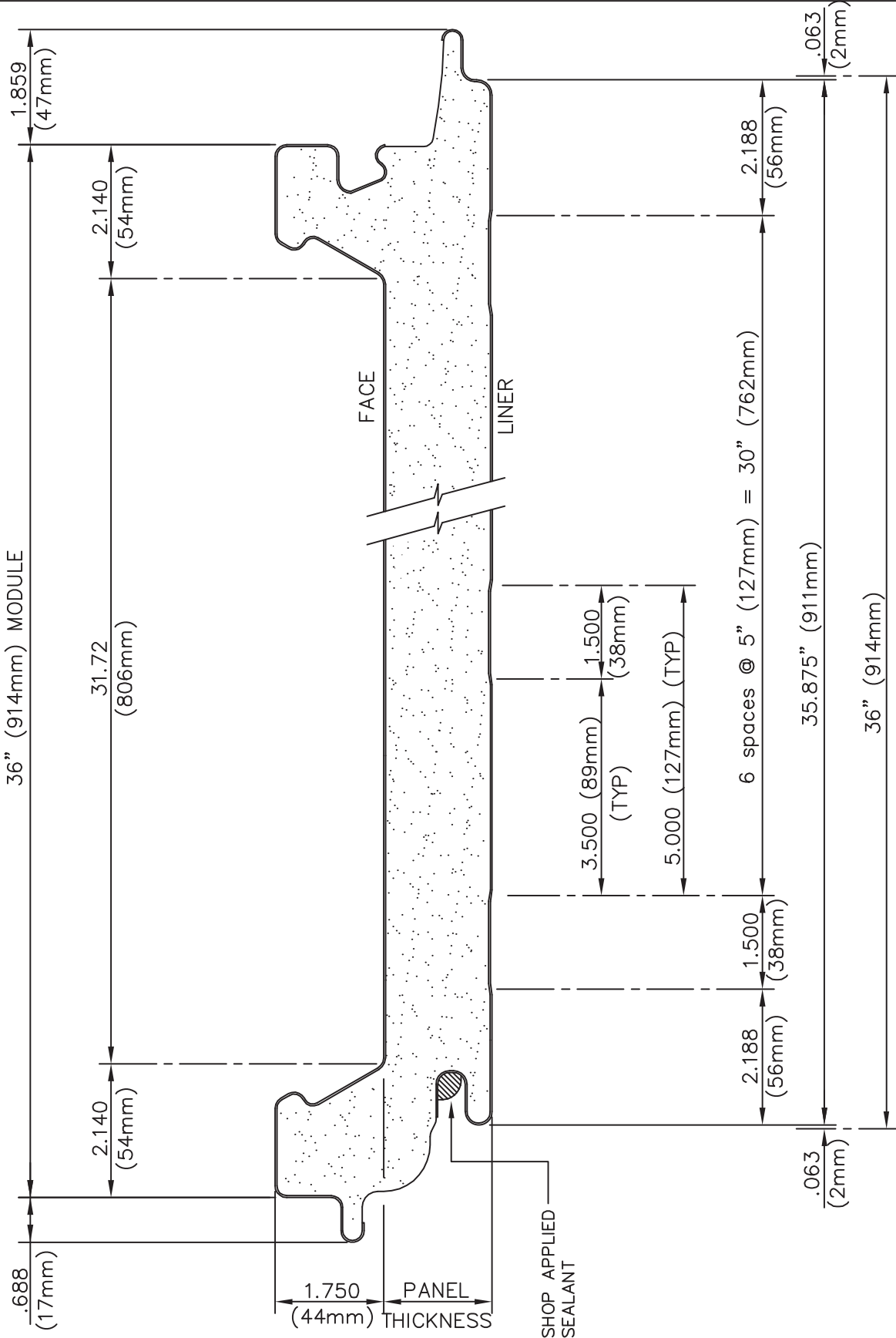

VERSAPANEL WALL



CENTRIA
CENTRIA Architectural Systems

VERSAPANEL WALL

VERSAPANEL

PROMOTIONAL
PROFILE # 003

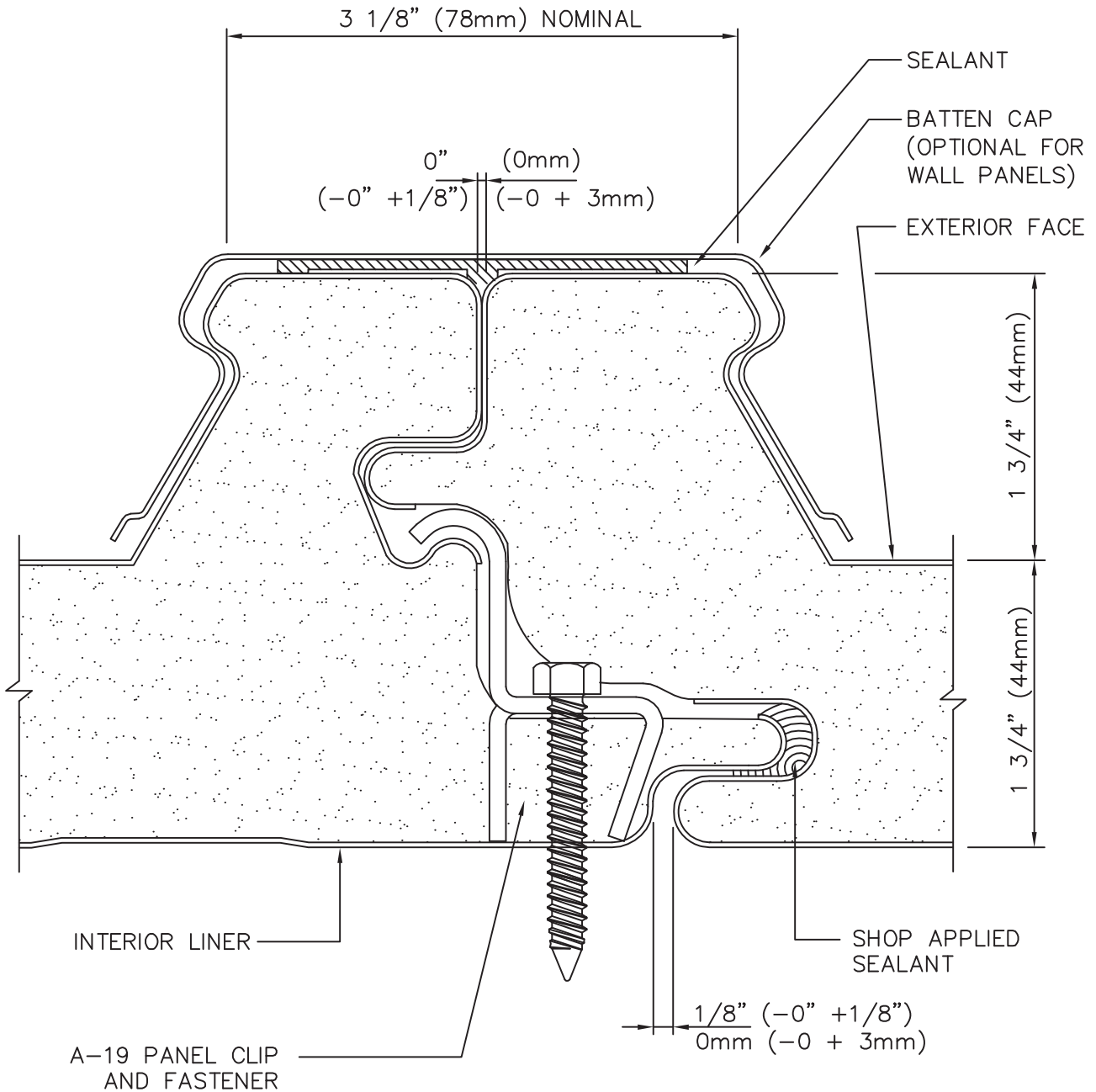

CENTRIA
CENTRIA Architectural Systems

1.75 ROOF PANEL JOINT

14
May 08

VERSAPANEL

PROMOTIONAL
PROFILE # 004

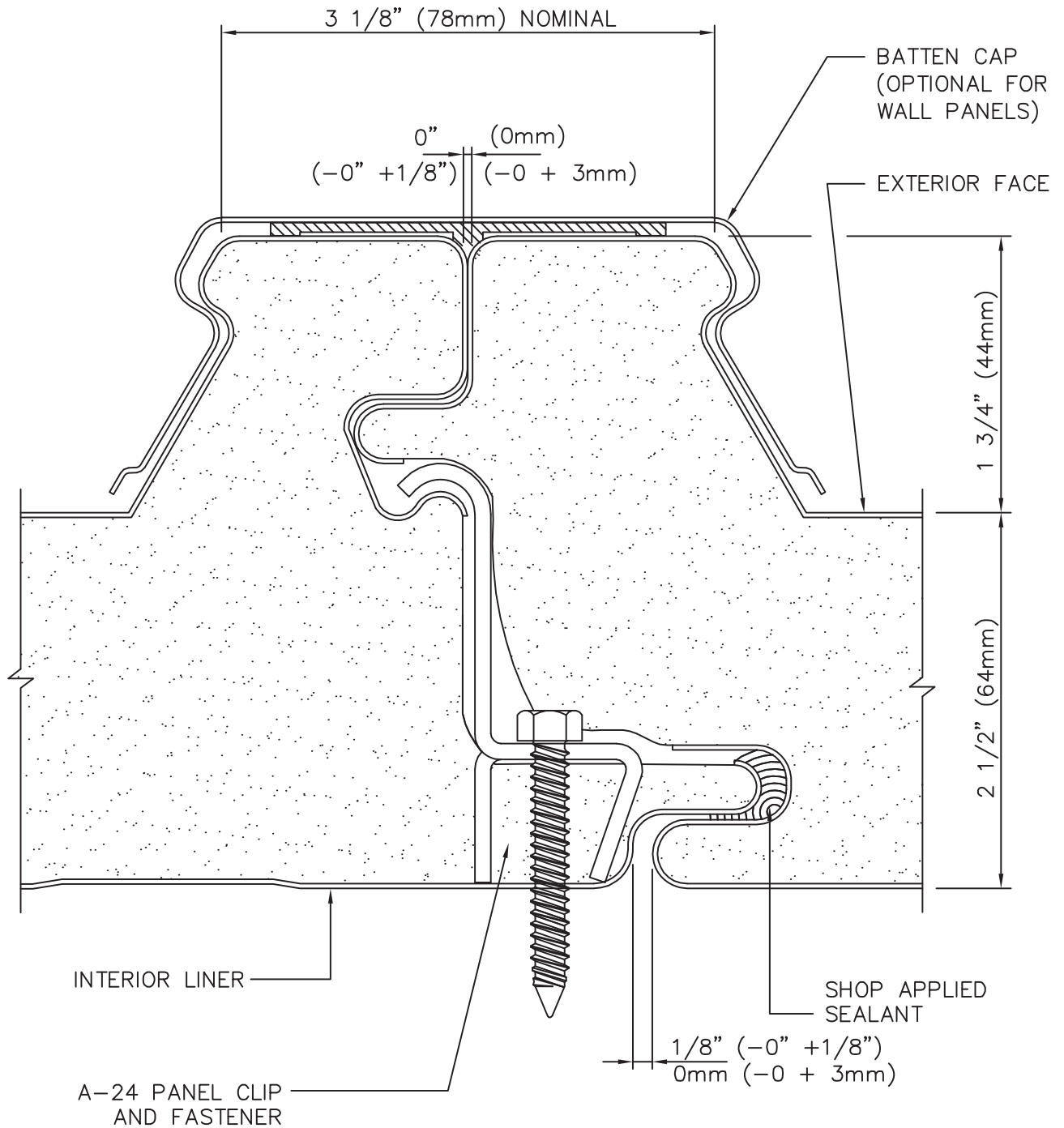

CENTRIA
CENTRIA Architectural Systems

2.50 ROOF PANEL JOINT

15
May 08

VERSAPANEL

PROMOTIONAL
PROFILE # 005

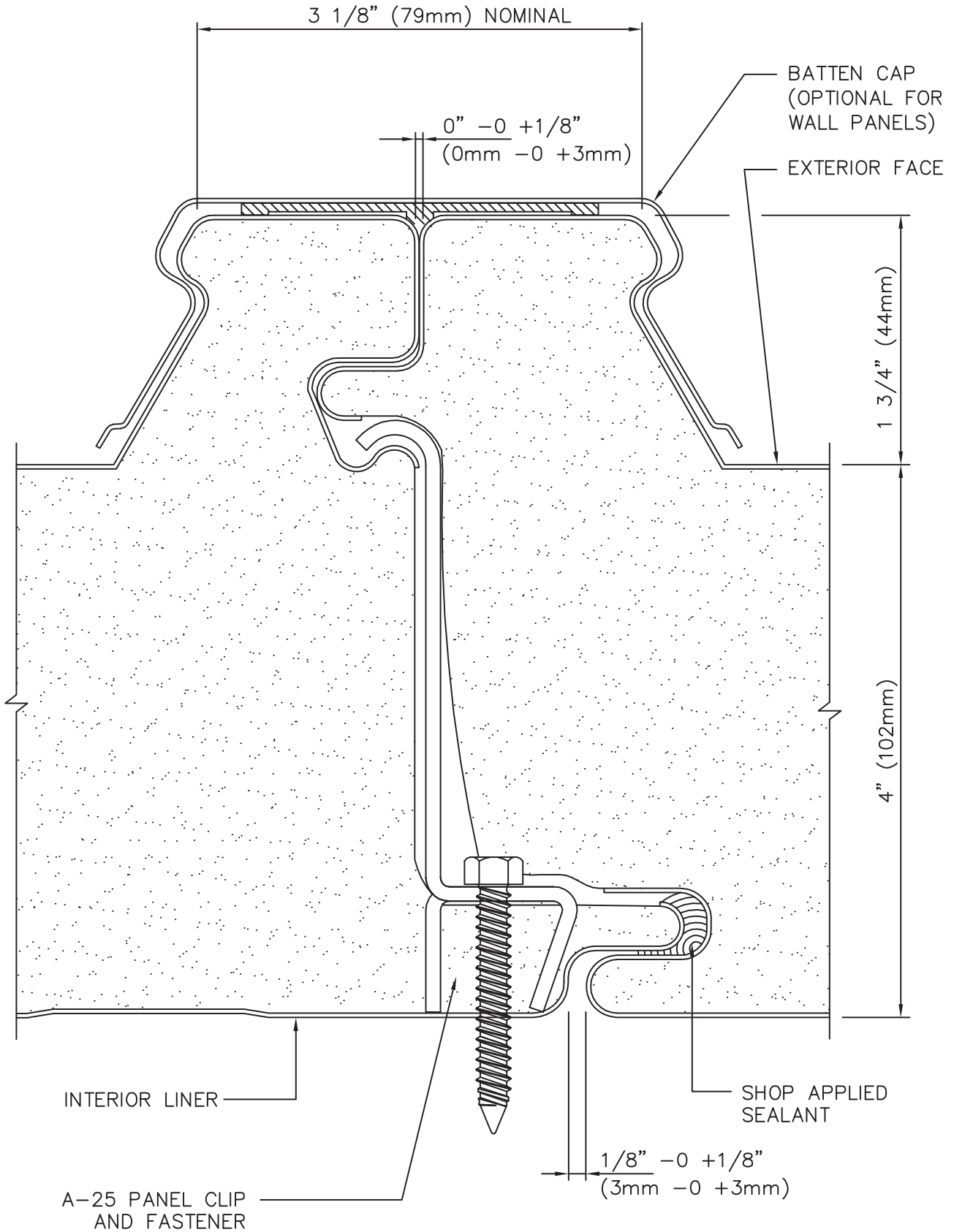

CENTRIA
CENTRIA Architectural Systems

4.00 ROOF PANEL JOINT

16
May 08

VERSAPANEL

PROMOTIONAL
DETAIL # 001

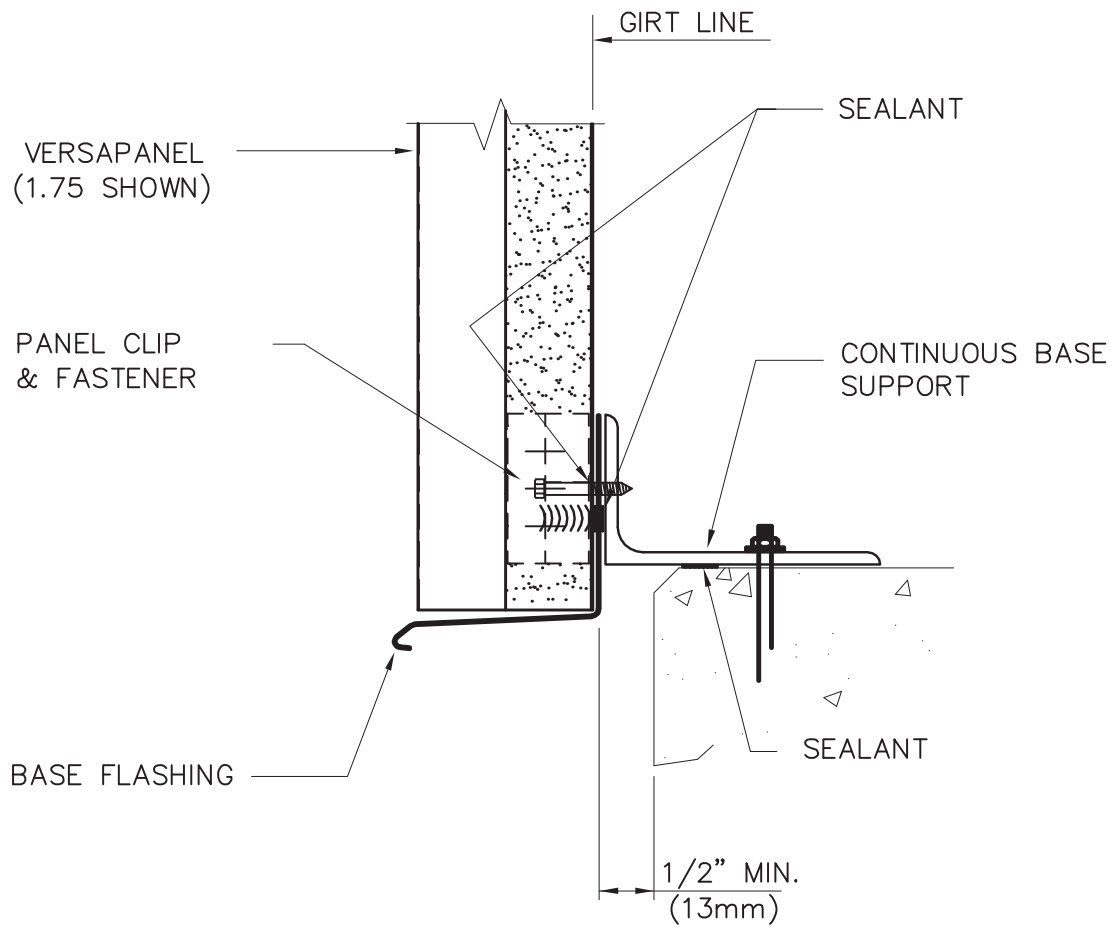

CENTRIA
CENTRIA Architectural Systems

BASE @ CURB

17
May 08

VERSAPANEL

PROMOTIONAL
DETAIL # 002

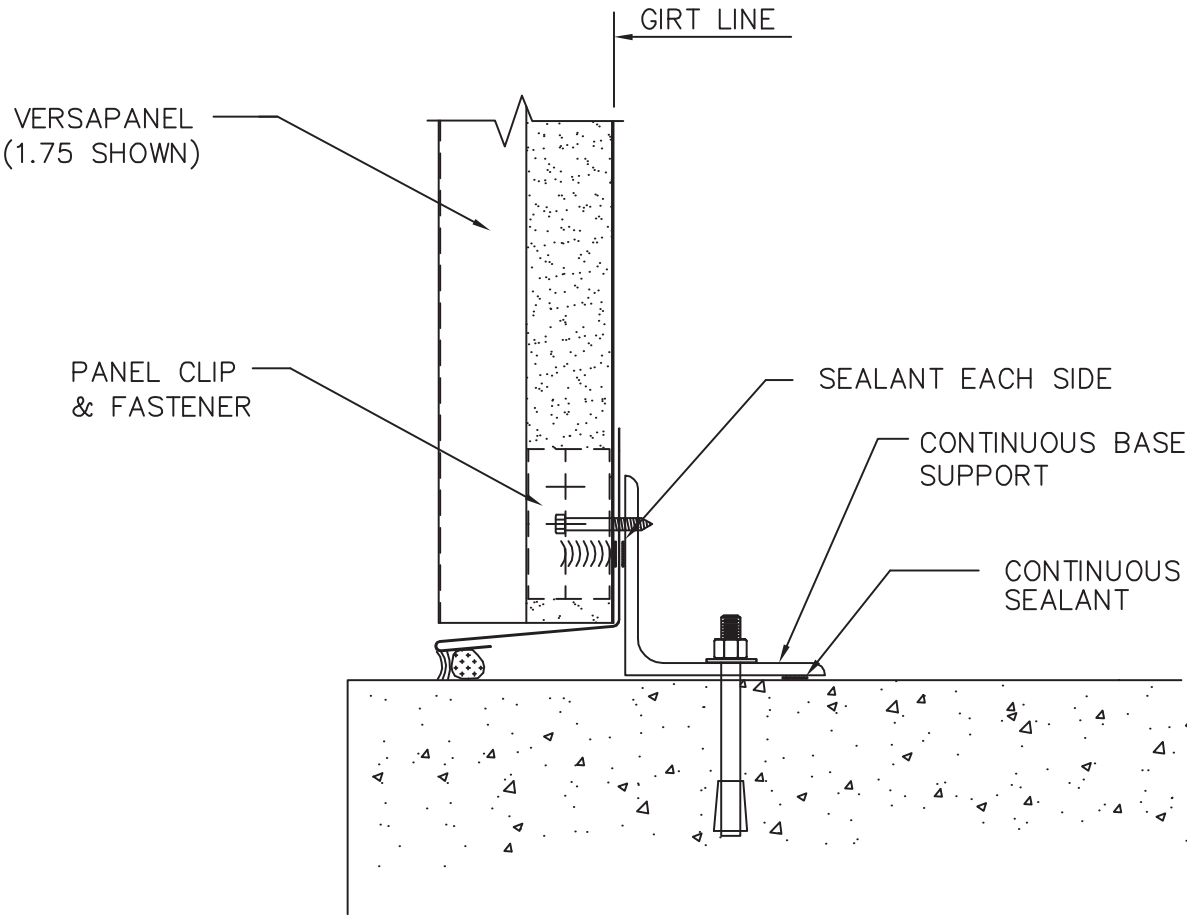

CENTRIA
CENTRIA Architectural Systems

BASE @ SLAB

VERSAPANEL

PROMOTIONAL
DETAIL # 003

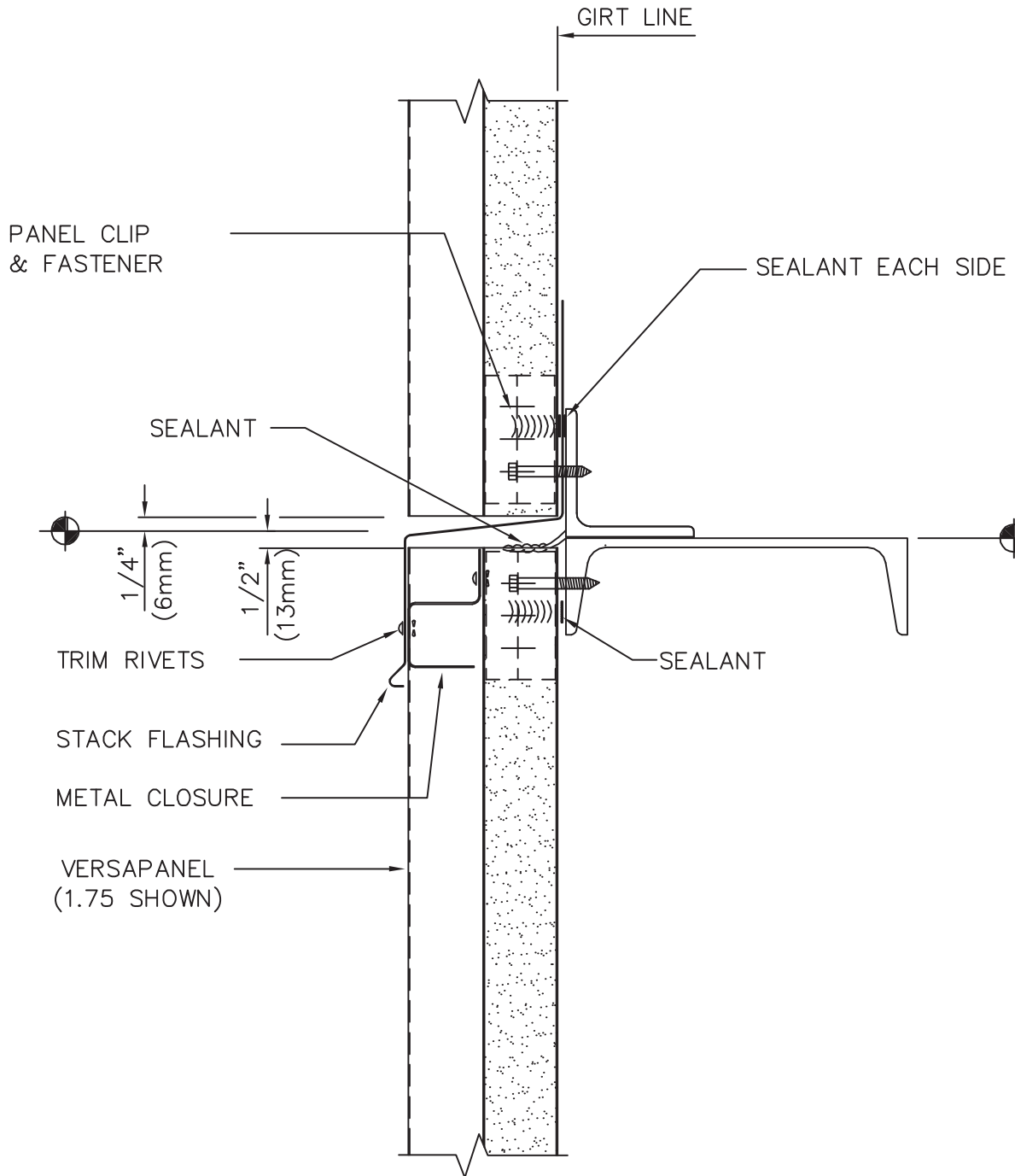

CENTRIA
CENTRIA Architectural Systems

STACK JOINT

VERSAPANEL

PROMOTIONAL
DETAIL # 004

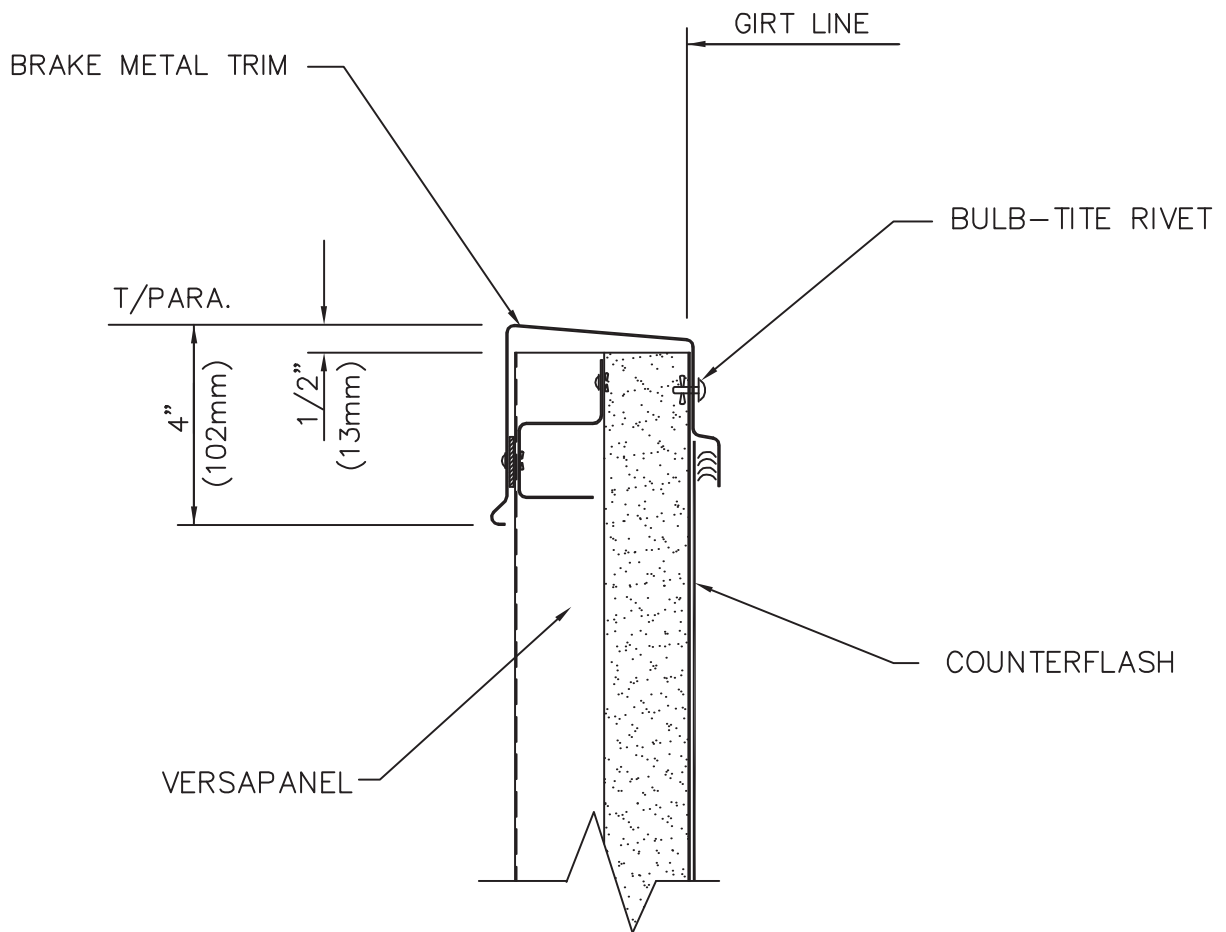

NOTE:

LINER SEAL IS PROPERLY LOCATED @ INTERSECTION WITH ROOF VAPOR BARRIER.



CENTRIA
CENTRIA Architectural Systems

PARAPET

20
May 08

VERSAPANEL

PROMOTIONAL
DETAIL # 005

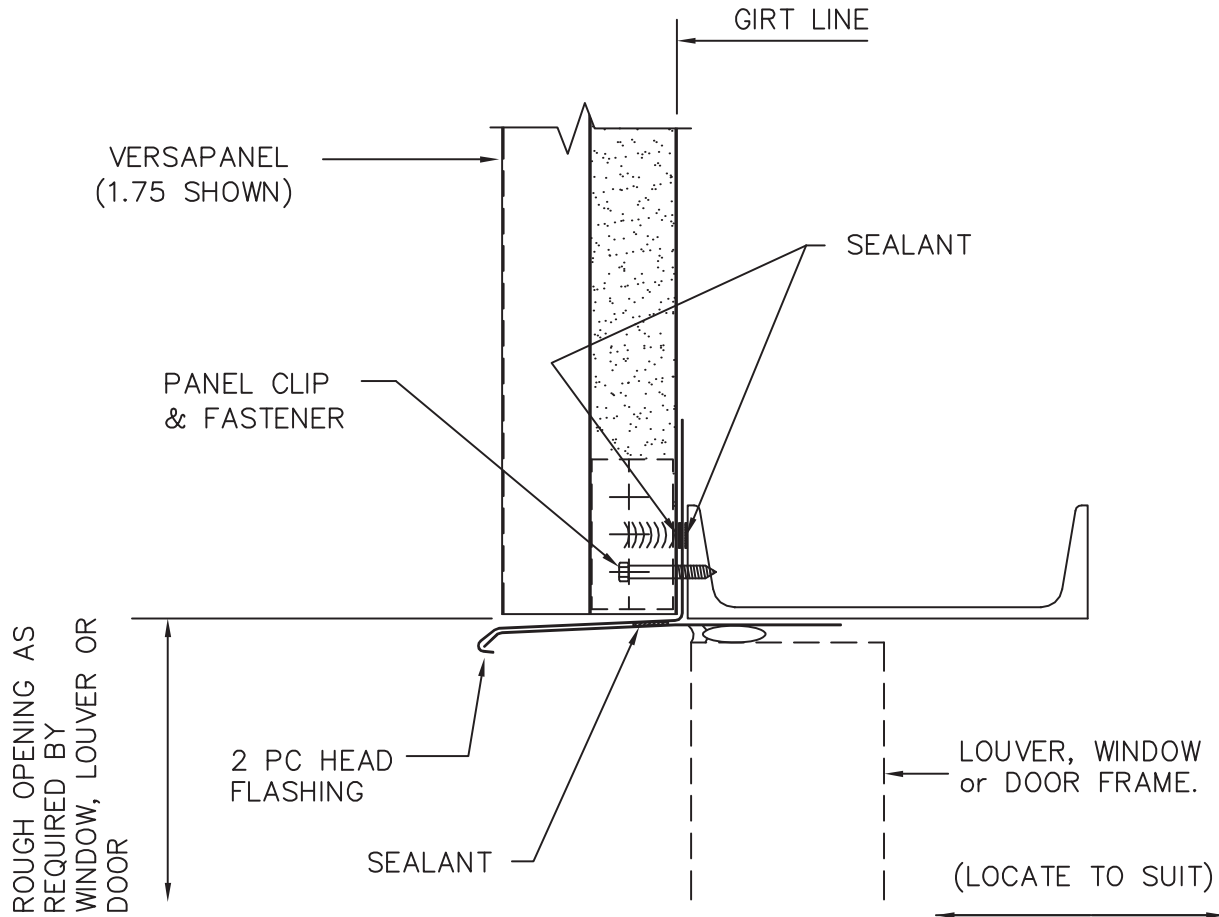

CENTRIA
CENTRIA Architectural Systems

HEAD

21
May 08

VERSAPANEL

PROMOTIONAL
DETAIL # 006

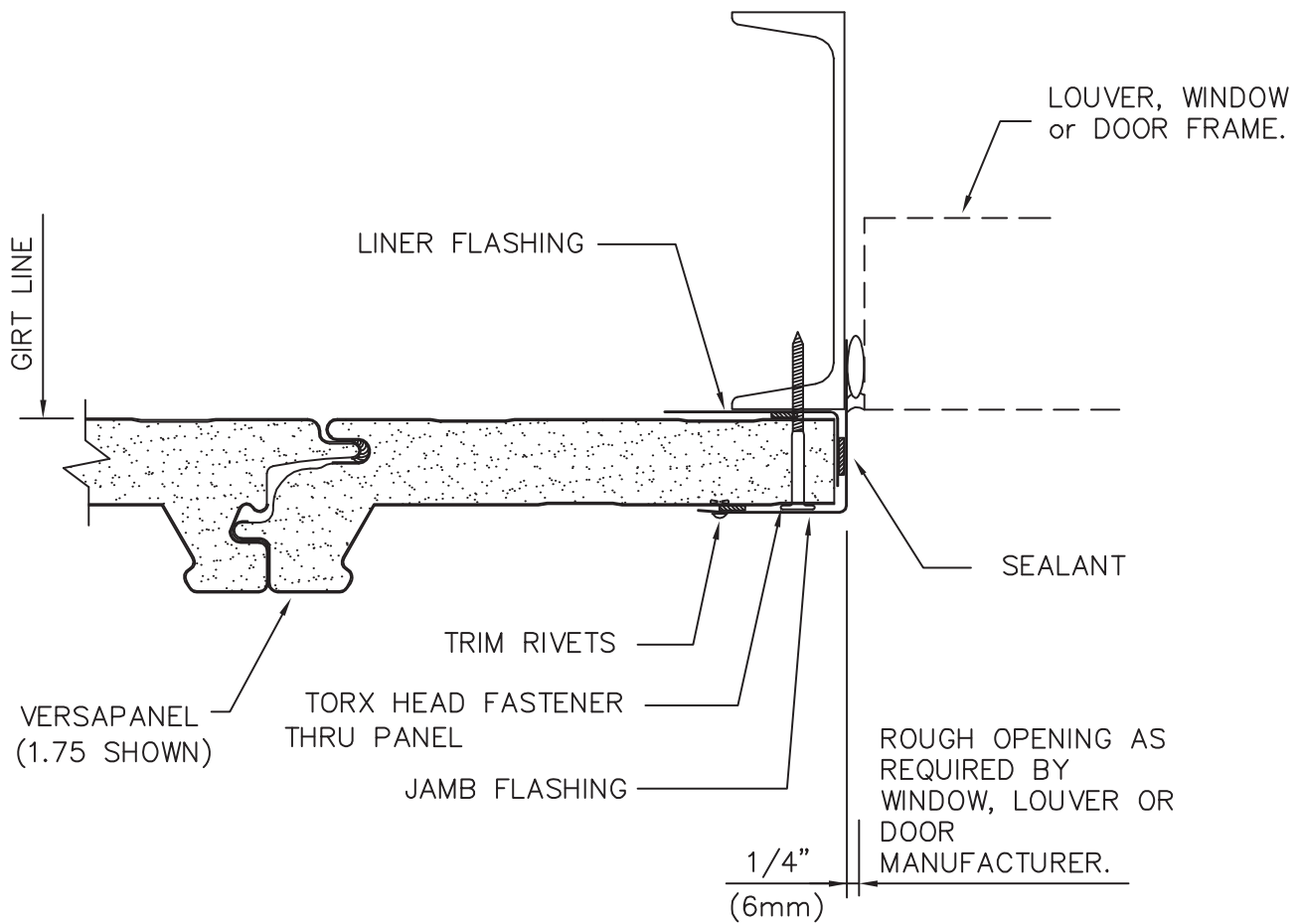

NOTE:

SET ALL FLASHING IN CONTINUOUS SEALANT



CENTRIA
CENTRIA Architectural Systems

JAMB

22
May 08

VERSAPANEL

PROMOTIONAL
DETAIL # 007

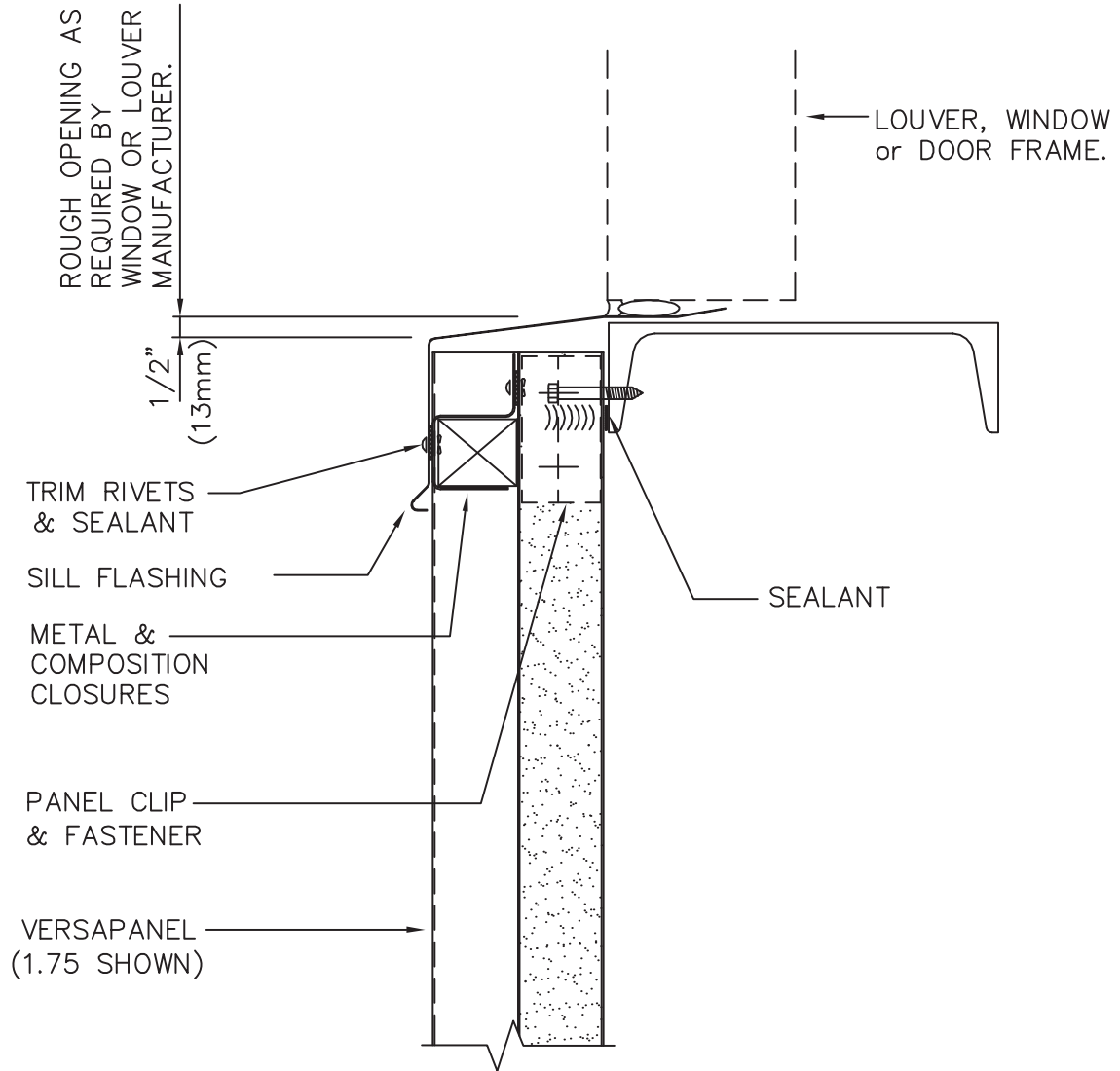

CENTRIA
CENTRIA Architectural Systems

SILL

23
May 08

VERSAPANEL

PROMOTIONAL
DETAIL # 008

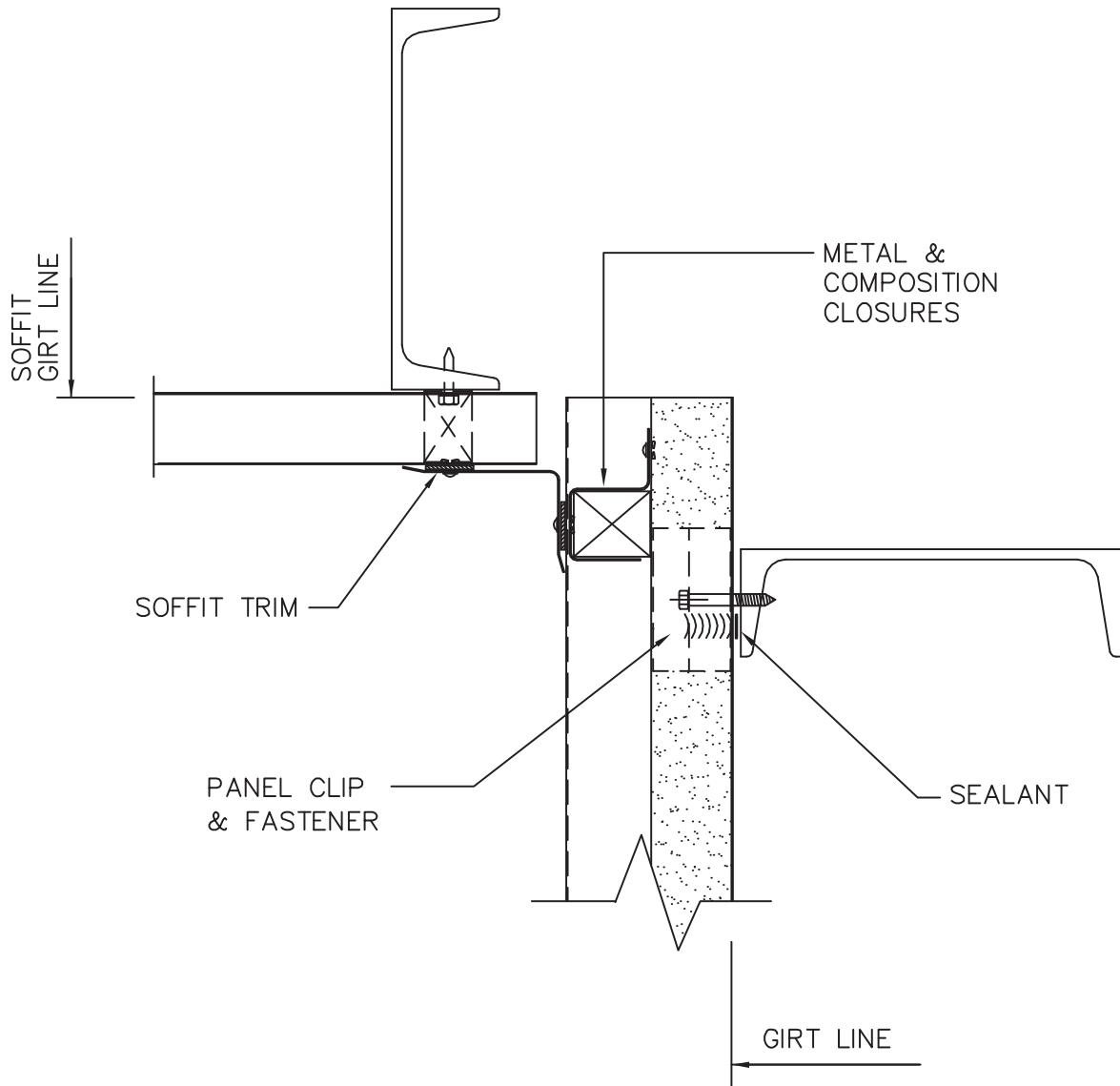

CENTRIA
CENTRIA Architectural Systems

SOFFIT-WALL

24
May 08

VERSAPANEL

PROMOTIONAL
DETAIL # 009

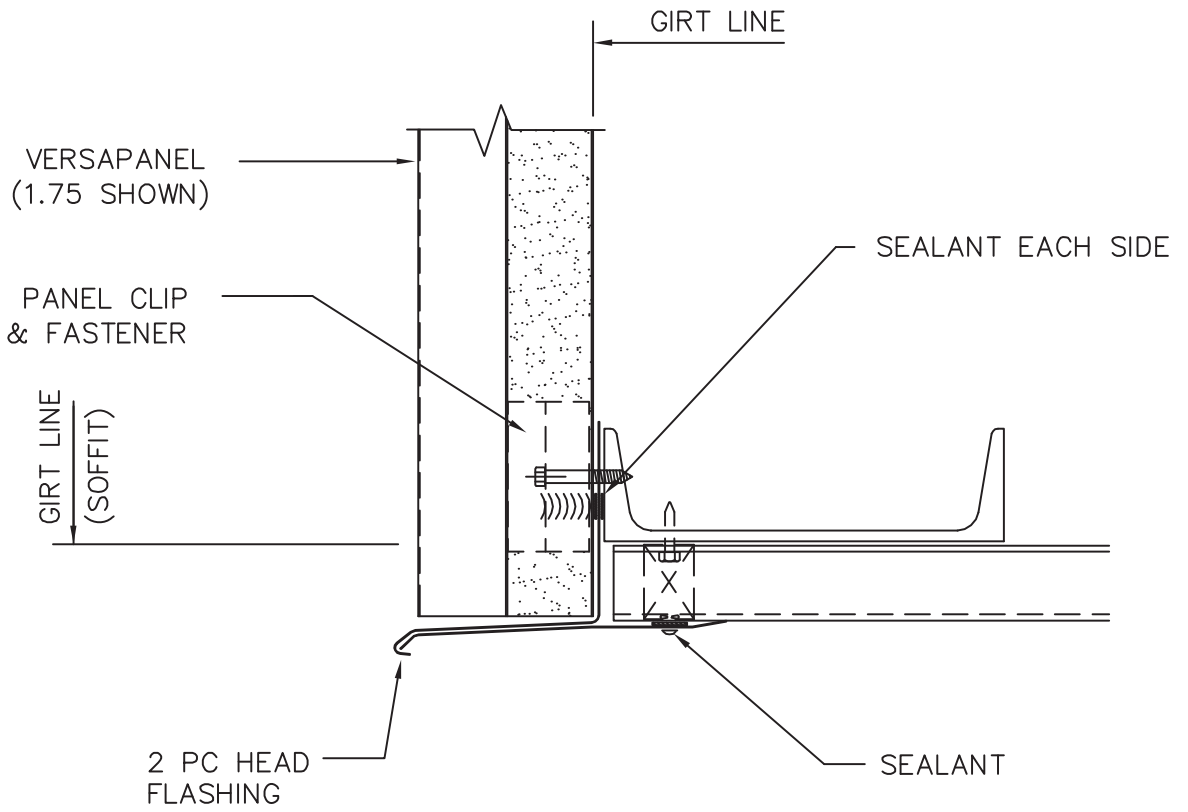

CENTRIA
CENTRIA Architectural Systems

WALL-SOFFIT

25
May 08

VERSAPANEL

PROMOTIONAL
DETAIL # 010

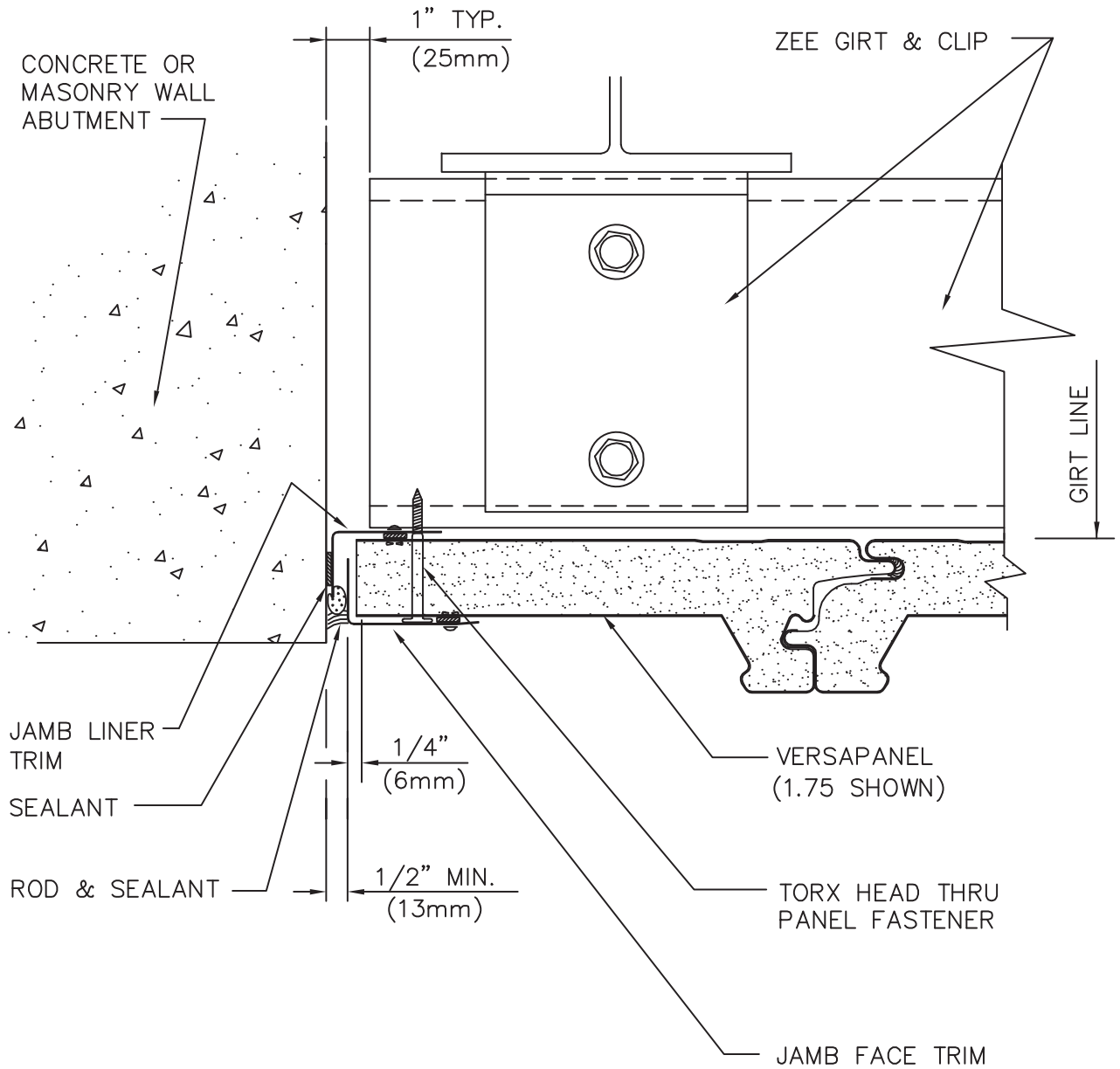

CENTRIA
CENTRIA Architectural Systems

JAMB @ MASONRY

26
May 08

VERSAPANEL

PROMOTIONAL
DETAIL # 0011

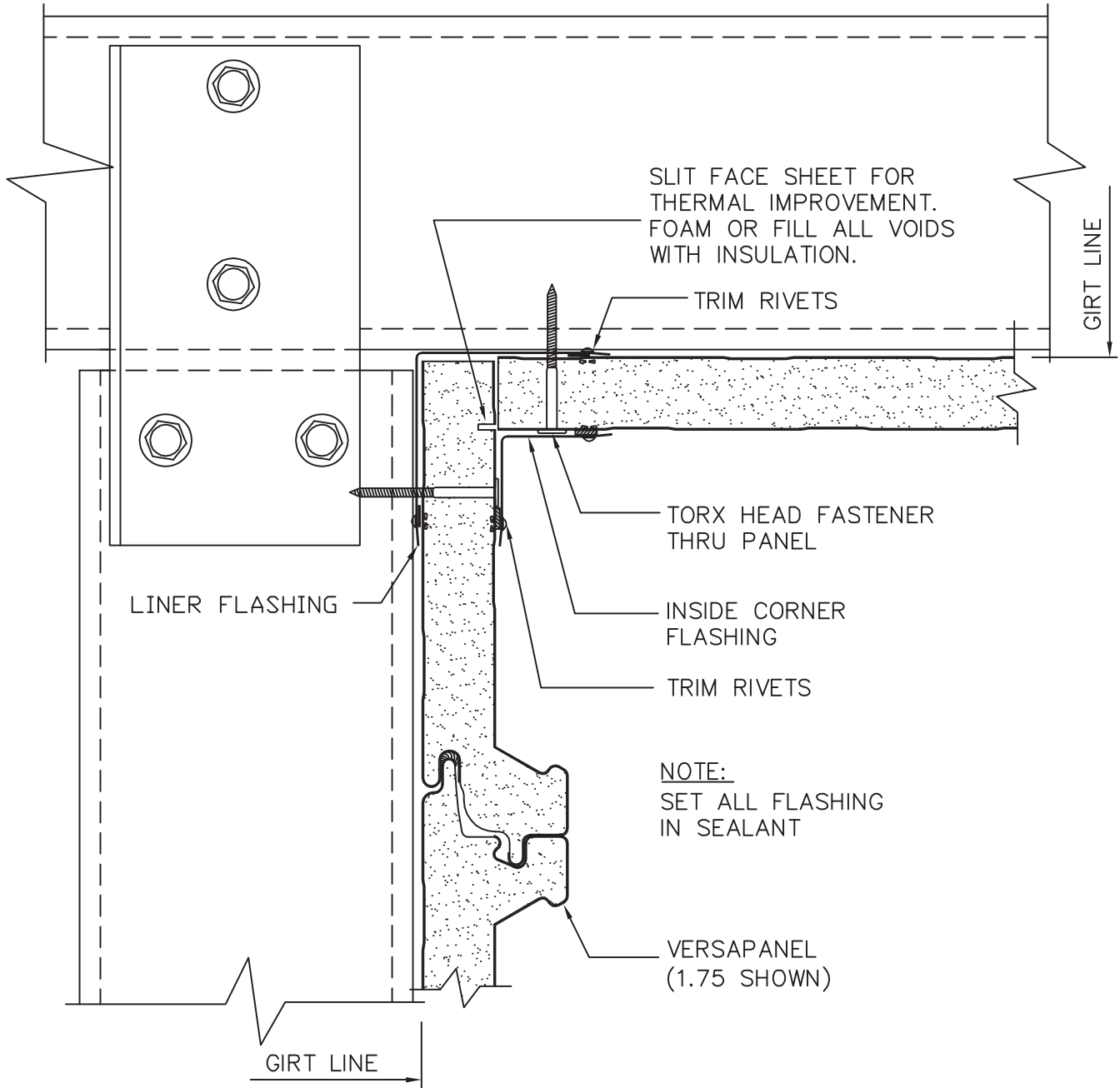

CENTRIA
CENTRIA Architectural Systems

INSIDE CORNER

27
May 08

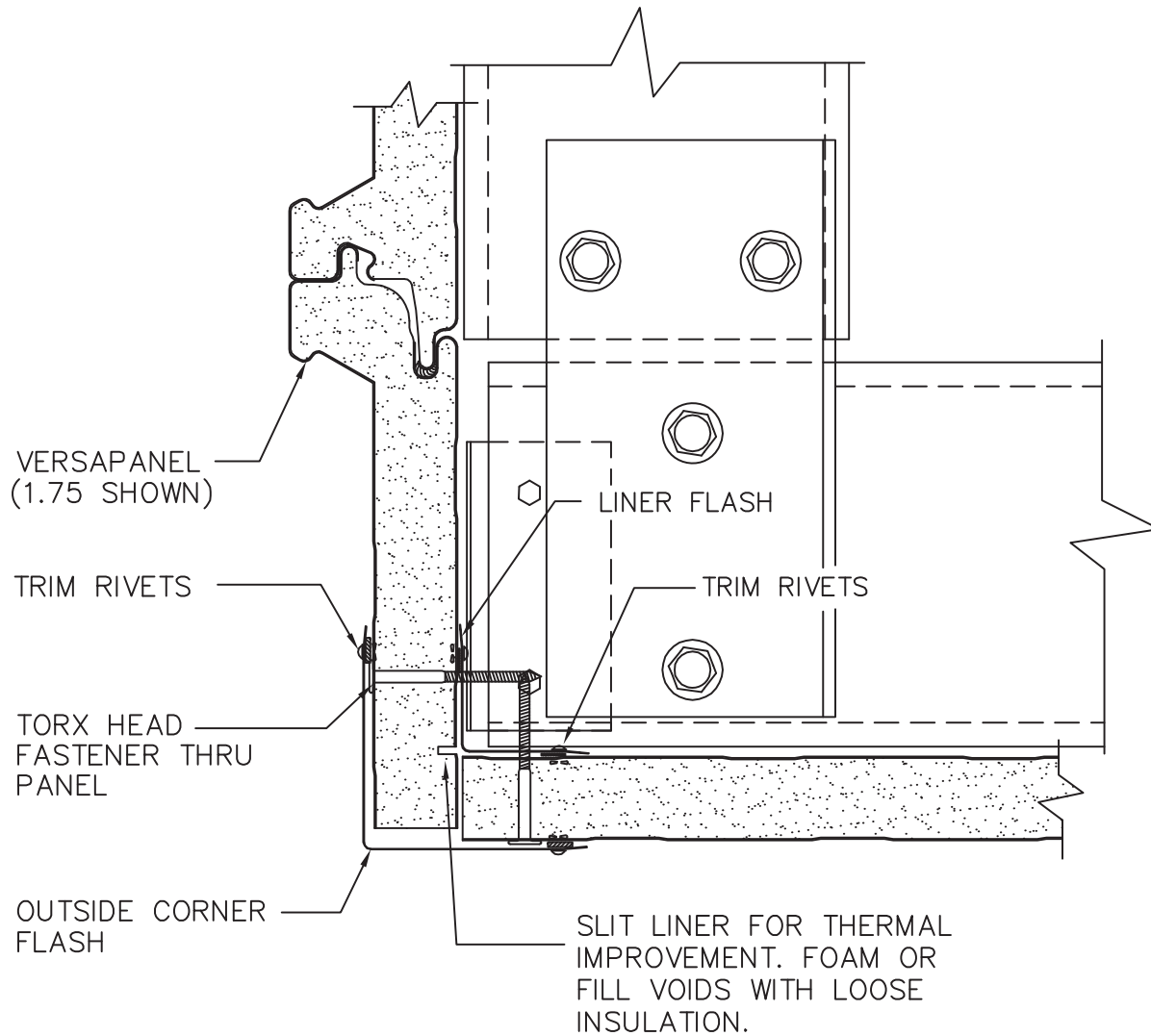

NOTE:

SET ALL FLASHING
IN SEALANT



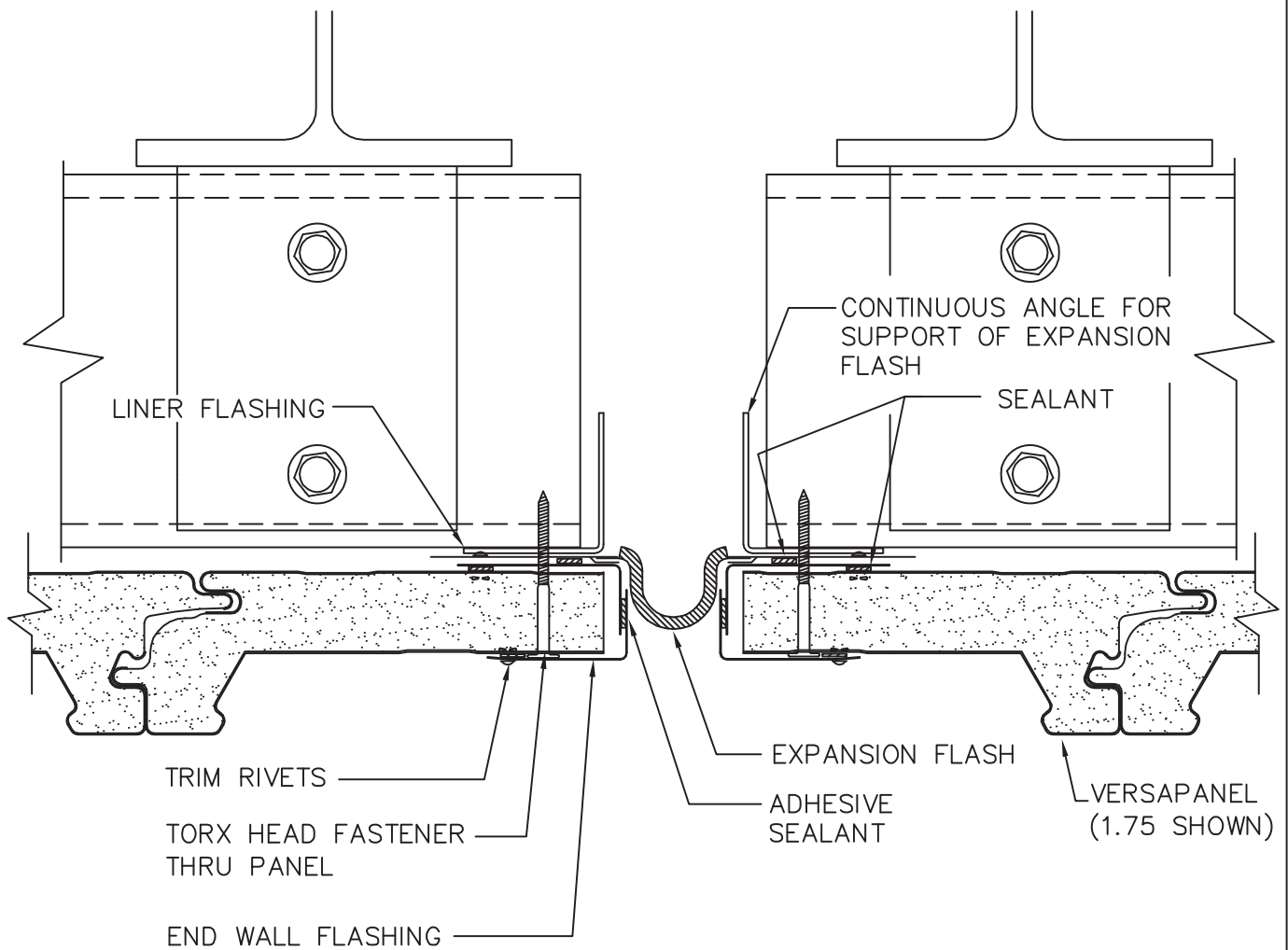

NOTE:

SET ALL FLASHING IN
CONTINUOUS SEALANT



VERSAPANEL

PROMOTIONAL
DETAIL # 101

KERF FOAM AS
SHOWN TO ALLOW
CLEARANCE FOR
FLASHING AND
SEALANT.

1 1/2"
(38mm)

SEALANT AROUND THE
INSIDE EDGE OF THE
METAL RIB CLOSURE.

VERSAPANEL
(R-250 SHOWN)

END/BATTEN

END/PNL

PANEL CLIP
& FASTENER

BATTEN

1/4"

SEALANT

METAL RIB
CLOSURE

BULB-TITE
RIVETS.

SEALANT

BULB-TITE

EAVE FLASHING

METAL CLOSURE

PANEL CLIP
& FASTENER

VERSAPANEL
(1.75 SHOWN)

3 1/2"
(89mm)

GIRT LINE



CENTRIA
CENTRIA Architectural Systems

EAVE

30
May 08

VERSAPANEL

PROMOTIONAL
DETAIL # 102

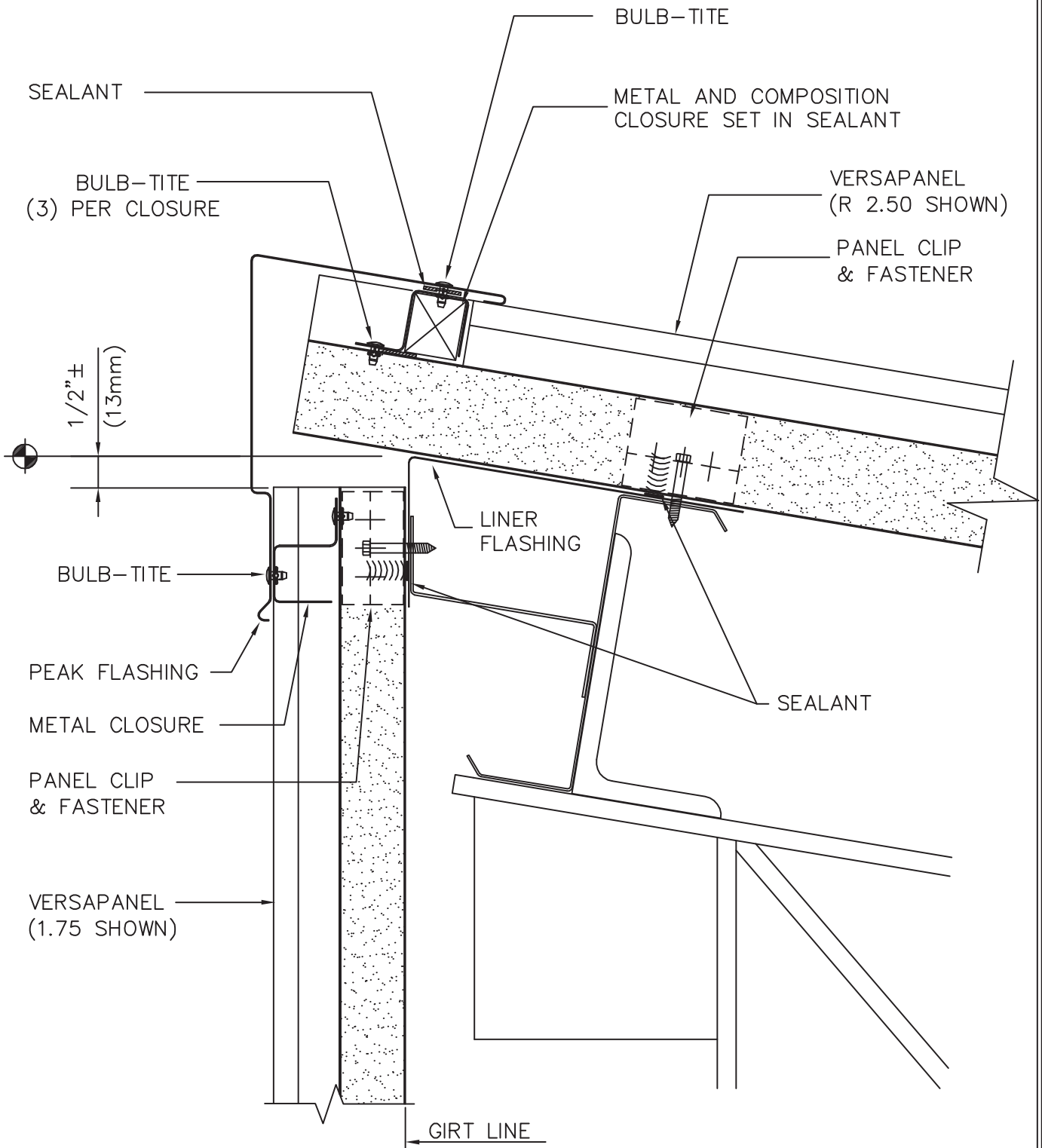

CENTRIA
CENTRIA Architectural Systems

PEAK

31
May 08

VERSAPANEL

PROMOTIONAL
DETAIL # 103

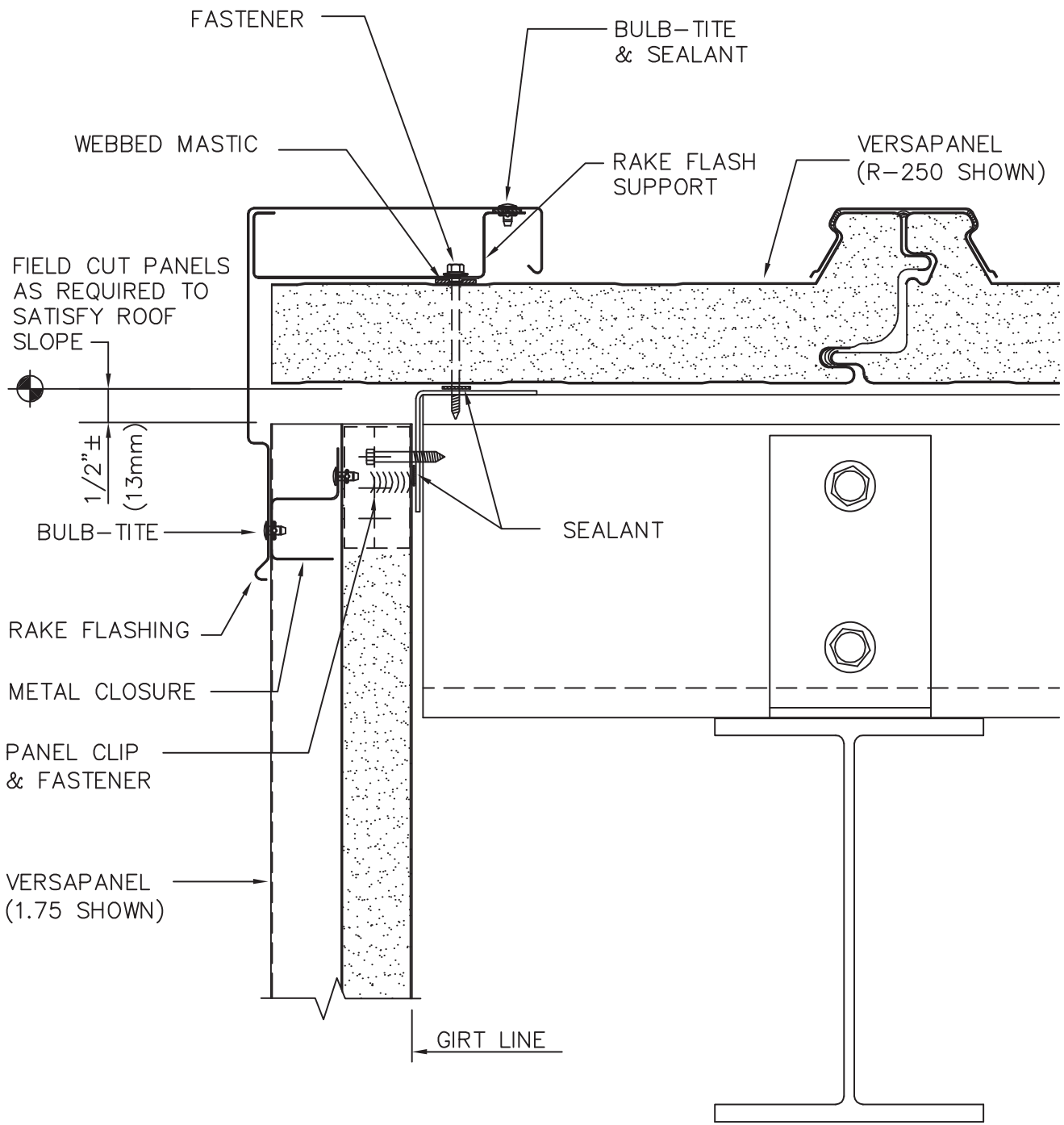

CENTRIA
CENTRIA Architectural Systems

RAKE

32
May 08

VERSAPANEL

PROMOTIONAL
DETAIL # 104

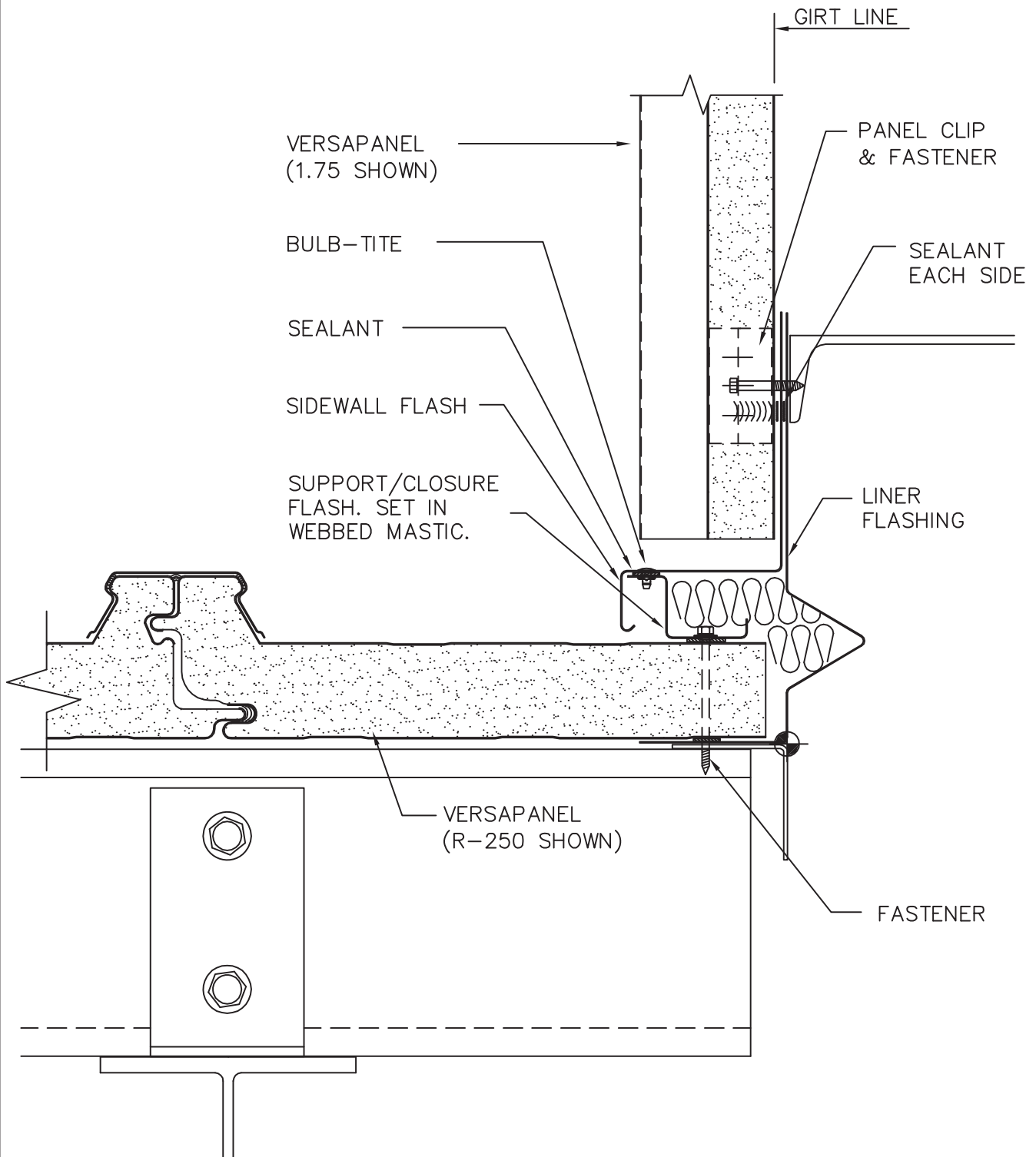

CENTRIA
CENTRIA Architectural Systems

SIDEWALL

33
May 08

VERSAPANEL

PROMOTIONAL
DETAIL # 105

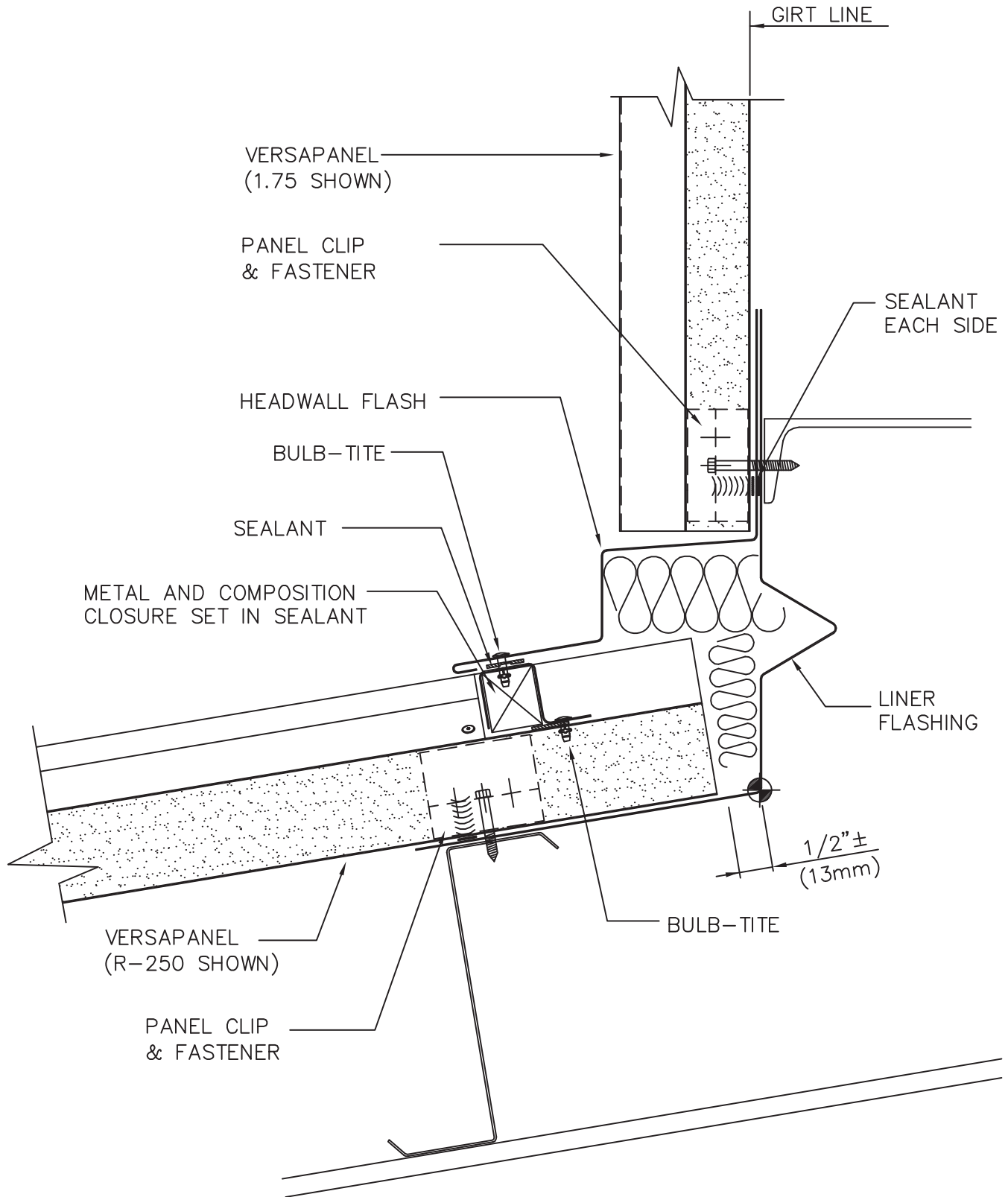

CENTRIA
CENTRIA Architectural Systems

HEAD WALL

VERSAPANEL

PROMOTIONAL
DETAIL # 106

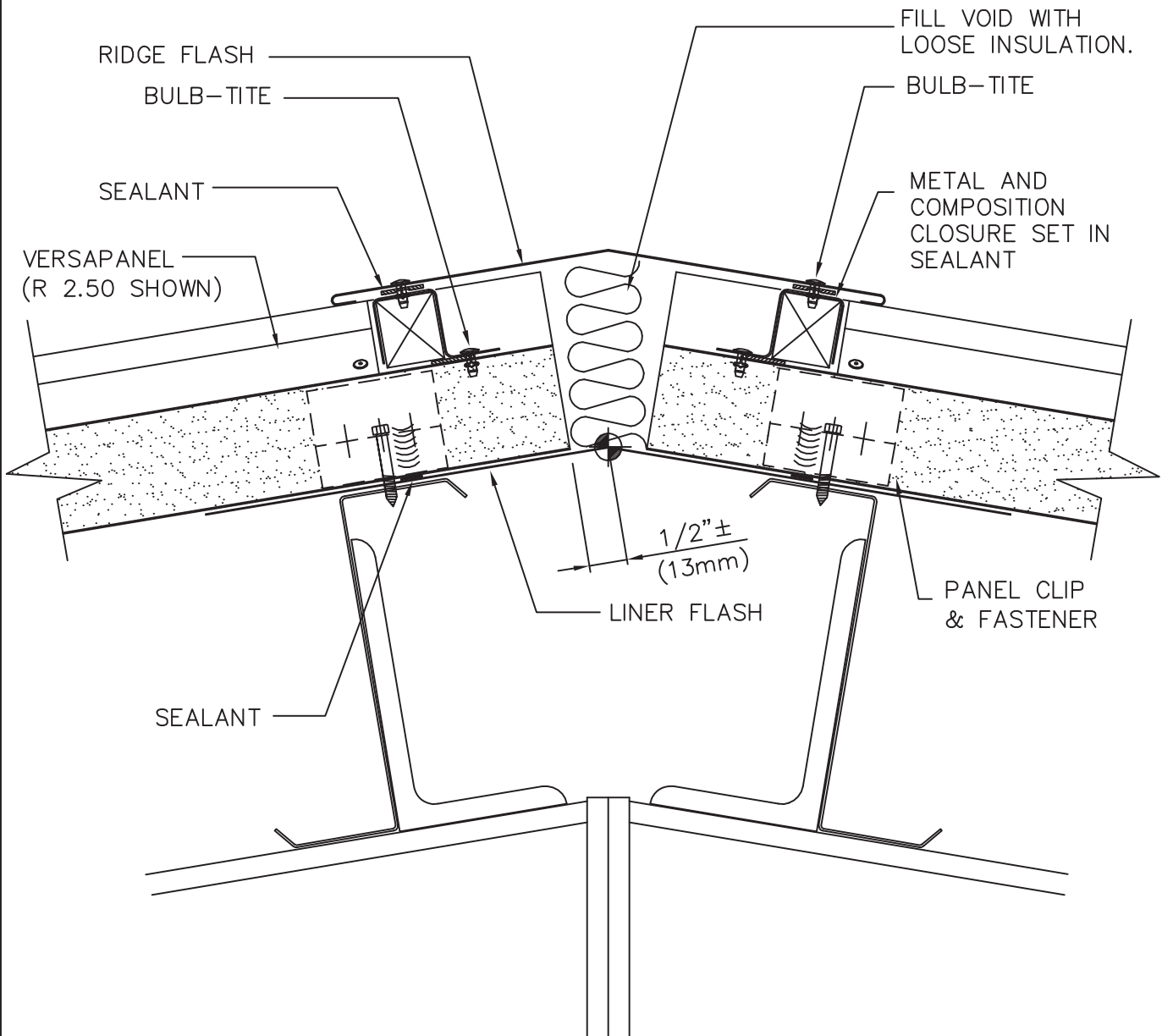

CENTRIA
CENTRIA Architectural Systems

RIDGE

35
May 08

VERSAPANEL

PROMOTIONAL
DETAIL # 107

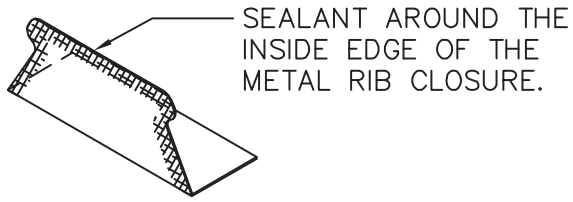

FIELD COPE PANEL
TO ACCEPT
CONTINUOUS "Z"
SUPPORT.

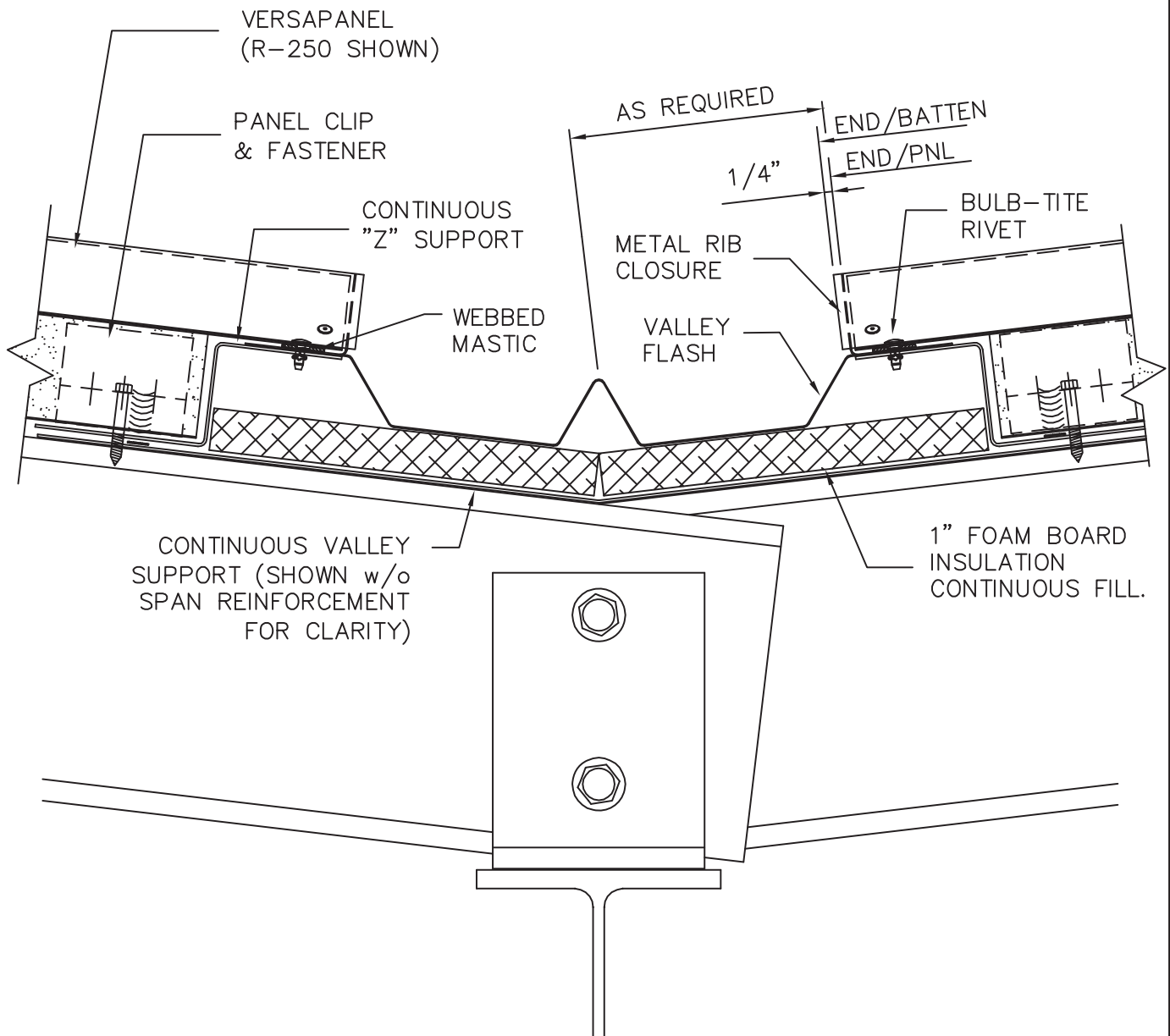
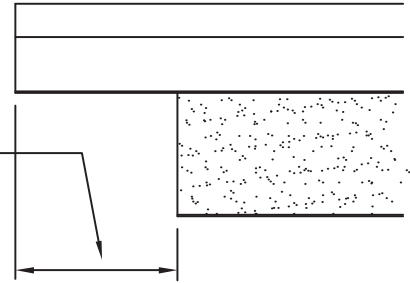

CENTRIA
CENTRIA Architectural Systems

VALLEY

36
May 08

VERSAPANEL ROOF/VERSAWALL

PROMOTIONAL
DETAIL # 108

KERF FOAM AS SHOWN TO ALLOW CLEARANCE FOR FLASHING AND SEALANT.

1 1/2"
(38mm)

SEALANT AROUND THE INSIDE EDGE OF THE METAL RIB CLOSURE.

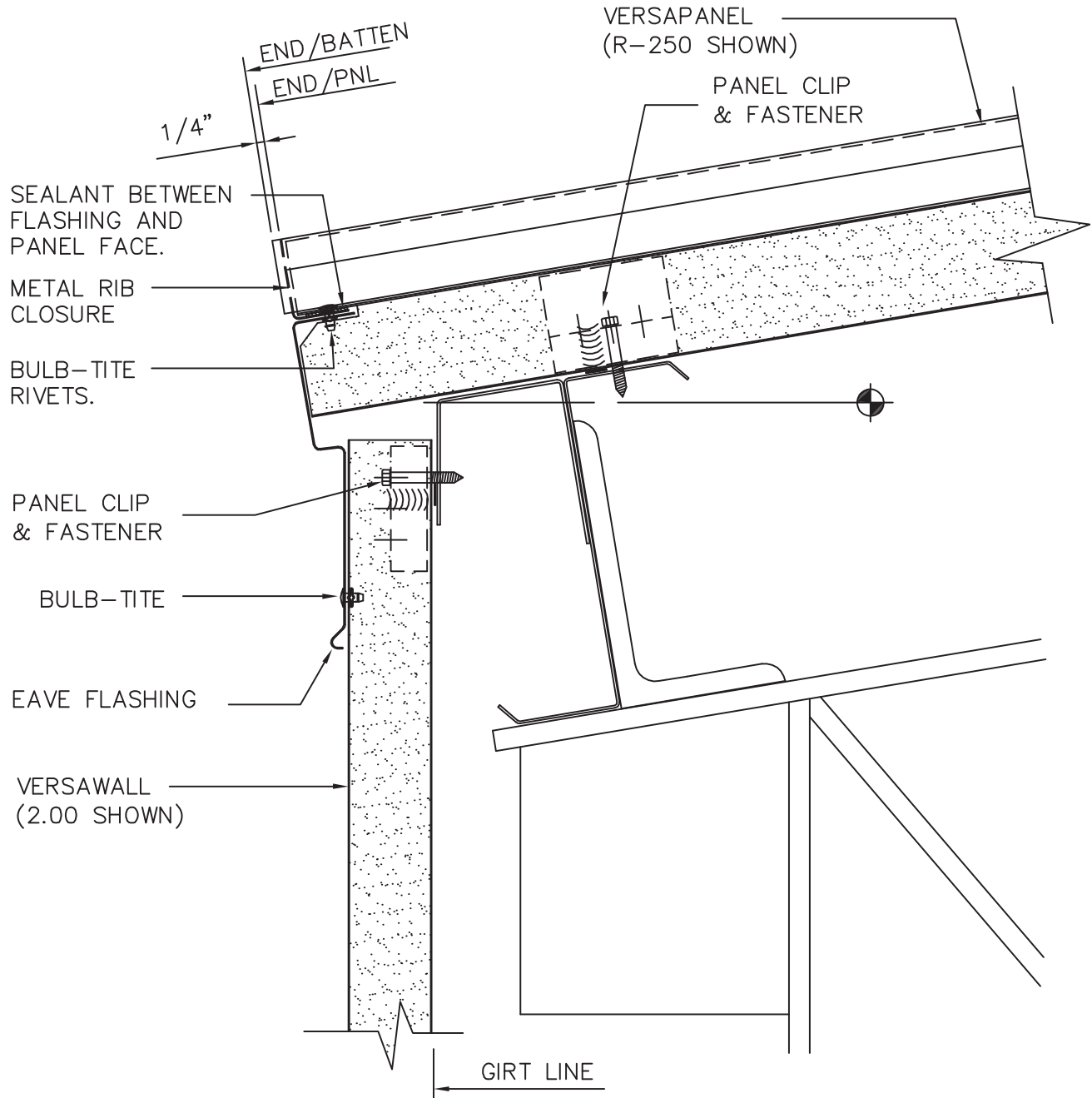

CENTRIA
CENTRIA Architectural Systems

EAVE

37
May 08

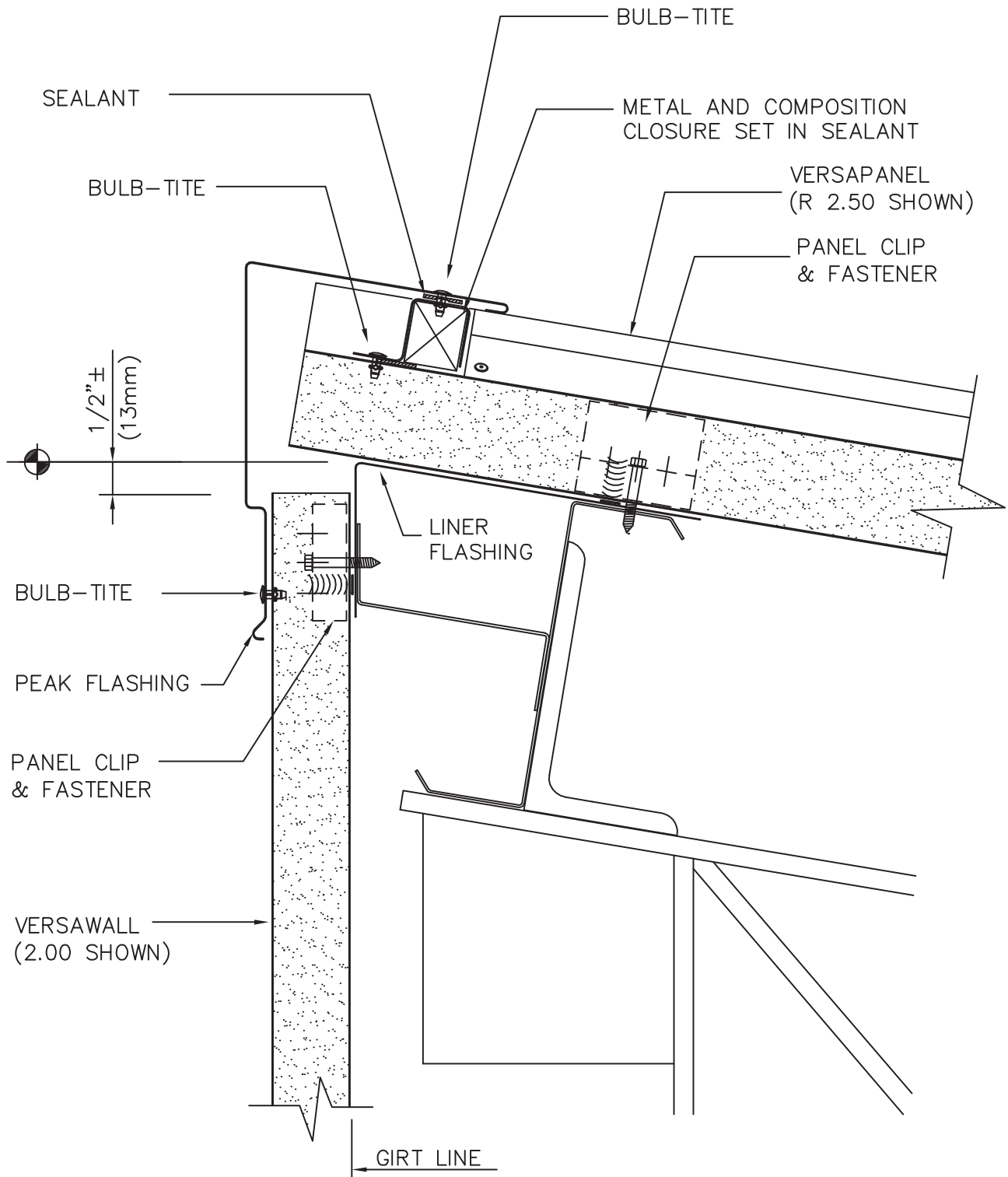

VERSAPANEL ROOF/VERSAWALL

PROMOTIONAL
DETAIL # 110

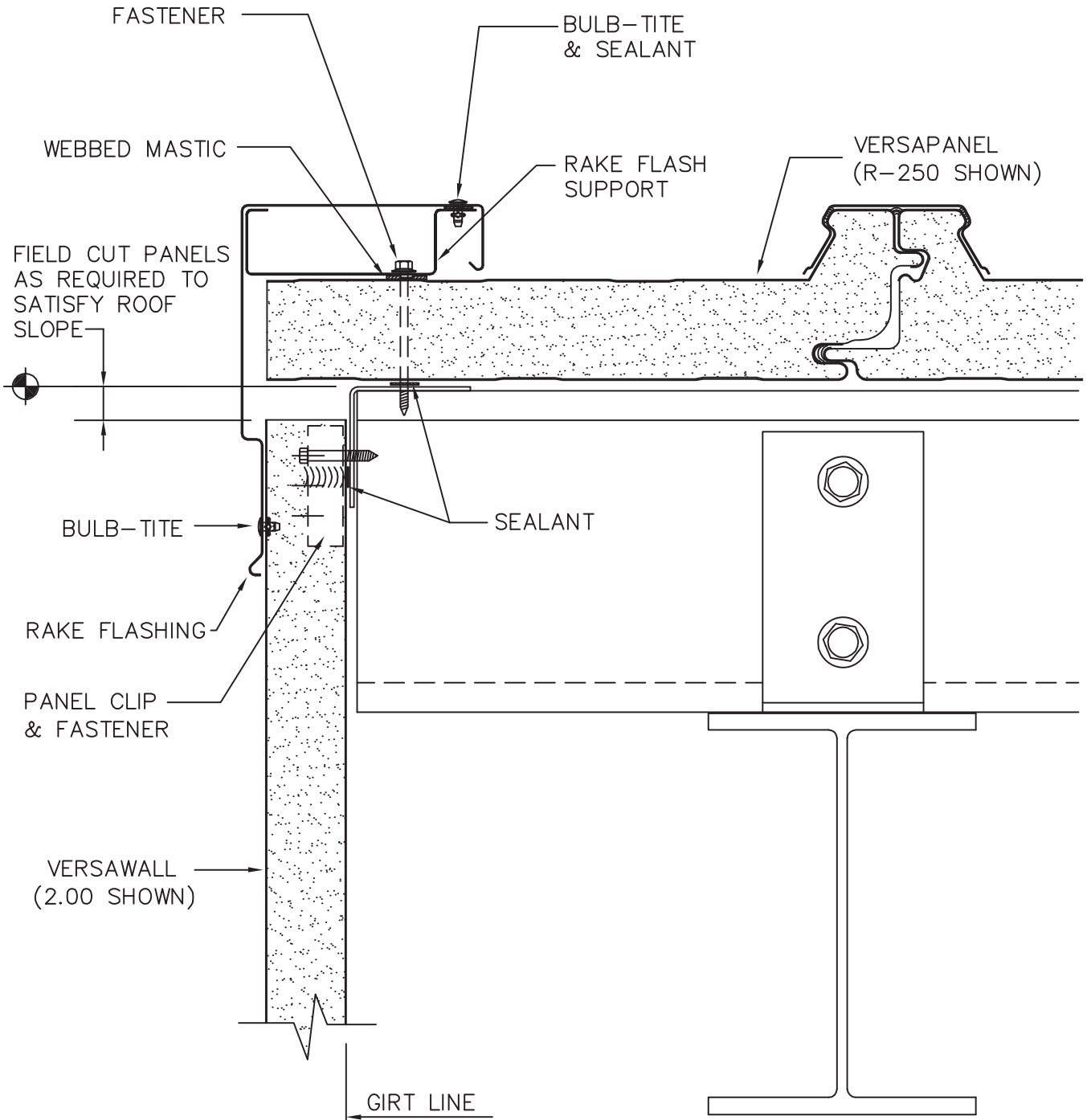

VERSAPANEL ROOF/VERSAWALL

PROMOTIONAL
DETAIL # 111

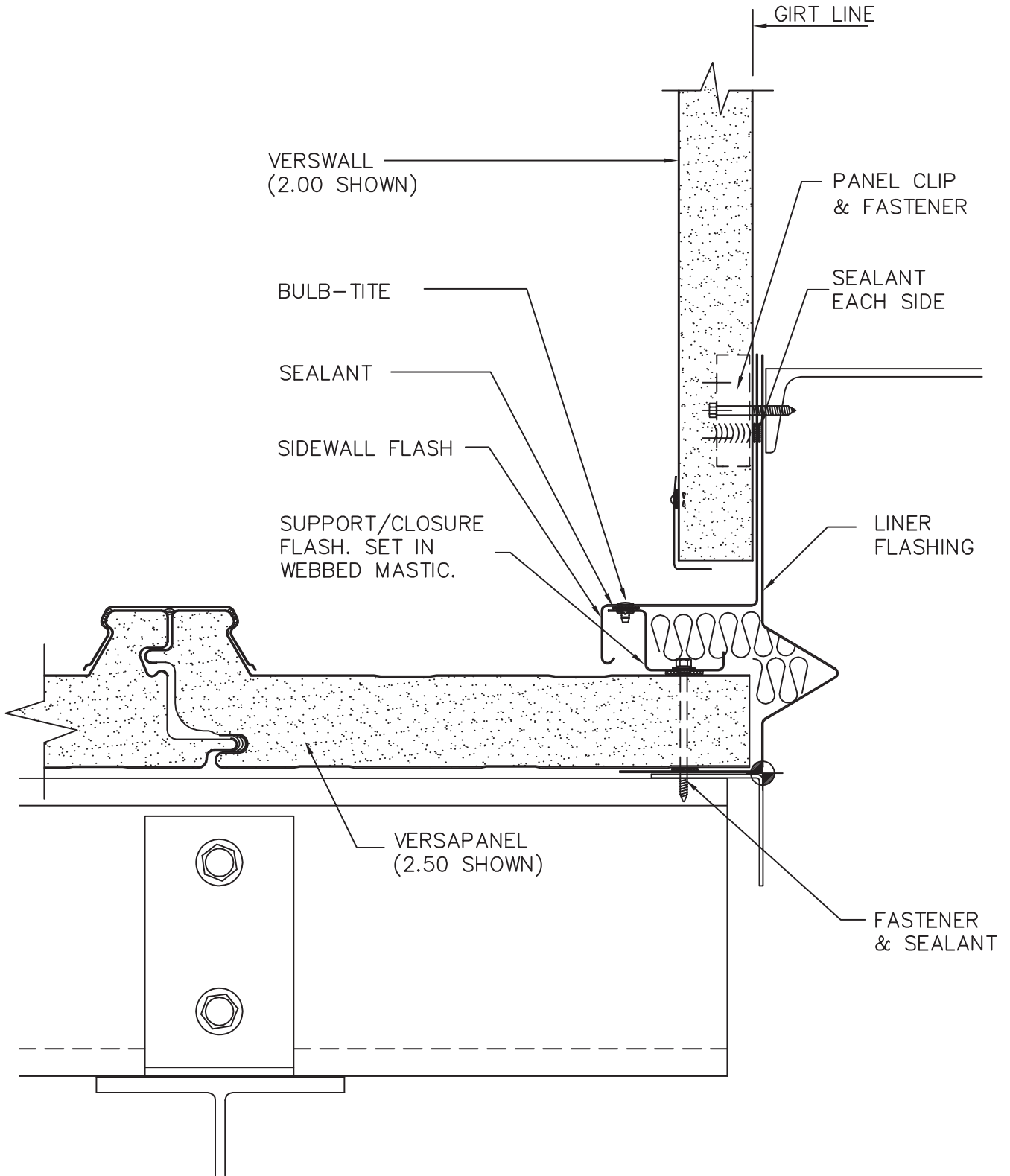

CENTRIA
CENTRIA Architectural Systems

SIDE WALL

40
May 08

VERSAPANEL ROOF/VERSAWALL

PROMOTIONAL
DETAIL # 112

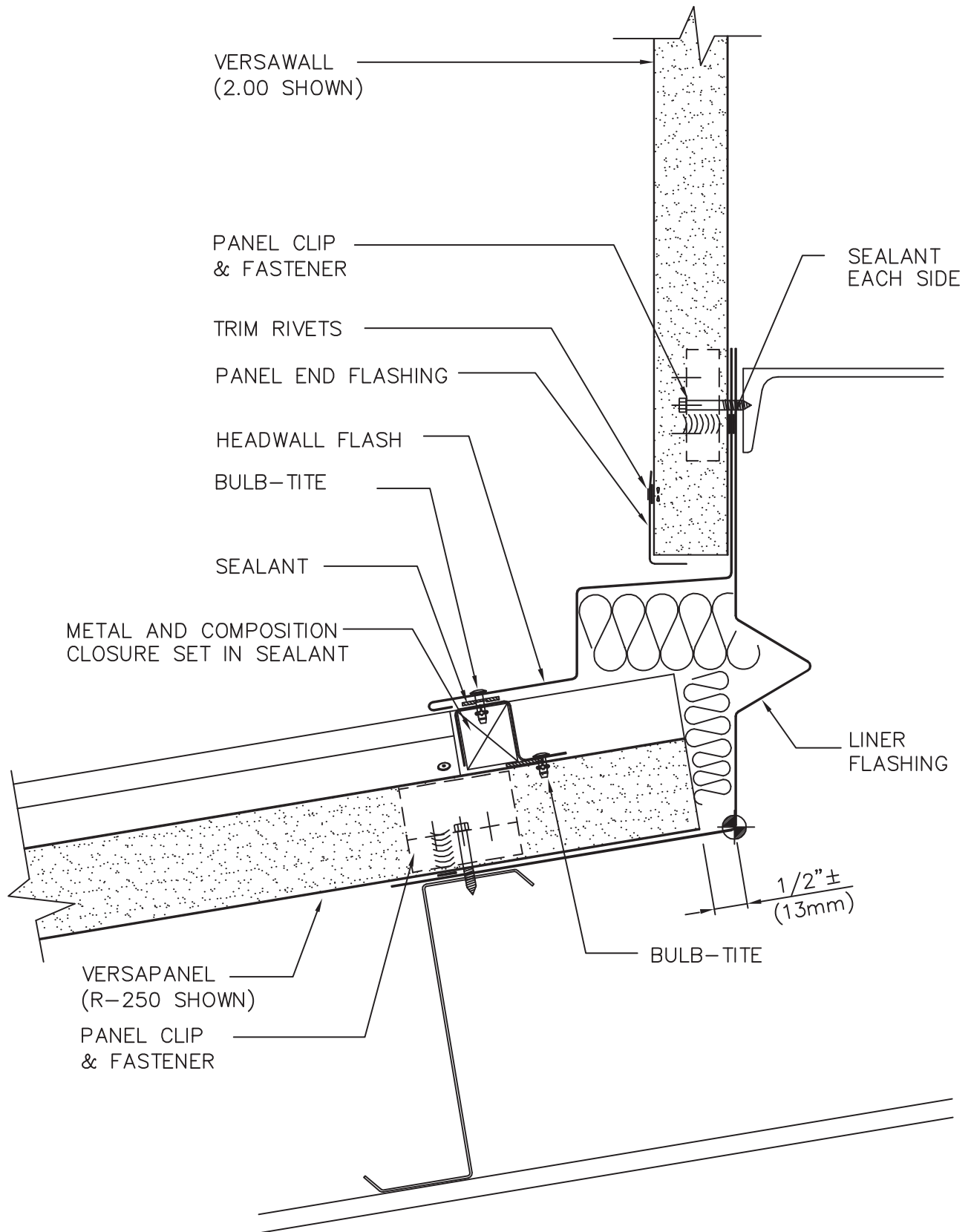

CENTRIA
CENTRIA Architectural Systems

HEADWALL

VERSAPANEL

PROMOTIONAL
DETAIL # 113

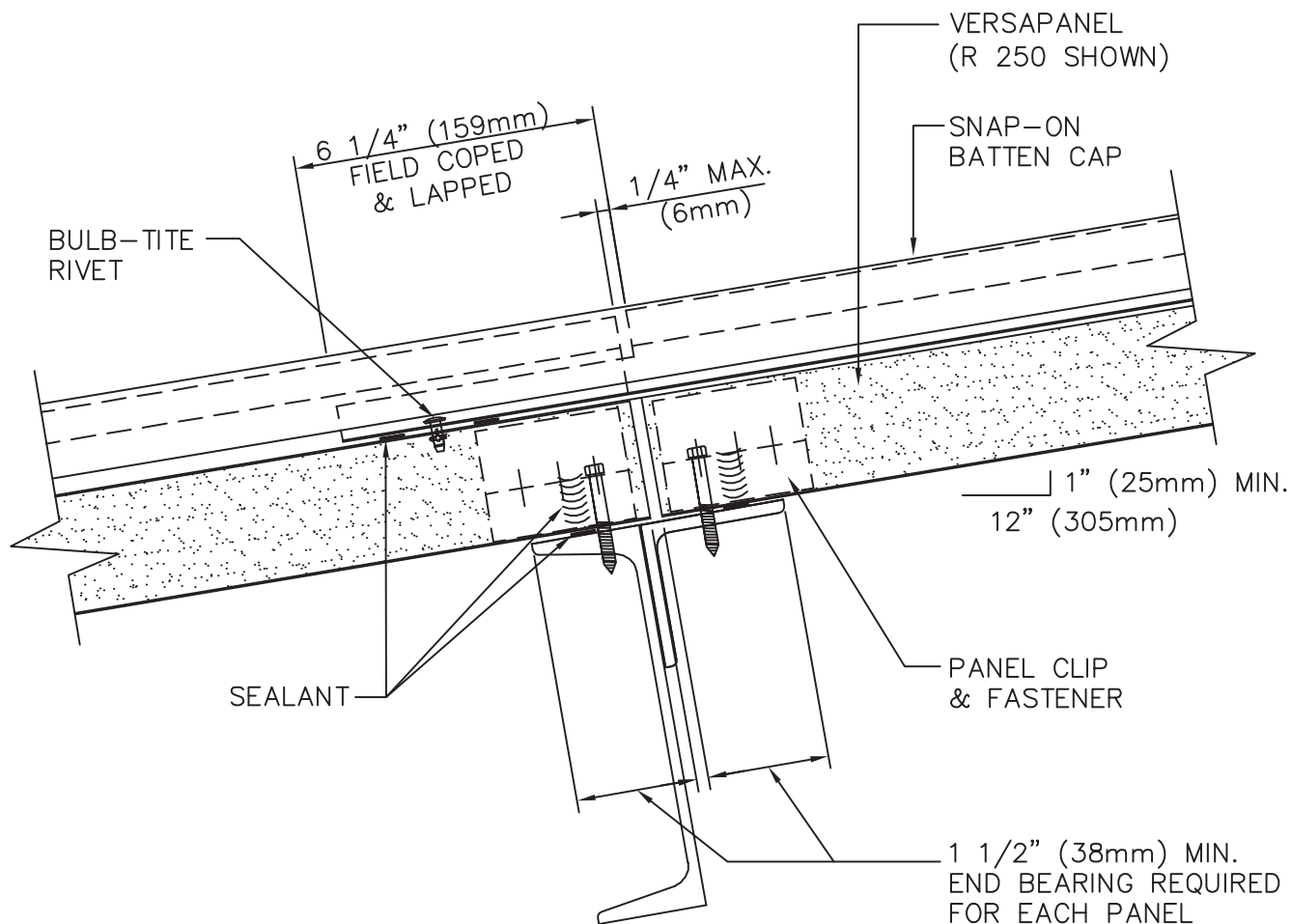

NOTES:

- 1) MINIMUM ROOF SLOPE IS 1":12" (25mm:305mm) WITH END LAPS.
- 2) DETAIL DOES NOT ILLUSTRATE ALL ITEMS NEEDED FOR INSTALLATION. CONTACT CENTRIA FOR COMPLETE INSTRUCTIONS.



CENTRIA
CENTRIA Architectural Systems

END LAP

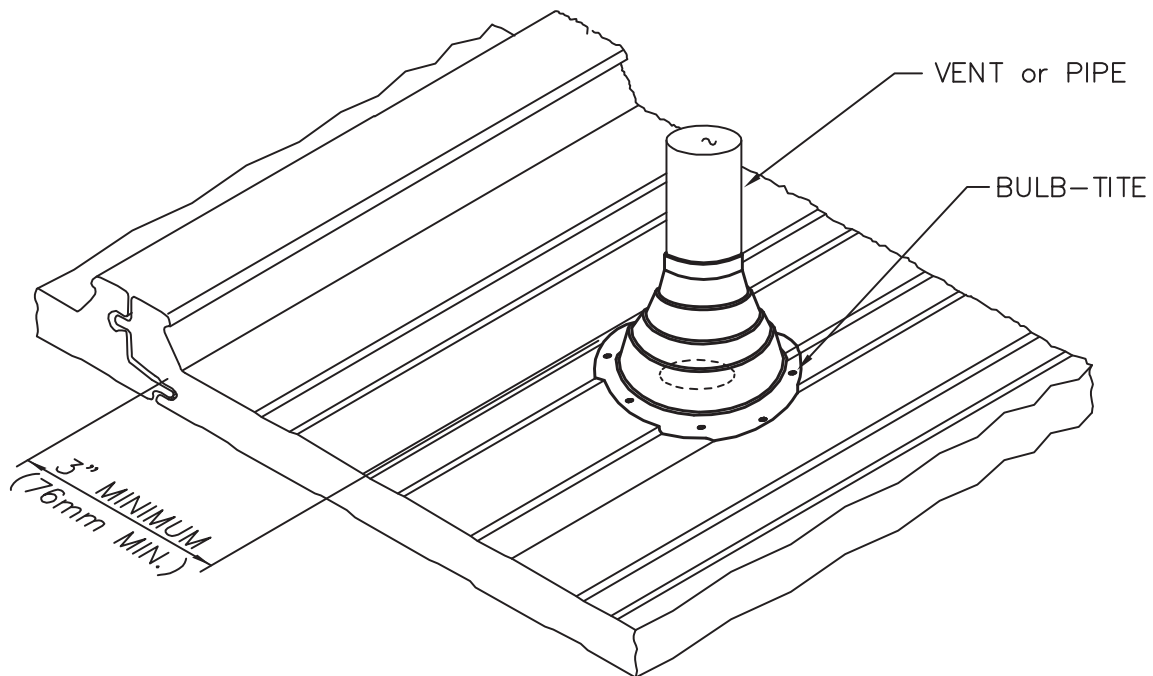

NOTE:
PIPE PENETRATIONS MUST NOT BE
INSTALLED THROUGH PANEL RIB AT SIDE
JOINT. PENETRATIONS OCCURRING AT
THIS LOCATION MUST USE DETAIL 115.

PIPE PENETRATION



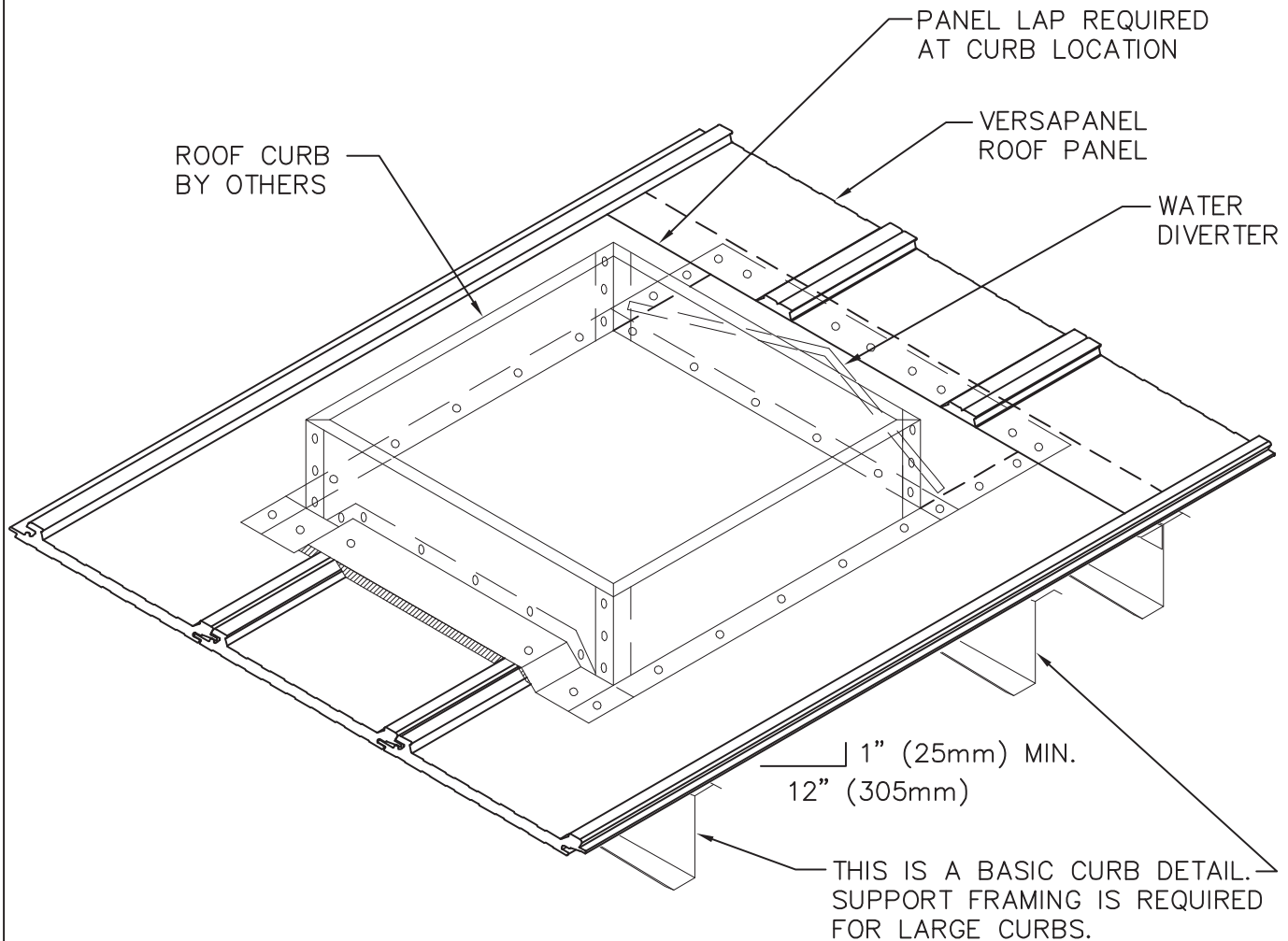

ROOF CURB PENETRATION

PANELS MUST BE ORDERED SHOP NOTCHED SO THEY CAN BE FIELD COPED TO MEET THIS CONDITION. THE COPED DISTANCE MUST BE 6 1/4" (159mm) PER MANUFACTURING STANDARDS FOR END LAP CONDITION.
METAL TRAPEZOIDAL END CLOSURES – USE STANDARD CLOSURES FOR STRAIGHT CUT ENDS. FIELD FORM FLATS FOR BEVELED CONDITIONS.
BED IN BUTYL SEALANT.



VERSAPANEL

3/16" Steel Supports

Thickness (in.)	Gage Face/Liner	No. Spans	Load-psf								
			20	25	30	35	40	45	50	55	60
1.75	26/26	1	14'-0"	11'-5"	9'-6"	8'-2"	7'-1"	6'-4"	5'-8"	5'-2"	4'-9"
		2	14'-9"	12'-0"	10'-0"	8'-8"	7'-8"	6'-11"	6'-3"	5'-9"	5'-4"
		3	13'-4"†	13'-3"	11'-1"	9'-6"	8'-4"	7'-5"	6'-8"	6'-1"	5'-7"
	24/24	1	15'-1"	12'-10"	10'-8"	9'-2"	8'-0"	7'-2"	6'-5"	5'-10"	5'-4"
		2	15'-9"	12'-9"	10'-9"	9'-3"	8'-3"	7'-5"	6'-9"	6'-2"	5'-8"
		3	13'-4"†	13'-4"†	11'-9"	10'-1"	8'-10"	7'-11"	7'-2"	6'-6"	6'-0"
2.50	26/26	1	15'-0"	12'-0"	10'-0"	8'-7"	7'-6"	6'-8"	6'-0"	5'-5"	5'-0"
		2	16'-0"*	13'-5"	11'-3"	9'-9"	8'-8"	7'-9"	7'-1"	6'-4"	5'-9"
		3	13'-4"†	13'-4"†	12'-3"	10'-5"	9'-1"	8'-0"	7'-2"	6'-5"	5'-10"
	24/24	1	16'-0"*	13'-4"	11'-2"	9'-7"	8'-4"	7'-5"	6'-8"	6'-1"	5'-7"
		2	16'-0"*	14'-9"	12'-5"	10'-9"	9'-6"	8'-7"	7'-9"	7'-0"	6'-4"
		3	13'-4"†	13'-4"†	13'-4"†	11'-7"	10'-1"	8'-11"	8'-0"	7'-2"	6'-6"
4.00	26/26	1	16'-0"*	13'-5"	11'-2"	9'-7"	8'-4"	7'-5"	6'-8"	6'-1"	5'-7"
		2	16'-0"*	16'-0"*	14'-0"	11'-10"	10'-2"	8'-10"	7'-10"	7'-0"	6'-4"
		3	13'-4"†	13'-4"†	13'-4"†	11'-7"	10'-1"	8'-11"	8'-0"	7'-2"	6'-6"
	24/24	1	16'-0"*	16'-0"*	13'-8"	11'-9"	10'-3"	9'-2"	8'-3"	7'-6"	6'-10"
		2	16'-0"*	16'-0"*	16'-0"*	14'-7"	12'-7"	11'-0"	9'-9"	8'-9"	7'-10"
		3	13'-4"†	13'-4"†	13'-4"†	13'-4"†	12'-5"	11'-0"	9'-10"	8'-10"	8'-0"

16 Gage Steel Supports

Thickness (in.)	Gage Face/Liner	No. Spans	Load-psf								
			20	25	30	35	40	45	50	55	60
1.75	26/26	1	11'-6"	9'-2"	7'-8"	6'-7"	5'-9"	5'-1"	4'-7"	4'-2"	3'-10"
		2	9'-7"	7'-9"	6'-7"	5'-9"	5'-1"	4'-7"	4'-2"	3'-10"	3'-6"
		3	10'-6"	8'-5"	7'-1"	6'-1"	5'-4"	4'-9"	4'-4"	4'-0"	3'-7"
	24/24	1	11'-6"	9'-2"	7'-8"	6'-7"	5'-9"	5'-1"	4'-7"	4'-2"	3'-10"
		2	9'-8"	7'-10"	6'-8"	5'-10"	5'-2"	4'-8"	4'-3"	3'-10"	3'-7"
		3	10'-6"	8'-6"	7'-1"	6'-1"	5'-4"	4'-9"	4'-4"	4'-0"	3'-8"
2.50	26/26	1	11'-6"	9'-2"	7'-8"	6'-7"	5'-9"	5'-1"	4'-7"	4'-2"	3'-10"
		2	9'-8"	7'-10"	6'-8"	5'-10"	5'-2"	4'-8"	4'-3"	3'-10"	3'-7"
		3	10'-6"	8'-6"	7'-1"	6'-1"	5'-4"	4'-9"	4'-4"	4'-0"	3'-8"
	24/24	1	11'-6"	9'-2"	7'-8"	6'-7"	5'-9"	5'-1"	4'-7"	4'-2"	3'-10"
		2	9'-9"	8'-0"	6'-9"	5'-11"	5'-3"	4'-8"	4'-3"	3'-11"	3'-7"
		3	10'-7"	8'-6"	7'-1"	6'-2"	5'-5"	4'-10"	4'-4"	4'-0"	3'-8"
4.00	26/26	1	11'-6"	9'-2"	7'-8"	6'-7"	5'-9"	5'-1"	4'-7"	4'-2"	3'-10"
		2	9'-9"	8'-0"	6'-9"	5'-11"	5'-3"	4'-8"	4'-3"	4'-0"	3'-7"
		3	10'-7"	8'-6"	7'-1"	6'-2"	5'-5"	4'-10"	4'-4"	4'-0"	3'-8"
	24/24	1	11'-6"	9'-2"	7'-8"	6'-7"	5'-9"	5'-1"	4'-7"	4'-2"	3'-10"
		2	9'-11"	8'-1"	6'-10"	6'-0"	5'-4"	4'-9"	4'-4"	4'-0"	3'-8"
		3	10'-7"	8'-6"	7'-2"	6'-2"	5'-5"	4'-10"	4'-5"	4'-0"	3'-8"

Explanatory notes for Load/Span Table:

1. Spans are limited to a maximum deflection of L/120 for positive wind load.
2. Spans are based on 2 fasteners per interior clip with an allowable pullout capacity of 1064 lb. per fastener for 3/16" thick steel supports and 344 lb. per fastener for 16 gage steel supports.
3. Consider gravity load/span table when applicable.
4. Higher loads may be achieved with special fastening details. Contact CENTRIA.
5. Table may be used for positive or negative wind loads. Panel dead weight has not been included.
6. * Spans limited by thermal stress and thermal bow considerations.
7. †Triple span limited by 40'-0" maximum panel length.
8. Contact CENTRIA for conditions not conforming to these notes.



CENTRIA
CENTRIA Architectural Systems

Wind Loads for Versapanel Wall & Roof Panels

VERSAPANEL

Load/Span Table - Wind Loads for Versapanel Wall and Roof Panels

4.75mm (3/16") Steel Supports											
Thickness	Gage	No.	Load - kPa								
(in.)	Face/Liner	Spans	1.00	1.25	1.50	1.75	2.00	2.25	2.50	2.75	3.00
45mm (1.75")	26/26	1	4.16m	3.32m	2.77m	2.38m	2.08m	1.85m	1.66m	1.51m	1.39m
		2	4.32m	3.49m	2.94m	2.55m	2.25m	2.02m	1.84m	1.69m	1.56m
		3	4.00m†	3.87m	3.23m	2.77m	2.43m	2.17m	1.96m	1.78m	1.63m
	24/24	1	4.51m	3.75m	3.12m	2.68m	2.34m	2.08m	1.87m	1.70m	1.56m
		2	4.61m	3.73m	3.14m	2.72m	2.41m	2.16m	1.97m	1.80m	1.67m
		3	4.00m†	4.00m†	3.44m	2.95m	2.59m	2.31m	2.09m	1.90m	1.75m
64mm (2.50")	26/26	1	4.37m	3.50m	2.92m	2.50m	2.19m	1.94m	1.75m	1.59m	1.46m
		2	4.86m	3.92m	3.30m	2.86m	2.53m	2.27m	2.06m	1.84m	1.66m
		3	4.00m†	4.00m†	3.57m	3.04m	2.64m	2.33m	2.08m	1.88m	1.70m
	24/24	1	4.88m	3.90m	3.25m	2.79m	2.44m	2.17m	1.95m	1.77m	1.63m
		2	4.88m*	4.33m	3.65m	3.16m	2.80m	2.51m	2.28m	2.04m	1.84m
		3	4.00m†	4.00m†	3.98m	3.38m	2.94m	2.59m	2.31m	2.08m	1.89m
102mm (4.00")	26/26	1	4.88m	3.90m	3.25m	2.79m	2.44m	2.17m	1.95m	1.78m	1.63m
		2	4.88m*	4.88m*	4.08m	3.43m	2.95m	2.57m	2.28m	2.04m	1.84m
		3	4.00m†	4.00m†	4.00m†	3.38m	2.94m	2.59m	2.31m	2.08m	1.89m
	24/24	1	4.88m*	4.79m	4.00m	3.42m	3.00m	2.66m	2.40m	2.18m	2.00m
		2	4.88m*	4.88m*	4.04m	4.25m	3.65m	3.19m	2.82m	2.52m	2.28m
		3	4.00m†	4.00m†	4.00m†	4.00m†	3.62m	3.19m	2.85m	2.70m	2.34m

1.50mm (16 Gage) Steel Supports											
Thickness	Gage	No.	Load-psf								
(in.)	Face/Liner	Spans	20	25	30	35	40	45	50	55	60
45mm (1.75")	26/26	1	3.35m	2.68m	2.23m	1.91m	1.67m	1.49m	1.34m	1.22m	1.12m
		2	2.80m	2.28m	1.93m	1.68m	1.49m	1.34m	1.22m	1.12m	1.03m
		3	3.07m	2.46m	2.06m	1.77m	1.56m	1.39m	1.26m	1.15m	1.06m
	24/24	1	3.35m	2.68m	2.23m	1.91m	1.67m	1.49m	1.34m	1.22m	1.12m
		2	2.83m	2.30m	1.95m	1.70m	1.51m	1.36m	1.23m	1.13m	1.05m
		3	3.06m	2.47m	2.07m	1.78m	1.57m	1.40m	1.27m	1.16m	1.06m
64mm (2.50")	26/26	1	3.35m	2.68m	2.23m	1.91m	1.67m	1.49m	1.34m	1.22m	1.12m
		2	2.83m	2.30m	1.95m	1.70m	1.51m	1.36m	1.23m	1.13m	1.05m
		3	3.08m	2.47m	2.07m	1.78m	1.57m	1.40m	1.27m	1.16m	1.06m
	24/24	1	3.35m	2.68m	2.23m	1.91m	1.67m	1.49m	1.34m	1.22m	1.12m
		2	2.86m	2.34m	1.98m	1.73m	1.53m	1.38m	1.25m	1.15m	1.06m
		3	3.08m	2.48m	2.08m	1.79m	1.58m	1.41m	1.27m	1.16m	1.07m
102mm (4.00")	26/26	1	3.35m	2.68m	2.23m	1.91m	1.67m	1.49m	1.34m	1.22m	1.12m
		2	2.87m	2.34m	1.98m	1.73m	1.53m	1.38m	1.25m	1.15m	1.06m
		3	3.09m	2.48m	2.08m	1.80m	1.58m	1.41m	1.28m	1.16m	1.07m
	24/24	1	3.35m	2.68m	2.23m	1.91m	1.67m	1.49m	1.34m	1.22m	1.12m
		2	2.90m	2.37m	2.02m	1.75m	1.55m	1.40m	1.27m	1.16m	1.07m
		3	3.09m	2.49m	2.09m	1.80m	1.59m	1.42m	1.28m	1.17m	1.08m

Explanatory notes for Load/Span Table:

- Spans are limited to a maximum deflection of L/120 for positive wind load.
- Spans are based on 2 fasteners per interior clip with an allowable pullout capacity of 11,830 N per fastener for 4.75mm (3/16") thick steel supports and 3825 N per fastener for 1.50mm (16 gage) steel supports.
- Consider gravity load/span table when applicable.
- Higher loads may be achieved with special fastening details. Contact CENTRIA.
- Table may be used for positive or negative wind loads. Panel dead weight has not been included.
- * Spans limited by thermal stress and thermal bow considerations.
- † Triple span limited by 12.00m (40'-0") maximum panel length.
- Contact CENTRIA for conditions not conforming to these notes.



CENTRIA
CENTRIA Architectural Systems

Metric Wind Loads for Versapanel Wall & Roof Panels

VERSAPANEL

Thickness (in.)	Gage Face/Liner	No. Spans	Load - psf								
			20	25	30	35	40	45	50	55	60
1.75	26/26	1	11'-9"	10'-8"	9'-10"	9'-2"	8'-7"	8'-1"	7'-7"	7'-3"	6'-11"
		2	13'-2"	12'-0"	11'-0"	10'-4"	9'-9"	8'-10"	8'-0"	7'-4"	6'-9"
		3	13'-4"†	12'-6"	11'-5"	10'-7"	9'-10"	8'-11"	8'-0"	7'-4"	6'-9"
	24/24	1	12'-8"	11'-5"	10'-6"	9'-8"	9'-1"	8'-6"	8'-0"	7'-7"	7'-3"
		2	15'-1"	13'-8"	12'-5"	11'-0"	9'-8"	8'-8"	7'-11"	7'-3"	6'-8"
		3	13'-4"†	13'-4"	12'-1"	11'-1"	9'-9"	8'-9"	7'-11"	7'-3"	6'-8"
2.50	26/26	1	14'-4"	13'-0"	12'-0"	11'-1"	10'-5"	9'-9"	9'-3"	8'-10"	8'-6"
		2	15'-7"	14'-1"	13'-0"	12'-2"	11'-6"	11'-0"	9'-11"	9'-1"	8'-4"
		3	13'-4"†	13'-4"†	13'-4"†	12'-10"	12'-1"	11'-1"	10'-0"	9'-2"	8'-5"
	24/24	1	15'-6"	14'-1"	13'-0"	12'-0"	11'-3"	10'-7"	10'-0"	9'-6"	9'-1"
		2	16'-0"*	16'-0"*	15'-1"	13'-11"	12'-3"	11'-0"	10'-0"	9'-2"	8'-5"
		3	13'-4"†	13'-4"†	13'-4"†	13'-4"†	12'-5"	11'-1"	10'-0"	9'-2"	8'-5"
4.00	26/26	1	16'-0"*	16'-0"*	15'-5"	14'-3"	13'-4"	12'-7"	12'-0"	11'-5"	10'-11"
		2	16'-0"*	16'-0"*	16'-0"*	15'-6"	14'-7"	13'-11"	12'-7"	11'-6"	10'-7"
		3	13'-4"†	13'-4"†	13'-4"†	13'-4"†	13'-4"†	13'-4"†	12'-9"	11'-7"	10'-8"
	24/24	1	16'-0"*	16'-0"*	16'-0"*	16'-0"*	15'-5"	14'-6"	13'-10"	13'-2"	12'-6"
		2	16'-0"*	16'-0"*	16'-0"*	16'-0"*	15'-7"	14'-0"	12'-8"	11'-7"	10'-9"
		3	13'-4"†	13'-4"†	13'-4"†	13'-4"†	13'-4"†	13'-4"†	12'-9"	11'-8"	10'-9"

Explanatory notes for Load/Span Table:

1. Spans are limited to a maximum deflection of L/180 for gravity load.
2. Consider wind load/span tables when applicable.
3. Panel dead weight has not been included.
4. * Spans limited by thermal stress and thermal bow considerations.
5. †Triple span limited by 40'-0" maximum panel length.
6. Contact CENTRIA for conditions not conforming to these notes.



VERSAPANEL

Load/Span Table - Gravity Loads for Versapanel Roof Panels

Thickness (in.)	Gage Face/Liner	No. Spans	Load - kPa								
			1.00	1.25	1.50	1.75	2.00	2.25	2.50	2.75	3.00
45 mm (1.75)	26/26	1	3.53m	3.19m	2.94m	2.73m	2.55m	2.40m	2.27m	2.16m	2.05m
		2	3.93m	3.56m	3.92m	3.09m	2.87m	2.58m	2.34m	2.14m	1.98m
		3	4.00m†	3.74m	3.41m	3.14m	2.91m	2.60m	2.35m	2.14m	1.97m
	24/24	1	3.78m	3.41m	3.12m	2.89m	2.70m	2.53m	2.39m	2.26m	2.15m
		2	4.50m	4.08m	3.68m	3.21m	2.84m	2.55m	2.31m	2.12m	1.96m
		3	4.00m†	3.96m	3.60m	3.26m	2.86m	2.55m	2.31m	2.21m	1.95m
64 mm (2.50)	26/26	1	4.28m	3.89m	3.58m	3.31m	3.10m	2.92m	2.77m	2.64m	2.53m
		2	4.66m	4.22m	3.90m	3.65m	3.45m	3.20m	2.90m	2.66m	2.45m
		3	4.00m†	4.00m†	4.00m†	3.84m	3.60m	3.24m	2.93m	2.67m	2.56m
	24/24	1	4.65m	4.20m	3.86m	3.58m	3.35m	3.15m	2.98m	2.83m	2.69m
		2	4.88m*	4.88m*	4.51m	4.07m	3.59m	3.22m	2.92m	2.68m	2.48m
		3	4.00m†	4.00m†	4.00m†	4.00m†	3.63m	3.24m	2.93m	2.68m	2.46m
102 mm (4.00)	26/26	1	4.88m*	4.88m*	4.60m	4.26m	3.98m	3.75m	3.56m	3.39m	3.25m
		2	4.88m*	4.88m*	4.88m*	4.63m	4.37m	4.06m	3.68m	3.67m	3.11m
		3	4.00m†	4.00m†	4.00m†	4.00m†	4.00m†	4.00m†	3.73m	3.40m	3.12m
	24/24	1	4.88m*	4.88m*	4.88m*	4.88m*	4.60m	4.34m	4.11m	3.92m	3.65m
		2	4.88m*	4.88m*	4.88m*	4.88m*	4.56m	4.09m	3.71m	3.40m	3.14m
		3	4.00m†	4.00m†	4.00m†	4.00m†	4.00m†	4.00m†	3.73m	3.41m	3.13m

Explanatory notes for Load/Span Table:

1. Spans are limited to a maximum deflection of L/180 for gravity load.
2. Consider wind load/span tables when applicable.
3. Panel dead weight has not been included.
4. * Spans limited by thermal stress and thermal bow considerations.
5. †Triple span limited by 12.00m (40'-0") maximum panel length.
6. Contact CENTRIA for conditions not conforming to these notes.





CENTRIA

Notes



CENTRIA

Notes

www.CENTRIA.com



CENTRIA

800.759.7474

1005 Beaver Grade Road, Moon Township, PA 15108-2944
412.299.8000; Fax: 412.299.8317