

PRODUCT DESIGNATION**IS, Interior****Silicone Face Seal
Wall Joint Covers****MANUFACTURER**

Michael Rizza Company™
A Division of Balco Inc.
2626 S. Sheridan
Wichita, Kansas 67214
(316) 945-9328 (phone)
(316) 945-0789 (fax)
(800) 767-0082 (toll free)

PRODUCT DESCRIPTION

Silicone face seal joint cover system for installation in interior joints between parallel wall sections, the system consisting of aluminum extrusions, and Silicone face seals. Wider versions also are provided with a clip for the face seal. The joint cover system is mechanically fastened to the wall. The joint cover system is designed so that the face seal is flush or nearly flush with the wall.

SIZE

Standard systems are available for joints 2" design width through 12" design width. For wider joints, please contact the factory.

ELASTOMERIC INSERT COLOR

Available in standard colors: black, white, gray, tan, or bronze. Contact the factory for custom colors.

MOVEMENT CAPABILITIES

The system permits unrestrained movement of the joint without disengagement of the cover. Conforms to the requirements of ASTM E 1399. Available in systems for 100% expansion and 50% or greater contraction.

FIRE RESISTANCE

System may be used in conjunction with **Metaflex 2000 Fire Barrier** to achieve a fire resistance rating of 2 hours. Fire resistance testing was in accordance with ASTM E1966 and/or UL 2079.

System may be used in conjunction with **MetaMat Fire Barrier**, up to 6" maximum open joint width, to achieve a fire resistance rating of 2 hours. Fire

resistance testing was in accordance with UL 2079.

System may be used in conjunction with **MetaBlock Fire Barrier**, up to 4" maximum open joint width, to achieve a fire resistance rating of 2 hours. Fire resistance testing was in accordance with UL 2079.

MOISTURE RESISTANCE

Available with elastomeric back seal attached to aluminum base members. This sheet membrane is designed to provide moisture resistance to the system.

BASIC USES

For use in commercial construction for wall and ceiling application.

- Exterior expansion joints
- Exterior seismic joints

ADVANTAGES

- Easy to install base members
- Easy to assemble joint cover
- Standard Fasteners provided with the joint cover by the factory
- Available in several standard colors as well as custom colors
- Face seals available in long lengths to minimize splicing
- Face seals are flush with the wall
- Easy to clean and maintain

LIMITATIONS

- Not recommended for conditions in which significant lateral shear movement is anticipated.

TECHNICAL DATA

Systems in the Series conform to the requirements of ASTM E 1399 for specified movement capabilities

LEED

Refer to the appropriate Balco, Inc. LEED Statement for the applicable LEED Rating System for information regarding LEED credits for which this Balco, Inc. Joint Cover System does or may qualify or contribute.

INSTALLATION

1. Mark the locations for the anchor holes on the base members. Drill the anchor holes into the base members at the marked locations.
2. Place the base members into their installed positions against the joint interface wall. Using the base members as templates, mark the anchor hole locations on the joint interface wall.
3. Remove the base members from their installed position against the joint interface wall, and drill the anchor holes into the joint interface wall at the marked locations.
4. Place the base members back into their installed positions against the joint interface wall. Attach the joint system base members to the joint interface wall using the fasteners provided by the factory.
5. Install the face seal(s) by pressing the face seal arrows into the base member channels.

STORAGE & HANDLING

Expansion and seismic joint cover systems should be stored in a cool, dry place. Keep products stored under protective cover, in their original containers.

AVAILABILITY AND COST

Balco, Inc. Expansion and Seismic Joint Cover Systems are available worldwide through your local Balco, Inc. Sales Representative or directly from the factory. Pricing and standard lead time are available through your local Sales Representative or from the factory.

WARRANTY

Balco, Inc. warrants to its purchasers that all products sold by it will be free from manufacturing and material defects. Any defective product will be replaced or repaired free of any charge, provided a claim is brought to Balco's attention, in writing, within the established warranty period following the date of shipment by us and provided Balco's examination shows the product

has failed under the terms of this warranty. The established warranty period for architectural joint cover systems is one (1) year. Balco, Inc. will not be responsible for installation costs involved in such repair or replacement. Balco, Inc. shall have no obligation under this warranty if owner subjects materials to improper conditions. This is in lieu of all other warranties, expressed or implied, and is the sole warranty extended by Balco, Inc. Balco, Inc. liability under this warranty is limited to repair or replacement and does not include any responsibility for consequential or other damage of any

nature. It is further agreed and understood that the price stated for the seller's products is consideration for the limitation of seller's liability hereunder.

MAINTENANCE

Establish an inspection schedule for the expansion joint covers. Clean dry contaminants away by wiping with a clean, damp cloth. Clean face seals using clean cloths, warm water and a gentle detergent (mild dishwashing detergents are acceptable). To remove tough stains, use isopropyl alcohol and clean cloths. Do not use abrasive cleaners.

TECHNICAL SERVICES

Technical services are available from Balco, Inc. and from your local Balco, Inc. Sales Representative.
BALCO, INC.
 Phone: (316) 945-9328
 Fax: (316) 945-0789
 Toll Free: (800) 767-0082

FILING SYSTEM

ARCAT Specifications
 Reed Construction Data
 Sweets™
 4specs.com

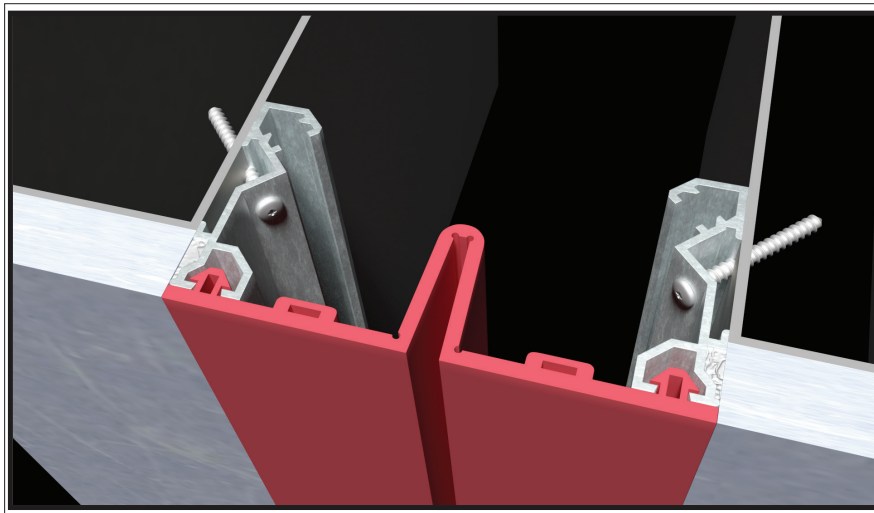

Type	Joint Dimension	Tension Back Seal	Total Compression
IS-2	2 inches (51 mm)	4 inches (102 mm)	1 inch (25 mm)
IS-3	3 inches (76 mm)	5 inches (127 mm)	2 inches (51 mm)
IS-4	4 inches (102 mm)	6 inches (152 mm)	3 inch (76 mm)
IS-5	5 inches (127 mm)	7 1/2 inches (191 mm)	4 inch (102 mm)
IS-6	6 inches (152 mm)	9 inches (229 mm)	5 inch (150 mm)
IS-7	7 inches (178 mm)	10 1/2 inches (266 mm)	6 inch (152 mm)
IS-8	8 inches (203 mm)	12 inches (305 mm)	7 inch (178 mm)
IS-9	9 inches (228 mm)	13 1/2 inches (330 mm)	8 inch (203 mm)
IS-10	10 inches (254 mm)	15 inches (381 mm)	9 inch (228 mm)
IS-11 (4GR)	11 inches (280 mm)	16 1/2 inches (419 mm)	10 inch (251 mm)
IS-12	12 inches (305 mm)	28 inches (458 mm)	11 inch (276 mm)