

**PRODUCT DESIGNATION**

**PC, Silicone Compression Seal Partition Closures**

**MANUFACTURER**

**Michael Rizza Company™**  
**A Division of Balco Inc.**  
**2626 S. Sheridan**  
**Wichita, Kansas 67214**  
**(316) 945-9328 (phone)**  
**(316) 945-9328 (fax)**  
**(800) 767-0082 (toll free)**

**PRODUCT DESCRIPTION**

The Rizza™ PC Series Partition Closures consist of an extruded, chambered silicone compression seal profile and an extruded aluminum channel installed using mechanical fasteners and silicone adhesive/sealant. The silicone adhesive/sealant is used to adhere the compression seal to the substrate and provide a durable, sound dampening, UV resistant system. Easy to install and maintain, these systems are attractive and economical. The seals allow deflection of the exterior glass during wind load.

**SIZE**

Standard system is available for joint ranging from 2" nominal up to 2 3/4" nominal width.

**MOVEMENT CAPABILITIES**

The system permits deflection of the exterior glazing of 1/4" or more.

**COLORS**

Rizza™ PC Series Compression Seals are offered in five (5) standard colors: Precast White, Natural Stone, Grey, Bronze, and Black. Custom colors are also available. Contact the factory for custom colors availability and lead times. Silicone sealant is color matched with seals.

**BASIC USES**

Rizza™ PC Series Partition Closure Systems are designed specifically for use in commercial buildings with glazing and glass curtain walls. Interior wall expansion joints

- Partition Closures

**ADVANTAGES**

- UV resistant.
- Ease of Installation - Simply anchor the channel, place the seal in position, and apply the adhesive/sealant to the seal/substrate interface.
- Resilient
- Sound dampening
- Easy to clean and maintain
- VOC Compliant - The seals are low VOC when cured, and the adhesive has a "0" VOC rating.
- Colorfast

**LIMITATIONS**

- Limited verticle shear movement capabilities
- Primer required for adhesive/sealant when applied to aluminum or other non-porous surfaces.
- Alcohols inhibit the cure of the adhesive/sealant.
- Not suitable for below grade installations.
- Not suitable for installation on surfaces continuously immersed in water.
- Limited abrasion resistance.
- Limited oil resistance.

**TECHNICAL DATA**

**LEED**

Refer to the appropriate Balco, Inc. LEED Statement for the applicable LEED Rating System for information regarding LEED credits for which this Balco, Inc. Joint Cover System does or may qualify or contribute.

**COMPRESSION SEAL PROPERTIES**

Durometer ASTM D2240	70/-5
Tensile Strength, min. ASTM D412,	1200psi
Elongation ASTM D412,	502%
Tear Strength @ 77-F ASTM D624	180 ppi

**INSTALLATION**

1. Mark the locations for the anchor holes on the aluminum channel. Drill the anchor holes into the channel at the marked locations.
2. Place the aluminum channel into its installed position against the end of

the wall assembly. Using the channel as a template, mark the locations for the anchor holes on the wall. Remove the channel from its installed position and drill the anchor holes into the wall at the marked locations.

3. Place the aluminum channel back into its installed position against the wall, ensuring the channel is straight and that the anchor holes in the channel are properly aligned with the anchor holes in the wall. Using the anchors provided by the factory, attach the channel to the wall.
4. Select the compression seal. Insert one end of the compression seal into the aluminum channel.
5. Install the glazing in accordance with the curtain wall or glazing manufacturer's written instructions.
6. Select the silicone adhesive/sealant and seal the compression seal to the glazing.

**STORAGE & HANDLING**

Rizza™ PC Series Partition Closure Systems should be stored in a cool, dry place. Keep products stored under protective cover, in their original containers.

**AVAILABILITY AND COST**

Rizza™ PC Series Partition Closure Systems are available worldwide through your local Balco, Inc. Sales Representative or directly from the factory. Pricing and standard lead time are available through your local Sales Representative or from the factory.

**WARRANTY**

Balco, Inc. warrants to its purchasers that all products sold by it will be free from manufacturing and material defects. Any defective product will be replaced or repaired free of any charge, provided a claim is brought to Balco's attention, in writing, within the established warranty period following the date of shipment by us and provided Balco's examination shows the product has failed under the terms of this

warranty. The established warranty period for Rizza™ PC Series Partition Closure Systems is five (1) year, if installed by an installer certified by Balco, Inc. Balco, Inc. will not be responsible for installation costs involved in such repair or replacement. Balco, Inc. shall have no obligation under this warranty if owner subjects materials to improper conditions. This is in lieu of all other warranties, expressed or implied, and is the sole warranty extended by Balco, Inc. Balco, Inc. liability under this warranty is limited to repair or replacement and does not include any responsibility for

consequential or other damage of any nature. It is further agreed and understood that the price stated for the seller's products is consideration for the limitation of seller's liability hereunder.

**MAINTENANCE**

Establish an inspection schedule for the partition closures. Clean dry contaminants away by wiping with a clean damp cloths. Clean the seals using clean cloths, warm water and a gentle detergent (dishwashing or mild laundry detergents are acceptable). To remove tough stains from the seals, use clean cloths soaked with isopropyl alcohol.

**TECHNICAL SERVICES**

Technical services are available from Balco, Inc. and from your local Balco, Inc. Sales Representative.  
**BALCO, INC.**  
 Phone: (316) 945-9328  
 Fax: (316) 945-0789  
 Toll Free: (800) 767-0082

**FILING SYSTEM**

ARCAT Specifications  
 Reed Construction Data  
 Sweets™  
 4specs.com

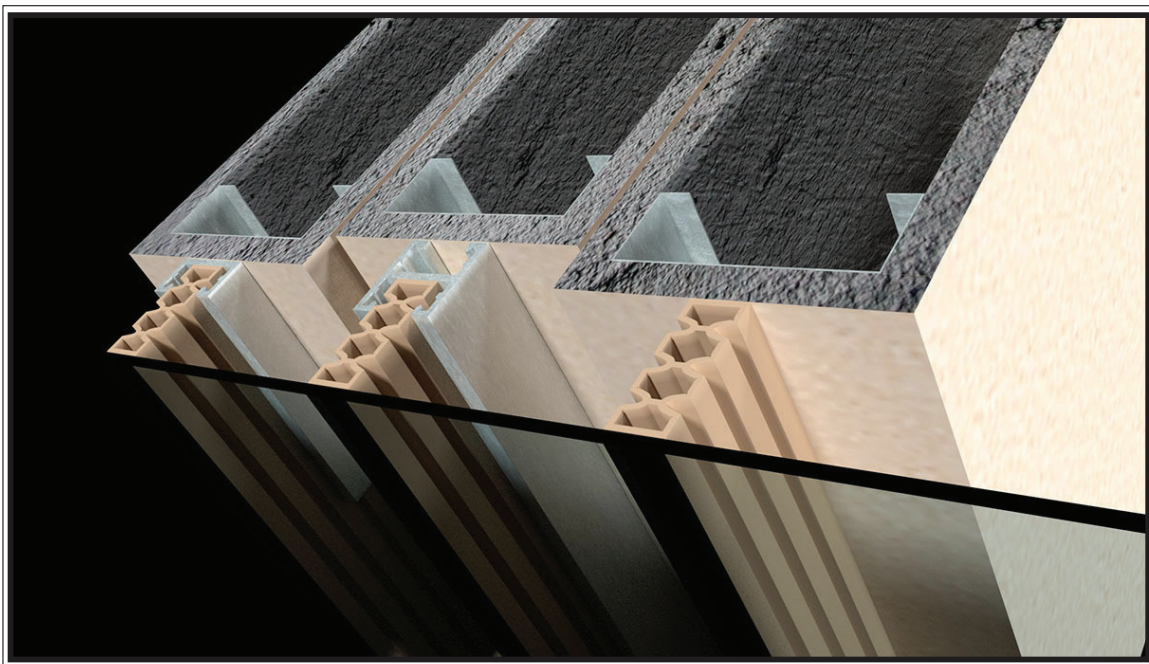

Type	Joint Dimension	Compression (minimum)	Extension (maximum)
CE-100SX	1 inch (25 mm)	0.375 inch (9.5 mm)	2 inches (51 mm)
CE-150SX	1 1/2 inch (37 mm)	0.563 inch (14.3 mm)	2 1/2 inches (63 mm)
CE-200SX	2 inches (51 mm)	1 inch (25 mm)	3 1/2 inches (88 mm)
CE-300SX	3 inches (76 mm)	1.38 inches (35 mm)	6 inches (152 mm)
CE-400SX	4 inches (102 mm)	2 inches (51 mm)	7 inches (175 mm)