

PL
PHOTOLUMINESCENT
101443

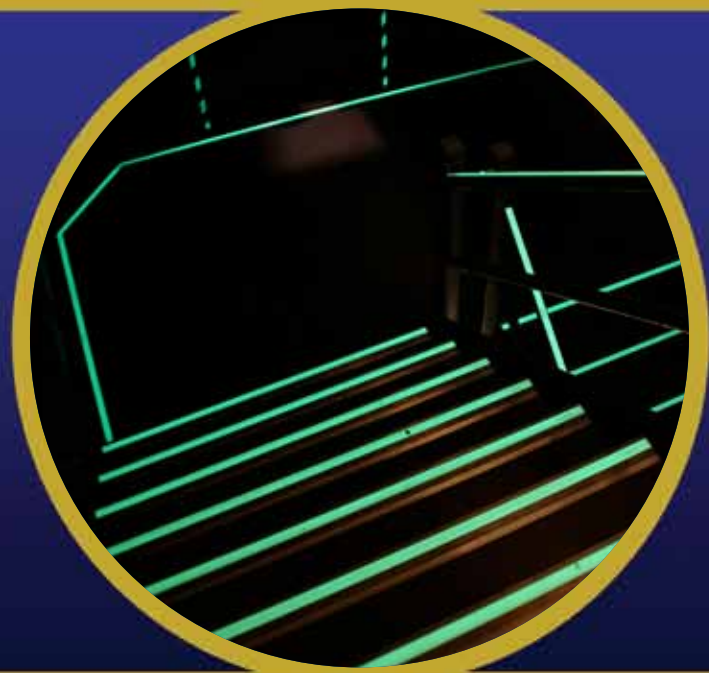

PHOTOLUMINESCENT EGRESS MARKINGS

STAIR NOSINGS

STAIRWAY EGRESS MARKINGS

DIRECTIONAL SIGNAGE



www.balcousa.com

TABLE OF CONTENTS

- 3 IllumiTread™ Introduction
- 4-5 Stair Nosing Products
- 6-7 Stairway Systems
- 8 Signage
- 9 Doors and Corridors
- 10 Signage Dimensions
- 11 Colors & Finishes

IllumiTread™, For Safety's Sake

Balco has been at the forefront of research and development of performance based Photoluminescent (PL) products for stairway egress and pathway markings since 2005. We continue to assist in the development of building code standards for the IBC, IFB, ICC and many other standards used by architectural, engineering and safety related institutions. Our research and innovation has lead to numerous performance criteria standards for ASTM, UL®, NIST, NFPA and others to ensure safety and long term endurance of PL installations.

Balco's IllumiTread™ product line delivers a tested performance based solution for PL pathway and egress that provide safe evacuation for building occupants while ensuring the highest efficiency and safety for first responders in full power outage conditions. We light the path with IllumiTread™ products by creating an intuitive route that can be easily followed during an emergency evacuation of High Rise buildings, Stadiums, Arenas, Medical Facilities, Hotels, and many other high occupancy types of venues.

IllumiTread™ Product Applications

Stair Nosing
Handrail Markings
Demarcation
Obstruction Markers
Directional Signage
Stairway Identification Signage
Final Exit Door Markings

IllumiTread™ Product Benefits

Non Electric
Non Toxic
Non Radioactive
Environmentally Friendly
UV Stable and Weather Resistant
Low Maintenance
Visible Through Darkness
and Smoke
ADA Compliant
Powered by Glowzone™
Technology

Contact Us

For more information on how you can purchase Balco's IllumiTread™ products, contact Balco at:

1-800-767-0082
www.balcousa.com
info@balcousa.com



The revolutionary new IllumiTread™ products provide highly visible, non-electric routing systems for emergency path finding in the event of total power loss within a building or structure. Balco IllumiTread™ products are powered by high performance photoluminescent guidance strips.

Public assembly venues including concert halls, arenas, stadiums, auditoriums, as well as multi-story buildings and parking garages are among the primary applications for IllumiTread™.

1/2" recommended for open air venues, i.e. stadiums, auditoriums.

1" recommended for emergency stairway egress systems.



**BROWARD CENTER FOR THE
PERFORMING ARTS,
BROWARD COUNTY, FL**

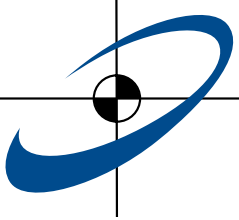

IllumiTread™ Photoluminescent Stair Nosing Products

1/2" PHOTOLUMINESCENT NOSINGS

2140
ILLUMITREAD™ RETROFIT STAIR NOSING

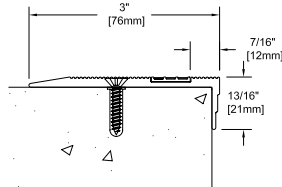

DXH-330-PL
ILLUMITREAD™
TWO COMPONENT STAIR NOSING

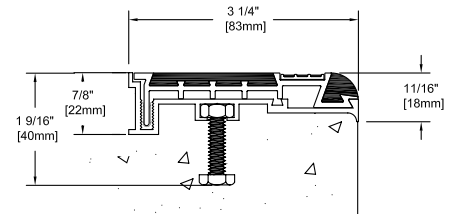

R-315P-PL
ILLUMITREAD™ STAIR NOSING

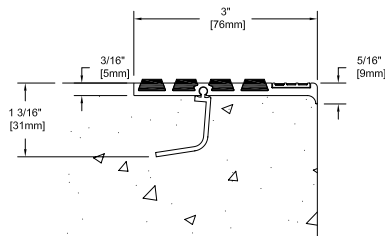

XH-330-PL
ILLUMITREAD™
TWO COMPONENT STAIR NOSING

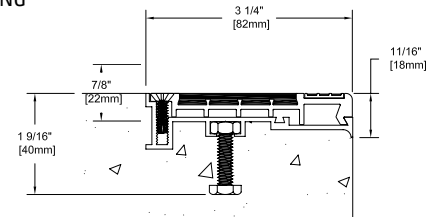

RS-405L-PL
ILLUMITREAD™ RETROFIT STAIR NOSING

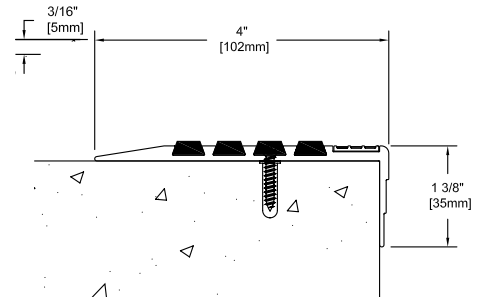

RS-609L-PL
ILLUMITREAD™ RETROFIT STAIR NOSING

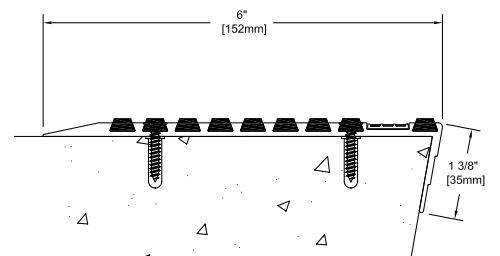

**SEATTLE SEAHAWKS CENTURY LINK
FIELD STADIUM, SEATTLE, WA**

1" PHOTOLUMINESCENT NOSINGS

P-3310-PL-100
ILLUMITREAD™ STAIR NOSING

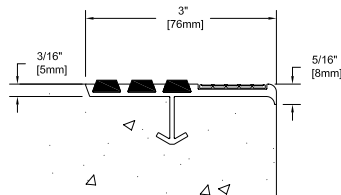

RS-405LP-PL-100
ILLUMITREAD™ STAIR NOSING

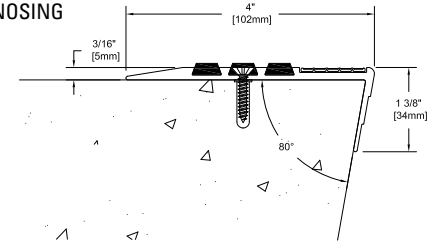

RS-405L-PL-100
ILLUMITREAD™ RETROFIT STAIR NOSING

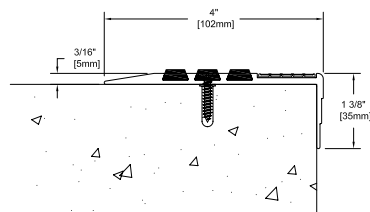

4120L-PL-100
ILLUMITREAD™ STAIR NOSING

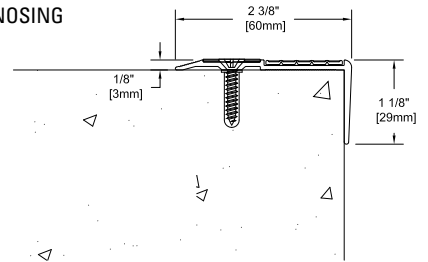

R-315P-PL-100
ILLUMITREAD™ STAIR NOSING

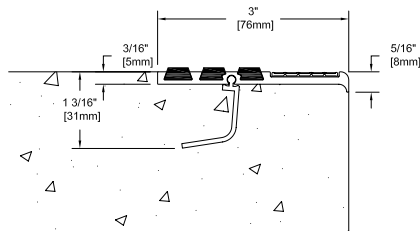

4120
ILLUMITREAD™ RETROFIT STAIR NOSING

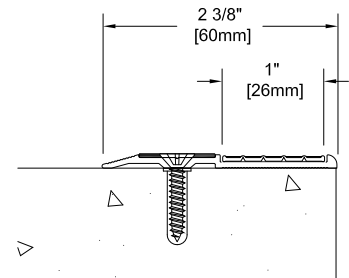

DXH-330-PL-100
ILLUMITREAD™ TWO COMPONENT STAIR NOSING

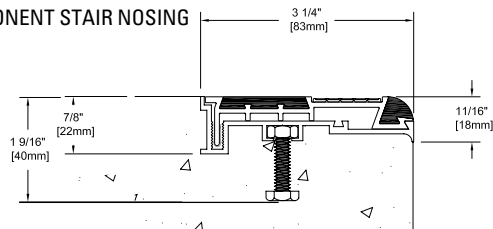

4199
ILLUMITREAD™ RETROFIT STAIR NOSING

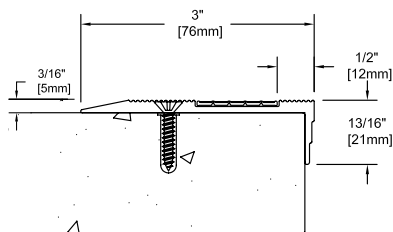

SEE COLOR SELECTION OPTIONS
ON PAGE 10

OBSTRUCTION MARKINGS

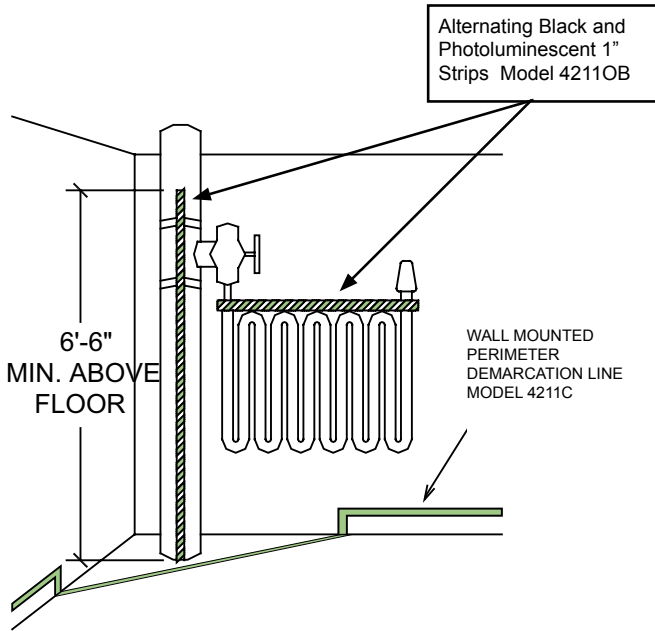

NOTE: All photoluminescent products require external light source for charging 60 minutes prior to illumination per IBC 1024

STAIRWAY EGRESS MARKINGS

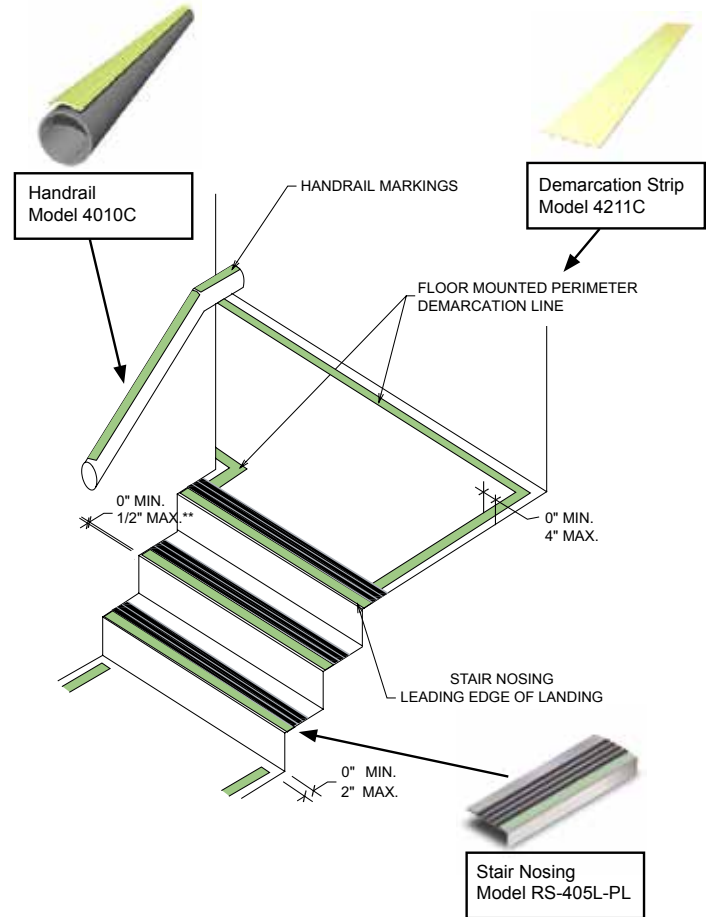

BARCLAYS CENTER
NEW YORK, NY

FINAL EXIT DOOR MARKINGS

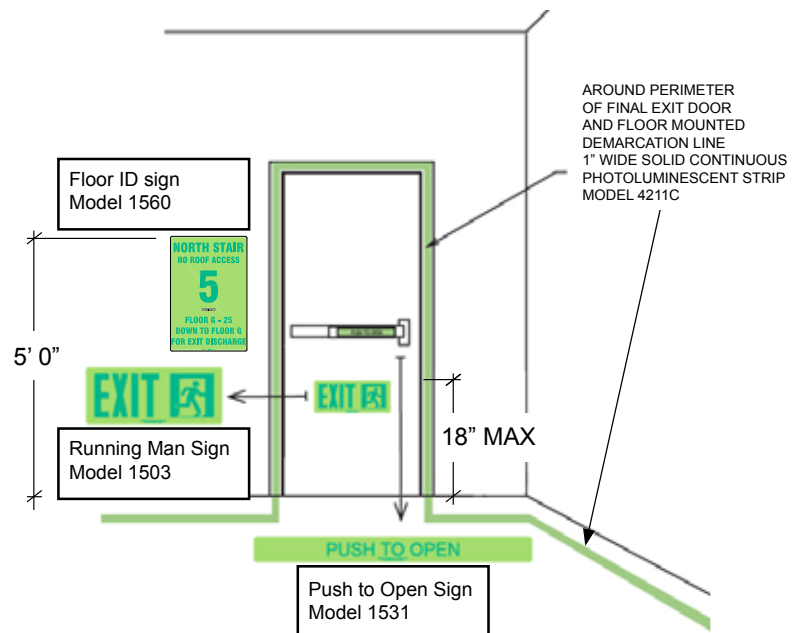

ILLUMITREAD™ STAIRWAY IDENTIFICATION SIGN

Dimensions 18"(457mm) Height X 12"(305mm) Width

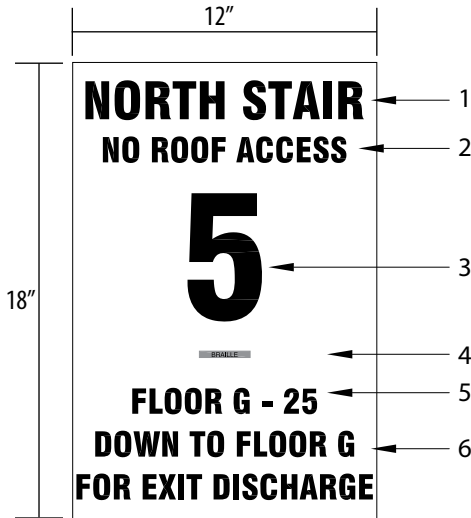

Item #1560

All Stairway Identification Signs will be:

- Minimum size 18" tall by 12" wide
- Characters & Background Non-glare Finish
- Characters will Contrast with Background

Placement of the Sign must be:

- 5 Feet above the Floor Level
- Adjacent to Door leading from Enclosure
- Visible when Door is Open or Closed

Legend:

- 1) Identification of stair
- 2) Is there roof access
- 3) The Floor Number
- 4) Braille Floor Identifier
- 5) The terminus of the top and bottom of the exit enclosure
- 6) The story of and direction to the exit discharge

DEMARICATION

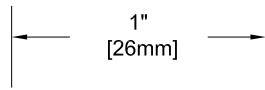

**Demarcation Strip
4211C**

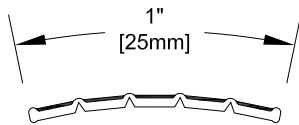

**Handrail Strip
4010C**

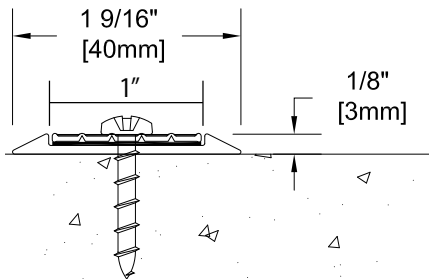

**Threshold Strip
PLTS-100**



FEATURES AND BENEFITS OF ILLUMITREAD™ EGRESS PRODUCTS

- Egress Strips meet 2012 IBC Section 1024 codes
- Stairway ID signs meet 2012 IBC Section 1022 codes
- IllumiTread™ products tested to ASTM 1024 and DL1554 standards
- Meets standards for NFPA, NIST, MEA, GSA and many other local requirements
- Project lists available for references

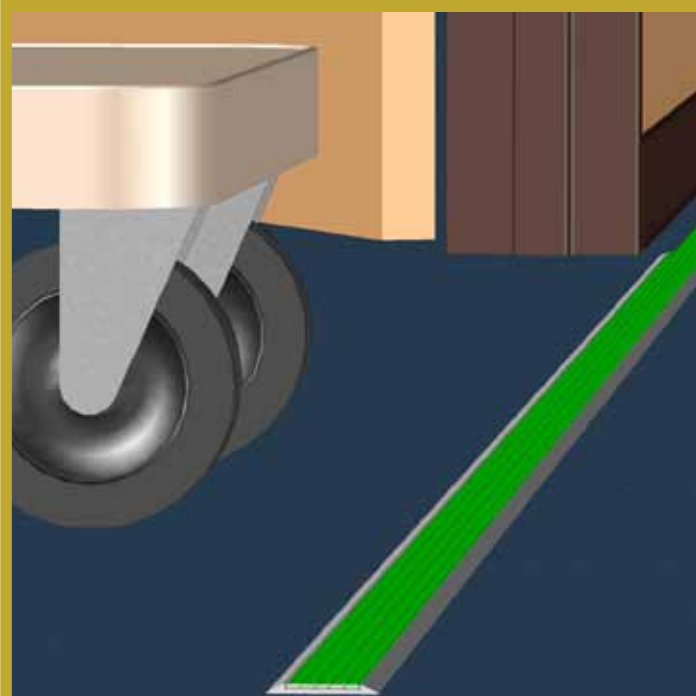

DIRECTIONAL SIGNAGE

Option 1

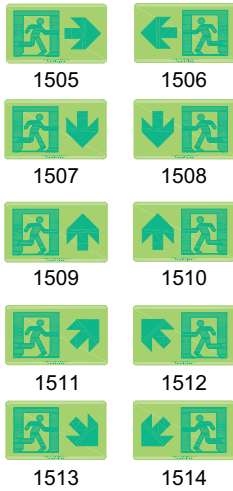
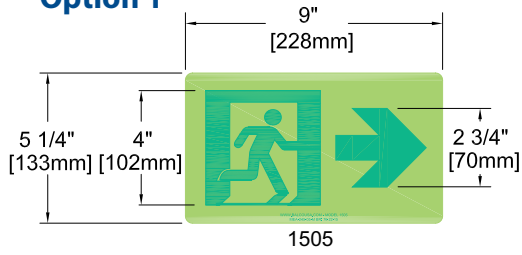

Option 2

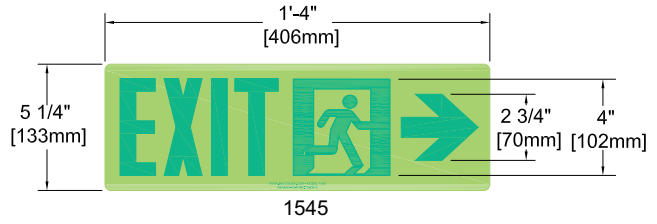

DOOR-MOUNTED EXIT SIGN

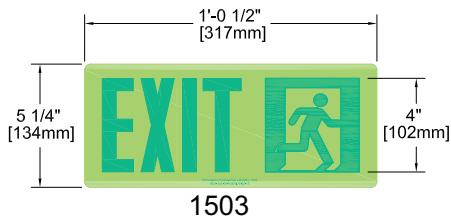

WALL-MOUNTED EXIT SIGNS

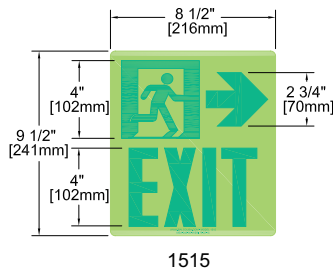

Meets IBC, MEA, ISO, ANSI Standards for Safety Signage

See Signage Dimensions on Page 10

NOT AN EXIT

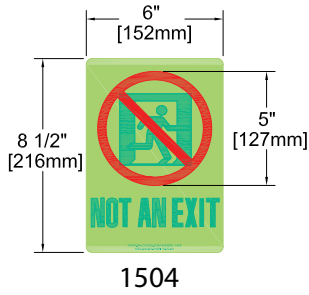

Recommended to mark doors that could be confused with Exit Door Enclosures.

FILM ADHESIVE



PLFA - 100

Recommended for marking handrails, final doors and wall demarcation, not for floor demarcation or stair edges



PLFA - 100 - OB

Recommended for obstruction markings such as stand pipes, hose cabinets or valve handles

INTERMEDIATE AND FINAL EXIT

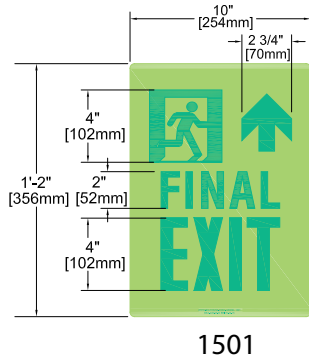

*Contact factory to add handicap symbol to any exit sign

DOOR HANDLE MARKINGS

IBC requires minimum 16 square inches for door handle markings

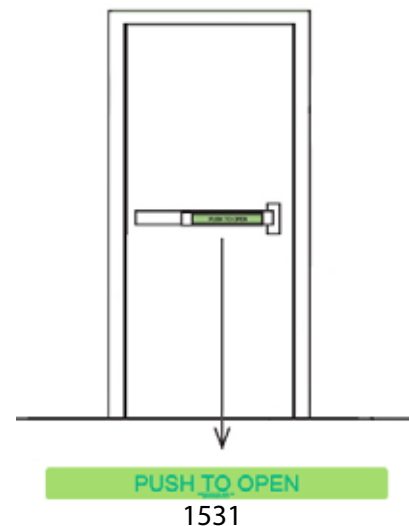
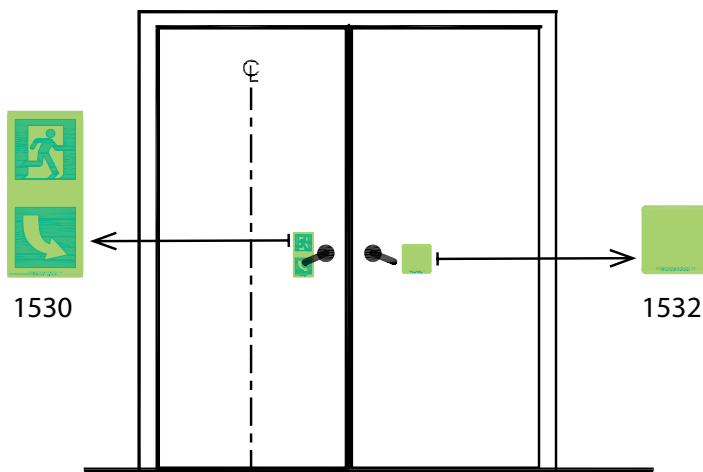

RUNNING MAN - EXIT SIGNS

Item #	Description	Size
1500	Exit, RMan Right, Diagonal Down Arrow	8" x 18"
1501	Final exit	10" x 14"
1502	Exit through Lobby (for Directional Pathway)	18" x 8"
1503	Exit (Final Exit Door Marker)	12.5" x 5.25"
1504	Not an Exit	8" x 10"
1505	RMan Right, Right Arrow	5.25" x 9"
1506	RMan Left, Left Arrow	5.25" x 9"
1507	RMan Right, Down Arrow	5.25" x 9"
1508	RMan Left, Down Arrow	5.25" x 9"
1509	RMan Right, Up Arrow	5.25" x 9"
1510	RMan Left, Up Arrow	5.25" x 9"
1511	RMan Right, Diagonal Up Arrow	5.25" x 9"
1512	RMan Left, Diagonal Up Arrow	5.25" x 9"
1513	RMan Right, Diagonal Down Arrow	5.25" x 9"
1514	RMan Left, Diagonal Down Arrow	5.25" x 9"
1515	Exit, RMan Right, Right Arrow	9.5" x 8.5"
1516	Exit, RMan Left, Left Arrow	9.5" x 8.5"
1517	Exit, RMan Right, Down Arrow	9.5" x 8.5"
1518	Exit, RMan Left, Down Arrow	9.5" x 8.5"
1519	Exit, RMan Right, Up Arrow	9.5" x 8.5"
1520	Exit, RMan Left, Up Arrow	9.5" x 8.5"
1521	Exit, RMan Right, Diagonal Up Arrow	9.5" x 8.5"
1522	Exit, RMan Left, Diagonal Up Arrow	9.5" x 8.5"
1523	Exit, RMan Right, Diagonal Down Arrow	9.5" x 8.5"
1524	Exit, RMan Left, Diagonal Down Arrow	9.5" x 8.5"
1545	Exit, RMan Right, Right Arrow	5.25" x 16"
1546	Exit, RMan Left, Left Arrow	5.25" x 16"
1547	Exit, RMan Right, Down Arrow	5.25" x 16"
1548	Exit, RMan Left, Down Arrow	5.25" x 16"
1549	Exit, RMan Right, Up Arrow	5.25" x 16"
1550	Exit, RMan Left, Up Arrow	5.25" x 16"
1551	Exit, RMan Right, Diagonal Up Arrow	5.25" x 16"
1552	Exit, RMan Left, Diagonal Up Arrow	5.25" x 16"
1553	Exit, RMan Right, Diagonal Down Arrow	5.25" x 16"
1554	Exit, RMan Left, Diagonal Down Arrow	5.25" x 16"
1529	Door Handle Marking RMan Left	5" x 11"
1530	Door handle Marking RMan Right	5" x 11"
1531	Panic Bar Marking	2" x 22"
1532	Door Handle Placard	4" x 4"
1560	Stairway Identification Sign	18" x 12"

STANDARD ABRASIVE COLOR SELECTIONS



black



yellow



silver gray

DESIGNER ABRASIVE COLOR SELECTIONS



twilight blue



black rain



redstone



pineland green



rare earth



gravel gray



canyon tan



brown bark

**OPTIONAL ANODIZED ALUMINUM COLORS
ADDITIONAL CHARGE - MILL FINISHED STANDARD**

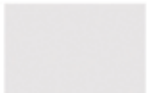

clear



black



dark bronze



medium bronze



light bronze



gold



champagne

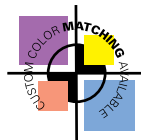

**RIVERWALK
SAN ANTONIO, TX**

The representation of colors available may vary due to printing process.
When specifying colors, please request actual sample from the factory.

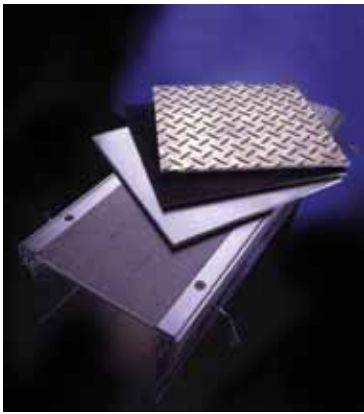

TRENCH & ACCESS COVERS

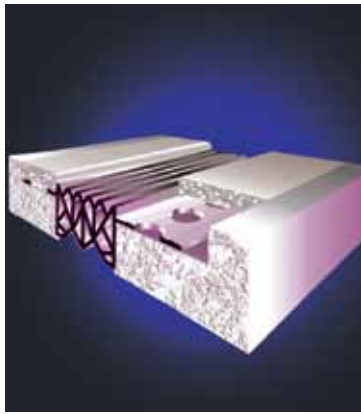

EXTERIOR EXPANSION JOINT SEALS

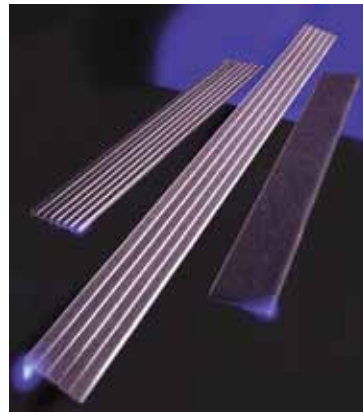

STAIR NOSINGS



EXPANSION JOINT COVERS
AND FIRE BARRIERS

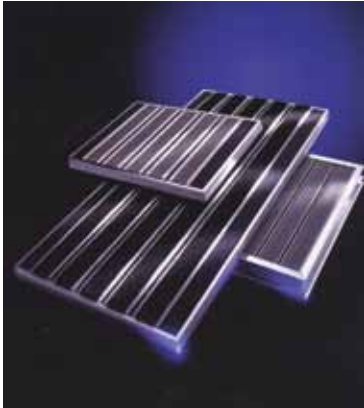

ENTRANCE MATTING SYSTEMS

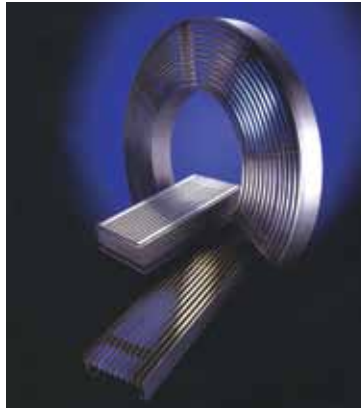

GRATES & FRAMES



PHOTOLUMINESCENT
EGRESS SYSTEMS



Quality products engineered and crafted to meet tomorrow's needs today... Over 50 years in the business is proof that we stand behind those words. Balco has set an industry benchmark with our combination of highly skilled engineers, comprehensive manufacturing processes, and prompt customer service. We customize our products to fit your projects' needs. At Balco, we're dedicated to bringing you the highest quality products at competitive prices. Let us be an integral part of your next project.

