

**BALCO INC**  
**IllumiTread™**  
Powered by glowZONE™  
Dependable Egress Path Markings

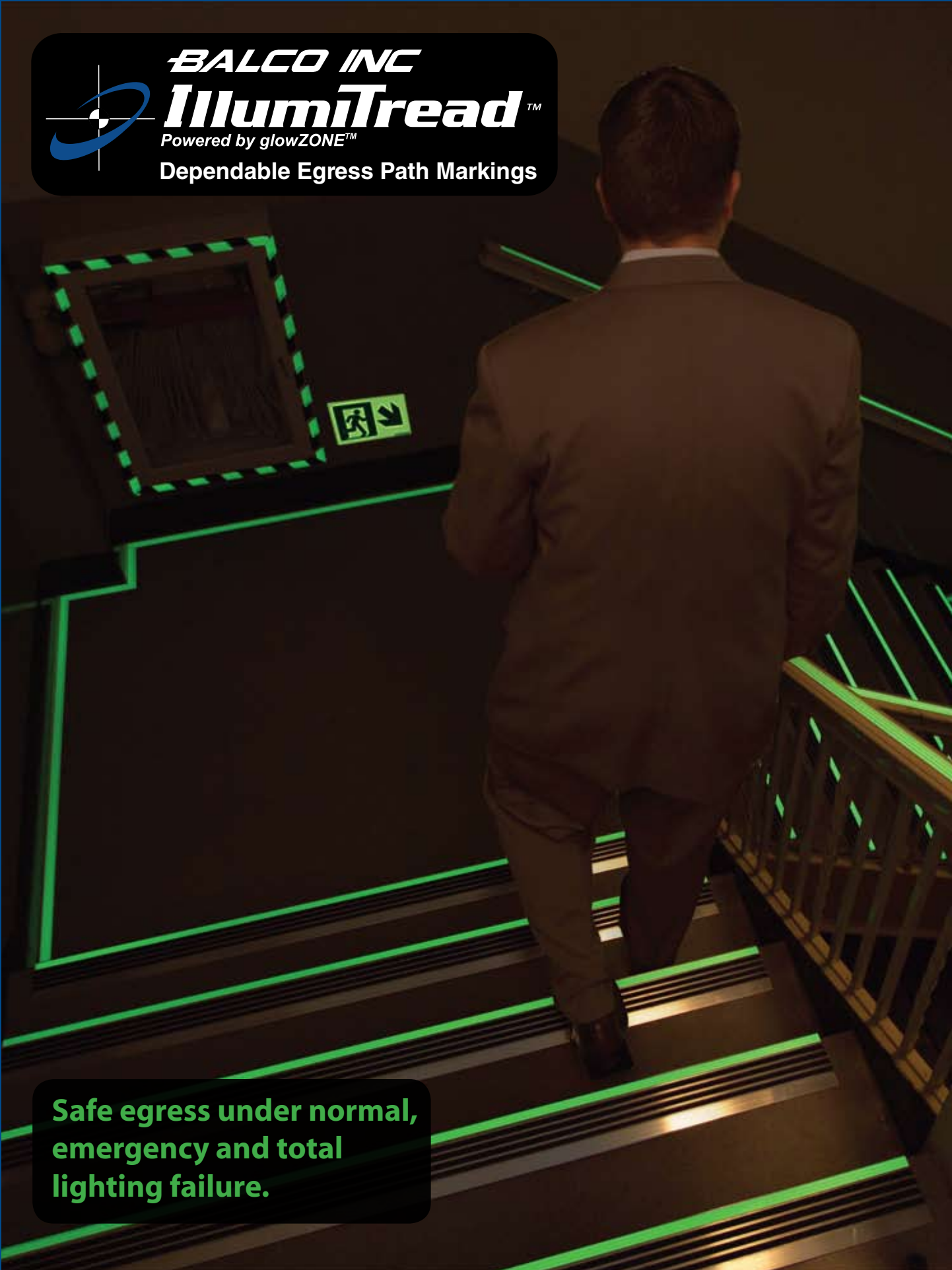

Safe egress under normal,  
emergency and total  
lighting failure.

***Balco's IllumiTread™  
powered by glowZONE™  
offers a revolutionary  
photoluminescent safety  
egress path marking sys-  
tem that is highly visible,  
yet non-electric, routing  
system for path finding  
in the event of a loss  
of power within a  
building or structure.***

***IllumiTread™ meets International  
Building Code 403.16 and 1027  
Exit Path Markings Section and  
NFPA 101 Life Safety Code.***

## IllumiTread™, For Safety's Sake

Electrical emergency lighting, batteries and electrical generators are subject to failure, leaving egress routes in the dark. IllumiTread™ is failsafe, providing a non-electric, highly visible egress path marking system that makes egress faster and safer for many hours after power loss.

The IllumiTread™ product line includes Stair Nosings, Aisle Markers, Demarcation, Hand Rail Markers and Signage all designed to help assure safe egress after the loss of electrical power in a building. IllumiTread™ powered by glowZONE™ uses only the highest grade Strontium Aluminate pigments, this means brighter glow, upwards of 30 times brighter than standard Zinc Sulfide photoluminescence materials. This provides a rating that exceeds the New York City Building Code Reference Standards RS 6-1 and RS 6-1A. IllumiTread™ meets International Building Code 403.16 and 1027 Exit Path Markings and NFPA 101 Life Safety Code 7.2.2.5.4 Stairway Marking. IllumiTread™ products are designed for new construction or for retrofit and are fail safe compared to traditional electrical systems.

### Product highlights of IllumiTread™

- Non-electric
- Non-radioactive
- Non-toxic
- Easily installed, low maintenance
- Durable
- Fire-resistant
- Weather-resistant for outdoor applications
- UV-stable
- Environmentally friendly
- Powered by glowZONE™

### What sets IllumiTread™ apart?

Balco's IllumiTread™ powered by glowZONE™ delivers the highest luminescence levels available, but requires significantly less ambient light to recharge.

### Contact Us

For more information on how you can purchase Balco's IllumiTread™ products, contact Balco at:

**1-800-767-0082**  
**www.balcousa.com**  
**info@balcousa.com**

## TABLE OF CONTENTS

IllumiTread™ Introduction .....	3
Stair Nosing Products.....	4
Stairwell Systems.....	6
Other Photoluminescent Products .....	7
Doors and Corridors .....	8
Signs .....	10

## Stair Nosing Products

**2140**  
ILLUMITREAD™ STAIR NOSING  
MILL FINISH ALUMINUM EXTRUSION  
w/ 1/2" PHOTOLUMINESCENT INSERT

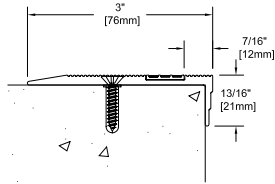

**4199**  
ILLUMITREAD™ STAIR NOSING  
MILL FINISH ALUMINUM EXTRUSION  
w/ 1" PHOTOLUMINESCENT INSERT

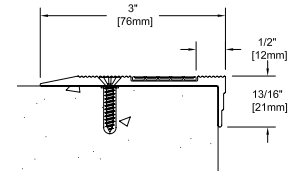

**R-315P-PL**  
ILLUMITREAD™ STAIR NOSING  
MILL FINISH ALUMINUM EXTRUSION  
w/ 1/2" PHOTOLUMINESCENT INSERT

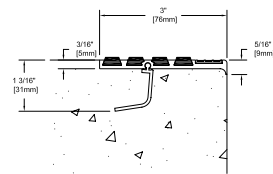

**RS-609L-PL**  
ILLUMITREAD™ RETROFIT STAIR NOSING  
MILL FINISH ALUMINUM EXTRUSION  
w/ 1/2" PL INSERT

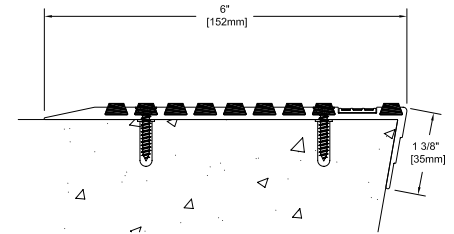

**DXH-330-PL**  
ILLUMITREAD™ STAIR NOSING  
MILL FINISH ALUMINUM EXTRUSION  
w/ 1/2" PHOTOLUMINESCENT INSERT

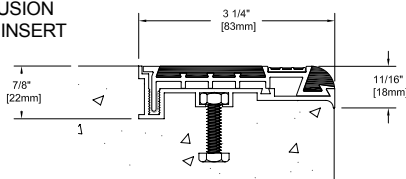

**XH-330-PL**  
ILLUMITREAD™ RETROFIT STAIR NOSING  
MILL FINISH ALUMINUM EXTRUSION  
w/ 1/2" PHOTOLUMINESCENT INSERT

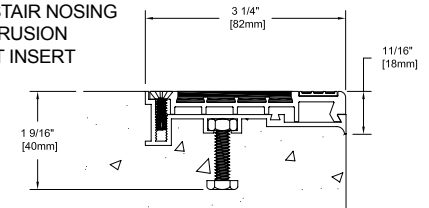

Sold in 2" increments, 36" - 120", maximum 10 ft. lengths.

**RS-405L-PL**  
ILLUMITREAD™ RETROFIT STAIR NOSING  
MILL FINISH ALUMINUM EXTRUSION  
w/ 1/2" PHOTOLUMINESCENT INSERT

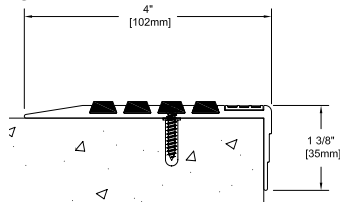

### Color Selection for Abrasive

The representation in the catalog of standard colors available may vary due to printing processes. Therefore, when specifying, please request actual samples from the factory.



earth brown



yellow



silver gray



black



terra cotta



cactus green



redwood



Saf-T-Glo™ II Yellow

RS-405L-PL-100  
ILLUMITREAD™ RETROFIT STAIR NOSING  
MILL FINISH ALUMINUM EXTRUSION  
w/ 1" PHOTOLUMINESCENT INSERT

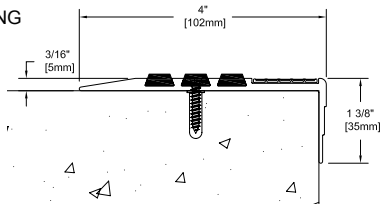

R-315P-PL-100  
ILLUMITREAD™ STAIR NOSING  
MILL FINISH ALUMINUM EXTRUSION  
w/ 1" PHOTOLUMINESCENT INSERT

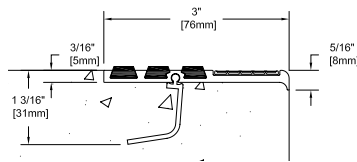

P-3310-PL-100  
ILLUMITREAD™ STAIR NOSING  
MILL FINISH ALUMINUM EXTRUSION  
w/ 1" PHOTOLUMINESCENT INSERT

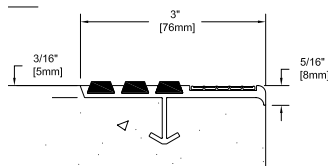

DXH-330-PL-100  
ILLUMITREAD™ STAIR NOSING  
MILL FINISH ALUMINUM EXTRUSION  
w/ 1" PHOTOLUMINESCENT INSERT

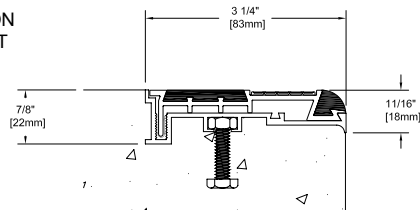

Sold in 2" increments, 36" - 120", maximum 10 ft. lengths.

**Color Selection for Anodized Finishes**

The representation in the catalog of standard colors available may vary due to printing processes. Therefore, when specifying, please request actual samples from the factory.



**Benefits**

Exceeds New York City RS 6-1 and RS 6-1A  
Exceeds IBC 403.16 and 1027 Exit Path Markings  
Meets or Exceeds NFPA 101  
Brightness Rating Requirements per New York City RS6-1  
1" Photoluminescent Models - BR: 41-10-7  
1/2" Photoluminescent Models - BR: 106-29-20

Highly durable and built for permanent installation inside or outside. UV stable

Easy, permanent installation

Easy clean – no other maintenance required

Non-flammable (fire resistant)

Non-toxic

Not radioactive

MEA-234-05M VOL.II

**Technical**

Passes RS 6-1 Illuminance Test ISO 17398 (NYC minimum)  
Passes ASTM E2072- 1 FC charging for 1 hour  
Meets ICC-ES AC169

Passes UL 1994

Passed Weatherometer (2000 hour ASTM G155) and Salt Spray (ASTM B117) tests

Screws and Anchors supplied

Passes RS 6-1 cleaning test – ASTM D 4828 – RESULT 10 (no residual soiling or staining – highest possible score, minimum required, requirement – 5)

Passes RS 6-1 flame spread test – ASTM D 635

Passes RS 6-1 toxicity test – Bombardier SMP800-C

Passes RS 6-1 radioactivity tests ASTM D3648

## Perimeter Demarcation\*

Various acceptable placements for photo luminescent markings at stairways.

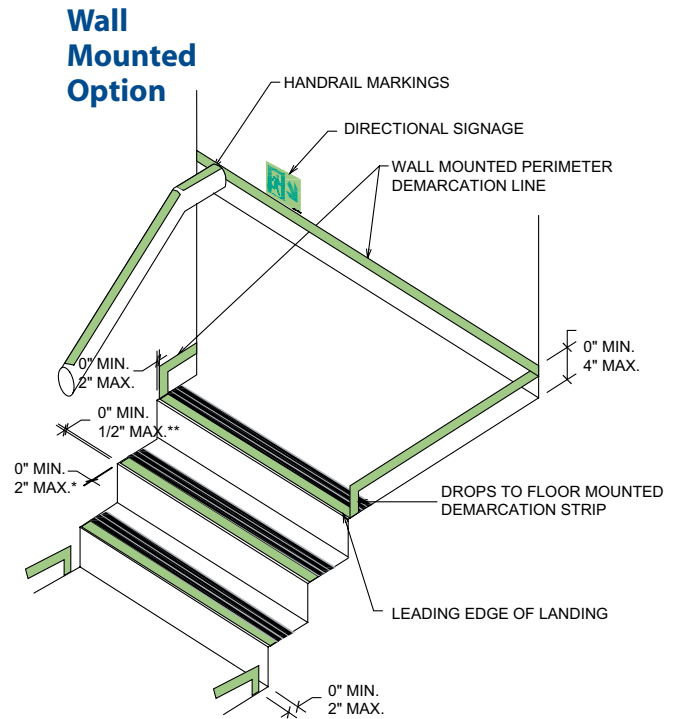
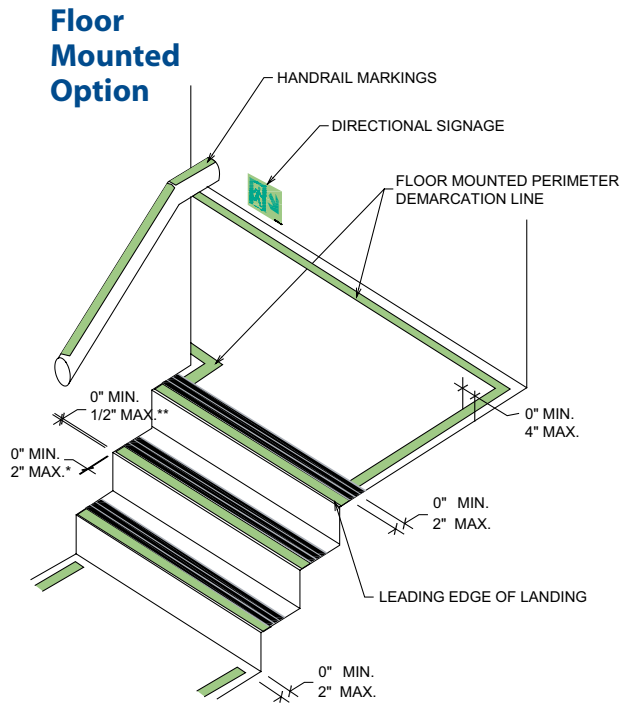

## Handrail Markings\*

Acceptable placements for photoluminescent markings at stairways.

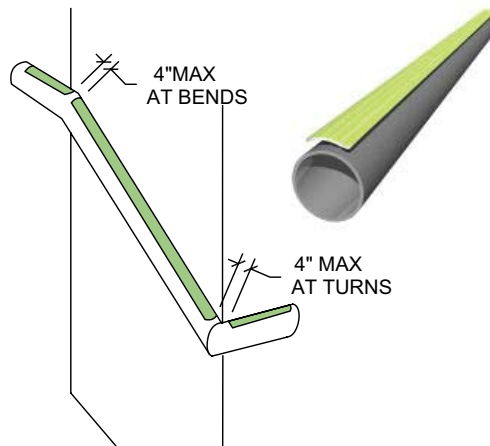

## Benefits

Model 4010c - 1" Handrail Strip

## Technical

Standard length 10' with formed radius to suit handrails with diameter between 1 1/2" to 2".

\* Meets IBC 403.16 and 1027 Exit Path Markings, NYC reference standard RS-6-1 and NFPA 101 Exit Stair Path Markings.

## Obstacle Markings\*

Acceptable placements for photoluminescent markings at obstacles.

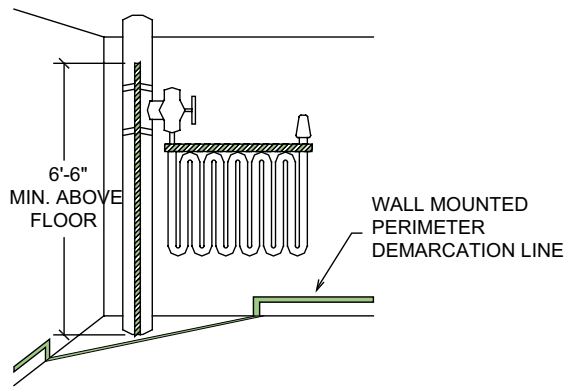
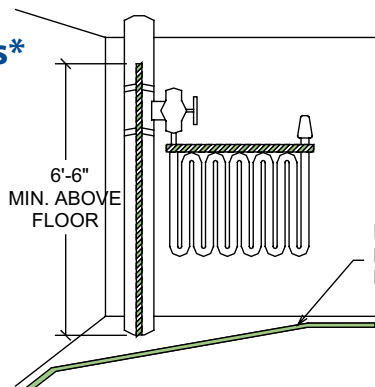

## Demarcation Strips - Aluminum (Rigid)\*

Description	Size
4211c demarcation strips	1" x 120"

Description	Size
4211 obstruction demarcation strip	1" x 78"

## Auxiliary Light Source (NEBU-Light™)

We start with a 1.5" x 22.5" x .25" domed poly-carbonate capsule that was developed specifically for this application, giving the product its V-Zero fire rating. The capsule is then cold injected with our super charged photoluminescent medium. Three magnets are then imbedded into the back of the stick, making it easy to install into florescent light fixtures. This technology gives the NEBU-Light™ a durable, long lasting, highly visible photoluminescent finish that will safely guide you to the emergency exit.

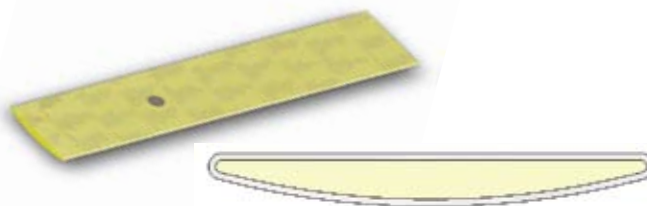

Description	Size
Model 7010	1.5" x 22.5" x .25"

## VMAX-UL-924 Exit Sign

VMAX framed Exit Signs complies with IBC 1011 and is listed by California State Fire Marshall. The optically clear polycarbonate face plate provides a UL 94 V-0 fire rating. Easy to install, all signs come with an aluminum frame giving each sign a rich and complete "high-end" finish that complements any architectural design. Installing VMAX Exit Signs will save you money, reduce energy and maintenance costs and could save the most important thing of all, lives.



vMax 1005-1



vMax 1005-2



vMax 1005-3



### Product Identification VMAX Exit Sign (SCPL) UL 924 Negative image w/ arrow kit

Item	Stroke	Dimensions	Chevron	Colors
1005-1	6" H X 3/4"	9 3/4" X 17"	Arrow Kit	1005-01 Red
1005-2	6" H X 3/4"	9 3/4" X 17"	Arrow Kit	1005-02 Green
1005-3	6" H X 3/4"	9 3/4" X 17"	Arrow Kit	1005-03 Black

A minimum 5 foot candle illuminations is required to properly charge.

\* Recommendations based on IBC 403.16 and 1027 Exit Path Markings, NYC reference standard RS-6-1 and NFPA 101 Exit Stair Path Markings.

## Doors Entering the Exit Enclosure Door-Mounted Options\*

Various acceptable placements for door signs using the door-mounted options.

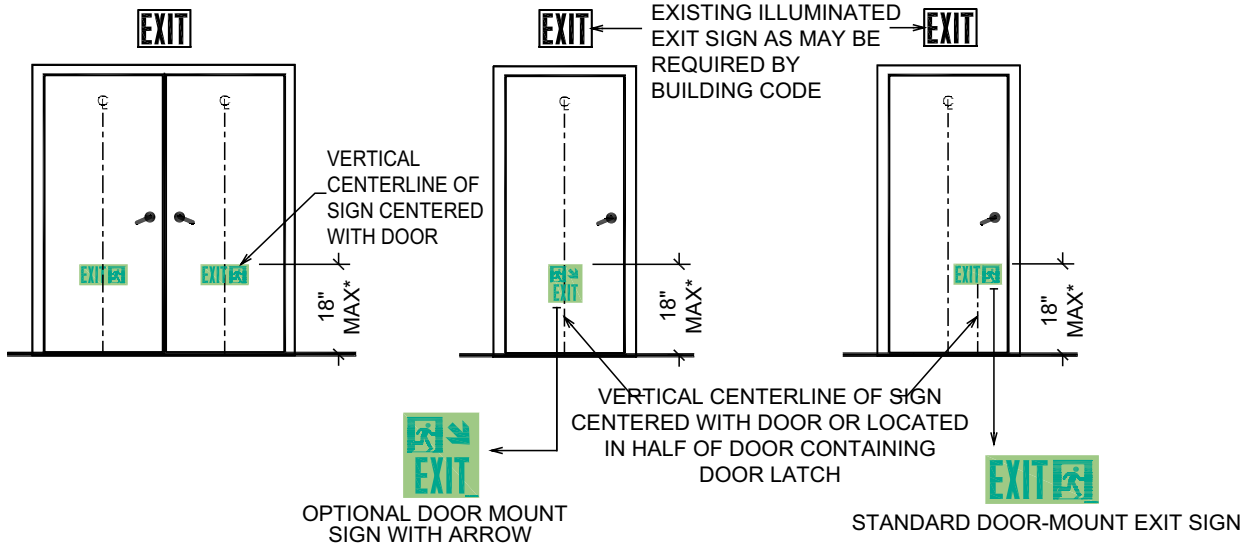

## Wall-Mounted Options\*

Various acceptable placements for door signs using the wall-mounted options.

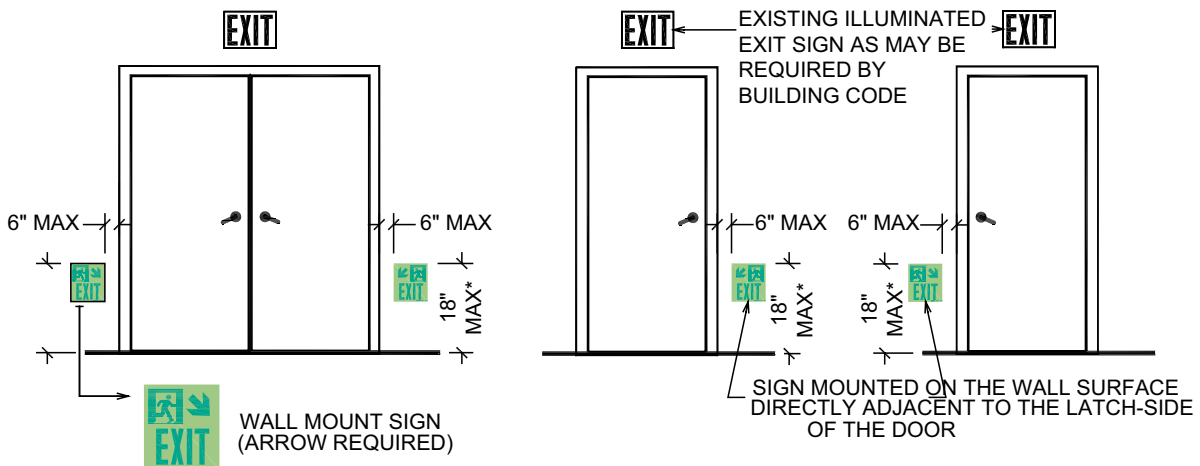

\* Recommendations based on NYC reference standard RS-6-1.



**Doors from Exit Enclosure  
Intermediate Exit Options\*\***

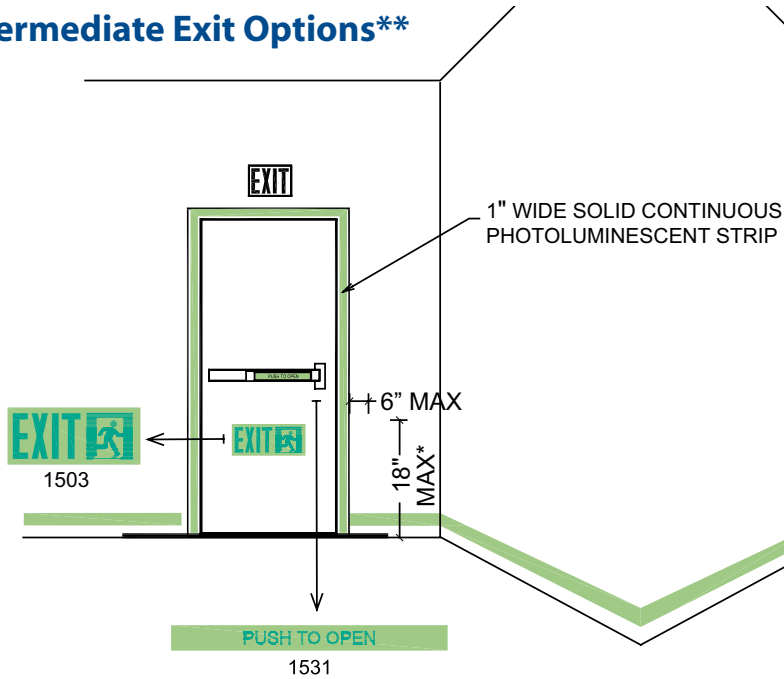

**Final Exit Options\*\***

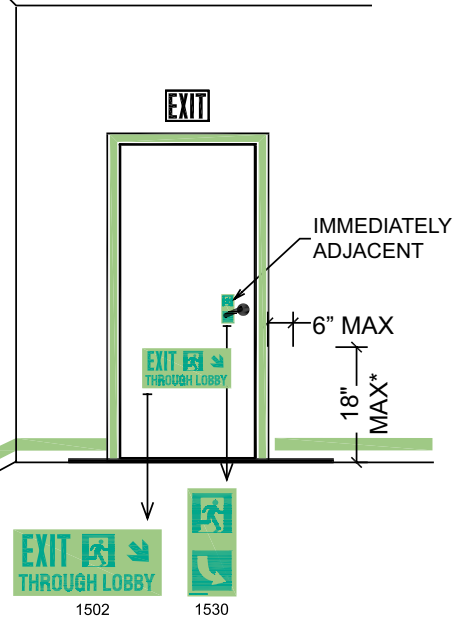

(SEE DOOR SIGN SCHEDULE FOR SIGNAGE)

**Typical Transfer Level and "T" Intersection\***

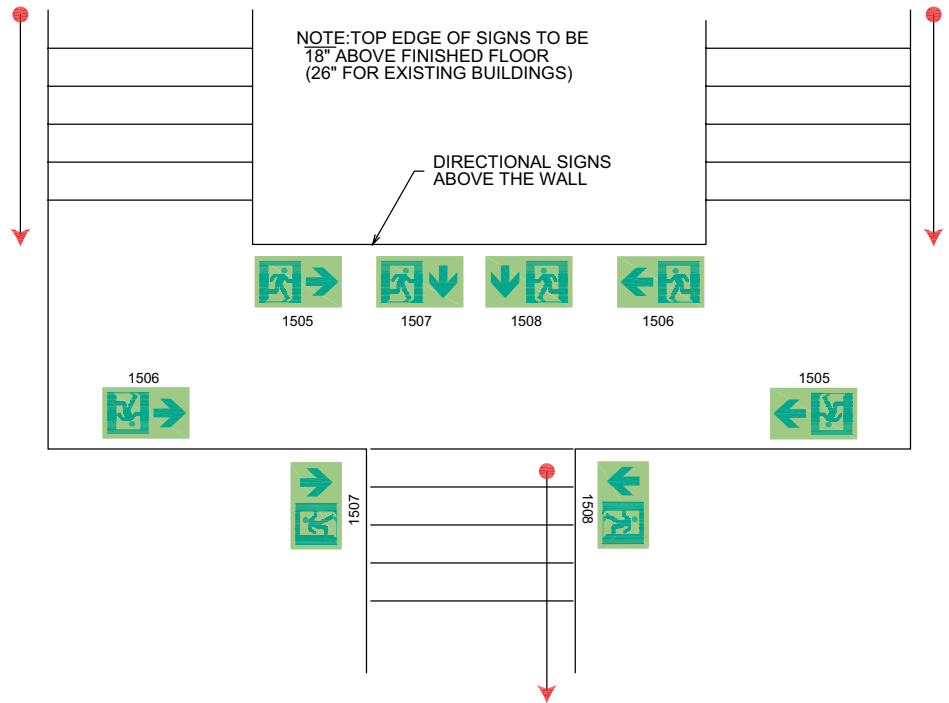

**Typical Signage Leading to a Dead End\***

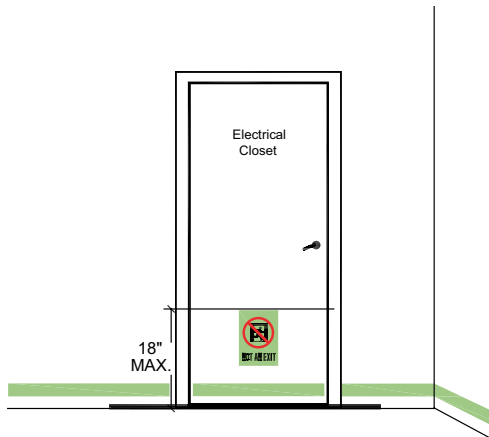

\* Recommendations based on NYC reference standard RS-6-1.

\*\* Meets IBC 403.16 and 1027 Exit Path Markings and NFPA 101 Exit Stair Path.

### Directional Signage\*

#### Option 1

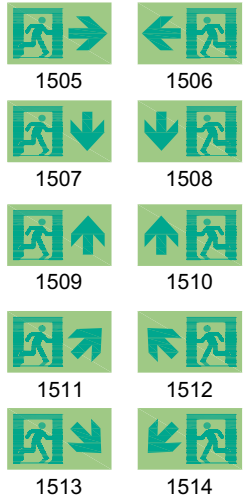
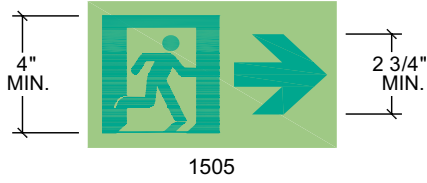

#### Option 2



### Door-Mounted Exit Sign



### Wall-Mounted Exit Signs\*

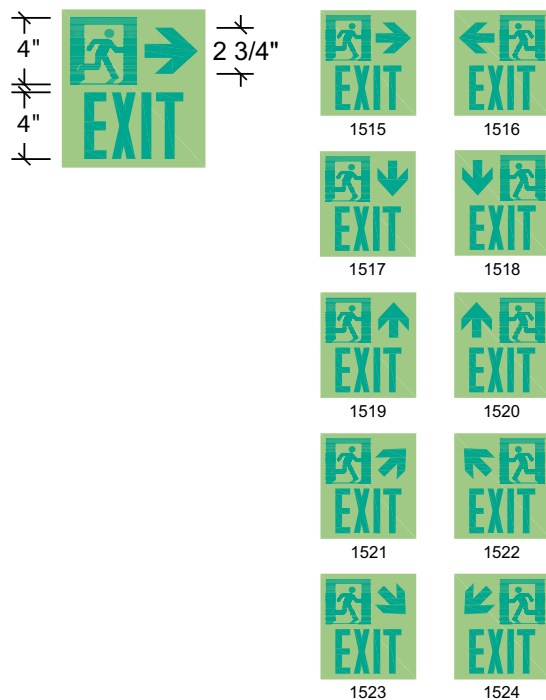

\* Recommendations based on NYC reference standard RS-6-1.

### Not An Exit\*

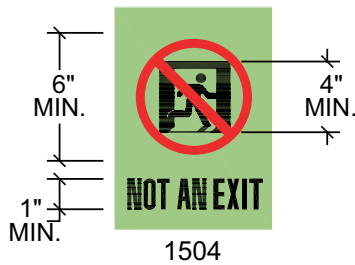

### Intermediate and Final Exit

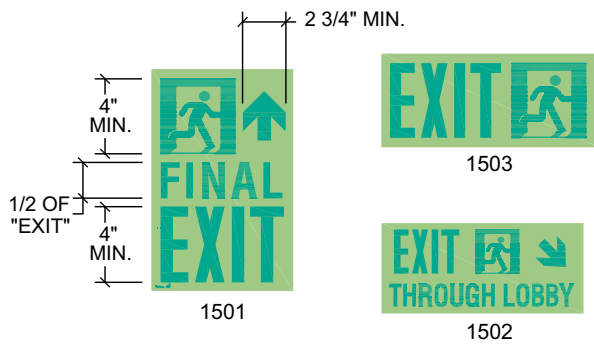

### Door Markings\*

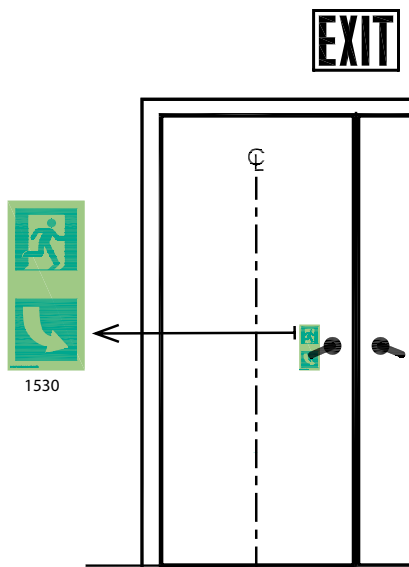

### Running man - Exit Signs

Item #	Description	Size
1501	Final exit	10" x 14"
1502	Final Exit through Lobby	18" x 8"
1503	Exit	12.5" x 5.25"
1504	Not an Exit	6" x 8.5"
1505	RMan, Right Arrow	5.25" x 9"
1506	RMan, Left Arrow	5.25" x 9"
1507	RMan Right, Down Stairs	5.25" x 9"
1508	RMan Left, Down Stairs	5.25" x 9"
1509	RMan Right, Up Stairs	5.25" x 9"
1510	RMan Left, Up Stairs	5.25" x 9"
1511	RMan Right Diagonal, Up Stairs	5.25" x 9"
1512	RMan Left Diagonal, Up Stairs	5.25" x 9"
1513	RMan Right Diagonal, Down Stairs	5.25" x 9"
1514	RMan Left Diagonal, Down Stairs	5.25" x 9"
1515	Exit, RMan Right, Right Arrow	9.5" x 8.5"
1516	Exit, RMan Left, Left Arrow	9.5" x 8.5"
1517	Exit, RMan Right, Down Stairs	9.5" x 8.5"
1518	Exit, RMan Left, Down Stairs	9.5" x 8.5"
1519	Exit, RMan Right, Up Stairs	9.5" x 8.5"
1520	Exit, RMan Left, Up Stairs	9.5" x 8.5"
1521	Exit, RMan Right Diagonal, Up Stairs	9.5" x 8.5"
1522	Exit, RMan Left Diagonal, Up Stairs	9.5" x 8.5"
1523	Exit, RMan Right Diagonal, Down Stairs	9.5" x 8.5"
1524	Exit, RMan Left Diagonal, Down Stairs	9.5" x 8.5"
1545	Exit, RMan Right, Right Arrow	5.25" x 13.5"
1546	Exit, RMan Left, Left Arrow	5.25" x 13.5"
1547	Exit, RMan Right, Down	5.25" x 13.5"
1548	Exit, RMan Left, Down	5.25" x 13.5"
1549	Exit, RMan Right Arrow, Up	5.25" x 13.5"
1550	Exit, RMan Left Arrow, Up	5.25" x 13.5"
1551	Exit, RMan Right, Diagonal Up	5.25" x 13.5"
1552	Exit, RMan Left, Diagonal Up	5.25" x 13.5"
1553	Exit, RMan Right, Diagonal Down	5.25" x 13.5"
1554	Exit, RMan Left, Diagonal Down	5.25" x 13.5"
1529	Door Handle Marking RMan Left	5" x 11"
1530	Door handle Marking RMan Right	5" x 11"
1531	Panic Bar Marking	2" x 22"

\* Recommendations based on NYC reference standard RS-6-1.

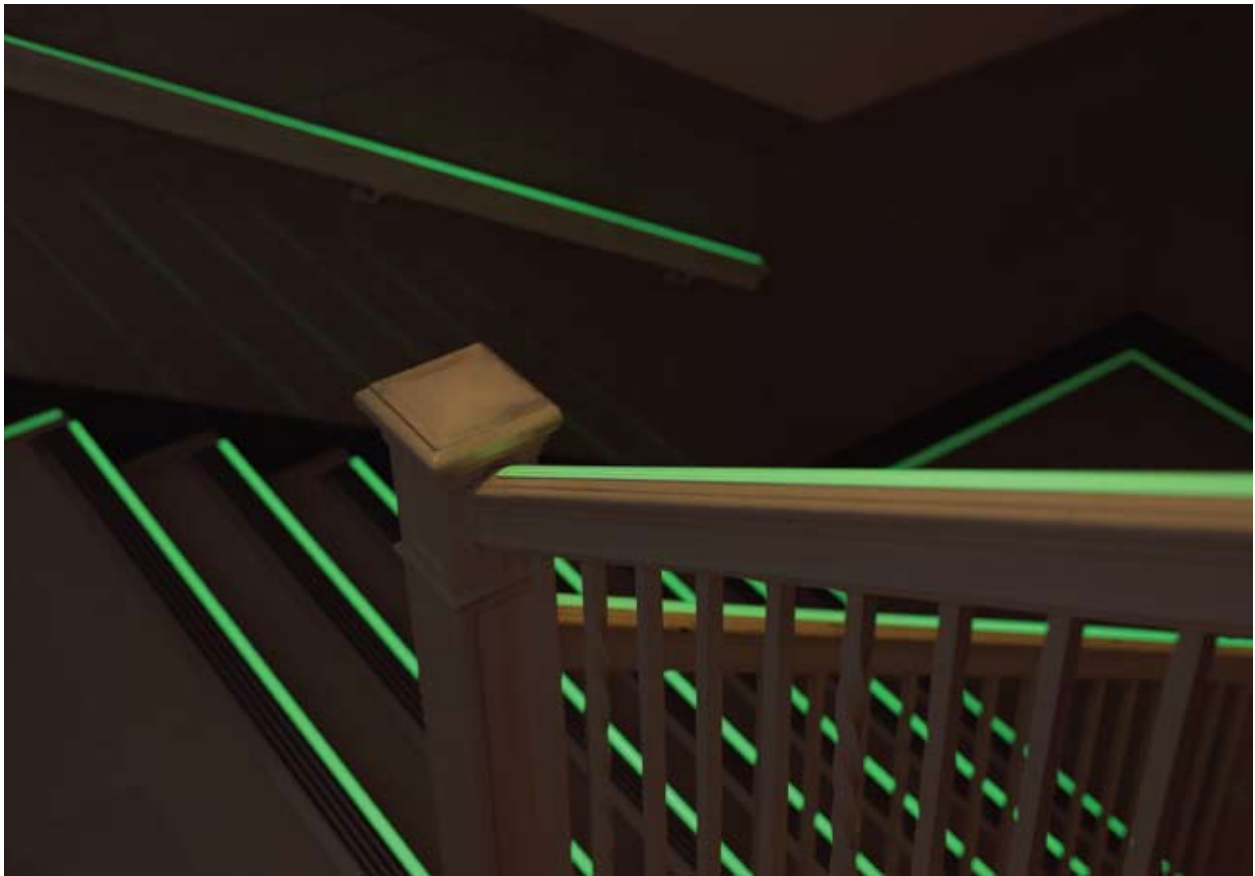

2626 S. Sheridan  
PO Box 17249  
Wichita, KS 67217-0249

1-800-767-0082  
info@balcousa.com

[www.balcousa.com](http://www.balcousa.com)