



Whirlpool® Home Appliances
The power to get more done.



CONTENTS

2Product matrix
 3Introduction
 4Built-In Ovens
 5Cooktops
 6Ranges
 7Speedcook Appliances
 7Microwaves/Ventilation
 8Refrigerators
 9Dishwashers
 10Fabric Care Suite
 11Front Load Fabric Care
 13Top Load Fabric Care
 15Commercial Laundry

	Whirlpool®	Whirlpool Gold®
Built-in Ovens		
Single	•	•
Double Oven	•	•
Double/Lower Convection/Upper Speedcook Oven/Micro Combination		•
Cooktops		
Electric – 30"	•	•
Electric – 36"	•	•
Gas – 30"	•	•
Gas – 36"	•	•
Modular – 30"	•	
Ranges		
Freestanding Electric – Self-Clean	•	•
Freestanding Electric – Self-Clean w/Warming Drawer		•
Freestanding Electric – Standard Clean	•	
Freestanding Gas – Self-Clean	•	•
Freestanding Gas – Standard Clean	•	
Slide-In Gas		•
Slide-In Electric	•	•
Drop-In Electric	•	
Microwaves/Ventilation		
Microwave/Hood Combination	•	•
Microwave/Hood Combination Convection		•
Countertop Microwave	•	•
Countertop Microwave with Trim Kit	•	•
Ventilation		
Canopy Wall Hood		•
Downdraft Vents		•
Slide-Out Hood		•
Under-Cabinet Hood (Recirculatory)	•	•
Under-Cabinet Hood (Vented)	•	•
Dishwashers		
Tall Tub		•
Standard Tub	•	
Refrigerators		
Side-by-Side Counter Depth		•
Side-by-Side Freestanding	•	•
Top-Mount Freezer Freestanding	•	•
Bottom-Mount Freezer Freestanding		•
Laundry/Fabric Care		
Fabric Care Studio		
The Fabric Care Studio		
Duet® Fabric Care System		•
Fabric Freshener	•	
Horizontal Access Washer - ENERGY STAR® Qualified		•
Top Load Washers - ENERGY STAR® Qualified		•
Top Load Washers	•	•
Resource Saver® Dryer Gas and Electric		•
Dryer – Gas and Electric	•	•
Compact Washer / 24" Front Load Compact	•	
Compact Dryer / 24" Front Load Compact	•	
Duet Sport™ Fabric Care System		•
Duet Sport™ HT Fabric Care System		•
Long Vent Dryer	•	
Stackable Units	•	•
Coin-Op	•	
Specialty Products		
Trash Compactor	•	•
Hot Water Dispenser	•	
Disposal	•	•
Automatic Ice Maker		•



Whirlpool Gold® Built-in Cooking Zone
 pictured: Whirlpool Gold® Double Oven GBD307PRY
 Velos™ Speedcook Oven GH7208XRY
 Whirlpool Gold® Warming Drawer GBW3050TS



Duet® Steam in Aspen with Laundry 123 custom laundry options
 pictured: Duet® Steam Washer WFW9600TA
 Duet® Steam Dryer WE/GD9600TA
 Laundry 123 Worksurface XW29000TA
 Laundry 123 Duet® Tower XVP9000TA

Whirlpool® Home Appliances Helping your clients get more done.



Today's homebuyers are busy, active people who appreciate help in accomplishing their tasks and managing their homes. They desire appliances that are easy to use, reflect their individual tastes and help them be incredibly productive. They also appreciate appliances that help them be environmentally responsible. Whirlpool brand responds with products that unite style, performance as well as eco-efficiency—helping to facilitate everyday chores with less effort, while saving time and resources.



In the kitchen, Whirlpool offers the PowerScour™ option that enhances dishwasher performance. Several Whirlpool refrigerator models help your busy clients with unique features like the In-Door-Ice® and Fast Fill dispensing systems. Similarly, many Whirlpool ranges and ovens feature the AccuBake® Temperature Management system that helps your clients achieve consistent, uniform baking performance with balanced heat. For a unified appearance,

pair up a Whirlpool freestanding range with a complementary microwave oven to create a PowerPair™ Cooking Center. **In the laundry room,** the new Whirlpool brand Duet® Steam laundry pair offers your clients a whole new way to care for laundry from start to finish, with the pure power of steam. Duet® washers and dryers also offer new design possibilities with an exciting new color—Aspen Green. You can count on Whirlpool brand for productivity-enhancing laundry solutions for single-family, multi-family and commercial applications. Whirlpool® is committed to developing products that are energy- and water-efficient.



And now, 3D digital models of Whirlpool products are immediately available via The Google® 3D Warehouse and may be downloaded directly into your CAD designs.

Built-in Ovens

Nothing sparks the passions of busy homeowners more than productivity and saving time in their kitchens. The variety and versatility of Whirlpool® all-electric large-capacity ovens will keep those passions cooking. You'll find built-in single ovens, double ovens and combination ovens, all with advanced features. Non-convection ovens are available 24", 27" and 30" wide, while convection ovens are 27" and 30" wide.



Whirlpool Gold® Double Oven

GBD307PRY 30" (pictured)

- Formed door styling, new handles and console, glass touch controls
 - 4.1 Cu. Ft. Upper & Lower Oven Capacity
 - AccuBake® Temperature Management System in both ovens
 - Upper Oven Convection and Lower Oven Thermal
 - White, Black, Stainless Steel and Monochromatic Stainless Steel
- GBD277PR 27"
Similar to GBD307PR with 3.6 Cu. Ft. Upper and Lower Oven Capacity
- White, Black and Stainless Steel



Whirlpool Gold® Speedcook/Combination Oven

GSC308PRB 30" (pictured)

- Formed door styling, new handles and console, glass touch controls
- 1.4 Cu. Ft. Upper Oven Capacity
- True Convection Upper Oven
- 900 Watts Microwave Cooking Power
- 4.1 Cu. Ft. Lower Oven Capacity
- AccuBake® Temperature Management System
- Fan Convection Cooking Lower Oven
- White, Black and Stainless Steel



Whirlpool Gold® Oven/Micro Combination

GMC305PRS 30" (pictured)

- Formed door styling, new handles and console, glass touch controls
 - 1.4 Cu. Ft. Upper Oven Capacity
 - 900 Watts Microwave Cooking Power
 - 4.1 Cu. Ft. Lower Oven Capacity
 - AccuBake® Temperature Management System
 - White, Biscuit, Black, Stainless Steel and Monochromatic Stainless Steel
- GMC275PR 27"
Similar to GMC305PR with 1.4 Cu. Ft. Upper Oven and 3.6 Cu. Ft. Lower Oven Capacity
- White, Black, Biscuit and Stainless Steel



Whirlpool® Double Oven (RBD305PRS)



Whirlpool Gold® Single Oven

GBS307PRS 30" (pictured)

- Formed door styling, new handles and console, glass touch controls
- 4.1 Cu. Ft. Oven Capacity
- AccuBake® Temperature Management System
- Convection Cooking System
- White, Black, Stainless Steel and Monochromatic Stainless Steel

GBS277PR 27"
Similar to GBS307PR with 3.6 Cu. Ft. Oven Capacity



Whirlpool® Double Oven

RBD305PRT 30" (pictured)

- 4.1 Cu. Ft. Upper & Lower Oven Capacity
- AccuBake® Temperature Management System in both ovens
- White, Biscuit, Black and Stainless Steel

RBD275PR 27"
Similar to RBD305PR with 3.6 Cu. Ft. Upper and Lower Oven Capacity

RBD245PR 24"
Similar to RBD305PR with 3.1 Cu. Ft. Upper and Lower Oven Capacity



Whirlpool® Single Oven

RBS305PRS 30" (pictured)

- 4.1 Cu. Ft. Oven Capacity
- AccuBake® Temperature Management System
- White, Biscuit, Black and Stainless Steel

RBS275PR 27"
Similar to RBS305PR with 3.6 Cu. Ft. Oven Capacity

RBS245PR 24"
Similar to RBS305PR with 3.1 Cu. Ft. Oven Capacity

- All Black console on 24" model

Cooktops

11 31 00/WHI
BuyLine 1501

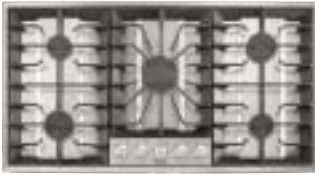

Whirlpool Gold® Gas Cooktop
GLS3665RS (36" pictured)

- Stainless Cooktop Surface
 - One 15,000 BTU Power™ burner, Two 12,000 BTU Power™ burners, Two 9,000 BTU burners
 - Full Width Cast-Iron Grates
 - Recessed Grate Design
 - Stainless Steel
- GLS3064R (30")



Whirlpool Gold® Gas Cooktop
GLT3657RB (36" pictured)

- Ceramic Glass Cooktop Surface
 - Two 12,500 BTU Power™ burners, One 9,100 BTU burner, Two 6,000 BTU burners
 - AccuSimmer® burner
 - Full Width Cast-Iron Grates
 - White and Black
- GLT3057R (30")

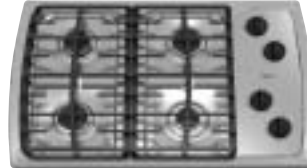

Whirlpool® Gas Cooktop
SCS3017RS (30" pictured)

- Stainless Steel or Porcelain Cooktop Surface
 - Two 12,500 BTU Power™ burners, One 9,100 BTU burner, One 5,000 BTU burner
 - Full Width Cast-Iron Grates
 - White, Black, Biscuit, Stainless Steel
- SCS3617R (36")
- White, Black and Stainless Steel



Whirlpool® Gas Modular Cooktop
SC8720EDB 30"

- Downdraft Vent
- Two 10,000 BTU gas burners
- Non-stick Grill Module, Optional Griddle Module sold separately
- White and Black

Configurations:
Non-Stick Grill Module (Shown)
Black: SCM20DB
Grill Cover: SCM50D

Two 10,000 BTU
Surface-Burner Module
Porcelain-on-Steel
SpillGuard™ Surface
SCM10D

Non-Stick Griddle Module
SCM40DB
(Grill Module SCM20DB
Required as Power Source)



Whirlpool Gold® Electric Downdraft Cooktop
GJD3044RP (30" pictured)

- Downdraft Vent
- Two Ceramic Glass Elements; One 6"/9" Dual Element and One 5"/8" Dual Element
- Infinite Heat Controls
- Black and Pure White



Whirlpool Gold® Electric Cooktop
GJC3055RB (30" pictured)

- Ceramic Glass
 - Glass Touch Controls
 - Two 6" Elements; One 6"/9" Dual Element and One 5"/8" Dual Element
 - 2-Level Simmer and 2-Level Warm Zone (all elements)
 - Infinite Heat Controls
 - Hot Surface Indicator Lights
 - Pure White, Black and Stainless Steel
- GJC3655R (36")



Whirlpool Gold® Electric Cooktop
GJC3054RP (30" pictured)

- Ceramic Glass
 - Double Dual Elements
 - One 6" Element; One 7" Element; One 6"/9" Dual Element and One 5"/8" Dual Element
 - AccuSimmer® Element
 - Infinite Heat Controls
 - Hot Surface Indicator Lights
 - Pure White, Black and Stainless Steel
- GJC3654R (36")



Whirlpool Gold® Electric Cooktop
GJC3034RB (30" pictured)

- Ceramic Glass
 - Bridge Element
 - One 6" Element; Two 7" Elements; One 6"/9" Dual Element
 - AccuSimmer® Element
 - Infinite Heat Controls
 - Hot Surface Indicator Lights
 - Pure White, Pure Biscuit, Black and Stainless Steel
- GJC3634R (36")



Whirlpool® Electric Cooktop
RCC3024RB

- Ceramic Glass
- Two 6" Elements, One 7" Element and One 9" Element
- Infinite Heat Controls
- White, Biscuit and Black



Whirlpool® 36" gas cooktop with full-width, cast-iron grates (GLT3057RB).

For the complete product offering and details, visit whirlpool.com.

Freestanding Ranges

To match your design requirements and your clients' cooking desires, Whirlpool brand offers a wide variety of gas and electric freestanding and slide-in ranges, plus electric drop-in ranges. Most are designed to fit flush with cabinets, and have large-capacity ovens. Gas ranges include conversion kits for converting to LP gas.



Whirlpool Gold® Freestanding Electric Range
GR673LXSS (30" pictured)

- 4.8 Cu. Ft. Oven Capacity
- AccuBake® Temperature Management System
- True Convection Cooking System
- Ceramic-Glass CleanTop® Cooktop
- Two 6"/9" Dual Radiant Elements
- Two 6" Elements
- 7" Warm Zone
- Glass Touch Controls
- PreciseClean™ Cleaning System
- White, Black and Stainless Steel



Whirlpool Gold® Freestanding Electric Range
RF367LXSS (30" pictured)

- 4.8 Cu. Ft. Oven Capacity
- AccuBake® Temperature Management System
- Convection Cooking System
- Ceramic-Glass CleanTop® Cooktop
- Two 6"/9" Dual Radiant Elements
- Two 6" Elements
- EZ-Touch™ Controls
- White, Black and Stainless Steel



Whirlpool Gold® Freestanding Electric Range
GR563LXSS (30" pictured)

- 4.8 Cu. Ft. Oven Capacity
- AccuBake® Temperature Management System
- Ceramic Glass CleanTop® Cooktop
- Two 6"/9" Dual Radiant Elements, Two 6" Elements
- 7" Warm Zone
- Glass Touch Controls
- White, Black, Biscuit and Stainless Steel



Whirlpool Gold® Freestanding Gas Range
GS773LXSS (30" pictured)

- 4.7 Cu. Ft. Oven Capacity
- AccuBake® Temperature Management System
- Upswept Porcelain SpillGuard® Cooktop
- Full-width Cast-Iron Grates
- Two 13,500 BTU Power™ Burners; One 9,500 BTU Burner; One 5,000 BTU Burner
- Sealed Gas Burners
- Warming Drawer
- Glass Touch Controls
- AccuSimmer® Burner
- PreciseClean™ Cleaning System
- White, Black and Stainless Steel



Whirlpool Gold® Freestanding Gas Range
GS563LXSS (30" pictured)

- 4.7 Cu. Ft. Oven Capacity
- AccuBake® Temperature Management System
- Upswept Porcelain SpillGuard® Cooktop
- Full-width Cast-Iron Grates
- One 13,500 BTU Power™ Burner; One 9,500 BTU Burner; One 12,500 BTU Burner; One 5,000 BTU Burner
- AccuSimmer® Burner
- Glass Touch Controls
- Storage Drawer
- White, Black, Biscuit and Stainless Steel

Slide-In Ranges



Whirlpool Gold® Gas Slide-In Range
GW395LEPS (30" pictured)

- 4.1 Cu. Ft. Oven Capacity
- AccuBake® Temperature Management System
- Full-surface 2-piece Porcelain-coated Cast-Iron Grates
- One 14,000 BTU Power™ Burner; One 12,000 BTU Power™ Burner; Two 6,000 BTU Burners
- Sealed Burners
- Storage Drawer
- White, Black, Biscuit and Stainless Steel



Whirlpool Gold® Electric Slide-In Range
GY398LXPS (30" pictured)

- 4.1 Cu. Ft. Oven Capacity
- AccuBake® Temperature Management System
- True Convection Cooking System
- Ceramic Glass CleanTop® System
- Two 6"; One 7" and One 9" Radiant Elements
- Storage Drawer
- White, Black and Stainless Steel



Whirlpool Gold® Electric Slide-In Range
GY396LXPS (30" pictured)

- 4.1 Cu. Ft. Oven Capacity
- AccuBake® Temperature Management System
- Ceramic Glass CleanTop® System
- Two 6", One 7" and One 9" Radiant Elements
- White, Black, Biscuit and Stainless Steel



The Whirlpool® Velos™ Oven with Speedcook Technology is the largest capacity speedcook appliance in the market with its interior cavity measuring two cubic feet. It leverages speedcook and convection technology to substantially reduce cooking times. Homeowners can use four primary working methods: True Convection, Speedcook technology, microwave cooking and steam cooking for excellent results. Combine with a complementary freestanding range to create a PowerPair™ Cooking Center.

Whirlpool Gold®
Velos™ Speedcook Oven
Microwave/Hood Combination
GH7208XRY (30" pictured)

- 2.0 Cu. Ft. Capacity
- Speedcook technology
- True Convection Cooking System
- 1200 Watts & 1500 Grill Watts
- Soften and Melt Functions
- Patented Steaming Function with SureMist® Steamer
- 4-Speed TruCapture™ Ventilation System
- CleanRelease® Non-Stick Interior
- Convertible for Vented or Non-Vented Use
- LCD Touch Screen Controls
- White, Black, Stainless Steel and Monochromatic Stainless Steel



Whirlpool Gold®
g2MicroOven™ Grill & Bake
SpeedCook Oven
GH6177XPQ (30" pictured)

- 1.7 Cu. Ft. Microwave
- Speedcook Technology
- 1100 Watts Cooking Power
- 1500 Watts Grilling Power
- Halogen/Quartz Light Cooking
- Touch Screen Controls
- CleanRelease® Non-Stick Interior
- Convertible for Vented or Non-Vented Use
- White, Black and Stainless Steel



Whirlpool Gold®
Microwave/Hood Combination
GH5184XPQ (30" pictured)

- 1.8 Cu. Ft. Family Capacity™ Oven
- 1100 Watts Cooking Power
- AccuWave® Power System
- 4-Speed Quiet Partner™ Exhaust Fan
- Convertible for Vented or Non-Vented Use
- White, Biscuit, Black and Stainless Steel



Whirlpool®
Microwave/Hood Combination
MH1170XSQ (30" pictured)

- 1.7 Cu. Ft. Family Capacity™ Oven
- 1000 Watts Cooking Power
- 3-Speed Exhaust Fan
- Convertible for Vented or Non-Vented Use
- White, Biscuit, Black and Stainless Steel



Built-in kits are also available for some countertop microwave units.



Whirlpool Gold®
Canopy Wall Hood
GZ9730XSS (30")

- Halogen Lighting
 - Heavy Duty Filters
 - Shipped to be installed vented
 - Stainless
 - Duct free kit available-optional, part number 8212566
 - Chimney Extension kit available-optional, part number 8212565
- GZ9736XSS
Identical to GZ9730XSS in 36" width



Whirlpool Gold®
Ventilation Unit
GZ7736XG 36"

- Vented Slide-Out Hood
 - Vertically Exhausts 320 CFMS with 3-1/4" x 10" Rectangular Duct
 - Fits Flush Under Cabinet
 - Stainless Steel with Brushed Aluminum Trim
- Optional: White, Biscuit and Black Trim Panels Available
- GZ7730XG
Identical to GZ7736XG in 30" width



Whirlpool Gold®
Ventilation Unit
GZ7936XH 36"

- Vented Retractable Downdraft System
 - Vertically Exhausts 600 CFMS with 3-1/4" x 10" Rectangular Duct
 - Pop-Up Raised Height 8-3/4"
 - Stainless Steel with Brushed Aluminum Trim
- Optional: White, Biscuit and Black Trim Panels Available
- GZ7930XH
Identical to GZ7936XH in 30" width

Refrigerators



Fast Fill Dispensing System with measured fill option, rotating dispenser and slide-out tray.



The In-Door-Ice® ice dispensing system moves the ice bin from inside the freezer compartment to the door.

From style to storage, Whirlpool refrigerators deliver the features that help homeowners be more productive in the kitchen. For example, the Fast Fill and In-Door-Ice® dispensing systems, featured on Whirlpool Gold® side-by-side refrigerators, allow homeowners to quickly fill large containers, and make more room in the freezer, respectively. New contoured door side-by-sides open new design possibilities.



Whirlpool Gold® Automatic Ice Maker

- 50 Lbs. of Ice per 24 Hours
- 25-Lb. Capacity Storage
- Self-Cleaning
- Optional Drain Pump
- White, Black, Biscuit and Stainless Steel

G11500XHS (15" pictured)

G11500PH

Similar to G11500XH with a Factory-Installed Drain Pump
White and Black



ENERGY STAR® is a U.S. Registered Mark.



Whirlpool Gold® Side-by-Side Counter Depth Refrigerator

GC5NHAXSY (36" pictured)

- 25 Cu. Ft. Capacity
- 6 Month push button PuR® filtration
- FastFill dispensing system with Measured Fill
- In-Door-Ice® Ice Dispensing System
- In-Door Air® cooling system
- ENERGY STAR® Qualified
- White, Black, Biscuit and Monochromatic Stainless Steel



Whirlpool Gold® Side-by-Side Formed Contoured Door Refrigerator

GF6NFEXTQ (36" pictured)

- 26 Cu. Ft. Capacity
- 6 Month push button PuR® filtration
- FastFill dispensing system with Measured Fill
- In-Door-Ice® Ice Dispensing System
- Integrated LED tap-touch controls
- In-Door Air® cooling system
- ENERGY STAR® Qualified
- Full-length metal handles
- White, Black and Monochromatic Stainless Steel



Whirlpool Gold® Side-by-Side Flat Smooth Door Refrigerator

GDSNVAXSY (36" pictured)

- 25 Cu. Ft. Capacity
- 6 Month push button PuR® filtration
- FastFill dispensing system
- In-Door-Ice® Ice Dispensing System
- Integrated LED tap-touch controls
- In-Door Air® cooling system
- ENERGY STAR® Qualified
- Mid-length metal handles
- White, Black, Biscuit, Stainless Steel, Satina and Monochromatic Stainless Steel



Whirlpool Gold® Side-by-Side Contoured Door Refrigerator

GS6NBEXRL (36" pictured)

- 26 Cu. Ft. Capacity
- 6 Month push button PuR® filtration
- FastFill dispensing system with Measured Fill
- In-Door-Ice® Ice Dispensing System
- In-Door Air® cooling system
- ENERGY STAR® Qualified
- White, Black, Biscuit, Stainless Steel, Monochromatic Stainless Steel, Satina and Monochromatic Satina



Whirlpool Gold® Bottom-Mount Freezer Refrigerator

GB2SHDXTS (33" pictured)

- 22 Cu. Ft. Capacity
- Right-Hand Reversible Doors
- Automatic Ice Maker
- Pull-out Freezer Drawer
- ENERGY STAR® Qualified
- White, Black, Stainless Steel and Satina



Whirlpool Gold® Top-Mount Freezer Refrigerator

GR2FHMXP (33" pictured)

- 22 Cu. Ft. Capacity
 - Right-Hand Reversible Doors with Integrated Cup Handles
 - Automatic Ice Maker
 - ENERGY STAR® Qualified
 - White, Black and Stainless Steel
- GR9FHMXP
Similar to GR2FHMXP with 19 Cu. Ft. Capacity

Your clients can count on Whirlpool dishwashers to deliver on what matters. Whirlpool dishwashers are easy to use, clean tough, baked-on foods with ease, and fit tall and odd shaped items. All Quiet Partner™ systems dishwashers are backed by our 30 Day Quiet Guarantee. A new Whirlpool Gold® model features a slate tub for a premium appearance and durability. Plus, no other leading brand of dishwashers has fewer repairs.*



Thirty six targeted spray jets scour away baked on food with out soaking or scrubbing.



**Whirlpool Gold®
Trash Compactor**
G900QPPS (15" pictured)

- 1/3 HP Motor
- Touch-Toe™ Drawer Opener
- Touch Pad Controls
- Easy Rollers™ Rear Installation Wheels
- Under-the-Counter Installation
- 7" Automatic Anti-Jam
- White, Biscuit, Black and Black with Stainless Steel Drawer Panel

GC900QPP
Similar to GX900QPP but Freestanding. Colors Available: Black and White



ENERGY STAR® is a U.S. Registered Mark.

* Shown in a leading consumer magazine, January 2006



**Whirlpool®
Disposer**
GC5000XE

- 3/4 HP Motor
- Continuous-Feed Operation
- Stainless Steel Grinding Wheel
- Sound insulation



Whirlpool Gold®
GU2700XTSS (24" pictured)

- Plastic Slate Super Capacity Tall Tub Dishwasher
- PowerScour™ Option
- 6 cycles / 6 options
- EZ-2-Lift™ adjustable upper rack
- Adaptive wash cycle
- NSF® Certified Sani Rinse option
- Quiet Partner™ IV System
- ENERGY STAR® Qualified
- White, Black, Biscuit, Stainless Steel and Monochromatic Stainless Steel



**Whirlpool®
Dishwasher**
DU1100XTPS (24" pictured)

- Super Capacity Tall Tub
- 4 cycles / 6 options
- Soak & Scour options for baked on foods
- NSF® Certified Sani Rinse option
- Quiet Partner™ II System
- ENERGY STAR® Qualified
- White, Black, Biscuit and Stainless Steel



Whirlpool Gold®
GU2455XTSB (24" pictured)

- Plastic Slate Super Capacity Tall Tub Dishwasher
- 5 cycles / 6 options
- EZ-2-Lift™ adjustable upper rack
- Glass Xpress™ 30 Minute Cycle
- Quiet Partner™ III System
- ENERGY STAR® Qualified
- White, Black, Biscuit and Stainless Steel



**Whirlpool®
Dishwasher**
DU1055XTSQ (24" pictured)

- Super Capacity Tall Tub
- 4 cycles / 5 options
- AnyWare™ Plus silverware basket
- Quiet Partner™ I System
- ENERGY STAR® Qualified
- White, Black, Stainless Steel and Universal Silver



Whirlpool Gold®
GU2300XTSB (24" pictured)

- Plastic Slate Super Capacity Tall Tub Dishwasher
- 4 cycles/6 options
- PowerScour™ Option
- NSF® Certified Sani Rinse™ Option
- Quiet Partner™ II System
- ENERGY STAR® Qualified
- White, Black, Biscuit and Stainless Steel



**Whirlpool®
Dishwasher**
DU915PWSS (24" pictured)

- Extra Large Capacity
- 5 cycles / 4 options
- Cycles include Pots & Pans, Heavy, Normal, Light and Rinse Only
- White, Black, Biscuit and Stainless Steel

Whirlpool Gold® Dishwasher
GU3600XTSY (24" pictured)

- Stainless Steel Super Capacity Tall Tub
- Formed door styling
- PowerScour™ Option
- 6 cycles / 6 options
- EZ-2-Lift™ adjustable upper rack
- Adaptive wash cycle
- NSF® Certified Sani Rinse option
- Quiet Partner™ IV System
- ENERGY STAR® Qualified
- White, Black and Monochromatic Stainless

For the complete product offering and details, visit whirlpool.com.

Whirlpool® Fabric Care Suite



Designed To Make Every Home More Productive.

The Fabric Care Suite is the next generation in fabric care, combining high-performance products with your design for an efficient laundry area. A concept conceived to make every day more productive as your clients clean and care for all of their fabrics. Combinations of our innovative Laundry Pairs, Laundry Towers, Pedestals, Worksurfaces and the Fabric Freshener can create the modular solution to best fit your clients needs.



Whirlpool® Duet HT® laundry pair shown with Laundry 123™ Worksurface and Tower (page 14).



Fabric Freshener LRF4001RY

- Removes Odors, Relaxes Wrinkles
- Uses distilled water only
- 3 Steam Cycles
- Collapsible and Portable
- For Laundry Room, Bedroom or Closet

The Whirlpool® Fabric Freshener has been recognized with an Industrial Design Excellence Award (IDEA) in 2005.



15.5" storage pedestal shown holds full-size bottles of detergent and includes a folding platform.



For front-loading fabric care, Whirlpool brand sets the industry standard with the Duet® Fabric Care System. Today, there are even more laundry solutions to maximize your design flexibility like the new Duet® Steam Laundry Pair. The Duet® Steam Washer naturally steams out tough stains while the dryer steams out wrinkles and odors. Accessories open up design options while enhancing productivity. Whirlpool™ Laundry 123™ custom laundry worksurface optimizes the top of front-loading laundry pairs for organizing, treating and folding laundry. Additionally, 10 and 15.5 inch pedestals are available to increase accessibility and create a universal design-oriented solution in the laundry space.



White with Sapphire Blue Accents (WFW9400SZ and WE/GD9400SZ)

Whirlpool® Duet® HT® 27" Washer

- 4.0 Cu. Ft. Capacity
- 6 Point Suspension System with gap dampers
- Direct Inject Wash System
- Quiet Wash Plus Noise Reduction System
- ENERGY STAR® Qualified
- Optional Stack Kit
- Optional Storage Pedestals

See below for color options

Whirlpool® Duet® 27" Dryer

- 7.0 Cu. Ft. Capacity
- AccelerCare™ Drying System
- 4-Way Venting Capable for both Electric and Gas
- Reversible Side-Swing Dryer Door
- Optional Stack Kit
- Optional Storage Pedestals

See below for color options



Aspen (WFW9600TA and WE/GD9600TA)

Whirlpool® Duet® Steam Washer

- 4.0 Cu. Ft. Ultra Capacity Plus
- Steam Technology
- Direct Inject Wash System
- 6 Point Suspension System
- Quiet Wash Plus Noise Reduction System
- Optional Stack Kit
- Optional Storage Pedestal
- Also available in White WFW9600TW

Whirlpool® Duet® Steam Dryer

- 7.4 Cu. Ft. Capacity
- Steam Technology
- AccelerCare™ Drying System
- Quick Refresh Cycle Integrated with Steam
- Enhanced Touch Up Cycle Integrated with Steam
- Reversible Door Swing
- Optional Stack Kit
- Optional Storage Pedestal
- Also available in White WE/GD9600TW

Additional Color Options:



White on White
WFW9200SQ and
WE/GD9200SQ



White with Brushed
Chrome Accents
WFW9400SW and
WE/GD9400SW



Black with Brushed
Chrome Accents
WFW9400SB and
WE/GD9400SB



Diamond Dust with
Brushed Chrome Accents
WFW9400SU and
WE/GD9400SU



Biscuit with Gold
Metallic Accents
WFW9400ST and
WE/GD9400ST



Shown with optional pedestals, see page 14 for details.

**Duet Sport™ HT Fabric Care System
27" Full-Size Front Load Washer**
WFW8400TW (shown with optional 10" pedestals)

- 3.7 cu. ft capacity stainless steel tub
- Internal heating element with NSF® Certified Sanitary Cycle
- Innovative 6-Point Suspension System— perfect for second floor installations.
- Up to 1050 rpm maximum spin speed
- ENERGY STAR® Qualified
- Available in White with Grey Accents or Black

**Duet Sport™ HT Fabric Care System
27" Full-Size Front Load Dryer**
WE/GD8300SW (shown with optional 10" pedestals)

- 6.7 cu. ft capacity
- AccelerCare™ Drying System
- 4 way venting capable for both electric and gas (kit required)
- Reversible side swing door (no kit required)
- Available in White with Grey Accents or Black

For laundry rooms with a limited footprint, Whirlpool brand offers a variety of washer and dryer solutions. The Duet Sport™ models offer exceptional capacity and versatile installation with side-by-side, stacked and on-pedestal configurations. The Whirlpool 24" washer and dryer can be mounted under an ADA-compliant countertop.



**Duet Sport™ Fabric Care System
27" Full-Size Front Load Washer**
WFW8300SW (shown stacked and under a custom counter-top)

- 3.4 cu. ft. capacity stainless steel tub
- Deep Clean Wash System
- Innovative Suspension System with Gap Dampers
- Up to 1050 rpm maximum spin speed
- ENERGY STAR® Qualified
- Available in White with Grey Accents

**Duet Sport™ Fabric Care System
27" Full-Size Front Load Dryer**
WE/GD8300SW (shown stacked and under a custom counter-top)

- 6.7 cu. ft. capacity
- AccelerCare™ Drying System
- 4 way venting capable for both electric and gas (kit required)
- Reversible side swing door (no kit required)
- Available in White with Grey Accents



Pair can be installed side by side, stacked or under a custom counter-top.



Whirlpool® 24" Front-Loading Washer
LHW0050PQ

- 2.9 cu. ft. Stainless Steel Wash Basket
- 11 Cycles
- Triple Dispenser for Prewash, Detergent, Fabric Softener
- ENERGY STAR® Qualified
- Stackable

Whirlpool® 24" Front-Loading Electric Dryer
LEW0050PQ

- Moisture Sensor Control
- 11 Cycles
- 4 Temperature Settings
- Long Vent Exhaust System
- Stackable

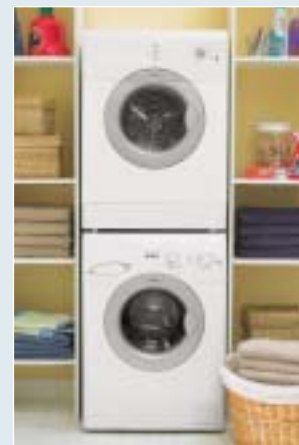

Shown stacked



Whirlpool brand delivers a variety of high-efficiency top-load washers and dryers that help keep fabrics fresh and looking new longer, while reducing the time and effort required in the laundry. The Cabrio™ Fabric Care System enhances productivity by washing 3 baskets of laundry in a single load.



Black

White

Biscuit



Whirlpool® Cabrio™ Washer
WTW6600S

- 4.5 Cu. Ft. Capacity
- See Through Tempered Glass Lid
- Cabrio™ Wash Plate
- 6th Sense™ Technology and Direct Inject Wash System
- Woolmark™ Certified Wool Cycle
- Ultra Quiet Wash Plus
- Detergent, Bleach and Fabric Softener Dispensers
- Up to 10 Hr. Delay Wash
- ENERGY STAR® Qualified
- 28" width
- White, Biscuit and Black



Whirlpool® Cabrio™ Dryer
WGD6400S (Gas)
WED6400S (Electric)

- 7.0 Cu. Ft. Capacity
- See Though Door Window
- AccelerCare™ Drying System
- 3 Way Venting Capable with Optional Kit on Both Electric and Gas
- Wrinkle Shield™ Plus option up to 90 minutes
- Reversible Side-Swing Door
- 28" width
- White, Biscuit and Black



Whirlpool® Classic Top Load Washer
WTW5790SW

- Super Capacity
- 12 Cycles
- 4 Temperature Settings
- White Porcelain-Coated Wash Basket
- Quiet Wash Noise Reduction System
- 27" width
- White and Biscuit



Whirlpool® Classic Dryer
WGD5790S (Gas)
WED5790S (Electric)

- Super Capacity Plus
- 7 Cycles
- 4 Temperature Settings
- Hamper Door Opening
- Wrinkle Shield™ option
- 27" width
- White and Biscuit



Whirlpool® Cabrio™ laundry pair shown.

Laundry Tower / Pedestals



Laundry Tower for Duet® Laundry Pair
WVP9000SW

- Pull-out tray with three dividers
 - Retractable 10" Steel/Chrome Hanging Rod
 - Steel Ball Bearing Drawer Glides
 - 13.5" width
 - White, Black, Diamond Dust and Aspen
- XVP9000TA-Aspen



Laundry Tower for Duet Sport™ or Cabrio™ Laundry Pairs
WVP8600SW

- Pull-out tray with three dividers
- Retractable 10" Steel/Chrome Hanging Rod
- Removable Console
- Steel Ball Bearing Drawer Glides
- 13.5" width
- White and Black



Laundry Tower for Whirlpool® Classic Laundry Pairs
WVP5000SW

- Pull-out tray with three dividers
- Removable Console
- Steel Ball Bearing Drawer Glides
- 13.5" width
- White



Shown: 15.5 inch pedestal



Shown: 10 inch pedestal

Storage Pedestals – 27" width

- Optional pedestals available in 10" and 15.5". 15.5" pedestal doubles as a storage drawer with a sliding shelf to support a laundry basket

15.5" Models:

- WHP1500SQ – White
- WHP1500ST – Biscuit
- WHP1500SB – Black
- WHP1500SU – Diamond Dust
- WHP1500SA – Aspen

10" Models:

- WHP1000SQ – White
- WHP1000ST – Biscuit
- WHP1000SB – Black
- WHP1000SU – Diamond Dust



Black



White



Aspen



Diamond Dust



Laundry Worksurface for Duet® and Duet Sport™ Laundry Pairs
WW29000SW

- Pull-out tray with three dividers
- Scratch and Stain Resistant Mat
- Supply Tray
- Backguard
- Spillguard™ Surface
- White/Grey, Diamond Dust/Grey and Aspen

Classic Laundry

Classic top load washers and dryers combine dependable performance with easy-to-use features to help residents complete laundry chores quickly.



Whirlpool® Classic Top Load Washer
WTW5590SW

- Super Capacity
- 7 Cycles
- 4 Water Levels
- Speckle Porcelain-Coated Wash Basket
- 27" width
- White and Biscuit



Classic Top Load Dryer
WGD5590SW (Gas)
WED5590SW (Electric)

- Long Vent Dryer
- Extra Large Capacity
- 5 Cycles
- Large Side-Swing Door
- 29" width
- White



Classic Top Load Dryer
WGD5500S (Gas)
WED5500S (Electric)

- Super Capacity
- 10 Cycles
- Hamper Door Opening
- 29" width
- White and Biscuit

You and your clients expect outstanding features from Whirlpool Corporation appliances. Commercial Laundry is no exception. With a variety of money acceptance options, water and energy savings, front service access and the exclusive direct drive no belts washing system for greater dependability and ease of service, Whirlpool Corporation commercial laundry is an excellent choice. For information about Whirlpool® commercial laundry products, call 1-800-NOBELTS (1-800-662-3587) or visit <http://coinop.com>.



Whirlpool® High-Efficiency Top Load 2-Speed Washer
CAM2762TQ

- Mechanical Metercase Money Acceptor not included
- Accepts coin drop, coin slide or dual pay card reader
- 3.2 Cu. Ft. capacity
- 3/7/10 year parts warranty



Whirlpool® Coin-Kit Installed Washer
CAM24742TQ

- 2007 Federal Energy Compliant
- Mechanical Metercase Coin Kit installed, ready to operate at up to \$2.00 per cycle
- Accepts coin drop, coin slide or dual pay card reader
- 3.2 Cu. Ft. capacity
- Exclusive 1 year labor warranty
- 1/3/7/10 year parts warranty



Whirlpool® Coin-Kit Installed Dryer
CEM2750TQ 27" (Electric)
CGM2751TQ 27" (Gas)

- Mechanical Metercase Coin Kit installed, ready to operate at up to \$2.00 per cycle
- 7.4 Cu. Ft. capacity
- Exclusive 1 year labor warranty, 2 year parts



Whirlpool® ADVANTECH® Control Stack Dryer
CSP2770KQ 27" (Electric)
CSP2771KQ 27" (Gas)

- Electronic Metercase Money Acceptor not included
- Accepts coin drop, coin slide or dual pay card reader
- Palm® Enabled Electronic Controls with optional management software pack
- 7.4 Cu. Ft. capacity per drum
- 4/7 year parts warranty
- 22 Kbtu Gas, 5.6KW electric per drum



Whirlpool® Mechanical Control Stack Dryer
CSP2760TQ 27" (Electric)
CSP2761TQ 27" (Gas)

- Mechanical Metercase Money Acceptor not included
- Accepts coin slide, coin drop card reader, push to start or dual pay
- 7.4 Cu. Ft. capacity per drum
- 3/7 year parts warranty
- 22 Kbtu Gas, 5.6KW electric per drum



Whirlpool® 2-Speed Washer with ADVANTECH® Control
CAE2762KQ 27"

- Electronic Metercase Money Acceptor not included
- Accepts coin slide, coin drop card reader or dual pay
- Palm® Enabled Electronic Controls with optional management software pack
- 2.5 Cu. Ft. capacity
- 4/7/10 year parts warranty
- Hot water reduction feature



Whirlpool® ADVANTECH® Control Dryer
CEE2760KQ 27" (Electric)
CGE2761KQ 27" (Gas)

- Electronic Metercase Money Acceptor not included
- Accepts coin drop, coin slide or dual pay card reader
- Palm® Enabled Electronic Controls with optional management software pack
- 7.4 Cu. Ft. capacity
- 3/7 year parts warranty
- 22 Kbtu Gas, 5.6KW electric

Palm is a registered trademark of Palm, Inc.



Together we can make a sustainable difference.

At Whirlpool Corporation, we're committed to being the building and design



professionals' go-to source for eco-efficient appliances needed to design, construct, operate and maintain green homes. We want to partner with you in developing designs that can make a sustainable difference.

Serving the design professional.

Whirlpool offers a number of complimentary services that benefit the design community. Our new

offering of 3D digital models for Google SketchUp allows you to download Whirlpool® product models from the Google 3D Warehouse right into your CAD designs. You can also connect with Google Earth to place your 3D design on a jobsite to share with clients.

You can also access **online continuing education, CSI three-part specifications and**

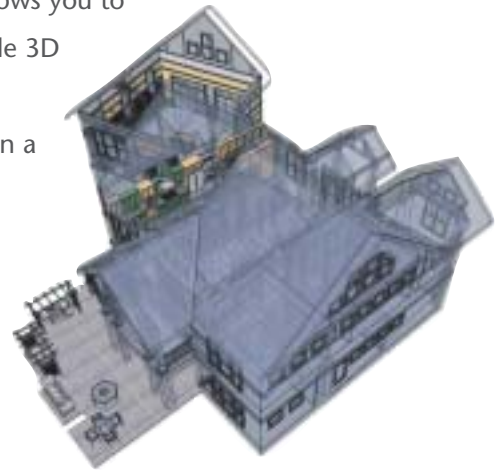

CAD details at
Sweets.com.

Professional courtesy
appliance discounts for AIA,
AIBD, NKBA and IIDA members' personal use
are also available.



To find out more, visit insideadvantage.com/designers or call 800-253-3977.

