

PAC-LOC FASCIA 3000

FOR BUILT-UP OR MODIFIED ROOFING SYSTEMS

PRODUCT FEATURES

- Wide variety of gauges and face sizes
- Superior, efficient engineering for ease of installation
- Non-penetrating design eliminates stripping-in
- Snap-on configuration eliminates field crimping
- Concealed splice plates allow for cleaner design
- Extruded aluminum anchor bar securely terminates the membrane
- Pre-punched holes for precise fastener placement
- Raised button-hole on waterdam vertical face for easy installation
- Wide variety of colors and finishes
- Convenient 12' lengths
- Reusable and recyclable material
- Custom and radius capabilities available
- Superior watertight integrity of the installation
- 20-Year, 110 mph wind warranty available

MATERIALS

- 37 Stocked PAC-CLAD Finishes – 24 GA Steel
- 18 Stocked PAC-CLAD Finishes – .040 Aluminum
- 29 Stocked PAC-CLAD Finishes – .050 Aluminum
- 6 Stocked PAC-CLAD Finishes – .063 Aluminum
- Mill Finish Aluminum – .040, .050 & .063 Aluminum
- Clear and Colored Anodized – .040, .050 & .063 Aluminum

ACCESSORIES

- Miters – 90 Degrees and Non-90 Degrees
- Scuppers – Downspout, Spillover and Overflow
- Drainage Component

TESTING

- ANSI/SPRI ES-1 Standard tested to comply with the International Building Code
- 5 1/4" – 8 1/4" in 24 GA & .040 aluminum to design pressure of 160 lbs/ft²
- 5 1/4" – 8 1/4" in .050 & .063 aluminum to design pressure of 180 lbs/ft²
- 9 3/4" – 12 3/4" in 24 GA & .040 aluminum to design pressure of 110 lbs/ft²
- 9 3/4" – 12 3/4" in .050 & .063 aluminum to design pressure of 140 lbs/ft²

WARRANTY

A 20-Year, 110 mph Wind Warranty is available on orders to meet a project's specification. It provides a maximum of 20 years, 110 mph coverage for the repair or replacement of any portion of the roof edge system that has failed due to a defect in the supplied material

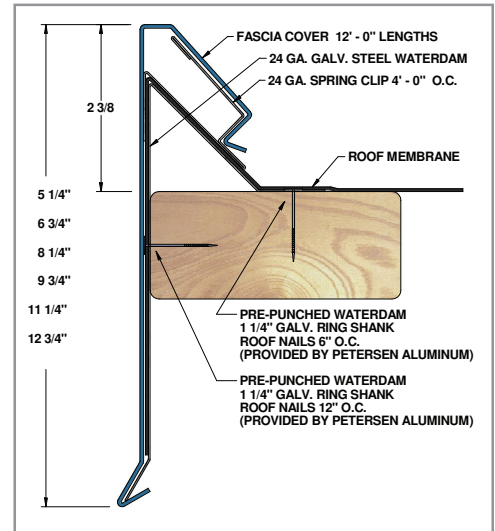

SIZES

Face Heights	Nailer Coverage
5 1/4"	1 Nailers
6 3/4"	2 Nailers
8 1/4"	3 Nailers
9 3/4"	4 Nailers
11 1/4"	5 Nailers
12 3/4"	6 Nailers

