

# PAC-TITE ANGULAR FASCIA

## FULLY ADHERED OR MECHANICALLY ATTACHED SINGLE-PLY VERSION

### PRODUCT FEATURES

- Unmatched uplift protection in roof edge applications
- Combines superior strength and aesthetics with ease of installation
- Meets stringent performance requirements
- Non-penetrating design eliminates need for stripping in/heat welding
- Superior watertight integrity of the installation
- Extruded aluminum anchor bar securely terminates the membrane
- Extensively tested to exceed industry standards
- Pre-punched holes for precise fastener placement and quick installation
- Slotted holes allow for thermal movement
- Lifetime, 170 mph wind warranty available
- Wide variety of colors and finishes
- Convenient 12' Lengths
- Custom and radius capabilities available
- Reusable and recyclable for reinstallation
- Ideal for parapet applications instead of coping

### MATERIALS

- 37 Stocked PAC-CLAD Finishes – 24 GA Steel
- 18 Stocked PAC-CLAD Finishes – .040 Aluminum
- Mill Finish Aluminum – .040 Aluminum
- Clear and Colored Anodized – .040 Aluminum

### ACCESSORIES

- Miters – 90 Degrees and Non-90 Degrees
- Scuppers – Downspout, Spillout and Overflow
- Drainage Components

### TESTING

- ANSI/SPRI ES-1 Standard to a design pressure of 290 lbs/ft<sup>2</sup> to comply with the International Building Code
- Factory Mutual 1-645 approved for wind uplift protection
- Miami-Dade Approved to comply with the High Velocity Hurricane Zone of the Florida Building Code

### WARRANTY

A Lifetime 170 mph warranty is available. It covers replacement or repair of any portion of the roof edge system that has failed due to a defect in the supplied materials. The warranty covers the roof edge for the lifetime of the roof on which it was originally installed.

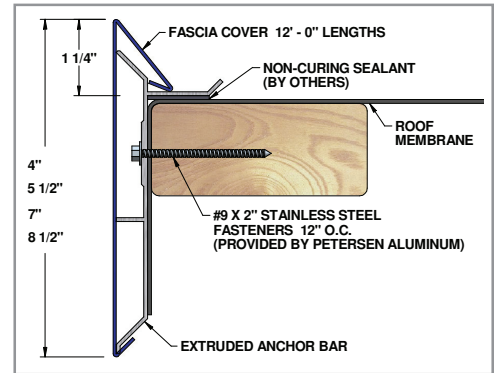

### SIZES

Face Heights	Nailer Coverage
4"	1 Nailers
5 1/2"	2 Nailers
7"	3 Nailers
8 1/2"	4 Nailers

