

EJ-EW-800/1000/1200

Expansion joint cover for walls

Wall to wall or wall to wall corner condition

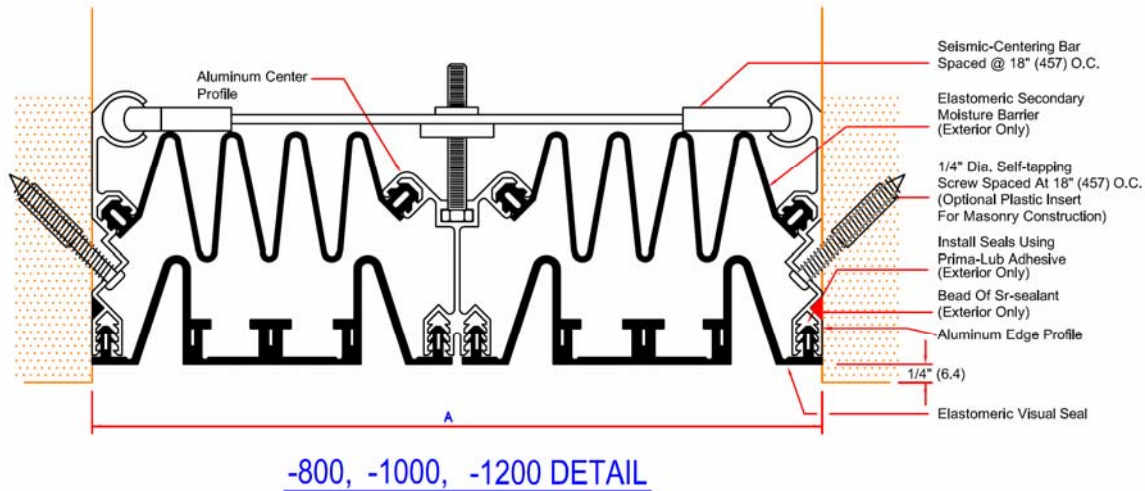

() - Denotes Millimeters

DIMENSION CHART			
MODEL	A OPENING AT INSTALLATION	A TOTAL MOVEMENT	A MAXIMUM OPENING *
EJ-EW-800	8"(203)	9-5/8"(244)	15-5/8"(397)
EJ-EW-1000	10"(254)	13-5/8"(346)	17-5/8"(448)
EJ-EW-1200	12"(305)	19-1/8"(486)	23-1/8"(587)

* Designed Without Stress To The System Components.
Capable Of Wider Openings During Seismic Event.



Right to site.

Call: 800-547-2635 Fax: 800-317-8770
USA or Canada
Web: www.nystrom.com
E-mail: info@nystrom.com

PROJECT: _____

CONTRACTOR: _____

ARCHITECT: _____

INITIALS: _____

QTY: _____

DATE: _____

PART NUMBER: _____