

EJ-TMM-W Series

Expansion joint cover for floor joints Floor to floor corner condition

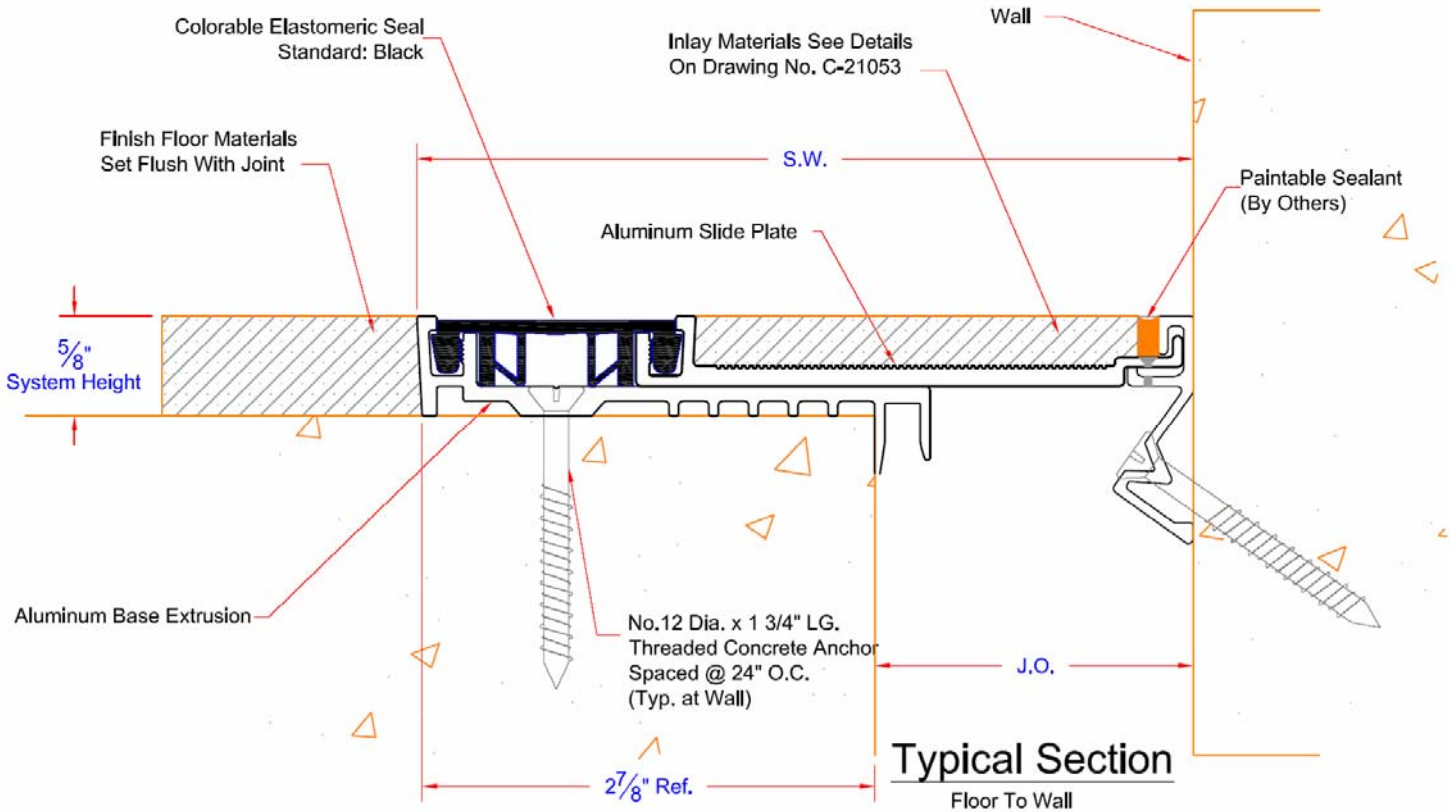

Design Features

- * Aesthetically attractive.
- * Slide plate recess accepts finish inlay materials.
- * Gasket provides flush finish and installation.
- * Easily replaceable flat gasket.
- * No preformed blockouts required - most applications.
- * Simple installation - fewer components.
- * Corridor wrap sightlines - utilize for floor and wall applications.
- * Low height system 5/8".
- * Multi - directional movement.
- * Complies with ADA guidelines.

Model	Joint Opening (J.O.)						Total movement		S.W.	
	at install		allow min.		allow max.		inches	mm	at install	
	inches	mm	inches	mm	inches	mm			inches	mm
-TMM-200W	2	51	1 1/8	29	3 5/8	92	2 1/2	64	4 7/8	124
-TMM-400W	4	102	1 1/8	29	5 5/8	143	4 1/2	114	6 7/8	175
-TMM-600W	6	152	1 1/8	29	7 5/8	194	6 1/2	165	8 7/8	225

Note: J.O. minimum and maximum values are after seismic movement occurs.



Right to site.

Call: 800-547-2635 Fax: 800-317-8770
USA or Canada
Web: www.nystrom.com
E-mail: info@nystrom.com

PROJECT: _____

CONTRACTOR: _____

ARCHITECT: _____

INITIALS: _____

QTY: _____

DATE: _____

PART NUMBER: _____