

B

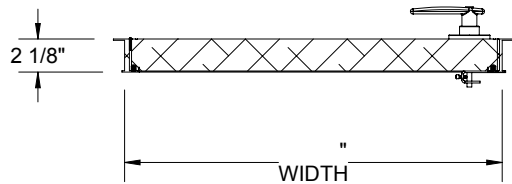
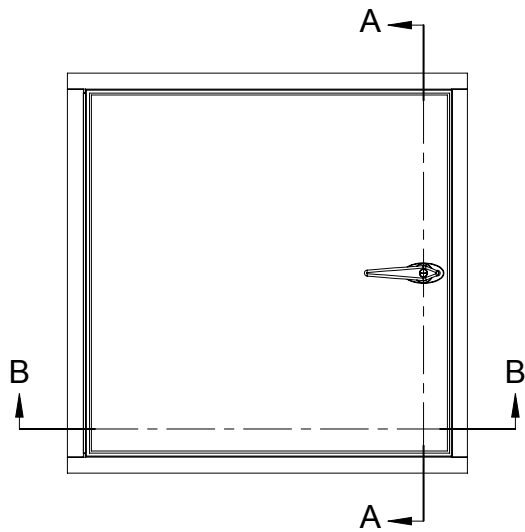

SECTION B-B

## NOTES:

- 1 **FRAME:** 6063-T5 Extruded Aluminum, Mill Finish
- 2 **DOOR:**
- 3 **HINGE:**
- 4 **GASKET:** EPDM Self-Adhesive, continuous Gasket
- 5 **INSULATION:** Foam Insulation, 2-1/4lb Density
- 6 **LATCH:**
- 7 **LOCK:** Lockable Handle

ROUGH OPENING: " x "  
 CLEAR OPENING: " x "  
 DEGREE OF OPENING: 180°  
 # LATCHING POINTS:

SECTION A-A

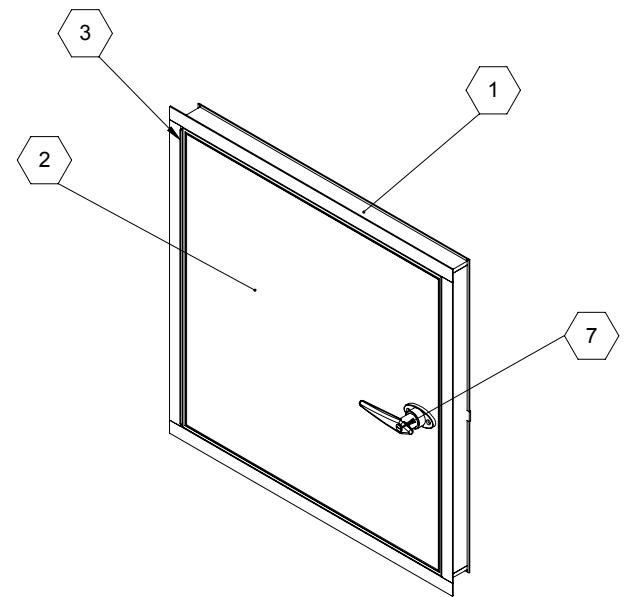
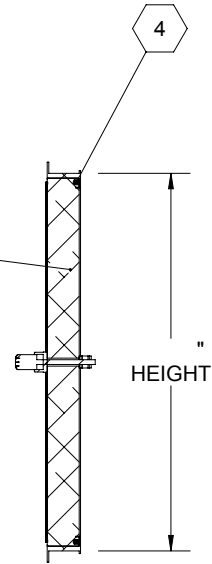

B

A

A

PROJECT:					
ARCHITECT:					
CONTRACTOR:					
QTY:					
PART#:					
<div><p>Right to site. 9300 73rd Avenue North Brooklyn Park, MN 55428</p></div>			TITLE:		
	NAME	DATE	SIZE	DWG. NO.	REV
DRAWN	GML	5/27/2014	A	XTL ShpDr	A
RELEASED	DWO	TODAY	WEIGHT: 23		SHEET 1 OF 2

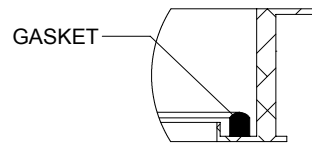
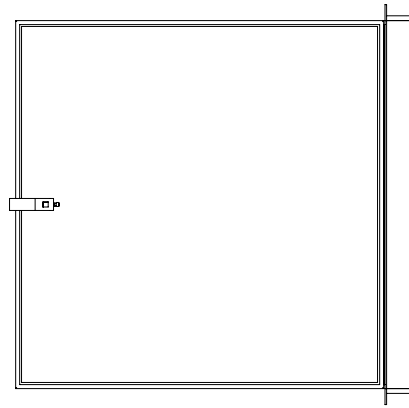
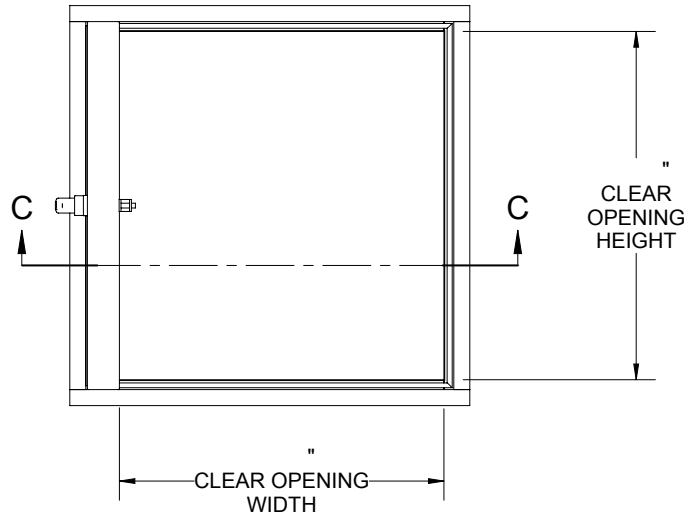

DETAIL D  
SCALE 1 : 3

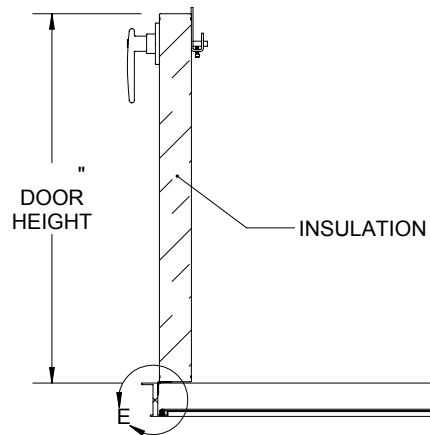

CONTINUOUS  
HINGE

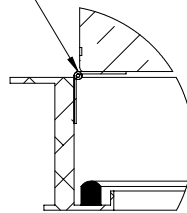

DETAIL E  
SCALE 1 : 3

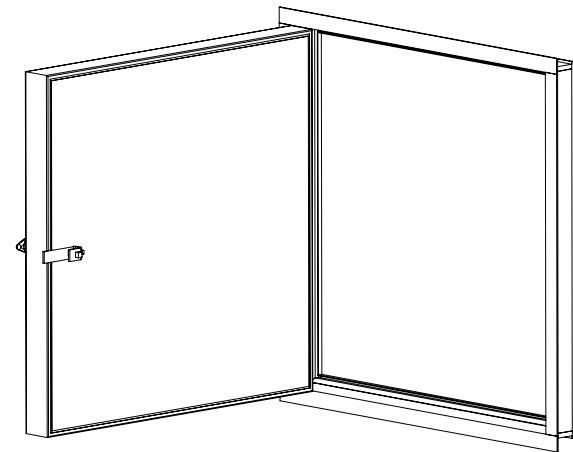

PROJECT:				
ARCHITECT:				
CONTRACTOR:				
QTY:				
PART#:				
<b>NYSTROM</b> Right to site. 9300 73rd Avenue North Brooklyn Park, MN 55428		TITLE:		
	NAME	DATE	SIZE	DWG. NO.
DRAWN	GML	5/27/2014	A	XTL ShpDr
RELEASED	DWO	TODAY	WEIGHT: 23	
				REV A
				SHEET 2 OF 2