

EJ-WCS-100 thru 300

Expansion joint cover for walls

Wall to wall condition

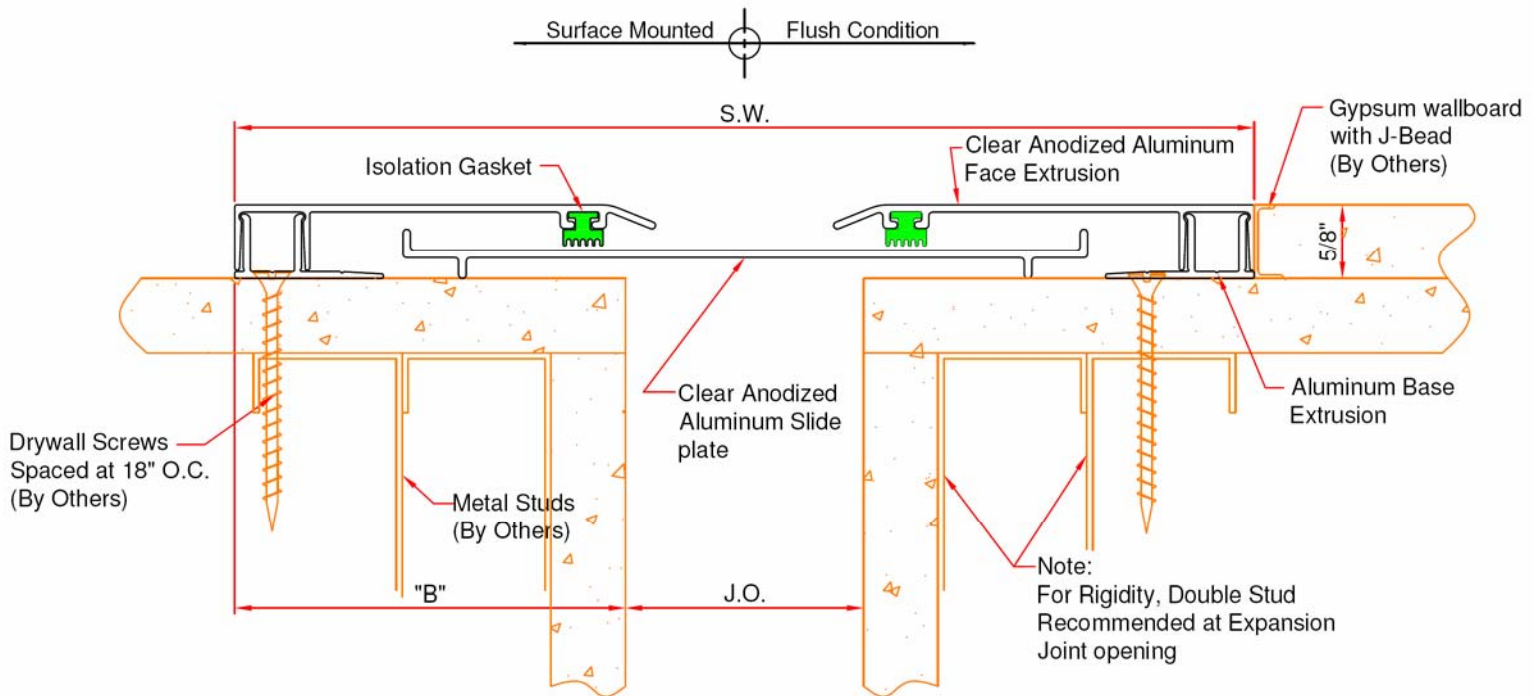

EJ-WCS -100 THRU EJ-WCS -300 DETAIL
WALL-TO-WALL CONDITION

() - Denotes Millimeters

DIMENSION CHART						
Model	J.O. @ Min.	J.O. @ Mid	J.O. @ Max.	"B"	Total Movement	System Width
-WCS-100	1/2" (13)	1" (25)	4 1/2" (114)	3 5/16" (84)	4" (102)	7 9/16" (192)
-WCS-200	1/2" (13)	2" (51)	4 1/2" (114)	3 5/16" (84)	4" (102)	8 9/16" (217)
-WCS-300	1/2" (13)	3" (76)	4 1/2" (114)	3 5/16" (84)	4" (102)	9 9/16" (243)



Right to site.

Call: 800-547-2635 Fax: 800-317-8770

USA or Canada

Web: www.nystrom.com

E-mail: info@nystrom.com

PROJECT: _____

CONTRACTOR: _____

ARCHITECT: _____

INITIALS: _____

QTY: _____

DATE: _____

PART NUMBER: _____