

EJ-LCA-100 DETAIL
CEILING TO CEILING CONDITION

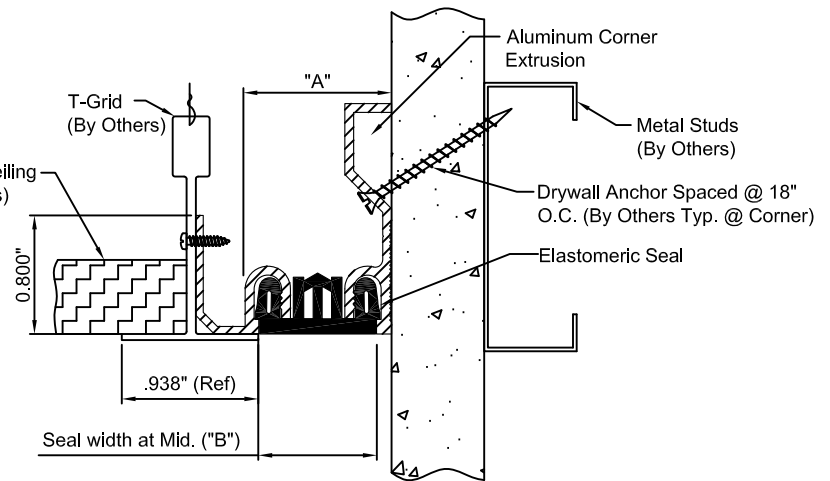

EJ-LCA-100W DETAIL
CEILING TO WALL CONDITION

() - Denotes Millimeters

Dimension Chart					
MODEL	"A" @ Min.	"A" @ Mid.	"A" @ Max.	Total Movement	"B"
EJ-LCA-100/100W	.75"(19)	1.00"(25)	1.25"(32)	.50"(13)	.781"(20)