



# G-550P ALUMINUM PLAIN DETAIL

PLAIN THIN LINE GRATES HAVE CONTINUOUS I-BEAM TREAD RAILS AND CAN BE FABRICATED WITH CURVES AND ANGLES. CONSTRUCTED WITH STUDY KEYLOCKS EVERY THREE INCHES, THIN LINE GRATES CAN STAND UP TO ALMOST ANY TRAFFIC.

## DETAIL NOTES:

- 1-TREAD RAILS MUST RUN PERPENDICULAR TO TRAFFIC DIRECTION.
- 2-TRAFFIC DIRECTION DIMENSION CAN ONLY BE CHANGED IN 3/4" (19.1MM) INCREMENTS UNLESS ALUMINUM FILLER IS ATTACHED TO THE FRAME.
- 3-GRATE DIMENSIONS ALLOW FOR CLEARANCE BETWEEN GRATE SECTIONS AND FRAME IN THE WIDTH DIMENSION.

## SPECIFICATIONS:

GRATEDESIGN MODEL G-550P HAS OUR THIN LINE RAIL THAT IS MADE WITH 6063-T52 ALLOY RAILS AND ARE 1-3/4" (44.5MM) DEEP AND, SPACED 3/4" (19.1MM) ON CENTER. WITH KEYLOCKS SPACED 3" (76.2MM) ON CENTER. FRAMES USED WITH THE G-550P ARE: TYPE F-1 LEVEL BED; TYPE F-LANG LARGE ANGLE; TYPE F-2 DEEP PIT; TYPE F-2T THIN SLAB FRAMES WHICH ARE MADE OF ALUMINUM.

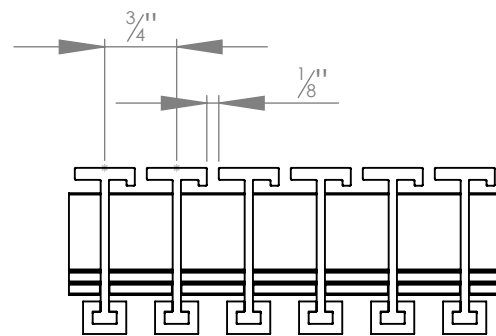

WIDTH VIEW

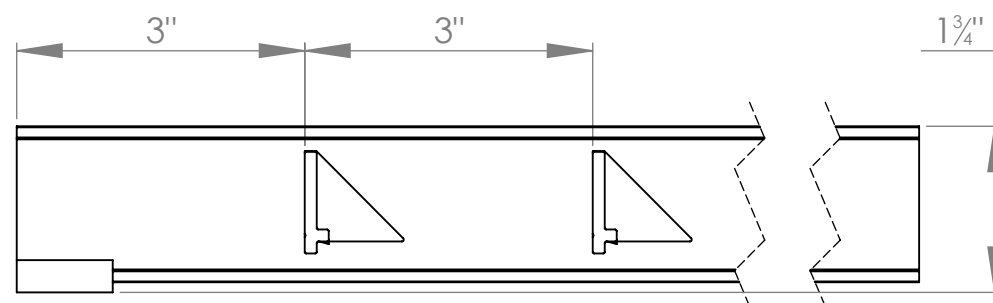

LENGTH VIEW

 Arden  
Architectural  
Specialties, Inc.  
9300 73rd Avenue North  
Brooklyn Park, MN 55428

JOB REF.

MODEL NO. **G-550P**

RELEASED DATE 6/3/2010

SHEET 1 OF 1