

PLAN VIEW
NOT TO SCALE

SPECIFICATIONS

- 1/8" HIGH IMPACT STYRENE PLASTIC DOOR & FRAME
- 3/4" REVERSABLE FLANGE FRAME
- STANDARD SNAP LATCHES W / REMOVABLE DOOR
- TEXTURED WHITE FINISH
- MANUFACTURED OF LONG LASTING A.B.S. PLASTER W / U.V. STABILIZERS
- EASY INSTALLATION W / ADHESIVE CAULK APPLIED TO SURFACE

| MODEL # | -A- W X L | -B- W X L | -C- W X L OUTSIDE TO OUTSIDE |
|---------|-------------------|-----------------|------------------------------------|
| PL0406 | 4.25" X 6.25" | 4.00" X 6.00" | 5.25" X 7.25" |
| PL0609 | 6.375" X 9.375" | 6.00" X 9.00" | 8.25" X 11.25" |
| PL0808 | 8.375" X 8.375" | 8.00" X 8.00" | 10.25" X 10.25" |
| PL1414 | 13.875" X 13.875" | 13.50" X 13.50" | 17.00" X 17.00" |
| PL1429 | 14.00" X 29.375" | 13.75" X 29.00" | 17.00" X 32.375" |

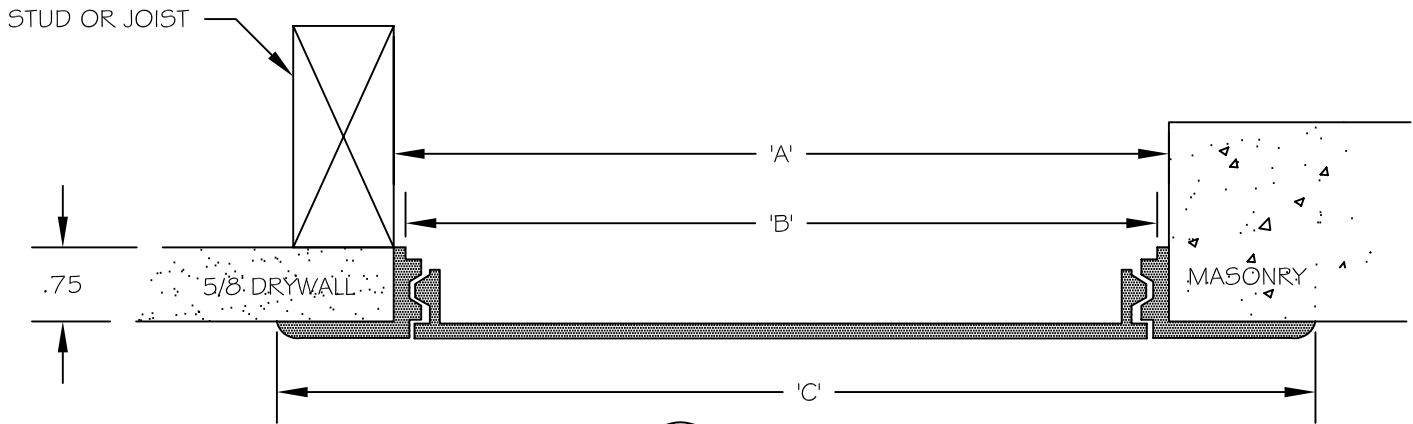

SECTION VIEW
NOT TO SCALE