



## *Altempco Structural Glass Wall Systems*

**Altempco Glass** (a division of **Hollman, Inc.**) is a leading manufacturer of structural glass wall systems, specializing in view walls for racquetball, handball, and squash court applications.

Since 1983, **Altempco** has been providing glass walls of exceptional quality, as well as superior customer service to athletic clubs, colleges and universities, and other recreational facilities worldwide. Our technical expertise and emphasis on client satisfaction are second to none. It's no wonder that **Altempco** has become the **clear** choice for structural glass needs.

# A L T E M P C O

*The Clear Choice in Structural Glass Wall Systems*



Texas Woman's University, Denton, Texas



*World's Leading Manufacturer  
of Panelized Court Systems and  
Athletic Glass Walls*

**Visit our web site at [www.hollman.com](http://www.hollman.com)!**

**2007**



## *A Personal Message . . .*

*As the leading manufacturer of panelized court systems and athletic glass walls in the world today, we have the background required to help detail and value-engineer the courts and glass for your project. You'll be inspired by our personal interest in assisting you to incorporate a first class court system in your facility. We look forward to talking with you.*

*Tom Fuchs*



**Balustrades**



**Structural Wall**

## *Doors and Door Hardware*

All standard glass doors are 3' 0" x 7' 0" (914mm x 2134mm) and are designed for easy access to courts. They have a flush-mounted pull-ring handle on the court side and a lever with a positive self-latching bolt on the viewing side. All hardware fittings used in the installation of the glass wall systems are manufactured of high tensile polyurethane. The side-hinged doors feature upper and lower stops to eliminate any chance for trapped fingers and limit deflection upon impact. The **Altempco** wall systems have no glass-to-glass or glass-to-metal contact anywhere in the entire system.



**WSF Certified and Approved Squash Court Walls**

## *Rigorous Testing With an Emphasis on Safety*

**Altempco** structural glass walls are pre-engineered and designed to withstand very high loading criteria. In the rare event of failure, the tempered glass panel or fin which is affected will fracture into innumerable small pieces, reducing the possibility of serious injury upon impact. **Altempco** glass walls meet and/or exceed the BOCA requirements as tested in accordance with CPSC 16 CFR part 1201. Documented evidence is available upon request.

## *A Total Package Deal*

**Altempco Glass** provides worldwide distribution of its glass products. Walls are erected quickly using conventional handling equipment.

When the **Altempco** products are packaged with other materials manufactured and installed by **Hollman, Inc.** you create a total package. No other company can provide such a service with over 40 years combined expertise in the industry. **Hollman** and **Altempco**, names to remember.



## *A Visible Improvement to Your Facility*

When you install **Altempco** structural glass walls as backwalls and sidewalls in your racquetball, handball, and squash courts, you'll notice a visible improvement. Interest and participation in these sports will increase, thus, adding a higher level of excitement and a more active social atmosphere to your club environment. **Altempco's** aesthetically pleasing glass walls also provide a more open and attractive club design. Architects and owners alike are finding that structural glass wall systems create the effect of spaciousness when used between gymnasiums, aerobic areas, entryways, etc.

## *State-of-the-Art Construction and Materials*

The combination of modern tempering with structural glass wall engineering makes the **Altempco** glass wall system truly state-of-the-art. Our wall system consists of tempered glass, high tensile polyurethane hardware, anchoring systems, and glass doors. Together, these materials create an integral unit that distributes stresses, minimizes deflection and vibration, and provides true rebound and response on the playing surface of the glass.

RACQUETBALL HANDBALL

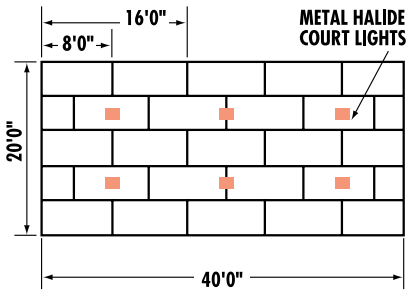

ROUGH FRAMING DIMENSIONS

**LENGTH** – 40' 2" (12.24m) from the face of the front wall studs to the face of the opposing rear wall studs.

**WIDTH** – 20' 1 3/4" (6.14m) from the face of the left side wall studs to the face of the opposing right side wall studs.

**HEIGHT** – 20' 3 1/4" (6.16m) from the low point in the concrete slab to the bottom of the joist. This dimension utilizes the standard floor height of 2 5/8". If another floor height is utilized, contact our office.

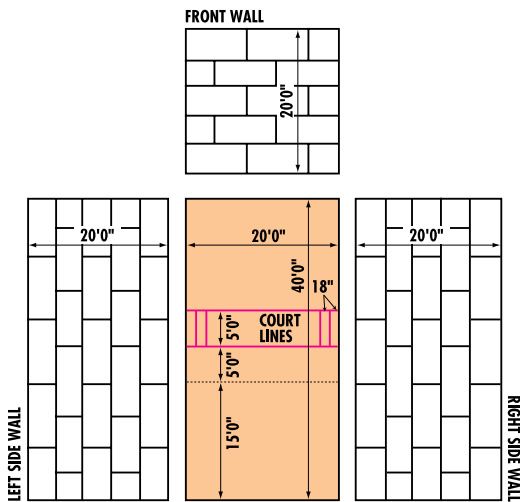

**SIDE WALL:** 1/2" THICK, 4' x 8' TONGUE-AND-GROOVE COURT WALL PANEL, SEE SPECIFICATIONS.

6" — 18 GAUGE GALVANIZED METAL "C" STUDS @ 16" O.C. @ SIDE WALL, AND REAR WALL, SEE SPECIFICATIONS.

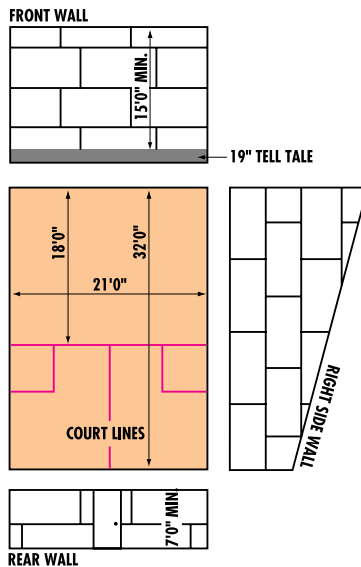

**FRONT WALL:** 1 1/2" THICK, 4' x 8' TONGUE-AND-GROOVE COURT WALL PANEL, SEE SPECIFICATIONS.

6" — 18 GAUGE GALVANIZED METAL "C" STUDS @ 12" O.C. @ FRONT WALL, SEE SPECIFICATIONS.

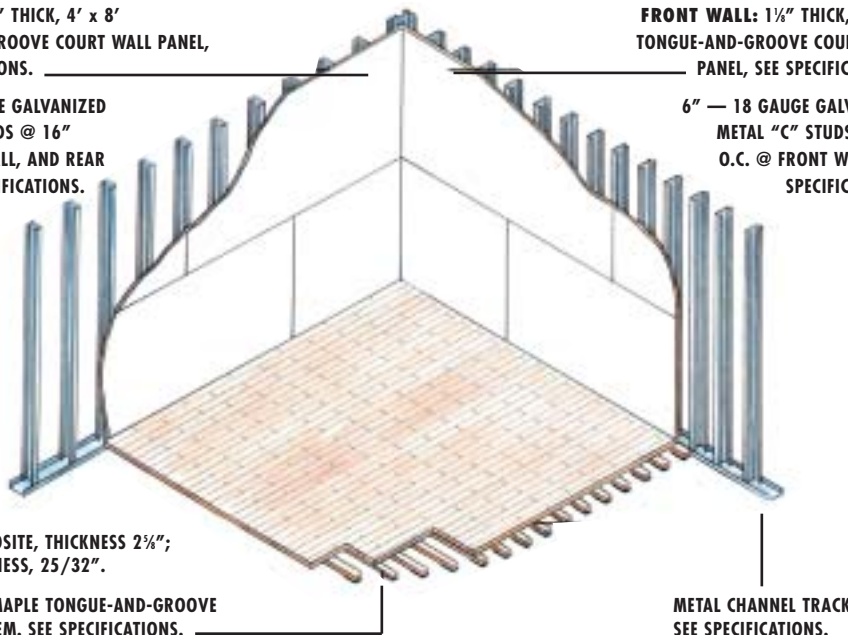

*International Squash*

21' 0" x 32' 0" x 20' 0" (6.40m x 9.75m x 6.09m)

ROUGH FRAMING DIMENSIONS

**LENGTH** – 32' 2 1/4" (9.81m) from the face of the front wall studs to the face of the opposing wall studs.

**WIDTH** – 21' 2 1/4" (6.46m) from the face of the left side wall studs to the face of the opposing right side wall studs.

**HEIGHT** – We recommend a finished court height of 20' 0" (6.09m) with court wall markings at regulation heights.

Hollman's commitment to provide world-class squash, racquetball, and handball courts has made us an industry leader. We market, manufacture, and install our own panels and glass systems with every step subject to total in-house quality control.

Hollman's panels can be applied against the most common types of framework: steel studs, wood studs, and/or steel or wood furring. The panels are set in place with PL400 adhesive and screwed through the base of the top tongue which pulls each panel tight and flush against the framing members. This ensures the smoothest playing surface and the tightest seam fits possible. We stagger each row of panels to create the interlocking design that is the Hollman trademark of quality. We support this first class system with a manufacturer's 10-year warranty.

Our tournament tested courts are accepted and approved by the American Amateur Racquetball Association, the United States Handball Association, and the World Squash Federation.

Due to the durability and reputation of our panels, the Hollman panels may also be used as indoor soccer dasher boards, gymnasium wall finishes, and multi-purpose room finishes. The panels are available in an array of colors and patterns. *Hollman, a name to remember.*



## Architectural Specifications

### SECTION 13032

#### PART ONE—GENERAL

##### 1.01 SCOPE OF WORK

Provide material, labor, equipment and services necessary to finish, deliver and install all work of this section as shown on the drawings, as specified, but not limited to, the following:

- A. All glass walls, including doors and court windows.
- B. All hardware, anchors and related items described in this section.

##### 1.02 QUALITY ASSURANCE

- A. The approved manufacturer is Altempco Glass (a division of Hollman, Inc.)  
HOLLMAN, INC.  
1825 WALNUT HILL LANE  
IRVING, TEXAS 75038

- B. Glass wall systems by manufacturers other than the one approved must submit sufficient data to enable approval to be given. As a minimum: design calculations, test results, installation instructions and list of prior installations shall be required.

##### 1.03 WARRANTY

All glass walls shall be structurally sound and free from defects in material and workmanship under normal use and service for a period of five (5) years after the date of delivery of the wall and hardware to the purchaser.

#### PART TWO - PRODUCTS

##### 2.01 PERFORMANCE REQUIREMENTS

- A. Glass walls shall provide unrestricted observation of the sports activity with complete safety. The tempered glass panels, mullions, jointing system, anchoring system, glass doors, hardware, etc. shall be engineered to act as an integral unit when subjected to impact from ball or player. This distributes and reduces stresses, minimizes deflection, vibration or damage, and provides true rebound of the ball.
- B. Glass walls meet or exceed BOCA Section 2407.0 requirements as tested in accordance with CPSC 16 CFR part 1201 with documented evidence to show compliance.

##### 2.02 MATERIALS

- A. Glass
  1. All glass shall be fully tempered 1/2" thick safety glass manufactured by a horizontal process.
  2. The tempered glass shall meet, at the time of installation, quality and strength requirements of Federal Specification ASTM C-1036 and ASTM C-1048 and the safety criteria of CPSC 16 CFR 1201 and ANSI Z97.1.
  3. All exposed edges shall be polished.
- B. Fittings
  1. Glass connection fittings shall be of a high-tensile polyurethane, black in color.

- 2. Fin base angles are chromed steel; size: 11-1/2" x 2-1/2" x 2-1/2" x 1/4" (292 x 64 x 64 x 6mm).
- 3. Concrete anchor bolts; size: 1/2" x 3-3/4" (13 x 95mm).
- 4. Fasteners through glass are made of steel, black in color.
- 5. Countersinks in glass are made of nylon, black in color.
- 6. Aluminum channels are clear anodized; size: 1" x 1" x 1/8" (25 x 25 x 3mm).
- 7. Aluminum angles are clear anodized; size: 2-1/2" x 3" x 1/8" (64 x 76 x 3mm).

##### C. Door Hardware

- 1. Door shall be locked by means of a positive locking system with a lever on the exterior and flush ring pull on the interior.
- 2. Lock housing to be clear anodized finish.
- 3. Side-mounting hinges to be used on all wall installations.

##### D. Sealants

All silicone shall be a clear high modulus, acetoxo construction-grade silicone.

##### E. Markings

Rear walls to have a permanent marking of lead-free white ceramic frit lines being 1" on center, 30" high, with a width of 1/8".

#### PART 3 - EXECUTION

##### 3.01 PREPARATION

- A. Installation of glass walls shall be performed by a qualified installer. Installer shall be responsible for and provide interface coordination between work specified hereunder and the work of other trades.
- B. Install walls, doors and related work using experienced workmen and as specified and detailed on the drawings.
- C. Set walls plumb, level, square and true and securely anchored in place, with all joints silicone smooth.
- D. Provide all anchors, clips and fasteners and accessories for complete installation.

##### STANDARD SIZES

###### RACQUETBALL

20'0" wide x 8'0" high (6.1 m x 2.44m)  
20'0" wide x 12'0" high (6.1m x 3.66m)

###### SQUASH

American: 18'6" wide x 6'6" high (5.64m x 1.98m)  
International: 21'0" wide x 7'0" high (6.4m x 2.13m) World Squash Federation (WSF) Approved and Certified

##### ALSO AVAILABLE

20'0" wide x 20'0" high (6.1 m x 6.1 m)  
40'0" wide x 20'0" high (12.2m x 6.1 m)  
View windows  
Glass balustrades  
Glass doors  
Structural walls  
Custom size windows and walls

### SECTION 13032

#### PART ONE—GENERAL

##### 1.01 SCOPE OF WORK

Provide prefabricated courts complete, including, but not limited to, the following:

- A. Walls and ceilings
  - B. Floors and floor finishing (including game lines)
  - C. Doors
  - D. Lights
  - E. Glass
  - F. Connection materials and accessories
- RELATED WORK SPECIFIED ELSEWHERE

##### 1.02 SUBMITTALS

Shop Drawings: Drawings showing court construction and overall dimensions submitted with brochures and product samples.

##### 1.03 PRODUCT HANDLING

- A. Cover and protect materials from pick-up to delivery.
- B. Materials shall not be delivered until the building is completely sealed and weather-tight. The temperature and humidity range must be maintained in proper accordance with manufacturer's recommendations.
- C. Unless otherwise noted, the owner/general contractor will be responsible for unloading the delivery trucks and stocking the court area with materials.
- D. All materials shall be structurally sound and free from defects in material and workmanship under normal use and conditions for a period of ten (10) years after the date of full payment per Hollman's standard printed warranty.

#### PART TWO—PRODUCTS

##### 2.01 QUALITY ASSURANCE

- A. Court materials manufactured and distributed by: HOLLMAN, INC.  
1825 WALNUT HILL LANE  
IRVING, TEXAS 75038
- B. Installer Qualifications: Experienced installers are in-house, trained in the proper erection of the Hollman system and approved by Hollman, Inc.

##### 2.02 PANELS

- A. Type: Precision tongue-and-groove.
- B. Racquetball/Handball: 11/8" thick front walls, 7/8" thick side and rear walls, and 9/16" thick ceilings.
- C. Squash: 11/8" thick front, side, and rear walls.
- D. Size: 48" by 96"
- E. Density: 55# per cubic foot. High pressure laminate shall be .050" in thickness.
- F. Connections: PL-400 or equivalent construction adhesive and special screws.

##### 2.03 GALVANIZED STEEL OR P.T. WOOD FRAMING

- A. Racquetball/Handball Walls: 6" x 18 ga studs spaced 12" o.c. on the front walls and 16" o.c. on the side and rear walls.
- B. Squash Walls: 6" x 18 ga studs spaced 10" o.c. on the front walls and 12" o.c. on the side and rear walls.

- C. Ceilings: 6" x 16 ga. joists spaced 16" o.c.
- D. Standard 2 x 4 P.T. wood furring or galvanized steel hat channel on concrete.

##### 2.04 FLOORS

- A. Concrete subfloor shall be furnished to the racquetball court subcontractor, broom-clean and finished smooth, straight and level to where maximum tolerance is 1/8" per 10' radius. All leveling is to be done by the general contractor.
- B. Maple flooring shall be installed in accordance with the current MFMA recommended procedures.
- C. Materials: As specified by owner/general contractor.
- D. Game Lines: Per regulations.

##### 2.05 DOORS

- A. A 1 3/4" solid core wood door manufactured by Hollman, Inc. with matching color laminate on both sides.
- B. A 1/2" thick tempered glass door manufactured by Altempco Glass (a division of Hollman, Inc.) with matching finish on both sides of wood door frame.

##### 2.06 LIGHTING

Metal halide or fluorescent light fixtures are available.

##### 2.07 INSULATION (OPTIONAL)

Suitable insulation to be inserted between the framing members on the walls as specified by owner/general contractor.

##### 2.08 GLASS

Tempered glass viewing windows, walls, and doors as manufactured by Altempco Glass (a division of Hollman, Inc.). Glass is 1/2" thick and BOCA tested meeting all structural and building code regulations.

##### 2.09 ACCESSORIES

- A. Goody Boxes: Valuable storage boxes as manufactured by Hollman, Inc.
- B. Wallyball Kits: Wallyball kits available include ball, net, mounting hardware, and rule book.

#### PART THREE—EXECUTION

##### 3.01 INSPECTION (BY GENERAL CONTRACTOR)

Inspect concrete subfloors and masonry walls for proper tolerances of 1/8" per 10'.

##### 3.02 INSTALLATION

Install courts complete, utilizing qualified and authorized personnel who have experience in the correct and proper installation of similar projects.

##### 3.03 CLEAN-UP

- A. Wipe down panels after installation.
- B. Caulk corner joints.
- C. Clean up all unused materials and debris and remove from premises.
- D. All installations shall be approved by owner or owner's agent by signing an acceptance agreement prior to installer's departure.



Park at Lee Vista, Orlando, Florida

Manufacturer reserves the right to change the design or specifications to improve product or process at any time.

WORLD HEADQUARTERS AND MANUFACTURING  
1825 Walnut Hill Lane, Irving, Texas 75038  
972-815-4000 • Fax 972-815-2921  
800-433-3630 • 800-525-8439 • www.hollman.com

"See listing in Sweets"

