

Sanparrel Informational Series

S410 Informational Signs

S410 Informational Signs

Standard Sizes

- ▶ 2" x 8" (51mm x 203mm)
- ▶ 4" x 4" (102mm x 102mm)
- ▶ 4" x 8" (102mm x 203mm)
- ▶ Custom sizes available
- ▶ 6" x 6" (152mm x 152mm)
- ▶ 8" x 8" (203mm x 203mm)
- ▶ 12" x 12" (305mm x 305mm)

Production Styles

- ▶ Tactile
- ▶ Partial Inlay
- ▶ Flush Inlay
- ▶ Engraved

Frame Options

- ▶ Standard injection molded frames with square or round corners:
 - 2" x 8" (51mm x 203mm)
 - 4" x 4" (102mm x 102mm)
 - 4" x 8" (102mm x 203mm)
 - 6" x 6" (152mm x 152mm)
 - 8" x 8" (203mm x 203mm)
 - 12" x 12" (305mm x 305mm)
- ▶ Custom size PVC and aluminum extruded frames available; square corners only
- ▶ Northern Hardwoods frames with red oak or maple wood or bamboo

Unframed Options

- ▶ Square, radius, scallop or notch corners
- ▶ Projection mounting available
- ▶ PRISM® Solid Surface available in 59 colors

Additional Information

- ▶ Manufactured from Sanparrel Rigid Vinyl Sheet
- ▶ Signs available in more than 180 colors and patterns
- ▶ Logos available; digital file required (eps, wmf, dmx or ai files accepted)
- ▶ Glow-in-the-dark option available
- ▶ For available pictograms, visit inprocorp.com
- ▶ See "Sign Collections" for additional style options



S410 Informational – Engraved Plastic

Standard Sizes

- ▶ Smallest: 1/2" h x 1" w
- ▶ Largest: 24" h x 48" w

Production Style

- ▶ Engraved

Additional Information

- ▶ 21 color combinations available
- ▶ Use for interior and exterior applications

IPC.960/REV.8



P.O. Box 406 · Muskego, Wisconsin 53150 USA
inprocorp.com
Nationwide 800.222.5556/Fax 888.715.8407
International Sales 262.679.5521/Fax 262.679.5524

INPRO
SIGNSCAPE
Signage and Wayfinding

S410 Informational Sign Suggested Specifications

PART 1 – GENERAL

1.01 SUMMARY

A. Interior non-illuminated informational surface mounted signage.

1.02 SECTION INCLUDES

A. S410 Informational Signage

1.03 REFERENCES

- A. Americans with Disabilities Act (ADA)
- B. American National Standards Institute (ANSI)

1.04 SYSTEM DESCRIPTION

A. Performance Requirements: Provide signage systems that conform to the following requirements of regulatory agencies and the quality control of InPro SignScape.

1. Signage shall comply with all applicable provisions of the ADA and ANSI A117.1-1998

1.05 SUBMITTALS

- A. Product Data: Manufacturer's printed product data for each signage system indicated in this section.
- B. Signage Report: SignPro signage report indicating signage sizes, lettering, and construction.
- C. Samples: Verification samples of signage systems minimum of 6 inches (152mm) square of each type and color indicated.
- D. Manufacturer's Installation Instructions: Printed Installation Instructions for each signage system.

1.06 DELIVERY, STORAGE, AND HANDLING

- A. Deliver materials in unopened factory packaging to the jobsite.
- B. Inspect materials at delivery to assure that specified product have been received.
- C. Store in original packaging in a climate controlled environment away from direct sunlight.

1.07 WARRANTY

A. Standard InPro SignScape limited lifetime warranty against material and manufacturing defects.

PART 2 – PRODUCTS

2.01 MANUFACTURERS

A. Acceptable Manufacturer: InPro SignScape,
InPro Corporation PO Box 406, Muskego, WI 53150 USA
Telephone: 800-222-5556, Fax: 888-715-8407
E-mail: service@inprocorp.com

B. Substitutions: Not permitted

C. Provide all signage systems from a single manufacturer.

2.02 MATERIALS

A. Signage Panel

- 1. Provide signage material in a color selected by the architect from InPro SignScape color selection.
- 2. Prism® Solid Surface Panels
 - a. Item number, Size and Shape:
SSPR-RD1616, 16" (406mm) x 16" (406mm), Radius
SSPR-RD1010, 10" (254mm) x 10" (254mm), Radius
SSPR-RD5555, 5¹/₂" (140mm) x 5¹/₂" (140mm), Radius
SSPR-RD0311, 3" (76mm) x 11" (279mm), Radius
SSPR-SQ1616, 16" (406mm) x 16" (406mm), Square
SSPR-SQ1010, 10" (254mm) x 10" (254mm), Square
SSPR-SQ5555, 5¹/₂" (140mm) x 5¹/₂" (140mm), Square
SSPR-SQ0311, 3" (76mm) x 11" (279mm), Square
SSPR-AR2014, 20" (508mm) x 14" (356mm), Arch
SSPR-AR0907, 9" (229mm) x 7" (178mm), Arch
SSPR-AR0705, 7" (178mm) x 5" (127mm), Arch
SSPR-OV1418, 14" (356mm) x 18" (457mm), Oval
SSPR-OV0911, 9" (229mm) x 11" (279mm), Oval
SSPR-OV0406, 4" (102mm) x 6" (152mm), Oval

B. Frames

- 1. Injection Molded Frames: Molded frames shall be manufactured of injection molded thermoplastic. Frame shall have square corners or corners with a ³/₄" (19mm) radius.
 - 2. Extruded Aluminum Frames: Aluminum frames shall be fabricated from 6063-T5 aluminum.
 - 3. Extruded Vinyl Frames: Vinyl frames shall be extruded from chemical and stain resistant polyvinyl chloride.
 - 4. Wood Frames: Wood frames shall be fabricated from kiln dried solid maple or red oak with a moisture content of 5-9%.
 - 5. Bamboo Frames: Bamboo frames shall be fabricated from kiln dried solid mao, grass reed in Natural or Carbonized with a moisture content of 5-9%.
 - 6. PRISM® Solid Surface Frames - PRISM® frames and panels shall be PRISM® Solid Surface Material in a color/pattern from InPro SignScape color selection.
- C. Frame Finishes
- 1. Injection Molded Frames: Color to be selected, by the architect, from the InPro SignScape finish selection. Texture shall be sand.
 - 2. Extruded Aluminum Frames: Color to be selected, by the architect, from the InPro SignScape finish selection. Aluminum shall be anodized.
 - 3. Extruded Vinyl Frames: Color to be selected, by the architect, from the InPro SignScape finish selection. Texture shall be smooth.
 - 4. Wood Stain: Color of the maple and red oak to be selected by the architect from the IPC stain selection. Wood frames shall be finished with two coats of low luster satin finish.
 - 5. Bamboo Stain: Color of the bamboo to be selected, by the architect, in a clear finish. Bamboo frames shall be finished with a water based, low luster satin finish.
 - 6. PRISM® Solid Surface Frames and Panels: PRISM® surface shall be smooth.
- D. Production Style
- 1. Tactile (Raised Letter)
 - a. Framed: Provide sign panel consisting of .060" (1.5mm) sheet bonded with .040" (1mm) sheet that is cut and assembled to create signage.
 - b. Unframed: Provide sign panel consisting of .080" (2mm) sheet bonded with .040" (1mm) sheet that is cut and assembled to create signage.
 - 2. Two-Piece Projection: Provide sign panel consisting of .060" (1.5mm) sheet bonded to .060" (1.5mm) sheet. An additional .040" sheet is cut and assembled to create signage.
 - 3. One-Piece Triangular Projection: Provide sign material consisting of .060" (1.5mm) sheet bonded with .040" (1mm) sheet that is cut and assembled to create signage.
2. Partial Inlay (Tamper Resistant Tactile Signage)
- a. Framed: Provide sign panel consisting of .060" (1.5mm) sheet that is engraved to receive .060" (1.5mm) sheet that is cut and assembled to create signage.
 - b. Unframed: Provide sign panel consisting of .080" (2mm) sheet that is engraved to receive .060" (1.5mm) sheet that is cut and assembled to create signage.
3. Flush Inlay
- a. Framed: Provide sign panel consisting of .080" (2mm) sheet that is engraved to receive .040" (1mm) sheet that is cut and assembled to create signage.
 - b. Unframed: Provide sign panel consisting of .080" (2mm) sheet that is engraved to receive .040" (1mm) sheet that is cut and assembled to create signage.
4. Engraved
- a. Framed: Provide sign panel consisting of .040" (1mm) sheet bonded to .040" (1mm) sheet that is engraved to create signage.
 - b. Unframed: Provide sign panel consisting of .060" (1.5mm) sheet bonded to .040" (1mm) sheet that is engraved to create signage.
5. One-Piece Plastic Engraved:
- a. Framed or Unframed: Provide sign panel consisting of ¹/₁₆" (1.5mm) 2-ply ABS or Acrylic that is engraved to create signage. Finish shall be matte in a color selected from the color palette for one-piece plastic engraved signage.
- E. Accessories/Options
- 1. Unframed Signage Mounting Options
 - a. Double-sided Foam Tape: Provide double-sided foam tape to adhere unframed signage to clean, dry, well sealed substrates.
 - b. Magnetic Mounting Strips: Provide magnetic mounting strips to attach unframed signage to steel substrates.
 - c. Screw Mount: Provide screw mount unframed signage with exposed mounting fasteners. Fasteners to be located at each corner.
 - d. Projection Mount: Provide mounting brackets to project unframed signage from the wall.
 - e. Double-sided Foam Tape and Heavy Duty Adhesive: Provide double sided foam tape and heavy duty adhesive to adhere larger signs and PRISM® Solid Surface signs to clean, dry, well sealed substrates.
 - 2. Unframed Signage Corner Conditions
 - a. Square Corners: Provide unframed signage corners that are 90 degrees square.
 - b. Radius Corners: Provide unframed signage corners with a .525" (13mm) radii.
 - c. Scalloped Corners: Provide unframed signage corners with a .5" (13mm) scallop.
 - d. Notched Corners: Provide unframed signage corners with a .5" (13mm) notch.
 - 3. Table Top Easel Signage: Provide table top easel signage with mounting base extending 50% the height of the sign. Sign shall have an incline of 60°.

2.03 MANUFACTURED UNITS

A. Molded Frames

- 1. Frame Item number, Size and Shape:
SFS0208, 2" (51mm) x 8" (203mm), square corners

- SFS0404, 4" (102mm) x 4" (102mm), square corners
- SFS0408, 4" (102mm) x 8" (203mm), square corners
- SFS0606, 6" (152mm) x 6" (152mm), square corners
- SFS0808, 8" (203mm) x 8" (203mm), square corners
- SFS1212, 12" (305mm) x 12" (305mm), square corners
- SFR0208, 2" (51mm) x 8" (203mm), radius corners
- SFR0404, 4" (102mm) x 4" (102mm), radius corners
- SFR0408, 4" (102mm) x 8" (203mm), radius corners
- SFR0606, 6" (152mm) x 6" (152mm), radius corners
- SFR0808, 8" (203mm) x 8" (203mm), radius corners
- SFR1212, 12" (305mm) x 12" (305mm), radius corners

B. Aluminum Frames

Size - Custom, Minimum 3" (76mm) x 3" (76mm), Maximum 48" (1.22m) x 96" (2.44m)

C. Extruded Vinyl Frame

Size - Custom, Minimum 3" (76mm) x 3" (76mm), Maximum 48" (1.22m) x 96" (2.44m)

D. Wood and Bamboo Frames

1. Frame Item number, Size and Shape:

- SFW-RD1616, 16" (406mm) x 16" (406mm), Radius
 - SFW-RD1010, 10" (254mm) x 10" (254mm), Radius
 - SFW-RD5555, 5¹/₂" (140mm) x 5¹/₂" (140mm), Radius
 - SFW-RD0311, 3" (76mm) x 11" (279mm), Radius
 - SFW-SQ1616, 16" (406mm) x 16" (406mm), Square
 - SFW-SQ1010, 10" (254mm) x 10" (254mm), Square
 - SFW-SQ5555, 5¹/₂" (140mm) x 5¹/₂" (140mm), Square
 - SFW-SQ0311, 3" (76mm) x 11" (279mm), Square
 - SFW-AR2014, 20" (508mm) x 14" (356mm), Arch
 - SFW-AR0907, 9" (229mm) x 7" (178mm), Arch
 - SFW-AR0705, 7" (178mm) x 5" (127mm), Arch
 - SFW-OV1418, 14" (356mm) x 18" (457mm), Oval
 - SFW-OV0911, 9" (229mm) x 11" (279mm), Oval
 - SFW-OV0406, 4" (102mm) x 6" (152mm), Oval
- Wood Type - Maple, Oak, or Bamboo

E. Two Piece Projection Mounting Brackets

1. Bracket Item number, Description and Color:

- SS100160, 2" (51mm) bracket for sign heights 2" (51mm) - 5" (127mm), color - silver
 - SS100161, 3" (76mm) bracket for sign heights 3" (76mm) - 11" (279mm), color - silver
 - SS100162, 4" (102mm) bracket for sign heights 4" (102mm) - 17" (432mm), color - silver
 - SS100163, 5" (127mm) bracket for sign heights 5" (127mm) - 20" (508mm), color - silver
- Maximum sign projection - 20" (508mm)

F. One Piece Triangular Projection

- 1. S410TP-0606, 6" (152mm) x 6" (152mm) Sign Face with 1" (25mm) mounting flanges.
- 2. S410TP-0808, 8" (203mm) x 8" (203mm) Sign Face with 1" (25mm) mounting flanges.

G. Scroll Bracket Projection

- 1. S110SBP-0618, 6" (152mm) x 18" (457mm) Sign Face with black powder coat metal bracket, bracket height 11" (279mm), maximum projection 24" (610mm).
- 2. S110SBP-1218, 12" (305mm) x 18" (457mm) Sign Face with black powder coat metal bracket, bracket height 11" (279mm), maximum projection 24" (610mm).

PART 3 – EXECUTION

3.01 EXAMINATION

A. Examine areas and conditions in which the signage system will be installed.

- 1. Complete all finishing operations, including painting, before beginning installation of signage systems.
- 2. Wall surface shall be dry and free from dirt, grease, and loose paint.

3.02 PREPARATION

A. General: Prior to installation, clean substrate to remove dust, debris, and loose particles.

3.03 INSTALLATION

A. General: Locate the signage system as indicated on the approved detail drawing for the appropriate substrate and in compliance with the InPro SignScape installation instructions. Install signage systems level and plumb at the height indicated on the drawings.

3.04 CLEANING

A. At completion of the installation, clean surfaces in accordance with the InPro SignScape clean up and maintenance instructions.



P.O. Box 406 · Muskego, Wisconsin 53150 USA

inprocorp.com

Nationwide 800.222.5556/Fax 888.715.8407

International Sales 262.679.5521/Fax 262.679.5524

INPRO CORPORATION
Interior and Exterior Architectural Products

Sanparrel Informational Series S420 Advanced Overlay Signs

Standard Sizes

- ▶ 4" x 4" (102mm x 102mm)
- ▶ 4" x 8" (102mm x 203mm)
- ▶ 6" x 6" (152mm x 152mm)
- ▶ 8" x 8" (203mm x 203mm)
- ▶ 12" x 12" (305mm x 305mm)

Production Styles

- ▶ Tactile with Grade 2 Braille
- ▶ Partial Inlay with Grade 2 Braille

Frame Options

- ▶ Standard injection molded frames with square or round corners:
- ▶ 4" x 4" (102mm x 102mm)
- ▶ 4" x 8" (102mm x 203mm)
- ▶ 6" x 6" (152mm x 152mm)
- ▶ 8" x 8" (203mm x 203mm)
- ▶ 12" x 12" (305mm x 305mm)
- ▶ Square corners recommended

Additional Information

- ▶ Clear polycarbonate sheet with Grade 2 Braille and text manufactured from Sanparrel Rigid Vinyl that snaps into frame

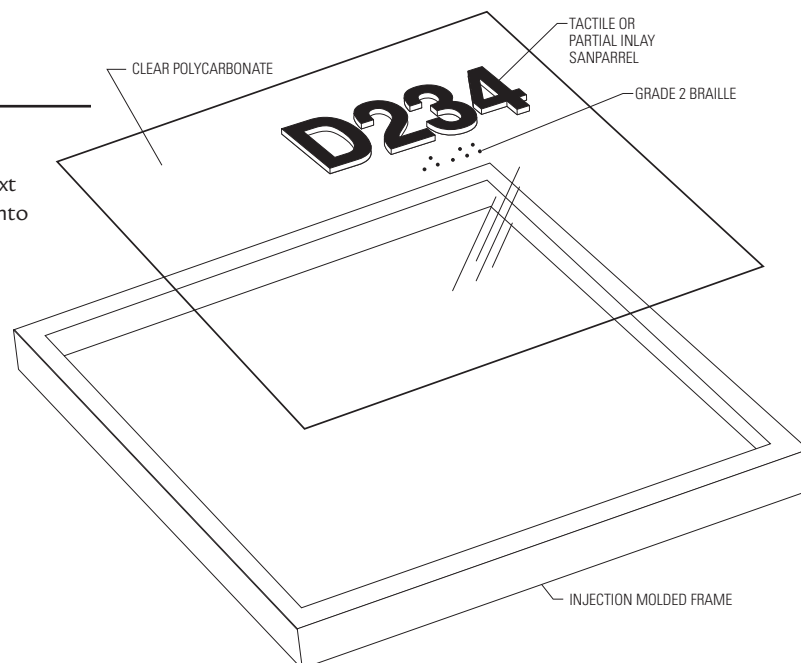

IPC.961/REV.6



P.O. Box 406 · Muskego, Wisconsin 53150 USA
inprocorp.com
Nationwide 800.222.5556/Fax 888.715.8407
International Sales 262.679.5521/Fax 262.679.5524

INPRO
SIGNSCAPE
Signage and Wayfinding

S420 Informational Sign Suggested Specifications

PART 1 – GENERAL

1.01 SUMMARY

A. Interior non-illuminated informational surface mounted signage.

1.02 SECTION INCLUDES

A. S420 Advanced Overlay Sign

1.03 REFERENCES

A. Americans with Disabilities Act (ADA)

B. American National Standards Institute (ANSI)

1.04 SYSTEM DESCRIPTION

A. Performance Requirements: Provide signage systems that conform to the following requirements of regulatory agencies and the quality control of InPro SignScape.

1. Signage shall comply with all applicable provisions of the ADA and ANSI A117.1-1998

1.05 SUBMITTALS

A. Product Data: Manufacturer's printed product data for each signage system indicated in this section.

B. Signage Report: SignPro signage report indicating signage sizes, lettering and construction.

C. Samples: Verification samples of signage systems minimum of 6 inches square of each type and color indicated.

D. Manufacturer's Installation Instructions: Printed Installation Instructions for each signage system.

1.06 DELIVERY, STORAGE AND HANDLING

A. Deliver materials in unopened factory packaging to the jobsite.

B. Inspect materials at delivery to assure that specified product have been received.

C. Store in original packaging in a climate controlled environment away from direct sunlight.

1.07 WARRANTY

A. Standard InPro SignScape limited lifetime warranty against material and manufacturing defects.

PART 2 – PRODUCTS

2.01 MANUFACTURERS

A. Acceptable Manufacturer:

InPro SignScape, InPro Corporation
PO Box 406, Muskego, WI 53150 USA
Telephone 800-222-5556, Fax: 888-715-8407
E-mail: service@inprocorp.com

B. Substitutions: Not permitted

C. Provide all signage systems from a single manufacturer.

2.02 MATERIALS

A. Frames

1. Injection Molded Frames: Molded frames shall be manufactured of injection molded thermoplastic. Frame shall have square corners.

B. Frame Finishes

1. Injection Molded Frames: Color to be selected, by the architect, from the InPro SignScape finish selection. Texture shall be sand.

C. Production Style

1. Tactile (Raised Letter)

a. Provide .060" (1.5mm) clear polycarbonate substrate bonded with .040" (1mm) sheet material that is cut and assembled to create signage.

2. Partial Inlay (Tamper Resistant Tactile Signage)

a. Provide .060" (1.5mm) clear polycarbonate substrate engraved to receive .060" (1.5mm) material that is cut and assembled to create signage.

3. Grade 2 Braille

a. Provide Grade 2 Braille produced with the Raster™ Method, patented process for placing Braille on signage. Raster™ Braille is computer engineered using a carbide-engraving bit, press-fit tool with vacuum pump and UV stable acrylic rasters.

2.03 MANUFACTURED UNITS

A. Molded Frame

1. Frame Item number, Size and Shape:

SFS0404, 4" (102mm) x 4" (102mm), square corners

SFS0408, 4" (102mm) x 8" (203mm), square corners

SFS0606, 6" (152mm) x 6" (152mm), square corners

SFS0808, 8" (203mm) x 8" (203mm), square corners

SFS1212, 12" (305mm) x 12" (305mm), square corners

SFR0404, 4" (102mm) x 4" (102mm), rounded corners

SFR0408, 4" (102mm) x 8" (203mm), rounded corners

SFR0606, 6" (152mm) x 6" (152mm), rounded corners

SFR0808, 8" (203mm) x 8" (203mm), rounded corners

SFR1212, 12" (305mm) x 12" (305mm), rounded corners

PART 3 – EXECUTION

3.01 EXAMINATION

A. Examine areas and conditions in which the signage system will be installed.

1. Complete all finishing operations, including painting, before beginning installation of signage systems.

2. Wall surface shall be dry and free from dirt, grease and loose paint.

3.02 PREPARATION

A. General: Prior to installation, clean substrate to remove dust, debris and loose particles.

3.03 INSTALLATION

A. General: Locate the signage system as indicated on the approved detail drawing for the appropriate substrate and in compliance with the InPro SignScape installation instructions. Install signage systems level and plumb at the height indicated on the drawings.

3.04 CLEANING

A. At completion of the installation, clean surfaces in accordance with the InPro SignScape clean up and maintenance instructions.



P.O. Box 406 · Muskego, Wisconsin 53150 USA
inprocorp.com
Nationwide 800.222.5556/Fax 888.715.8407
International Sales 262.679.5521/Fax 262.679.5524

INPRO CORPORATION
Interior and Exterior Architectural Products

Sanparrel Informational Series S430 Overlay Signs

Standard Sizes

- ▶ 2" x 8" (51mm x 203mm)
- ▶ 4" x 4" (102mm x 102mm)
- ▶ 4" x 8" (102mm x 203mm)
- ▶ 6" x 6" (152mm x 152mm)
- ▶ 8" x 8" (203mm x 203mm)
- ▶ 12" x 12" (305mm x 305mm)

Production Styles

- ▶ Frame with clear polycarbonate sheet

Frame Options

- ▶ Standard injection molded frames with square or round corners:
- ▶ 2" x 8" (51mm x 203mm)
- ▶ 4" x 4" (102mm x 102mm)
- ▶ 4" x 8" (102mm x 203mm)
- ▶ 6" x 6" (152mm x 152mm)
- ▶ 8" x 8" (203mm x 203mm)
- ▶ 12" x 12" (305mm x 305mm)
- ▶ Square corners recommended

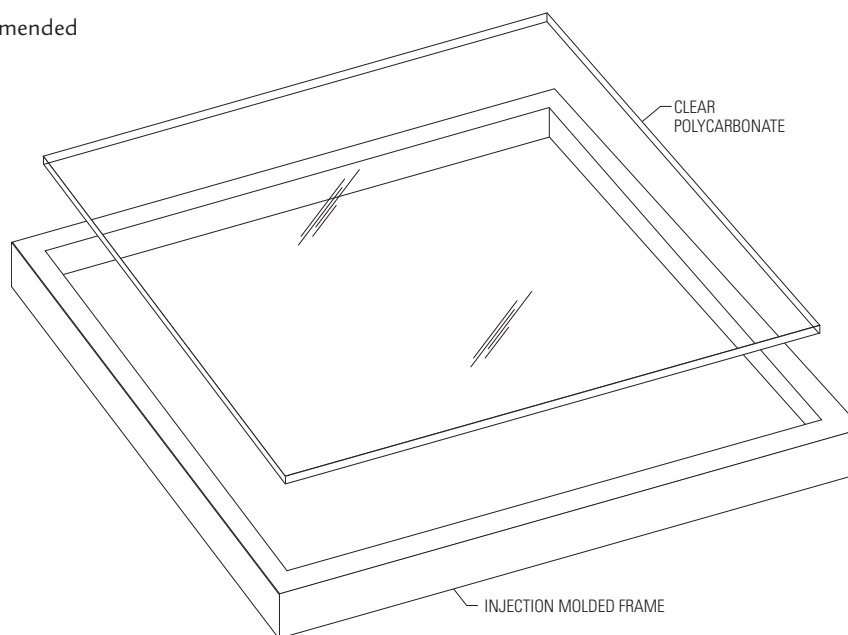
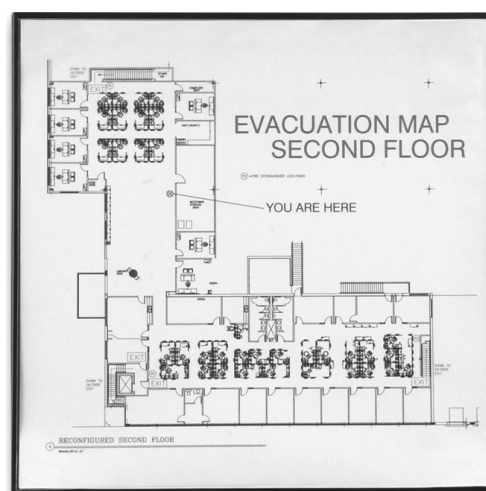
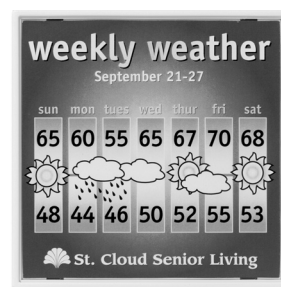

IPC.962/REV.6

S430 Informational Sign Suggested Specifications

PART 1 – GENERAL

1.01 SUMMARY

A. Interior non-illuminated informational surface mounted signage.

1.02 SECTION INCLUDES

A. S430 Overlay Sign

1.03 REFERENCES

A. Americans with Disabilities Act (ADA)
B. American National Standards Institute (ANSI)

1.04 SYSTEM DESCRIPTION

A. Performance Requirements: Provide signage systems that conform to the following requirements of regulatory agencies and the quality control of InPro SignScape.

1. Signage shall comply with all applicable provisions of the ADA and ANSI A117.1-1998

1.05 SUBMITTALS

A. Product Data: Manufacturer's printed product data for each signage system indicated in this section.

B. Signage Report: SignPro signage report indicating signage sizes, lettering and construction.

C. Samples: Verification samples of signage systems minimum of 6 inches square of each type and color indicated.

D. Manufacturer's Installation Instructions: Printed Installation Instructions for each signage system.

1.06 DELIVERY, STORAGE AND HANDLING

A. Deliver materials in unopened factory packaging to the jobsite.

B. Inspect materials at delivery to assure that specified product have been received.

C. Store in original packaging in a climate controlled environment away from direct sunlight.

1.07 WARRANTY

A. Standard InPro SignScape limited lifetime warranty against material and manufacturing defects.

PART 2 – PRODUCTS

2.01 MANUFACTURERS

A. Acceptable Manufacturer:

InPro SignScape, InPro Corporation
PO Box 406, Muskego, WI 53150 USA
Telephone 800-222-5556, Fax: 888-715-8407
E-mail: service@inprocorp.com

B. Substitutions: Not permitted

C. Provide all signage systems from a single manufacturer.

2.02 MATERIALS

A. Frames

1. Injection Molded Frames: Molded frames shall be manufactured of injection molded thermoplastic. Frame shall have square corners or corners with a 3/4" radius.

B. Frame Finishes

1. Injection Molded Frames: Color to be selected, by the architect, from the InPro SignScape finish selection. Texture shall be sand.

C. Production Style

1. Panel Face

a. Provide Clear .030" (.8mm) polycarbonate material cut to snap into frame and protect user supplied printed graphics.

2.03 MANUFACTURED UNITS

A. Molded Frames

1. Frame Item number, Size and Shape:

SFS0208, 2" (51mm) x 8" (203mm), square corners
SFS0404, 4" (102mm) x 4" (102mm), square corners
SFS0408, 4" (102mm) x 8" (203mm), square corners
SFS0606, 6" (152mm) x 6" (152mm), square corners
SFS0808, 8" (203mm) x 8" (203mm), square corners
SFS1212, 12" (305mm) x 12" (305mm), square corners
SFR0208, 2" (51mm) x 8" (203mm), rounded corners
SFR0404, 4" (102mm) x 4" (102mm), rounded corners
SFR0408, 4" (102mm) x 8" (203mm), rounded corners

SFR0606, 6" (152mm) x 6" (152mm), rounded corners
SFR0808, 8" (203mm) x 8" (203mm), rounded corners
SFR1212, 12" (305mm) x 12" (305mm), rounded corners

PART 3 – EXECUTION

3.01 EXAMINATION

A. Examine areas and conditions in which the signage system will be installed.

1. Complete all finishing operations, including painting, before beginning installation of signage systems.

2. Wall surface shall be dry and free from dirt, grease and loose paint.

3.02 PREPARATION

A. General: Prior to installation, clean substrate to remove dust, debris and loose particles.

3.03 INSTALLATION

A. General: Locate the signage system as indicated on the approved detail drawing for the appropriate substrate and in compliance with the InPro SignScape installation instructions. Install signage systems level and plumb at the height indicated on the drawings.

3.04 CLEANING

A. At completion of the installation, clean surfaces in accordance with the InPro SignScape clean up and maintenance instructions.



P.O. Box 406 · Muskego, Wisconsin 53150 USA
inprocorp.com
Nationwide 800.222.5556/Fax 888.715.8407
International Sales 262.679.5521/Fax 262.679.5524

INPRO CORPORATION
Interior and Exterior Architectural Products

Sanparrel Informational Series

S440 Informational Sign

S440 Window Signs

Standard Sizes

- ▶ 12" x 12" (305mm x 305mm) with 8.5" x 11" (216mm x 279mm) clear window
- ▶ 16" x 16" (406mm x 406mm) with 11" x 14" (279mm x 356mm) clear window
- ▶ 22" x 20" (559mm x 508mm) with two 11" x 8.5" (279mm x 216mm) clear windows, unframed only
- ▶ 15" x 28" (381mm x 711mm) with three 11" x 8.5" (279mm x 216mm) clear windows, unframed only
- ▶ 18" x 24" (457mm x 610mm) with six 16.875" x 2.375" (429mm x 60mm) clear windows, unframed only

Production Styles

- ▶ Tactile
- ▶ Partial Inlay
- ▶ Flush Inlay
- ▶ Engraved

Frame Options

- ▶ Standard injection molded frames with square or round corners: 12" x 12" (305mm x 305mm)
- ▶ Custom size PVC and aluminum extruded frames available; square corners only
- ▶ Northern Hardwoods frames with red oak or maple wood or bamboo

Additional Information

- ▶ Manufactured from Sanparrel Rigid Vinyl Sheet and clear polycarbonate sheet
- ▶ Signs available in more than 180 colors and patterns
- ▶ Logos available; digital file required (eps, wmf, dmx or ai files accepted)
- ▶ See "Sign Collections" for additional style options

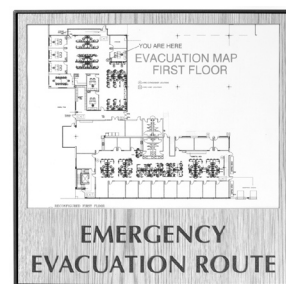

S440 Standard

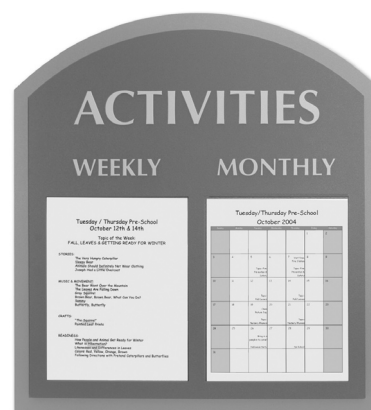

S440 ADW (Arched double window)
Shown with available backplate

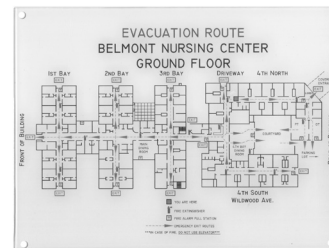

S440 Subsurface Sign

Standard Size

- ▶ 9" h x 12" w (228mm x 305mm)

Production Style

- ▶ Digital printing (image printed below top surface)

IPC.963/REV.8



P.O. Box 406 · Muskego, Wisconsin 53150 USA
 inprocorp.com
 Nationwide 800.222.5556/Fax 888.715.8407
 International Sales 262.679.5521/Fax 262.679.5524

INPRO
SIGNSCAPE
Signage and Wayfinding

S440 Informational Sign Suggested Specifications

PART 1 – GENERAL

1.01 SUMMARY

A. Interior non-illuminated information surface mounted signage.

1.02 SECTION INCLUDES

A. S440 Informational Sign with Window

1.03 REFERENCES

A. Americans with Disabilities Act (ADA)
B. American National Standards Institute (ANSI)

1.04 SYSTEM DESCRIPTION

A. Performance Requirements: Provide signage systems that conform to the following requirements of regulatory agencies and the quality control of InPro SignScape.

1. Signage shall comply with all applicable provisions of the ADA and ANSI A117.1-1998

1.05 SUBMITTALS

A. Product Data: Manufacturer's printed product data for each signage system indicated in this section.
B. Detail Drawings: Detail drawings showing sizes and lettering, construction details of each type of sign and mounting details with appropriate fasteners for specific project substrates.
C. Samples: Verification samples of signage systems minimum of 6 inches (152mm) square of each type and color indicated.
D. Manufacturer's Installation Instructions: Printed Installation Instructions for each signage system.

1.06 DELIVERY, STORAGE AND HANDLING

A. Deliver materials in unopened factory packaging to the jobsite.
B. Inspect materials at delivery to assure that specified product have been received.
C. Store in original packaging in a climate controlled environment away from direct sunlight.

1.07 WARRANTY

A. Standard InPro SignScape limited lifetime warranty against material and manufacturing defects.

PART 2 – PRODUCTS

2.01 MANUFACTURERS

A. Acceptable Manufacturer: InPro SignScape, InPro Corporation
PO Box 406, Muskego, WI 53150 USA
Telephone 800-222-5556, Fax: 888-715-8407
Email: service@inprocorp.com
B. Substitutions: Not permitted
C. Provide all signage systems from a single manufacturer.

2.02 MATERIALS

A. Signage Panel

1. Provide signage material in a color selected by the architect from InPro SignScape color selection.

B. Frames

1. Injection Molded Frames: Molded frames shall be manufactured of injection molded thermoplastic. Frame shall have square corners or corners with a $\frac{3}{4}$ " (19mm) radius.
2. Extruded Aluminum Frames: Aluminum frames shall be fabricated from 6063-T5 aluminum.
3. Extruded Vinyl Frames: Vinyl frames shall be extruded from chemical and stain resistant polyvinyl chloride.
4. Wood Frames: Wood frames shall be fabricated from kiln dried solid maple or red oak with a moisture content of 5-9%.
5. Bamboo Frames: Bamboo frames shall be fabricated from kiln dried solid mao, grass reed in Natural or Carbonized with a moisture content of 5-9%.

C. Frame Finishes

1. Injection Molded Frames: Color to be selected, by the architect, from the InPro SignScape finish selection. Texture shall be sand.
2. Extruded Aluminum Frames: Color to be selected, by the architect, from the InPro SignScape finish selection. Aluminum shall be anodized.
3. Extruded Vinyl Frames: Color to be selected, by the architect, from the InPro SignScape finish selection. Texture shall be smooth.
4. Wood Stain: Color of the maple and red oak to be selected by the architect from the IPC stain selection. Wood frames shall be finished with two coats of low luster satin finish.
5. Bamboo Stain: Color of the bamboo to be selected, by the architect, in a clear finish. Bamboo frames shall be finished with a water based, low luster satin finish.

D. Production Style

1. Tactile (Raised Letter)

a. Framed: Provide sign panel consisting of a top layer of .060" (1.5mm) sheet, .010" (.3mm) clear polycarbonate sheet (Arch Double Window - .030" (.8mm)) and a back layer of

.060" (1.5mm) sheet. Top layer is cut and bonded to clear sheet to create window. Clear sheet is bonded to back layer with space to allow user supplied paper to slide behind clear sheet. Additional .040" (1mm) sheet is cut and adhered to the top layer to create signage. Grade 2 Braille is optional.

b. Unframed: Provide sign panel consisting of a top layer of .060" (1.5mm) sheet, .010" (.3mm) clear polycarbonate sheet (Arch Double Window and Arch Triple Window - .030" (.8mm)) and a back layer of .060" (1.5mm) sheet. Top layer is cut and bonded to clear sheet to create window. Clear sheet is bonded to back layer with space to allow user supplied paper to slide behind clear sheet. Additional .040" (1mm) sheet is cut and adhered to the top layer to create signage. Grade 2 Braille is optional.

2. Partial Inlay (Tampor Resistant Tactile Signage)

a. Framed: Provide sign panel consisting of a top layer of .060" (1.5mm) sheet, .010" (.3mm) clear polycarbonate sheet (Arch Double Window - .030" (.8mm)) and a back layer of .060" (1.5mm) sheet. Top layer is cut and bonded to clear sheet to create window. Clear sheet is bonded to back layer with space to allow user supplied paper to slide behind clear sheet. Top layer is engraved to receive additional .060" (1.5mm) sheet that is cut and adhered to the top layer to create signage. Grade 2 Braille is optional.

b. Unframed: Provide sign panel consisting of a top layer of .060" (1.5mm) sheet, .010" (.3mm) clear polycarbonate sheet (Arch Double Window and Arch Triple Window - .030" (.8mm)) and a back layer of .060" (1.5mm) sheet. Top layer is cut and bonded to clear sheet to create window. Clear sheet is bonded to back layer with space to allow user supplied paper to slide behind clear sheet. Top layer is engraved to receive additional .060" (1.5mm) sheet that is cut and adhered to the top layer to create signage. Grade 2 Braille is optional.

3. Flush Inlay

a. Framed: Provide sign panel consisting of a top layer of .040" (1mm) material, .010" (.3mm) clear polycarbonate sheet (Arch Double Window - .030" (.8mm)) and a back layer of .040" (1mm) sheet. Top layer is cut and bonded to clear sheet to create window. Clear sheet is bonded to back layer with a space to allow user supplied paper to slide behind clear sheet. Top layer is engraved to receive additional .040" (1mm) sheet that is cut and adhered to the top layer to create signage.

b. Unframed: Provide sign panel consisting of a top layer of .040" (1mm) sheet, .010" (.3mm) clear polycarbonate sheet (Arch Double Window and Arch Triple Window - .030" (.8mm)) and a back layer of .060" (1.5mm) sheet. Top layer is cut and bonded to clear sheet to create window. Clear sheet is bonded to back layer with a space to allow user supplied paper to slide behind clear sheet. Top layer is engraved to receive additional .040" (1mm) sheet that is cut and adhered to the top layer to create signage.

4. Engraved

a. Framed: Provide sign panel consisting of two layers of .040" (1mm) sheet, .010" (.3mm) clear polycarbonate sheet (Arch Double Window - .030" (.8mm)) and a back layer of .040" (1mm) material. Top two layers are cut and bonded to clear sheet to create window. Clear sheet is bonded to back layer with a space to allow user supplied paper to slide behind clear sheet. Top layer is engraved to create signage.

b. Unframed: Provide sign panel consisting of two layers of .040" (1mm) sheet, .010" (.3mm) clear polycarbonate sheet (Arch Double Window and Arch Triple Window - .030" (.8mm)) and a back layer of .040" (1mm) sheet. Top two layers are cut and bonded to clear sheet to create window. Clear sheet is bonded to back layer with a space to allow user supplied paper to slide behind clear sheet. Top layer is engraved to create signage.

5. Grade 2 Braille

a. Provide Grade 2 Braille produced with the Raster™ Method, patented process for placing Braille on signage. Raster™ Braille is computer engineered using a carbide-engraving bit, press-fit tool with vacuum pump and UV stable acrylic rasters.

E. Accessories/Options

1. Unframed Signage Mounting Options

a. Double-sided Foam Tape: Provide double-sided foam tape to adhere unframed signage to clean, dry, well sealed substrates.
b. Magnetic Mounting Strips: Provide magnetic mounting strips to attach unframed signage to steel substrates.

c. Screw Mount: Provide screw mount unframed signage with exposed mounting fasteners. Fasteners to be located at each corner.
d. Double-sided Foam Tape and Heavy Duty Adhesive: Provide double sided foam tape and heavy duty adhesive to adhere larger signs and PRISM® signs to clean, dry, well sealed substrates.

2. Unframed Signage Corner Conditions

a. Square Corners: Provide unframed signage corners that are 90 degrees square.
b. Radius Corners: Provide unframed signage corners with a .525" (13mm) radii.
c. Scalloped Corners: Provide unframed signage corners with a .5" (13mm) scallop.
d. Notched Corners: Provide unframed signage corners with a .5" (13mm) notch.

2.03 MANUFACTURED UNITS

A. Molded Frames

1. Frame Item number, Size and Shape:
SFS1212, 12" (305mm) x 12" (305mm), square corners
SFR1212, 12" (305mm) x 12" (305mm), radius corners

B. Aluminum Frames

Size - Custom, Minimum 3" (76mm) x 3" (76mm),
Maximum 48" (1.22m) x 96" (2.44m)

C. Extruded Vinyl Frame

Size - Custom, Minimum 3" (76mm) x 3" (76mm),
Maximum 48" (1.22m) x 96" (2.44m)

D. Wood and Bamboo Frames

1. Frame Item number, Size and Shape:
SFW-AR2014, 20" (508mm) x 14" (356mm), Arch
SFW-RD1616, 16" (406mm) x 16" (406mm), Radius
SFW-SQ1616, 16" (406mm) x 16" (406mm), Square
Wood Type - Maple, Oak, or Bamboo

E. Standard Sign Panels

1. Single Window

a. 12" (305mm) x 12" (305mm) with one
8.5" (216mm) x 11" (279mm) clear window
b. 16" (406mm) x 16" (406mm) with one
11" (279mm) x 14" (356mm) clear window
Specify framed or unframed

2. Arch, Double Window

22" (559mm) x 20" (508mm) with two 11" (279mm) x 8.5" (216mm) clear windows, unframed only

3. Arch, Triple Window

15" (381mm) x 28" (711mm) with three 11" (279mm) x 8.5" (216mm) clear windows, unframed only

4. Today's Direction

18" (457mm) x 24" (610mm) with six 16.875" (429mm) x 2.375" (60mm) clear windows, unframed only

PART 3 – EXECUTION

3.01 EXAMINATION

A. Examine areas and conditions in which the signage system will be installed.

1. Complete all finishing operations, including painting, before beginning installation of signage systems.
2. Wall surface shall be dry and free from dirt, grease and loose paint.

3.02 PREPARATION

A. General: Prior to installation, clean substrate to remove dust, debris, and loose particles.

3.03 INSTALLATION

A. General: Locate the signage system as indicated on the approved detail drawing for the appropriate substrate and in compliance with the InPro SignScape installation instructions. Install signage systems level and plumb at the height indicated on the drawings.

3.04 CLEANING

A. At completion of the installation, clean surfaces in accordance with the InPro SignScape clean up and maintenance instructions.



P.O. Box 406 · Muskego, Wisconsin 53150 USA

inprocorp.com

Nationwide 800.222.5556/Fax 888.715.8407

International Sales 262.679.5521/Fax 262.679.5524

INPRO CORPORATION
Interior and Exterior Architectural Products

Sanparrel Informational Series

S440-G Glow-in-the-Dark Window Signs

Standard Sizes

- ▶ 12" x 12" (305mm x 305mm) with
8.5" x 11" (216mm x 279mm) clear window

Production Styles

- ▶ Tactile
- ▶ Partial Inlay

Frame Options

- ▶ Standard injection molded frames with square or round corners: 12" x 12" (305mm x 305mm)
- ▶ Custom size PVC and aluminum extruded frames available; square corners only
- ▶ Northern Hardwoods frames with red oak or maple wood or bamboo

Additional Information

- ▶ Manufactured from Sanparrel Rigid Vinyl Sheet, photoluminescent sheet and clear polycarbonate sheet
- ▶ Evacuation plan to be printed on transparency
- ▶ Signs available in more than 180 Sanparrel colors and patterns
- ▶ Logos available; digital file required (eps, dmx, ai and wmf files accepted)
- ▶ See "Sign Collections" for additional style options

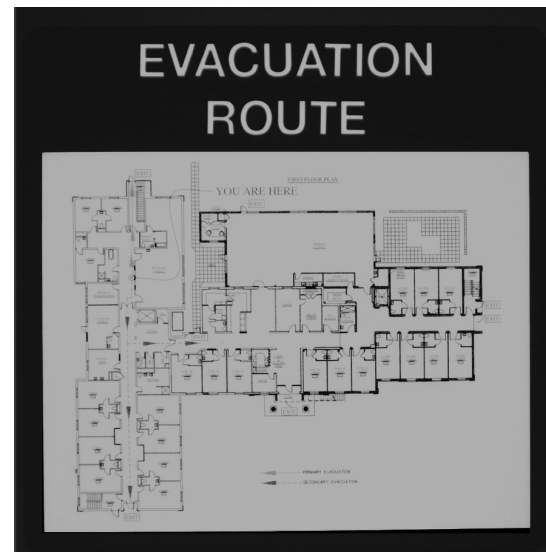

Window and text glow



P.O. Box 406 · Muskego, Wisconsin 53150 USA
inprocorp.com
Nationwide 800.222.5556/Fax 888.715.8407
International Sales 262.679.5521/Fax 262.679.5524

IPC.974/REV.5

INPRO
SIGNSCAPE
Signage and Wayfinding

S440-G Glow-in-the-Dark Window Sign

Suggested Specifications

PART 1 – GENERAL

1.01 SUMMARY

- A. This section includes ADA compliant tactile signage and changeable message signage

1.02 SECTION INCLUDES

- A. S440G Glow in the Dark Informational Sign with Window

1.03 REFERENCES

- A. Americans with Disabilities Act (ADA)
B. American National Standards Institute (ANSI)
C. American Society of Testing and Materials (ASTM)
D. Deutsche Institut fuer Normung (DIN)

1.04 SYSTEM DESCRIPTION

- A. Performance Requirements: Provide signage systems that conform to the following requirements of regulatory agencies and the quality control of InPro SignScape.

1. Signage shall comply with all applicable provisions of the ADA and ANSI A117.1-1998

2. Provide Glow in the Dark, photoluminescent material that complies with applicable provisions of ASTM E-2073-02 and DIN 67510. Photoluminescent material shall have up to 8 hours of luminance.

1.05 SUBMITTALS

- A. Product Data: Manufacturer's printed product data for each signage system indicated in this section.
B. Signage Report: SignPro signage report indicating signage sizes, lettering and construction.
C. Samples: Verification samples of signage systems minimum of 6 inches square of each type and color indicated.
D. Manufacturer's Installation Instructions: Printed Installation Instructions for each signage system.

1.06 DELIVERY, STORAGE AND HANDLING

- A. Deliver materials in unopened factory packaging to the jobsite.
B. Inspect materials at delivery to assure that specified product have been received.
C. Store in original packaging in a climate controlled environment away from direct sunlight.

1.07 WARRANTY

- A. Standard InPro SignScape limited lifetime warranty against material and manufacturing defects.

PART 2 – PRODUCTS

2.01 MANUFACTURERS

- A. Acceptable Manufacturer: InPro SignScape, InPro Corporation PO Box 406, Muskego, WI 53150 USA Telephone 800-222-5556, Fax: 888-715-8407 E-mail: service@inprocorp.com
B. Substitutions: Not permitted
C. Provide all signage systems from a single manufacturer.

2.02 MATERIALS

- A. Signage Panel

1. Provide signage material in a color selected by the architect from InPro SignScape color selection.

- B. Frames

1. Injection Molded Frames: Molded frames shall be manufactured of injection molded thermoplastic. Frame shall have square corners or corners with a 3/4" radius.
2. Extruded Aluminum Frames: Aluminum frames shall be fabricated from 6063-T5 aluminum.
3. Extruded Vinyl Frames: Vinyl frames shall be extruded from chemical and stain resistant polyvinyl chloride.
4. Wood Frames: Wood frames shall be fabricated from kiln dried solid maple or red oak with a moisture content of 5-9%.
5. Bamboo Frames: Bamboo frames shall be fabricated from kiln dried solid mao, grass reed in Natural or Carbonized with a moisture content of 5-9%.

- B. Frame Finishes

1. Injection Molded Frames: Color to be selected, by the architect, from the InPro SignScape finish selection. Texture shall be sand.
2. Extruded Aluminum Frames: Color to be selected, by the architect, from the InPro SignScape finish selection. Aluminum shall be anodized.
3. Extruded Vinyl Frames: Color to be selected, by the architect, from the InPro SignScape finish selection. Texture shall be smooth.
4. Wood Stain: Color of the red oak and the maple to be selected by the architect from the IPC stain selection. Wood frames shall be finished with two coats of low luster satin finish.
5. Bamboo Stain: Color of the bamboo to be selected, by the architect, in a clear finish. Bamboo frames shall be finished with a water based, low luster satin finish.

- C. Production Style

1. Tactile (Raised Letter)

- a. Framed: Provide sign panel consisting of a top layer of .060" sheet, .010" clear polycarbonate sheet and a back layer of .050" glow-in-the-dark photoluminescent material with up to 8 hours of luminance. Top layer is cut and bonded to clear sheet to create window. Clear sheet is bonded to back layer with space to allow user supplied paper to slide behind clear sheet. Additional .040" sheet or .050" glow-in-the-dark photoluminescent material is cut and adhered to the top layer to create signage. Braille is optional.
b. Unframed: Provide sign panel consisting of a top layer of .060" sheet, .010" clear polycarbonate sheet and a back layer of .050" glow-in-the-dark photoluminescent material with up to 8 hours of luminance. Top layer is cut and bonded to clear sheet to create window. Clear sheet is bonded to back layer with space to allow user supplied paper to slide behind clear sheet. Additional .040" sheet or .050" glow-in-the-dark photoluminescent material is cut and adhered to the top layer to create signage. Braille is optional.

2. Partial Inlay (Tamper Resistant Tactile Signage)

- a. Framed: Provide sign panel consisting of a top layer of .060" sheet, .010" clear polycarbonate sheet and a back layer of .050" glow-in-the-dark photoluminescent material with up to 8 hours of luminance. Top layer is cut and bonded to clear sheet to create window. Clear sheet is bonded to back layer with space to allow user supplied paper to slide behind clear sheet. Top layer is engraved to receive .060" or .050" material. Additional .060" sheet or .050" glow-in-the-dark photoluminescent material is cut and adhered to the top layer create signage. Braille is optional.
b. Unframed: Provide sign panel consisting of a top layer of .060" sheet, .010" clear polycarbonate sheet and a back layer of .050" glow-in-the-dark photoluminescent material with up to 8 hours of luminance. Top layer is cut and bonded to clear sheet to create window. Clear sheet is bonded to back layer with space to allow user supplied paper to slide behind clear sheet. Top layer is engraved to receive .060" or .050" material. Additional .060" sheet or .050" glow-in-the-dark photoluminescent material is cut and adhered to the top layer create signage. Braille is optional.

3. Grade II Braille

- a. Provide Grade II Braille produced with the Raster™ Method, patented process for placing Braille on signage. Raster™ Braille is computer engineered using a carbide-engraving bit, press-fit tool with vacuum pump and UV stable acrylic rasters.

- D. Accessories/Options

1. Unframed Signage Mounting Options
a. Double-sided Foam Tape: Provide double-sided foam tape to adhere unframed signage to clean, dry, well sealed substrates.
b. Magnetic Mounting Strips: Provide magnetic mounting strips to attach unframed signage to steel substrates.
c. Screw Mount: Provide screw mount unframed signage with exposed mounting fasteners. Fasteners to be located at each corner.
d. Double-sided Foam Tape and Heavy Duty Adhesive: Provide double sided foam tape and heavy duty adhesive to adhere larger signs and PRISM® Solid Surface signs to clean, dry, well sealed substrates.
2. Unframed Signage Corner Conditions
a. Square Corners: Provide unframed signage corners that are 90° square.
b. Radius Corners: Provide unframed signage corners with .525" radii.
c. Scalloped Corners: Provide unframed signage corners with .500" scallop.
d. Notched Corners: Provide unframed signage corners with .500" notch.

2.03 MANUFACTURED UNITS

- A. Molded Frames

1. Frame Item number, Size and Shape:
SFS1212, 12"(305mm) x 12"(305mm), square corners
SFR1212, 12"(305mm) x 12"(305mm), radius corners

- B. Aluminum Frames

- Size - Custom, Minimum 3"(76mm) x 3"(76mm), Maximum 48"(1.22m) x 96"(2.44m)

- C. Extruded Vinyl Frame

- Size - Custom, Minimum 3"(76mm) x 3"(76mm), Maximum 48"(1.22m) x 96"(2.44m)

- D. Wood and Bamboo Frames

1. Frame Item Number, Size and Shape
SFW-RD1616, 16"(406mm) x 16"(406mm), Radius
SFW-SQ1616, 16"(406mm) x 16"(406mm), Square
SFW-AR2014, 20"(508mm) x 14"(356mm), Arch

- Wood Type - Maple, Oak, or Bamboo

- F. Standard Sign Panels

1. Glow in the Dark, Single Window Sign
a. 12"(305mm) x 12"(305mm), with one 8.5"h(280mm) x 11"w(216mm) clear window. Specify framed or unframed

PART 3 – EXECUTION

3.01 EXAMINATION

- A. Examine areas and conditions in which the signage system will be installed.

1. Complete all finishing operations, including painting, before beginning installation of signage systems.
2. Wall surface shall be dry and free from dirt, grease and loose paint.

3.02 PREPARATION

- A. General: Prior to installation, clean substrate to remove dust, debris and loose particles.

3.03 INSTALLATION

- A. General: Locate the signage system as indicated on the approved detail drawing for the appropriate substrate and in compliance with the InPro SignScape installation instructions. Install signage systems level and plumb at the height indicated on the drawings.

3.04 CLEANING

- A. At completion of the installation, clean surfaces in accordance with the InPro SignScape clean up and maintenance instructions.



Sanparrel Informational Series S450 and S455 Activity/Calendar Signs

Standard Sizes

- ▶ S450: Overall Sign Size 47⁷/₈" x 68¹/₂" (1.19m x 1.74m)
- ▶ S450: Clear Magnetic Window Sign Size 6¹/₂" x 8¹/₂" (165mm x 216mm)
- ▶ S455: Overall Sign Size 28¹/₂" x 44" (72m x 1.12m)
- ▶ S455: Clear Magnetic Window Sign Size 3" x 5" (76mm x 127mm)

Production Styles

- ▶ Tactile and Flush

Additional Information

- ▶ Manufactured from Sanparrel Rigid Vinyl Sheet
- ▶ Signs available in more than 180 Sanparrel colors and patterns
- ▶ 35 clear magnetic window signs allow you to insert your own sign or photo produced from the convenience of your own computer/printer
- ▶ No templates required; clear window signs accommodate 8¹/₂" x 11" paper folded in half (S450) or standard 3" x 5" index cards (S455)
- ▶ Logos available; digital file required (eps, wmf, dmx or ai files accepted)



S455



S450

IPC.975/REV.4

P.O. Box 406 · Muskego, Wisconsin 53150 USA
inprocorp.com
Nationwide 800.222.5556/Fax 888.715.8407
International Sales 262.679.5521/Fax 262.679.5524

INPRO
SIGNSCAPE
Signage and Wayfinding

S450/S455 Activity/Calendar Sign

Suggested Specifications

PART 1 – GENERAL

1.01 SUMMARY

A. This section includes ADA compliant tactile signage and changeable message signage

1.02 SECTION INCLUDES

A. S450/S455 Activity/Calendar Sign

1.03 REFERENCES

A. Americans with Disabilities Act (ADA)
B. American National Standards Institute (ANSI)

1.04 SYSTEM DESCRIPTION

A. Performance Requirements: Provide signage systems that conform to the following requirements of regulatory agencies and the quality control of InPro SignScape.

1. Signage shall comply with all applicable provisions of the ADA and ANSI A117.1-1998

1.05 SUBMITTALS

A. Product Data: Manufacturer's printed product data for each signage system indicated in this section.
B. Detail Drawings: Detail drawings showing sizes and lettering, construction details of each type of sign and mounting details with appropriate fasteners for specific project substrates.
C. Samples: Verification samples of signage systems minimum of 6 inches square of each type and color indicated.
D. Manufacturer's Installation Instructions: Printed Installation Instructions for each signage system.

1.06 DELIVERY, STORAGE AND HANDLING

A. Deliver materials in unopened factory packaging to the jobsite.
B. Inspect materials at delivery to assure that specified product have been received.
C. Store in original packaging in a climate controlled environment away from direct sunlight.

1.07 WARRANTY

A. Standard InPro SignScape limited lifetime warranty against material and manufacturing defects.

PART 2 – PRODUCTS

2.01 MANUFACTURERS

A. Acceptable Manufacturer: InPro SignScape, InPro Corporation PO Box 406, Muskego, WI 53150 USA
Telephone 800-222-5556, Fax: 888-715-8407
E-mail: service@inprocorp.com

B. Substitutions: Not permitted

C. Provide all signage systems from a single manufacturer.

2.02 MATERIALS

C. Production Style

1. Tactile (Raised Letter)

a. Provide sign material consisting of .040" sheet bonded to .060" sheet. Top layer is cut and assembled to create signage.

b. Provide clear sign window consisting of a top layer of .060" sheet, .010" clear polycarbonate sheet and a back layer of .060" sheet. Top layer is cut and bonded to clear sheet to create window. Clear sheet is bonded to back layer with space to allow user supplied paper to slide behind clear sheet.

2. Flush Inlay

Provide sign panel consisting of .080" (2mm) sheet that is engraved to receive .040" (1mm) sheet that is cut and assembled to create signage.

2.03 MANUFACTURED UNITS

A. S450 Activity/Calendar Sign

1. Overall size: 47⁷/₈"(1.22m)h x 68¹/₂"(1.74m)w
Clear window: size 6¹/₂"(165mm)h x 8¹/₂"(216mm)w, quantity – 35, Clear windows are to be mounted to sign with magnetic strips.

Monthly header Sign: Size 1¹/₂"(38mm)h x 23⁷/₈"(606mm)w

B. S455 Activity/Calendar Sign

1. Overall size: 28¹/₂"(.724m)h x 44" (1.12m)w
Clear window: size 3¹/₂"(89mm)h x 5¹/₂"(140mm)w, quantity – 35, Clear windows are to be mounted to sign with magnetic strips.

Monthly Header Sign: Size 1¹/₄"(32mm)h x 10"(254mm)w

PART 3 – EXECUTION

3.01 EXAMINATION

A. Examine areas and conditions in which the signage system will be installed.

1. Complete all finishing operations, including painting, before beginning installation of signage systems.
2. Wall surface shall be dry and free from dirt, grease and loose paint.

3.02 PREPARATION

A. General: Prior to installation, clean substrate to remove dust, debris and loose particles.

3.03 INSTALLATION

A. General: Locate the signage system as indicated on the approved detail drawing for the appropriate substrate and in compliance with the InPro SignScape installation instructions. Install signage systems level and plumb at the height indicated on the drawings.

3.04 CLEANING

A. At completion of the installation, clean surfaces in accordance with the InPro SignScape clean up and maintenance instructions.



P.O. Box 406 · Muskego, Wisconsin 53150 USA
inprocorp.com
Nationwide 800.222.5556/Fax 888.715.8407
International Sales 262.679.5521/Fax 262.679.5524

INPRO CORPORATION
Interior and Exterior Architectural Products

Sanparrel Informational Series

S460 Donor Board

Standard Sizes

- ▶ Donor Board: 27" x 36"
- ▶ Side Expansion Board: 20³/₄" x 11"
- ▶ Magnetic Nameplate: 1¹/₄" x 3"

Production Styles

- ▶ Tactile
- ▶ Partial Inlay

Additional Information

- ▶ Manufactured from Sanparrel Rigid Vinyl Sheet: nameplates manufactured from brushed gold or silver on black styrene
- ▶ Signs available in more than 180 colors and patterns
- ▶ Logos available; digital file required (eps, wmf, dmx or ai files accepted)



Donor Board

Side Expansion Board

IPC.991/REV.2

P.O. Box 406 · Muskego, Wisconsin 53150 USA
 inprocorp.com
 Nationwide 800.222.5556/Fax 888.715.8407
 International Sales 262.679.5521/Fax 262.679.5524

INPRO
SIGNSCAPE
 Signage and Wayfinding

S460 Donor Board

Suggested Specifications

PART 1 – GENERAL

1.01 SUMMARY

- A. Interior Donor Board

1.02 SECTION INCLUDES

- A. S460 Donor Sign

1.03 REFERENCES

- A. Americans with Disabilities Act (ADA)
- B. American National Standards Institute (ANSI)

1.04 SYSTEM DESCRIPTION

- A. Performance Requirements: Provide signage systems that conform to the following requirements of regulatory agencies and the quality control of InPro SignScape.

1. Signage shall comply with all applicable provisions of the ADA and ANSI A117.1-1998

1.05 SUBMITTALS

- A. Product Data: Manufacturer's printed product data for each signage system indicated in this section.
- B. Detail Drawings: Detail drawings showing sizes and lettering, construction details of each type of sign and mounting details with appropriate fasteners for specific project substrates.
- C. Samples: Verification samples of signage systems minimum of 6 inches square of each type and color indicated.
- D. Manufacturer's Installation Instructions: Printed Installation Instructions for each signage system.

1.06 DELIVERY, STORAGE AND HANDLING

- A. Deliver materials in unopened factory packaging to the jobsite.
- B. Inspect materials at delivery to assure that specified product have been received.
- C. Store in original packaging in a climate controlled

environment away from direct sunlight.

1.07 WARRANTY

- A. Standard InPro SignScape limited lifetime warranty against material and manufacturing defects.

PART 2 – PRODUCTS

2.01 MANUFACTURERS

- A. Acceptable Manufacturer: InPro SignScape, InPro Corporation PO Box 406, Muskego, WI 53150 USA Telephone 800-222-5556, Fax: 888-715-8407 E-mail: service@inprocorp.com

- B. Substitutions: Not permitted

- C. Provide all signage systems from a single manufacturer.

2.02 MANUFACTURED UNITS

A. S460 Donor Board

1. Overall size: 27" (.686m)h x 36" (914m)w

- a. Header: Provide Donor Board Header, 9"h x 36"w, consisting of .060" sheet bonded to a back layer of .080" sheet. Top layer, 7"h x 34.75"w, of .040" sheet is bonded to the two back layers, leaving a border. A text layer of .040" sheet is bonded and cut to form text.

- b. Donor Board: Provide Donor Board, 18"h x 36"w, consisting of sheets of .040", .040", and .060" thickness bonded together. Sheets shall be of the same color/pattern. 100 nameplate openings, 1.25"h x 3"w, are cut into the top two layers of sheet. Magnetic tape, 1" wide, shall be adhered in nameplate opening.

- c. Side Board Header: Provide Side Board Header, 2.75"h x 11"w, consisting of .040" sheet bonded to .040" sheet that is bonded to a back layer of .060" sheet.

- d. Side Board: Provide Side Board, 18"h x 11"w, consisting of .040", .040", and .060" sheet that is bonded together. 30 nameplate openings, 1.25"h x 3"w, are cut into the front and middle layers of sheet. 1" magnetic tape is adhered in each name plate opening.
- e. Nameplates: Provide Donor Board Nameplates, 1.25"h x 3"w, consisting of .060" thick material. Nameplates are engraved to produce text. 1" metal foil will be adhered to the back of nameplate. Nameplates shall mount flush in donor board.

PART 3 – EXECUTION

3.01 EXAMINATION

- A. Examine areas and conditions in which the signage system will be installed.

1. Complete all finishing operations, including painting, before beginning installation of signage systems.

2. Wall surface shall be dry and free from dirt, grease and loose paint.

3.02 PREPARATION

- A. General: Prior to installation, clean substrate to remove dust, debris and loose particles.

3.03 INSTALLATION

- A. General: Locate the signage system as indicated on the approved detail drawing for the appropriate substrate and in compliance with the InPro SignScape installation instructions.

Install signage systems level and plumb at the height indicated on the drawings.

3.04 CLEANING

- A. At completion of the installation, clean surfaces in accordance with the InPro SignScape clean up and maintenance instructions.

