

CURTAIN WALL & OVERHEAD GLAZING

kawneer.com

 **KAWNEER**
AN ALCOA COMPANY

CURTAIN WALL & OVERHEAD GLAZING

Kawneer offers a comprehensive line of architectural aluminum building products and systems for commercial construction – entrances, framing systems, windows and curtain wall systems. For over a century, Kawneer has been recognized as an innovator. Since that time, we've balanced experience with change and ongoing improvement. We strive every day to develop solutions that promote integrated, sustainable building practices, and we are dedicated to providing the tools our customers need to succeed. Thermal breaks, condensation management and building integrated photovoltaic (BIPV) and unitized curtain walls are just a few examples of how we have responded to customer needs.



1600 SS™ (Screw Spline) Curtain Wall (custom), 360 Insulclad® Doors
Ryerson Image Centre and the School of Image Arts
Architects: Diamond Schmitt Architects Inc., Toronto, Ontario, Canada
Glazing Contractor: Stouffville Glass Inc., Stouffville, Ontario, Canada
Photography: © Arthur Kendrick



1600 Wall System®1 (Impact Resistant), 350 IR Doors
LECOM School of Dental Medicine, Bradenton, Florida
Architect: FAWLEYBRYANT, Sarasota, Florida
Glazing Contractor: Key Glass LLC, Bradenton, Florida
Photography: © Mark Borosch Photography



Advanced Façades, Dual Custom Unitized Curtain Wall, Custom Vents (chain actuated by building operating system and power button), 360 Insulclad® Doors
Loyola University Chicago Marcella Niehoff School of Nursing, Maywood, Illinois
Architect: Solomon Cordwell Buenz, Chicago, Illinois
Glazing Contractor: Mid-States Glass and Metal, Morton Grove, Illinois
Photography: © FotoGraphix – Viken Djaferian

HURRICANE RESISTANT AND BLAST MITIGATION PRODUCTS

Kawneer offers single-source responsibility with a comprehensive group of independently tested hurricane resistant and blast mitigation products. Many hurricane resistant products have received Notices of Acceptance (NOAs) issued by Miami-Dade County BCCO and Florida State Approvals. Blast mitigation products meet requirements of the General Services Administration (GSA), Interagency Security Committee (ISC) and Department of Defense (DoD). For more information, visit Kawneer.com.

Custom Curtain Wall

Selected for the world's most recognized buildings
Engineering and design expertise | Established leadership in major applications around the world

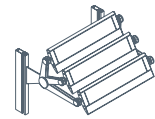

1600 PowerShade®

Provides a single-source solution and optimal shade while generating solar power and reducing energy use
Pre-engineered sunshade system effectively reduces solar heat gain | Dual-position pivot system provides optimal angle and extension for shading any location | Can be directly connected to 1600 Wall System®1

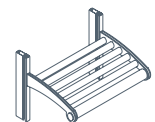

Versoleil™ SunShade – Outrigger System

An economical, pre-engineered and integrated sunshade with mix-and-match design choices
Standardized design compatible with 1600 Wall System®1, 1600 Wall System®2, 1600UT System™1, 1600 Wall System®5 and 1600 SS™ | Shades interiors and conserves energy with 30" and 36" projection options | Provides a single-source solution | Outriggers, fascia caps and louvers are available in several shapes

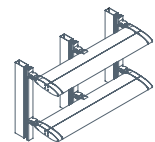

Versoleil™ SunShade – Single Blade System

Shades of versatility in form and function
Standardized solution for seamless integration with 1600 Wall System®1, 1600 Wall System®2, 1600 Wall System®5, 1600 SS™ and 1600 SS™ SSG curtain wall systems | Highly versatile design allows for blades to be mounted in horizontal or vertical configurations | Innovative mounting design allows for multiple angles in both horizontal and vertical configurations | Multiple blade sizes ranging from 6" to 14" deep

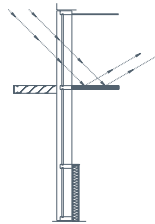

InLighten® Light Shelf

Reduces the need for artificial lighting by passively channeling natural daylight into an occupied space
Leverages minimal material content, sightlines, weight, installation and maintenance efforts, all while maximizing value, daylighting and design options | Light shelf features an extruded aluminum chassis system with several panel choices | Tilt feature for easy cleaning of the top reflective panel surface | Availability of depths of up to 30" allows for maximizing the overall reflective surface area



1600 PowerWall® and 1600 PowerSlope®

Combines 1600 Wall System®1 and 1600 Sloped Glazing and photovoltaic (PV) panels that convert light energy from the sun directly into electricity without using fossil fuels
Fully compatible with 1600 Wall System®1 and 1600 Sloped Glazing for vertical and sloped glazed applications



1600UT (Ultra Thermal) System™1 and 1600UT System™2

Ultra-innovative solution raises standards for thermal performance
System1 – outside glazed, captured system
System2 – outside glazed, structural silicone glazed system
Built on the success of the flagship 1600 curtain wall platform, the 1600UT System™ delivers high thermal performance, versatility, reliability and value | Ideal for low- to mid-rise commercial applications where high thermal performing façades are needed | Accepts double or triple glazing



1600 Wall System®3 and 1600 Wall System®4

Inside/outside glazed curtain wall system
System3 has a 2-1/2" profile
System4 has a 2-1/4" profile
Incorporates IsoStrut® Thermal Break for superior structural and thermal performance | Allows for a structural silicone glazing option | Integral exterior cover and thermal isolator reduce installed cost | Inside glazing reduces installation costs | Outside glazing option for spandrel re-glazing

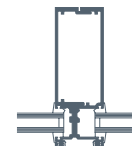

1600 Wall System®5

An inside glazed curtain wall/ribbon window system
2-1/2" profile | Offered in 7-1/2" system depth and optional 6" system depth | Shear block construction for fabrication versatility | Structural silicone glazed option | Optional split mullion design with screw spline construction for ease of installation and fabrication | Allows two-color design options



1600 SS™ (Screw Spline) Curtain Wall / 1600 SS Unitwall™ (Pre-glazed option)

Shop assembled for faster field installation
Outside glazed captured or SSG curtain wall | Concealed screw spline joinery allows for shop assembly | Unique interlocking mullion design eliminates the need for anti-buckling clips | System depths and sightline match 1600 Wall System®1 and System®2 | 1600 SS Unitwall™ allows units to be pre-glazed in the shop | 1600 SS™ blast tested per ASTM F 1642 and GSA-TS01-03 standards



Clearwall™ Curtain Wall

Achieves an all-glass monolithic aesthetic in a field glazed, screw spline application
Innovative toggle assembly captures glass, eliminating field application of structural silicone | Six glazing options use the toggle-based glass retention system | No structural silicone required for Clearwall™ SS/SB glazing options, which use the toggle to directly capture recessed spacer glass | Other glazing options use a metal interface attached to standard 1" insulating glass | Screw spline joinery method allows shop assembly of ladder sections, reducing field labor | Deeper mullions with shear block joinery allow for higher free span applications

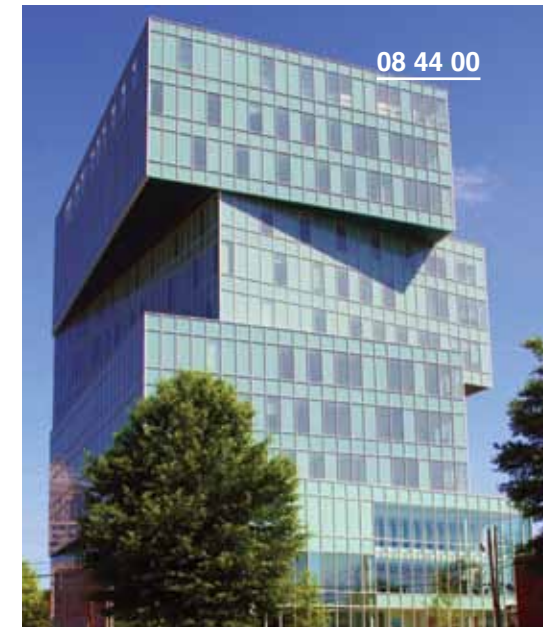

1600 Wall System®3
UNC Charlotte Center City Building, Charlotte, North Carolina
Seeking LEED® Silver certified
Architect: Gantt Huberman Architects, Charlotte, North Carolina
Glazing Contractor: SPS Corporation, Apex, North Carolina
Photography: © Progress Photo



1600 Wall System®1, 1600 Wall System®2, Trifab® VG (VersaGlaze®) 451T Framing, Trifab® VG (VersaGlaze®) 450 Framing, 350 Medium Stile Doors, 1600 SunShade® (custom), Alcoa – Reynobond® ACM (Aluminum Composite Material) Panels
Georgia Gwinnett College Library and Learning Center, Lawrenceville, Georgia
LEED® Gold certified
Architect: LEO A DALY, Atlanta, Georgia
Glazing Contractor: Glass Systems, Inc., Lithonia, Georgia
Photography: © Creative Sources Photography / Rion Rizzo



Clearwall™ Curtain Wall
Port of Nanaimo Cruise Ship Terminal, Nanaimo, British Columbia, Canada
Architects: David Poiron Architect Inc., Nanaimo, British Columbia, Canada
Ben Checkwith Design, Salt Spring Island, British Columbia, Canada
Glazing Contractor: b3 Glass Ltd, Burnaby, British Columbia, Canada
Photography: Courtesy Nanaimo Port Authority

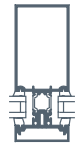

7500 Wall®

Exceptional thermal performance and resistance to condensation
Incorporates high-performance IsoWeb® Thermal Break |
Accommodates 1" double-glazed or 2" triple-glazed insulating glass
units | Exterior pressure glazed system

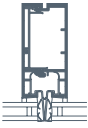

2500 PG Unitwall™

A high-performance unitized curtain wall system
Available in stock length, fabricated or pre-assembled and glazed
units | Unitized construction accelerates installation | Available
systems include 4-sided captured, vertical and horizontal SSG
(Structural Silicone Glazed) or 4-sided SSG | 2-1/2" x 7-1/2" profile |
Suitable for new construction or remodel | Dual finish capabilities

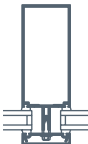

1600 L-R (Low-Rise) Wall®

Economical stock length system for low-rise applications
Outside glazed pressure plate system available in captured or
two-sided vertical SSG option | Standard 5-3/4" or 7-1/4" system
depths | Shear block construction utilizing concealed fasteners

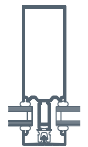

2250 L-R (Low-Rise) Wall

The economical system designed for low-rise applications
Economical stick system with no-compromise performance |
Utilizes a polymer thermal clip, allowing for easier installation
and labor savings | 2-1/4" sightline | Design flexibility allows a
structural silicone glazed option | Mullion drained design

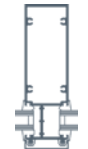

2250 IG (Inside Glazed)

An economical, inside glazed ribbon window/curtain
wall system
Narrow 2-1/4" profile | Offered in 4-1/2", 6" and 7-1/2" system
depths | Shear block and screw spline construction for easy
fabrication | Structural silicone glazed option | Allows two-color
design options | Thermally improved

OVERHEAD GLAZING



1600 Sloped Glazing and 2000 Skylight

Curtain wall performance in overhead glazing systems
Stick system – fully factory fabricated | Silicone glazed or captured
purlin options | Flush grid exterior has a 2-1/2" sightline | Various
mullion depths to meet wind and snow loads | Handles hip and
valley rafter applications

COVER PHOTO

1600 Curtain Wall, 2250 IG (Inside Glazed) Curtain Wall, 2000 Skylight, Trifab® VG (VersaGlaze®)
450 Framing, 350 Standard Entrances
Art Gallery of Alberta, Edmonton, Alberta, Canada
Architects: Randall Stout Architects, Los Angeles, California, USA and HIP Architects, Edmonton,
Alberta, Canada
Glazing Contractor: Flynn Canada, Acheson, Alberta, Canada
Photography: Image courtesy of Randall Stout Architects, Inc., © 2010

Kawneer Company, Inc.
Technology Park / Atlanta
555 Guthridge Court
Norcross, GA 30092

kawneer.com
kawneergreen.com
770 . 449 . 5555



FINISHES

ANODIZED FINISHES

Long-lasting, protective coatings resist
abrasion, corrosion and UV rays, and meet
or exceed AAMA 611

Architectural Metals

Light satin is a Class I finish with a chrome-like
brightness and light brushed texture | Available
on a variety of products

Permanodic® Clear Finishes

Available in Anodized Class I (#14) or Class II (#17)

Permanodic® Color Finishes

Available in clear (Class I and Class II) and color
(Class I) choices, including champagne, black, light
bronze, medium bronze and dark bronze

PAINTED FINISHES

Fluoropolymer Coatings – Enduring color with
high performance and durability

Available in many standard choices and unlimited
custom colors | These include Permafluor™ and
Permadize® finishes, which meet or exceed AAMA
2604 or AAMA 2605

Powder Coatings – Create a "green" element
with solvent-free high performance, durability
and scratch resistance

Permacoat™ finishes available in 24 standard
colors | Powder coatings meet or exceed
AAMA 2604

NOTICE

Laws and building and safety codes governing the
design and use of windows, glazed entrance, framing,
curtain wall and overhead glazing products vary widely.
Kawneer does not control the selection of product
configuration, operating hardware or glazing materials,
and assumes no responsibility thereof.

Information contained in this catalog is subject to
change without notice.

OTHER PRODUCTS FROM KAWNEER

Entrances & Framing 08 41 00; Windows 08 51 00

FOR MORE INFORMATION

Visit Kawneer.com for more detailed information,
including the most current Guide Specifications, CAD
libraries and BIM product models.

