

COMPLETE WATERPROOFING ONE COMPANY

CCW provides a complete line of waterproofing solutions and the expertise to help you select the one that is best for your project.

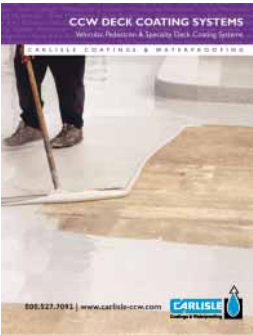

CCW Deck Coatings

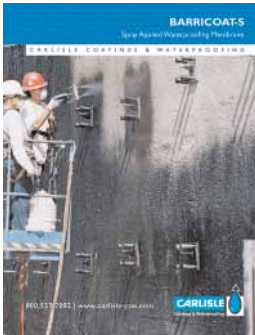

Barricoat™-S

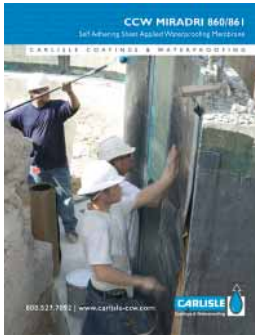

CCW MiraDRI® 860/861

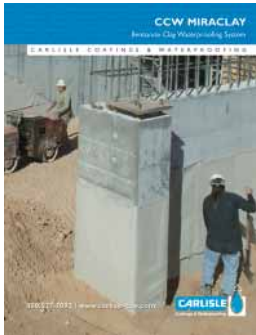

CCW MiraCLAY®

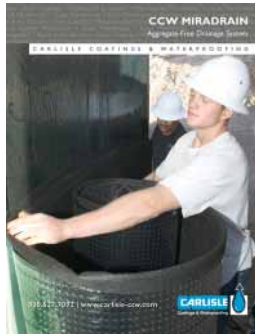

CCW MiraDRAIN



Air & Vapor Barrier Systems



CCW 525



Visit Our Web Site at
www.carlisle-ccw.com

- **Updates**
- **Data Sheets**
- **Contacts**
- **Guide Specifications**
- **Architectural Details**
- **Technical Bulletins**

LIMITED WARRANTY

Carlisle Coatings & Waterproofing, Incorporated (Carlisle) warrants this product to be free of defects in workmanship and materials only at the time of shipment from our factory. If any Carlisle materials prove to contain manufacturing defects that substantially affect their performance, Carlisle will, at its option, replace the materials or refund its purchase price.

This limited warranty is the only warranty extended by Carlisle with respect to its materials. There are no other warranties including the implied warranties of merchantability and fitness for a particular purpose.

Carlisle specifically disclaims liability for any incidental, consequential or other damages including, but not limited to, loss of profits or damages to a structure or its contents arising under any theory of law whatsoever.

The dollar value of Carlisle's liability and buyer's remedy under this limited warranty shall not exceed the purchase price of the Carlisle material in question.

900 Hensley Lane • Wylie TX 75098
800-527-7092 • www.carlisle-ccw.com



Carlisle, Sure-Seal, Barricoat, MiraDRI, MiraCLAY and MiraDRAIN are trademarks of Carlisle. LEED is a registered trademark of the U.S. Green Building Council.
© 2010 Carlisle. 601400 CCW-500R 07/11 CCS

CCW-500R

Reinforced Hot-Applied Liquid Waterproofing Membrane

C A R L I S L E C O A T I N G S & W A T E R P R O O F I N G



800.527.7092 | www.carlisle-ccw.com



CCW-500R Reinforced Hot-Applied Liquid Waterproofing Membrane

Carlisle Coatings & Waterproofing Incorporated (CCW) provides a broad range of solutions to meet specific waterproofing needs. CCW offers technical services, research and development and manufacturing capabilities from its headquarters in Wylie, Texas and three additional manufacturing facilities in Terrell, TX; Elberton, GA; and Carlisle, PA. The CCW network is further supported by over 50 manufacturer's sales representatives



FEATURES AND BENEFITS

- CCW-500R is a hot-applied rubberized asphalt waterproofing system that provides a monolithic system, free of seams, which fully adheres to the substrate.
- CCW-500 contains 26% pre-consumer content that helps contribute toward LEED® credits.
- CCW-500R membrane forms a watertight seal, eliminating water migration and buildup of moisture on the surface of the substrate.
- CCW-500 can be applied in low ambient temperatures. Its immediate curing time allows the project to progress in a timely fashion.
- CCW-500 will conform to surface irregularities and fill minor deck flaws – ideal for rough, uneven surfaces on rehab applications. The self-healing characteristics of CCW-500R allow for a watertight membrane, even after minor construction punctures.
- CCW-500R membrane, when used in an inverted roofing membrane application (IRMA), has a longer performance life than conventional roofing applications because it is protected from thermocycling and mechanical damage.
- CCW-500 is a single-component material that does not require the addition of a catalyst or the curing steps typical of cold fluid-applied systems.

directed by regional sales offices throughout the country. CCW offers a complete line of waterproofing and moisture protection products for the architectural, general construction, industrial and maintenance industries. Carlisle Coatings & Waterproofing, Inc., is part of the Carlisle Construction Materials Division of Carlisle Companies, Inc., which is a publicly traded company on the NYSE.

PRODUCT DESCRIPTION
CCW-500 is a single-component, hot-applied, waterproofing membrane that cures to form a strong, flexible, fully adhered, monolithic waterproofing and roofing membrane. While serving as an exceptionally resilient waterproofing barrier, it also contains a special blend of renewable content, comprised of 26% pre-consumer material, and can contribute toward LEED® credits in new building construction.

The double-layer, reinforced CCW-500R system adheres tenaciously to virtually any structural surface, vertical or horizontal, to ensure that water will not migrate beneath the membrane in the event of physical damage. CCW-500R allows for applications on a wide variety of substrate conditions and enhances crack bridging capability.

APPLICATIONS
CCW-500 is the perfect waterproofing membrane for all of the following applications:

- Roof Decks in an Inverted Roof Membrane Assembly (IRMA)
- Split Slab Construction for Plaza Decks
- Roof Terraces and Planters
- Parking Garages and Foundation Walls
- Walkway Links
- Highway Bridge Decking and Tunnels
- GreenRoof/Rooftop Planting Systems

- INSTALLATION GUIDELINES**
- Remove any foreign matter from the concrete that may be detrimental to the adhesion of the membrane.
 - Prime the surface with CCW-550 Primer (Not available in states with VOC restrictions. Alternative solutions include: CCW-702, CCW-702LV and CCW AWP.)
 - Pretreat all construction joints, cracks, drains, penetrations and wall junctions with CCW-500 and fabric reinforcement.
 - Install CCW-711-90 on all exposed flashing areas.
 - For a reinforced system, apply first coat of CCW-500 at 90 mils thick, then apply the fabric reinforcing sheet, firmly pressing into the hot layer of CCW-500. Apply second coat of CCW-500 at 125 mils thick.
 - Cover the CCW-500 membrane with CCW Protection Course.
 - Water test the system for 24 hours with 2" minimum water coverage.
 - Install CCW MiraDRAIN, insulation and finished surfacing.

- STANDARD TESTS CERTIFICATES**
- Patent-Pending Formulation
 - Membrane for Roofing Systems
 - Classified by Underwriters Laboratories Inc. As to External Fire Exposure Only 5M85
 - Canadian Specification CGSB-37.50-M89
 - UL790 Class A
 - Miami-Dade Certification

SYSTEM DEFINITION
CCW-500:
Hot-Applied Waterproofing Membrane

CCW-500R Membrane:
Reinforced Membrane Assembly (CCW-500, Reinforcing Fabric, CCW-500)

CCW-500R System:
Complete Hot-Applied System Components (Deck to Finished, Exposed Cover)



CCW-500 application to a roof deck.

TYPICAL IRMA APPLICATION USING CCW-500R

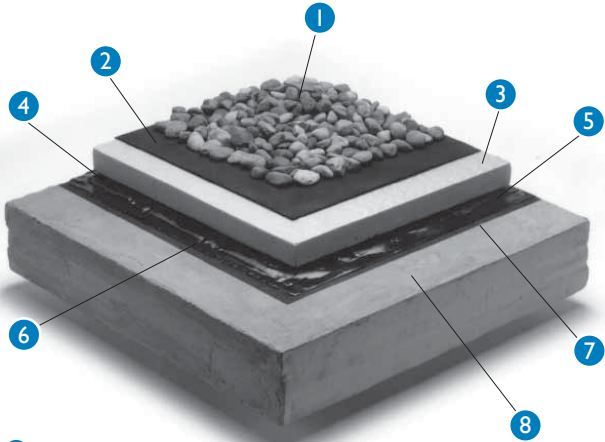

- 1 Ballast
- 2 Sure-Seal® HP Protection Mat
- 3 Insulation
- 4 Root-Barrier
- 5 CCW MiraDRAIN® or protection board
- 6 CCW-500R Membrane
- 7 CCW-550 Primer (Not available in states with VOC restrictions. Alternative solutions include: CCW-702, CCW-702LV and CCW AWP.)
- 8 Roof Deck

TYPICAL PLAZA DECK APPLICATION USING CCW-500R

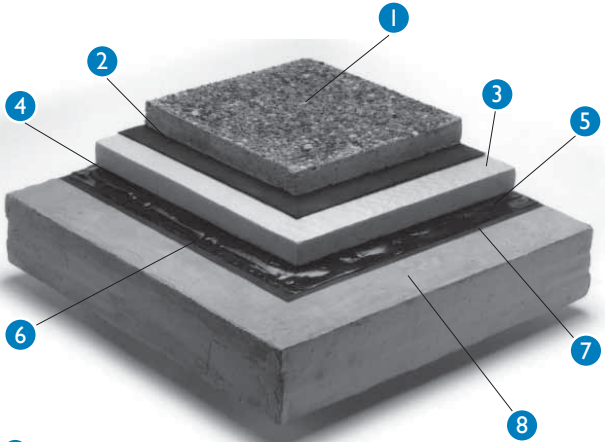

- 1 Plaza Deck
- 2 Sure-Seal HP Protection Mat
- 3 Insulation
- 4 Root-Barrier
- 5 CCW MiraDRAIN or protection board
- 6 CCW-500R Membrane
- 7 CCW-550 Primer
- 8 Roof Deck