

## Supplied Brackets

- All 2" Blinds, 1" Classic & 1/2" Micro
- 1" Supreme Blinds

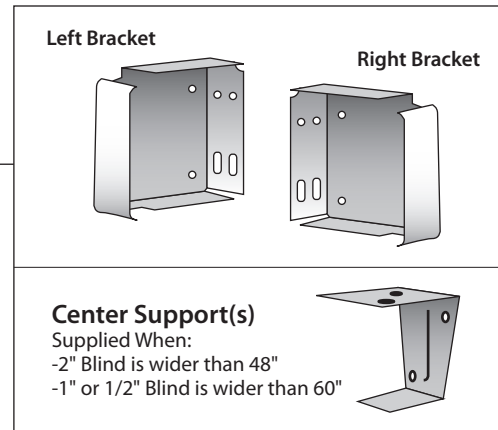
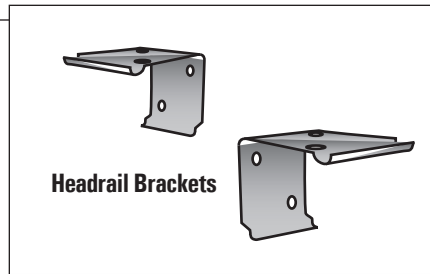

## 2" Blinds, 1" Classic & 1/2" Micro Blinds

### Attach The Brackets:

Use 2 screws per bracket. Install the 2 end brackets either into the ceiling, wall or side casing using the respective holes.

When center supports are supplied, you must attach them for the extra support. Make sure to install them within a straight line of the 2 side brackets. If your blind has an even number of "ladders" or "tapes", you can install the center support right in the center if only 1 is required. If your blind has an odd number of "ladders" or "tapes", you must install the center supports off center as to not interfere.

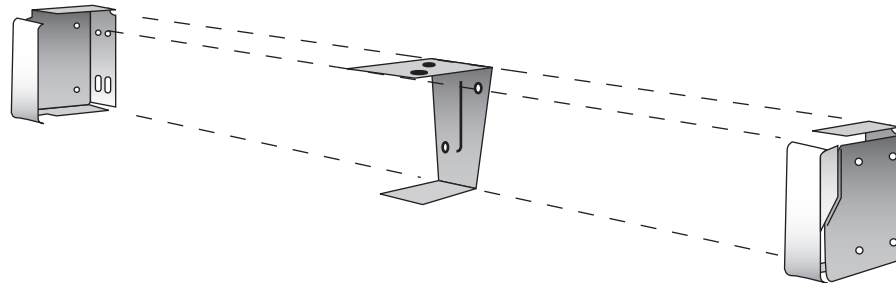

## 1" Supreme Mini Blinds

### Attach The Brackets:

Use 2 screws per bracket. Install the "hidden" brackets either into the ceiling or wall with even spacing between. It is important to mount brackets within at least 8" from the ends to give proper support to the pull cord mechanism. Depending on your blinds overall width, you will be supplied with 2 to 6 brackets.

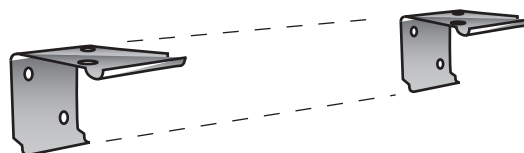

## Installing the Valances

### 2" Premium Wood Blinds

**Any Mount** - Attach clips (1) to headrail before installing blind in window. Take clip brackets (2) and insert them into the channel on back of valance. Position these clips relatively near where you placed the headrail clips. Hold valance just below headrail and adjust headrail clips to align with valance clips. Insert the valance and adjust height accordingly. For Outside Mounted blinds, returns are supplied with the valance: To Assemble, insert the small plastic/metal L-clip into slot on the back of the valance. Carefully apply pressure to seat the return onto the L-clip along the corresponding groove in the valance return.

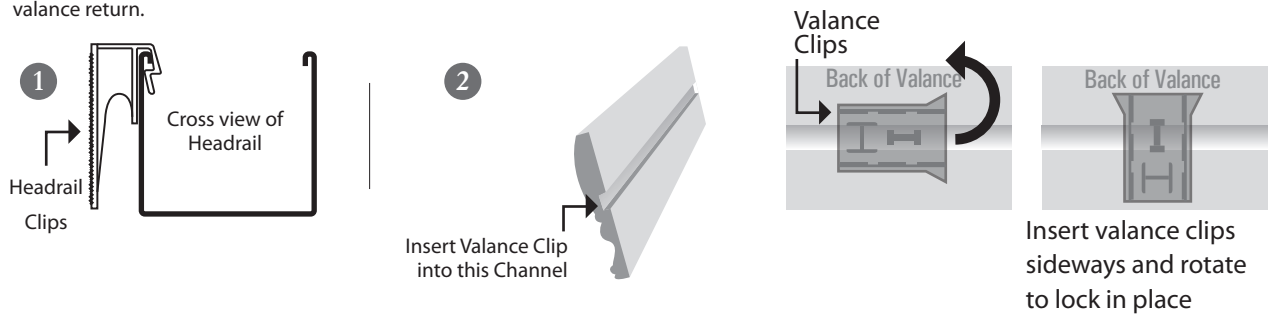

### 2" Trends Fauxwood Blinds

**Outside Mount** - Attach the clips to the valance first and then snap the clips onto the headrail. **Valance Returns** - To Assemble, insert the small plastic/metal L-clip into slot on the back of the valance. Carefully apply pressure to seat the return onto the L-clip along the corresponding groove in the valance return.

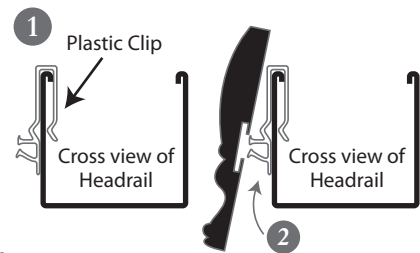

**Inside Mount** - If there is not enough room to slide the clips over the headrail you will need to attach the clips onto the headrail first prior to inserting the blind in the brackets.

### 2" Astra PVC Blinds (Optional Deluxe Valance)

**Outside Mount** - Mount the supplied valance brackets to the headrail with the C-Clip facing forward. Lock the bracket to headrail by swiveling the metal arm into position. Attach Valance fascia to C-Clips. Attach returns to supplied corner brackets.

**Inside Mount** - Mount Valance PRIOR to installing blind. Mount the valance straight up into the header of the window.

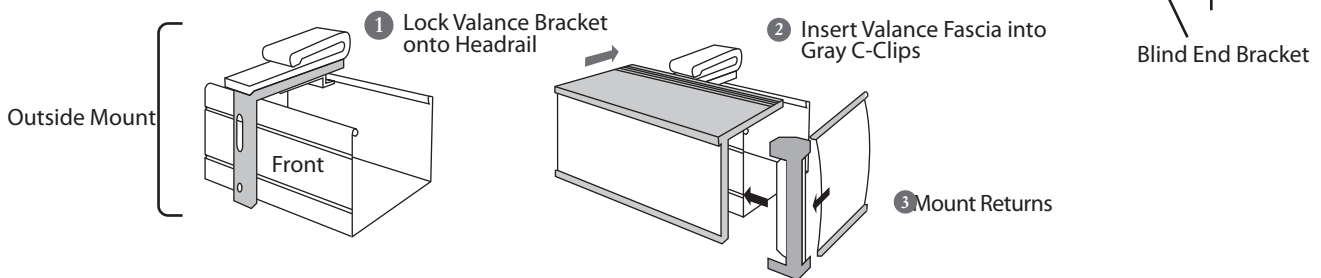

### Hold Down Brackets

These brackets are used only where it is desirable to keep the bottom of the blind from swinging freely, such as a door mounted scenario. Install blind and lower it all the way. Mark the position of the hold down brackets. Screw the Hold Down brackets to the surface. Slip the pin located on the bottom rail into brackets.

